



## EXIT TOYS 48 Inch 122cm Pool Ladder User Manual

[Home](#) » [EXIT TOYS](#) » EXIT TOYS 48 Inch 122cm Pool Ladder User Manual 



48 Inch 122cm Pool Ladder



User Manual

**Important safety rules:** Before installing and using this product read, understand, follow all instructions carefully and keep it for future reference!

## Contents

- [1 Part reference](#)
- [2 Introduction](#)
- [3 Guidelines for safe use](#)
- [4 Care and usage](#)
- [5 Limited warranty](#)
- [6 Documents / Resources](#)
- [7 Related Posts](#)

## Part reference

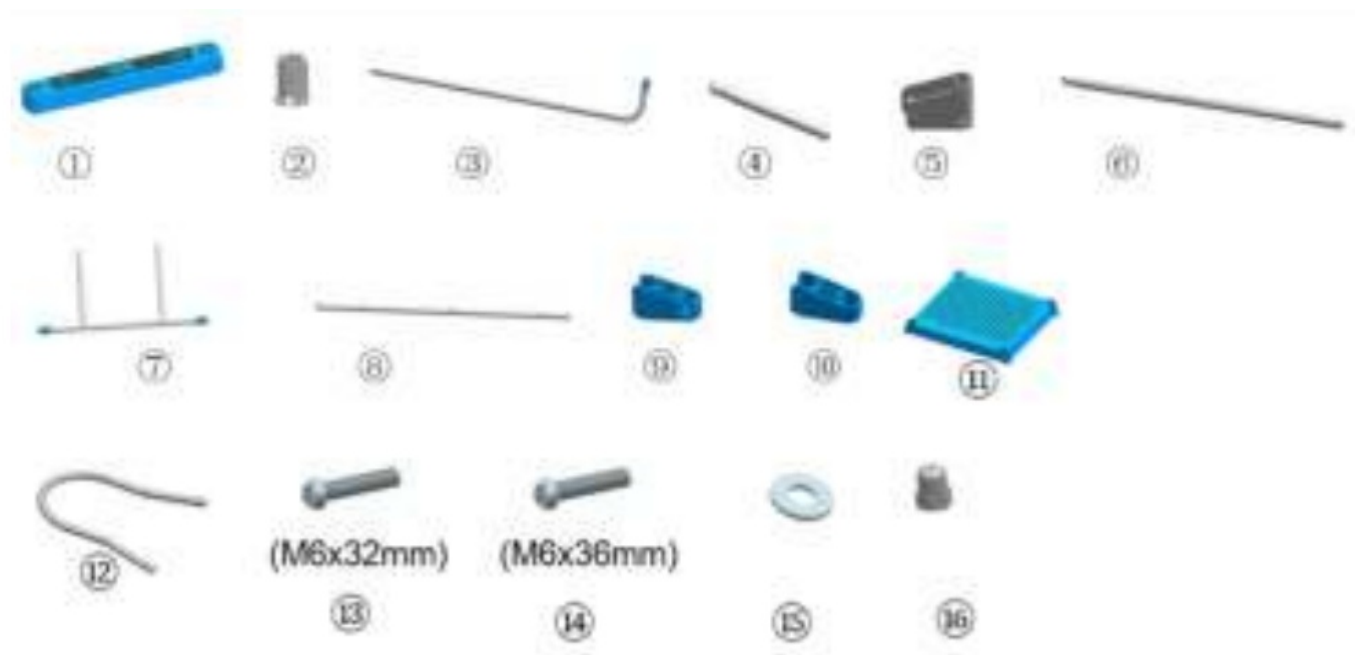

**NOTE:** Drawing for illustration purpose only. Actual product may vary. Not to scale. Before assembling your p, layout and review the contents to become familiar with all the parts you will be using during the assembly:

Part	Item no.	#
1	395238	6
2	395239	12
3	395254	2
4	395255	2
5	395242	2
6	395256	2
7	395244	1
8	395245	2
9	395246	2
10	395247	2
11	395257	1
12	395249	2
13	395250	6
14	395251	12
15	395252	40
16	395253	20

!

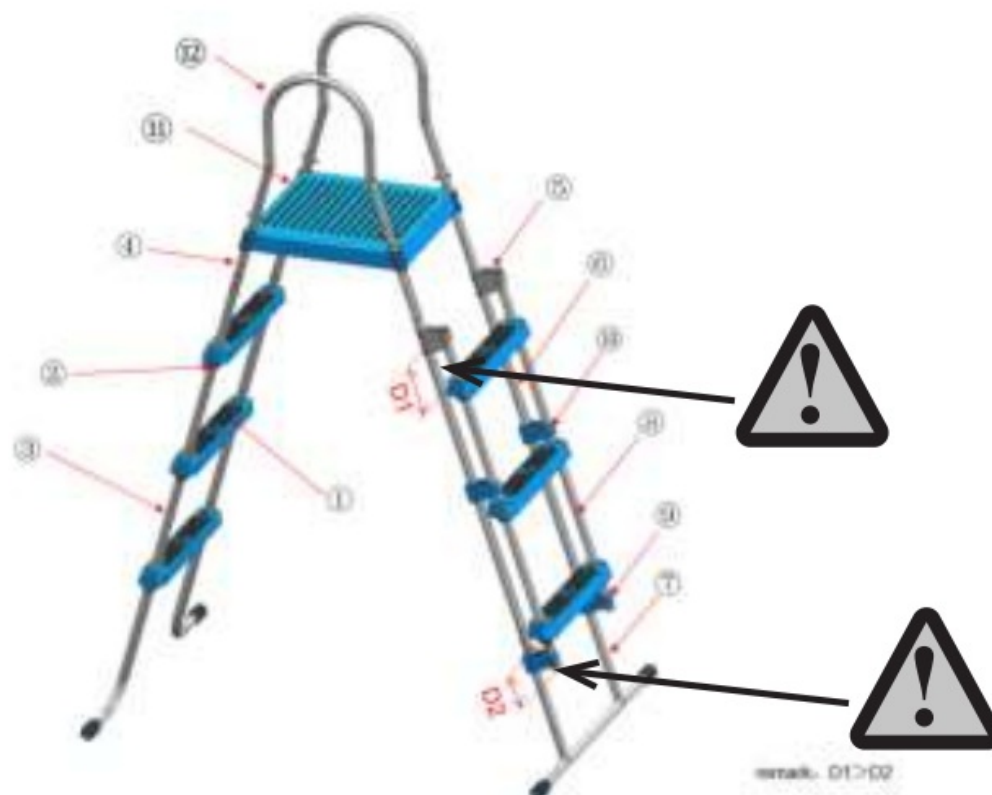

1.

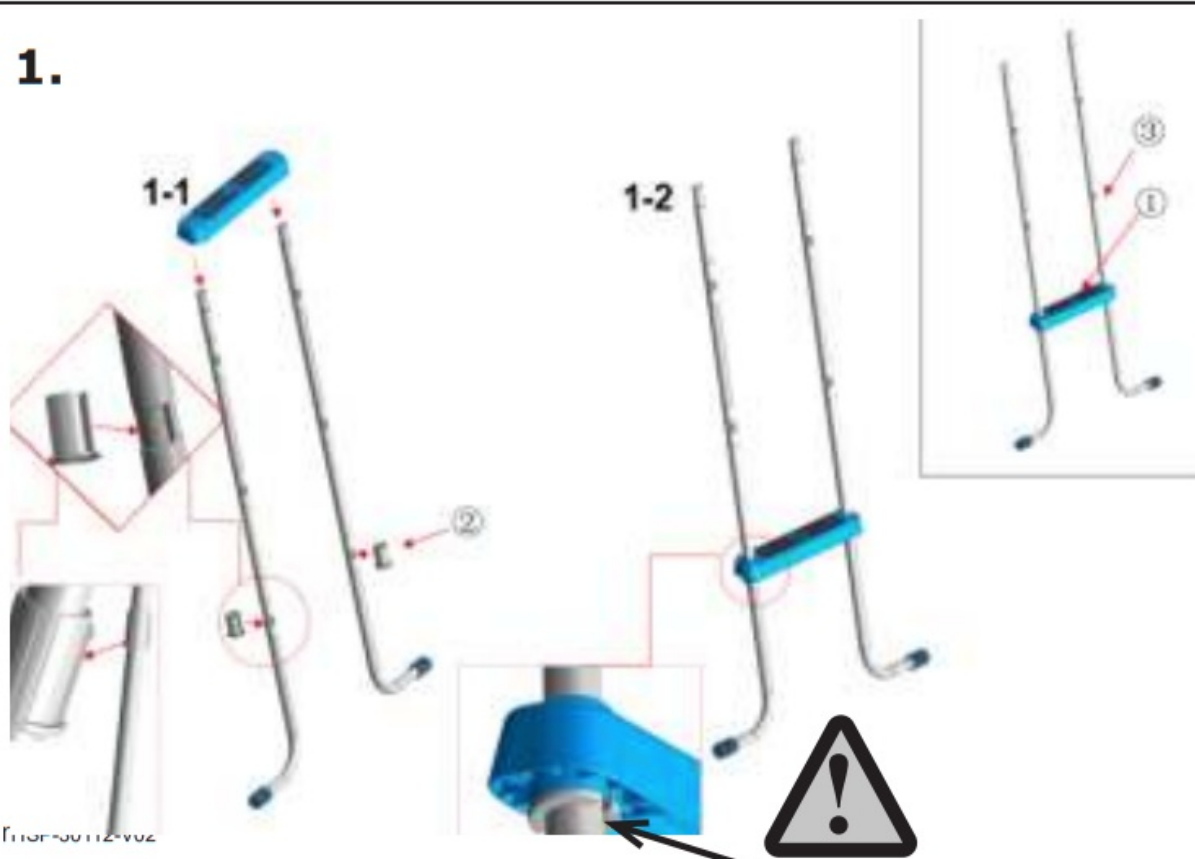

2.

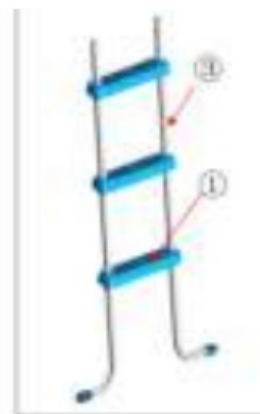

3.

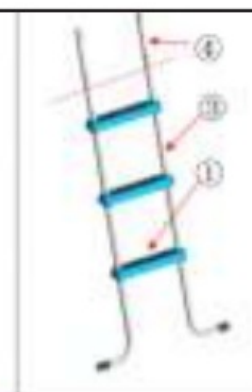
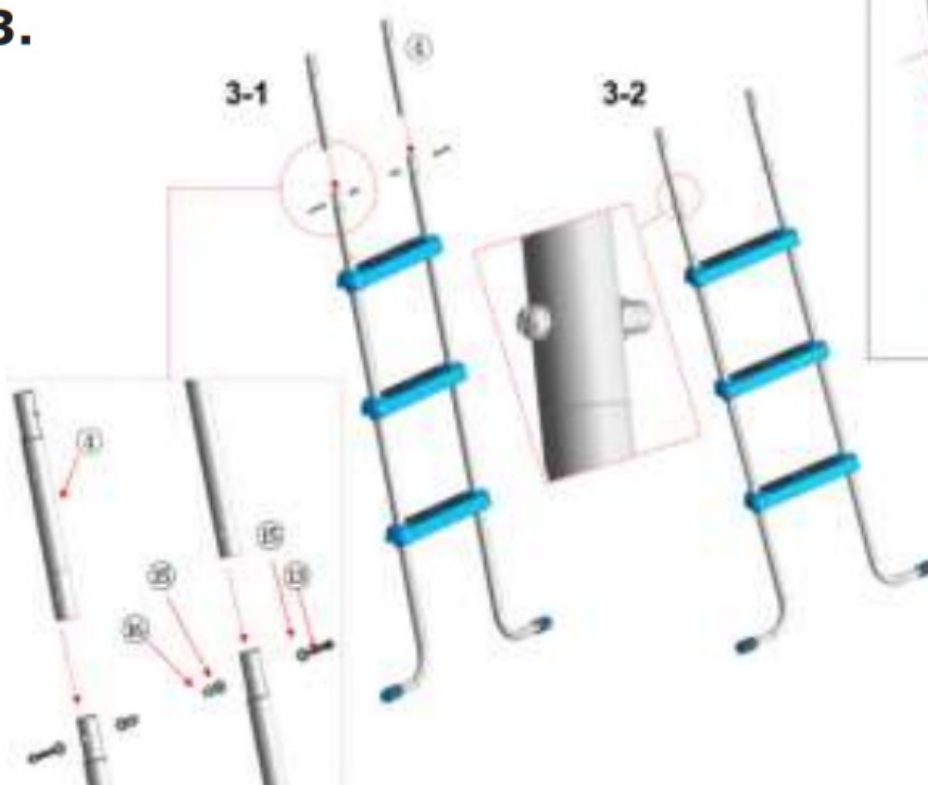

## 4.

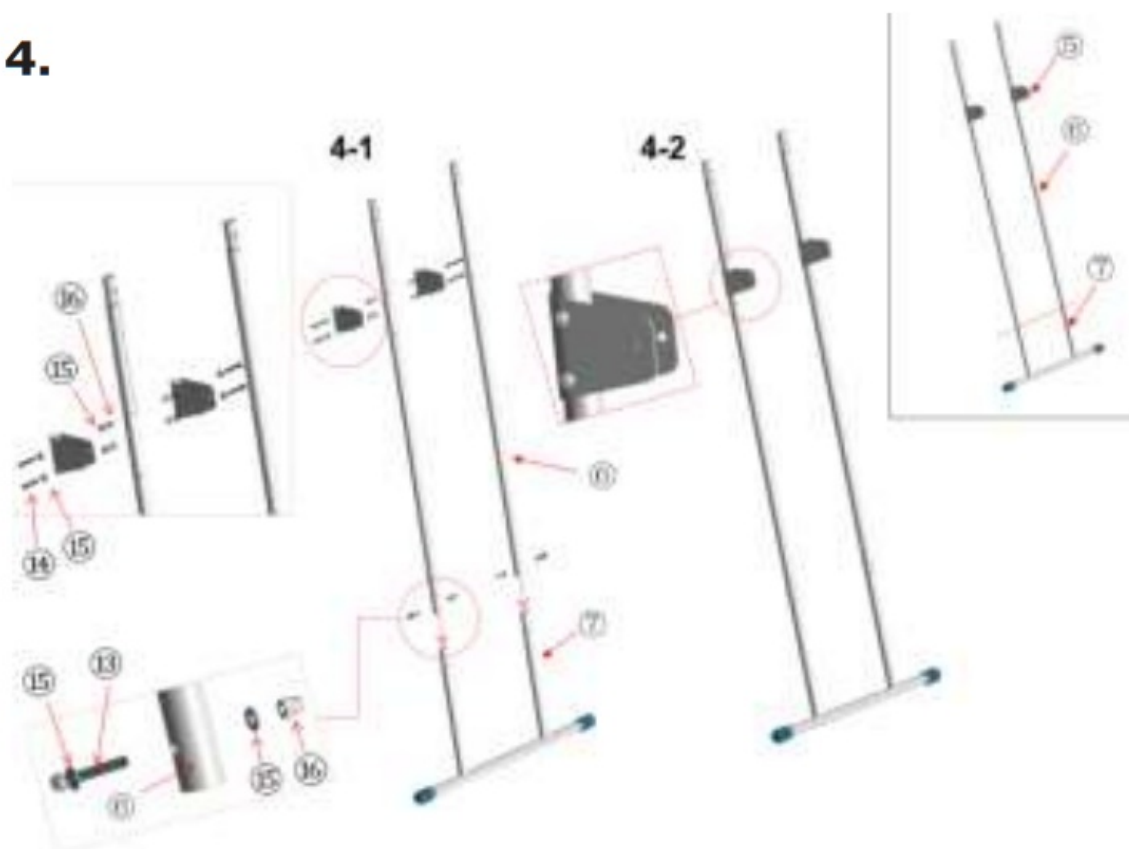

## 5.

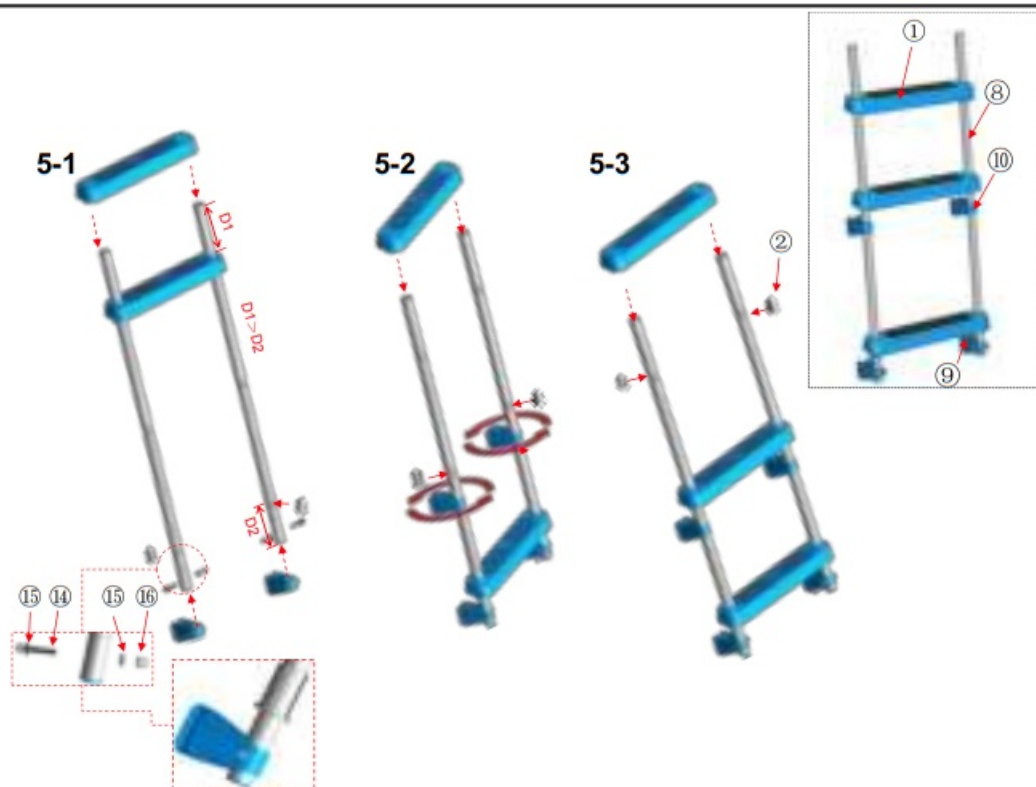

6.

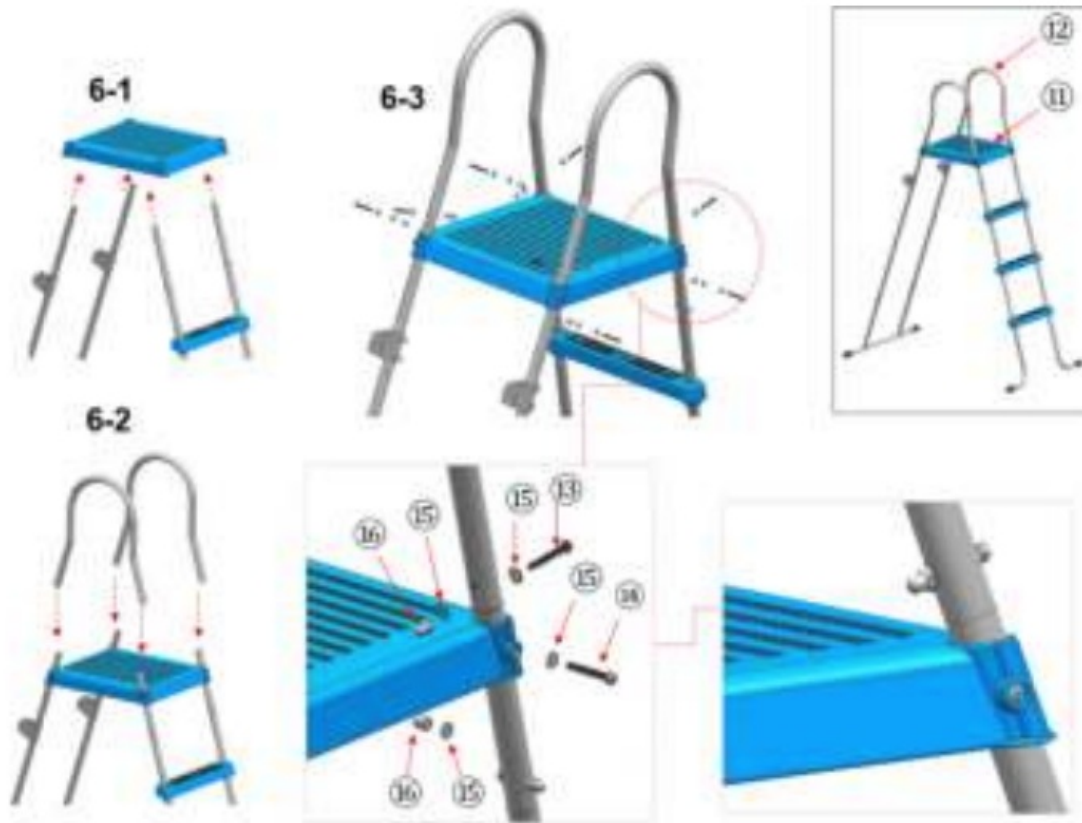

7.

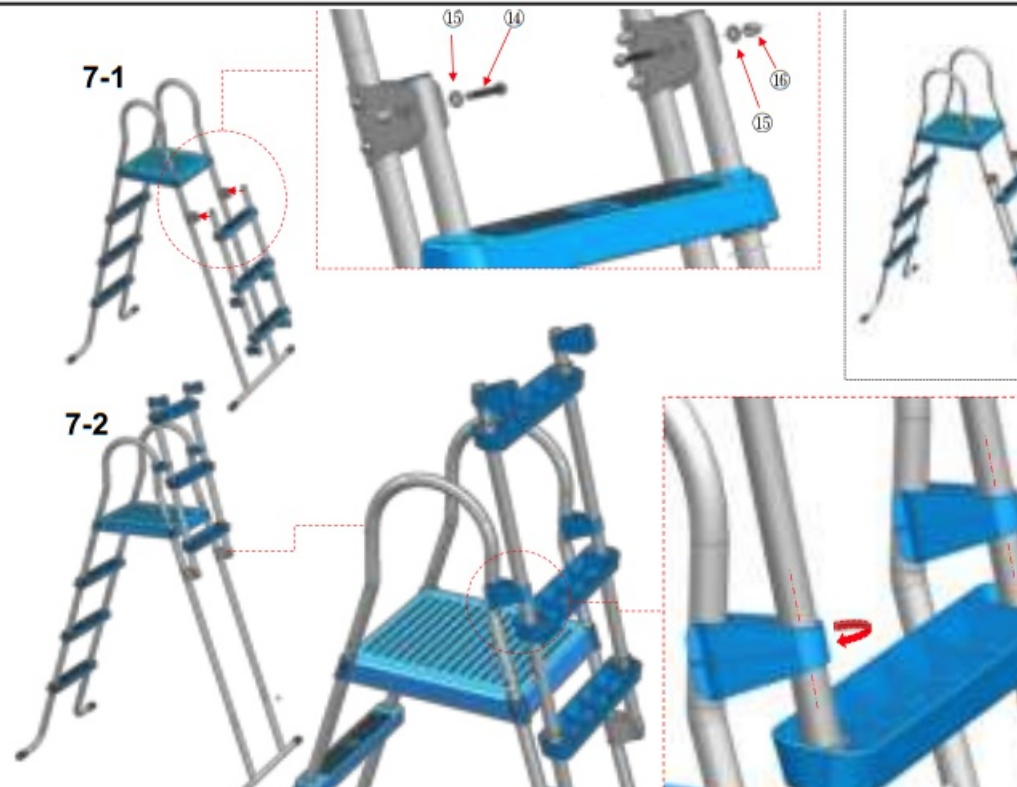

MSP-30112-V02

8

## Introduction

Congratulations on choosing a EXIT Toys Pool Ladder!

**Have fun, be active and play outdoors.....**

That's what keeps driving us to develop innovative, quality toys for cool kids and parents.

We do everything possible to develop safe products for children. As our products are classed as toys, we comply with the toughest consumer safety regulations. Before launching our products onto the market, we have independent tests carried out for certification. We also continuously test our production runs and periodically have



independent tests performed again as a further check. Only products which live up to the highest EXIT Toys standard are marked with and recognized by the EXIT-brand. "We want to thank you for your custom and your confidence in this product. We're sure your kids will have as much fun as we did during development. Being openminded, we really appreciate all comments and ideas which will help us improve our products or develop new ones. You are invited to send your ideas to us at [info@exittoys.com](mailto:info@exittoys.com)"

Please visit [www.exittoys.com](http://www.exittoys.com) and discover more cool new products.

The EXIT Toys team

## Guidelines for safe use



**WARNING:** Failure to follow these warnings may result in broken bones, entrapment, paralysis, drowning or other serious injuries.

1. Supervise children and those with disabilities at all times.
2. Always assist children when they use the ladder to avoid falls and/or serious injury.
3. Never dive or jump from this ladder.
4. Locate the ladder on a level, solid base.
5. One person on this ladder at a time.
6. Maximum load: 300 lbs (136 kg). Complies with EN16582 strength requirements.
7. Face the ladder at all times for entry/exit of pool.
8. Remove and secure ladder when pool is not occupied.
9. Do not swim under, through or behind ladder.
10. Check all nuts and bolts regularly to ensure ladder stays sturdy.
11. If swimming at night use artificial lighting to illuminate all safety signs, ladders, pool floor and walkways.
12. Assembly and disassembly by adults only.
13. This ladder is designed and manufactured for a specific pool wall height and/ or deck of the pool. Do not use with other pools.
14. Failure to follow the maintenance instructions and warnings may result in adverse health effects or injury, particularly to children.
15. Only use this ladder for the purposes described in this manual.

These product warnings, instructions and safety rules provided with the product represent some common risks of water recreation devices and do not cover all instances of risk and danger. Please use common sense and good judgment when enjoying any water activity.

## Care and usage

1. Store ladder in safe and dry place.
2. Never store any materials on ladder.
3. Keep ladder clean and free of all foreign materials.
4. Do periodic maintenance on screws, when the ladder is not in use, put some antirust oil on them.
5. Do not use the ladder in the temperature below -5°C
6. Recommend to remove pool ladder from the swimming pool during the off season(winter months).
7. Disassemble all the components and dry thoroughly.
8. Store in a dry location out of children's reach



## Limited warranty

We warrant all components contained in this Pool ladder against defects in materials and workmanship under normal use and service, for a period of 90 days from the date of purchase for the original owner only.

If any of the components have been consumer-replaced, damaged, or misused, the corresponding warranty on those components is invalidated. In this situation, you will be advised of the cost of replacement parts and processing instructions.

If a verifiable manufacturing defect is found during the relevant time period, we agree to replace at its option any product under warranty provided proper proof of purchase is presented.

This limited warranty is not valid if the product is used for commercial purposes, or if the damage is caused by an accident, consumer misuse, neglect or abuse, vandalism, improper use of chemicals, exposure to extreme weather conditions or negligence during product set up or disassembly.

We cannot be held responsible for the cost of installation, labor, or transportation expenses incurred due to the replacement of defective parts. This limited warranty, furthermore, does not cover any unauthorized alterations to the product.

### Contact:

#### Dutch Toys Group

Edisonstraat 83, 7006RB, Doetinchem , the Netherlands

P.O. Box 369, 7000AJ, Doetinchem, the Netherlands

[info@exittoys.com](mailto:info@exittoys.com)

[www.exittoys.com](http://www.exittoys.com)

**EXIT is a registered trade mark of Dutch Toys Group**

**MSP-30112-V02**

## Documents / Resources

 The image shows the cover of a user manual for an EXIT pool ladder. It features the EXIT logo at the top left, followed by the text 'User manual', 'Gebrauchsanweisung', 'Gebrauchsanleitung', and 'Mode d'emploi'. Below this is 'POOL LADDER' and '48 122 CM'. A small illustration of the ladder is in the center. At the bottom, there is a block of small text in multiple languages.	<p><a href="#">EXIT TOYS 48 Inch 122cm Pool Ladder</a> [pdf] User Manual</p> <p>48 Inch 122cm Pool Ladder, 48 Inch Pool Ladder, 122cm Pool Ladder, Pool Ladder, Ladder</p>
--	--