



EWEADN Q1 Bluetooth Wireless Mouse 2.4G Screen Display User Guide

[Home](#) » [EWEADN](#) » EWEADN Q1 Bluetooth Wireless Mouse 2.4G Screen Display User Guide 

EWEADN Q1 Bluetooth Wireless Mouse 2.4G Screen Display User Guide



Fiest. Basic parameters

Number of keys: 7 key

DPI adjustment: three gear-800-1200 (default) -1600

Return rate: 125Hz

Interface type: Type-C

Battery capacity: 400 mAh

Bluetooth name: Eweadn-Q1

Charging voltage: 3.7V (does not support fast charging)

Connection mode :Bluetooth connection Wireless connection distance: 10 meters (without hindering an open environment)

Support system: Windows, MacOS, Android, iOS

Product weight: 65g (without a receiver)

Product size: 107.8x63x39.2mm

Related parameter handmade measurement, if there is a difference, it is subject to the real thing!

Contents

[1 Second. Button](#)

[Description](#)

[2 Third. Dormant mechanism:](#)

[3 Seven. the list of items](#)

[4 Documents / Resources](#)

[4.1 References](#)

[5 Related Posts](#)

Second. Button Description

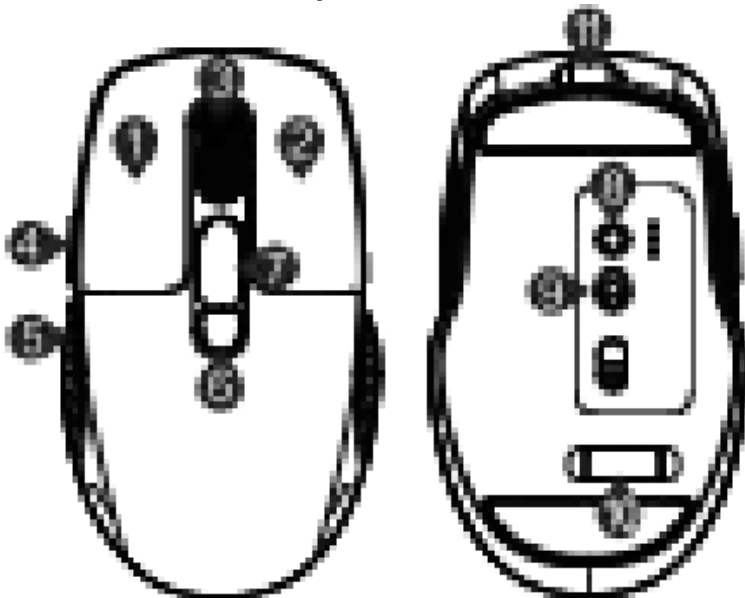

1. Left button
2. Right button
3. Scroll wheel/middle button
4. Forward keys
5. Backbone key
6. DPI switch (three gear)
7. screen display
8. Bluetooth switching key (Short -press
9. switch Bluetooth long press the right code) Switch (/medium off/lower Bluetooth)
10. receiver storage place
11. Type-C connection interface (do not use fast charging, charging service Please use the supporting charging cable to connect the computer for charging!

Third. Dormant mechanism:

Enter the first -level dormant in one minute, enter the second -level dormant after ten minutes, the indicator light is turned off, You can press the key to wake up.

Remarks: During mild sleep, allow movement or keys to wake up the mouse. Deep dormant default Allow keys to wake up.

Four. indicator light:

Model light: Bluetooth 1/Bluetooth 2 is a flash blue light.

Five. Screen description

Electricity: 100% display three grids, two cells below 50%, 25%, 25%

The following.

DPI: Show DPI value.

Six. Connection method

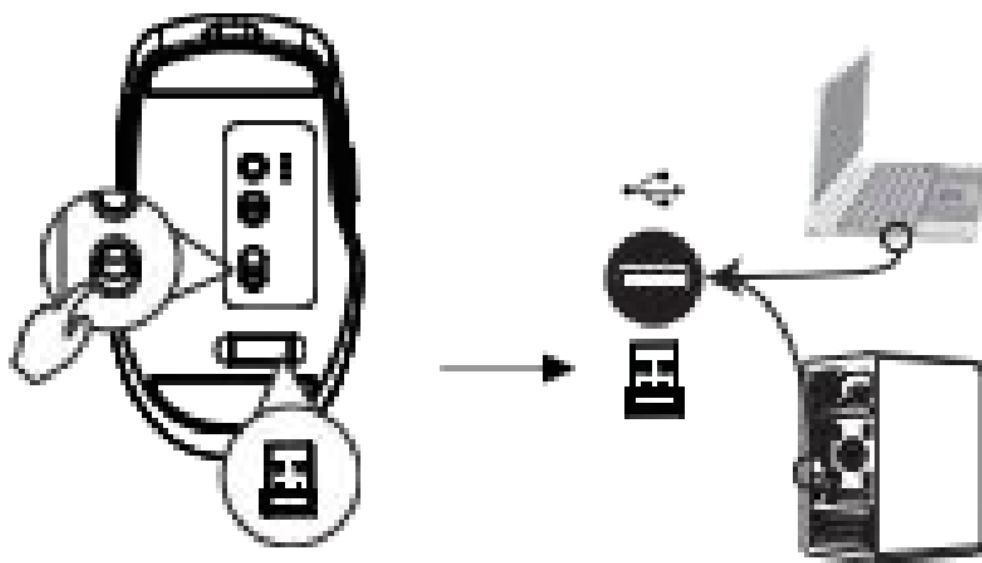

Bluetooth connection

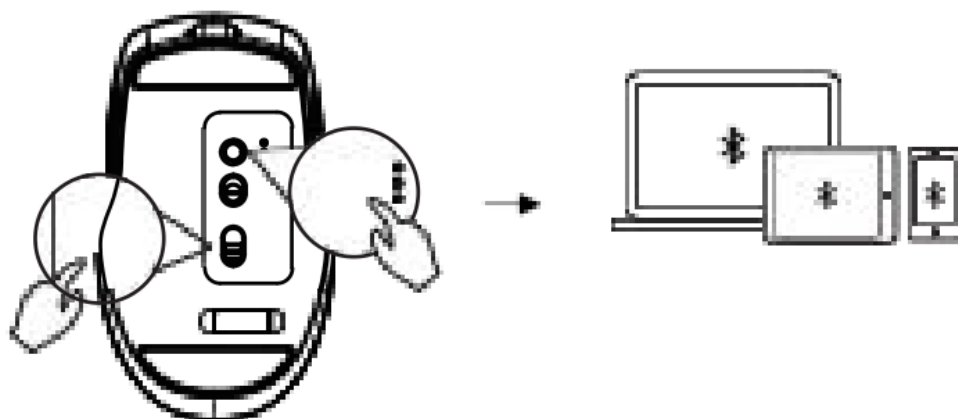

Short press switch BT1/BT2

BT1/BT2

Long press the right code

Mouse Bluetooth Name: "EWEADN-Q1"

Pluck the power switch below and switch to the Bluetooth mode (the indicator is BT1 \ BT2 blue)
Open the Bluetooth that needs to be connected. It can be used after successful.

Seven. the list of items



1. One mouse
2. Type-C charging cable one
3. One manual

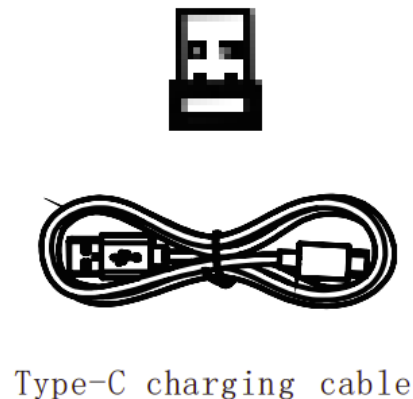

Authorized dealer: Yuandao Industrial (Shenzhen) Co., Ltd. Room 1610, 1610, Fuyong, Fuyong, Guangshen Road, Baoan District, Shenzhen Manufacturer: Jiangxi Jichi Technology Co., Ltd. Building 3, Gorfred Industrial Park, Qingyuan District, Ji'an City, Jiangxi Province

Contact number: 0755-23089616

Website: www.eweadn.cn

Product execution standard number: mouse GB/T 26245-2010

Note: Product pictures are for reference only, and may be different from the real objects. Please refer to the actual objects, please forgive me!

FCC Caution:

This device complies with part 15 of the FCC Rules. Operation is subject to the following two conditions: (1) This device may not cause harmful interference, and (2) this device must accept any interference received, including interference that may cause undesired operation. Any changes or modifications not expressly approved by the party responsible for compliance could void the user's authority to operate the equipment.

NOTE: This equipment has been tested and found to comply with the limits for a Class B digital device, pursuant to Part 15 of the FCC Rules. These limits are designed to provide reasonable protection against harmful interference in a residential installation. This equipment generates, uses and can radiate radio frequency energy and, if not installed and used in accordance with the instructions, may cause harmful interference to radio communications. However, there is no guarantee that interference will not occur in a particular installation. If this

equipment does cause harmful interference to radio or television reception, which can be determined by turning the equipment off and on, the user is encouraged to try to correct the interference by one or more of the following measures:

- Reorient or relocate the receiving antenna.
- Increase the separation between the equipment and receiver.
- Connect the equipment into an outlet on a circuit different from that to which the receiver is connected.
- Consult the dealer or an experienced radio/TV technician for help. The device has been evaluated to meet general RF exposure requirement. The device can be used in portable exposure condition without restriction.

Documents / Resources

	EWEADN Q1 Bluetooth Wireless Mouse 2.4G Screen Display [pdf] User Guide 2BFQI-Q1, 2BFQIQ1, Q1 Bluetooth Wireless Mouse 2.4G Screen Display, Q1, Bluetooth Wireless Mouse 2.4G Screen Display, Wireless Mouse 2.4G Screen Display, Mouse 2.4G Screen Display, Screen Display, Display
---	---

References

- [🌐 EWEADN/](#)
- [User Manual](#)

[Manuals+](#), [Privacy Policy](#)

This website is an independent publication and is neither affiliated with nor endorsed by any of the trademark owners. The "Bluetooth®" word mark and logos are registered trademarks owned by Bluetooth SIG, Inc. The "Wi-Fi®" word mark and logos are registered trademarks owned by the Wi-Fi Alliance. Any use of these marks on this website does not imply any affiliation with or endorsement.