



[Home](#) » [Evooor](#) » **Evooor Tesla C 8.9 Inch Head-Up Display with Wireless CarPlay and Android Auto User Manual** 

Contents [[hide](#)]

- [1 Evooor Tesla C 8.9 Inch Head-Up Display with Wireless CarPlay and Android Auto](#)
- [2 Product Information](#)
- [3 What's Included](#)
- [4 Front Installation](#)
- [5 Product configuration](#)
- [6 Display in P mode](#)
- [7 Frequently Asked Questions](#)
- [8 Documents / Resources](#)
 - [8.1 References](#)

Evooor

Evooor Tesla C 8.9 Inch Head-Up Display with Wireless CarPlay and Android Auto



Product Information

Specifications

- Display Resolution: 1920*720
- Touchscreen: 2.5D Full Lamination Anti-Fingerprint Technology
- Interface Support: Type-C port, data transfer, software upgrades
- RAM: 1G
- ROM: 512M
- Input Voltage: DC12V
- Operating Current: 350mA
- Display Mode: P mode

What's Included

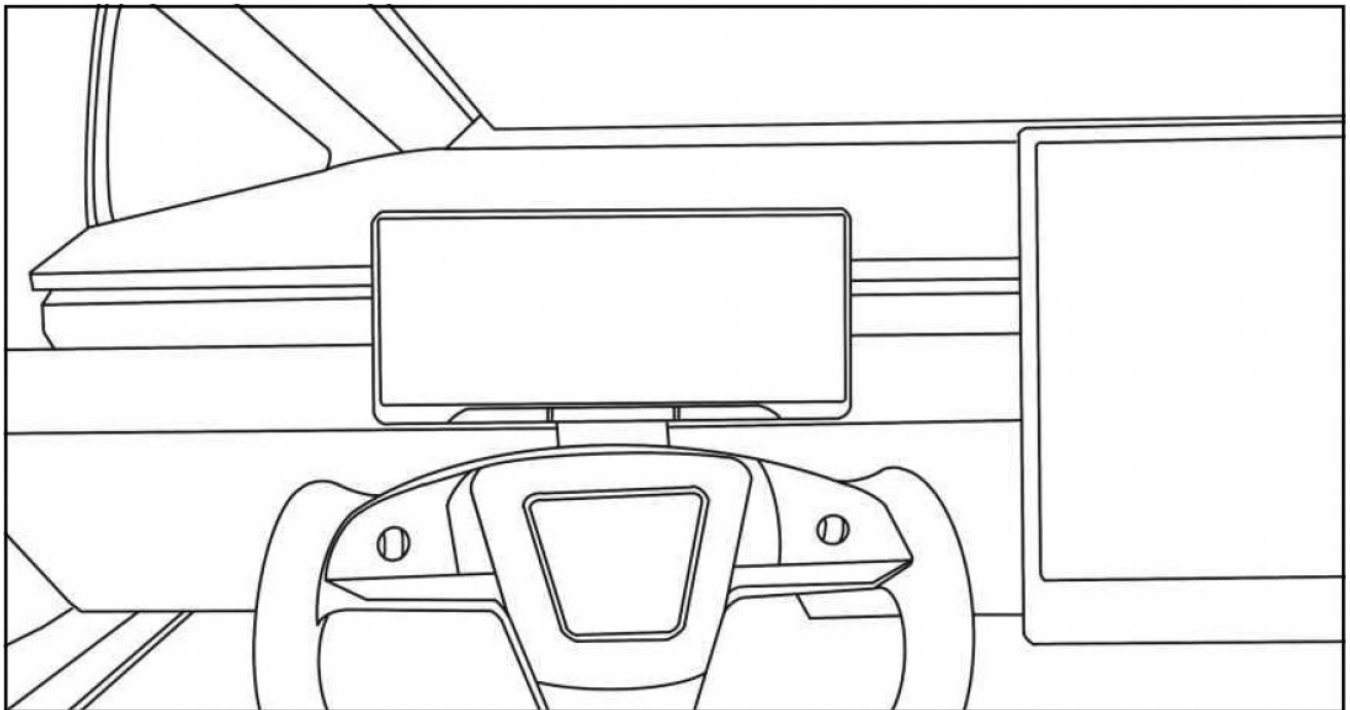
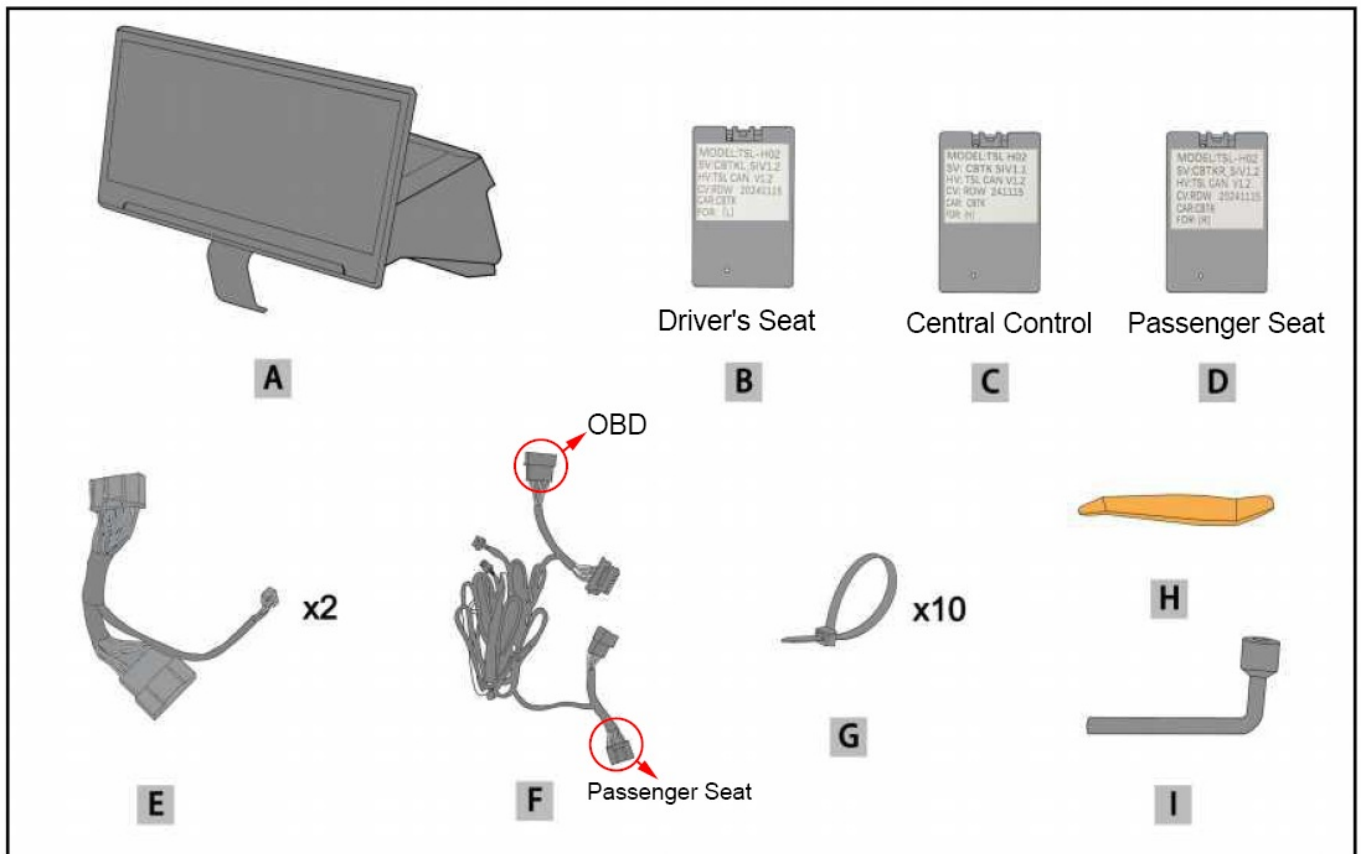

Front Installation

During installation, remove both the left and right seat door panels from the original vehicle at the same time to make installation easier. If you accidentally disconnect the wrong plug, simply reconnect it-no need to worry.

1. Locate the small plastic pieces on the left and right sides of the dashboard as shown

in the image.

2. Use a prying tool to remove the plastic panel.

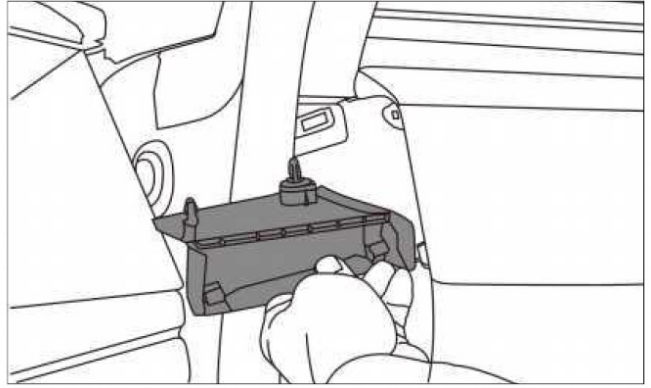
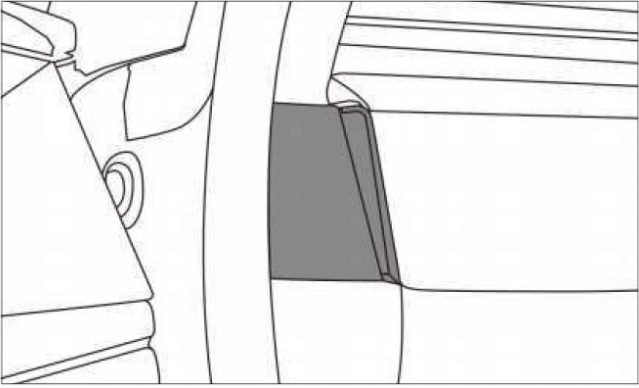

3. Lift the dashboard panels on both sides.
4. Pull back the plastic panels below the driver and passenger seats, especially pulling the passenger side as much as possible.

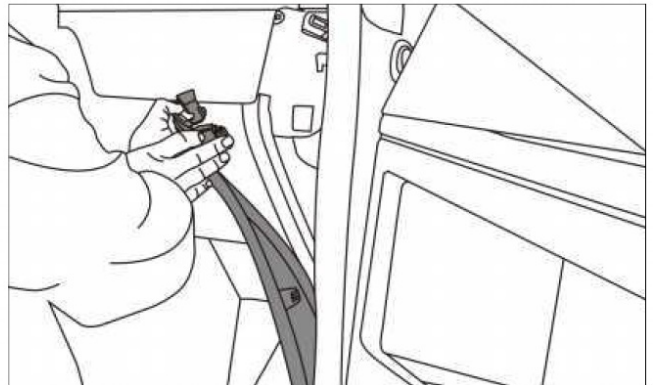
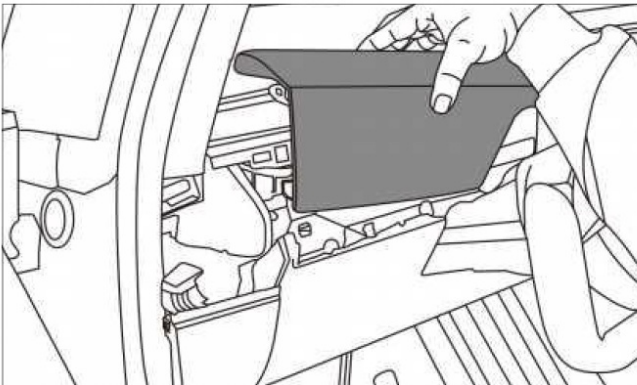

5. Lift the floor mat at the base of the passenger side.
6. Unplug the blue connector on the inner side.

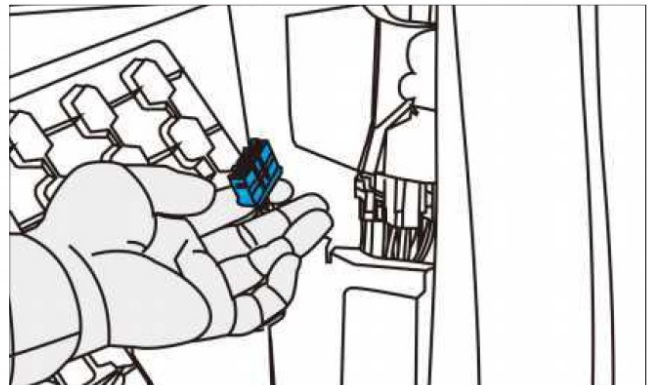
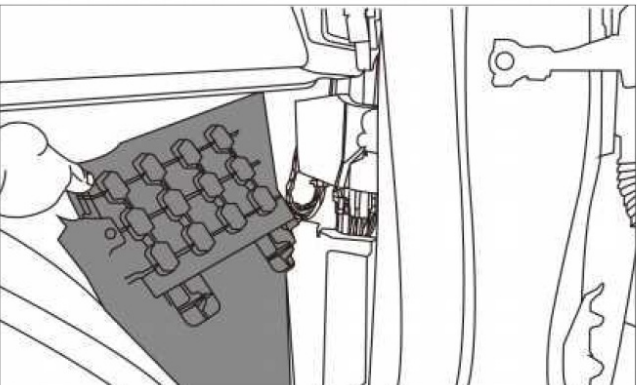

7. Place Harness A on the dashboard, routing the end with the adapter down to the passenger floor mat area.
8. Connect it to the original blue connector in the vehicle.

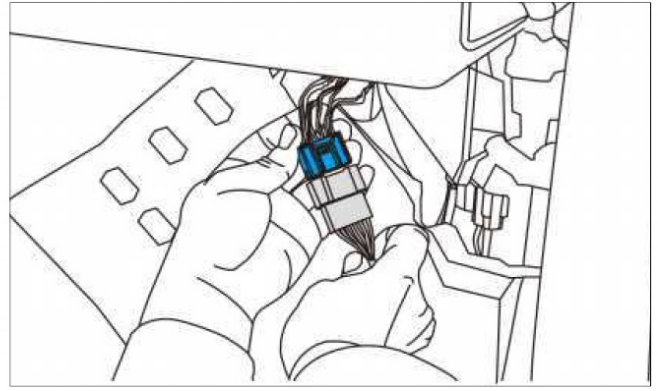
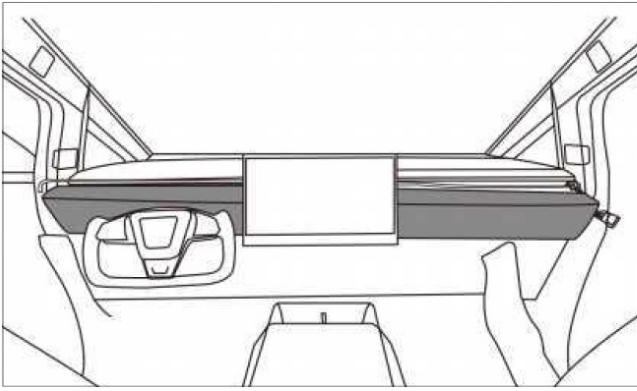

9. Connect the other end back to the original blue plug location.
10. Organize the harness, then replace the floor mat.

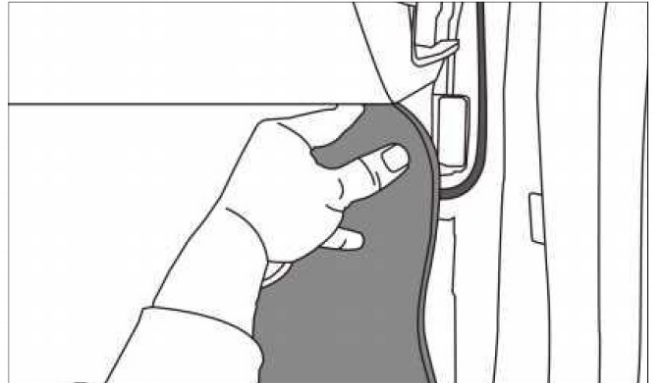
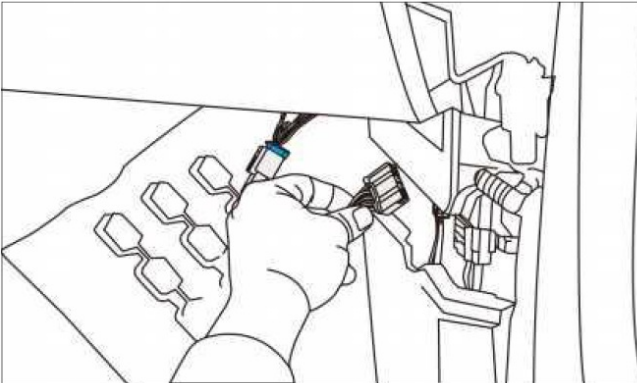

11. Reinstall the threshold plastic panels as shown in the image.
12. Arrange the harness on the dashboard, placing it beneath the dashboard panel.

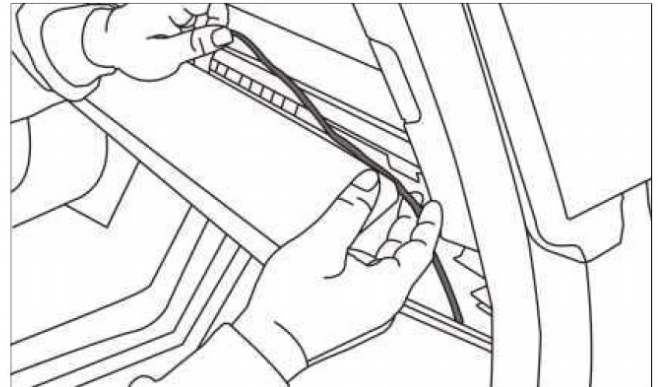
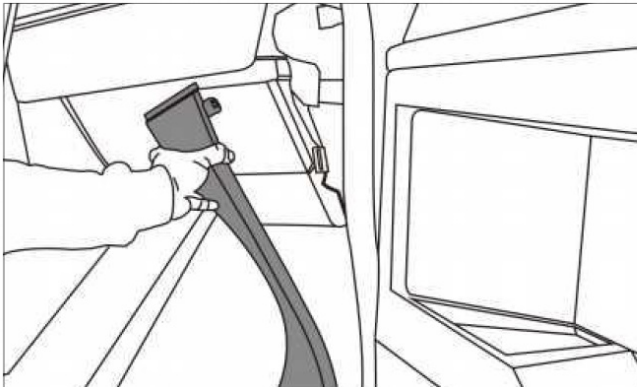

13. Ensure the harness below the dashboard does not obstruct the panel clips.
14. Connect the small connector on Harness A to the instrument display screen.

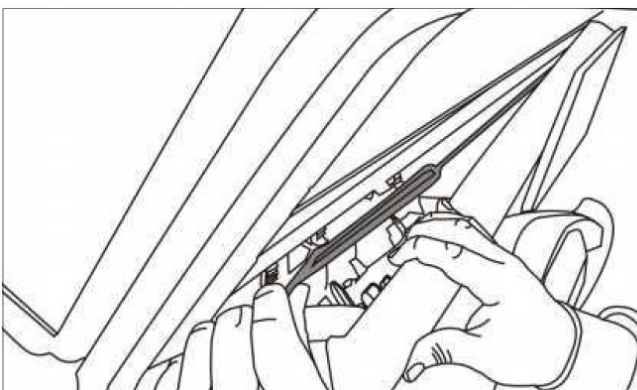

15. After connecting the harness, organize it below the dashboard, place the display screen on the dashboard, and reinstall the dashboard clips.

16. Once the dash board panel is reinstalled, insert the display screen into the dashboard vent, manually lifting the upper dashboard panel if needed.

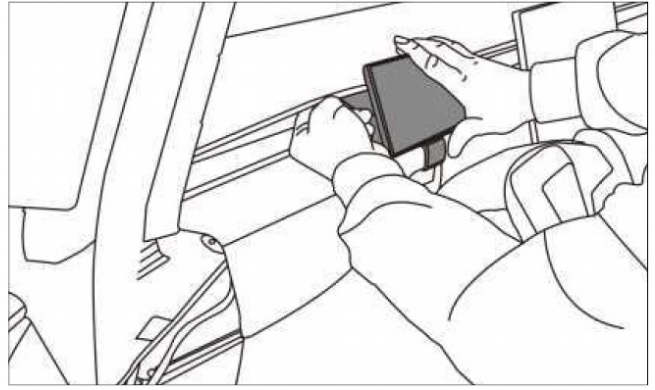
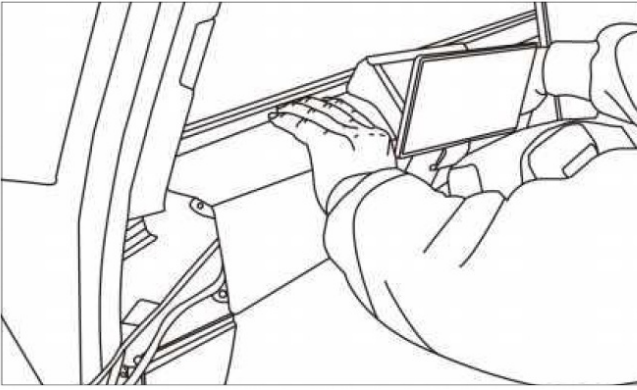

17. Connect the other plug on the harness to the control box (model SV HIV1 .0).

18. Once the control box is connected, hide it below the dashboard panel.

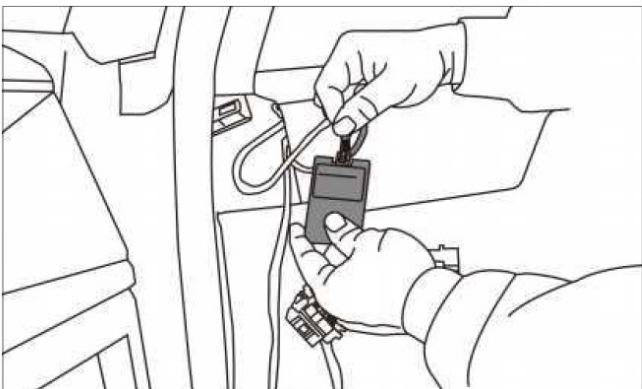

19. Route the OBD plug on Harness A through the threshold area down to the driver's side, connecting it to the OBD port.

20. After plugging in the OBD port, hide the remaining section under the floor mat.

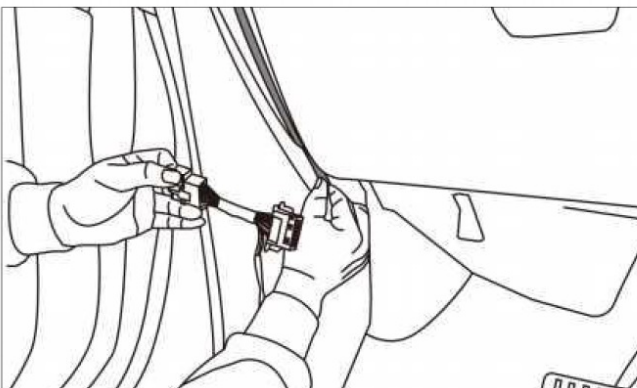

21. Reinstall the plastic threshold panel.

22. Reattach the small plastic panels on both sides and cover them with the door edge weather stripping.

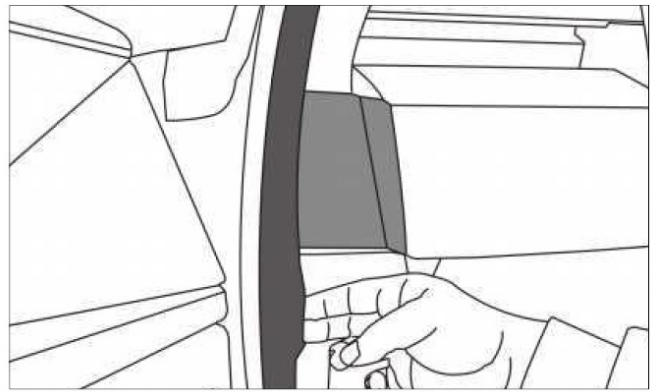
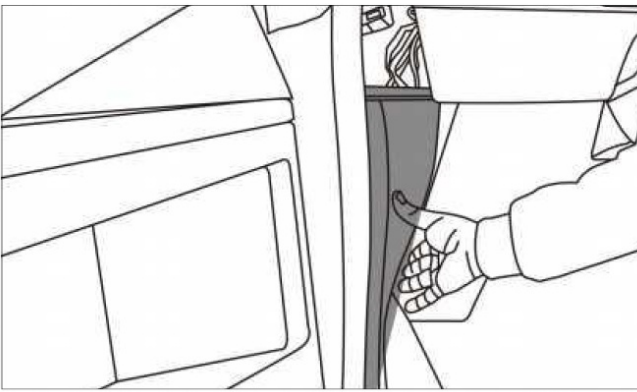

23. Remove the door interior panel, prying off the top trim panel with a prying tool and disconnecting any attached harnesses.

24. Disconnect the wiring harnesses for the lights on both sides.

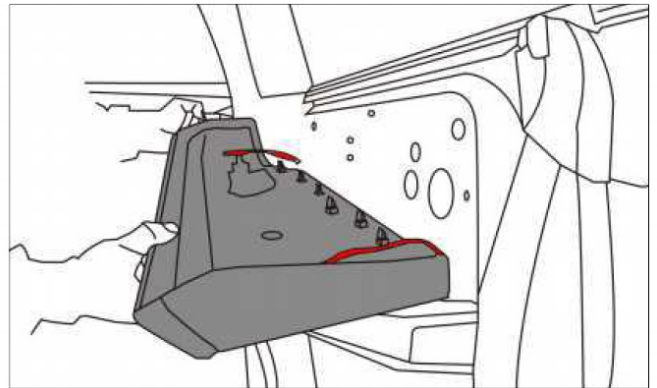
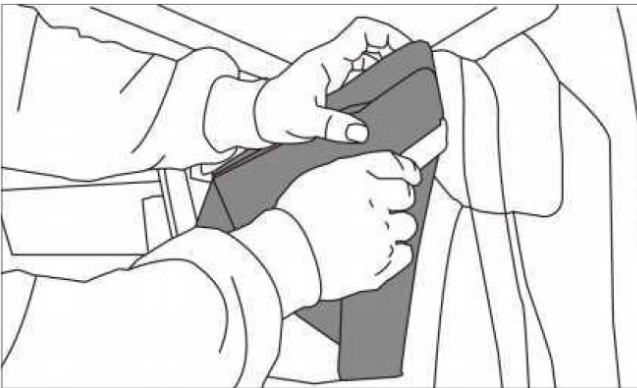

25. Remove the wiring harness connectors on both door panels .

26. Reattach the upper door panel of the original vehicle.

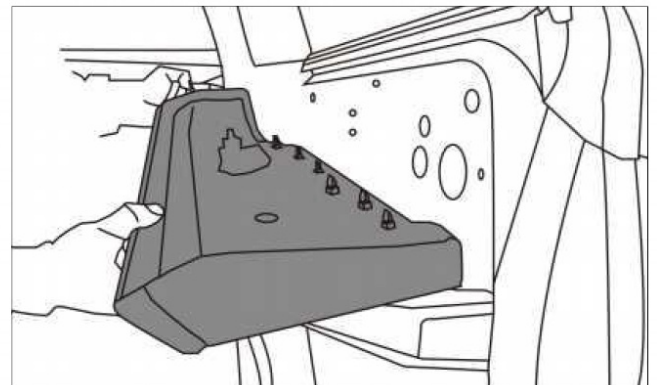
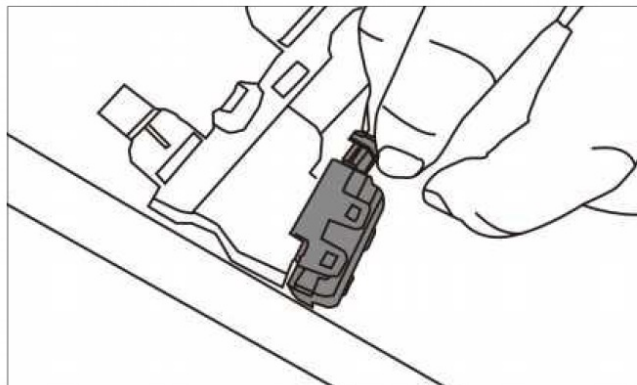

27. Use a socket tool to un s crew the three bolts on the door panel.

28. Remove the lower door, placing a small stool un der neath for support so the entire door panel does not need to be detached.

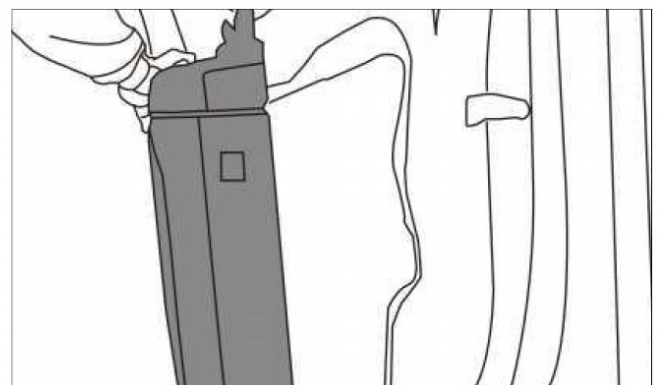
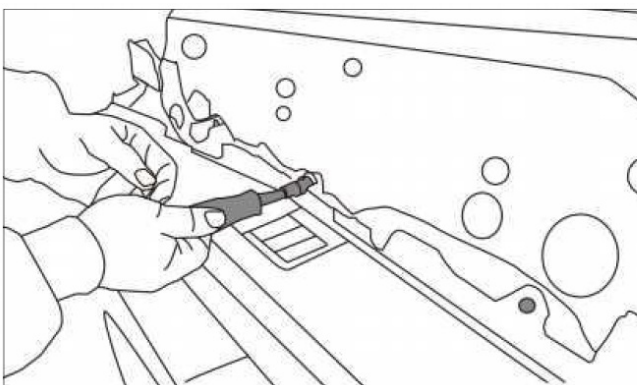

29. Connect Harness B to the control box, then connect the control box labeled (SV SIV1 .0) to the passenger door for adapter installation.
30. Disconnect the original blue plug, located in the middle of the lower door trim.

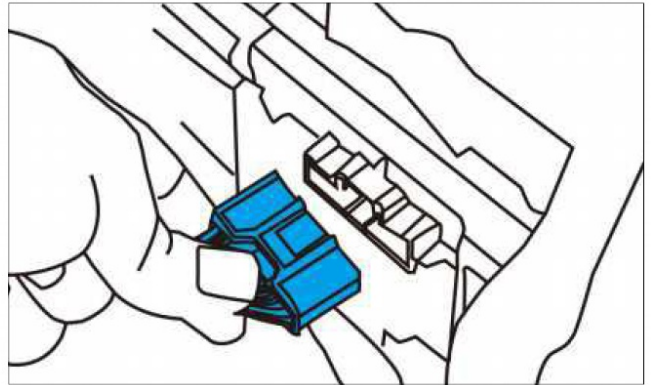
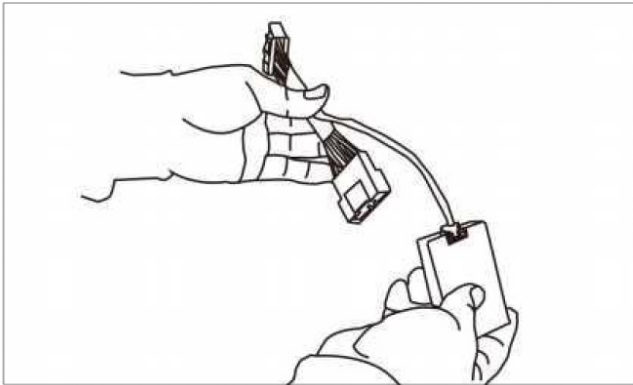

31. Complete the adapter connection for Harness B, inserting the other end of Harness B into the original blue plug position.
32. Organize the harness and reinstall the original interior trim panel. Mirror these steps on the driver's side to complete the installation.



User manual for

Dashboard Screen

We are very pleased that you have chosen our company's instrument display product. This product is based on the Linux system, with stable software decoding of the original vehicle protocol and a simple yet elegant UI design. It offers a truly unobstructed Tesla instrument display. The functional display allows you to fully understand the status of your vehicle (speed display, gear position display, door status display, built-in high-quality speakers, etc.). Our product enhances your in-car experience by providing a comprehensive visual experience through the instrument display.

Product configuration

- Display resolution: 1920*720

- Touchscreen :2.SD Full Lamination Anti-Fingerprint Technology
- Interface Support: Type-C port, data transfer, software upgrades
- RAM:1G
- ROM:512M
- Input Voltage: DC 12V
- Operating Current: 350mA

Display in P mode

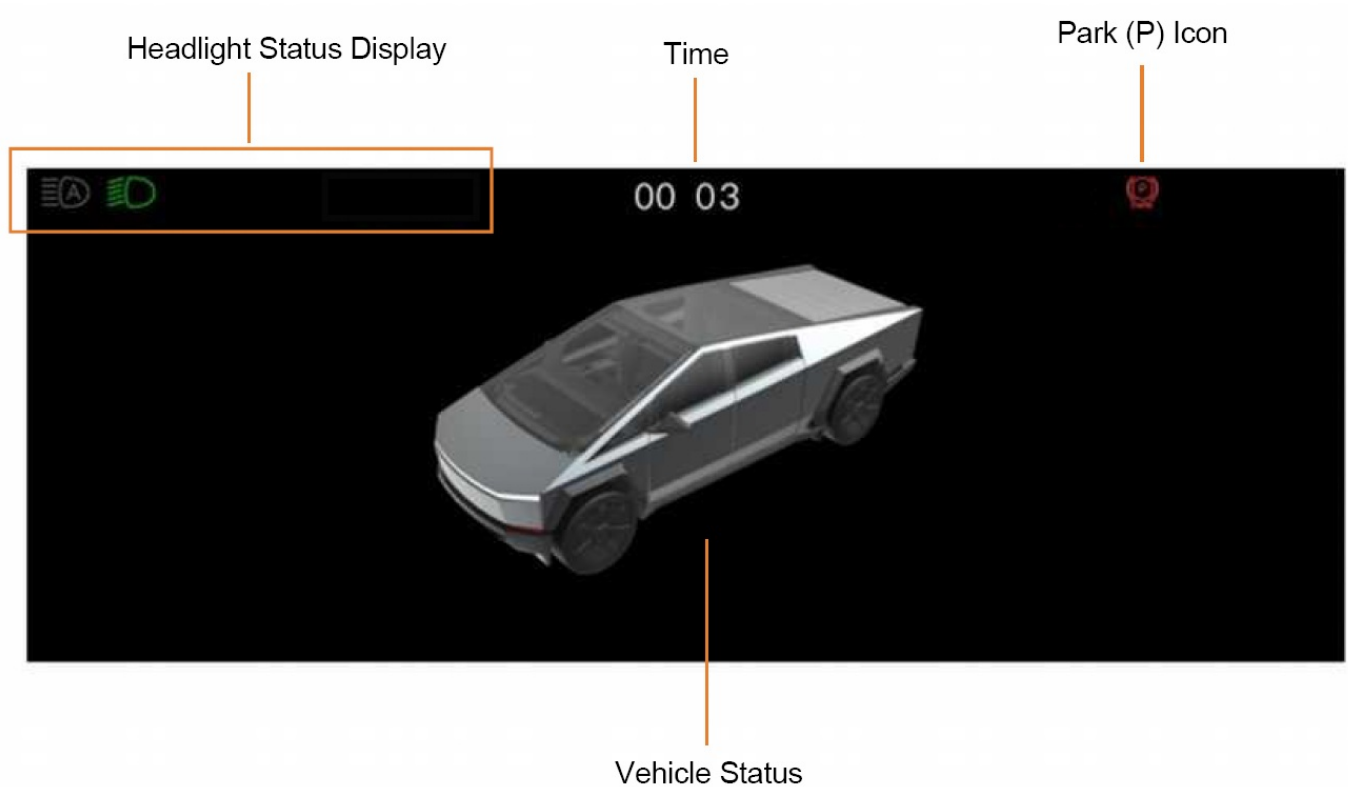

1. When shifting to Park (P) after parking, the above interface is displayed automatically.
2. If the car door is not properly closed or the gear is still in Park (P), for safety reasons, the display will remain on the Park (P) interface.

When in Park (P) mode, swipe down on the top of the screen with your finger.

Auto-connect CarPlay settings. When the icon is grey, it indicates manual connection.

Volume Adjustment

Enter the Settings menu

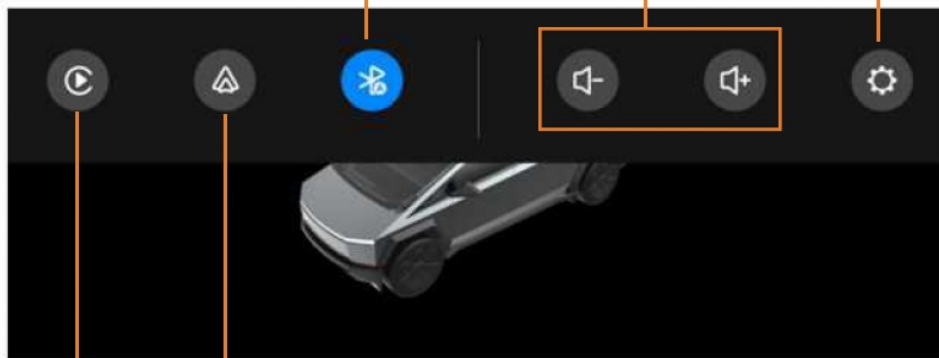

Enter Android Auto Connection

Enter CarPlay Connection.

Enter Drive (D) mode

Speedometer Display

Time

Odometer Display



Gear Position Display

Select in the Settings menu (UI)

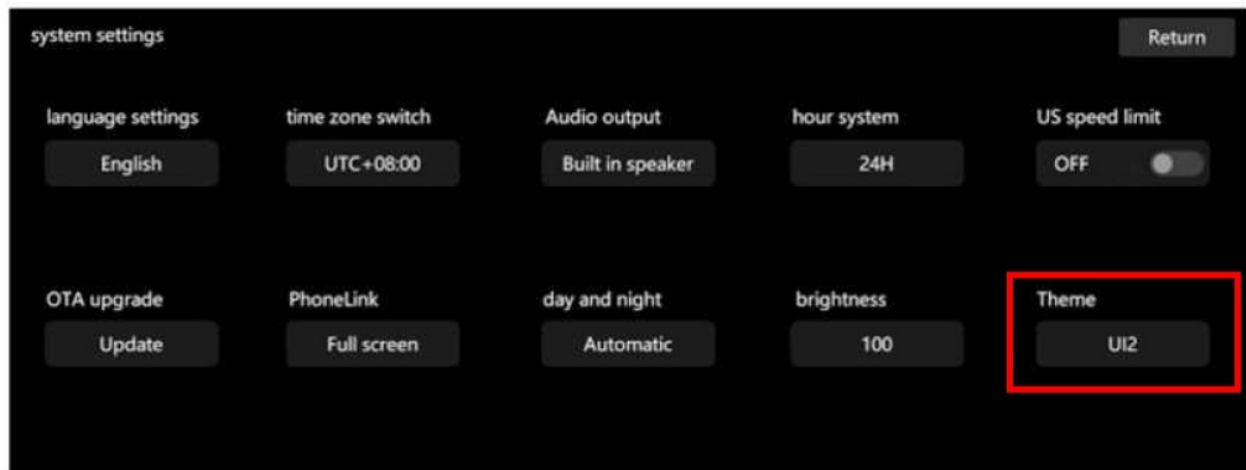

Includes three UI selection interfaces. Press and hold the right-side scroll wheel to the left to enter the settings menu. After making the desired adjustments, tap "Back" to return.

UI Interface——Day Mode



UI Interface——Night Mode

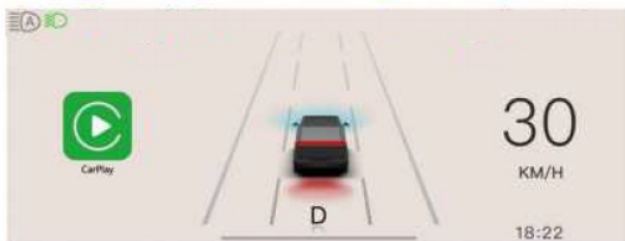

CarPlay Connection Interface

1. In your phone's settings, turn on Bluetooth and find the corresponding Bluetooth name of the device, for example: CarKi t-9DE1.

2. On your phone, tap the device's Bluetooth name to begin pairing.
3. When connecting, a prompt will appear on your phone. Select "Use CarPlay" to connect to the car's infotainment system.



CarPlay Connection

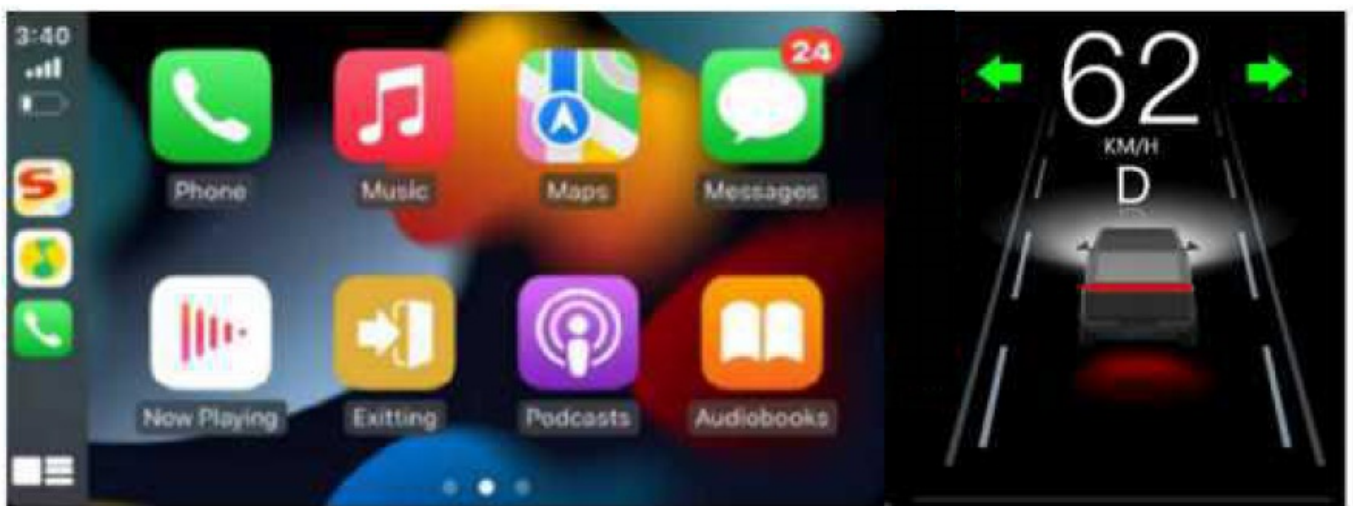

Android Auto Connection



The connection method for Android Auto is similar to that of CarPlay.

Instrument Cluster Settings

Press the right-side scroll wheel to the right or press and hold it to the left to enter the settings menu.

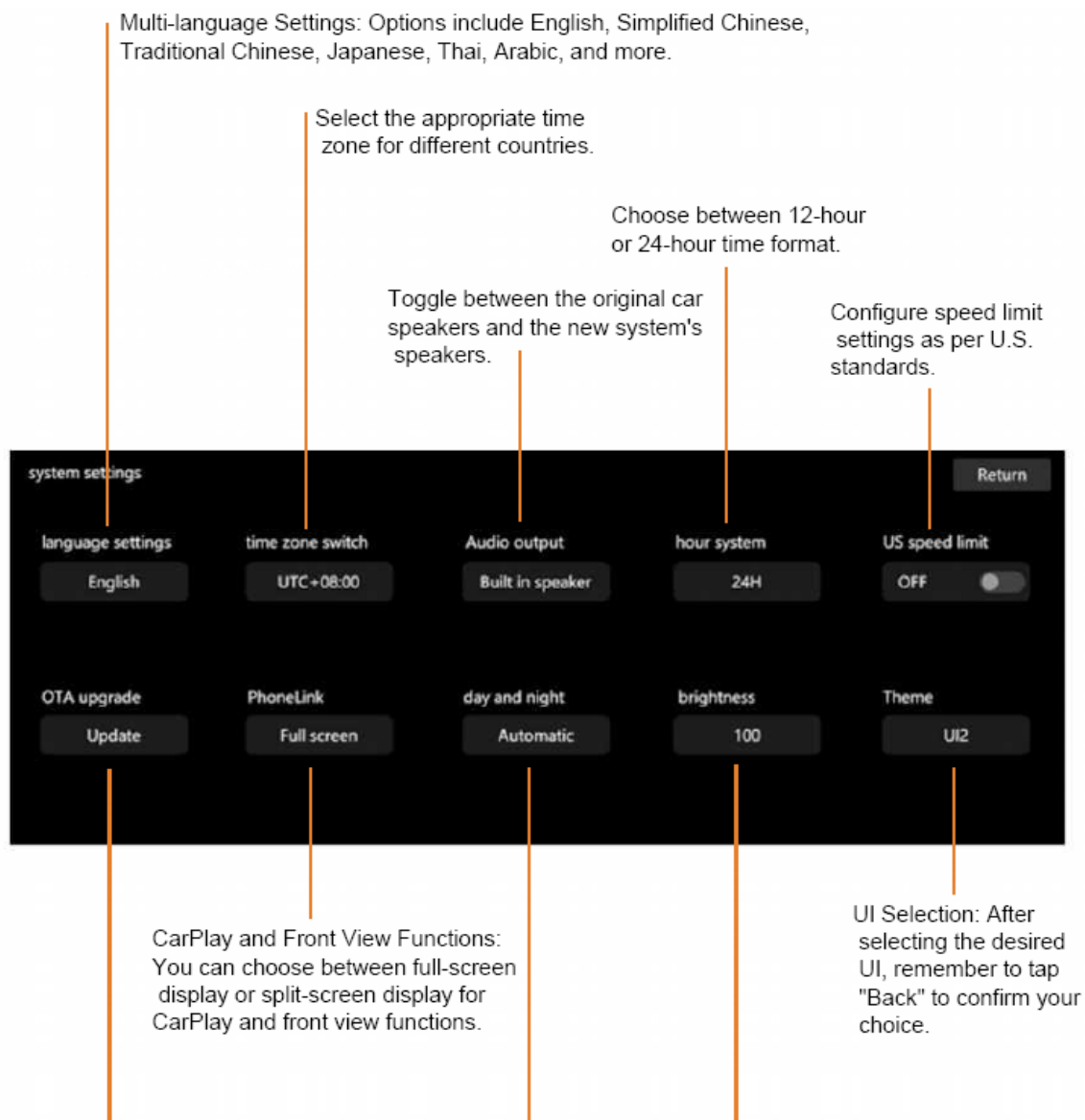

Choose between Day, Night, or Auto modes.

After each upgrade, adjust the brightness back to 100 in the brightness settings.

Software updates can be done through Wi-Fi. To check the version, press and hold the right-side scroll wheel, and version information will appear.

OTA Upgrade: App-OTA upgrade and Protocol-OTA upgrade

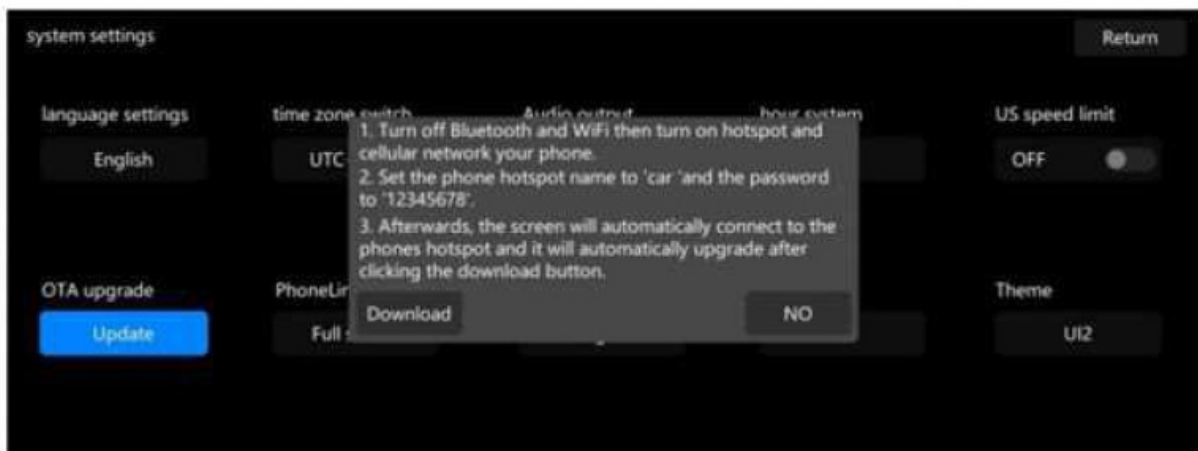
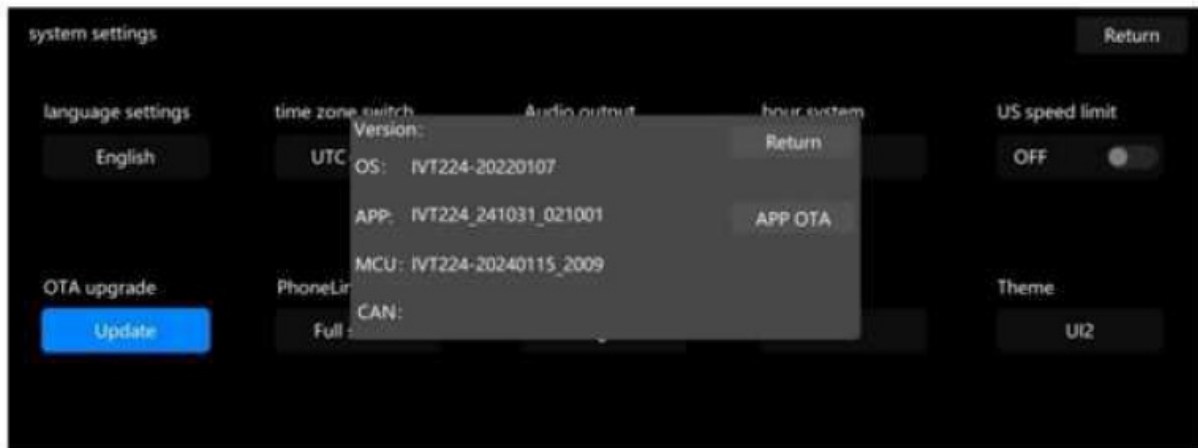



Turn on your phone's Wi-Fi hotspot, set the Wi-Fi name to "car" and the password to "12345678." When you see the download section on the left change from grey to a darker color, click on "Download."

Once the screen switches to the Park (P) mode interface, do not perform any other actions. After 2 seconds, the upgrade interface will appear.

Protocol Box Upgrade Method

1. Download and install the app, then grant necessary permissions.
2. Copy the upgrade file to the root directory of your phone.

3. Open the app, tap “Connect,” and find XLBLE.Note the names:
- Main box: XLBLE_LCD
 - Left box: XLBLE_LEFT
 - Right box: XLBLE_RIGHT
 - Select the corresponding file and then tap “Upgrade.”
4. During the upgrade, do not leave the upgrade page.Ensure you’re upgrading the correct box by checking the name.
- Press and hold the left scroll wheel to force a restart.
 - Tum the left scroll wheel up or down to adjust the volume.
 - Press and hold the right scroll wheel to enter the settings menu.
- 
- When  press and hold the right scroll wheel to the right, and the software version will pop up.

Frequently Asked Questions

- **Q: What should I do if I accidentally disconnect the wrong plug during installation?**
A: Simply reconnect it, there is no need to worry. Ensure to follow the correct connection steps as outlined in the manual.
- **Q: How can I check if the display is functioning correctly?**
A: The display should show specific interface details based on the vehicle status. Refer to the manual for specific display indications.

Documents / Resources

	Evooor Tesla C 8.9 Inch Head-Up Display with Wireless CarPlay and Android Auto [pdf] User Manual Tesla C, Tesla C 8.9 Inch Head-Up Display with Wireless CarPlay and Android Auto, 8.9 Inch Head-Up Display with Wireless CarPlay and Android Auto, Head-Up Display with Wireless CarPlay and Android Auto, Display with Wireless CarPlay and Android Auto, Wireless CarPlay and Android Auto, CarPlay and Android Auto
---	--

References

- [User Manual](#)

📁 Evooor

🔍 8.9 Inch Head-Up Display with Wireless CarPlay and Android Auto, CarPlay and Android Auto, Display with Wireless CarPlay and Android Auto, Evooor, Head-Up Display with Wireless CarPlay and Android Auto, Tesla C, Tesla C 8.9 Inch Head-Up Display with Wireless CarPlay and Android Auto, Wireless Carplay and Android Auto

Leave a comment

Your email address will not be published. Required fields are marked *

Comment *

Name

Email

Website

☐ Save my name, email, and website in this browser for the next time I comment.

Post Comment

Search:

e.g. whirlpool wrf535swhz

Search

This website is an independent publication and is neither affiliated with nor endorsed by any of the trademark owners. The "Bluetooth®" word mark and logos are registered trademarks owned by Bluetooth SIG, Inc. The "Wi-Fi®" word mark and logos are registered trademarks owned by the Wi-Fi Alliance. Any use of these marks on this website does not imply any affiliation with or endorsement.