



## evonic fires E-Smart Cloud Pairing Apps Instructions

[Home](#) » [evonic fires](#) » evonic fires E-Smart Cloud Pairing Apps Instructions 

### Contents

- 1 [evonic fires E-Smart Cloud Pairing Apps](#)
- 2 [E-Tab Controller:](#)
- 3 [Connecting a device to an Evonic product:](#)
- 4 [Selecting your fire:](#)
- 5 [App Control Overview:](#)
- 6 [Setting timer:](#)
- 7 [Signing in and out of your account](#)
- 8 [Pairing with Alexa:](#)
- 9 [Alexa Commands:](#)
- 10 [Problem Solving:](#)
- 11 [Documents / Resources](#)
  - 11.1 [References](#)
- 12 [Related Posts](#)

evonicfires

## evonic fires E-Smart Cloud Pairing Apps



### E-Tab Controller:

PLEASE NOTE: Once fully charged, the battery life of the E-tab control system is roughly 24 hours.



1. Volume control
2. Power Button—Press and hold for 3 seconds to turn ON/OFF
3. USB charging point
4. Plug socket
5. USB connection lead



The e-smart cloud app can be used with both smart phone and tablet devices. Utilising the e-smart cloud app will allow complete controllability of your Evonic product. To download the Evonic e-smart cloud app please follow the below steps.

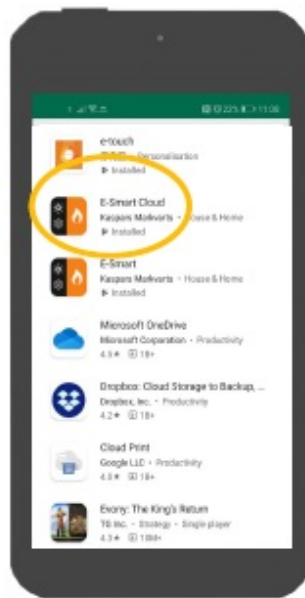

1. Access either the Apple app store or Google play, this is depending on the operating system of your smart phone or tablet.
2. Search, locate, and download the app entitled evonic 'E-smart Cloud'.

### Connecting a device to an Evonic product:

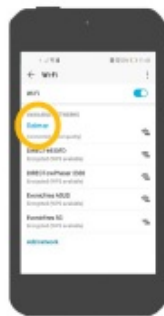

Fig 1.



Fig 2.



Fig 3.

- Once your appliance has been installed and turned on, go to the wi-fi settings on your device and select the fire. This will connect your device to the fire. Fig 1.
- Open your e-smart cloud app, and in the settings panel ( Fig 2.) establish your connection by selecting your home wi-fi. This will pair the fire with your router. Fig 3.
- Your evonic product will now be paired and ready to operate.
- Under the settings panel located in the app, you can now change the name of your fire. Ensure you enter your e-mail address, as this is to identify between the fireplace and you. You can also change units of temperature. Fig 4.

Fig 4.



## Selecting your fire:



1. Once your product is paired, open the app. The above screen will appear with your fire shown. Single press Kalmar. Please note: It may take a few minutes for your fire to appear on the screen.
2. Single press the flame icon to turn on the lights.
3. Single press the heater button to turn on the heater

## App Control Overview:

### App Control Overview:



- Target Temperature—This displays the desired room temperature.
- Temperature Control— Temperature adjustor. Press, hold and rotate to adjust.
- Animation setting— Displays selected animation. Single press arrow to reveal drop-down menu. D). Side Lights— Single press to turn on side lights.
- Main Lighting—Single press to adjust fuel, flame & overbed lighting.
- Flame— Slide left or right to adjust brightness of flame.
- Fuel— Slide left or right to adjust brightness of fuel bed.
- Speed— Single press to adjust the speed of selected animation.

## Setting timer:



### 1. Setting timer:

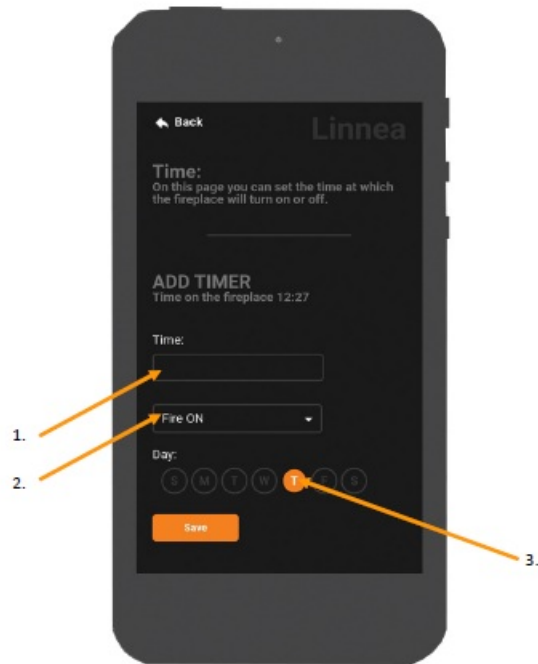

2. Single press the Time box to open up your clock settings.
3. Then select a command for your fire to complete at the selected time. Single press the 'Fire ON' box to display a drop down menu.
4. Then select the desired day of the week you would like the command to be set for. Single press the desired day.

PLEASE NOTE: Please de-select all days before you press save on your timer.

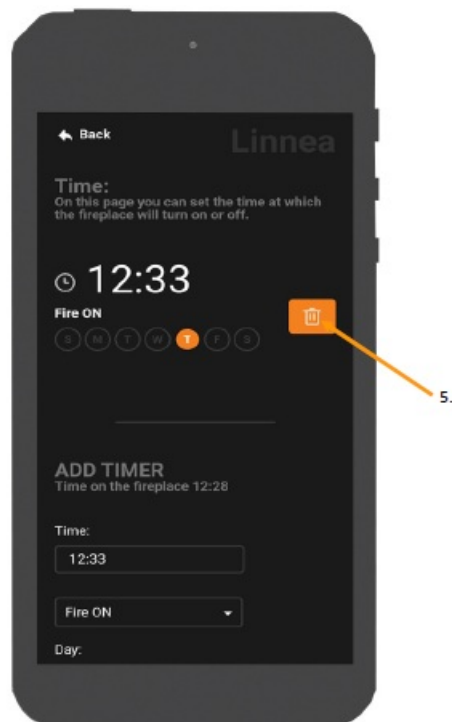

5. The following screen will then appear with your set timer. You can choose to delete it using the 'Bin' icon.

## Signing in and out of your account



To sign into your e-smart cloud account (fig 1), simply enter the details used during the initial setup process. To sign out of your account or switch accounts, click the 'log out' icon in the top right hand corner.

## Pairing with Alexa:



1. Once you fire is installed and fully functioning, download the Amazon Alexa app.
2. Configure your echo with the Amazon app by adding device.
3. On the home screen, you will see a menu icon in the top left hand side. Single press to open the menu and select 'skills and games'
4. Once open, in the top right corner search 'evonic' and the below skill option will appear. Fig 1.
5. Single press to select skill, which will then open up the below page. Fig 2.
6. Once you press 'ENABLE TO USE', you will be directed to the evonet page.
7. Please enter the account details you registered earlier in the e-smart app setup and wait for the page to indicate you have been successfully linked.
8. Then turn your fire off & on again at the rocker switch.
9. To complete pairing ask Alexa to 'discover devices'.

**Fig 1**

1 Result

Sort: Relevance ▾



Evonicfires Halo

**'Alexa, turn on fireplace'**

Smart Home

★★★★★ 0

**Fig 2**

**Evonicfires Halo**

CK Fires

Rated: Guidance Suggested

★★★★★ 0

ENABLE TO USE



## Alexa Commands:

Please note: For the purposes of instruction we are referring to your appliance as 'fire'. You will need to refer to whatever name has been designated on your e-smart app. This may be the model of the fire, or you may have changed name of your fire.

1. Turning appliance ON or OFF – 'Alexa, turn fire on'  
'Alexa, turn fire off'
2. Turning heater ON or OFF – 'Alexa, set fire heater to auto'  
'Alexa, set fire heater to off'
3. Changing temperature – 'Alexa, set temperature to 25 degrees' (Please note: Alexa will only change
  - temperature between 10° & 32°)
  - 'Alexa, make it cooler in there' (decrease 3°) 'Alexa, make it warmer in there' – (increase 3°)
4. Animation selection – 'Alexa, set animation to still'
  - 'Alexa, set animation to breathe' '
  - 'Alexa, set animation to spectrum'
  - 'Alexa, set animation to embers'
  - 'Alexa, set animation to odyssey'
  - 'Alexa, set animation to aurora'

## Problem Solving:

1. e-smart app will not connect to product and is continuously showing the below screen: Please follow the below steps.

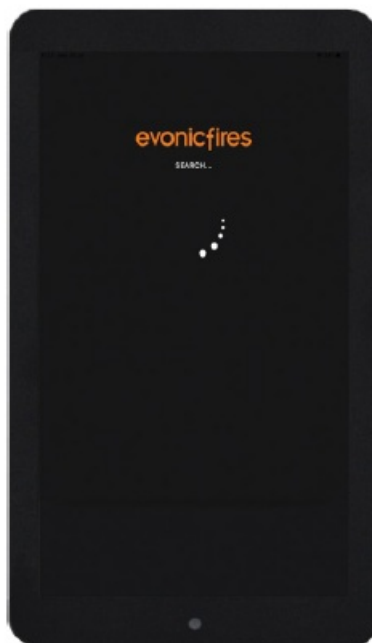

2. Force close the app by pressing the square at the bottom of your phone/e-tab. Then attempt to re-launch the app.
3. Ensure that the rocker switch is in the ON position, and re-scan for the product. Evonic House, Clifford Park, Clifford Lane, Stratford upon-Avon, Warwickshire, CV37 8HW [www.evonicfires.co.uk](http://www.evonicfires.co.uk) 01789 263868

## Documents / Resources



	<p><a href="#">evonic fires E-Smart Cloud Pairing Apps</a> [pdf] Instructions</p> <p>E-Smart Cloud Pairing Apps</p>
---	---

## References

- [ef Electric Fires, Stoves & Inset fires - Evonic Fires](#)