



EVOLVE GEH6073 Field Adjustable Module Installation Guide

[Home](#) » [EVOLVE](#) » EVOLVE GEH6073 Field Adjustable Module Installation Guide 

Contents

- [1 EVOLVE GEH6073 Field Adjustable Module](#)
- [2 BEFORE YOU BEGIN](#)
- [3 General](#)
- [4 Adjusting The Output](#)
 - [4.1 Example](#)
- [5 Documents / Resources](#)
 - [5.1 References](#)
- [6 Related Posts](#)



EVOLVE GEH6073 Field Adjustable Module

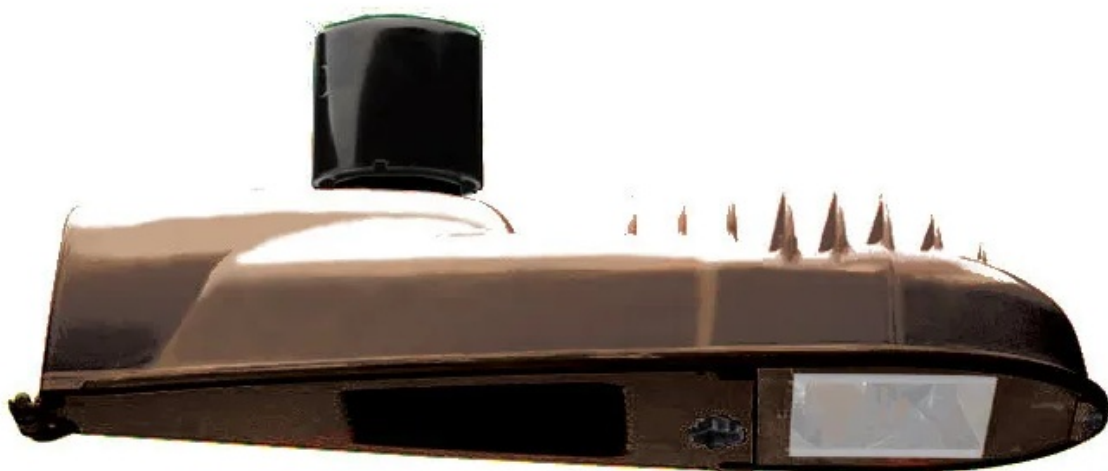

BEFORE YOU BEGIN

Read these instructions completely and carefully. Save these instructions for future use.

WARNING

- RISK OF ELECTRIC SHOCK
- Disconnect power before service installation, or maintenance of the product.

CAUTION

- RISK OF INJURY
- Wear safety glasses and gloves during installation and servicing.

General

The Field Adjustable Module (FAM) is a factory-installed voltage regulating device that is connected to the gray (-) and violet (+) 0-10V dimming leads of the LED driver. Manually dialing the switch allows the fixture to be dimmed in the field.

Position Posició n	Dimming Voltage	% Output Power
10	OPEN	100%
9	OPEN	100%
8	7.75	85%
7	6.59	71%
6	6.06	64%
5	5.50	58%
4	4.71	49%
3	4.49	47%
2	3.02	31%
1	3.01	30%

Adjusting The Output

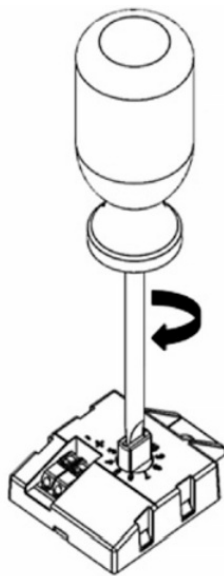

Rotate the actuator knob by hand or with a flat head screwdriver to adjust the light output based on the table. Position 10 is the factory default position and represents full brightness. Position 1 is the lowest brightness level.

- Fixture % lumen output is approximately equal to % output power.
- Actual Lumens = Rated Lumens x % Output Power

Example

- **Rated Lumens** = 15,000 lm
- **FAM Position** = 7
- **% Output Power** = 71%
- **Actual Lumens** = 10,650 lm

Note: Specifications subject to change without notice. Actual performance may vary with application conditions. Circuit is protected up to 30V. FAM is not compatible with DALI control or GE Light Grid.

gecurrent.com/evolve

© 2022 Current Lighting Solutions, LLC. All rights reserved. GE and the GE monogram are trademarks of the General Electric Company and are used under license. Information and specifications subject to change without notice. All values are design or typical values when measured under laboratory conditions.

Documents / Resources

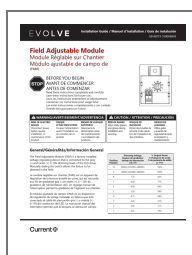

[EVOLVE GEH6073 Field Adjustable Module](#) [pdf] Installation Guide
GEH6073 Field Adjustable Module, GEH6073, Field Adjustable Module, Adjustable Module, Module

References

- [C EvolveÂ® Lighting Solutions | Current - GLI Brands](#)

[Manuals+](#), [home](#) [privacy](#)