



## evo 51ECI1702 Shutter Switch User Manual

[Home](#) » [EVO](#) » evo 51ECI1702 Shutter Switch User Manual 

# eve shutter switch

### Contents

- [1 Meet Eve Shutter Switch](#)
- [2 Get Started](#)
- [3 Installation – Preparation](#)
- [4 Installation](#)
- [5 Mounting](#)
- [6 Setup](#)
- [7 Enjoy](#)
- [8 Reset](#)
- [9 Disassembly](#)
- [10 Documents / Resources](#)
- [11 Related Posts](#)

### Meet Eve Shutter Switch

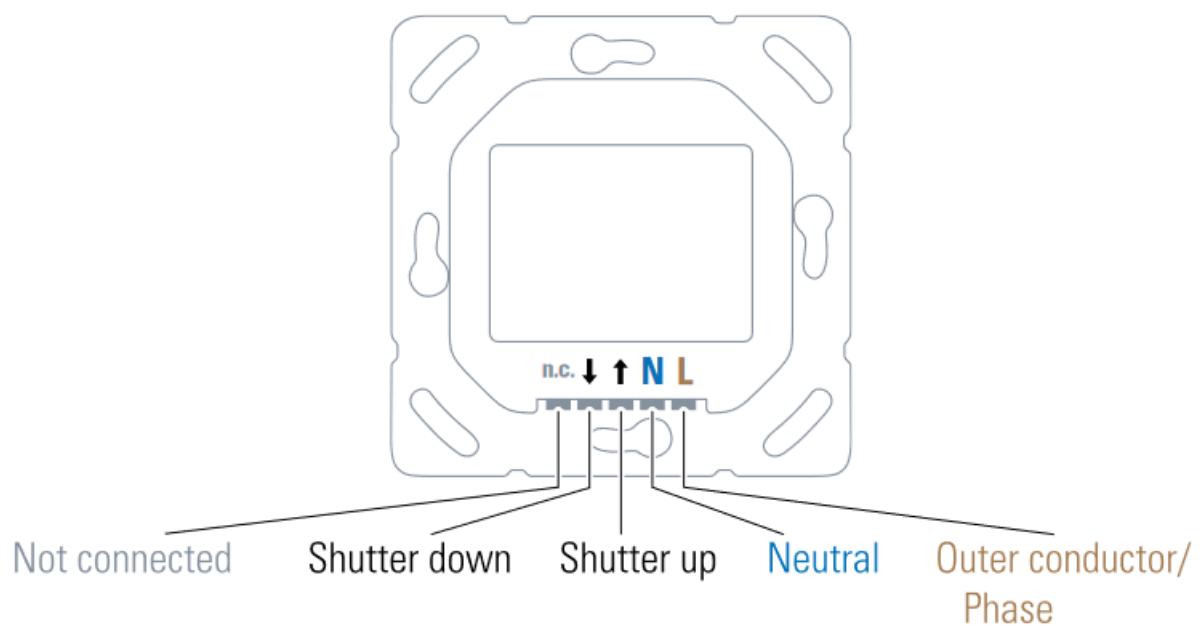
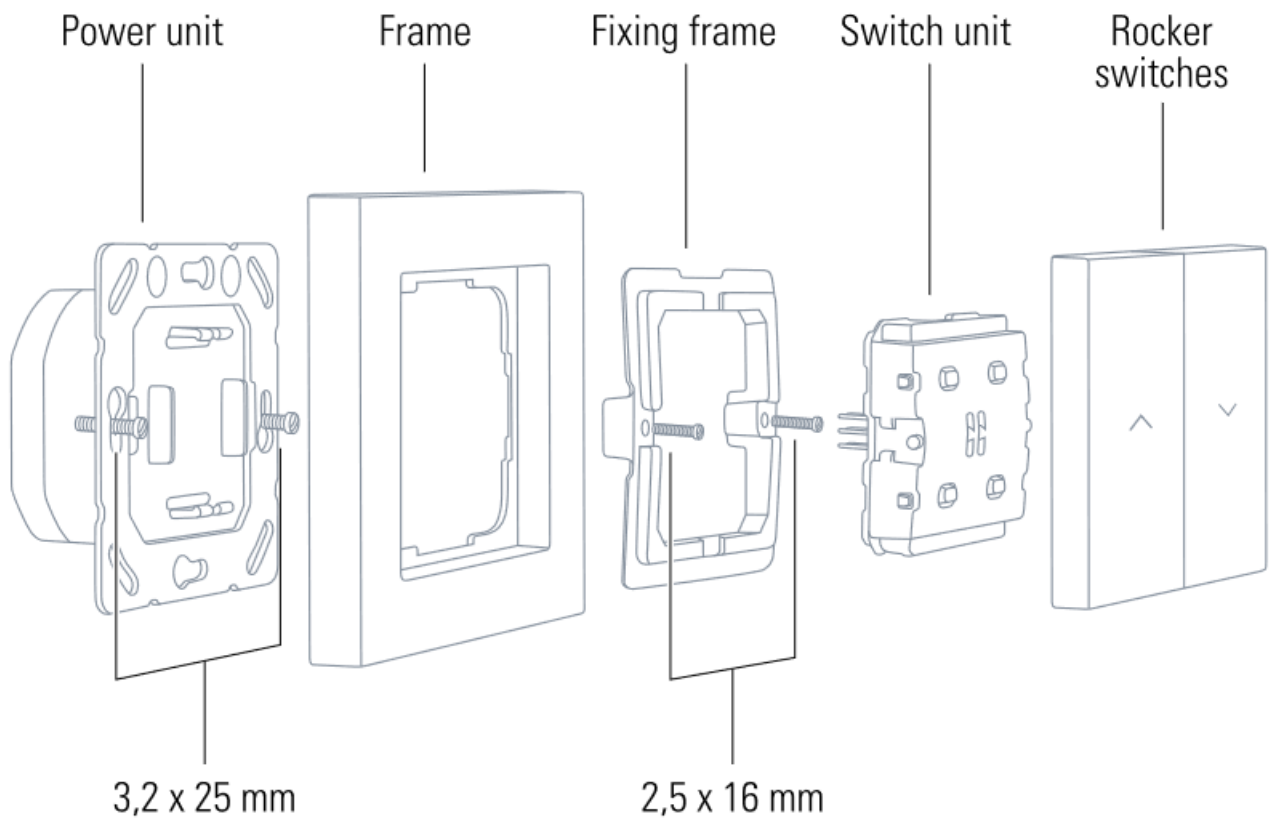

- Voltage: 230 V— 50 / 60 Hz
- max. connected load: 750 VA
- max. load current: 6 A (max. 5 A per channel)
- Connection terminals: 1.5 mm<sup>2</sup> rigid wire
- Flush-mounted socket dimension: 0 60 mm, min. 35 mm depth
- Ambient temperature: -10 °C to 50 °C
- Operating humidity: max. 85%, non-condensed
- Protection rating: IP30
- Frequency range: 2402 – 2480 MHz (BLE) / 2405 — 2480 MHz (Thread)

- Max. RF Power (EIRP): 20 dBm

## Get Started



**CAUTION** – Risk of electric shock!

Only authorized electricians may connect, install and set up Eve Shutter Switch. Before installation, ensure the system is disconnected from the power supply!

Eve Shutter Switch is used to directly switch permanently connected electrical loads with a supply voltage of 230 V—. Eve Shutter Switch is designed for use in household and similar fixed installations. Before installation, ensure suitability by reviewing the technical data and the operating conditions.

Eve Shutter Switch must not be used in conjunction with life-support systems or other devices that could put the life or health of humans and animals at risk or risk property damage.

## Installation – Preparation

In your fuse box, switch off the fuse connected to your shutter switch. Press the buttons on your current shutter switch a few times to make sure that there is no current flowing.

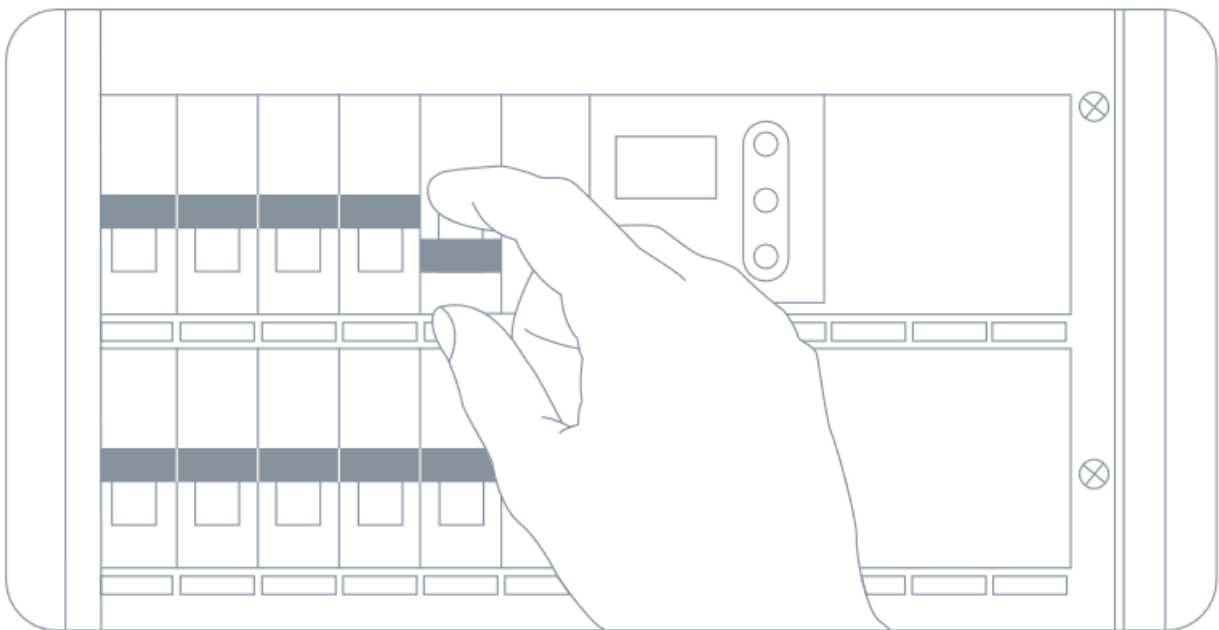

## Installation

### 1. Remove your current shutter switch

Loosen your existing shutter switch and pull it out. Note the current wiring and take a photo of it if necessary. You can usually tell which line is the current-carrying input (L ) and which lines leads to the shutter by the direction from which the cables are led into the box and by the inscription on your old shutter switch.



Eve Shutter Switch can only be installed if there is a neutral line (N, usually blue) in your outlet.

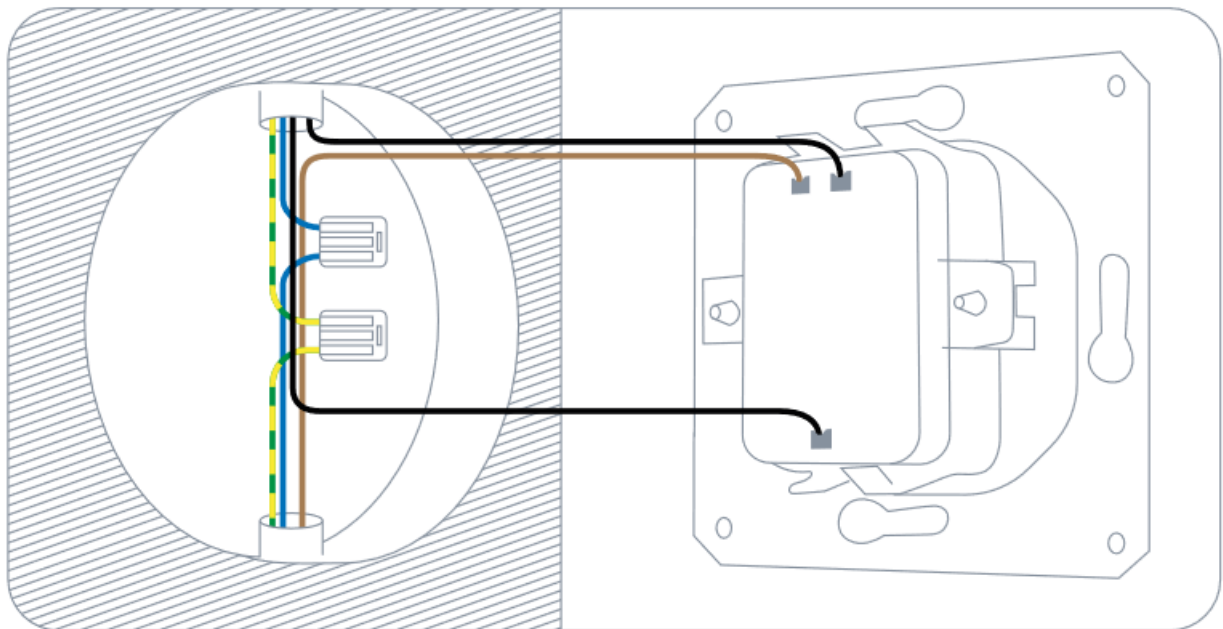

## 2. Connect Eve Shutter Switch

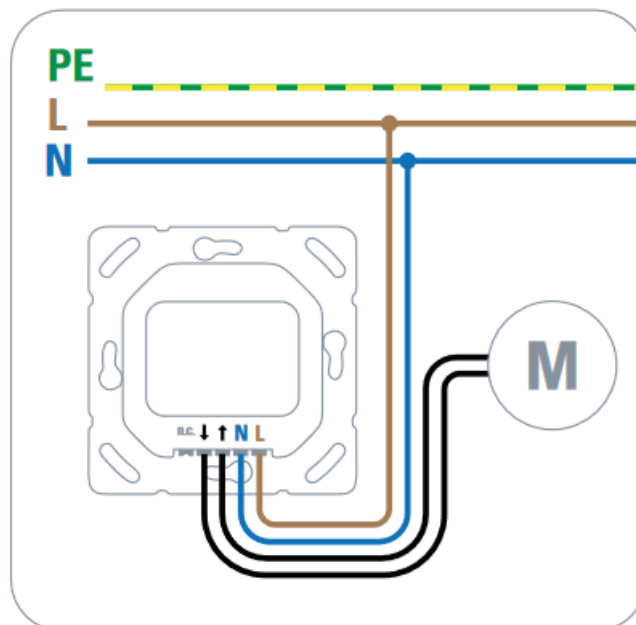

↓: Shutter down

↑: Shutter up

N: Neutral line Eve Shutter Switch requires that a neutral line is connected. If the outlet is not equipped with a neutral line, Eve Shutter Switch is incompatible with this outlet.

L: Outer conductor / phase (current-carrying line)

n.c.: not connected

**i** Eve Shutter Switch does not require a connection to a protective conductor / ground wire (PE, usually green/yellow).

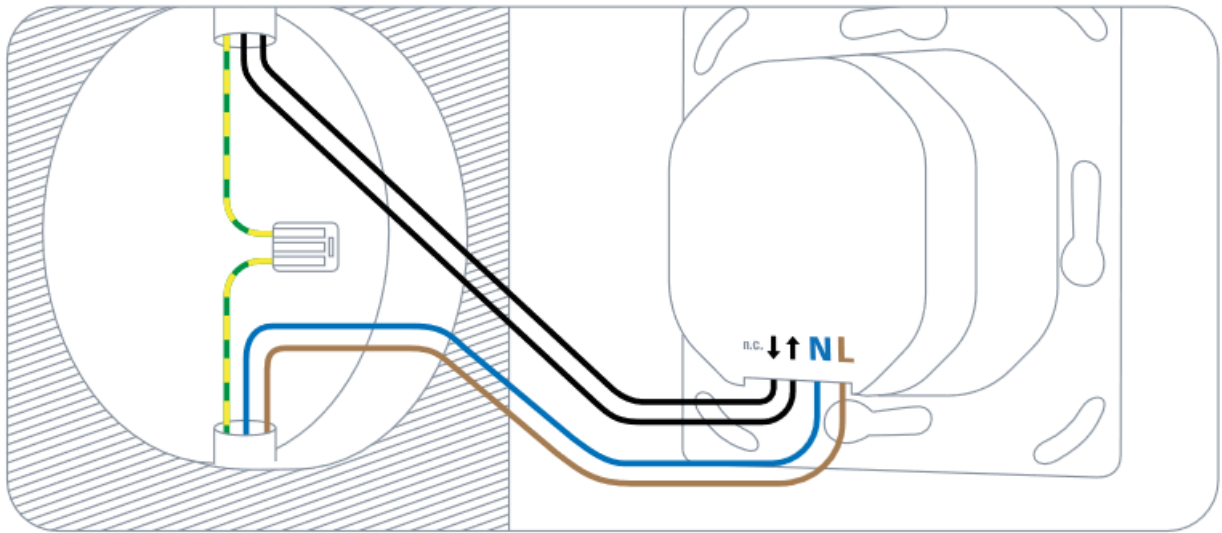

## Mounting

1. Place the power unit in the flush-mounted socket and secure it with the 3.2 x 25 mm screws (included).
2. Place the supplied or your existing frame on the power unit and secure the fixing frame with the supplied screws.
3. Insert the switching unit and then press the rocker switches onto it.
4. In your fuse box, switch on the fuse dedicated to the circuit of that shutter switch. You should now be able to move your shutter by pressing Eve Shutter Switch.

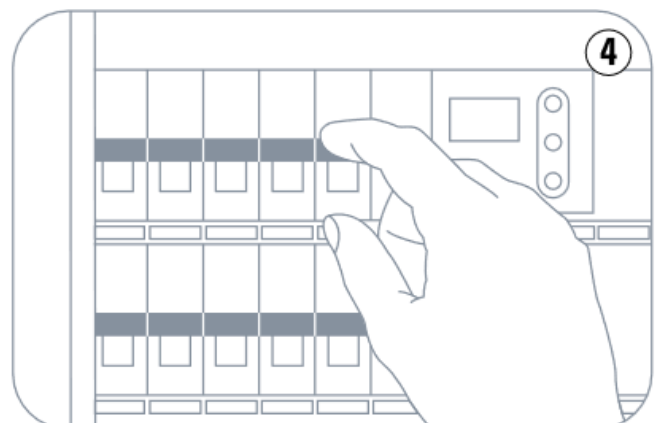
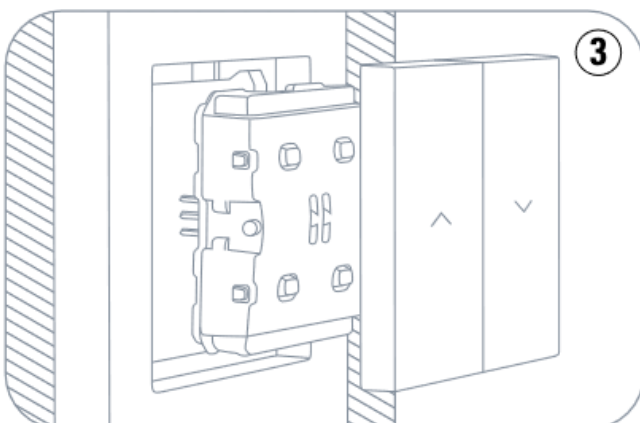
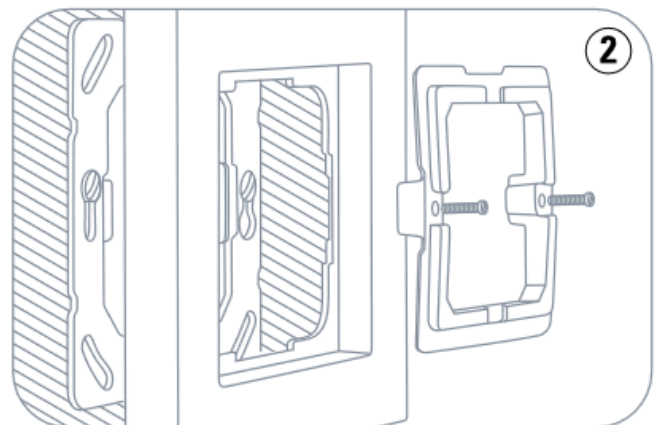
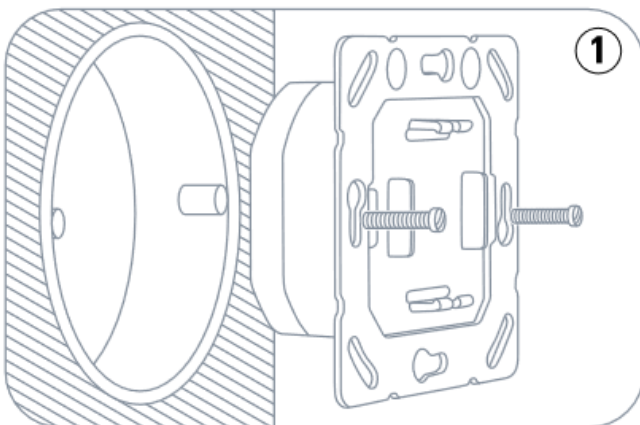

## Setup

1. Download the Eve app from the App Store.
2. Open the Eve app and tap Add Accessories. Eve will now guide you through the setup process.

If you already have Eve set up, open Eve settings and add Eve Shutter Switch.

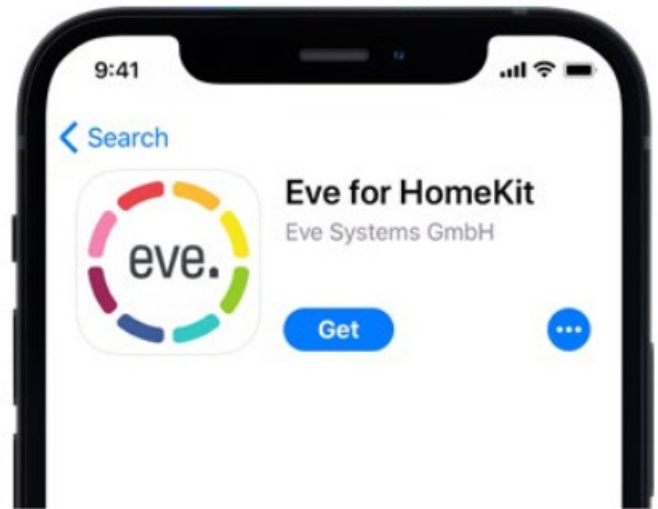
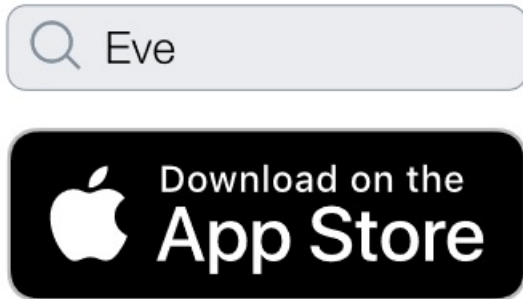

 To add Eve Shutter Switch, use the HomeKit code on the back of this manual.

## Enjoy

Operate your shutter using the app or a Siri voice command.



You can also operate your shutter directly via Eve Shutter Switch.

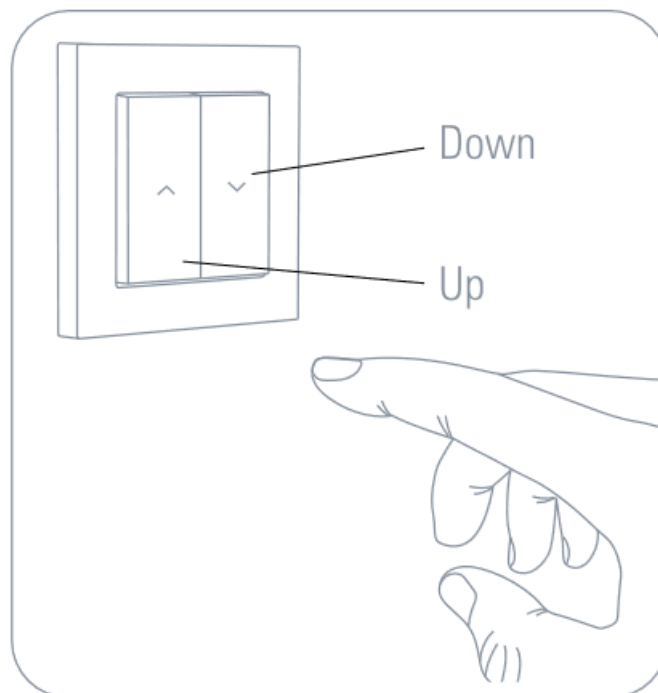

**Reset**

1. Remove the left rocker switch by pulling down this rocker switch from top edge.

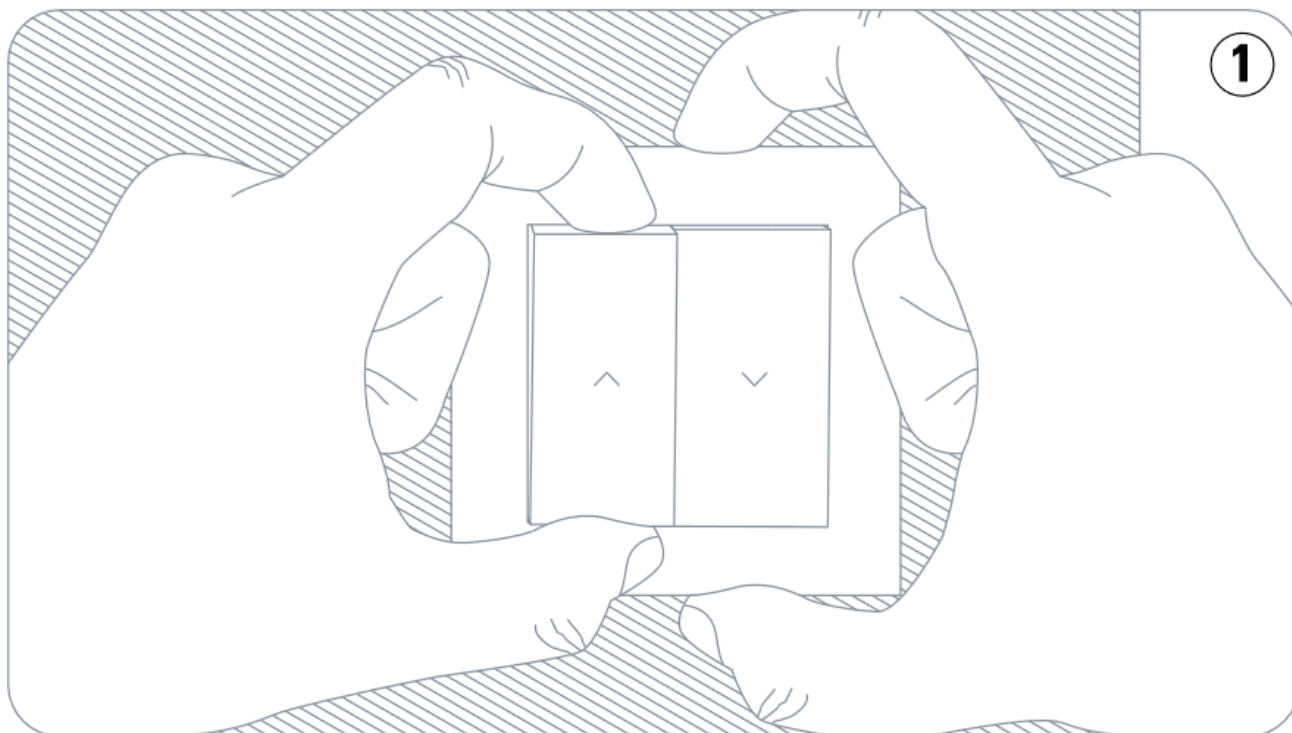

2. Press both left buttons simultaneously for 10 seconds.

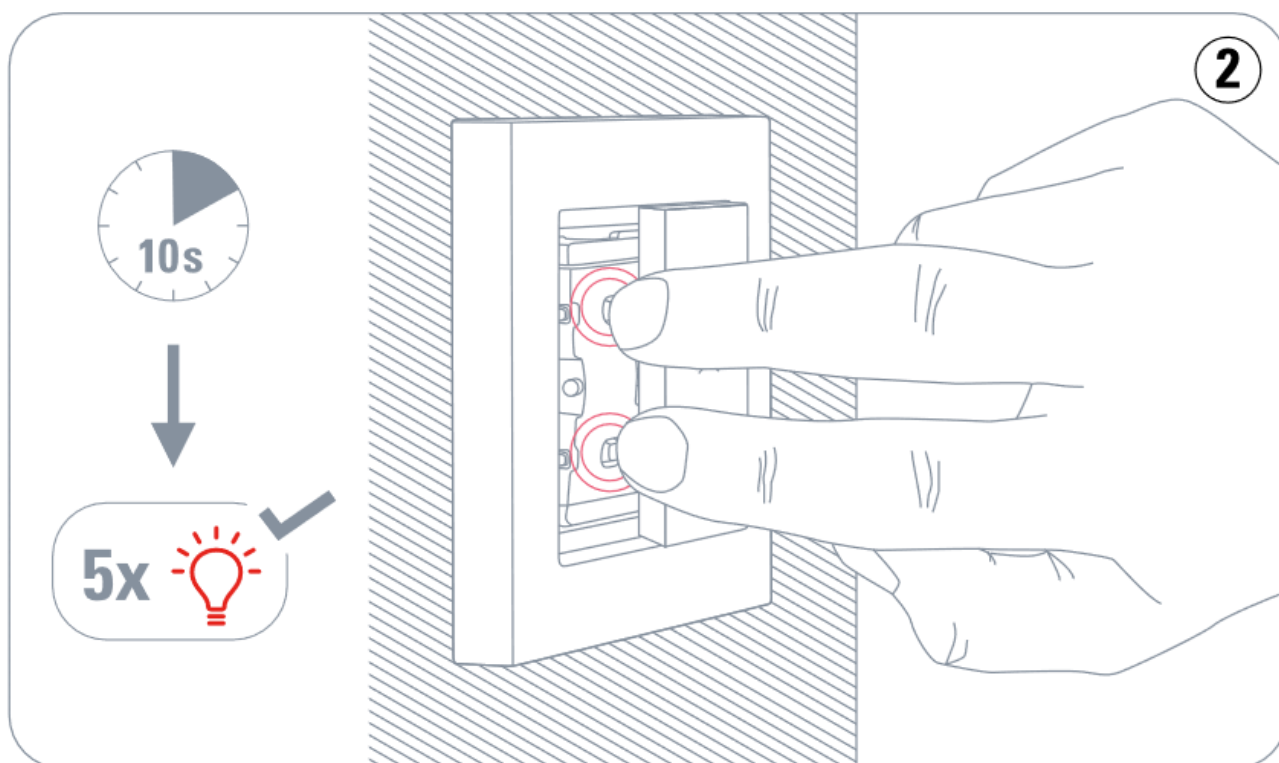

## Disassembly

1. In your fuse box, switch off the fuse connected to your shutter switch.
2. Make sure that there is no current flowing by pressing the buttons on Eve Shutter Switch a few times.
3. Remove the rocker switches by pulling down each rocker switch evenly from top edge.
4. Remove the switching unit by inserting a screwdriver into each of the corners and levering it out evenly.
5. Loosen the screws, remove the fixing unit and remove the frame.



6. You can now remove the power unit from your flush-mounted socket and disconnect the cables.

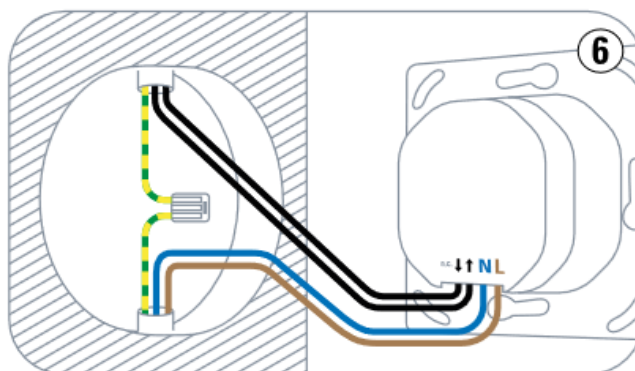
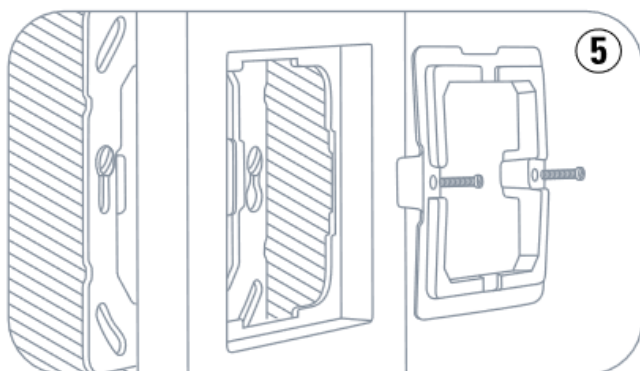
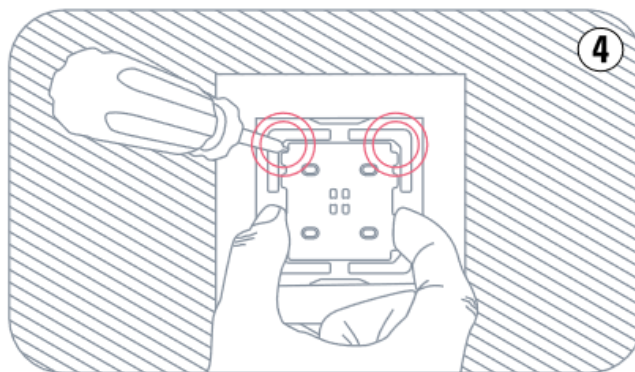
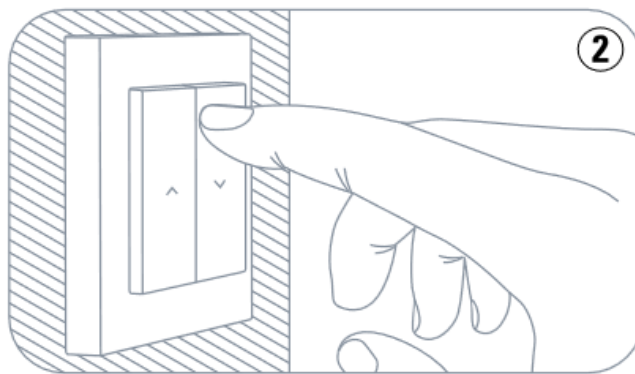
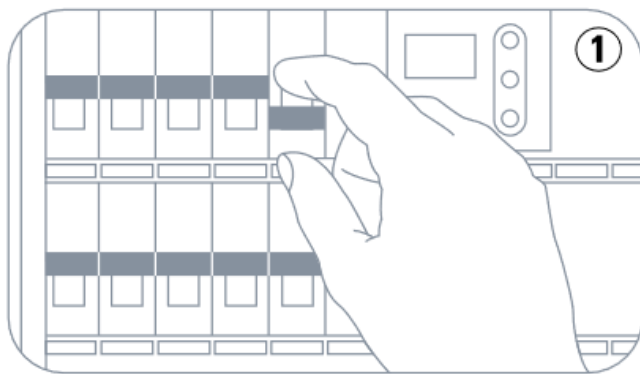

## Legal Information

This device conforms to the general requirements and further relevant provisions of the 2014/53/EC directive. You can download the declaration of conformity from [www.evehome.com/doc](http://www.evehome.com/doc).

Product: 10ECI1701 • Model: 20EC11701 • Part: 51ECI1702

Please keep your HomeKit Setup Code in a safe place. You need it to securely add Eve to your home, and nobody but you has a copy.

## Documents / Resources

eve shutter switch ©	<a href="#">evo 51ECI1702 Shutter Switch</a> [pdf] User Manual 51ECI1702 Shutter Switch, 51ECI1702, Shutter Switch, Switch
----------------------	---