



EVO FOX GO Smartphone Wireless Gamepad User Guide

[Home](#) » [EVO FOX](#) » EVO FOX GO Smartphone Wireless Gamepad User Guide 



GO
SMART PHONE
WIRELESS GAMEPAD
QUICK START GUIDE



Contents

- [1 PRODUCT OVERVIEW](#)
- [2 IN THE BOX](#)
- [3 CHARGING THE GAMEPAD](#)
- [4 IPHONE, IPAD AND APPLE TV MODE](#)
- [5 ANDROID MODE](#)
- [6 ANDROID HID MODE](#)
- [7 EASY CLICK SETUP \(MACROS\)](#)
- [8 TURBO SETTINGS](#)
- [9 CHANGING VIBRATION LEVELS](#)
- [10 SPECIFICATIONS](#)
- [11 WARRANTY STATEMENT](#)
- [12 Documents / Resources](#)
 - [12.1 References](#)
- [13 Related Posts](#)

PRODUCT OVERVIEW

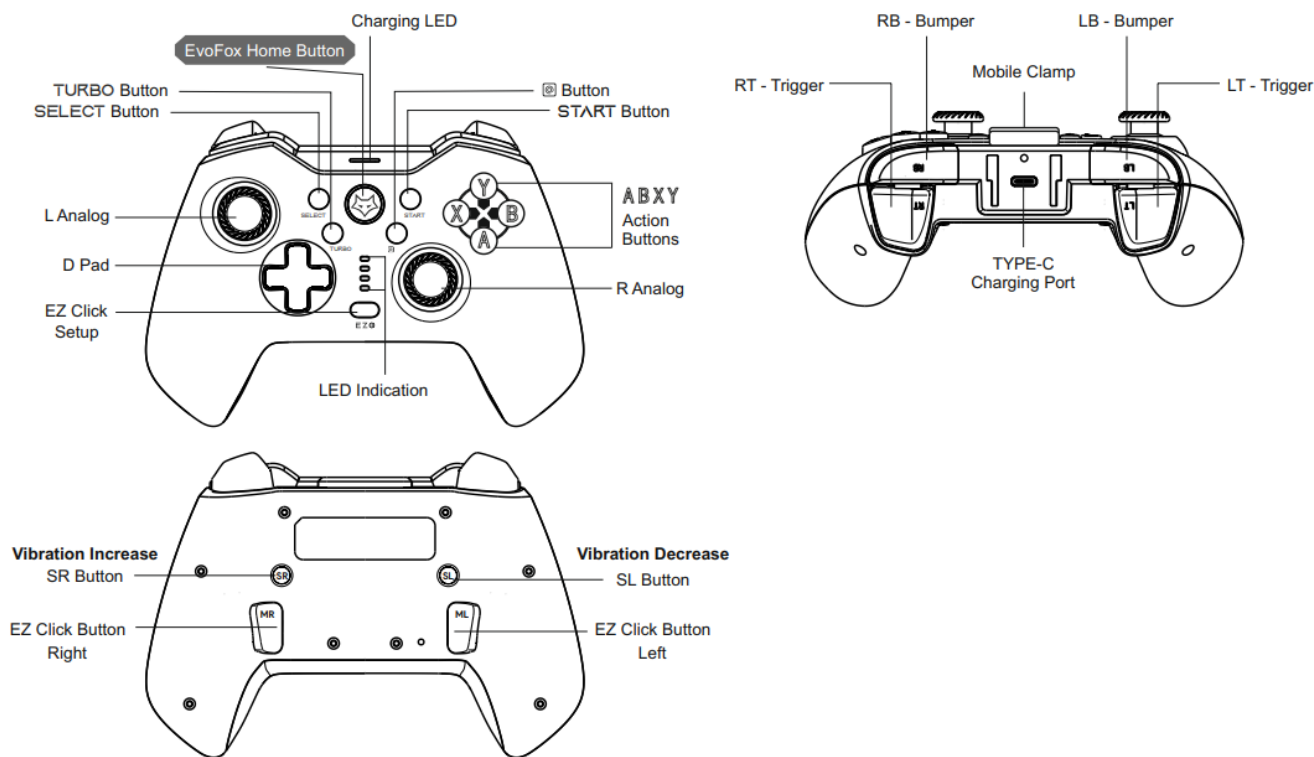

1. SLEEP AFTER 10 SEC OF DISCONNECTION.
2. TURNS OFF AFTER 5 MIN OF NO ACTION.
3. TO POWER OFF PRESS THE EVOFOX BUTTON FOR 5 SEC.

IN THE BOX



CHARGING THE GAMEPAD

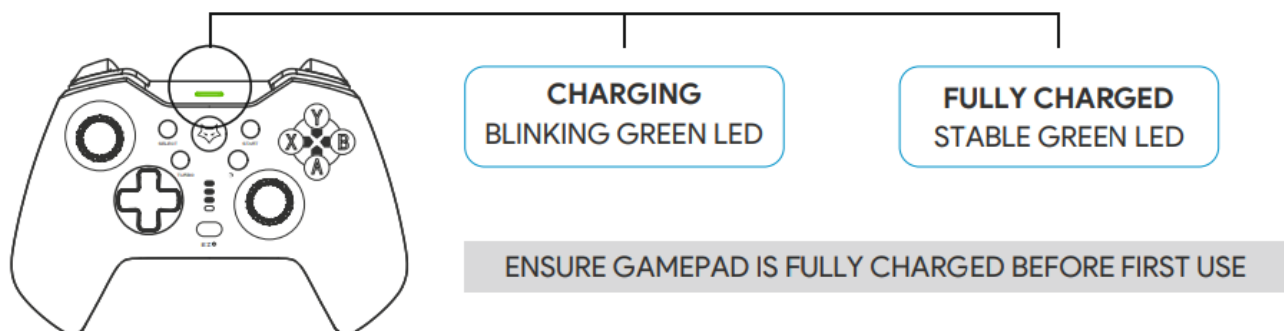

IPHONE, IPAD AND APPLE TV MODE

1. Press  + 

2. Open Bluetooth Settings on the device.

3. Connect to “DUALSHOCK 4 Wireless Controller”.



RECONNECTING: SIMPLY PRESS THE EVOFOX BUTTON TO POWER ON AND RECONNECT THE GAMEPAD

ANDROID MODE

1. Press  + 

2. Open Bluetooth Settings on the device.

3. Connect to “Wireless Controller”.



RECONNECTING: SIMPLY PRESS THE EVOFOX BUTTON TO POWER ON AND RECONNECT THE GAMEPAD

ANDROID HID MODE

1. Press  + 

2. Open Bluetooth Settings on the device.

3. Scan the devices and pair with “EvoFox Go ”.



EASY CLICK SETUP (MACROS)

Enable MACRO

1. Press **EZ** + MR or EZ+ ML together to set Macro .Connection LED will Blink.

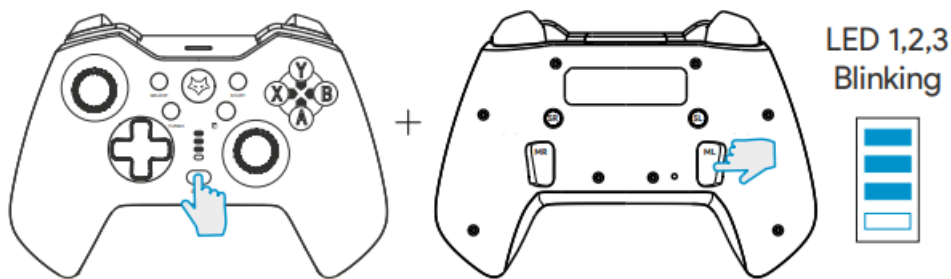

1. YOU CAN USE UP TO 14 BUTTON IMPRESSIONS TO SET UP THE MACRO.
2. THE BUTTON SHOULD BE PRESSED ONLY IN THEE SEQUENCE TO CREATE THE MACRO.

2. Disable Macro

Repeat the above step 1.

3. CLEAR MACRO'S

Long Press **EZ** to clear the MACRO.

All 4 LEDs will Blink.

Your MACRO is now cleared.



TURBO SETTINGS

1. Enter the TURBO Speed Function:

ENABLE: Press Turbo+ ABXY LT/RT LB/RB to enable the turbo on a particular button.

DISABLE: Repeat above step to disable the turbo



2. Adjust TURBO Speed:

Press Turbo+ DPAD (UP/DOWN) to increase or decrease the turbo speed.

Gamepad will Vibrate

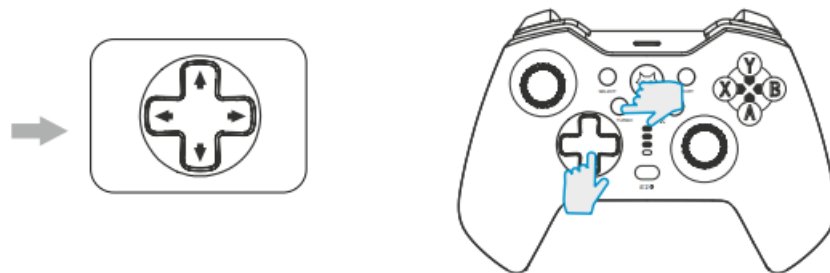

3. Clear ALL TURBO Setting:

Long Press the turbo button to clear the turbo.

All the 4 LEDs will blink with a vibration.



CHANGING VIBRATION LEVELS

Once Connected

Press SR Button
to Increase
Vibration

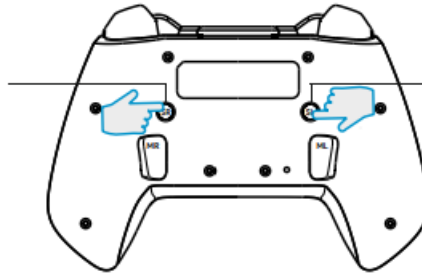

Press SL Button
to Decrease
Vibration

LED STATUS

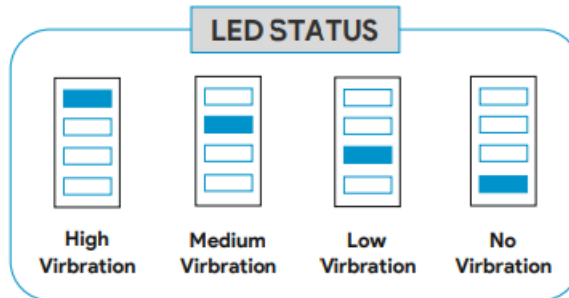

THERE ARE 4 LEVELS TO ADJUST THE VIBRATION

ENHANCE JOYSTICK PRECISION

Enable Joystick Precision

Press **EZ** + LEFT JOYSTICK

Disable Joystick Precision

Again Press **EZ** + LEFT JOYSTICK



RESET THE GAMEPAD

In the unlikely event the Gamepad is not responsive, use a pin to press the RESET button located at the back.

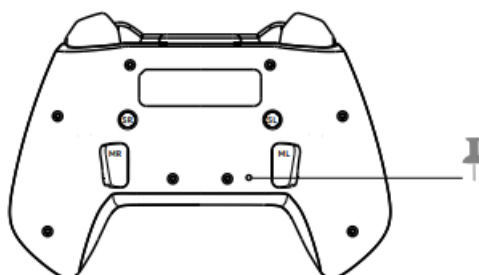

TROUBLESHOOTING

Why is this Gamepad not being detected by my device?

- Make sure it is charged.
- Make sure it is in the correct pairing mode.
- Make sure it is not connected to any other device.
- You may need to unpair and repair it.

Why is the Gamepad disconnecting?

The Gamepads needs to be charged.

Why is the Gamepad not working in all my games on Android or iOS?

Ensure the game has support of Gamepads.

Facing any trouble with the connection?

The gamepad may require you to unpair and reset it for further use.

SPECIFICATIONS

Working Platforms	iPhone. iPad. Android	Connection Types	Wireless/Bluetooth
Working Modes	'OS. Android	Charging Time	~ 2-2.5 hrs
		Working Distance	10 Feet
Play Time	~8 hrs	Net weight	220g



WARRANTY STATEMENT

Amkette EvoFox GO Smartphone Wireless Gamepad is backed by a 1 year performance warranty against any manufacturing defects in material or workmanship from the date of original purchase. This warranty entitles the purchaser to get the product repaired or replaced under the following conditions:

- The warranty applies to the original purchaser. Proof of original purchase is required.
 - The warranty does not cover the damage caused by misuse, abuse or improper storage.
 - In no event shall Amkette be responsible for any direct, incidental, consequential or other damages of any kind.
- Please contact our Technical Support Line and/or send the defective product, postage pre-paid, together with the proof of purchase to our Customer Care Service Center to avail warranty service. Return postage will be paid by us.

CUSTOMER CARE SERVICE CENTER

Amkette House, C-64/4, Okhla, Phase-II, New Delhi-110020

	1800-11-9090 (Toll Free) (9:30 AM – 6:00 PM)
	+91 9312691448 (9:30 AM – 6:00 PM)
	techsupport@amkette.in

FOR HASSLE FREE SERVICE REGISTER YOUR PRODUCT AT WWW.AMKETTE.COM/REGISTER

Documents / Resources



[EVO FOX GO Smartphone Wireless Gamepad](#) [pdf] User Guide
GO Smartphone Wireless Gamepad, GO, Smartphone Wireless Gamepad, Wireless Gamepad
, Gamepad

References

-  [Product Registration – Amkette](#)

Manuals+.