



EVERSPRING ST802 Flood Detector Instruction Manual

[Home](#) » [EVERSPRING](#) » EVERSPRING ST802 Flood Detector Instruction Manual 

Contents

- [1 EVERSPRING ST802 Flood Detector](#)
- [2 General Introduction](#)
- [3 Product Layout](#)
- [4 Binding with VIAS](#)
- [5 Mounting the ST802](#)
- [6 Maintenance](#)
- [7 Troubleshooting](#)
- [8 Manual binding](#)
- [9 Operation](#)
- [10 Specifications](#)
- [11 Documents / Resources](#)
 - [11.1 References](#)
- [12 Related Posts](#)



EVERSPRING®

EVERSPRING ST802 Flood Detector



General Introduction

The ST802 Flood Detector is designed to sense the presence of water in basements, garage and many others residential and commercial applications, providing early warning of developing floods. It has great compatibility with our U-Net family security products for VIAS system.

Product Layout

The Flood Detector consists of a sensor probe connected to a main unit through a 3m long cable.

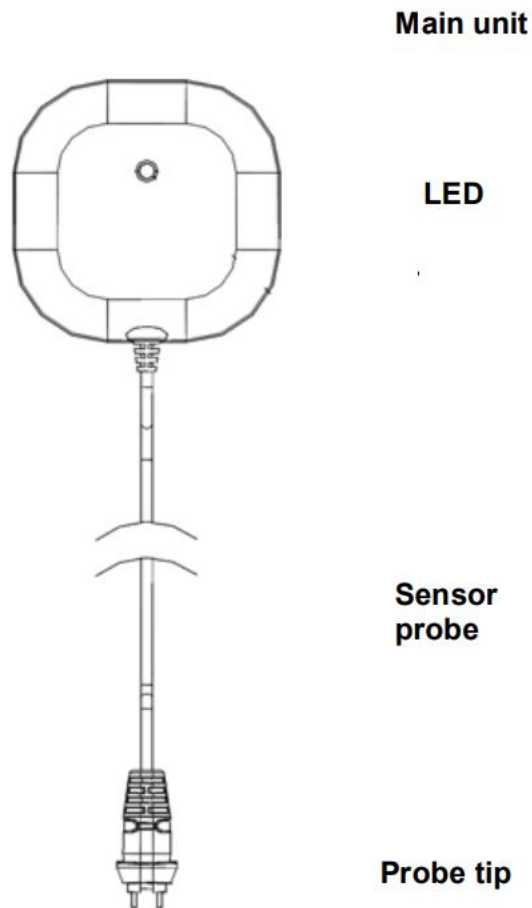

Binding with VIAS

1. Unscrew the screw from the bottom edge of the main unit. Then detach the back mounting plate by sliding it downwards.

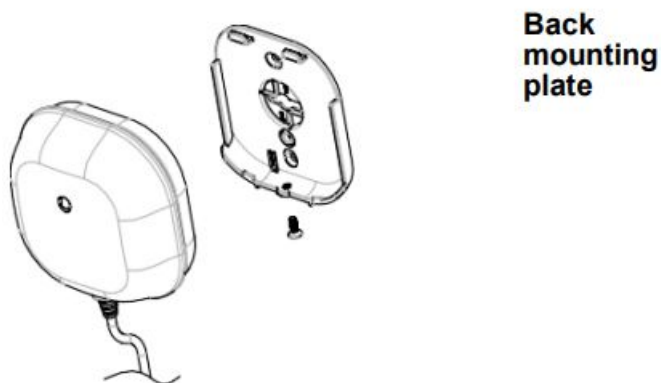

2. Remove the battery cover by removing its screw.

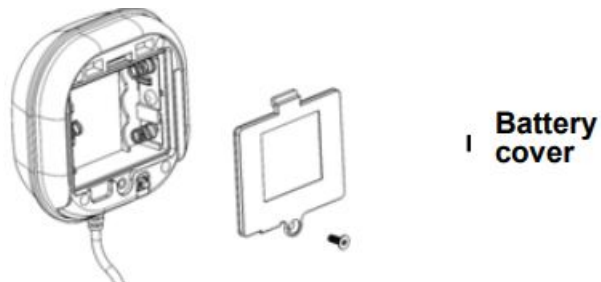

Remove the battery cover by removing its screw.

3. Login to VIAS account from the APP.
4. Enter the panel main page from gateway list, open the left menu list, and select "System Setup", then choose

“Add Device”.

5. Select “Flood Detector” to start the inclusion. This means the gateway is entering binding mode.
6. Insert the batteries with correct polarity at this point. The device can be auto-binding at first inclusion when power on.

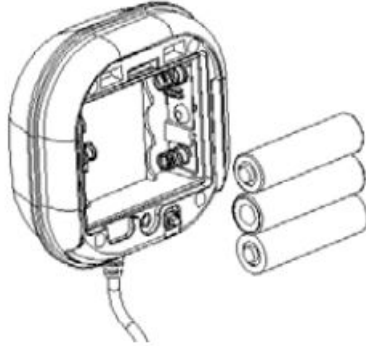

7. The APP wizard will appear if the process is successful.
8. Time-out will occur if the binding process was unsuccessful. Please refer to the Manual Binding procedure in the Troubleshooting section.

Testing

1. Prepare a glass of water and dip the tip of the sensor probe into the water.
2. The LED will flash orange and a beep sound will be heard.
3. The gateway will then register a flood event and a notification will be sent to the smartphone App.
4. If the test is unsuccessful, please refer to the troubleshooting section.
5. Attach back the battery cover and screw it tight.

Mounting the ST802

A clean smooth surface is required to securely mount the Flood Detector. The main unit should be placed as high up as possible on the wall to improve communication and prevent from coming into contact with water in case of flood.

The tip of the sensor probe should be mounted at a height from the floor at which the probe is intended to detect the flood level.

As shown below, secure the flood detector in place using the supplied cable racks and probe racks which first are drilled into the wall.

Maintenance

Do not immerse this unit in water or any other liquid, only the sensor probe can enter in contact with liquids.

Low Battery: When the battery becomes low, the detector will report back to the gateway and the LED will flash red every 30secs when this happens. Replace the batteries at once.

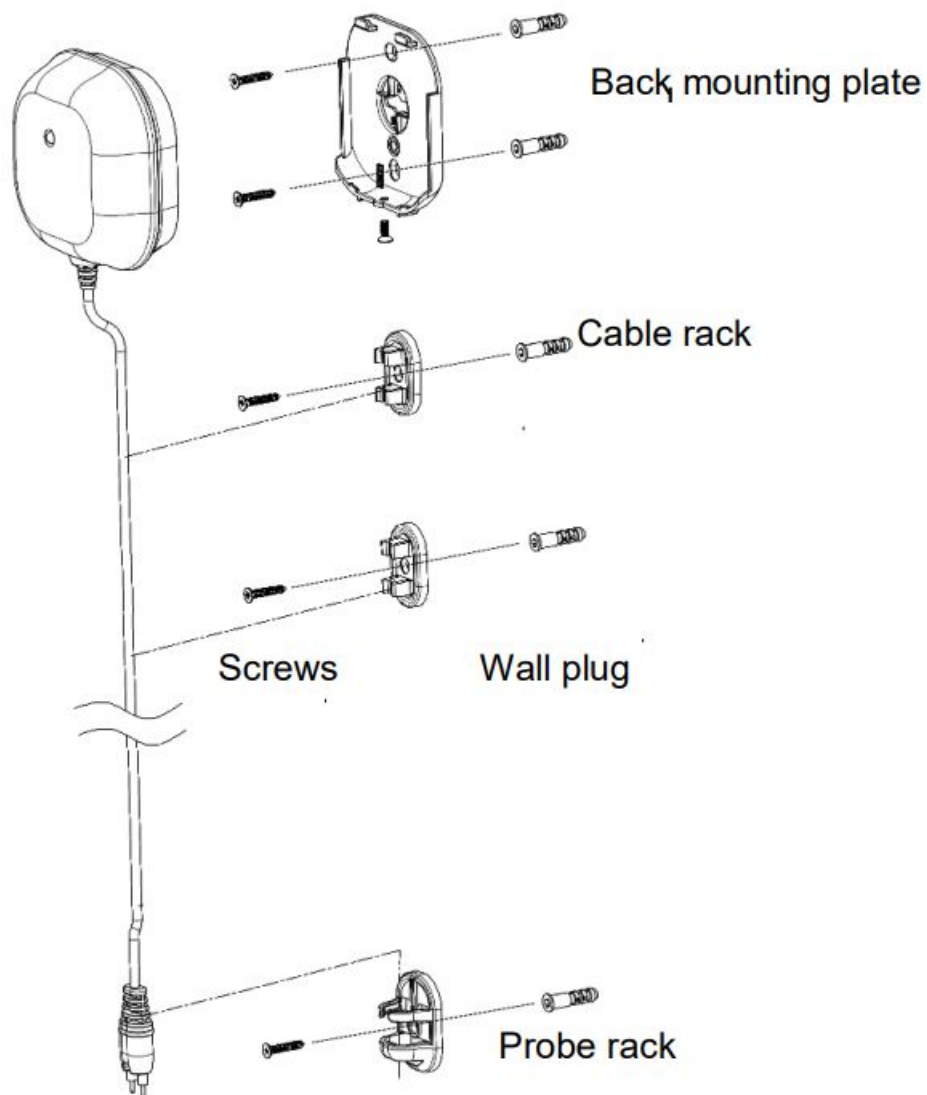

Installation location is applicable in wide ranges from basement, water sink, refrigerator..etc.

Troubleshooting

The troubleshooting table lists some possible causes and solutions.

Please contact your original retailer or nearest service center if the below solutions cannot solve your problem.

| Symptom | Possible Cause | Recommendation |
|--|---|---------------------------------------|
| LED not indicating | Batteries have not | Check out if batteries are |
| and detector not working | been fitted or insufficient battery power | fitted or replace new batteries |
| | Check if the unit is | Do not open up the detector |
| | out of order. | and send it for repair |
| LED is flashing red every 30secs | Batteries are running low | Replace batteries at once. |
| Gateway does react when detector detects a flood condition | The detector cannot communicate with the gateway. | Place the unit closer to the gateway. |
| | Unsuccessful binding operation. | Follow "Manual binding" procedure |

Manual binding

1. Repeat steps 5 to 7 of the Binding according to Wizard instruction.
2. Locate Learn button on the back of the main unit.

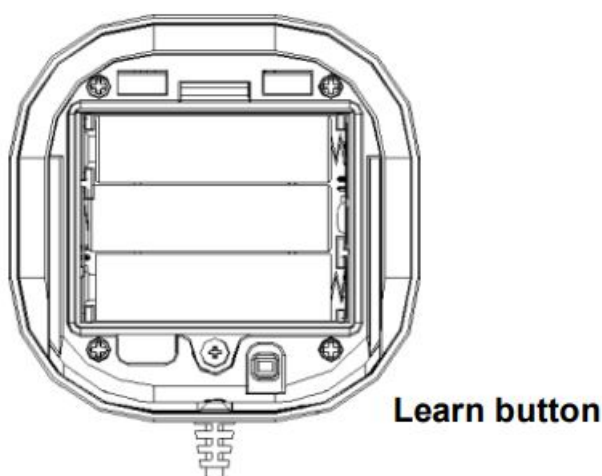

3. Press and hold the learn button for more than 3 seconds then release, and a 30-second countdown will start. The detector will beep rapidly and the LED will flash green.
4. Within 5 secs the detector will emit a long beep indicating the binding procedure is completed. The screen below will appear indicating the process is successful.

Reset to factory default

To reset detector back to factory default state:

1. Press and hold the learn button for more than 3 seconds then release, the detector will beep rapidly and the green LED will flash green.
2. Within 30 secs press and hold the learn button again for more than 6 seconds until a long beep is heard. This indicates the detector has been reset back to factory default settings.

Operation

1. When water is detected, the orange LED of detector will flash one second every one minute and beep 30 seconds and transmit radio signal to the Siren & Strobe or Control Panel of alarm system (option) simultaneously. In normal mode, the detector is allowed to be activated once in one minute, avoiding false trigger.
2. When water is released, the green LED on the detector will illuminate once and emit radio signal to the Siren & Strobe (option) or Control Panel of alarm system.
3. When the battery level on the detector drops to low battery level, the red LED will flash once every 30 seconds and radio signal will be transmitted to Control Panel of alarm system.
4. Flood detector can work with advanced feature on automation by creating the scene/automation scenarios to make warning with voice alert by siren or sent push together. For advanced settings, please set by VIAS APP>Scene>Automation>+Add Automation.

Specifications

| | |
|-----------------------|------------------------------|
| Battery Type | 1.5V AA batteries x3 |
| Battery Life | About 1year @25°C |
| Distance | >300m open space |
| Operating Frequency | 868MHz(EU) / 923MHz(America) |
| Protection | IP44/Indoor use |
| Operating Temperature | 0°C – 40°C (32°F-104°F) |

*Specifications are subject to change and improvement without notice.

WARNING:

Do not dispose of electrical appliances as unsorted municipal waste, use separate collection facilities.

Contact your local government for information regarding the collection systems available.

If electrical appliances are disposed of inland fills or dumps, hazardous substances can leak into the ground water and get into the food chain, damaging your health and well-being.

When replacing old appliances with new ones, the retailer is legally obligated to take back your old appliance for disposal at least for free of charge.



www.everspring.com

3F., No.50, secl, ZhonghuaRd., Tucheng
Dist., New Taipei City 23666, R.O.C.

Documents / Resources

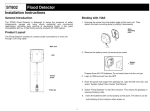

[EVERSPRING ST802 Flood Detector](#) [pdf] Instruction Manual ST802, ST802 Flood Detector, Flood Detector, Detector

References

- [Everspring –](#)
- [Everspring –](#)

[Manuals+.](#)