



Evenflo Pivot Xpand Modular Stroller User Manual

[Home](#) » [evenflo](#) » Evenflo Pivot Xpand Modular Stroller User Manual 

evenflo®

PIVOT XPAND™

Modular Stroller User Manual



Contents

- 1 Features
- 2 Important Information
- 3 Identification of Parts
- 4 Choosing Mode of Use
- 5 Assembling Your Stroller – Frame
- 6 Using Your Stroller – Toddler Seat Mode to Carriage Mode
- 7 Pivot Xpand Use Configurations
- 8 Care and Maintenance
- 9 Limited Warranty
- 10 Documents / Resources
 - 10.1 References
- 11 Related Posts

Features

Holds Evenfall Sarema™ or Lisema™ Infant Car Seats Only

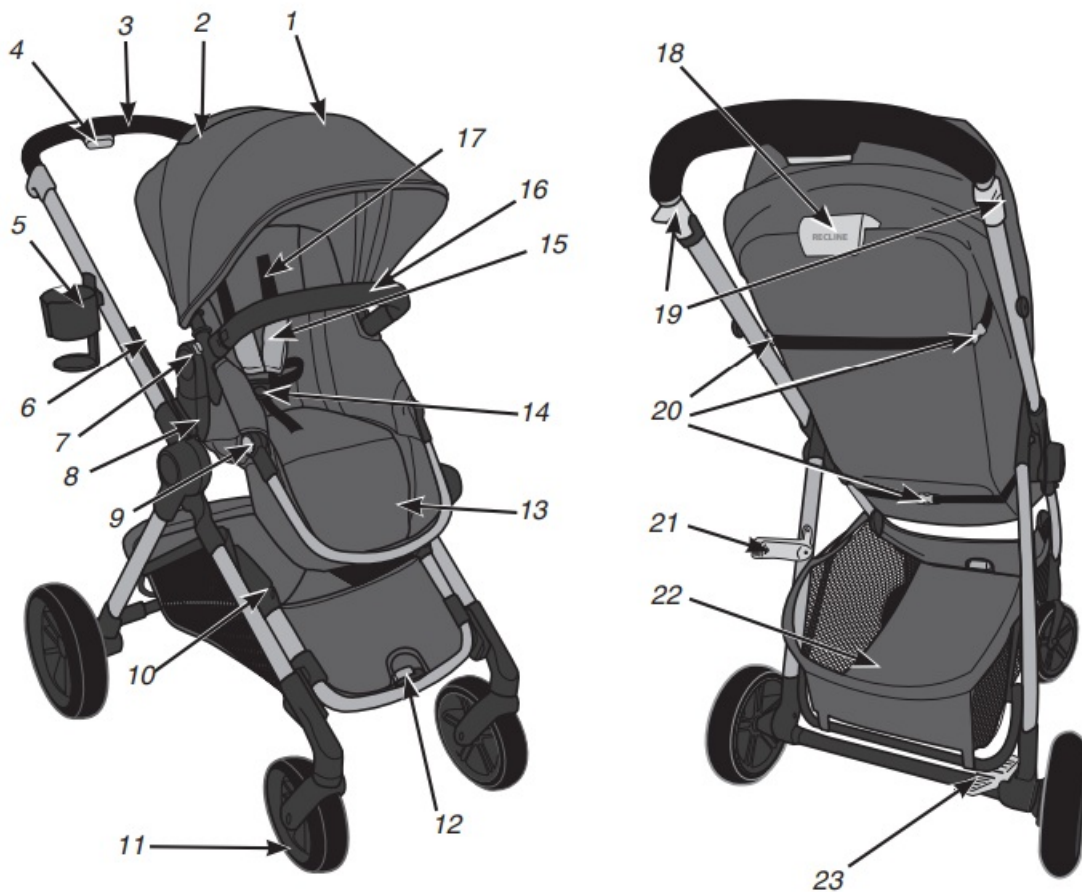

1. Canopy 2. Canopy Window 3. Parent Handle 4. Adjustable Handle Button 5. Cupholder 6. Slide Mount Track (Upper and Single Seat Positions) 7. Toddler Seat Release Button 8. Single Seat Mount	9. Footrest Adjustment Button 10. Lower Seat Mount 11. Swivel Wheel 12. Lower Seat Mount Release Button 13. Footrest 14. Harness Buckle 15. Harness Cover 16. Bumper Bar	17. Shoulder Straps 18. Multi-Position Recline Lever 19. Fold Release Levers 20. Carriage Mode Buckles 21. Side Frame Lock 22. Storage Basket 23. Brakes
--	---	--



WARNING!

DEATH or SERIOUS INJURY can occur.

READ AND FOLLOW ALL WARNINGS AND INSTRUCTIONS!

FAILURE TO DO SO COULD RESULT IN SERIOUS INJURY OR DEATH!

- Only use Evenfall Sarema™ and Lisema™ infant car seats with this stroller.
Other infant car seats or carriers are not designed to fit the stroller frame unless specified in the instructions. Any car seats used with this stroller that are not specified in the instructions may result in serious injury to your child.
- NEVER leave child unattended. ALWAYS keep child in view while in the stroller.
- Adult assembly required. Take care when unpacking and assembling; contains small parts and some items with sharp edges.
- To prevent a possible choking hazard, remove and discard packing material before using this product.
- To avoid serious injury from child falling or slipping out of stroller, ALWAYS use the internal harness system in Toddler Seat Mode and Carriage Mode.
- DO NOT carry or roll stroller on stairs or escalators with child in it.
- DO NOT hang items on handle bar or place them on the canopy as they can tip stroller over and injure child.
- Be sure stroller is fully assembled and locked in unfolded position before using.
- ALWAYS exercise care when going over curbs or steps, and never use stroller for anything other than transporting your child.
Push stroller at a normal walking pace only; faster strolling can cause a loss of control and injury to the child.
- DO NOT place hot liquids in cup holder. Spills can burn you or your child.
- To avoid serious injury from child falling out of stroller, DO NOT raise or recline seat with child in stroller.
- DO NOT use stroller if any parts are missing or broken.
- DO NOT allow child to climb on, into, out of, or around stroller.
- DO NOT allow child to stand on the footrest. Stroller may tip over and injure child.
- DO NOT carry additional children, goods, or accessories in or on this stroller except as advised in these instructions. The stroller is intended for use with two children and to accommodate only the additional weights in storage as listed in these instructions.
- Care must be taken when folding or unfolding stroller to prevent finger injury to you or your child in hinge areas. Make sure child is not in the seat or near the stroller when folding or unfolding.
- NEVER leave stroller on a hill or incline, even with brakes set. Stroller may tip, injuring the child.

- To avoid accidental rolling, ALWAYS set brakes when stroller is not being pushed.
 - AVOID STRANGULATION:
 - DO NOT suspend strings or toys from the canopy.
 - DO NOT place stroller anywhere near cords from window blinds, draperies, phone, etc.
 - DO NOT place items with a string around your child's neck such as hood strings or pacifier cords.
 - If not properly secured, the child may slip into leg openings and strangle.
 - When making adjustments to the stroller, ALWAYS ensure that all parts of the child's body are clear of any moving parts of the stroller.
 - The canopy is not intended to provide UV protection.
 - Sharp or heavy objects placed in pockets may cause damage to the stroller, or injury to the child.
 - To ensure safety for your baby, please refer to the manufacturer's instructions for the use of your recommended infant car seats and keep all instructions available for reference.
 - DO NOT lift stroller by using the infant car seat handle when installed on stroller.
 - If unable to securely attach the infant car seat to this stroller, remove the car seat and contact Evenflo ParentLink at 1-800-233-5921 (USA), 1-937-773-3971 (Canada), or 800-706-1200 (México).
 - To avoid stroller instability and tip-overs, DO NOT load cup holder with over 1 lb (0.45 kg) , and the main cargo basket with over 10 lbs (4.5 kg).
 - NEVER use the toddler seat without the canopy attached.
 - NEVER lift or carry the toddler seat by the bumper bar.
 - NEVER use the stroller frame without the toddler seat or car seat attached.
 - NEVER use toddler seat in a motor vehicle or use it as a booster seat.
 - To avoid falls, never remove toddler seat from the stroller with child in it.
 - To avoid falls, always make sure the toddler seat or car seat is securely attached into the seat mounts on both sides of the stroller before placing child in the seat.
 - When stroller is in carriage mode, it is intended for a child from birth up to 6 months of age OR who is incapable of sitting upright unassisted. ONLY use the stroller in the upright position with a child who is capable of sitting upright unassisted.
 - NEVER use seat in the carriage mode position unless the straps under the seat are unbuckled and the seat is set up in Carriage Mode as per the instructions.
 - To avoid tipping, always remove heavier weight child before removing the lighter weight child.
 - To avoid serious injury, NEVER use the stroller in any other configuration other than what is shown in the instruction manual.
- This stroller can be used in multiple configurations both as a single and double stroller (see page 26-27).
- DO NOT exceed the maximum weight limits defined in the infant car seat or accessory manuals.
 - For additional use configurations with optional accessories, you can refer to the manuals that are provided with the Pivot Xpand Accessories (sold separately). These include but are not limited to: infant car seat adapters for other manufacturer's carseats, a Rider Board and a Second Toddler Seat option.

Important Information

Child Requirements – When stroller is in carriage mode, it is intended for a child up to 6 months of age OR who is incapable of sitting upright unassisted. Only use the stroller in the upright position with a child who is capable of sitting upright unassisted.

- Maximum weight: – 55 lbs (25 kg) in toddler seat
- Maximum height: – 43 inches (109 cm) in toddler seat

IMPORTANT: Read instructions carefully before use. Save these instructions for future reference. It is very important to assemble the stroller according to these instructions. If you are missing parts, do not use stroller and call Evenflo ParentLink at 1-800-233-5921 (U.S.A.), 1-937-773-3971 (Canada), or 800-706-1200 (México) to order replacement parts.

Registration Information

Please register this product so we can reach you if there is a safety alert or recall. We will not sell, rent, or share your personal information. To register your product, please complete and mail the card that came with it or visit our online registration at www.evenflo.com/registerproduct.

For future reference, record the Model Number and Date of Manufacture below. You can find this information on one of the rear stroller legs.

Model Number: _____

Date of Manufacture: _____

Identification of Parts



Front Wheel Assembly (2)



Frame



Rear Wheel (2)



Cupholder (1)



Bumper Bar



Basket Assembly
Bar

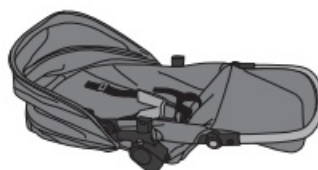

Toddler Seat

Choosing Mode of Use

YOUR STROLLER SEAT CAN BE USED IN TWO DIFFERENT MODES:
TODDLER SEAT MODE OR CARRIAGE MODE.

Your stroller seat is shipped in carriage mode with the buckles unfastened under the footrest and on the sides of the toddler seat.

You will need to follow the instructions completely to make sure you set up your stroller in your preferred mode of use.

After the frame and the wheels have been assembled, you can choose to set the stroller up in Carriage Mode or Toddler Seat Mode by following instructions on pages 12 – 15.

Toddler Seat Mode



Carriage Mode



Assembling Your Stroller – Frame



WARNING!

DEATH or SERIOUS INJURY can occur.

Care must be taken when folding or unfolding stroller to prevent finger injury in hinge areas.

To protect flooring, place a protective covering (carton) beneath the stroller during assembly.

Unlatch side frame lock.

Continue holding the lock open while unfolding the stroller.

Grab the parent's handle and pull upward until the stroller opens fully with an audible click.

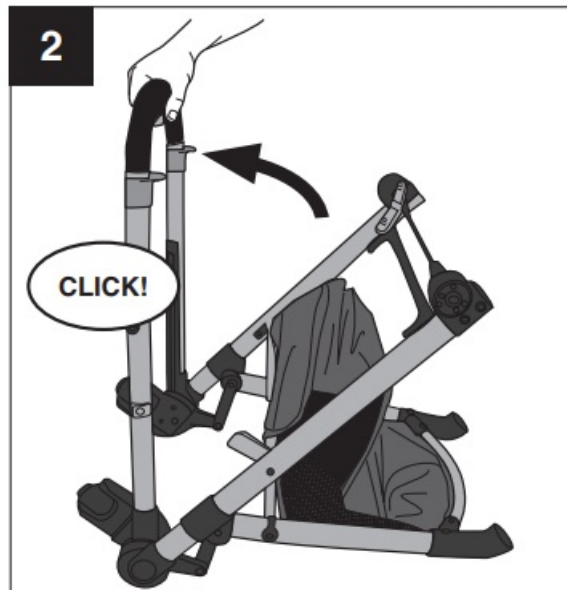
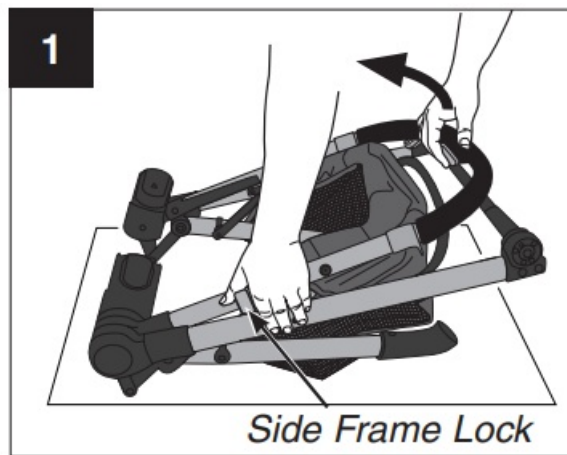

Make sure the stroller is locked in the open position by pushing down on the parent's handle.

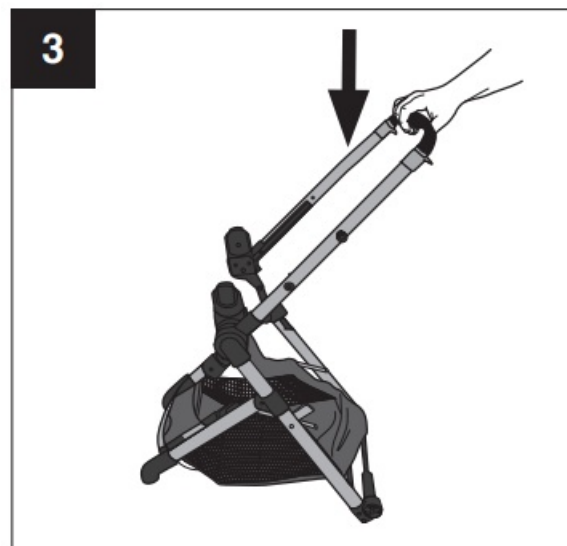

Assembling Your Stroller – Wheels

Turn the stroller so the front of the stroller is facing upwards as shown.

To attach front wheels, push wheel onto front leg tube until it clicks into place. Repeat on other side. Pull on wheels to make sure both of them are securely attached.

Turn the stroller upside down as shown so the rear of the stroller is facing upwards.

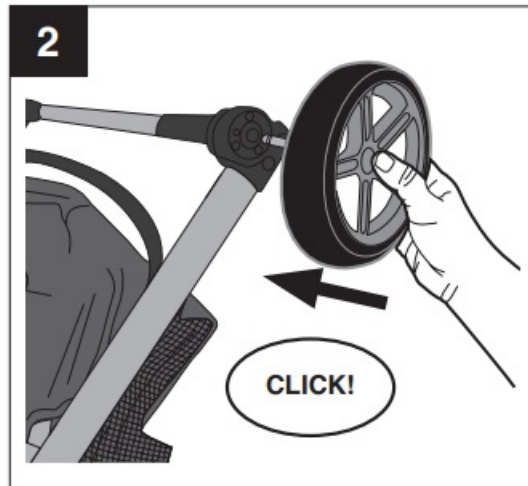
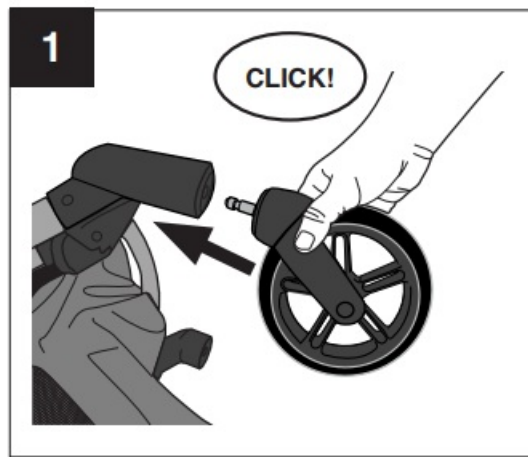

To attach rear wheels, push wheel onto rear leg tube until it clicks into place. Repeat on other side. Pull on wheels to make sure both of them are securely attached.

Assembling Your Stroller – Basket

To attach basket, locate the basket assembly bar and ensure the push buttons are on the bottom. Push basket assembly bar onto frame until it clicks into place on both sides with an audible click. Once installed, pull on the basket assembly bar to make sure it is locked into place. Complete assembly by zipping basket fabric around basket assembly bar and attaching snap buttons on both sides of the stroller frame.

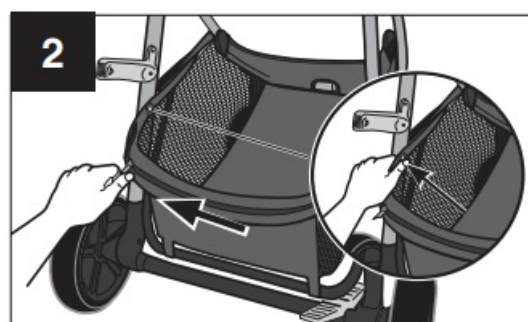
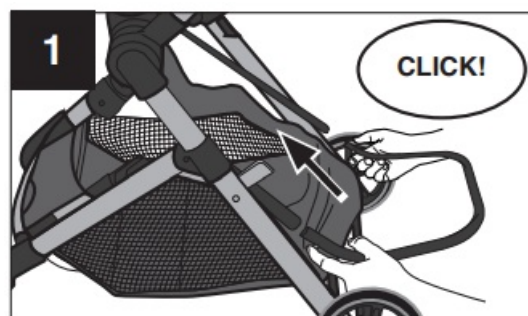

Assembling Your Stroller – Toddler Seat Mode

Fasten buckles behind leg rest and on each side of toddler seat.

IMPORTANT: The buckles **MUST** be fastened before placing child in the seating area.

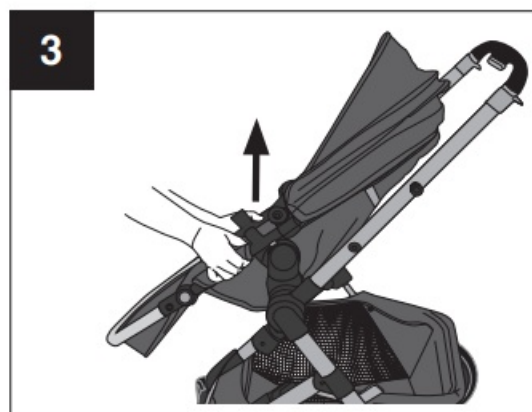
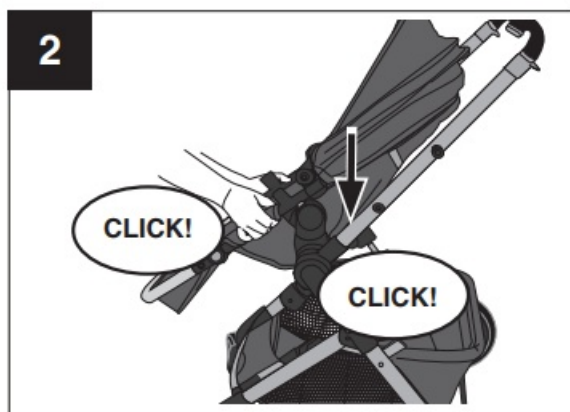

To attach toddler seat, slide seat onto the mounts until they both click into place on both sides of the frame. The toddler seat may be attached forward-facing or parent-facing. CHECK to make sure it is securely attached by pulling up on it.

NOTE: Stroller cannot be folded with seat in parent-facing position.

To adjust the footrest, push both buttons and lift the footrest up or down to desired position.

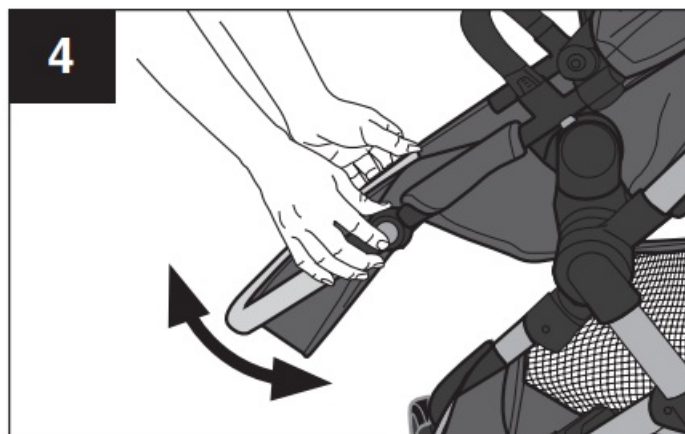

Assembling Your Stroller – Toddler Seat Mode



DEATH or SERIOUS INJURY can occur.

To avoid serious injury, DO NOT raise or recline seat with child in stroller.

To recline toddler seat, lift handle at the top of the seat and rotate seat to the desired position.

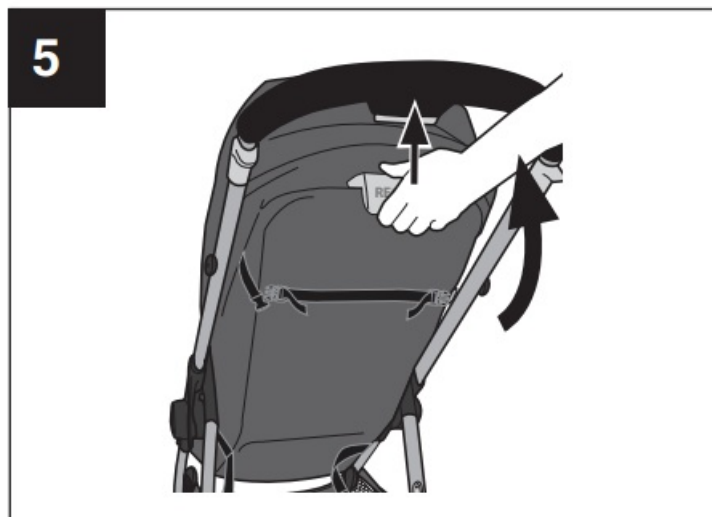

To attach bumper bar, push tabs into openings on stroller on either side of frame until it clicks into place. Pull on the bumper bar to make sure it is locked into place.

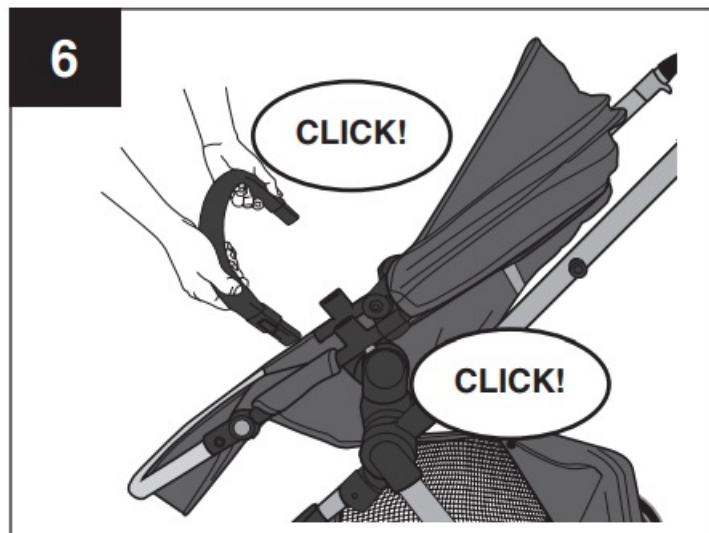

To remove the bumper bar, push both tabs and remove the bumper bar from the stroller.

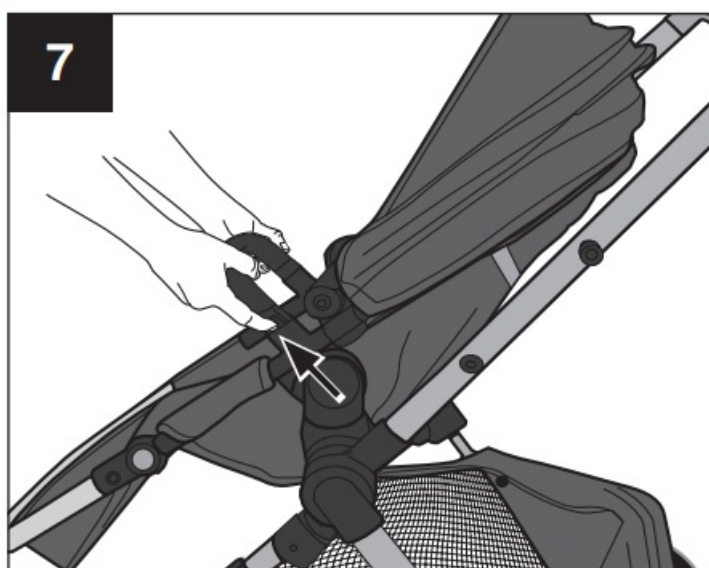

Using Your Stroller – Toddler Seat Mode to Carriage Mode



WARNING!

DEATH or SERIOUS INJURY can occur.

NEVER use seat in a reclined carriage position unless straps on the sides and under seat are unbuckled and seat is set up in Carriage Mode as per the instructions.

NEVER lift or carry toddler seat by the bumper bar or with child in it. The toddler seat is not a carrier.

ALWAYS use the harness system when the toddler seat is in Carriage Mode.

When using Carriage Mode, canopy MUST be in the lowest position (see pg. 19).

To avoid serious injury or death: DO NOT use Carriage mode with top rail lowered.

If you are in Toddler Seat Mode as shown, follow these steps to convert to Carriage Mode.



Unfasten buckles behind leg rest and on each side of toddler seat.

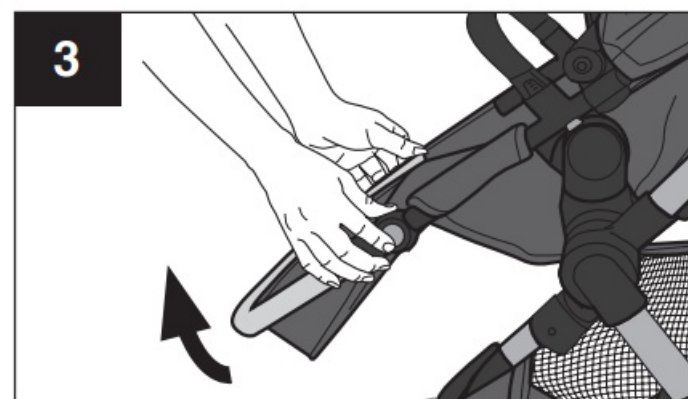
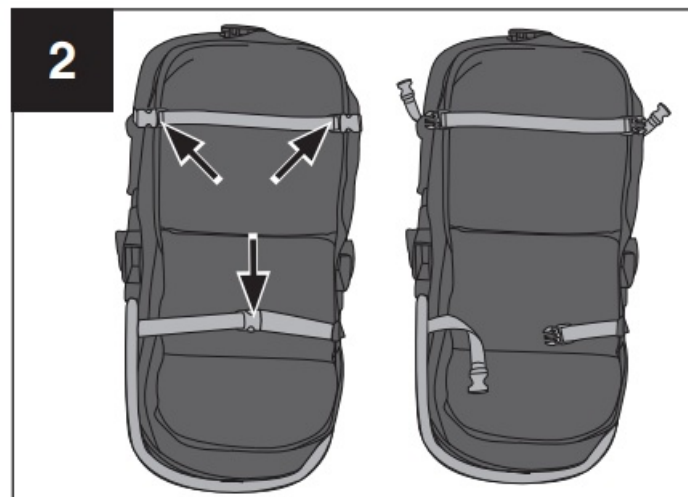

IMPORTANT: The buckles MUST be unfastened before placing child in the seating area. When using in Carriage Mode, the footrest MUST be in horizontal position as shown.

Lift handle and rotate seat all the way down so that it is flat.

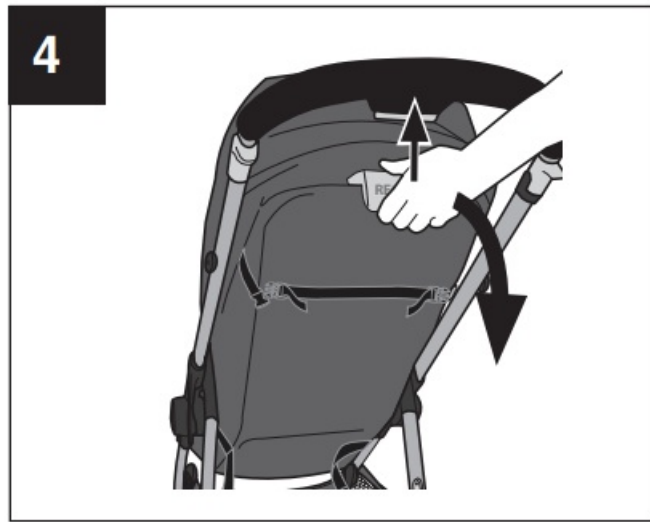

Press down on the inside of the toddler seat to flatten out the inside.

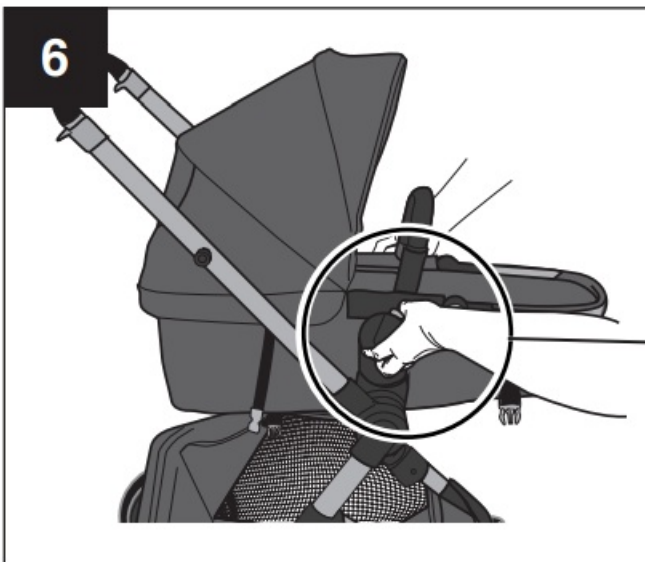
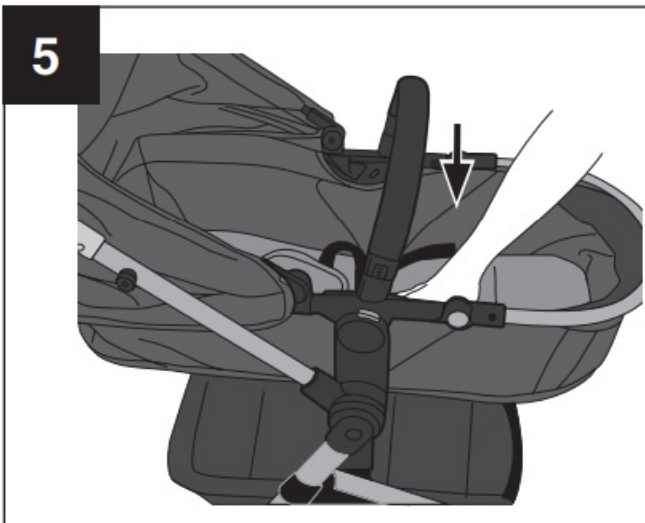

To remove and use in

parent-facing mode: Press the release buttons on both sides of toddler seat, lift seat off stroller frame and turn it around and re-attach.

CHECK to make sure it is securely attached on both sides by pulling up on it.

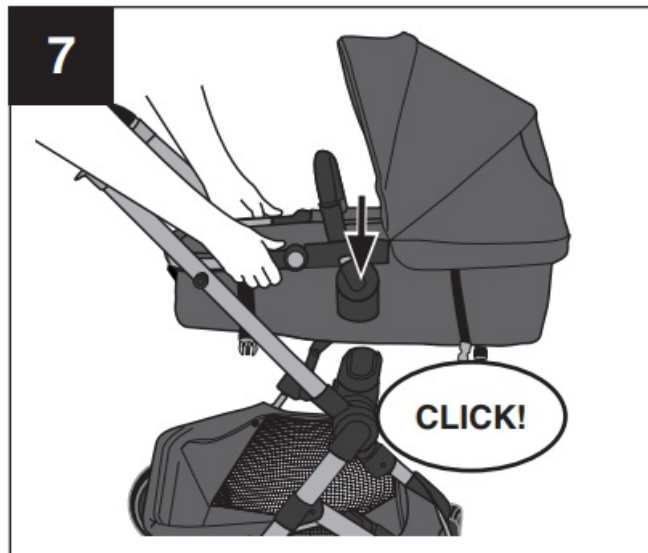

Using Your Stroller – Cupholder

To attach cupholder, slide down on the mount on either side of stroller as shown.

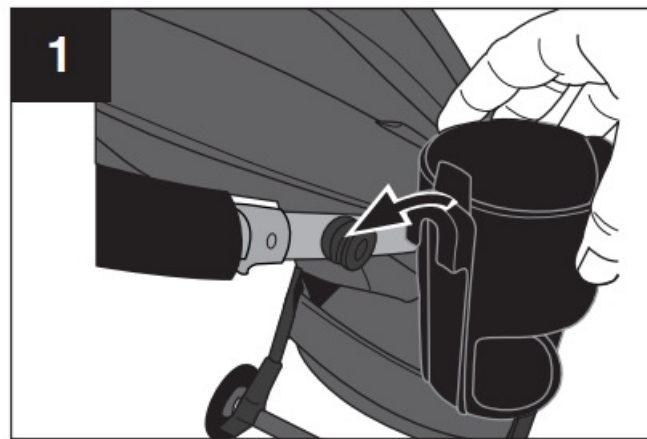

To remove cupholder, press tab towards center and slide up as shown.

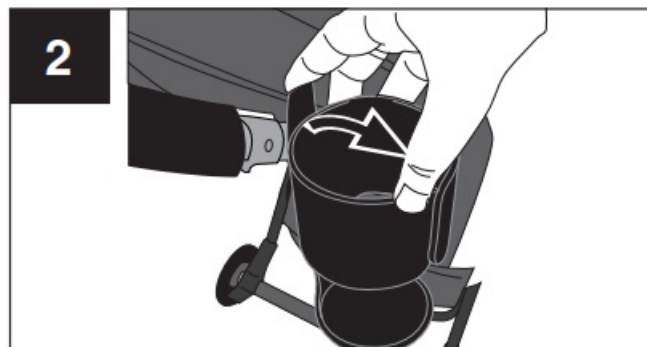

Using Your Stroller – Footrest

To adjust footrest, push both buttons on footrest and adjust up or down to the desired position.

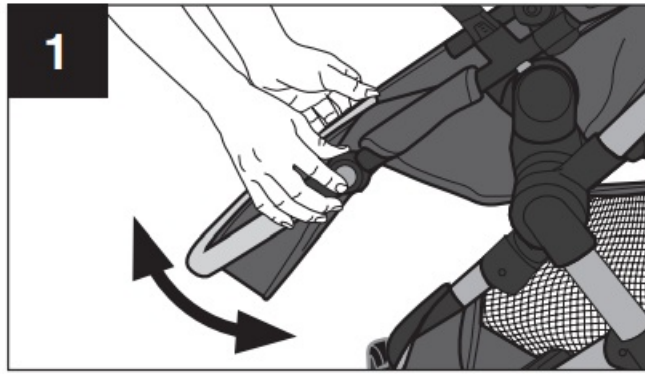

Using Your Stroller – Parent's Handle

To adjust the Parent Handle, press the Parent Handle release button.

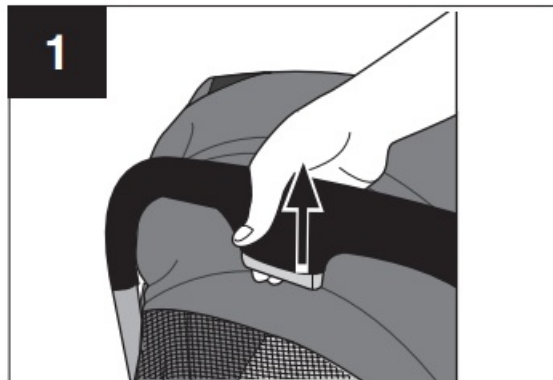

Lift or lower the Parent Handle to the desired height.

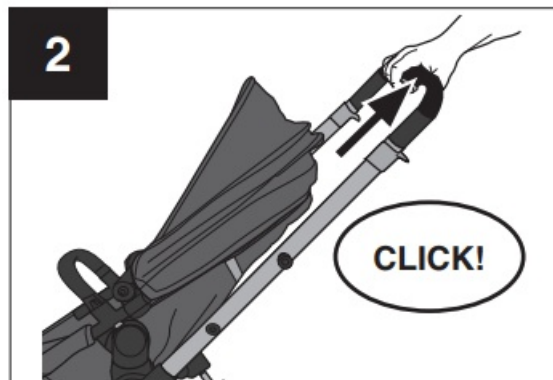

Using Your Stroller – Canopy

To open or close canopy, push to the front or the rear of the stroller as shown.
Canopy has a window that can be pulled back so you can view child in Toddler Seat Mode.

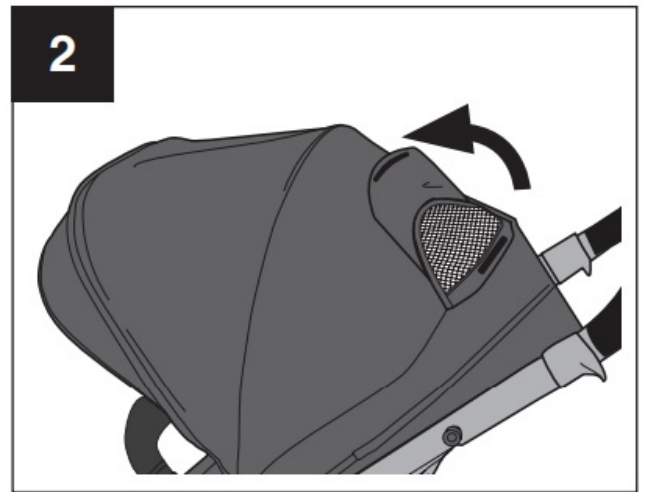
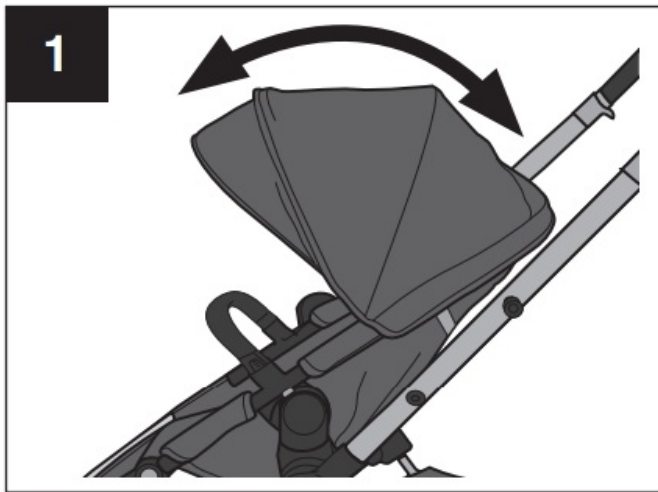

To remove canopy, unfasten canopy mounts from sides of toddler seat as shown.
 To re-attach canopy, reconnect canopy mounts to desired height on toddler seat.
NOTE: There are 3 canopy positions on the toddler seat.
 Move the canopy up as your child grows for comfortable coverage.

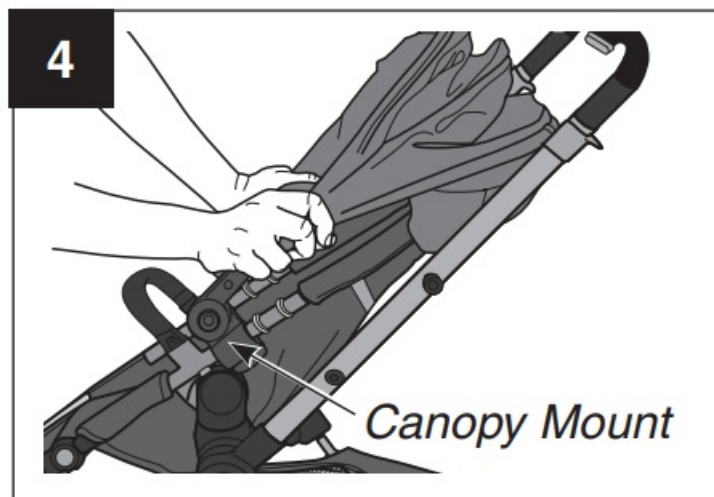
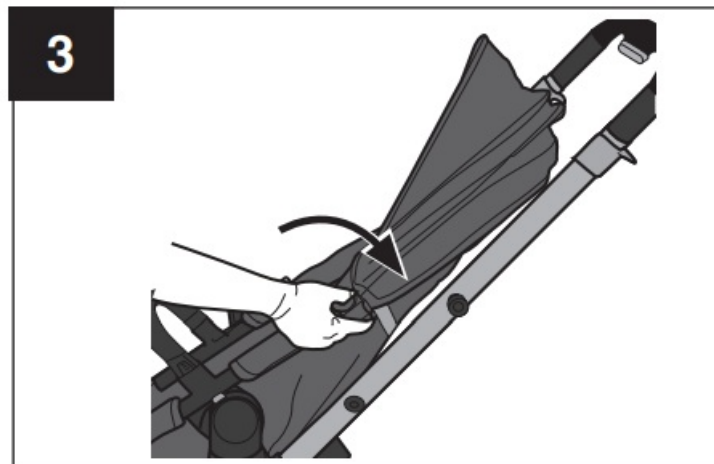

Using Your Stroller – Harness



WARNING!

DEATH or SERIOUS INJURY can occur.

To avoid serious injury from falling or sliding out, **ALWAYS** use waist restraint.

NOTE: Verify the stroller is locked in the open position by pushing down on the parent's handle.
Lock the rear brakes and remove the bumper bar.
The harness shoulder straps G must be at shoulder height or lower, closest to the baby's shoulders H.

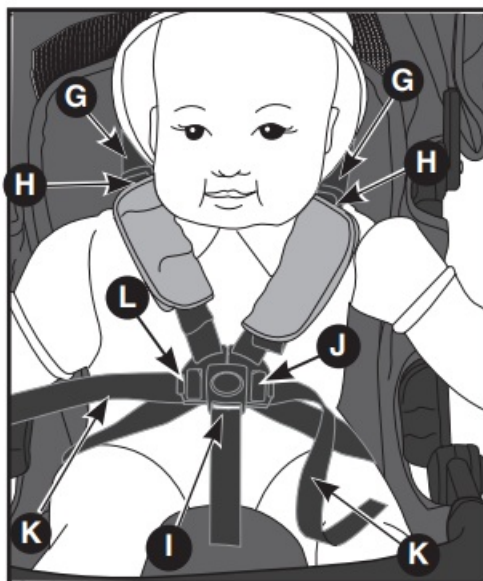

Place the baby in the seat and bring the crotch panel I up between the child's legs. Fasten each buckle J. For a snug, comfortable fit, pull the shoulder straps G to tighten the shoulder restraint and pull the waist restraint straps K to tighten the waist restraint.

NOTE: To loosen the waist straps K, push in the release button L on the buckle and pull.

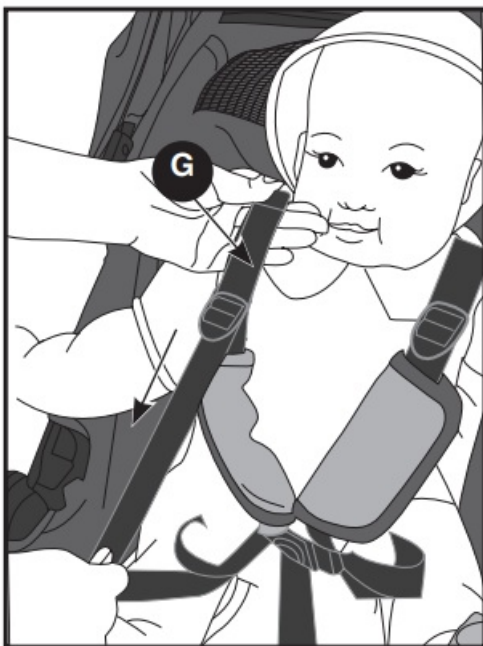

To loosen shoulder straps push up on the retainer M while pulling down on the shoulder strap.
Once the child is properly restrained, re-attach the bumper bar.
Make sure the bumper bar locks into position with audible clicks.
Pull on the bumper bar to make sure it is locked into place.

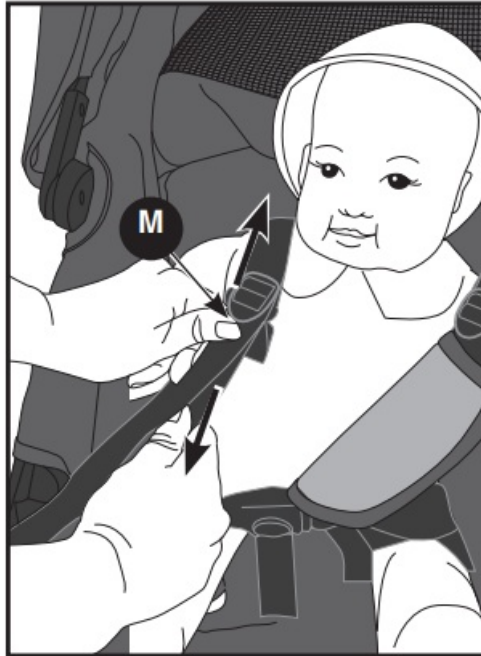

Using Your Stroller – Harness

To change from 5-point to 3-point harness:

Unlock the Harness: Depress button N as shown. Remove harness shoulder strap G from each buckle J as shown.

Store shoulder harness straps for future use.

3-Point Harness

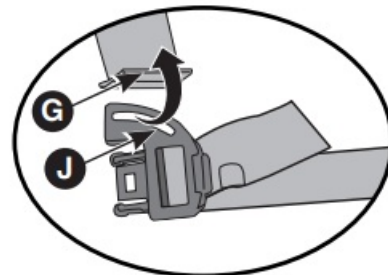
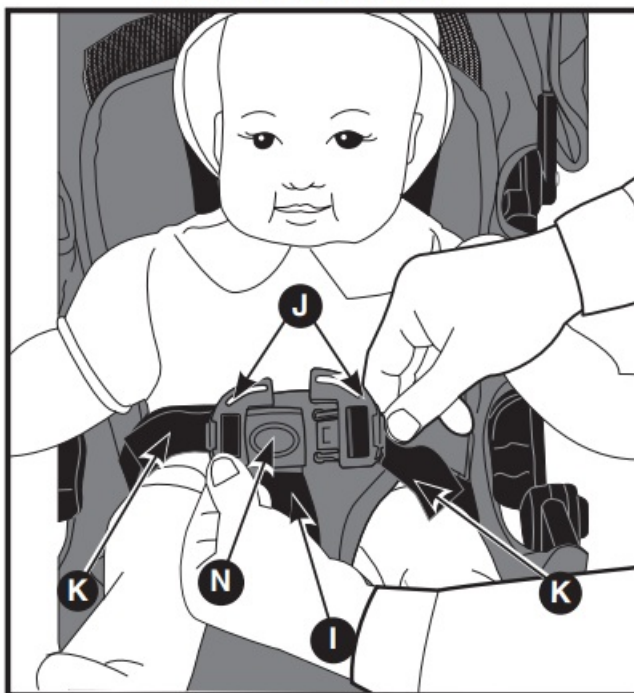

Using Your Stroller – Brakes



WARNING!

DEATH or SERIOUS INJURY can occur.

ALWAYS lock brakes. Make sure brakes are on by trying to push the stroller.

To lock, press brake lever DOWN at bottom of brake as shown.

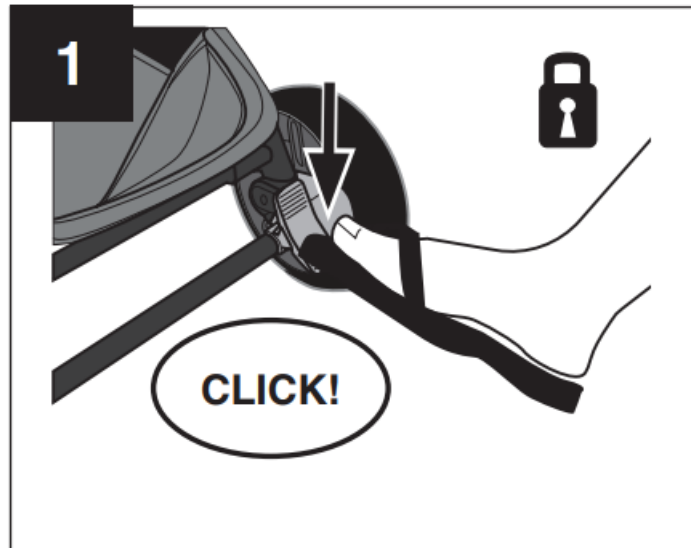

To unlock, push lever DOWN at top of brake as shown.

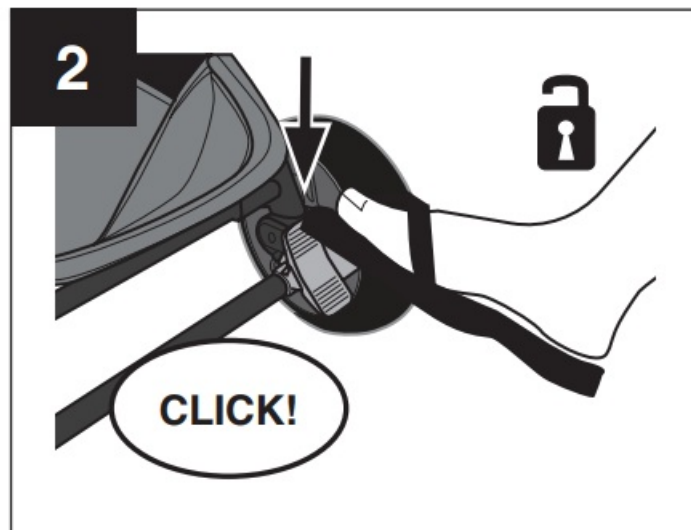

Using Your Stroller – Folding Stroller



WARNING!

DEATH or SERIOUS INJURY can occur.

Care must be taken when folding or unfolding stroller to prevent finger injury in hinge areas.

NOTE: Stroller will not fold when toddler seat is parent-facing.

To fold the stroller, remove your child, adjust seat back to upright position, lock the rear brakes, and close the canopy.

Make sure parent handle is down to lowest position (see pg. 17).

Pull the levers on both sides of the stroller and lower frame until the side frame lock clicks into place. Double check side frame lock is securely closed.



In order for stroller to stand when folded, make sure the front wheels are facing forward.



For more compact fold, fold footrest down and place toddler seat in upper seat mount position (pg. 24). You can also remove the toddler seat before folding the stroller frame.

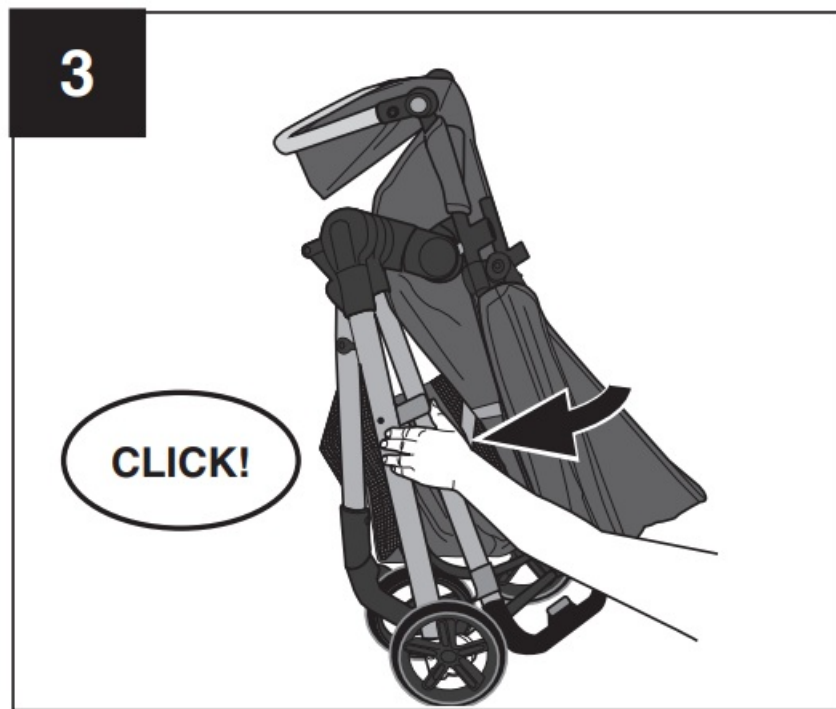

NEVER fold the stroller when the toddler seat is in Carriage Mode.
To unfold stroller, see pg. 10.

Using your Stroller with the Recommended Infant Car Seats



WARNING! DEATH or SERIOUS INJURY can occur.

- Only use Evenfall SoftMax™ or any version of the Lisema™ infant car seats with this stroller. Other infant car seats or carriers are not designed to fit the stroller frame and if used with this stroller may result in serious injury to your child.
- Before using the infant car seat with this stroller, read all the instructions provided with it and keep the instructions stored properly for future use.
- DO NOT lift stroller by using the infant car seat handle when installed on stroller.
- If unable to securely attach your infant car seat to this stroller, remove the car seat and contact Evenfall Parent Link at 1-800-233-5921 (USA), 1-937-773-3971 (Canada), or 800-706-1200 (México).
- To avoid serious injury, make sure the infant car seat is securely snapped onto the car seat mounts.
- Some Evenfall SoftMax™ and Lisema™ infant car seats have a blanket/boot option that must be removed for proper attachment to this stroller.

To remove the toddler seat, press the release buttons down on both sides of the toddler seat and lift seat off stroller frame.

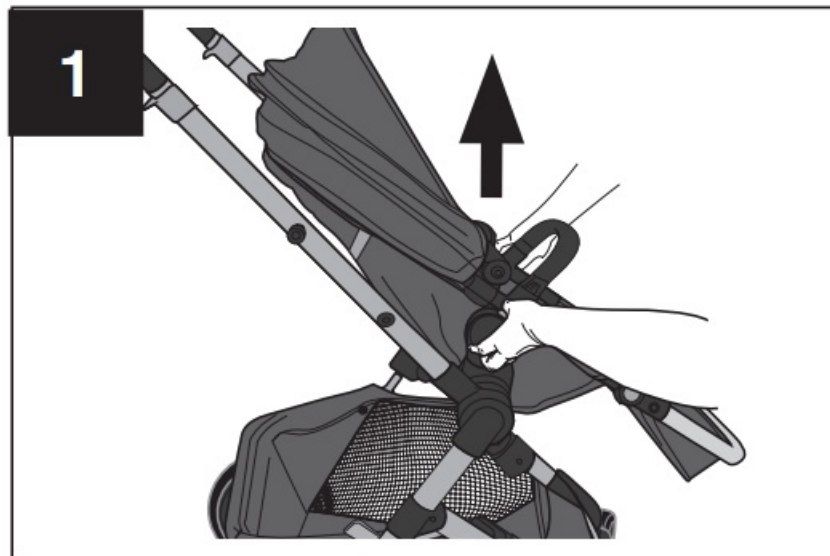

To attach car seat, insert car seat into the mounts until they both click into place on both sides of the frame.

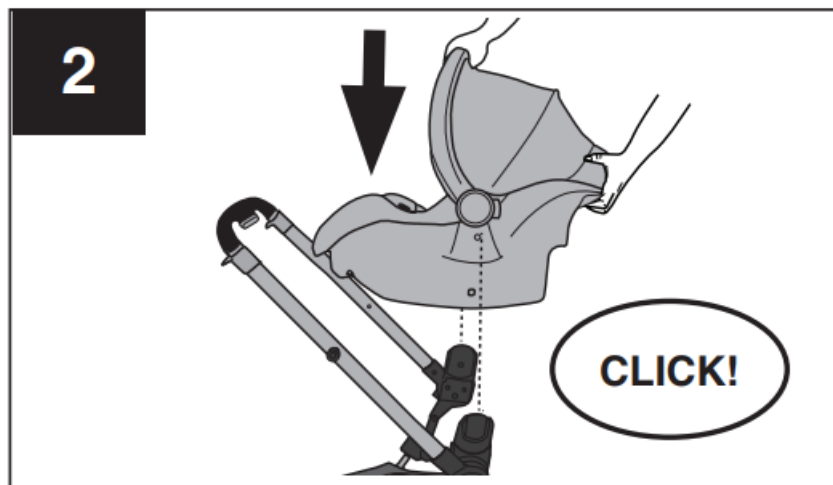

Using your Stroller with the Recommended Infant Car Seats

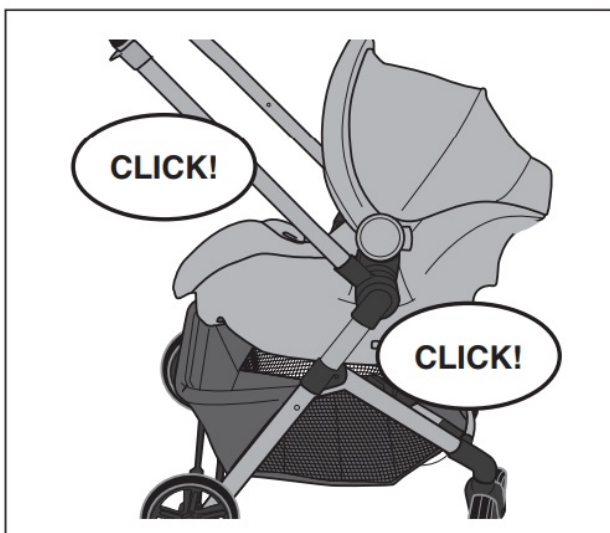

OR

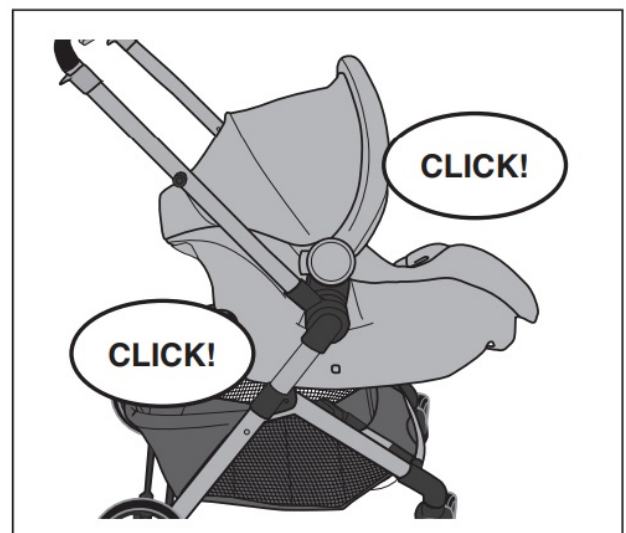

NOTE: The infant car seat may be installed parent-facing or forward-facing on the stroller frame.

Pull up on the front and back of the infant car seat to test that it is properly locked into place.

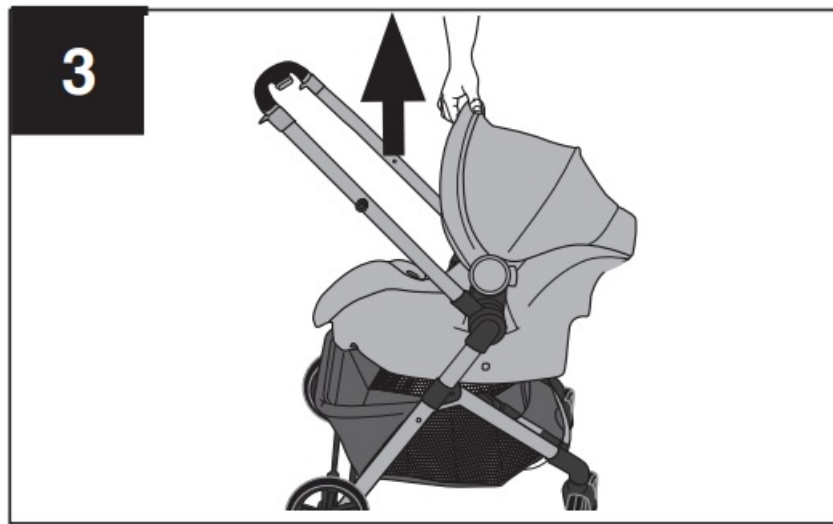

To remove infant car seat, lock brakes, squeeze handle on rear of seat and pull car seat up off of the stroller.

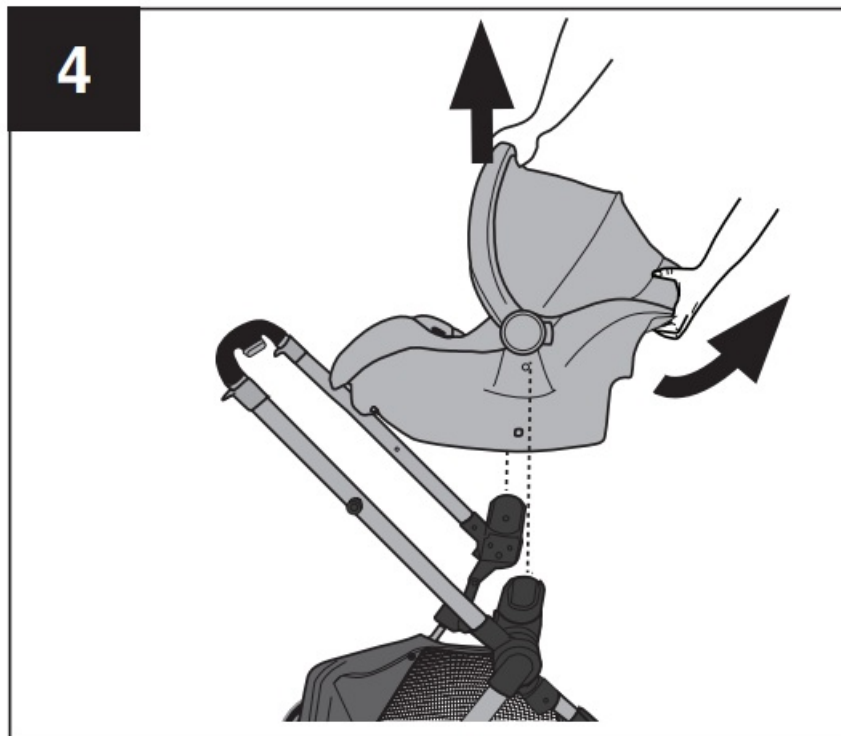

Using Your Stroller as a Double Stroller

! WARNING! DEATH or SERIOUS INJURY can occur.

- Only use Evenfall Sarema™ or any version of the Lisema™ infant car seats with this stroller. Other infant car seats or carriers are not designed to fit the stroller frame and if used with this stroller may result in serious injury to your child.
- Before using the infant car seat with this stroller, read all the instructions provided with it and keep the instructions stored properly for future use.
- DO NOT lift stroller by using the infant car seat handle when installed on stroller.
- If unable to securely attach your infant car seat to this stroller, remove the car seat and contact Evenfall Parent Link at 1-800-233-5921 (USA), 1-937-773-3971 (Canada), or 800-706-1200 (México).
- To avoid serious injury, make sure the infant car seat is securely snapped onto the car seat mounts.

- Some Evenfall Sarema™ and Lite ax™ infant car seats have a blanket/boot option that must be removed for proper attachment to this stroller.

TO SET UP AS A DOUBLE STROLLER, lock brakes then set up the lower seat mount position by squeezing the button. While squeezing lower seat mount release button in, pull up, then push tube away from you. This will rotate the mounts forward into position until the tube clicks into place, as shown.

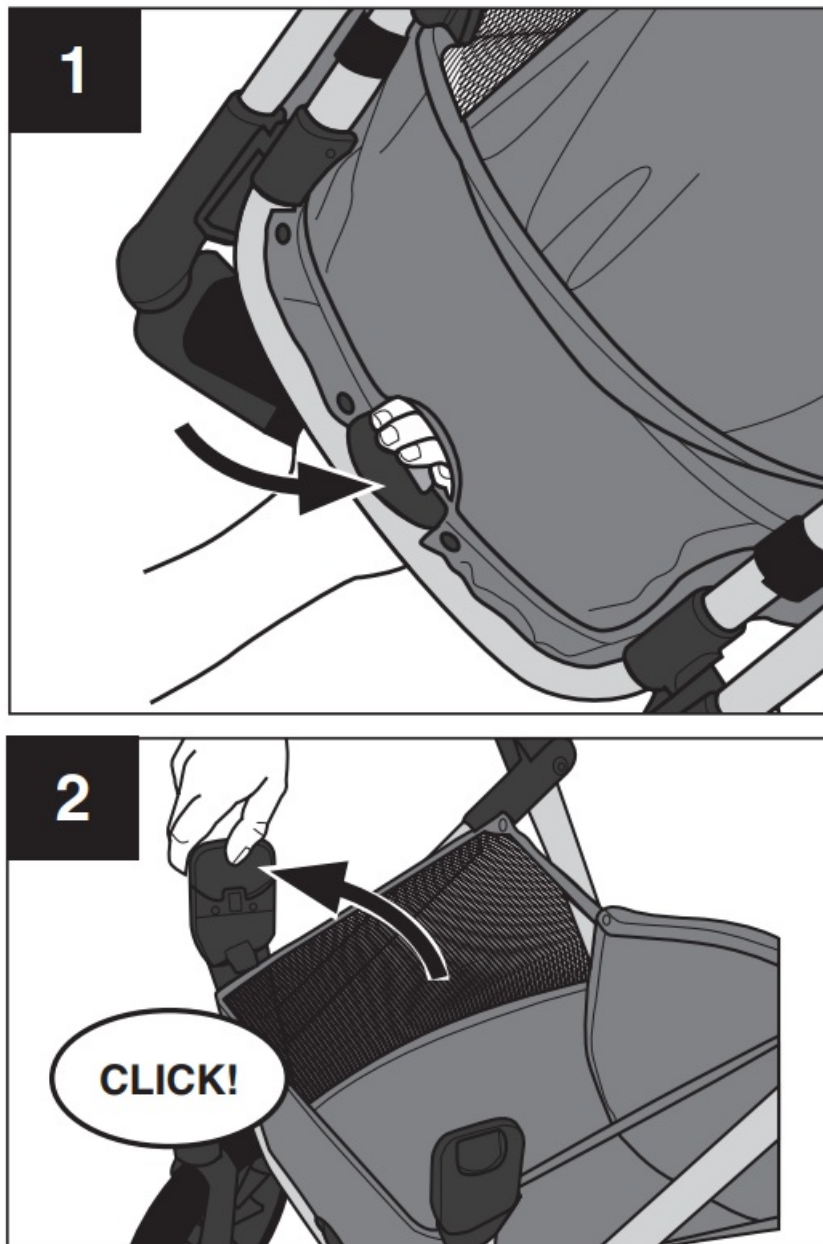

NOTE: You must squeeze the button first before pulling up. If the button gets stuck, press the mounts down so button clicks out and start again.

Using Your Stroller as a Double Stroller

There are 2 seating mount positions:

- Single seat mount position
- Upper seat mount position

Once the lower seat mounts are set up into position (pg. 23) press the button on single seat mounts and slide them up into the upper mount position to allow for room to place a car seat or toddler seat in the lower mount position.

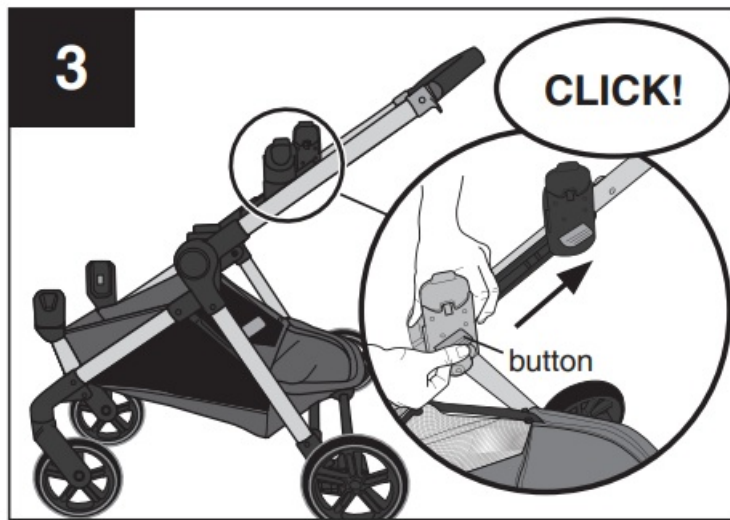

Double check mounts are locked into position by pushing them up or down on the slide track before placing either the car seat or toddler seat onto the stroller.

To attach toddler seat, slide seat onto the lower seat mounts until they click into place. LIFT UP on seat to make sure it is securely attached to the mounts.

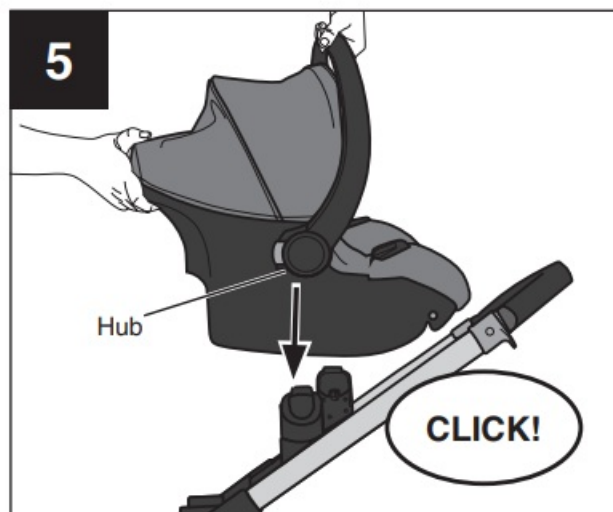

NOTE: You will need to attach either the car seat or toddler seat onto the lower seat mount before attaching your other accessory onto the upper mount position.

To attach infant car seat to the upper mount position, line up hub of handle with the seat mounts. Insert the car seat into the mounts until they click into place on both sides of the frame.



LIFT UP on the car seat to make sure that it is securely attached.
Your double stroller mode is now ready to use.

Using Your Stroller as a Double Stroller



WARNING!

DEATH or SERIOUS INJURY can occur.

Care must be taken when folding or unfolding stroller to prevent finger injury in hinge areas.
To avoid tipping, always remove heavier weight child before removing the lighter weight child.

To fold the stroller from double stroller mode, lock brakes, then remove the toddler seat or infant car seat from the lower seat mount.

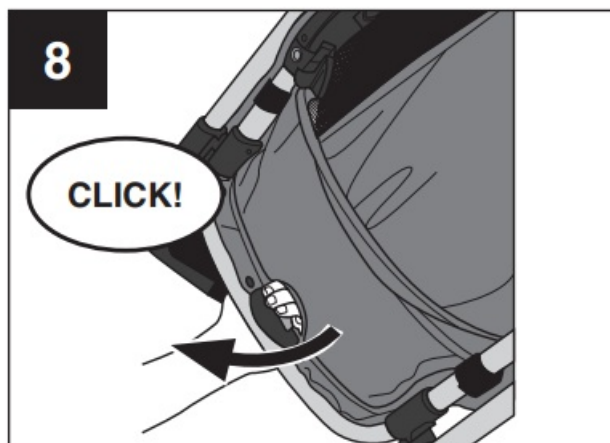
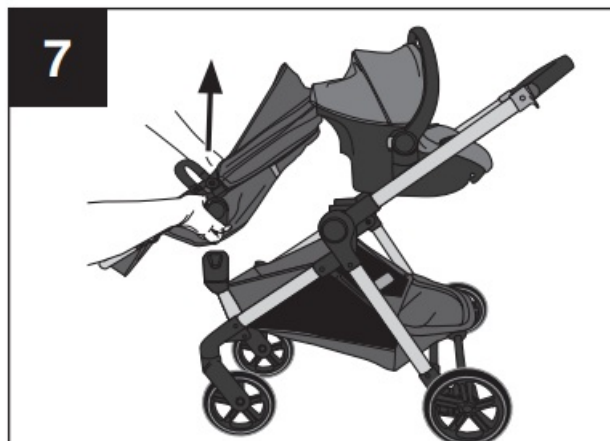

While squeezing lower seat mount release button in, pull tube up. This will rotate the mounts back into position until the tube clicks into place, as shown.

If using the infant car seat in the upper seat mount, remove infant car seat and replace with toddler seat forward facing until it clicks into place. LIFT UP on the toddler seat to make sure it is securely attached.

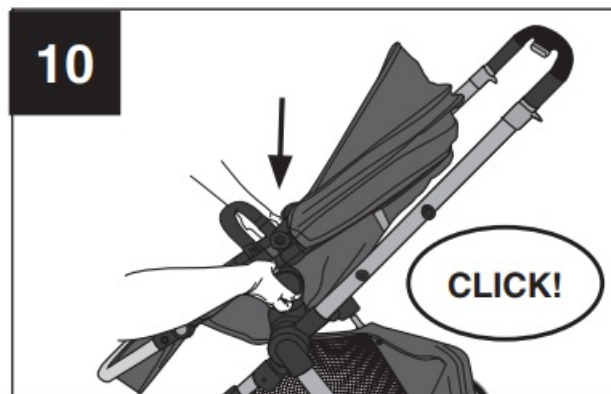
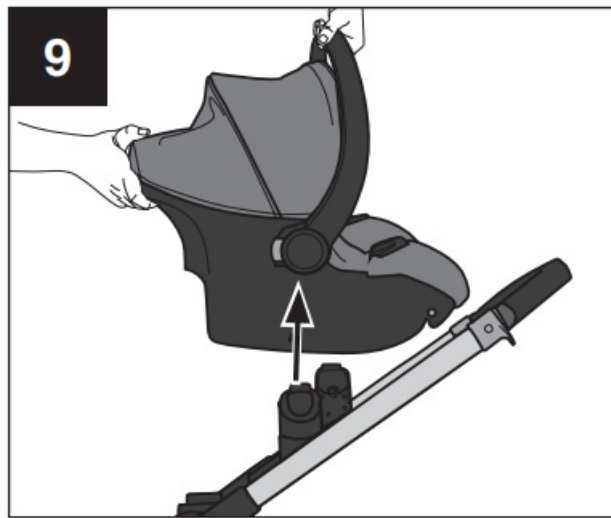

NOTE: Toddler seat **MUST** be upright and forward facing. Stroller will not fold when toddler seat is parent-facing. **NEVER** fold the stroller when the toddler seat is in Carriage Mode. The toddler seat can be folded with the stroller in single seat or upper seat mount positions. To fold as single stroller, see pg. 20.

Pivot Xpand Use Configurations

! WARNING! DEATH or SERIOUS INJURY can occur.

- To avoid tipping, always remove the heavier weight child from a seating position before removing the lighter weight child.
- To avoid serious injury, **NEVER** use the stroller in any other configuration other than what is shown in this instruction manual.

This stroller can be used in multiple configurations both as a single and double stroller.

- **DO NOT** exceed the maximum weight limits defined in the infant car seat or accessory manuals.
- For additional use configurations with optional accessories, you can refer to the manuals that are provided with the Pivot Expand Accessories (sold separately). These include but are not limited to: infant car seat adapters for other manufacturer's cars eats, a Rider Board and a Second Toddler Seat option.



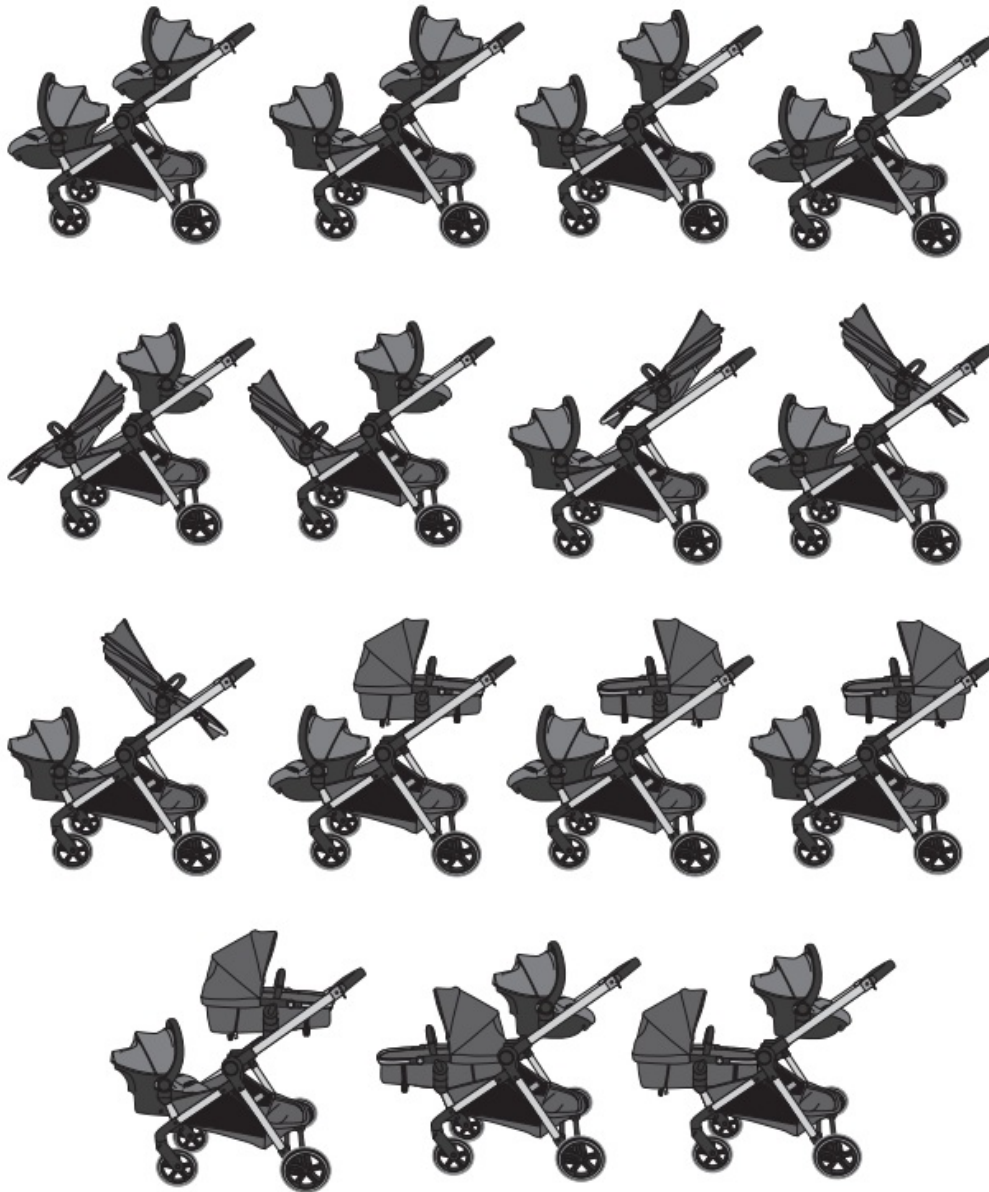

Care and Maintenance

- Clean minor spills and stains on cloth or plastic surfaces with cold water and mild soap. Air dry.
- Metal and plastic parts can be wiped clean with a soft damp cloth and dried with a soft cloth. DO NOT use abrasive cleaners or solvents.

Limited Warranty

For a period of 90 days from the original purchase of this Product, Evenflo warrants to the original end user ("Purchaser") this Product (including any accessories) against defects in material or workmanship. Evenflo's sole obligation under this express limited warranty shall be, at Evenflo's option, to repair or replace any Product that is determined to be defective by Evenflo and determined to be covered by this warranty.

Repair or replacement as provided under this warranty is the exclusive remedy of the Purchaser. Proof of purchase in the form of a receipted invoice or bill of sale evidencing that the Product is within the warranty period must be presented to obtain warranty service. This express limited warranty is extended by Evenflo ONLY to the original Purchaser of the Product and is not assignable or transferable to subsequent purchasers or end users of the Product. For warranty service, contact Evenflo's ParentLink Consumer Resource Center at 1-800-233-5921 or www.evenflo.com.

EXCEPT TO THE EXTENT PROHIBITED BY APPLICABLE LAW, ANY IMPLIED WARRANTY OF MERCHANTABILITY OR FITNESS FOR A PARTICULAR PURPOSE ON THIS PRODUCT IS HEREBY

DISCLAIMED. EVENFLO SHALL NOT BE LIABLE FOR ANY INCIDENTAL, CONSEQUENTIAL, SPECIAL OR PUNITIVE DAMAGES OF ANY KIND FOR BREACH OF THE EXPRESS LIMITED WARRANTY ON THIS PRODUCT, OR ANY WARRANTY IMPLIED BY OPERATION OF LAW. OTHER THAN THE EXPRESS LIMITED WARRANTY SET FORTH ABOVE, THERE ARE NO OTHER WARRANTIES THAT ACCOMPANY THIS PRODUCT AND ANY ORAL, WRITTEN OR ANY OTHER EXPRESS REPRESENTATION OF ANY KIND IS HEREBY DISCLAIMED.

ParentLink®
answers. advice. affirmation.™
www.evenflo.com
USA: 1-800-233-5921 8 AM – 5 PM E.T.
Canada: 1-937-773-3971
México: 800-706-1200

Documents / Resources

 <p>evenflo PIVOT XPAND Stroller/Travel System Poussette/Système de déplacement</p> <p>STROLLER Up to 55 lb (25 kg) Up to 45 in (115 cm)</p> <p>POURBETTE jusqu'à 55 lb (25 kg) Jusqu'à 115 cm (45 po)</p> <p><small>Read all instructions carefully and follow them exactly. Read all instructions and follow them exactly. Consult the instructions for the car seat and stroller. Consult the instructions for the car seat and stroller. © 2018 Evenflo Company, Inc. 10011100 10011100</small></p>	<p>Evenflo Pivot Xpand Modular Stroller [pdf] User Manual Pivot Xpand Modular Stroller, Pivot Xpand, Modular Stroller, Stroller</p>
--	---

References

- [🔗 Car Seats, Strollers, & Baby Essentials | Evenflo® Official Site](#)
- [🔗 Evenflo® Product Registration | Evenflo® Official Site](#)