



evenflo Pivot Suite Stroller or Travel System Instruction Manual

[Home](#) » [evenflo](#) » evenflo Pivot Suite Stroller or Travel System Instruction Manual 

Contents

- [1 evenflo Pivot Suite Stroller or Travel System](#)
- [2 Product Information](#)
- [3 Product Usage Instructions](#)
- [4 Features](#)
- [5 WARNINGS AND INSTRUCTIONS](#)
- [6 Important Information](#)
- [7 Identification of Parts](#)
- [8 Choosing Mode of Use](#)
- [9 Assembling](#)
- [10 Using Your Stroller](#)
- [11 Using your Stroller with the Recommended Infant Car Seats](#)
- [12 Care and Maintenance](#)
- [13 Limited Warranty](#)
- [14 Documents / Resources](#)
 - [14.1 References](#)
- [15 Related Posts](#)



evenflo Pivot Suite Stroller or Travel System



Product Information

The Evenflo Stroller is a baby stroller that can hold up to 55 lbs (25 kg) and up to 45 in (114.3 cm). It is compatible with Evenflo SafeMax™ or LiteMax™ Infant Car Seats only. The stroller has various features such as a canopy, parent handle, fold release lever, cupholder, toddler seat release button, rotating seat mount, swivel wheel, lower seat fold button, footrest, harness buckle, harness cover, bumper bar, shoulder straps, canopy window, upper seat fold button, multi-position recline handle and strap, side frame lock, suspension, storage basket, and brakes.

Product Usage Instructions

Before assembling and using the Evenflo Stroller, it is important to read all the instructions provided in the user manual. Keep the instructions for future use. To assemble the stroller frame, follow the below steps:

1. To protect flooring, place a protective covering (carton) beneath the stroller during assembly.
2. Unlatch the side frame lock and continue holding the lock open while unfolding the stroller.
3. Grab the parent's handle and pull upward until the stroller opens fully with an audible click.

The stroller seat can be used in two different modes- Toddler Seat Mode or Carriage Mode. The stroller seat is shipped in carriage mode with the buckles unfastened under the footrest of the toddler seat. To set up your stroller in your preferred mode of use, follow the instructions provided on pages 12 – 16 of the user manual.

It is important to follow all warnings and instructions provided in the user manual to prevent serious injury or death. Record the model number and date of manufacture provided on one of the rear stroller legs for future reference. Register the product either by mailing the card that came with it or by visiting the online registration at www.evenflo.com/registerproduct.

Features

Holds Evenflo SafeMax™ or LiteMax™ Infant Car Seats Only:

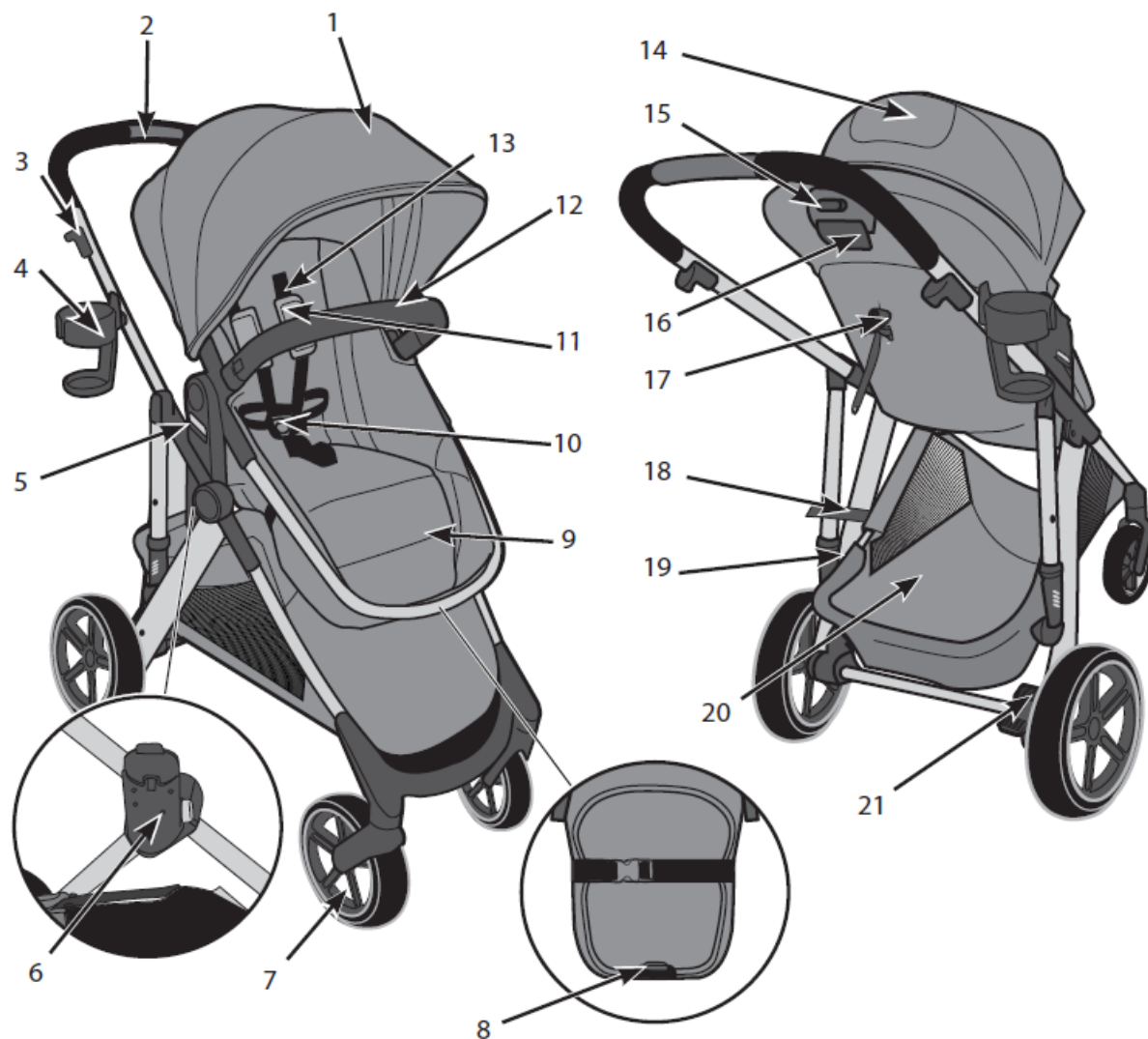

1. Canopy
2. Parent Handle
3. Fold Release Lever
4. Cupholder
5. Toddler Seat Release Button
6. Rotating Seat Mount
7. Swivel Wheel
8. Lower Seat Fold Button
9. Footrest
10. Harness Buckle
11. Harness Cover
12. Bumper Bar
13. Shoulder Straps
14. Canopy Window
15. Upper Seat Fold Button
16. Multi-Position Recline Handle
17. Multi-Position Recline Strap
18. Side Frame Lock
19. Suspension

20. Storage Basket

21. Brakes

WARNINGS AND INSTRUCTIONS

READ AND FOLLOW ALL WARNINGS AND INSTRUCTIONS! FAILURE TO DO SO COULD RESULT IN SERIOUS INJURY OR DEATH!

- Only use Evenflo SafeMax™ and LiteMax™ infant car seats with this stroller. Other infant car seats or carriers are not designed to fit the stroller frame unless specified in the instructions. Any car seats used with this stroller that are not specified in the instructions may result in serious injury to your child.
- NEVER leave child unattended. ALWAYS keep child in view while in the stroller.
- Adult assembly required. Take care when unpacking and assembling; contains small parts and some items with sharp edges.
- To prevent a possible choking hazard, remove and discard packing material before using this product.
- To avoid serious injury from child falling or slipping out of stroller, ALWAYS use the waist restraint in Toddler Seat Mode and Carriage Mode.
- DO NOT carry or roll stroller on stairs or escalators with child in it.
- DO NOT hang items on handle bar or place them on the canopy as they can tip stroller over and injure child.
- Be sure stroller is fully assembled and locked in unfolded position before using.
- ALWAYS exercise care when going over curbs or steps, and never use stroller for anything other than transporting your child. Push stroller at a normal walking pace only; faster strolling can cause a loss of control and injury to the child.

DO NOT place hot liquids in cup holder. Spills can burn you or your child.

- To avoid serious injury from child falling out of stroller, DO NOT raise or recline seat with child in stroller.
- DO NOT use stroller if any parts are missing or broken.
- DO NOT allow child to climb on, into, out of, or around stroller.
- DO NOT allow child to stand on the footrest. Stroller may tip over and injure child.
- DO NOT carry additional children, goods, or accessories in or on this stroller except as advised in these instructions. The stroller is intended for use with one child and to accommodate only the additional weights in storage as listed in these instructions.
- Care must be taken when folding or unfolding stroller to prevent finger injury to you or your child in hinge areas. Make sure child is not in the seat or near the stroller when folding or unfolding.
- NEVER leave stroller on a hill or incline, even with brakes set. Stroller may tip, injuring the child.
- To avoid accidental rolling, ALWAYS set brakes when stroller is not being pushed.
- AVOID STRANGULATION:
 - DO NOT suspend strings or toys from the canopy.
 - DO NOT place stroller anywhere near cords from window blinds, draperies, phone, etc.
 - DO NOT place items with a string around your child's neck such as hood strings or pacifier cords.
 - If not properly secured, the child may slip into leg openings and strangle.
- When making adjustments to the stroller, ALWAYS ensure that all parts of the child's body are clear of any moving parts of the stroller.
- The canopy is not intended to provide UV protection.
- Sharp or heavy objects placed in pockets may cause damage to the stroller, or injury to the child.

- To ensure safety for your baby, please refer to the manufacturer's instructions for the use of your recommended infant car seats and keep all instructions available for reference.
- DO NOT lift stroller by using the infant car seat handle when installed on stroller.
- If unable to securely attach the infant car seat to this stroller, remove the car seat and contact Evenflo ParentLink at 1-800-233-5921 (USA), 1-937-773-3971 (Canada), or 800-706-1200 (México).
- To avoid stroller instability and tip-overs, DO NOT load cup holder with over 1 lb (0.45 kg), and the main cargo basket with over 10 lbs (4.5 kg).
- NEVER use the toddler seat without the canopy attached.
- NEVER lift or carry the toddler seat by the bumper bar.
- NEVER use the stroller frame without the toddler seat or car seat attached.
- NEVER use toddler seat in a motor vehicle or use it as a booster seat.
- To avoid falls, never remove toddler seat from the stroller with child in it.
- To avoid falls, always make sure the toddler seat or car seat is securely attached into the seat mounts on both sides of the stroller before placing child in the seat.
- When stroller is in carriage mode, it is intended for a child from birth up to 6 months of age OR who is incapable of sitting upright unassisted. ONLY use the stroller in the upright position with a child who is capable of sitting upright unassisted.
- NEVER use seat in the carriage mode position unless the straps under the seat are unbuckled and the seat is set up in Carriage Mode as per the instructions.
- DO NOT exceed the maximum weight limits defined in the infant car seat or accessory manuals.
- NEVER use harness covers that are included on your stroller seat in your infant car seat.

Important Information

Child Requirements – When stroller is in carriage mode, it is intended for a child up to 6 months of age OR who is incapable of sitting upright unassisted. Only use the stroller in the upright position with a child who is capable of sitting upright unassisted.

- **Maximum weight:** – 55 lbs (25 kg) in toddler seat
- **Maximum height:** – 45 inches (114.3 cm) in toddler seat

IMPORTANT: Read instructions carefully before use. Save these instructions for future reference. It is very important to assemble the stroller according to these instructions. If you are missing parts, do not use stroller and call Evenflo ParentLink at 1-800-233-5921 (U.S.A.), 1-937-773-3971 (Canada), or 800-706-1200 (México) to order replacement parts.

Registration Information

Please register this product so we can reach you if there is a safety alert or recall. We will not sell, rent, or share your personal information. To register your product, please complete and mail the card that came with it or visit our online registration at www.evenflo.com/registerproduct.

For future reference, record the Model Number and Date of Manufacture below. You can find this information on one of the rear stroller legs.

- **Model Number:** _____
- **Date of Manufacture:** _____

Identification of Parts



Front Wheel Assembly (2)

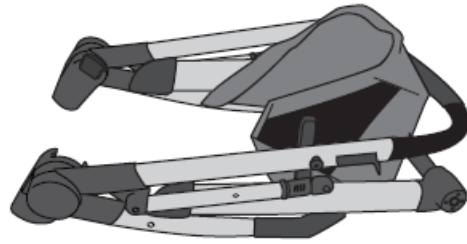

Frame



Rear Wheel (2)



Cupholder (1)



Bumper Bar

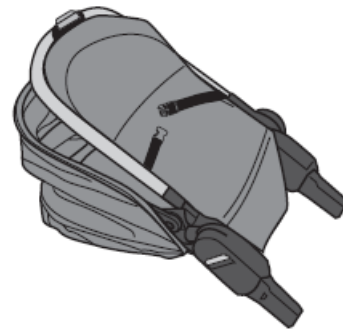

Toddler Seat



Basket Assembly
Bar

Choosing Mode of Use

YOUR STROLLER SEAT CAN BE USED IN TWO DIFFERENT MODES:

TODDLER SEAT MODE OR CARRIAGE MODE.

Your stroller seat is shipped in carriage mode with the buckles unfastened under the footrest of the toddler seat. You will need to follow the instructions completely to make sure you set up your stroller in your preferred mode of use. After the frame and the wheels have been assembled.

Toddler Seat Mode



Carriage Mode



Assembling

Your Stroller – Frame

WARNING Care must be taken when folding or unfolding stroller to prevent finger injury in hinge areas.

1. To protect flooring, place a protective covering (carton) beneath the stroller during assembly.

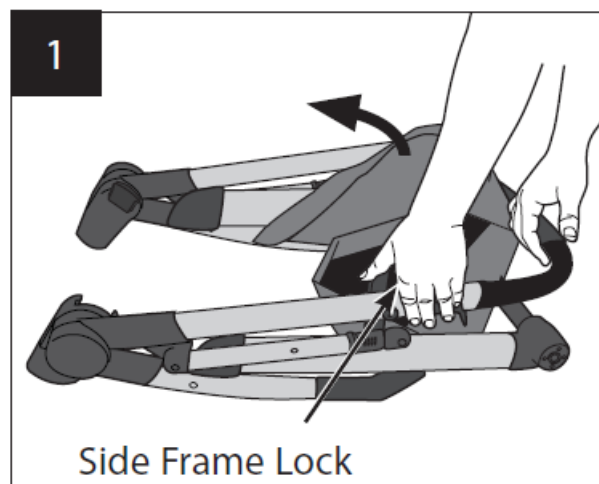

Unlatch side frame lock. Continue holding the lock open while unfolding the stroller.

2. Grab the parent's handle and pull upward until the stroller opens fully with an audible click.

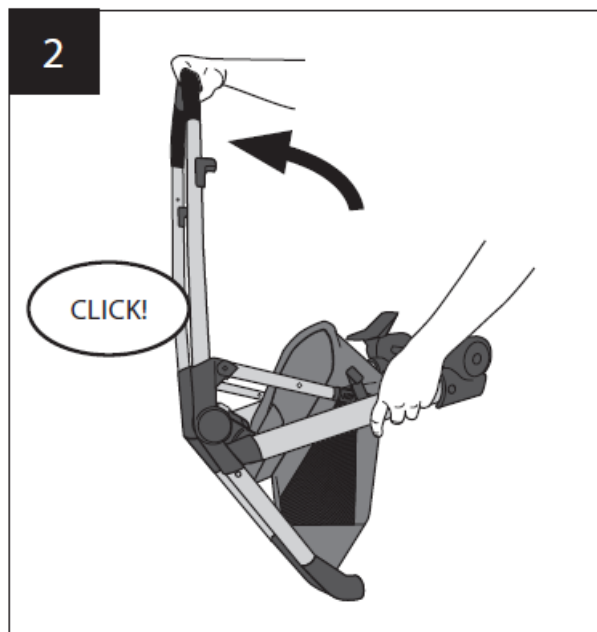

3. Make sure the stroller is locked in the open position by pushing down on the parent's handle.

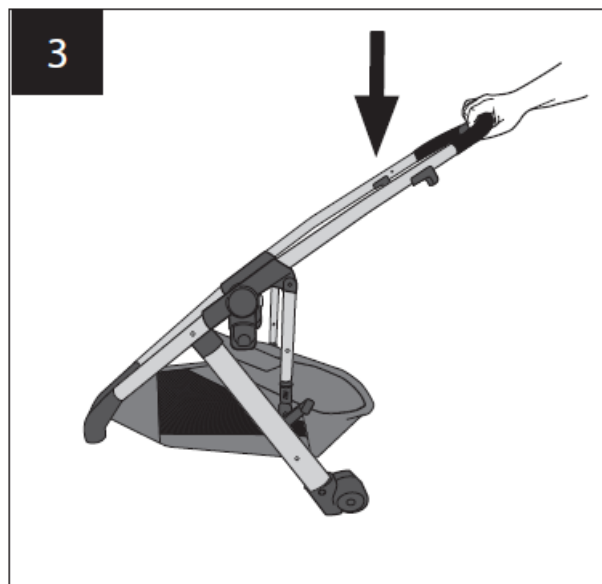

Your Stroller – Wheels

1. Turn the stroller so the front of the stroller is facing upwards as shown.

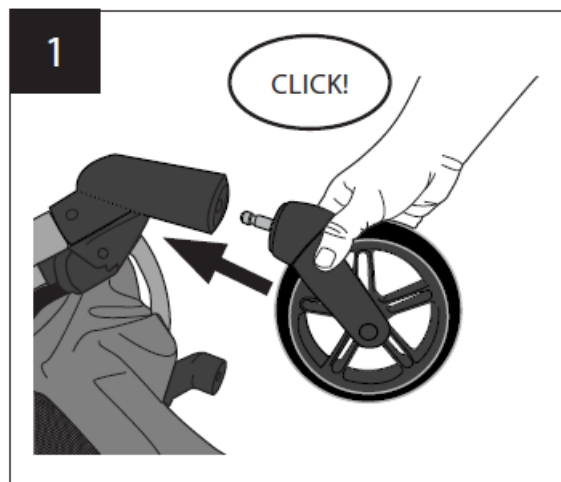

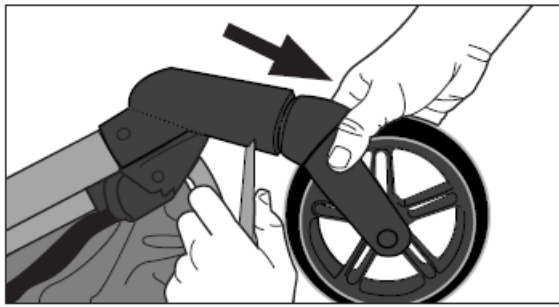

To attach front wheels, push wheel onto front leg tube until it clicks into place. Repeat on other side. Pull on wheels to make sure both of them are securely attached.

To remove front wheel, insert flat tool into slot and pull wheel off stroller.

2. Turn the stroller upside down as shown so the rear of the stroller is facing upwards.

To attach rear wheels, push wheel onto rear leg tube until it clicks into place. Repeat on other side. Pull on wheels to make sure both of them are securely attached.

To remove rear wheel, press button on stroller frame as shown and pull wheel off stroller.

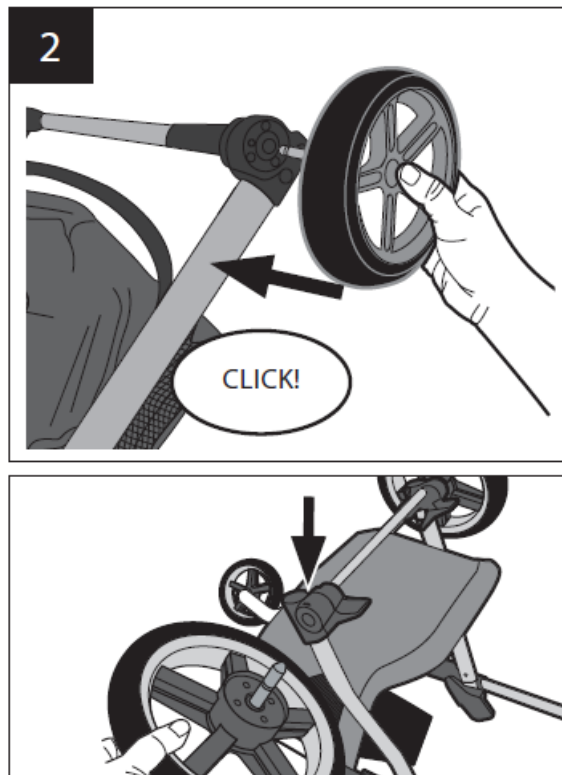

Your Stroller – Basket

1. To assemble basket, locate the basket assembly bar and ensure the push buttons are on the bottom. Press the buttons in, then push basket assembly bar onto frame until it clicks into place on both sides with an audible click.

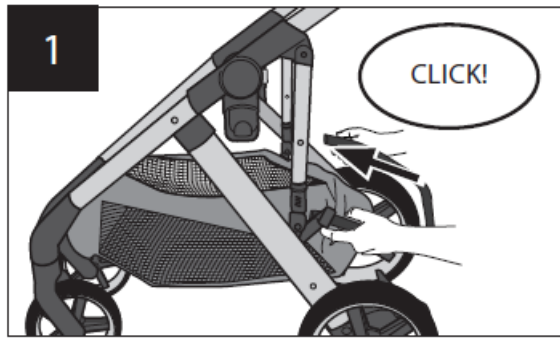

2. Once installed, pull on the basket assembly bar to make sure it is locked into place. Complete assembly by zipping basket fabric around basket assembly bar and attaching snap buttons on both sides of the stroller frame.

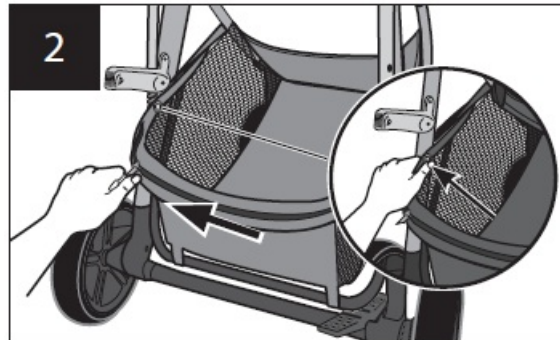

Your Stroller – Toddler Seat Mode

1. Fasten buckle behind leg rest of toddler seat.

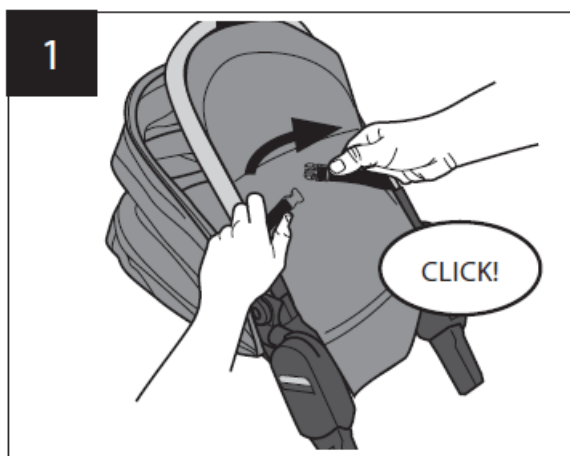

IMPORTANT: Keep seat folded out of package. The buckle **MUST** be fastened before placing child in the seating area.

2. With toddler seat folded, line up toddler seat towers with seat mounts on the stroller frame. Slide seat onto the mounts until it clicks into place on both sides of the frame.

The toddler seat may be attached forward-facing or parent-facing.

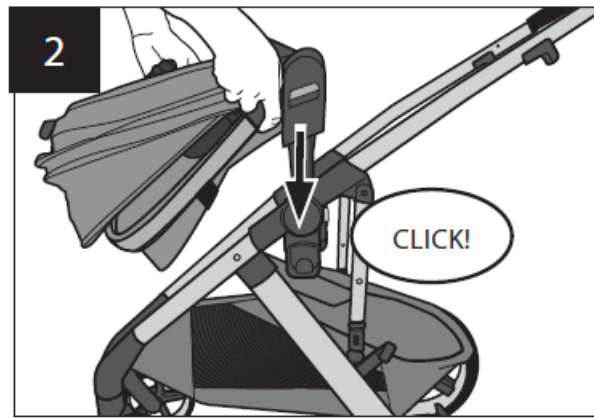

3. CHECK to make sure it is securely attached by pulling up on it.

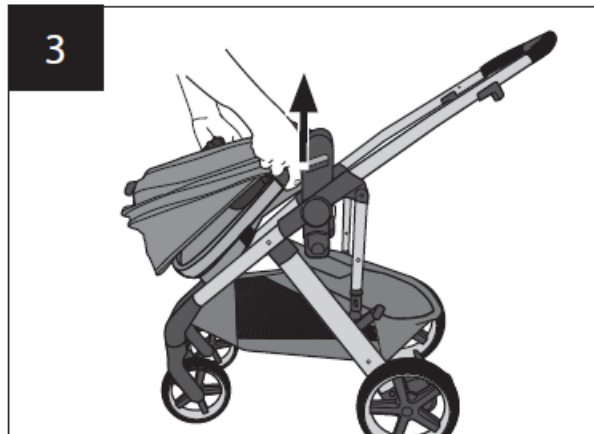

4. Continue to unfold toddler seat until it clicks into place.

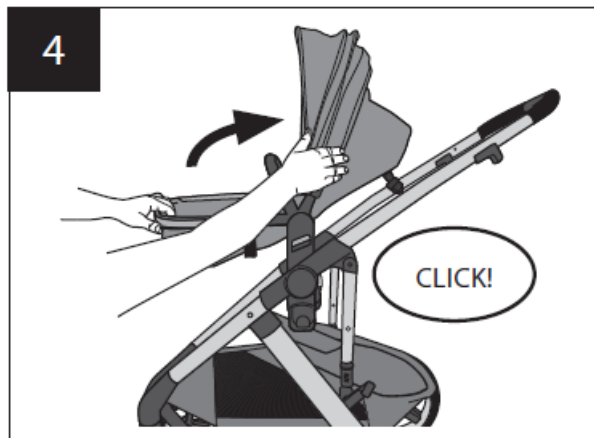

5. To recline toddler seat, lift multi-position recline handle at the top of the seat and rotate seat to the desired position.

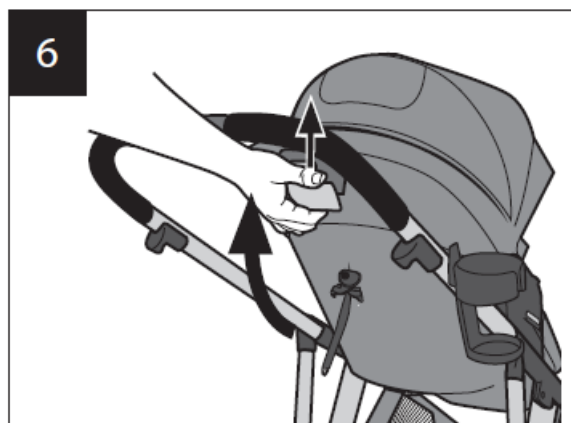

6. To attach bumper bar, push tabs into openings on stroller on both sides of frame until it clicks into place. Pull on the bumper bar to make sure it is locked into place.

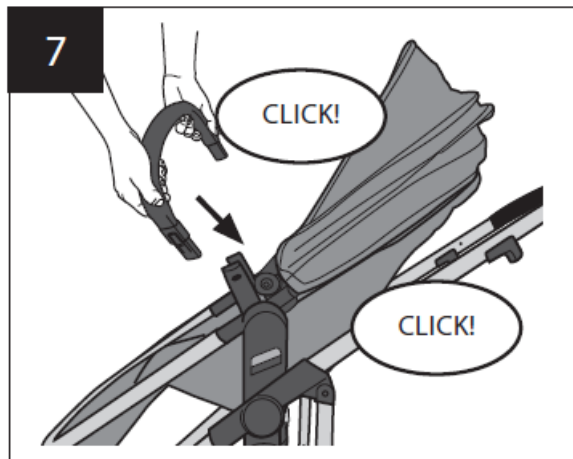

7. To remove the bumper bar, push both tabs and remove the bumper bar from the stroller.

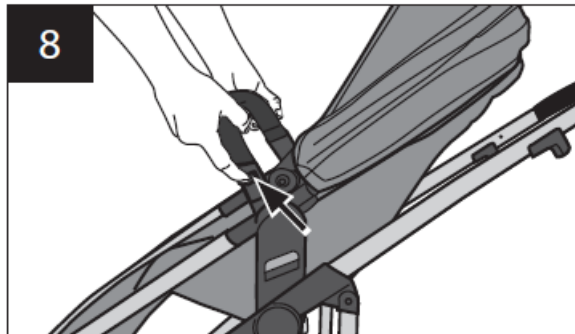

Using Your Stroller

Toddler Seat Mode to Carriage Mode

- NEVER use seat in a reclined carriage position unless straps under seat are unbuckled and seat is set up in Carriage Mode as per the instructions.
- NEVER lift or carry toddler seat by the bumper bar or with child in it. The toddler seat is not a carrier.
- ALWAYS use the waist restraint when the toddler seat is in Carriage Mode.
- To avoid falls, never remove toddler seat from the stroller with child in it.

1. If you are in Toddler Seat Mode as shown, follow these steps to convert to Carriage Mode.



2. Unfasten buckles behind leg rest of toddler seat. To recline seat, squeeze button and pull down on multi-position recline strap.

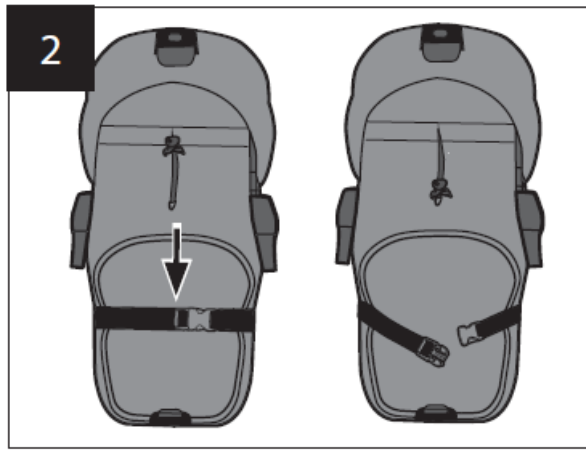

IMPORTANT: The buckles **MUST** be unfastened before placing child in the seating area.

3. Lift multi-position recline handle and rotate seat all the way down so that it is flat.



4. Press down on the inside of the toddler seat to flatten out the inside.

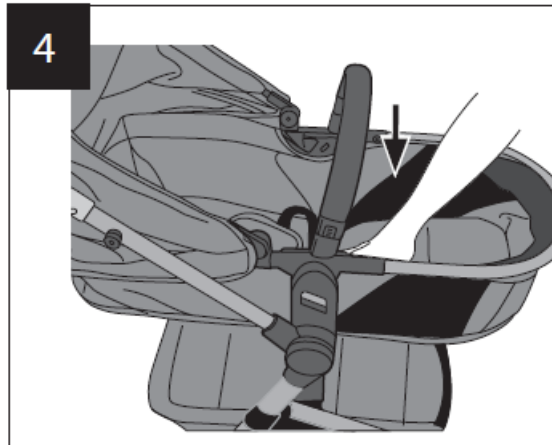

5. To remove and use in parent-facing mode: Press the release buttons on both sides of toddler seat, lift seat off stroller frame and turn it around and re-attach.

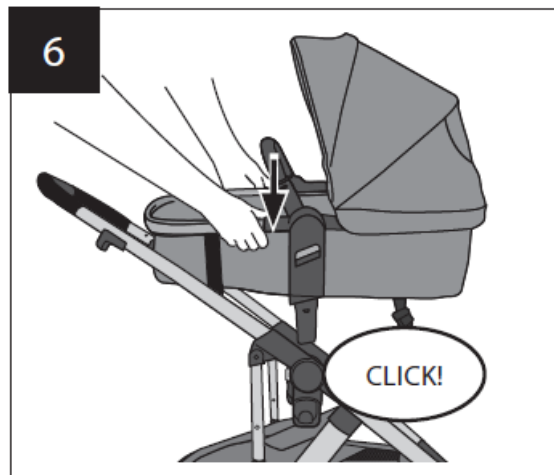
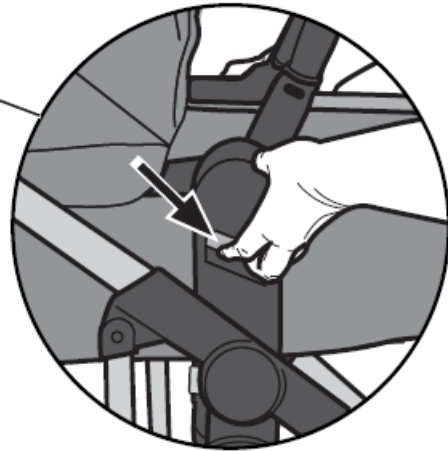
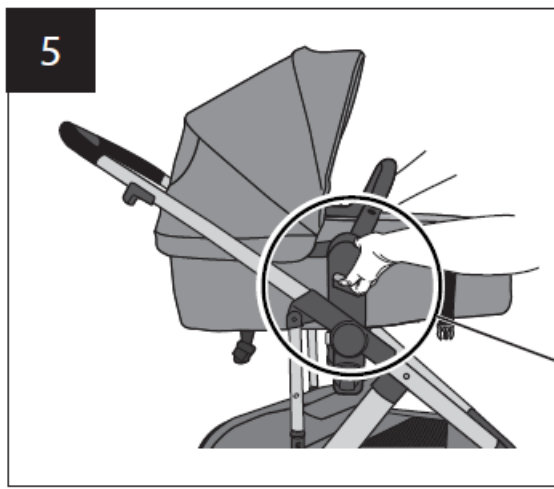

6. CHECK to make sure it is securely attached on both sides by pulling up on it.

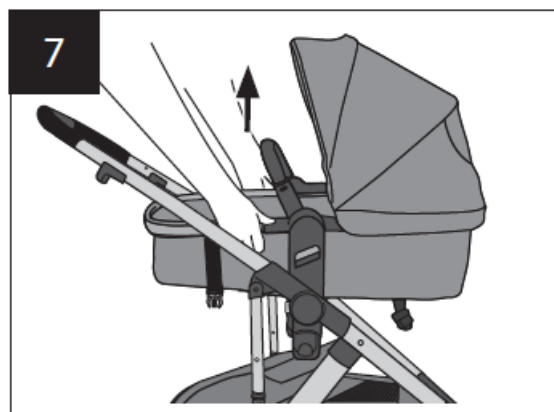

Cupholder

1. To attach cupholder, slide down on the mount on either side of stroller as shown.

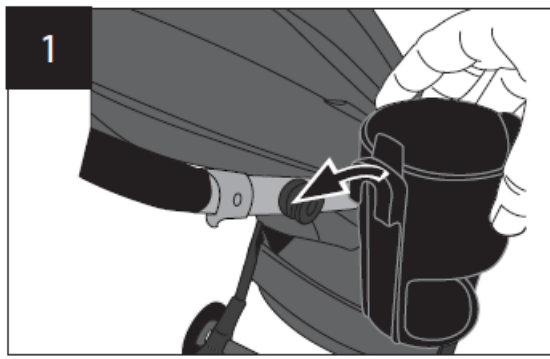

2. To remove cupholder, press tab towards center and slide up.



Canopy

1. To open or close canopy, push to the front or the rear of the stroller as shown.

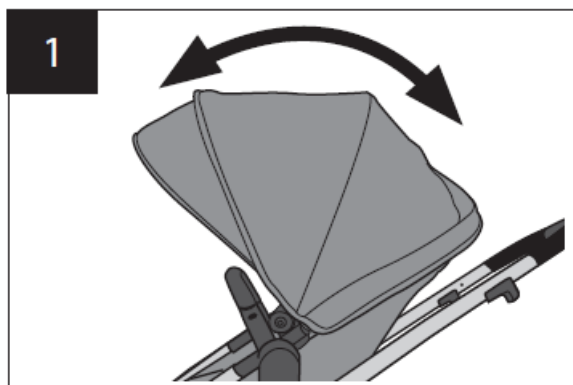

2. Canopy has a window that can be pulled back so you can view child in Toddler Seat Mode.

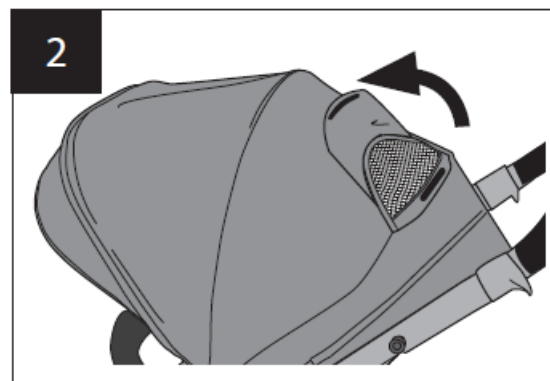

Harness

WARNING! To avoid serious injury from falling or sliding out, ALWAYS use waist restraint.

- **NOTE:** Verify the stroller is locked in the open position by pushing down on the parent's handle. Lock the rear brakes and remove the bumper bar.

The harness shoulder straps G must be at shoulder height or lower, closest to the baby's shoulders H.

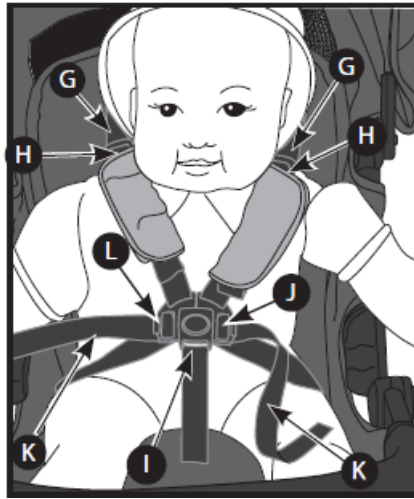

- Place the baby in the seat and bring the buckle panel I up between the child's legs. Fasten each buckle J. For a snug, comfortable fit, pull the shoulder straps G to tighten the shoulder restraint and pull the waist restraint straps K to tighten the waist restraint.

NOTE: To loosen the waist straps K, push in the release button L on the buckle and pull.

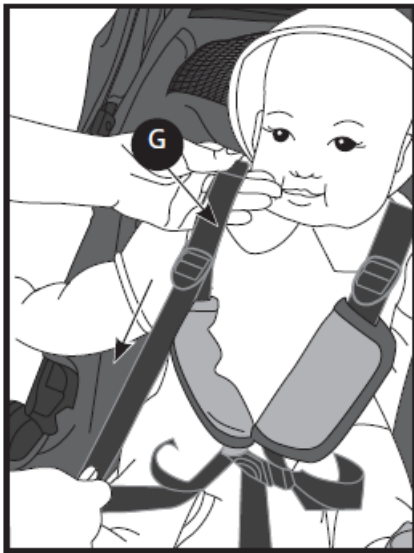

- To loosen shoulder straps push up on the retainer M while pulling down on the shoulder strap. Once the child is properly restrained, re-attach the bumper bar. Make sure the bumper bar locks into position with audible clicks. Pull on the bumper bar to make sure it is locked into place.

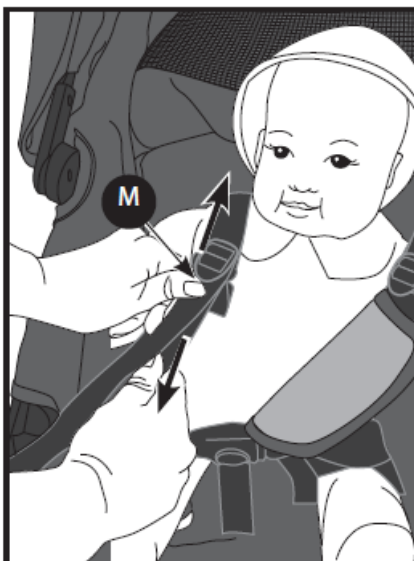

- To change from 5-point to 3-point harness:
Unlock the Harness: Depress button N as shown. Remove harness shoulder strap G from each buckle J as

shown. Store shoulder harness straps for future use.

3-Point Harness

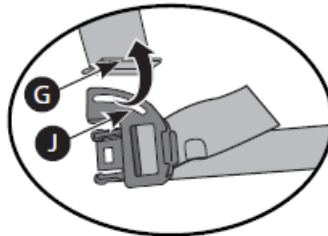
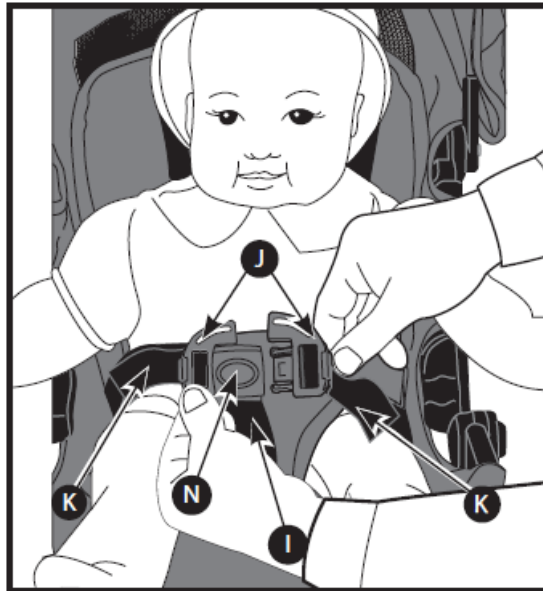

Brakes

1. To lock, press brake lever DOWN at bottom of brake as shown.

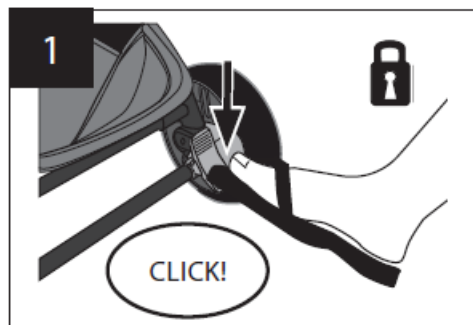

2. To unlock, push lever DOWN at top of brake as shown.

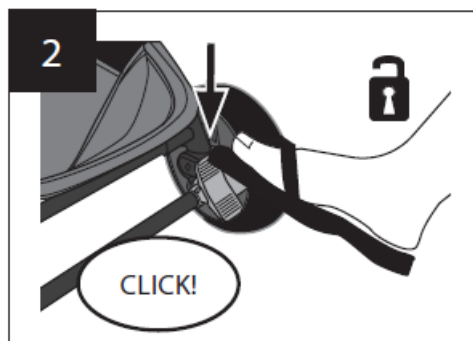

Folding Stroller

1. To fold the stroller forward-facing, remove your child, adjust seat back to upright position, lock the rear brakes, and close the canopy.

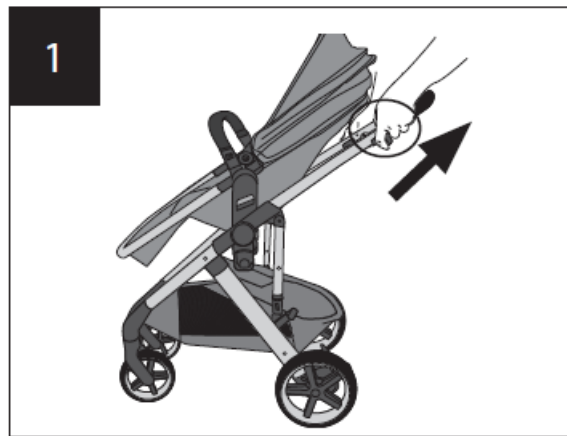

2. Pull the fold release levers on both sides of the stroller and use the bumper bar to help guide stroller down. Lower frame until the side frame lock clicks into place. Double check side frame lock is securely closed. Stroller will stand on its handle and rear wheels when folded.

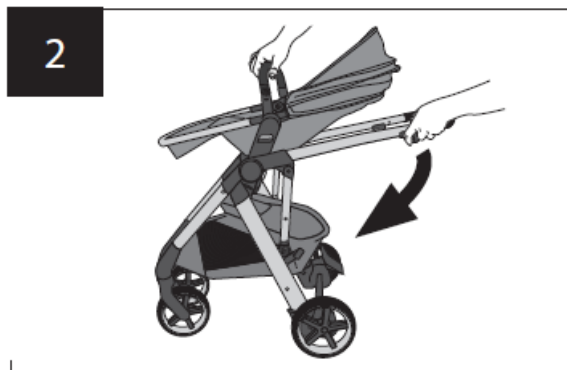

3. While using the bumper bar to help guide the toddler seat, press the lower fold lock and fold the toddler seat forward as shown.

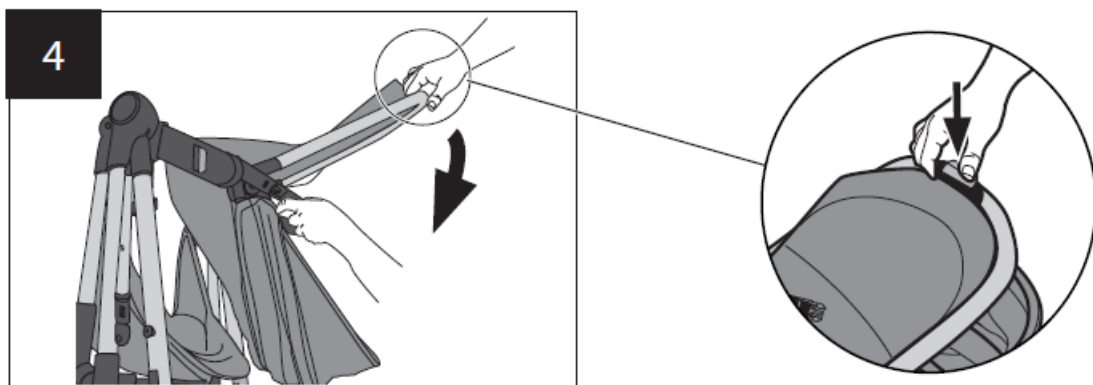
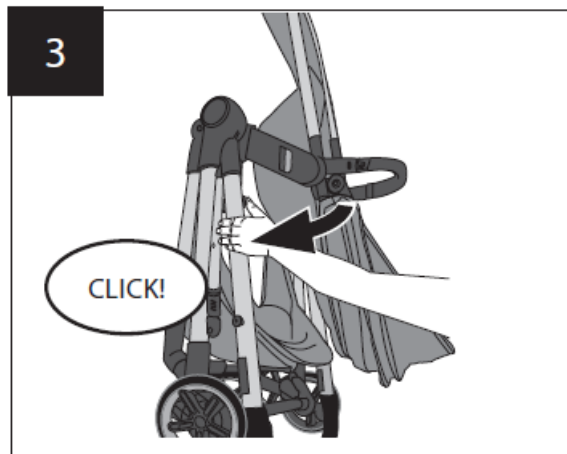

4. To fold the stroller parent-facing, remove your child, lock the rear brakes, and close the canopy.

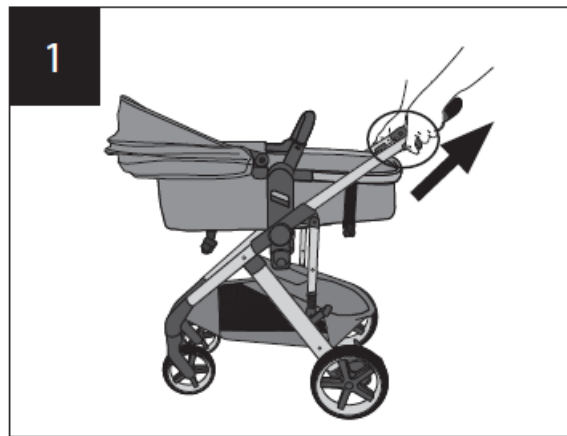

5. Pull the fold release levers on both sides of the stroller and use the bumper bar to help guide stroller down. Lower frame until the side frame lock clicks into place. Double check side frame lock is securely closed. Stroller will stand on its handle and rear wheels when folded.

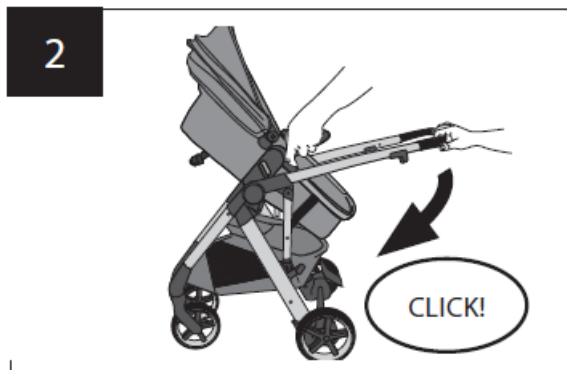

6. While using the bumper bar to help guide the toddler seat, fully lift the multi-position recline handle. With handle lifted, press the upper fold lock and fold the toddler seat forward as shown.

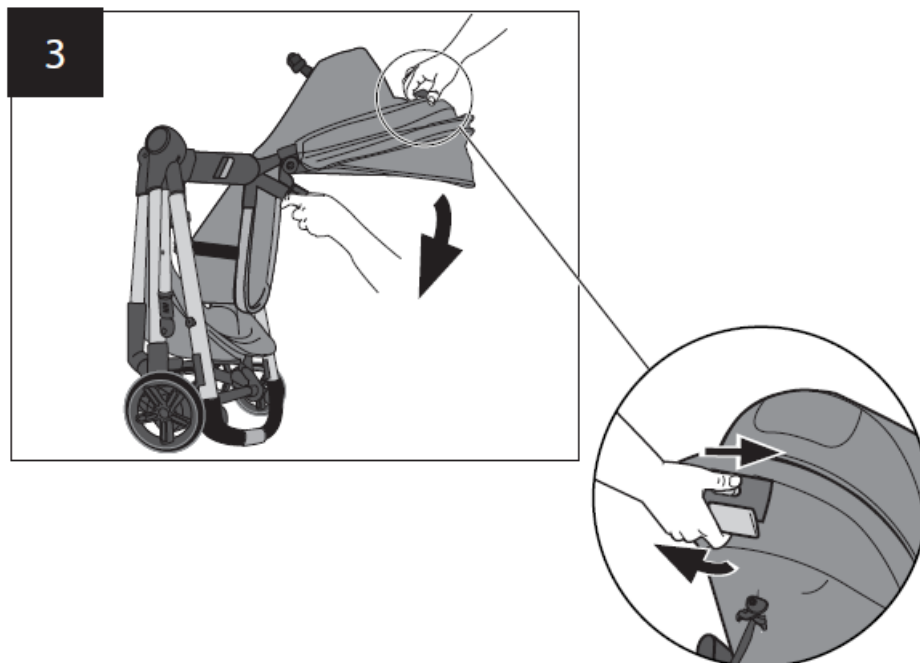

Unfolding Stroller

1. To unfold the stroller, unlatch side frame lock. Continue holding lock open while unfolding the stroller.

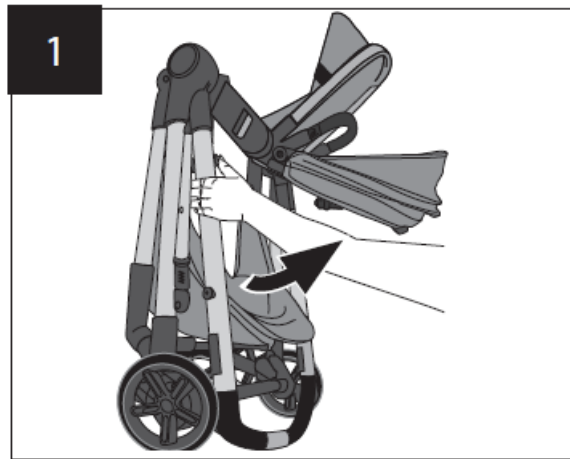

2. Grab the parent's handle and pull upward until the stroller opens fully with an audible click.

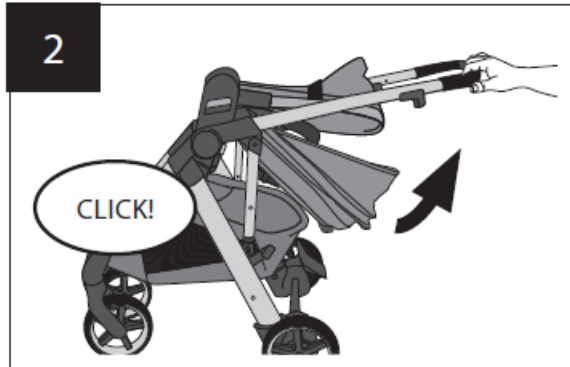

3. Make sure stroller locks in open position by pushing down on parent's handle.

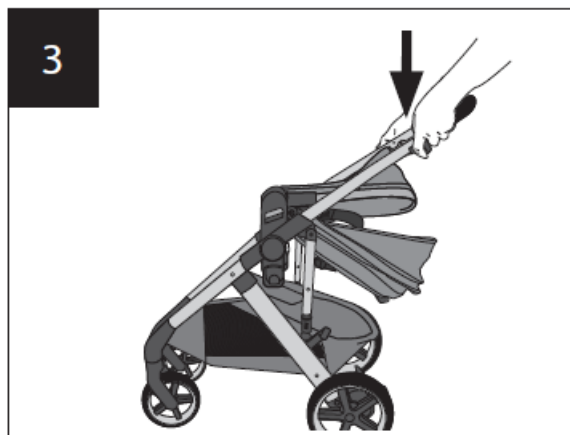

4. Continue to unfold toddler seat until it clicks into place.

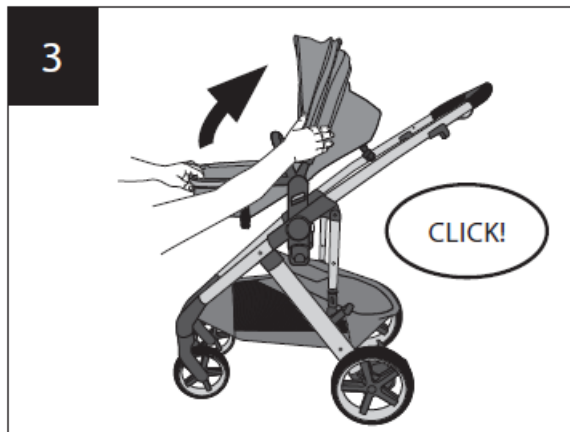

Using your Stroller with the Recommended Infant Car Seats

- Only use Evenflo SafeMax™ or any version of the LiteMax™ infant car seats with this stroller. Other infant car

seats or carriers are not designed to fit the stroller frame and if used with this stroller may result in serious injury to your child.

- Before using the infant car seat with this stroller, read all the instructions provided with it and keep the instructions stored properly for future use.
 - DO NOT lift stroller by using the infant car seat handle when installed on stroller.
 - If unable to securely attach your infant car seat to this stroller, remove the car seat and contact Evenflo ParentLink at 1-800-233-5921 (USA), 1-937-773-3971 (Canada), or 800-706-1200 (México).
 - To avoid serious injury, make sure the infant car seat is securely snapped onto the car seat mounts.
 - Some Evenflo SafeMax™ and LiteMax™ infant car seats have a blanket/boot option that must be removed for proper attachment to this stroller.
1. To remove the toddler seat, press the toddler seat release buttons on both sides of the toddler seat and lift seat off stroller frame.

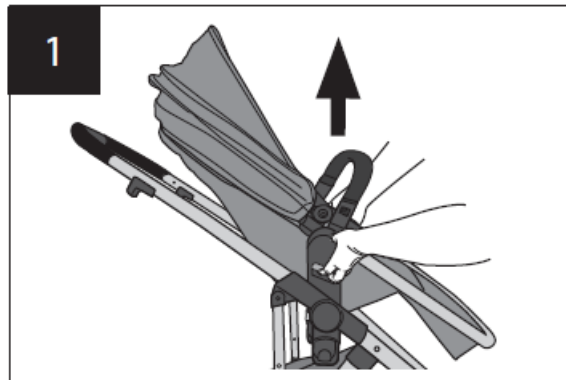

2. Rotate the car seat mounts using the release button on both sides of the stroller as shown. Make sure mounts lock into position with an audible click.

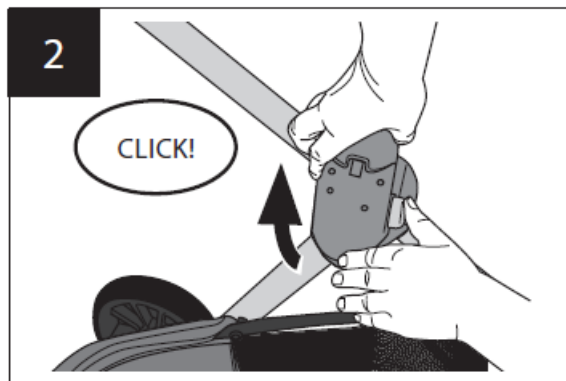

3. To attach car seat, insert car seat into the mounts until they both click into place on both sides of the frame.

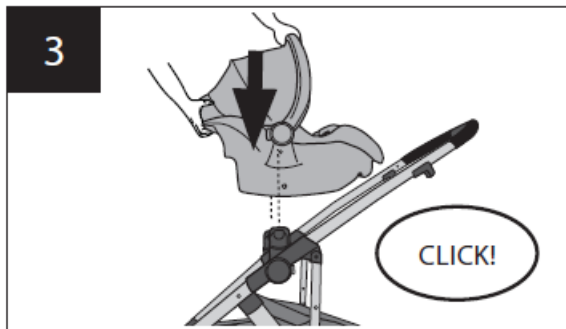

NOTE: Please be sure handle is in upright position when used on the stroller, as shown.

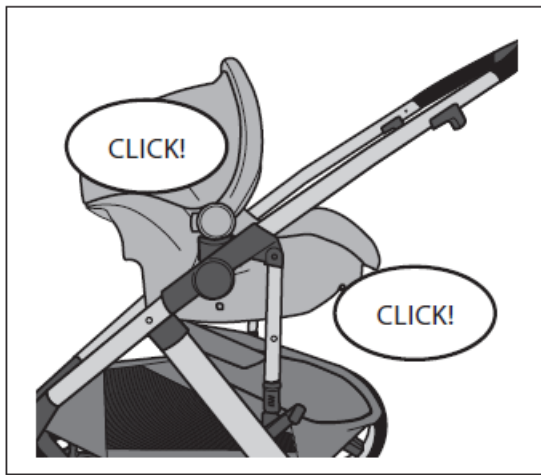

OR

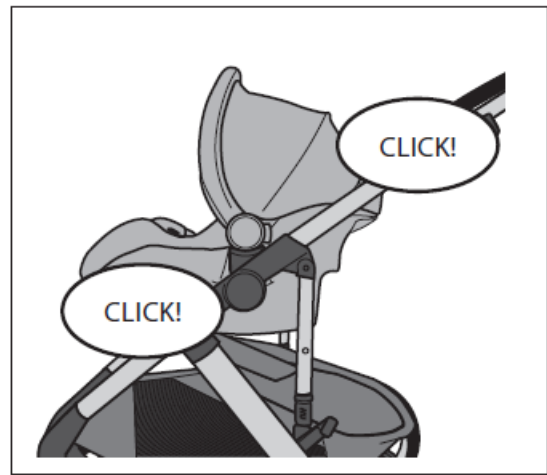

NOTE: The infant car seat may be installed parent-facing or forward-facing on the stroller frame.

4. Pull up on the infant car seat handle to test that it is properly locked into place.

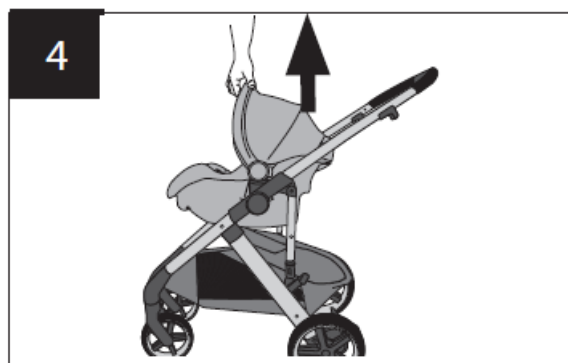

5. To remove infant car seat, lock brakes, squeeze handle on rear of seat and pull car seat up off of the stroller.

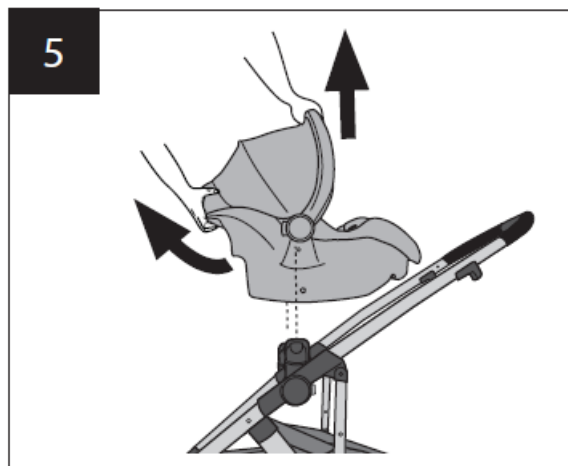

Care and Maintenance

- Clean minor spills and stains on cloth or plastic surfaces with cold water and mild soap. Air dry.
- Metal and plastic parts can be wiped clean with a soft damp cloth and dried with a soft cloth. DO NOT use abrasive cleaners or solvents.

Limited Warranty

For a period of 90 days from the original purchase of this Product, Evenflo warrants to the original end user ("Purchaser") this Product (including any accessories) against defects in material or workmanship. Evenflo's sole obligation under this express limited warranty shall be, at Evenflo's option, to repair or replace any Product that is determined to be defective by Evenflo and determined to be covered by this warranty.

Repair or replacement as provided under this warranty is the exclusive remedy of the Purchaser. Proof of purchase in the form of a receipted invoice or bill of sale evidencing that the Product is within the warranty period must be presented to obtain warranty service. This express limited warranty is extended by Evenflo ONLY to the original Purchaser of the Product and is not assignable or transferable to subsequent purchasers or end users of the Product. For warranty service, contact Evenflo's ParentLink Consumer Resource Center at 1-800-233-5921 or www.evenflo.com.

EXCEPT TO THE EXTENT PROHIBITED BY APPLICABLE LAW, ANY IMPLIED WARRANTY OF MERCHANTABILITY OR FITNESS FOR A PARTICULAR PURPOSE ON THIS PRODUCT IS HEREBY DISCLAIMED. EVENFLO SHALL NOT BE LIABLE FOR ANY INCIDENTAL, CONSEQUENTIAL, SPECIAL OR PUNITIVE DAMAGES OF ANY KIND FOR BREACH OF THE EXPRESS LIMITED WARRANTY ON THIS PRODUCT, OR ANY WARRANTY IMPLIED BY OPERATION OF LAW. OTHER THAN THE EXPRESS LIMITED WARRANTY SET FORTH ABOVE, THERE ARE NO OTHER WARRANTIES THAT ACCOMPANY THIS PRODUCT AND ANY ORAL, WRITTEN OR ANY OTHER EXPRESS REPRESENTATION OF ANY KIND IS HEREBY DISCLAIMED.

www.evenflo.com

USA: 1-800-233-5921 8 AM – 5 PM E.T.

Canada: 1-937-773-3971

México: 800-706-1200

Documents / Resources

 <p>evenflo PIVOT[®] SUITE Stroller/Travel System Poussette/Système de déplacement Carrinho/Sistema de viagem</p> <p>STROLLER 100 in (254 cm) H 18 in (45 cm) L 14.2 lbs (6.4 kg)</p> <p>WHEELS Front: 21 kg (45 lb) Rear: 14 kg (30 lb)</p> <p>CARRIAGE 100 in (254 cm) H 18 in (45 cm) L</p> <p><small>Read all instructions before assembly and use of product. LIREZ LES INSTRUCTIONS AVANT L'ASSEMBLAGE ET L'UTILISATION DU PRODUIT. LEIA TODAS AS INSTRUÇÕES ANTES DE MONTAR E USAR O PRODUTO. GUARDE LAS INSTRUCCIONES PARA USO FUTURO.</small></p>	<p>evenflo Pivot Suite Stroller or Travel System [pdf] Instruction Manual 25701721, Pivot Suite Stroller or Travel System, Pivot Suite, Stroller or Travel System</p>
--	---

References

- [Car Seats, Strollers, & Baby Essentials | Evenflo® Official Site](#)
- [Car Seats, Strollers, & Baby Essentials | Evenflo® Official Site](#)
- [Evenflo® Product Registration | Evenflo® Official Site](#)