



Eve HQEM2ZM Light Switch Control Your Lights User Guide

[Home](#) » [eve](#) » Eve HQEM2ZM Light Switch Control Your Lights User Guide 

eve light switch

HQEM2ZM Light Switch Control Your Lights
User Guide

Contents

- [1 HQEM2ZM Light Switch Control Your Lights](#)
- [2 Get Started](#)
- [3 Enjoy](#)
- [4 Reset](#)
- [5 Legal Information](#)
- [6 Happily connected?](#)
- [7 Documents / Resources](#)
 - [7.1 References](#)

HQEM2ZM Light Switch Control Your Lights

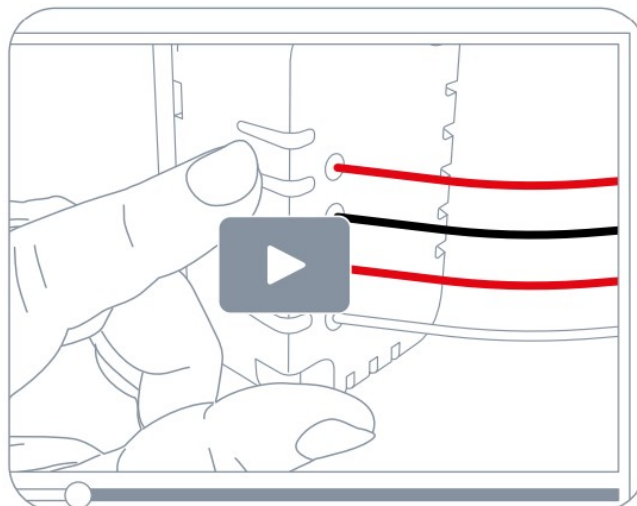

Get Started

! Eve Light Switch requires a neutral wire and replaces a single-pole or 3-way switch. Only for use with copper or copper clad wire in dry, indoor locations.

If you are unsure or uncomfortable about installing Eve Light Switch, consult a qualified electrician. To be installed and/or used in accordance with appropriate electrical codes and regulations.

Min. 3 W; Max. 1800 W/ 15 A (resistive), 600 W/ 5 A (incandescent /tungsten), 120 VAC

1. Turn off power at the circuit breaker that controls the light switch. Ensure power is off by switching your existing light switch on and off multiple times.

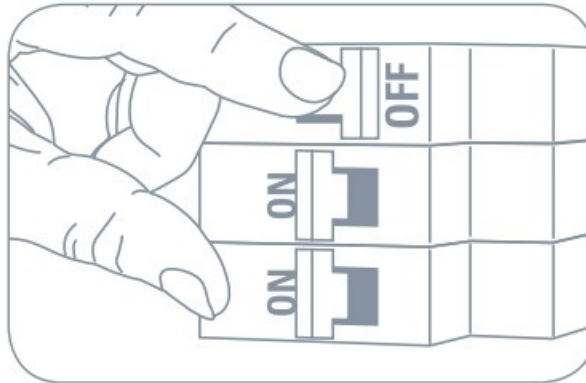

2. Remove your existing wall plate and light switch. Only proceed with the installation if there is a neutral wire (usually white) in the switch box.

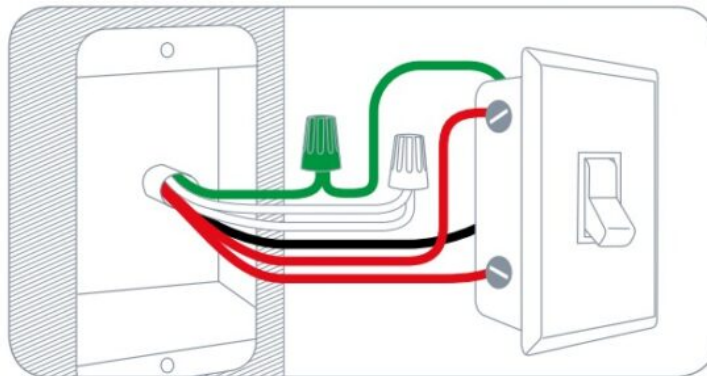

3. Replace a single-pole switch

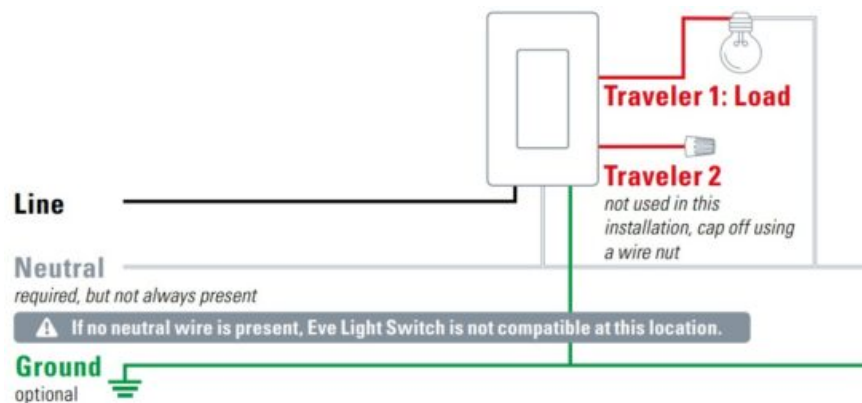

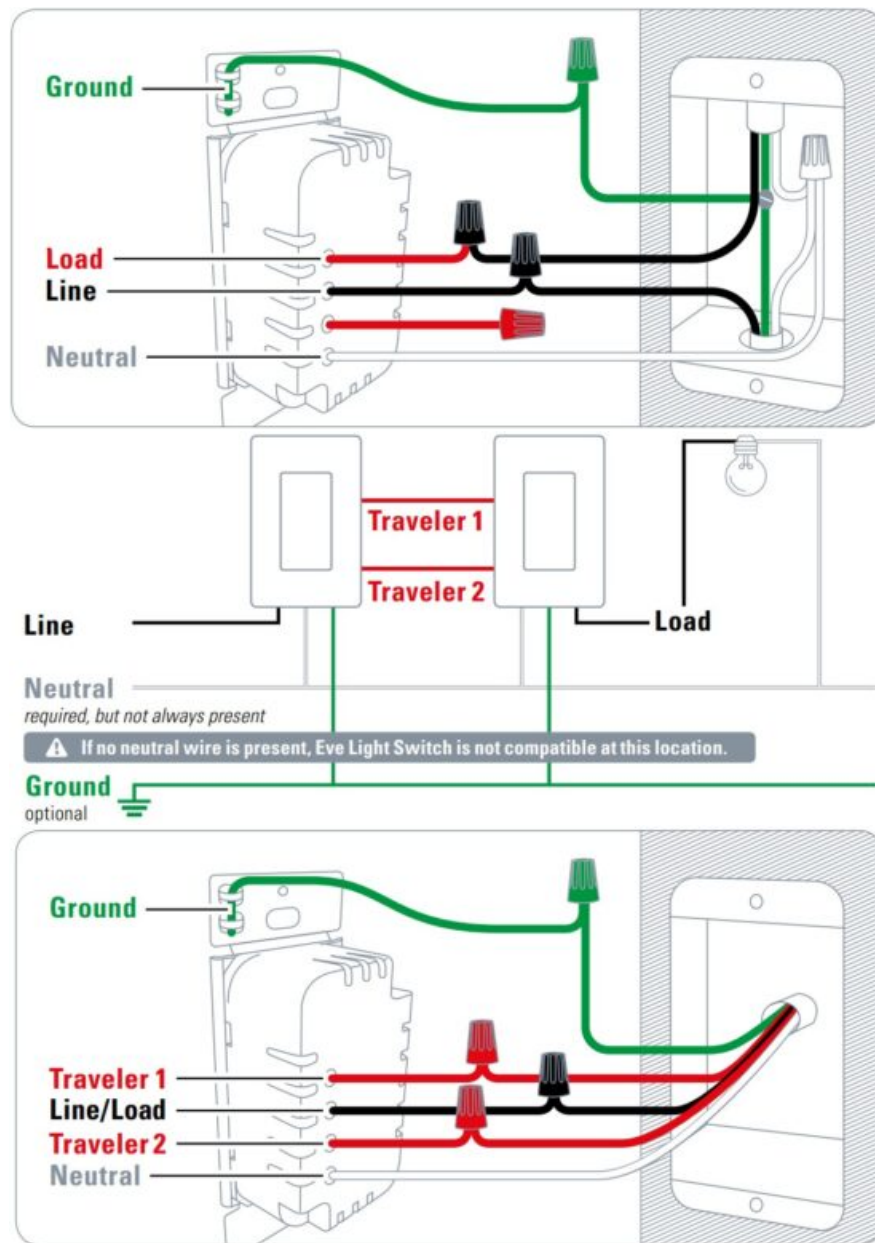

4. Mount Eve Light Switch into the wall.
5. Screw in the snap plate (5a) and push the face plate onto it (5b). Alternatively, use your existing wall plate.
6. Turn on power at the circuit breaker that controls the light switch.
Tap Eve Light Switch – your lights should now turn on.
If your lights do not turn on, your live and load wires might be swapped. Turn off power at the circuit breaker and try swapping them.

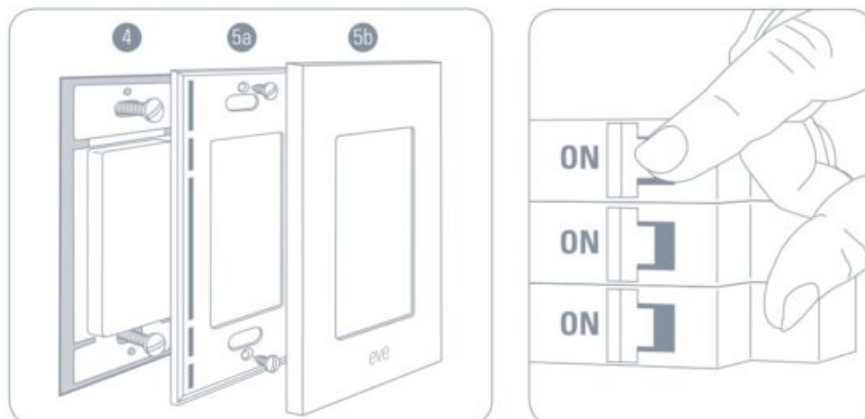

7. Add Eve Light Switch to the platform of your choice and make sure to have a compatible Thread Border Router.



Learn more at evehome.com/hub



View time and duration statistics



Set schedules



Access Eve Light Switch using the Eve App, or the apps or voice assistants of your preferred platforms. Feature sets may vary, depending on your platform. More information at evehome.com/eve-light-switch

Enjoy



Eve is designed to safeguard your personal data. All data is fully encrypted and only transferred directly between your Eve Light Switch and iPhone, iPad or home hub.

Learn more at evehome.com/privacy

Reset

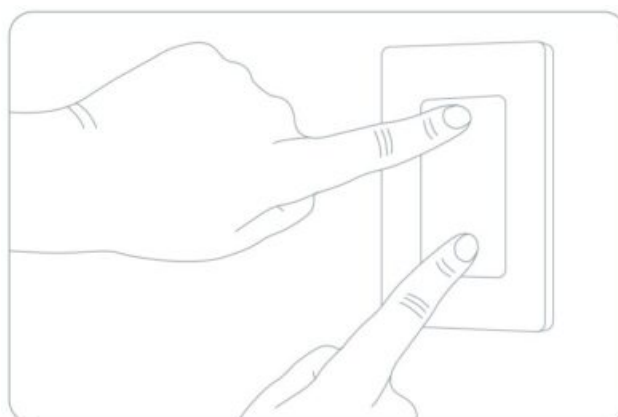

Legal Information

This device complies with part 15 of the FCC Rules and Industry Canada licence-exempt RSS standard(s). Operation is subject to the following two conditions: (1) This device may not cause interference, and (2) this device must accept any interference received, including interference that may cause undesired operation. This equipment has been tested and found to comply with the limits for a Class B digital device, pursuant to part 15 of the FCC Rules. These limits are designed to provide reasonable protection against harmful interference in a residential

installation.

This equipment generates, uses and can radiate radio frequency energy and, if not installed and used in accordance with the instructions, may cause harmful interference to radio communications. However, there is no guarantee that interference will not occur in a particular installation. If this equipment does cause harmful interference to radio or television reception, which can be determined by turning the equipment off and on, you are encouraged to try to correct the interference by one or more of the following measures: reorient or relocate the receiving antenna; increase the separation between the equipment and receiver; consult the dealer or an experienced radio/T V technician for help.

This Class B digital apparatus complies with Canadian ICES-003.

This equipment complies with FCC RF, IC RSS-102 and CE radiation exposure limits set forth for an uncontrolled environment. This equipment should be installed and operated with a minimum distance of 20 centimeters between the radiator and your body. This transmitter must not be co-located or operating in conjunction with any other antenna or transmitter.







Changes or modifications not expressly approved by Eve Systems could void your authority to operate this device. For questions about Eve product compliance with FCC regulations, please contact: Compliance Officer, Eve Systems, 100 Pine St., Suite 1250, San Francisco CA 94111, USA..

Purpose of control: operating control; construction of control: independently wall mounted control; type 1 action; operating time: continuous; control pollution degree: 2; frequency range: 2402 – 2480 MHz (BLE) / 2405 – 2480 MHz (Thread); max. EIRP: 10 dBm; temperature range: 32 °F – 104 °F; rated impulse withstand voltage: 2.5 kV
Product: 10ECE4151

- Model: 20ECE4101
- Part: 51ECE4151
- FCC ID: SNE-ELS-003
- IC: 11192A-ELS003

Happily connected?

Write a review and tell your friends
Stay in touch and discover more via:

	Facebook facebook.com/meeteve		YouTube @MeetEve
	X @meeteve		Instagram @meet_eve
	Eve Newsletter evehome.com/newsletter		Eve Blog blog.evehome.com

Reach out now: Visit our knowledge base or contact our support team



help.evehome.com



evehome.com/contact



Please keep your Matter Setup Code in a safe place. You need it to securely add Eve to your home, and nobody but you has a copy.

Powered by



eve light switch @

Documents / Resources

	Eve HQEM2ZM Light Switch Control Your Lights [pdf] User Guide HQEM2ZM Light Switch Control Your Lights, HQEM2ZM, Light Switch Control Your Lights, Switch Control Your Lights, Control Your Lights, Lights
---	---

References

- @. [Eve Blog | evehome.com](#)
- @. [Contact Us | evehome.com](#)
- @. [Which hub is right for me? | evehome.com](#)
- @. [Newsletter | evehome.com](#)
- [User Manual](#)

Manuals+, Privacy Policy

This website is an independent publication and is neither affiliated with nor endorsed by any of the trademark owners. The "Bluetooth®" word mark and logos are registered trademarks owned by Bluetooth SIG, Inc. The "Wi-Fi®" word mark and logos are registered trademarks owned by the Wi-Fi Alliance. Any use of these marks on this website does not imply any affiliation with or endorsement.