

EVALOGIK®

EVALOGIK
WF30TS 3 Way
WiFi Toggle On
and Off Switch



EVALOGIK WF30TS 3 Way WiFi Toggle On and Off Switch User Guide

[Home](#) » [EVALOGIK](#) » EVALOGIK WF30TS 3 Way WiFi Toggle On and Off Switch User Guide 

Contents

- [1 EVALOGIK WF30TS 3 Way WiFi Toggle On and Off Switch](#)
- [2 Product Information](#)
- [3 Product Usage Instructions](#)
- [4 Part 1. Installation](#)
- [5 Bluetooth Quick-Fit Mode](#)
- [6 Part 5. Product Operating Instructions](#)
- [7 Part 6. Network Configuration](#)
- [8 Part 7. Parameter Settings](#)
- [9 FCC](#)
- [10 Documents / Resources](#)
 - [10.1 References](#)
- [11 Related Posts](#)

EVALOGIK®

EVALOGIK WF30TS 3 Way WiFi Toggle On and Off Switch



Product Information

Product Usage Instructions

Installation

Please check the best option for your 3-way installation before proceeding.

Manual Control

To manually control the device, follow the instructions provided in the manual.

FAQ

How do I switch between different values in Parameter Settings?

In order to toggle between values, quickly press the up or down toggle 5 times. Each press will switch to the next value sequentially.

Meet your new smart switch!

- Power: 120V AC, 60Hz
- Wireless Frequency: 2.4GHz
- Wireless Standard: IEEE802.11b/g/n
- Maximum Load: 8A
- Incandescent 500W
- LED 150W
- Resistive 1000W
- Temperature Range: 32° - 104° F
- Range: Up to 100 feet line of sight



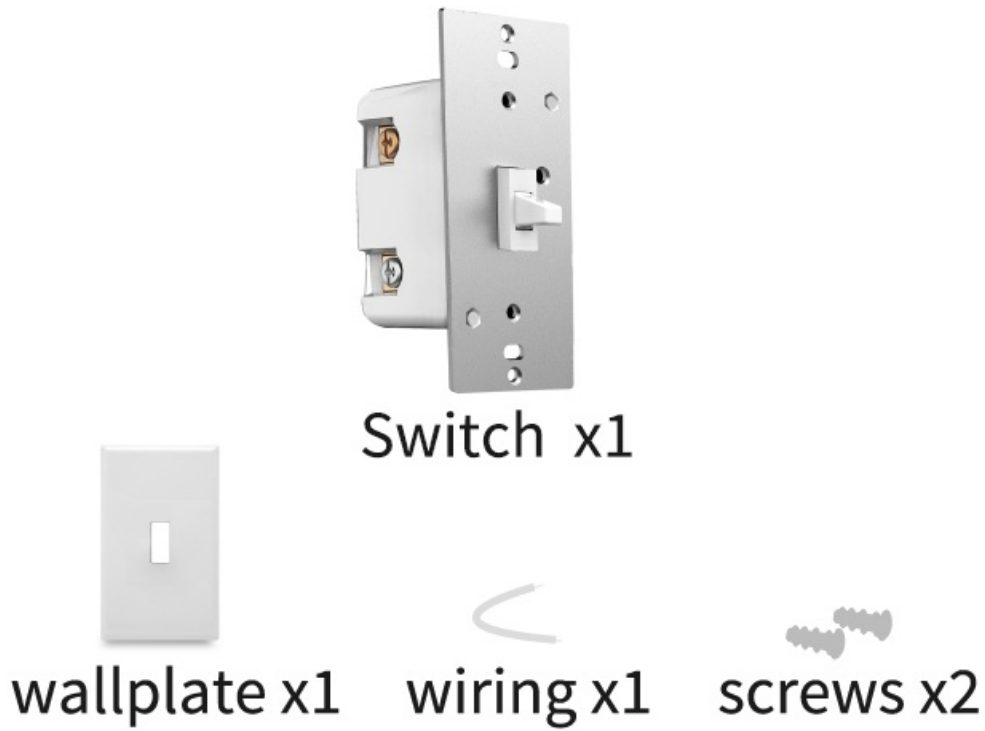

For indoor use.



Part 1. Installation

1. Few Quick Reminders

A quick note before we give out the wiring schematics. Please do not try installing this device if you are unsure of how electrical circuits operate within your home. As exciting as it is to have a smart switch installed, it can be dangerous and even life-threatening if you do not install this correctly. Please consult a qualified electrician if necessary. With that said, here are a few other warnings we'd like to point out for your safety:

-  Line (hot) — black (connected to power)
-  Neutral — white
-  Load — black (connected to lighting/3-way)
-  Traveler— red/other (connected to lighting /3-way)

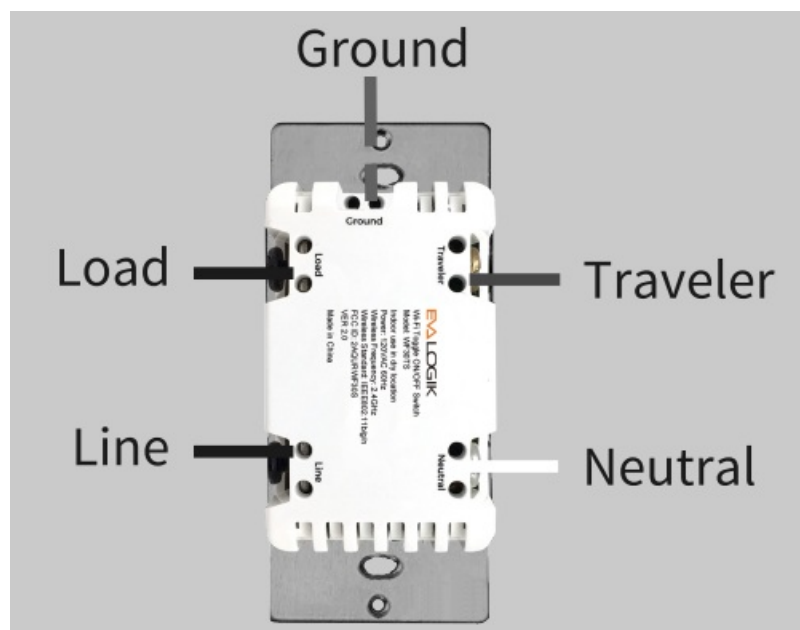

HOW TO INSTALL THE WIRES



1. Unscrew: carefully turn the screw counterclockwise to leave enough space for the wire to be inserted. Do not unscrew the screws completely.
2. Press down: Once loosened, use your finger so it catches the thread.
3. Insert the wire: make sure the wire is completely straight, then insert it into the terminal while holding down the screw. Do not wrap the wire around the screw!
4. Tighten: Turn the screw clockwise to tighten the wire. Make sure the wires are locked!

Note: There are 2 holes for each terminal can be used in the connection. You can use a jump wire or the second hole at the terminal to connect.

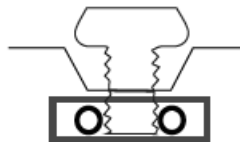

Note before installation

1. The Wi-Fi In-wall Smart Switch must not exceed Incandescent 500W / LED 150W / Resistive 1000W.
2. Work with regular 3-way on/Off for 2 locations control. It can only be connected with regular 3-way on/off switch, don't use a smart switch or a dimmer switch! Couldn't work with an add-on switch!
3. The colors of your wires may not match the ones in our diagrams so please make sure you've identified all wires correctly based on their source, not color only.
4. Please check your original 3-way wiring circuit in your home before installation, and then follow the wiring diagram option 1 or 2 in the manual.
5. Install the smart switch in the switch box which directly connects to the power Line and Neutral.
6. This switch requires a Neutral for installation, or the installation will not succeed.
7. Not recommended for fan.

If you have any questions, please contact us at ask@evalogik.com

1. Tool: Please prepare a flat head screwdriver.
2. Turn power OFF at circuit breaker or fuse box.

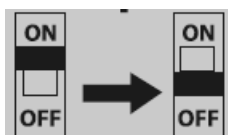

3. Remove wallplate.
4. Remove the switch mounting screws.
5. Disconnect the wires and label them after remove the old switch. (Please use our sticker)

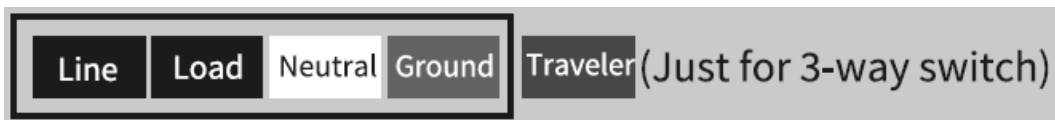

- Carefully remove the switch from the switch box. (DO NOT disconnect the wires.)
- There are up to five screw terminals on the smart switch, these are marked (Please check <HOW TO INSTALL THE WIRES>)
- Fix the wallplate with screws after wiring succeed. (Please use our screws.)
- The Ground was excluded from the diagram to simplify the illustration. Please Make sure the ground wires connected to the switches respectively.

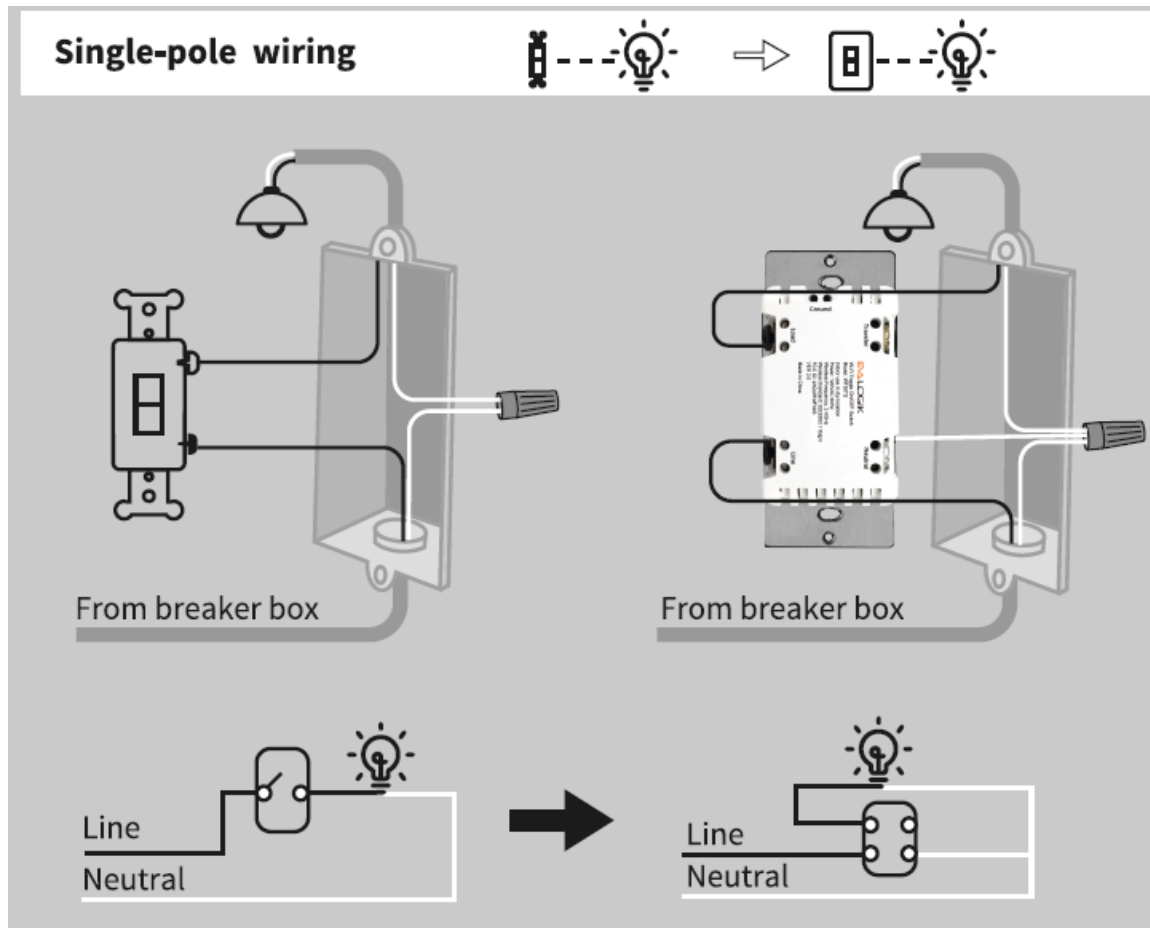

NOTE:

- Neutral required. If the switch box do not have a Neutral, please stop! Connect the white wire to neutral terminal (use a white jump wire form the package or the second hole at the terminal to connect.)
- the old switch detached, please identify the common terminal.
- Only work with regular 3-way on/off for 2 locations control. It can only be connected with regular 3-way on/off switch, don't use a smart switch or a dimmer switch! Couldn't work with an add-on switch!

Please check which option is be*t for your 3-way installation.

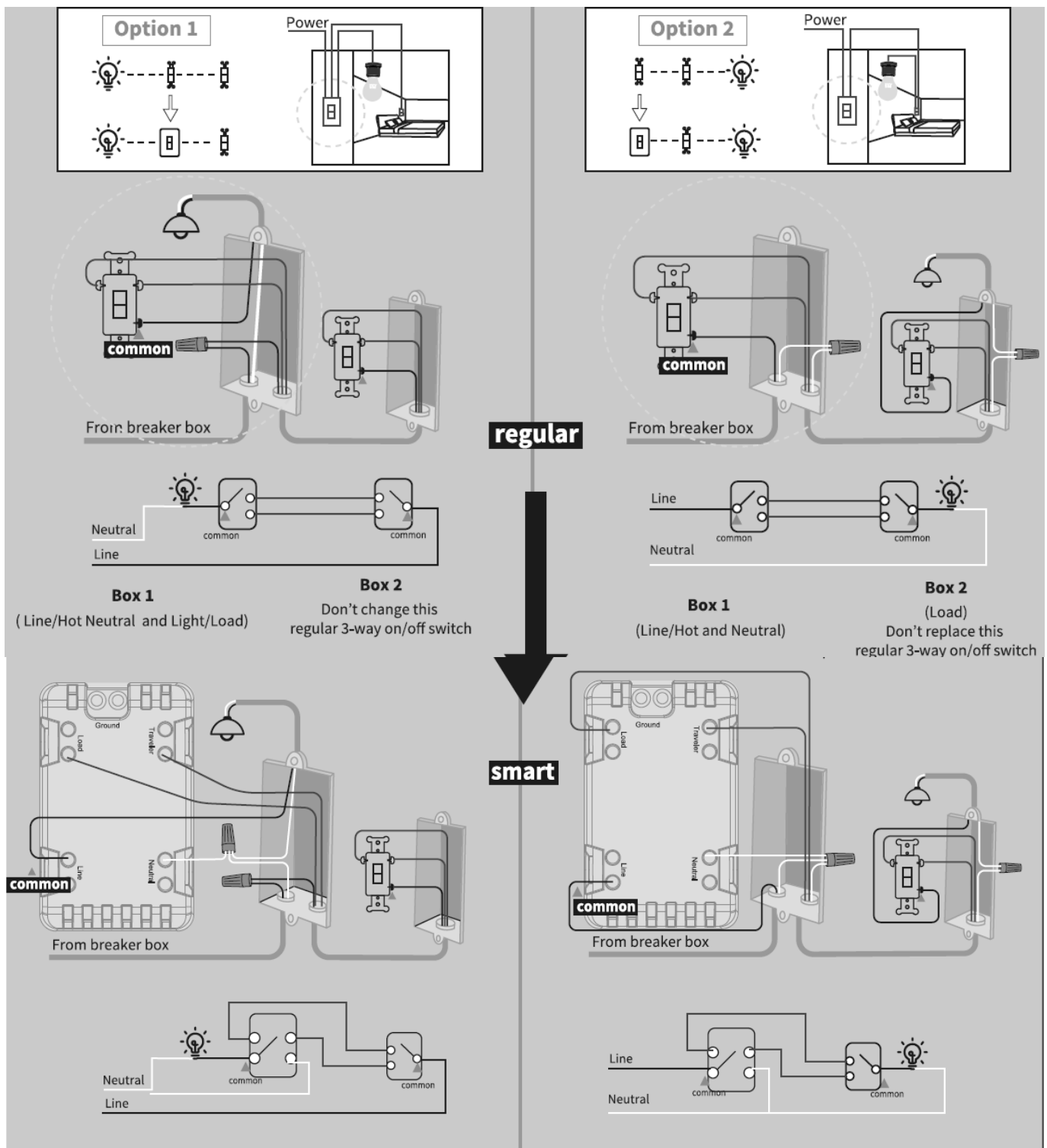

Part 3. Manual Contro

1. Tap I(Up toggle): turn on the light
2. Tap I(Down toggle) : turn off the light
3. Adding your device to a Wi-Fi network:
Hold the “down” toggle more than 5s until the bulb flashes and the blue LED blinks rapidly to initiate App-configured Mode.
4. If you need to reset the device (Factory setting)
Network reset
Hold the “down” toggle until the bulb flashes (the blue LED blinks rapidly)

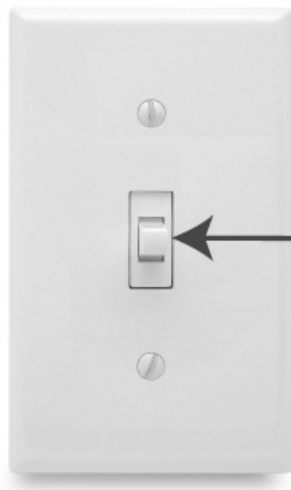

LED Indicator:

Red: Network failure

Blue: Network configuration mode

Orange: Light status indicator

Purple: AP Network configuration mode

Part 4. APP Connection

1. Please scan the QR code to download the application "Smart Life"
2. If you cannot download Smart Life app, please search "Smart Life on Google Play (for Android phone) or Apple Store (for iOS phone) to download.

After you download the Smart Life App and register a new account, please follow the instructions below to set up your smart switch.

3. The smart switch can be also used with Amazon Echo and Google Home. Please scan the QR code below and follow the instructions if you have any trouble pairing with them.



QR code



Smart Life





Amazon-Echo



Google-Home

Note:

1. Our products only support 2.4GHz Wi-Fi network.
2. 3 connection network modes: Bluetooth quick-fit Mode, Easy Mode, AP Mode.
Choose the most suitable mode to configure the network.
3. Please operate quickly when  blue LED indicator blinks rapidly.
4. When indicator flash enters the network, complete standard operation within 3 minutes.
5.  Purple LED Flashing slowly enters AP Mode (select "AP Mode" follow the below instructions.)
6. Make sure the switch works properly by manual control before network configuration.

Device Reset / Network reset hold the "Down" toggle until the light bulb flashes ( blue LED blinks rapidly)

Bluetooth Quick-Fit Mode

1. Turn on your Phone bluetooth.

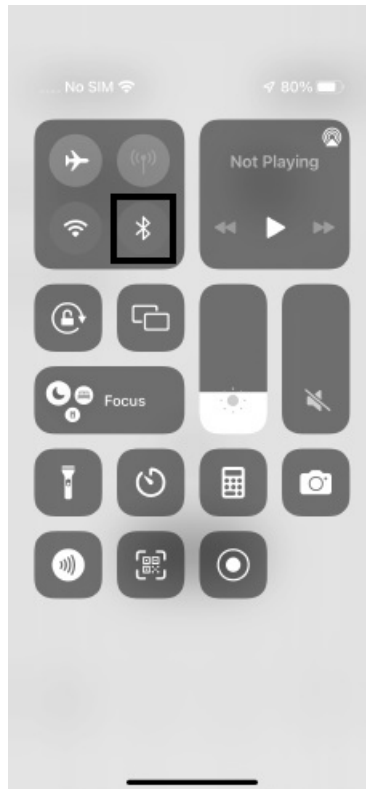

2. The auto-connection comes  with blue LED indicator blinks for 3 minutes to wait for configuration. If it stopped, please Hold the “down” toggle more than 5s until the bulb flashes and the blue LED blinks again.
3. Tap ‘+’ to add this switch in the “Smart Life” APP.
4. You’ll see “Devices to be added”—“Go to add”.
5. Click to “Add “

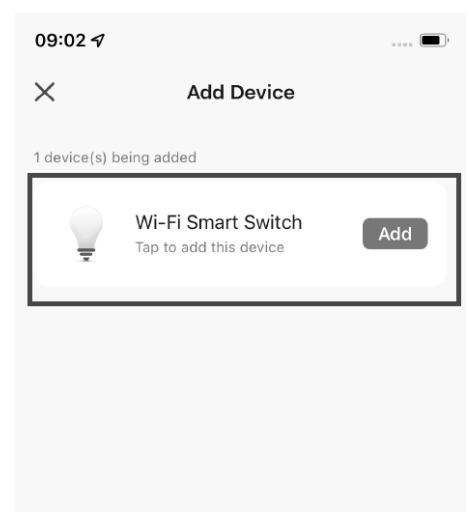
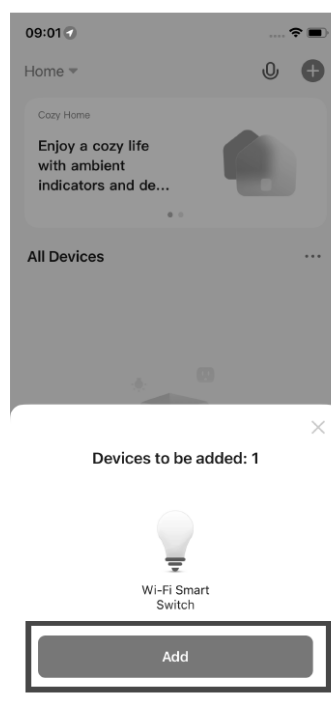
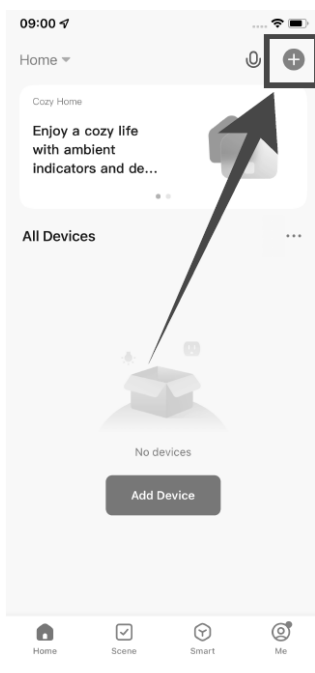

6. Enter the Wi-Fi Password(Your phone should have connected to the same Wi-Fi first).
7. Wait for it's 100% (LED stays in  green 3 seconds.)

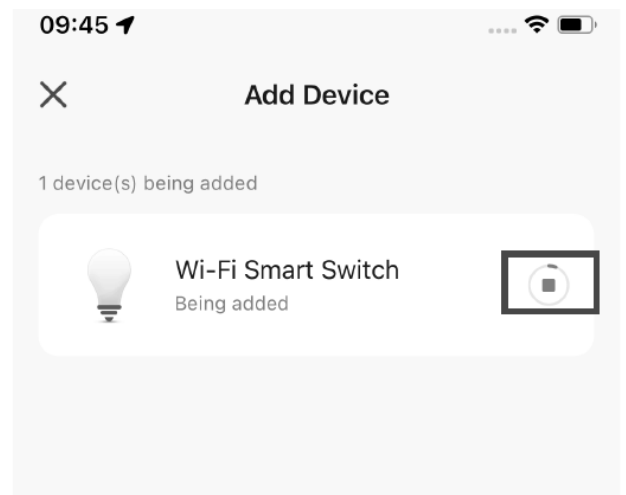
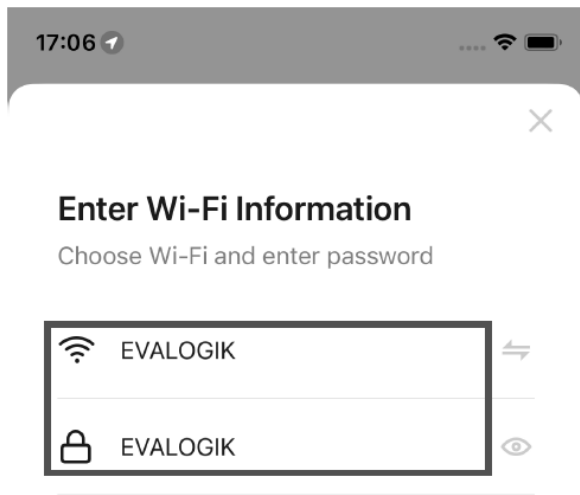

8. Edit the name of your new smart switch!

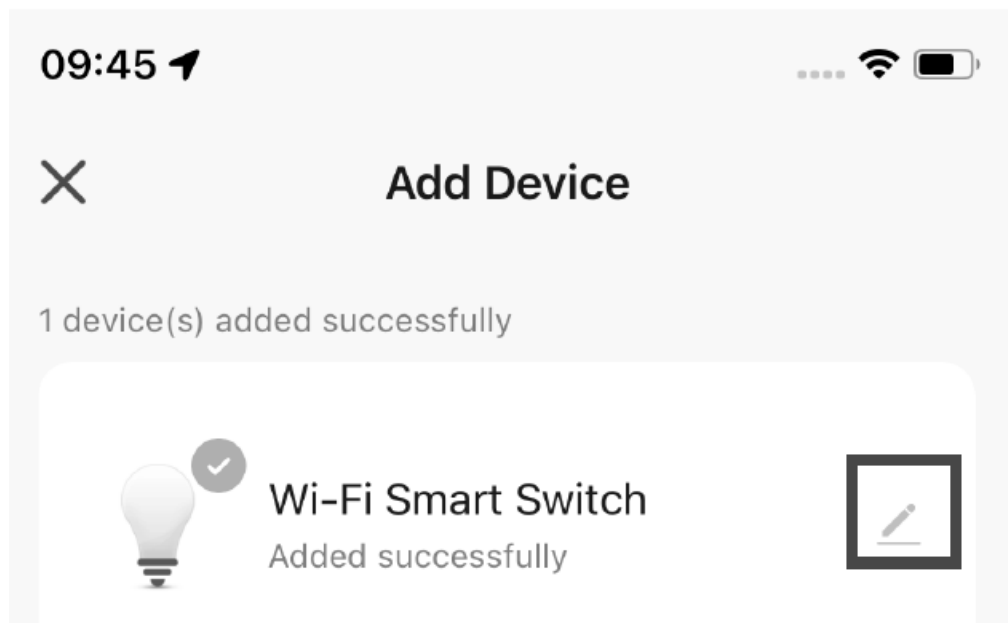

Note:

When the Bluetooth is off, APP will remind: "You are advised to enable Bluetooth".

Easy Mode

1. Tap "Add Device" to add a device in your app
2. Select "Electrician "Switch (Wi-Fi)"
3. Enter the Wi-Fi Password

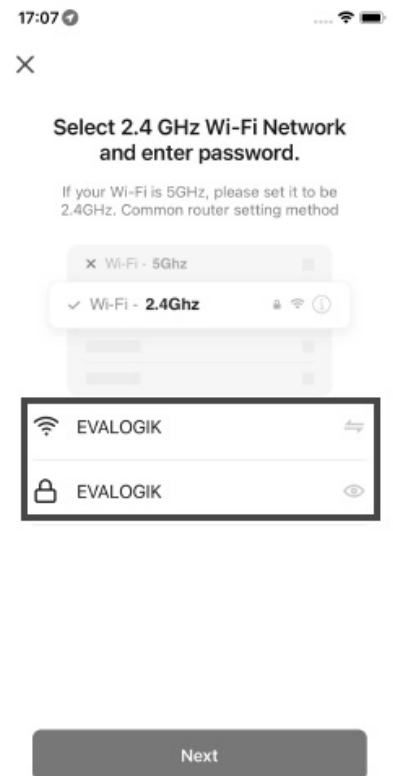
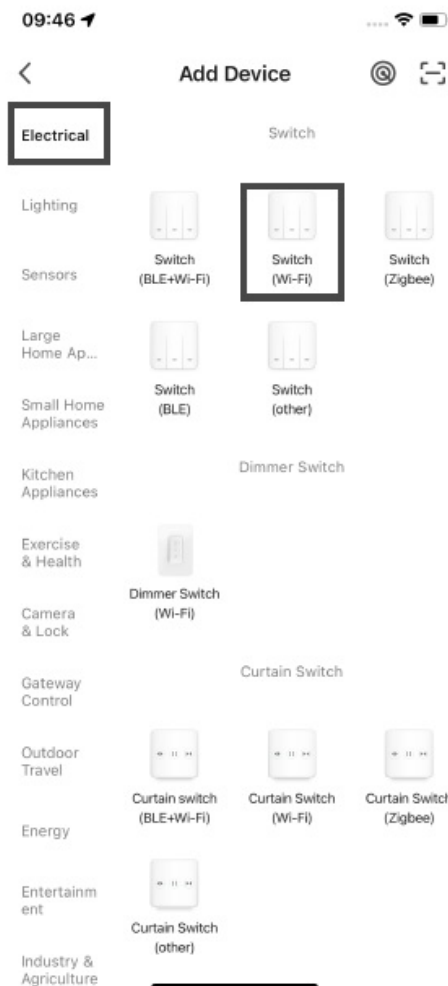
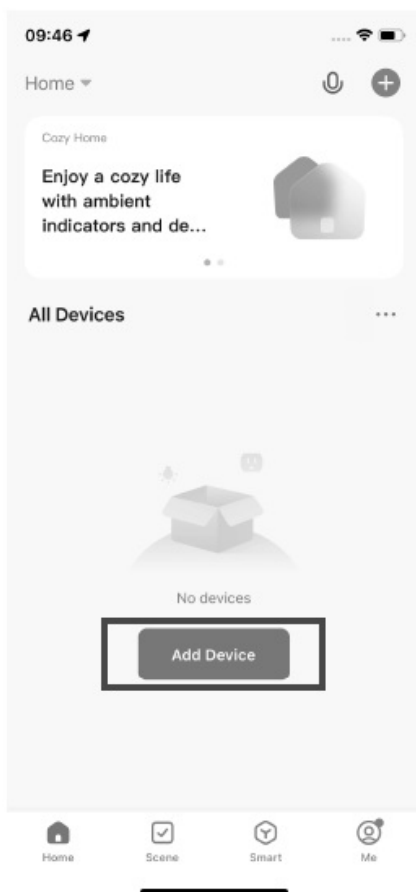

4. Hold the “down” toggle more than 5s until the bulb flashes and “BLUE” LED blinks rapidly.

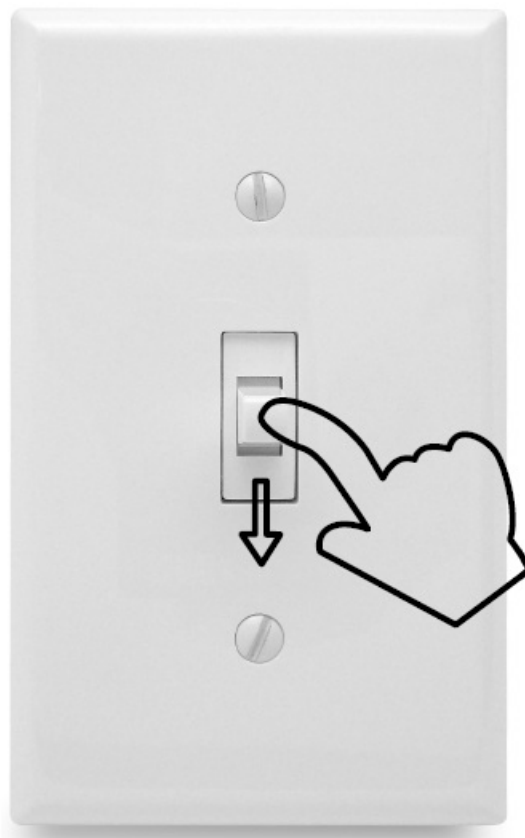

5. Tap “Confirm the indicator is blinking rapidly.”

Power on the device and confirm that the indicator is blinking rapidly.

Note: please complete the network distribution within 3 minutes after resetting the device.

Confirm the indicator is blinking rapidly.

Reset Device Step by Step

6. Click "Blink Quickly"

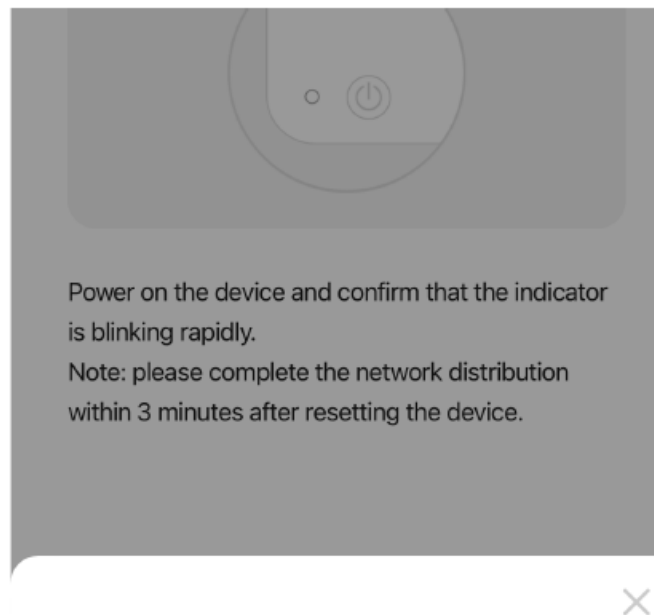

Select the status of the indicator light or hear the beep:

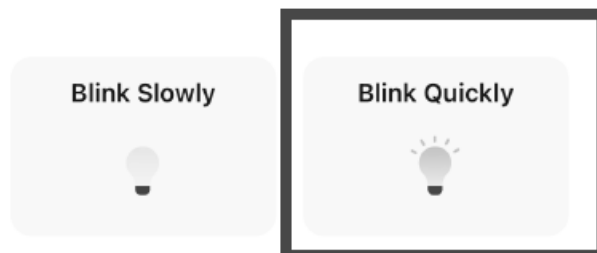

7. Wait for it's 100%
(LED stays ino green 3 seconds.)



01:58



8. Click and edit the name of switch!

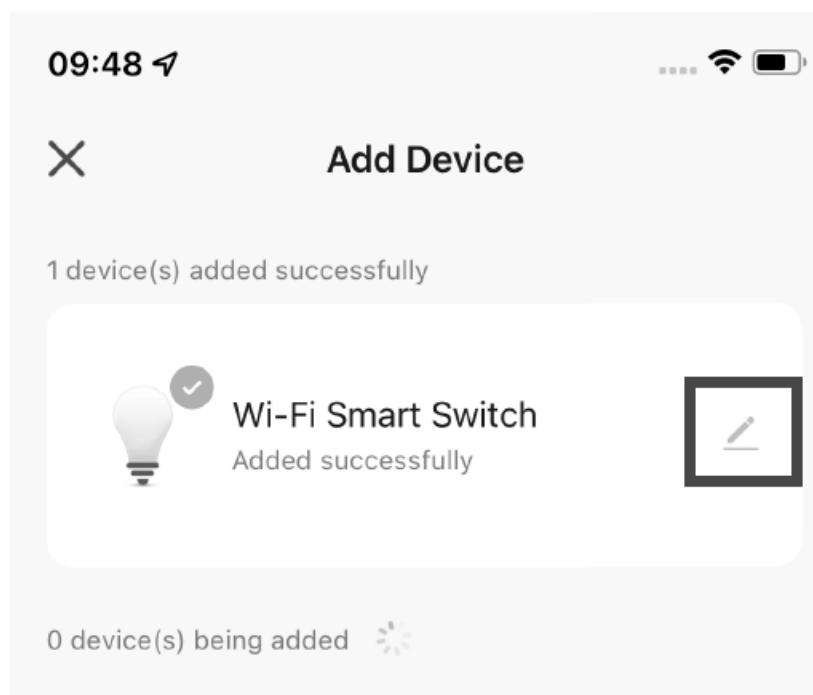

AP Mode

If you cannot successfully configure the default mode, try connecting to AP mode.

1. Select "Electrician" - "Switch (Wi-Fi)" and enter the Wi-Fi password.
2. When the blue LED indicator flashes quickly, press and hold the off button (default is the down button) for more than 5s until the bulb flashes twice to enter the AP mode, and the purple LED indicator flashes quickly.
3. Click "Confirm the indicator is blinking rapidly." Then select "Blink Slowly".
4. Open wireless WLAN settings with "SmartLife-xxxx".
5. Back in the application, continue adding devices and wait for the connection to complete.

AP Network configuration mode to Easy Mode: When the purple LED indicator flashes quickly, press and hold the

“down” toggle for more than 5s until the bulb flashes 1 time to enter easy mode, and the blue LED indicator flashes quickly.

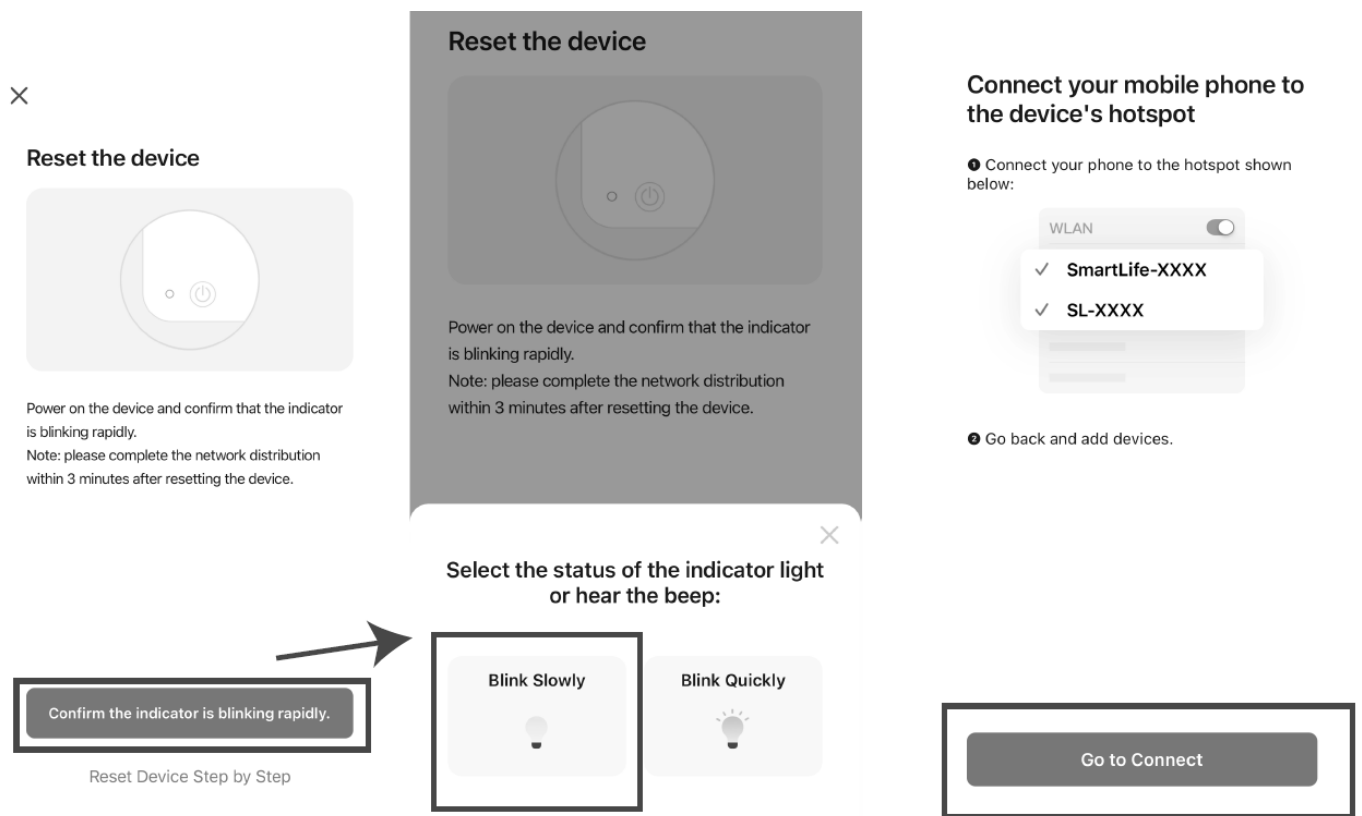

Part 5. Product Operating Instructions

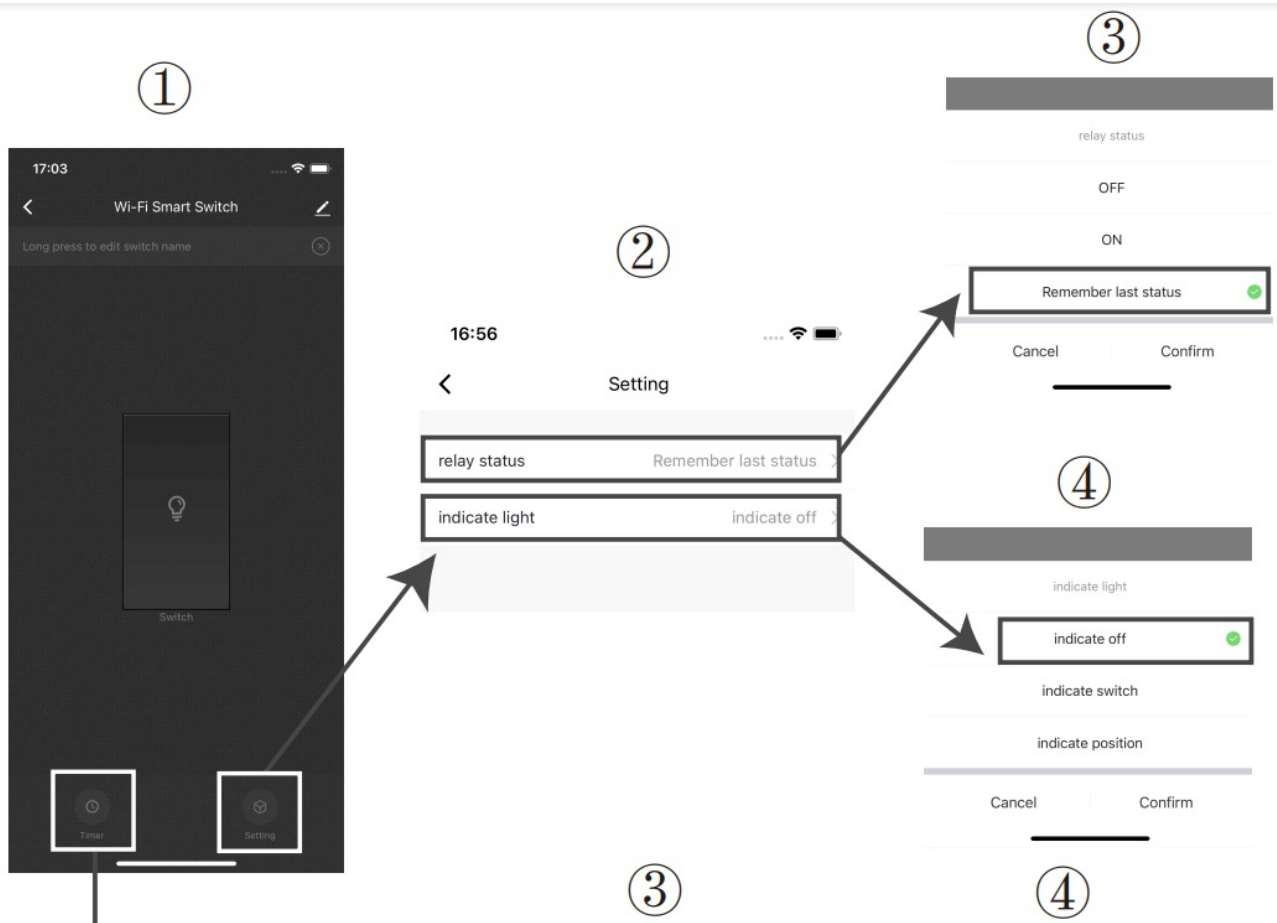

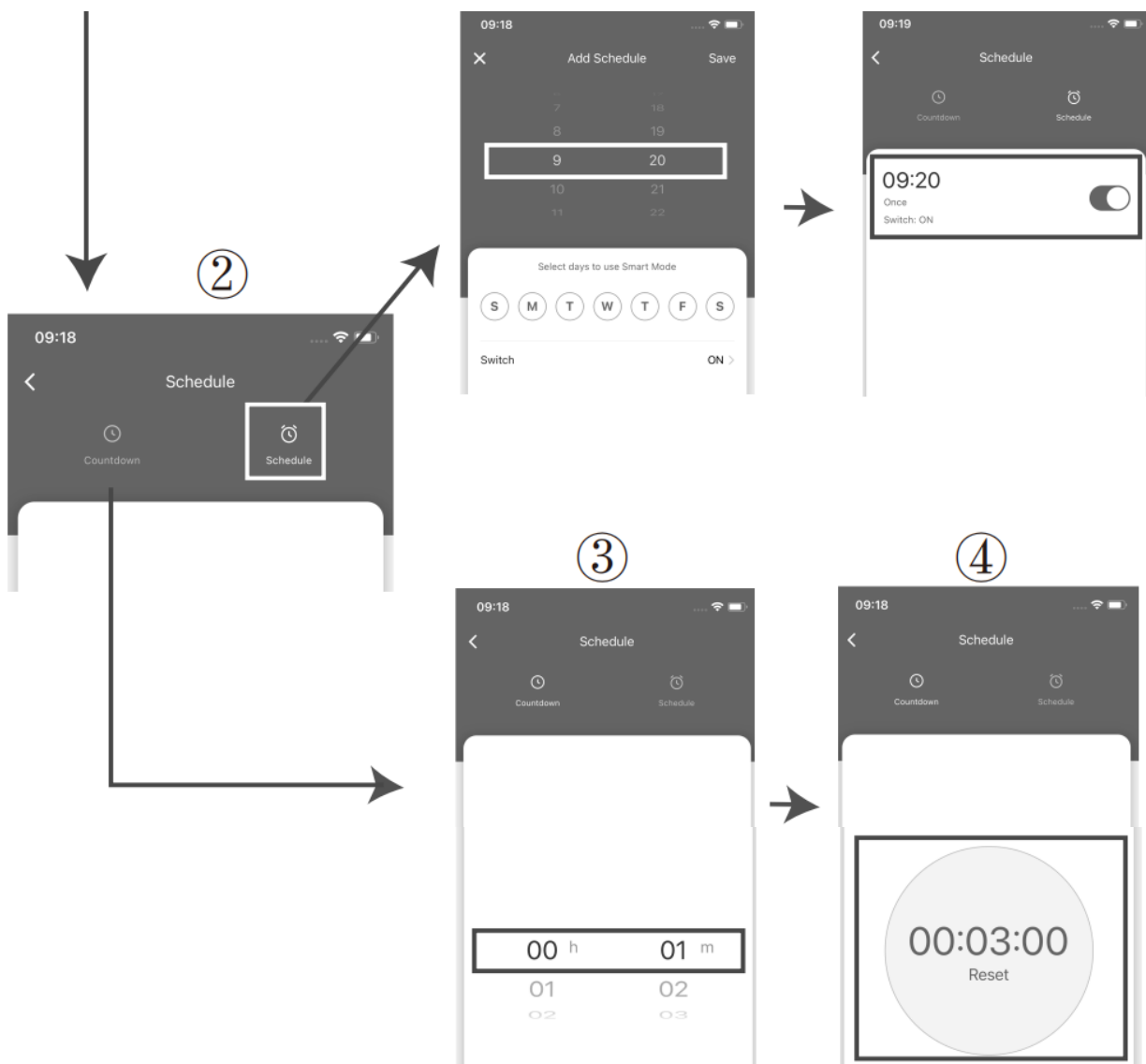

Part 6. Network Configuration

Hold the “down” toggle until the light bulb flashes (blue LED blinks rapidly).

Guidelines for switching between AP Network configuration mode and Normal Network configuration mode

- Normal Network configuration mode to AP Network configuration mode:
When the blue LED indicator flashes quickly, press and hold the “down” toggle for more than 5s until the bulb flashes twice to enter the AP Network configuration mode, and the purple LED indicator flashes quickly.
- AP Network configuration mode to Normal Network configuration mode:
When the purple LED indicator flashes quickly, press and hold the “down” toggle for more than 5s until the bulb flashes 1 time to enter normal mode, and the blue LED indicator flashes quickly.

Part 7. Parameter Settings

The Oran LED indicator flashes 3 times after each parameter setting successfully.)

LED Indicator Status Setting

(This parameter can access you to choose the In lca or o eon w en e switch (light) is on/off, or LED indicator remains on/off all times.)

1. Value=1 LED is On when the switch (light) On and LED is Off when the switch (light) Off.
2. Value=2 (default) LED is On when the switch (light) Off and LED is Off when the switch (light) On.
3. Value=3 LED is always Off.

Operation: Quickly press “down” toggle 5 times.

Please note: the switching of each value is in order, a quick press “down” toggle 5 times will switch once. eg: Switching from value 0 to value 3 needs 3 switchings.

Restores State after Power Failure

(This parameter can access you to set the switch to be on/off after power failure.)

1. Value=1 The switch is off regardless of the state prior to power failure
2. Value=2 The switch is on regardless of the state prior to power failure
3. Value=3 (default) Memory state before power failure This switch will be return to state prior to the power failure after power is restored.

Operation: Quickly press “up” toggle 5 times.

Please note: the switching of each value is in order, a quick press “up” toggle 5 times will switch once. eg: Switching from value 0 to value 2 needs 2 switchings.

Light off State Setting

(This parameter can access you to set the light fade out or off immediately.)

Value=1 (default) Fade out

Value=2 Instantaneous off

Operation: Quickly press “up” toggle 8 times

Please note: the switching of each value is in order, a quick press “up” toggle 8 times will switch once. eg: Switching from value 1 to value 2 needs 1 switching.

Button Function Setting (This parameter can access you to set the “up” toggle to turn the light on/off.)

1. Value=1 (default) The “up” toggle turn the light on and “down” toggle turn lights off.
2. Value=2 The “up” toggle turn the light off and “down” toggle turn lights on.
3. **Value=3** (default) Memory state before power failure This switch will be return to state prior to the power failure after power is restored.

Operation: Quickly press “down” toggle 8 times

Please note: the switching of each value is in order, a quick press “down” toggle 8 times will switch once. eg: Switching from value 1 to value 2 needs 1

FCC

This device complies with part 15 of the FCC and Industry Canada license-exempt RSS standard(s). Operation is subjected to the following two conditions:

1. this device may not cause harmful interference, and
2. this device must accept any interference received, including interference that may cause undesired operation.

FCC NOTE:

The manufacturer is not responsible for any radio or TV interference caused by unauthorized modifications to this equipment. Such modifications could void the user's authority to operate the equipment.

- Reorient or relocate the receiving antenna.
- Increase the separation between the equipment and receiver.
- Connect the equipment into an outlet on a circuit different from that to which the receiver is connected.
- Consult the dealer or an experienced radio/TV technician for help

NOTE: This equipment has been tested and found to comply with the limits for a Class B digital device pursuant to Part 15 of the FCC Rules. These limits are designed to provide reasonable protection against harmful interference in a residential installation. This equipment generates, uses and can radiate radio frequency energy and, if not installed and used in accordance with the Instructions may cause harmful interference to radio communications. However, there is no guarantee that interference will not occur in a particular installation. If this equipment does cause harmful interference to radio or television reception, which can be determined by turning the equipment off and on, the user is encouraged to try to correct the interference by one or more of the following measures:

Important note: To comply with the FCC RF exposure compliance requirement's, no change to the antenna or the device is permitted. Any change to the antenna or the device could result in the device exceeding the RF exposure requirements and void user's authority to operate the device.

CAUTION – PLEASE READ!

This device is intended for installation in accordance with the National Electric Code and local regulations in the United States, or the Canadian Electrical Code and local regulations in Canada.

If you are unsure or uncomfortable about performing this installation consult a qualified electrician.

WARNING – SHOCK HAZARD

TURN OFF THE POWER to the circuit for the switch and lighting fixture at the service panel (circuit breaker) prior to installation.

ALL WIRING CONNECTIONS MUST BE MADE WITH THE POWER OFF to avoid personal injury and/or damage to the switch.

OTHER WARNINGS

- Risk of Fire
- Risk of Electrical Shock
- Risk of Burns
- V.I.o

Documents / Resources

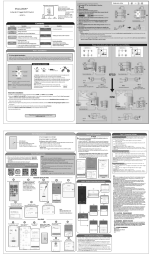

[EVALOGIK WF30TS 3 Way WiFi Toggle On and Off Switch](#) [pdf] User Guide
WF30TS, WF30TS 3 Way WiFi Toggle On and Off Switch, 3 Way WiFi Toggle On and Off Switch
, WiFi Toggle On and Off Switch, Toggle On and Off Switch, Switch

References

- [User Manual](#)

[Manuals+](#), [Privacy Policy](#)

This website is an independent publication and is neither affiliated with nor endorsed by any of the trademark owners. The "Bluetooth®" word mark and logos are registered trademarks owned by Bluetooth SIG, Inc. The "Wi-Fi®" word mark and logos are registered trademarks owned by the Wi-Fi Alliance. Any use of these marks on this website does not imply any affiliation with or endorsement.