



eurolite 70064578 Easy Show DMX Controller User Manual

[Home](#) » [eurolite](#) » eurolite 70064578 Easy Show DMX Controller User Manual 

eurolite®

EASY SHOW
DMX Controller



User Manual

EASY Show

Programmed DMX controller for over 120 Eurolite spotlights



No. 70064578

www.eurolite.de

D00113864, version 1.0, publ. 09/08/2021

For product updates, documentation, software, and support please visit www.eurolite.de. You can find the latest version of this user manual in the product's download section.

© 2021 Eurolite. All rights reserved.

No part of this document may be reproduced in any form without the written permission of the copyright owner. The contents of this document are subject to revision without notice due to continued progress in methodology, design, and manufacturing. Eurolite shall have no liability for any error or damage of any kind resulting from the use of this document.

All trademarks mentioned herein are the property of their respective owners.

Contents

- 1 INTRODUCTION
- 2 IMPORTANT SAFETY INSTRUCTIONS
- 3 OPERATING ELEMENTS AND CONNECTIONS
- 4 GETTING STARTED
- 5 DMX ADDRESSING
- 6 OPERATION
- 7 ADVANCED FUNCTIONS
- 8 CLEANING AND MAINTENANCE
- 9 TECHNICAL SPECIFICATIONS
- 10 Documents / Resources
 - 10.1 References
- 11 Related Posts

INTRODUCTION

Experience Eurolite. Product videos are suitable accessories, firmware, software updates, documentation and the latest news about the brand. You will find this and much more on our website. You are also welcome to visit our YouTube channel and find us on Facebook.



www.eurolite.de

Welcome to Eurolite! Easy Show is a flight controller designed to be as simple as possible, already programmed for a large number of fixtures. You can therefore simply connect your fixtures to the DMX output, set the start addresses, and immediately call up 12 different colors and 24 show programs. If you want to use this basic function, follow the explanations in the main part of this manual.

Easy Show can also be used as a DMX recorder. This allows you to create your own moods and programs with any DMX controller and transfer them to Easy Show. The unit provides a DMX input for this purpose. This function is ideal for experienced lighting technicians who prepare the device for inexperienced users. Read about this in the chapter Advanced functions.

Users of this product are recommended to carefully read all warnings in order to protect themselves and others from damage. Please keep this manual for future needs and pass it on to further owners.

Product features

- Ideal for colored LED spotlights, KLS systems, moving lights, and lighting effects
- No programming is required, simply connect your spotlights and get started
- All spotlights can be freely combined for a show
- 12 color schemes and 24 chases are directly available
- Controls for overall brightness, running speed, fade time, and strobe effect
- Can also be used as a DMX recorder for your own projects
- Data storage on USB flash drives
- QuickDMX connector for wireless DMX connection
- Backlit LCD display
- Compact desktop console
- Includes USB flash drive, USB plug-in power adapter and mounting brackets

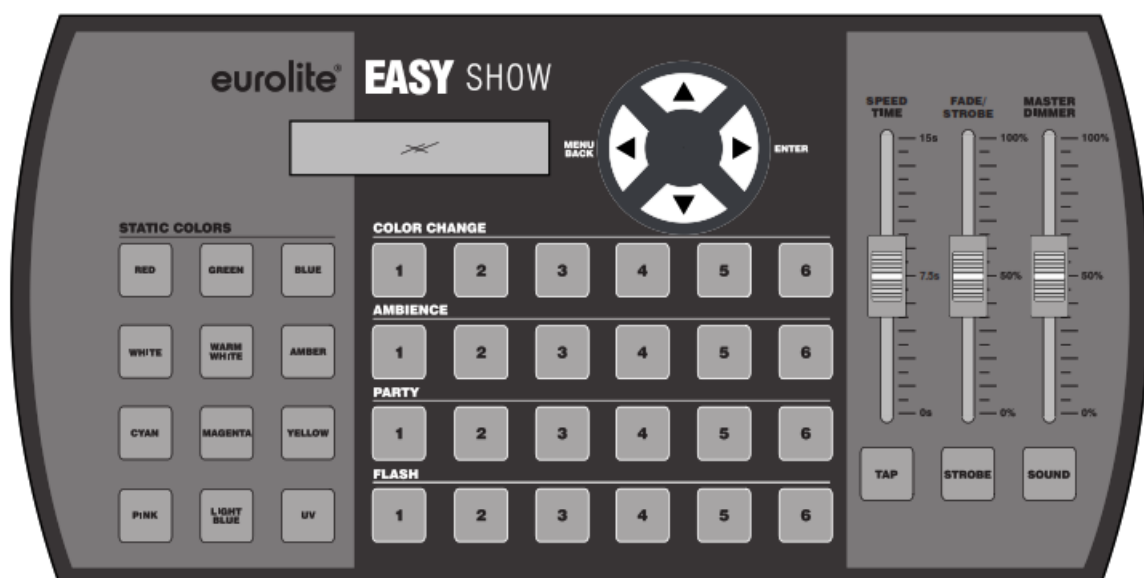

Package contents

- EASY Show
- Power adapter
- Mounting brackets
- Mini USB flash drive
- These instructions

IMPORTANT SAFETY INSTRUCTIONS



CAUTION!

Operating conditions

This device has been designed for indoor use only. Keep this device away from rain and moisture.



DANGER!

Electric shock is caused by short-circuiting I am careful with your operations. With a dangerous voltage, you can suffer a dangerous electric shock when touching the wires!

- Please read these operating instructions carefully before using the product. They contain important information for the correct use of your product. Please keep them for future reference.
- Only use the product according to the instructions given herein. Damages due to failure to follow these operating instructions will void the warranty! We do not assume any liability for any resulting damage.
- We do not assume any liability for material and personal damage caused by improper use or non-compliance with the safety instructions. In such cases, the warranty/guarantee will be null and void.
- Unauthorized rebuilds or modifications of the product are not permitted for reasons of safety and render the warranty invalid.
- Never open any part of the product to prevent a possible electric shock.
- **IMPORTANT:** This product is not an outdoor product! Only for indoor use! Do not use this device near water. The recommended temperature range is -5 to +45 °C.
- To clean the unit, disconnect it from the power source.
- Only use a soft cloth, never use any solvent.
- Do not touch the power cord and connectors with wet hands as it may cause electric shock.
- This product is not a toy. Keep it out of the reach of children and pets. Do not leave packaging material lying around carelessly.



- This unit corresponds to all required directives of the EU and is therefore marked with.

Intended use

EASY Show serves for easy and convenient operation of KLS systems, moving lights, lighting effects, and LED spotlights.



When to be definitively put out of the operation, take the product to a local recycling plant for disposal that is not harmful to the environment. Devices marked with this symbol must not be disposed of as household waste. Contact your retailer or local authorities for more information. Remove any inserted batteries and dispose of them separately from the product.



You as the end-user are required by law (Battery Ordinance) to return all used batteries/rechargeable batteries. Disposing of them in household waste is prohibited. You may return your used batteries free of charge to collection points in your municipality and anywhere where batteries/rechargeable batteries are sold. By disposing of used devices and batteries correctly, you contribute to the protection of the environment.

OPERATING ELEMENTS AND CONNECTIONS

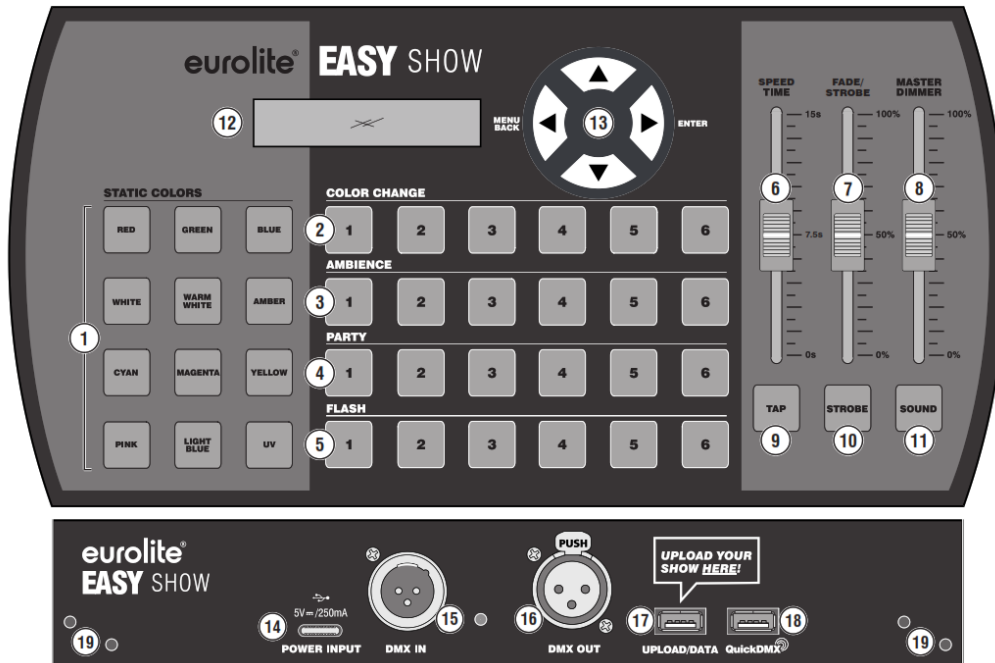

No.	Element	Function
1	STATIC COLORS buttons	For selecting 12 static colors
2	COLOR CHANGE buttons	For selecting multi-color chaser programs
3	AMBIENCE buttons	For selecting two-color chaser programs
4	PARTY buttons	For selecting two-color chaser programs with alternating fixtures
5	FLASH buttons	For selecting fast flashing chaser programs
6	SPEED TIME fader	To adjust the running speed of the programs
7	FADE/STROBE fader	To adjust the fade time or the flash rate when the strobe effect is activated
8	MASTER DIMMER fader	To adjust the overall brightness
9	TAP button	Press twice to set the running speed of the programs
10	STROBE button	To activate the strobe effect
11	SOUND button	To activate sound control
12	Display	Shows the current setting and other important functions
13	Menu buttons	For settings in the system menu
14	Power input	Connect the power adapter provided here
15	DMX input with signal LED	Use this input for DMX recordings
16	DMX output	Connect the DMX chain here
17	UPLOAD/DATA connector	Plug in a USB flash drive here for storing and importing data
18	QuickDMX connector	Plug in a QuickDMX receiver here for a wireless DMX connection
19	Mounting points	For mounting the brackets provided

GETTING STARTED

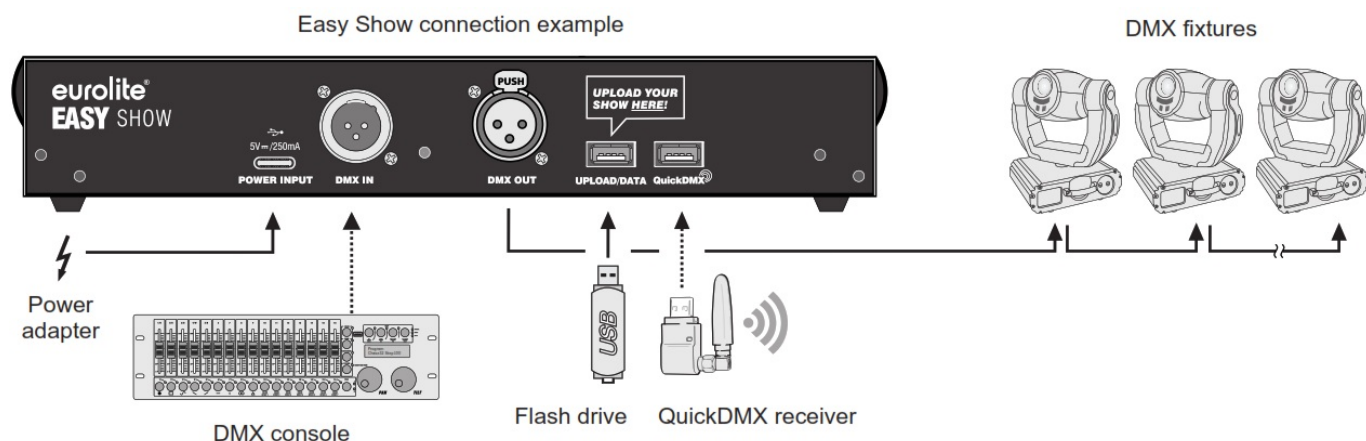

Step 1: Connect the USB flash drive

Easy Show is the easiest way imaginable to control your spotlights. In order for the device to work, first, plug the supplied USB flash drive into the **UPLOAD/DATA** USB port. All programs and settings are stored on the flash drive.

Note

We strongly recommend that you make a backup copy of the flash drive. If the drive is lost or files are accidentally deleted, you can continue working with the backup copy as usual.

Step 2: Connect to the power supply

Connect the power adapter provided to the POWER INPUT jack and plug it into a power outlet. After use, disconnect the power plug again to avoid unnecessary power consumption.

Step 3: Connect your spotlights

Connect the **DMX OUT** socket to the DMX input of the first fixture using a 3-pin DMX cable. Then connect the DMX output of the first fixture in the chain to the DMX input of the next fixture. Always connect one output to the input of the next fixture until all fixtures are connected. For the last fixture, it is often recommended that a terminator be used. In most cases, this is not necessary. Only if you notice a random flickering or twitching in your fixtures, this can be a problem solver.

Step 4: Using a QuickDMX wireless receiver

Easy Show features a second USB port marked with **QuickDMX**. Here you can plug in an optional wireless transmitter or receiver for the QuickDMX system from Eurolite. You can use this connector for wireless transmission of DMX control signals to fixtures with a QuickDMX receiver. The receiver is already integrated into some fixtures, for other fixtures it can be retrofitted. For information on how to set up the transmitters and receivers, please refer to their instructions.

Step 5: DMX addressing

Finally, set the corresponding start address and, if necessary, the DMX mode for the spotlights. Which start address and which mode are required, will be explained in the next chapter.

DMX ADDRESSING

KLS systems

Address KLS systems according to the following table. To control several systems synchronously, they must be assigned the same start address and the same model.

Fixture	Item no.	Mode	Start address
KLS 200	42109700		1
KLS 400	42109780		1
KLS 401	42109781		1
KLS 800	42109850		1
KLS 801	42109851		1
KLS 1001	42109875		1
KLS 30	42109603	16 channels	16
KLS 902 Next	42109860	16 channels	16
KLS 120	42109606	16 channels	16
KLS 2001	42109890	23 channels	33
KLS 2500	42109892	23 channels	33
KLS 3002 Next	42109895	24 channels	56
KLS PARty	42110197	20 channels	80
KLS 170	42109620	16 channels	100
KLS 180	42109630	21 channels	116
KLS 190	42109608	13 channels	137
KLS Laser Bar	51741090	27 channels	150
KLS Laser Bar Pro	51741091	28 channels	150

RGB spotlights (3in1)

Basically, all RGB spotlights with 3 control channels can be used (channel 1: red, channel 2: green, channel 3: blue). There are 4 start addresses provided for these fixtures. If you operate a single spotlight, use the first start address, i.e. 4. If you operate two spotlights, use the first two start addresses, and so on. If you operate more than four spotlights, start again from the beginning with the fifth device, i.e. with 4.

Type	Mode
RGB spotlight	3 channels

Compatible Eurolite RGB fixtures include:

Fixture	Item no.	Fixture	Item no.
SLS 6 TCL	51915361	ML-56 COB RGB 100W bl	41607301
CBB 2 COB RGB	51930274	ML-56 COB RGB 100w sil	41607321
Par-30 COB RGB bl	41607200	Pro Slim Par-6 COB RGB	51842564
Par-30 COB RGB sil	41607225	IP Pad COB RGB 25W	51914155
Par 56 COB RGB 25W bl	41607215	Par-56 COB RGB 60W bl	41607210
Par 56 COB RGB 25W sil	41607240	Par-56 COB RGB 60W sil	41607235
CBB-4 RGB	51930278	CBB-6 RGB	51930279
IP-T1000 TCL	51914123	IP Pad COB RGB 60W	51914165
PML-80 COB RGB	41602595	PMB 8 COB RGB 30W	51930286
Pro Slim Par-12 MK2	51842562	IP Pad COB RGB 180W	51914167
IP Par 12x3W TCL	51914175	SLS-180 RGB 18x1W	51915375
Par 56 COB RGB 100W bl	41607220	Par-65 RGB 10mm Short	51913582
Par 56 COB RGB 100W sil	41607245		

RGBW spotlights (4in1)

Basically, all RGBW spotlights with 4 control channels can be used (channel 1: red, channel 2: green, channel 3: blue, channel 4: white). There are 4 start addresses provided for these fixtures. If you operate a single spotlight, use the first start address, i.e. 16. If you operate two spotlights, use the first two start addresses and so on. If you operate more than four spotlights, start again from the beginning with the fifth device, i.e. with 16.

Type	Mode
RGBW spotlight	4 channels

Compatible Eurolite RGBW fixtures include:

Fixture	Item no.	Fixture	Item no.
Par-56 QCL Short sil	51913592	IP Pad 4x8W QCL	51914156
Par-56 QCL Short bl	51913593	IP Par 14x8W QCL	51914178
Bar-12 QCL RGBW	51930398	CLS-9 QCL RGBW 9x8W	51913888
LED 4c-7 Silent Slim Spot	51915315	Par 64 COB RGBW 120W	41603605
Par-64 QCL 12x8W Flo bl	51914030	CLS-18 QCL RGBW 18x8W	51913889
Par-64 QCL 12x8W Flo sil	51914031	Stage Pixel Bar 5	51841359
4c-12 Silent Slim Spot	51915316	IP Tourlight 120 QCL	51914250
Akku Flat Light 1 sil	41700001	THA-120 PC	41602130
Akku Flat Light 1 bl	41700011	IP Pad 24x8W QCL	51914160
Akku Flat Light 3 sit	41700015	Multiflood Pro IP RGBW	51914136
Akku Flat Light 3 bl	41700016	SLS-144 RGBW Floor	51915280
Pix-12 QCL	51930426	Akku IP Flat Light 1 cr	41700050

RGB+UV spotlights (4in1)

Basically, all RGB+UV spotlights with 4 control channels can be used (channel 1: red, channel 2: green, channel 3: blue, channel 4: UV). There are 2 start addresses provided for these fixtures. Use 486 for the first fixture and 490 for the second. If you operate more than two spotlights, use the two start addresses alternately.

Type	Mode
RGB+UVspotlight	4 channels

Compatible Eurolite RGB+UV fixtures include:

Fixture	Item no.	FixtureItem no.
SLS 603 TCL6UV	51915358	TL-4 QCL RGB&UV
TL-3 RGB&UV Trusslight	51915445	Bar-12 QCL RGB&UV
LED Bar-6 QCL RGB&UV	51930394	

RGBAW spotlights (5in1)

Basically, all RGBAW spotlights with 5 control channels can be used (channel 1: red, channel 2: green, channel 3: blue, channel 4: amber, channel 5: white). There are 4 start addresses provided for these fixtures. If you operate a single spotlight, use the first start address, i.e. 36. If you operate two spotlights, use the first two start addresses and so on. If you operate more than four spotlights, start again from the beginning with the fifth device, i.e. with 36.

Type	Mode
RGBAW spotlight	5 channels

Compatible Eurolite RGBAW fixtures include:

Fixture
ML-56 COB RGBAW 100W
ML-56 COB RGBAW 100W

RGBWA+UV spotlights (6in1)

Basically, all RGBWA+UV spotlights with 6 control channels can be used (channel 1: red, channel 2: green, channel 3: blue, channel 4: white, channel 5: amber, channel 6: UV). There are 4 start addresses provided for these fixtures. If you operate a single spotlight, use the first start address, i.e. 56. If you operate two spotlights, use the first two start addresses and so on. If you operate more than four spotlights, start again from the beginning with the fifth device, i.e. with 56.

Type	Mode
RGBWA+UV spotlight	6 channels

Compatible Eurolite RGBWA+UV fixtures include:

Fixture	Item no.	Fixture	Item no.
LED Bar-3 HCL	51930395	ML-56 HCL 12x10W Floor	51913678
SLS-7 HCL Floor	51915379	PIX-12 HCL	51930406
Par-56 HCL Short sil	51913590	Stage Panel 16 HCL LED	51913891
Par-56 HCL short bl	51913591	IP Par 12x12W HCL	51914187
IP Par 3x12W HCL	51914188	IP T-1000 HCL	51914121
SLS 12-HCL MK2	51915381	IP Pad 9x8w HCL	51914159
PIX-6 HCL	51930401	POS-8 LED HCL	51841367
Pro Slim Par-12 MK2 HCL	51842561	Stage Panel 32 HCL LED	51913893

RGB/CW/WW/A/UV spotlights (7in1)

Basically, all RGB/CW/WW/A/UV spotlights with 7 control channels can be used (channel 1: red, channel 2:

green, channel 3: blue, channel 4: cold white, channel 5: warm white, channel 6: amber, channel 7: UV). There are 2 start addresses provided for these fixtures. Use 178 for the first fixture and 185 for the second. If you operate more than two spotlights, use the two start addresses alternately.

Type	
RGB/CW/WW/A/UV spotlight	7 channels

Compatible Eurolite RGB/CW/WW/A/UV fixtures include:

Fixture	Item no.	Fixture
LED IP Par 12x9W SCL	51914233	LED 7C-7 Silent Slim
LED IP Par 7x9W SCL	51914232	LED 7C-12 Silent Slim
LED IP Par 3x9W SCL	51914235	

Lighting effects

Address these Eurolite fixtures according to the following table. To control several systems synchronously, they must have the same start address and the same model.

Compatible Eurolite fixtures include:

Fixture	Item no.	Mode	Start address
LED B 40 HCL	51918951	11 channels	192
LED B40 Laser	51741087	10 channels	203
LED B40 Laser white	51741088	10 channels	203
LED BR 60	51918320	7 channels	213
LED D-2000	51918317	5 channels	220
LED FE 2500 Hypno	51741084	16 channels	225
LED FE 1750	51741083	13 channels	241
LED Laser Derby	51741086	13 channels	254
LED WF-30	51918545	9 channels	267
LED WF-40	51918544	9 channels	276
LED FE-700	51918616	10 channels	285
LED Z-1000	51918221	10 channels	295
LED Mini D-20 Hybrid	51918202	4 channels	305
LED Gobo Derby	51918330	8 channels	309
LED Super Strobe ABL	52200920	22 channels	464
LED CBT-6	51930281	21 channels	433

Moving heads

Address these Eurolite fixtures according to the following table. Use the same start address when using multiple devices of the same type.

Tip

The fixtures should be set up with the display facing the direction in which the light is emitted. For a good effect, use an even number of moving heads and an inverted pan, and tilt with every second device. Make this adjustment directly on the fixtures. The fixtures will then work in opposite directions, creating a very nice image.

Compatible Eurolite moving heads include:

Fixture	Item no.	Mode	Start address
TMH 75 Hybrid	51785982	21 channels	317
TMH 75 Hybrid white	51786090	21 channels	317
LED TMH 60	51785984	11 channels	338
LED TMH 60 MK2	51785983	11 channels	338
LED TMH 30	51785980	11 channels	338
LED TMH 30 MK2	51785981	11 channels	338
LED TMH 17	51786065	9 channels	349
LED TMH 13	51785972	9 channels	349
LED TMH 46	51785892	16 channels	358
LED TMH W36	51785880	15 channels	374
LED TMH W63	51785880	15 channels	374
LED TMH X4	51785915	16 channels	399
LED TMH S30	51786070	10 channels	389
LED TMH S90	51786075	15 channels	494

Scanners

Scanners of the same type also use the same start address. Pan should be inverted at every second device so that the horizontal axis works in the opposite direction or the pan and tilt axis if both axes should run in the opposite direction.

Compatible Eurolite scanners include:

Fixture	Item no.	Mode	Start address
LED TSL 150	51786119	9 channels	415
LED TSL 200	51786123	9 channels	424

OPERATION

Once Easy Show is connected to the power, the flash drive is plugged in and you have wired and addressed the fixtures correctly, you can start controlling your spotlights. After switching on, the display briefly inserts the firmware version and the device starts with the last setting. This chapter explains the basic functions of the device for which you do not need the four menu buttons arranged in a circle. To avoid accidentally changing anything, you should simply not use the buttons.

Color mode

On the left side, you will find the STATIC COLORS buttons. If you press one of these buttons, the connected spotlights light up in the corresponding color. The display shows the color, e.g. "STCL01" for red. If a fixture can not display a color, either a similar color is displayed or, for some lighting effects, the split colors that make up that color are displayed. UV light, the popular black light effect, can only display by fixtures equipped with UV LEDs.

Color change programs

There are a total of 24 buttons in the center, which you can use to call up various automatic running lights. To start a program, press the program buttons. The LED of the button flashes and the display shows the program, e.g. "PART01 ►" for party program 1. Pressing the button again stops the program at the current position and the button lights up permanently.

Button group	Function
COLOR CHANGE	1-6: multi-color chaser programs using all fixtures
AMBIENCE	1-6: two-color chaser programs using all fixtures
PARTY	1-4: Programs with alternating fixtures, 5-6: programs using all fixtures
FLASH	1-6: fast flashing chaser programs using all fixtures

Brightness and speed adjustment

Use the 3 faders and function buttons on the right side to set programs and moods. The device saves the settings for SPEED TIME and FADE for each program button, which means that they will be retained the next time you call up the programs, even after switching off. To do this, wait 10 seconds after your setting before turning the power off. Also note that when switching programs, the faders may need to be moved again for them to take effect. The display shows all settings:

PART01 steps:002← Program / ►=play, ■ =stop / step
13.45s F079 D255 ← Speed time / Fade time or flash rate / Brightness

Control element	Function
MASTER DIMMER	Controls the overall brightness with 0-100%. Note: A few lighting effects do not support this function and the fader does not work.
FADE/STROBE	This fader has a double function. The further you pull it up, the further you increase the fade time and thus achieve a fade effect for the color change programs. If the strobe function is activated with the STROBE button below (button is lit), the fader controls the flash rate of the spotlights. Note: Not all spotlights support the fade function. Fading is also not possible with the FLASH 1-6 programs.
SPEED TIME	Controls the running speed of the programs, i.e. how long a step is displayed, between 0 and 15 seconds.
TAP	This button also defines the running speed of the programs. Simply press the button twice and the device adopts the time between the two actions for lighting control.
STROBE	This button activates the strobe function. Then the fader above the button controls the flash rate.
SOUND	This button activates the sound control. The color change programs are then synchronized with music impulses picked up via the internal microphone. The microphone sensitivity can be set in the system menu.

Note

With scanners and moving heads, fast settings are not practical. The movement and the color wheels cannot keep up with high speeds and the light becomes very chaotic.

ADVANCED FUNCTIONS

In this chapter, you will learn how to change important system settings and how to use the device as a DMX recorder.

System settings

Press the MENU/BACK button to enter the system settings. Use the ▼/▲ buttons to navigate and set the options. Press the ENTER button to jump forward one menu level. Press BACK to jump backward and exit the system settings.

Display	Function
New Firmware	This function can be used to upload new firmware versions. The password is 1234. Check the product page on www.eurolite.de for more information about this.
Sound Sens	For setting the microphone sensitivity from 0 (low) to 100 (high).
DMX Merge	The device can be used as a simple DMX merger. In this menu, you define up to which DMX address it generates the DMX signal itself and from which value it takes over the signal of an external light controller.
Channel Config	Here you can set for each of the 512 DMX channels whether it is a dimmer channel or a function channel. Dimmer channels are used for master dimming and fade, function channels always remain at their stored value. First select the DMX channel with ▼/▲, confirm with entering and then set the desired function with ▼/▲. Then jump back to the channel selection by entering or to the main level with BACK .
Memory Load	Here you can assign other programs to the memory locations. The function is included for future further developments and is currently not available.
Memory Type	DMX recordings can be made step by step or as time recording (REC over time). Here you can define the desired storage type for each memory location. First select the memory location with ▼/▲, confirm with entering and then set the desired memory type with ▼/▲. Then jump back to the memory location selection with entering or to the main level with BACK .
Enable Record	This function must be activated so that you can make DMX recordings. For this, select the YES setting with ▼/▲ and jump back to the main level with BACK . After recording programs, you should deactivate the function again so that unwanted recordings do not occur.
Factory Reset	This function is used to reset the device to the factory settings. The password for this is 1234.

Operation as DMX recorder

Easy Show can be used as a DMX recorder to record your own moods and chases from another DMX controller. To do this, connect the controller to the DMX IN input. The DMX output is intended for your spotlights. There are 24 memory locations available via the four button groups 1-6 in the center. The recordings can be done step by step or as time recording. Use the step-by-step storage mode if you need the fade function. The REC over time storage mode, on the other hand, allows you to record complex sequences of a larger DMX console. The stored programs can be called up and controlled as described in the chapter Operation.

Step by step recordings

1. Activate the recording function in the Enable Record menu item.
2. In the **Memory Type** menu item, select the step-by-step memory type for the desired memory location.
3. Exit the menu with BACK.
4. **Briefly** press the button of the memory location for recording.
5. Press the memory location button again for **3 seconds**.

The display shows the memory location and **steps:000**.

CLCG01 steps:000

press 3s to save

6. Create the first mood on your DMX console and briefly press the memory location button to save the first step.
The display now shows steps:001.
7. Repeat step 6 to record further steps.
8. Finally, press the memory location button for 3 seconds to save the recording.
9. Recordings cannot be edited. Pressing a memory location button for a long time deletes the stored programming.

REC over time recordings

1. Activate the recording function in the Enable Record menu item.
2. In the Memory Type menu item, select the REC over time memory type for the desired memory location.
3. Exit the menu with BACK.
4. Briefly press the button of the memory location for recording.
5. Press the memory location button again for 3 seconds.

The display shows the memory location and the duration of the recording.

CLCG03 00:00:00

press 3s to save

6. Briefly press the memory location button to start the recording. The display now shows ► .
7. Briefly press the memory location key to end the recording. The display now shows ■ .
8. Finally, press the memory location key for 3 seconds to save the recording.
9. Recordings cannot be edited. Pressing a memory location button for a long time deletes the stored programming.

Note

Recordings are stored on the USB flash drive. You can easily duplicate the flash drive on a computer to create backup copies. This allows you to continue working with the backup copy after a defect or accidental deletion of programs. Rental companies can use this function to store special setups on a different flash drive for their customers.

CLEANING AND MAINTENANCE

The product is maintenance-free, except for occasional cleaning. You can use a lint-free, slightly dampened cloth for cleaning. Refer all servicing to qualified personnel.

TECHNICAL SPECIFICATIONS

Power supply:	100-240 V AC, 50/60 Hz via included power adapter (5 V/250 mA)
Power consumption:	1.25 W
DMX512 connectors:	3-pin XLR
QuickDMX connection:	USB-A
Storage connection:	USB-A
Sound-control:	via built-in microphone or RCA input
Dimensions (W x D x H):	280 x 145 x 60 mm
Weight:	1.3 kg

Specifications are subject to change without notice due to product improvements.

Pin connection:

<p>DMX-output XLR mounting socket:</p> 	<p>DMX-Input XLR mounting plug:</p> 
--	---

eurolite[®]

Eurolite is a brand of Steinigke Showtechnic GmbH Andreas-
Bauer-Str. 5 97297
D00113864 Version 1.0 Publ. 09/08/2021



Documents / Resources

	<p>eurolite 70064578 Easy Show DMX Controller [pdf] User Manual 70064578, Easy Show, DMX Controller, Easy Show DMX Controller, 70064578 Easy Show DM X Controller</p>
---	---

References

-  [Eurolite: Ihre Experten für Licht - Hersteller von Lichteffekten](#)

Manuals+.