



## eufy T8420 Security Floodlight Camera User Guide

[Home](#) » [Eufy](#) » eufy T8420 Security Floodlight Camera User Guide

### eufy T8420 Security Floodlight Camera User Guide



Anker Innovations Limited. All rights reserved. Eufy Security and Eufy Security Logo are trademarks of Anker Innovations Limited, registered in the United States and other countries. All other trademarks are the property of their respective owners.

## Contents [ [hide](#)

- 1 Safety Instructions
- 2 What's in the Box
- 3 Getting Started
- 4 Installing the Junction Box
- 5 Mounting Floodlight Camera
  - 5.1 Hang Floodlight Camera
  - 5.2 Mount Floodlight Camera On the Junction Box
- 6 Adjusting Floodlight Camera
  - 6.1 Restoring Power
  - 6.2 Using the Floodlight Camera on the Eufy Security App
- 7 FCC Statement
- 8 Customer Service
- 9 Documents / Resources
  - 9.1 References
- 10 Related Posts

## Safety Instructions

1. Shut off power at the fuse or circuit breaker before installing.
2. Do not install the device near flammable surfaces.
3. Must have a licensed electrician install the Floodlight Camera.
4. Do not use the device in environments where the temperature is too high or too low, avoid exposing the device to direct sunshine or very wet environments.
5. The suitable temperature for the product and accessories is -20°C to 50°C

## What's in the Box

- Floodlight Camera (T8420X)

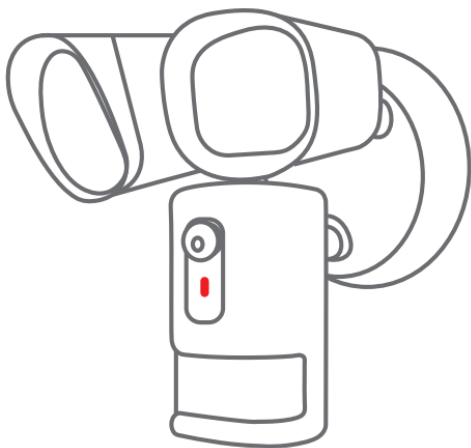

- Junction Box

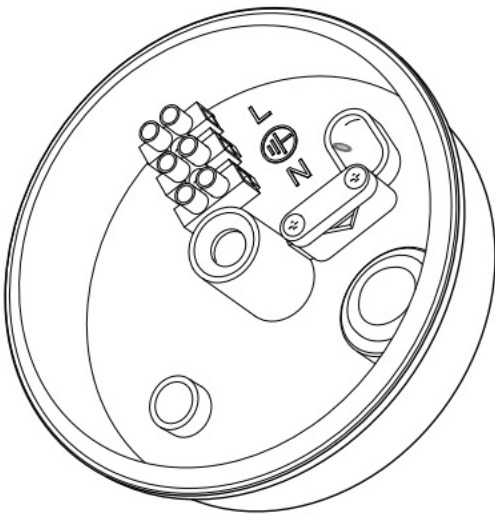

- Installation Hook



- Central Screw



- Central Screw Cap



- Plate Screws



## Getting Started

1. Shut the power off at the breaker in your house. Switch on/off the lights to make sure the electricity in your house is properly shut off.

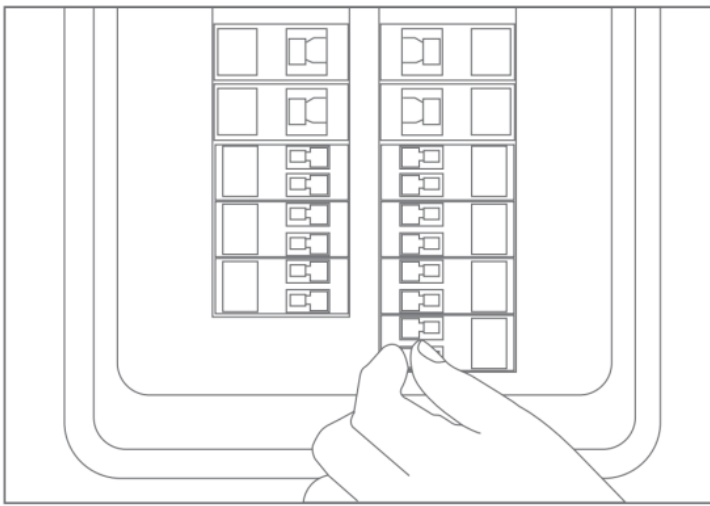

2. Determine the area you want to be lit and camera coverage is required. Install your Floodlight Camera on the front wall or on a side wall of your house. To get optimal detection and light coverage for the floodlight and camera, install it on a side wall if possible. \*

\* The motion sensor is more sensitive to movements across the camera field of view than movements towards or away from the sensor. We highly recommend you install the floodlight camera on the side wall.

- On the side wall:

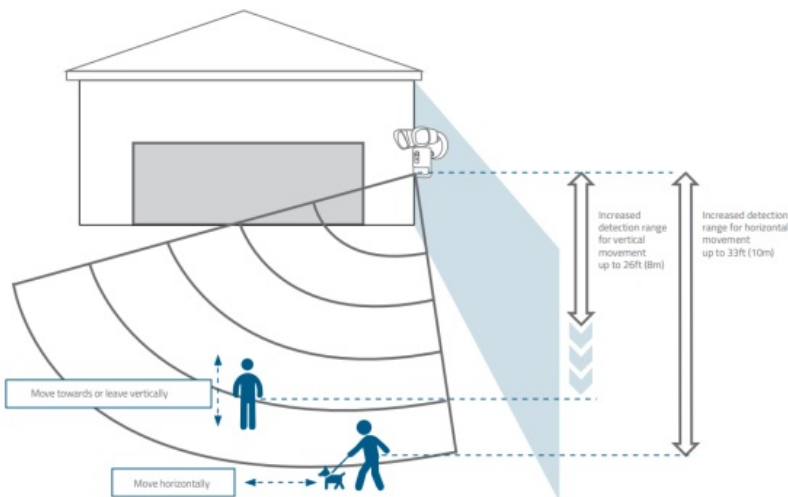

- On the front wall:

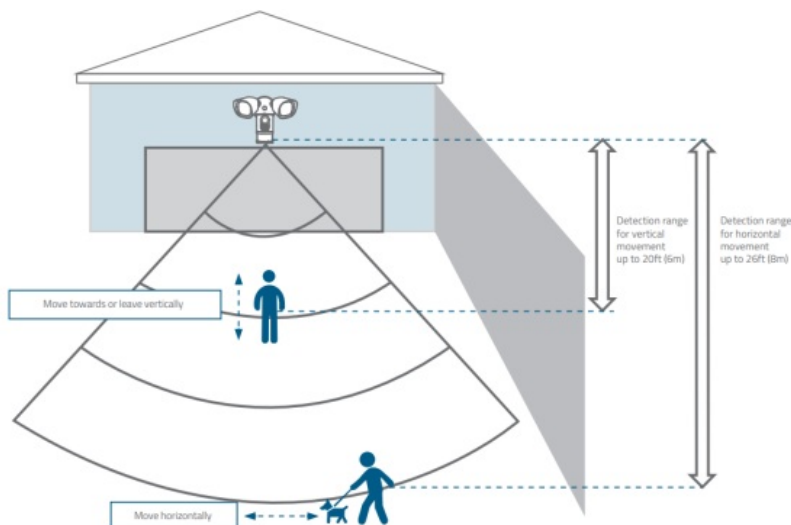

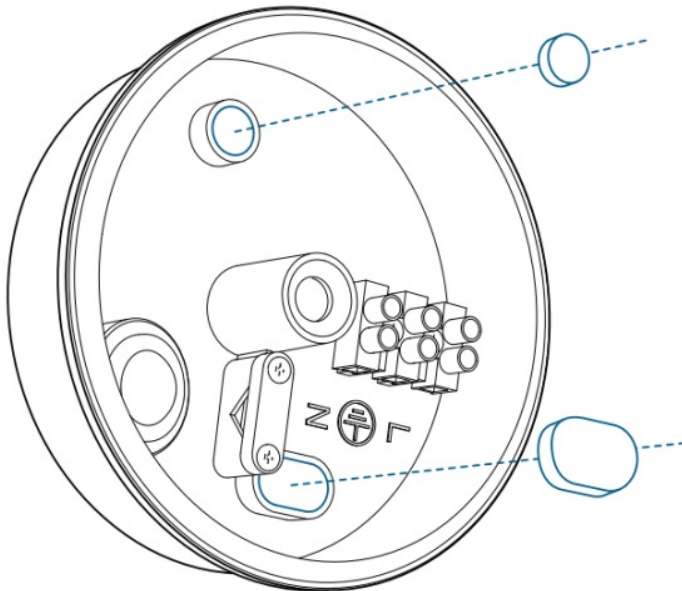

## Installing the Junction Box

1. Remove the rubber plugs indicated in the illustration below.

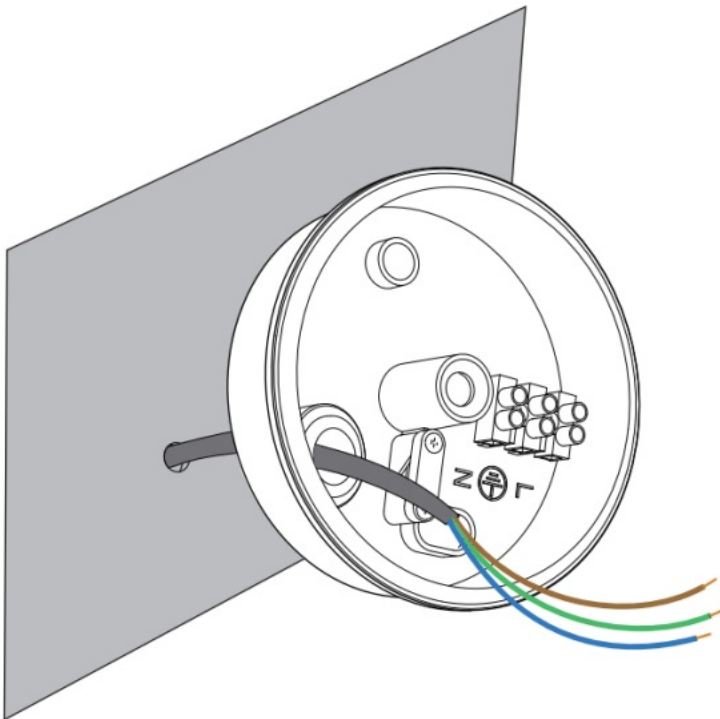

2. Run the existing wire through the hole.



 If you don't have existing wires outdoors, contact a licensed electrician to run the wires.

3. Install the junction box:

- Orientate the two mounting holes vertically to ensure stable mounting.
- On wooden walls, DO NOT pre-drill holes. Use the screws provided to fix the junction box onto the wall.

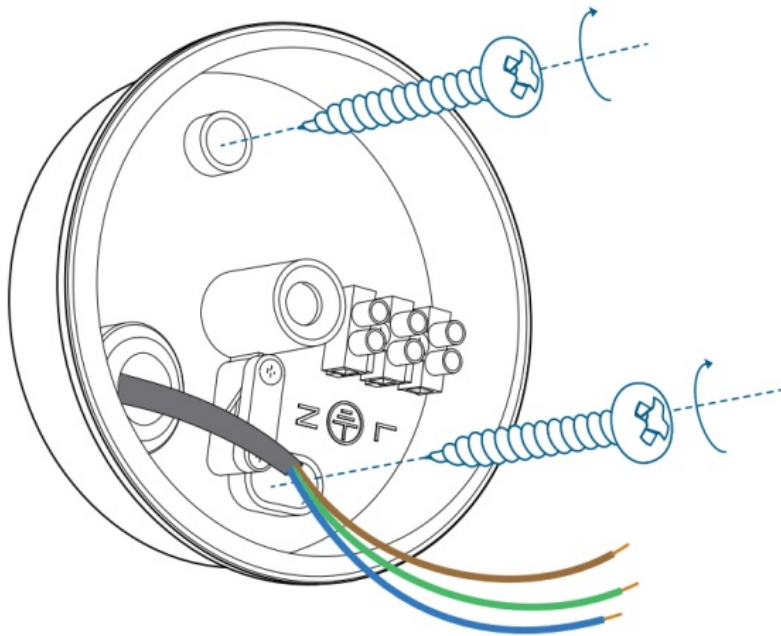

- On walls that are made out of hard materials, such as stucco, brick, or concrete, drill holes with a 15/64 inch (6 mm) drill bit, and then insert the anchors provided into the holes. Use the screws provided to fix the junction box on the wall.

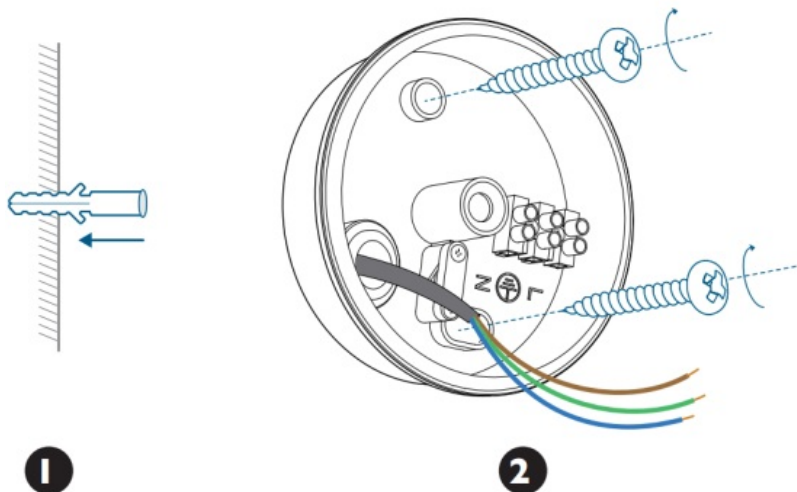

4. Unscrew the bolt with a flat-head screwdriver. Connect the Neutral (blue) / Ground (green / green and yellow) / Live (brown) wire to the Neutral / Ground / Live wire connector in the junction box respectively. Secure the wires tightly to prevent wires from falling.

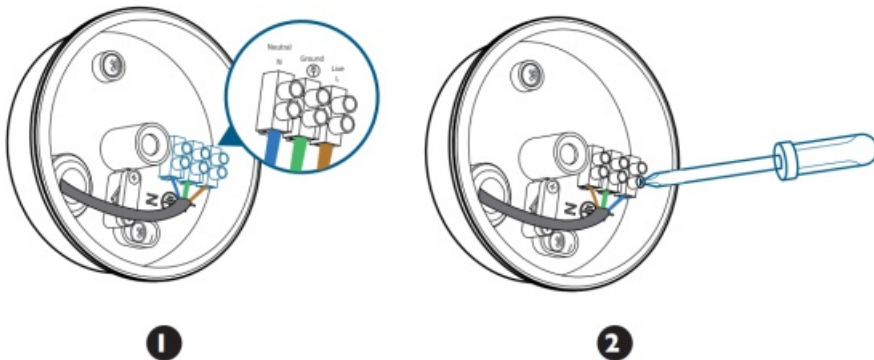

## Mounting Floodlight Camera

### Hang Floodlight Camera

Hang Floodlight Camera on the junction box with the hook provided.

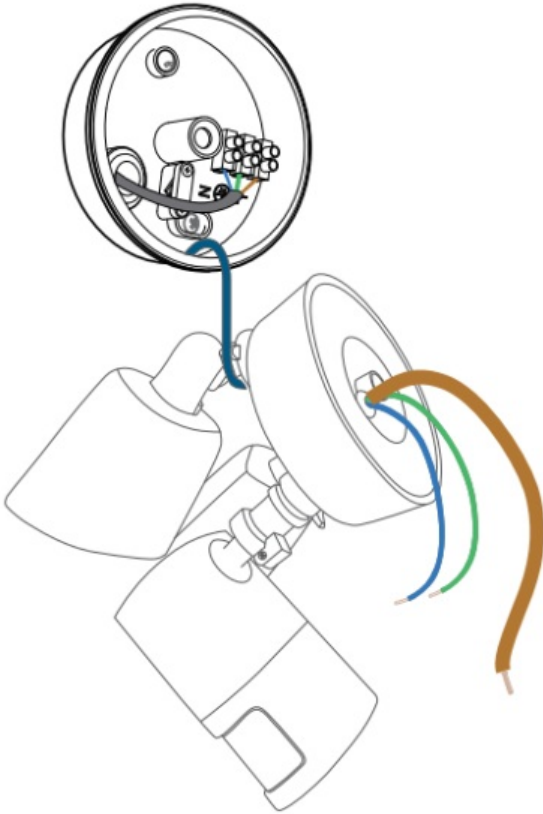

### Connect Wires

1. Connect Ground wire from the Floodlight Camera to the Ground wire from the wire connector in the junction box.
2. Connect the Live / Neutral wire from the Floodlight Camera to the Live / Neutral wire from the wire connector in the junction box respectively.

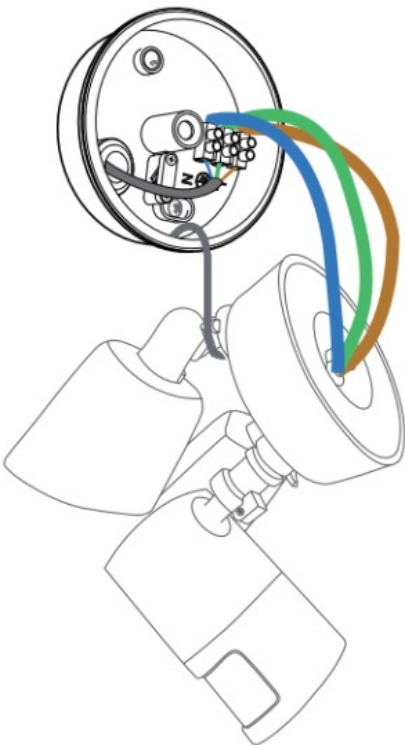

3. Secure the wires with a flat-head screwdriver.



Green / green and yellow, brown and blue wires must connect to the matching colors. Never cross connect.

### Mount Floodlight Camera On the Junction Box

1. Align the hole on the junction box with the opening in the Floodlight Camera.
2. Screw the central screw through the center of Floodlight Camera to mount it in position.

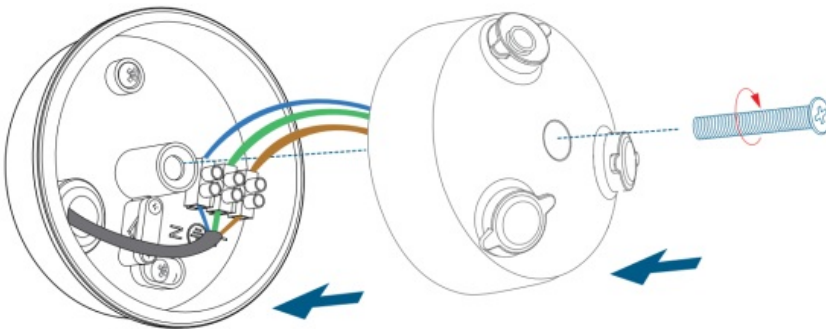

3. Cover the central screw with the central screw cap to prevent it from rusting.

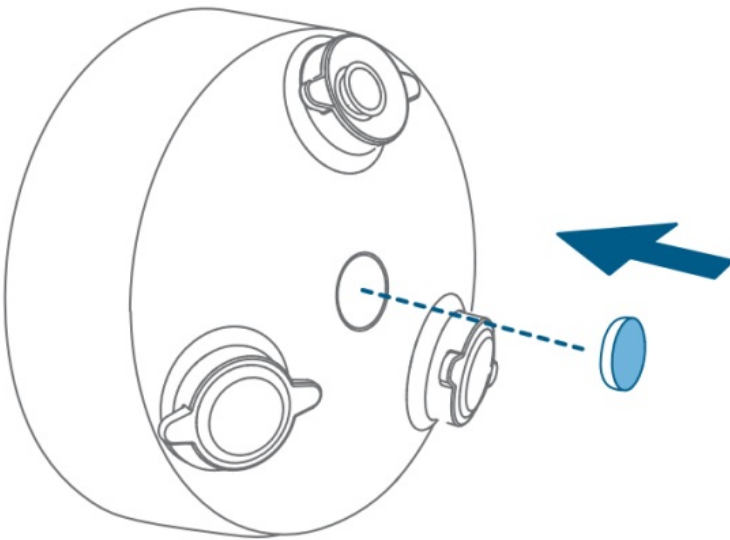

### Adjusting Floodlight Camera

1. After installation is complete, loosen the adjustment screws on the camera and floodlight to adjust the camera and light position to the desired angles.
2. Tighten the screws firmly to complete the installation.

### Restoring Power

Switch on the main circuit breaker in the house. To confirm whether the Floodlight Camera is operating, check the LED indicator. If it is flashing red, it is ready for Eufy Security App setup.



If Floodlight Camera is not powered on, switch off the circuit breaker before checking the wiring of Floodlight Camera.

### Using the Floodlight Camera on the Eufy Security App

1. Download the Eufy Security app from the App Store (iOS devices) or Google Play (Android devices).





2. Sign up for a Eufy Security account. Follow the onscreen instructions to connect Floodlight Camera to your Wi-Fi network. Now you can check live stream in the Eufy Security App.



The Floodlight Camera can be used only after your phone and the Floodlight Camera are connected to the same wireless network.

For troubleshooting, check the Help section in the Eufy Security app. Refer to the app for information on the various LED status indications.

## NOTICE

### FCC Statement

This device complies with Part 15 of the FCC Rules. Operation is subject to the following two conditions: (1) this device may not cause harmful interference, and (2) this device must accept any interference received, including interference that may cause undesired operation.

**Warning:** Changes or modifications not expressly approved by the party responsible for compliance could void the user's authority to operate the equipment.

**Note:** This equipment has been tested and found to comply with the limits for a Class B digital device, pursuant to Part 15 of the FCC Rules. These limits are designed to provide reasonable protection against harmful interference in a residential installation.

This equipment generates uses and can radiate radio frequency energy and, if not installed and used in accordance with the instructions, may cause harmful interference to radio communications. However, there is no guarantee that interference will not occur in a particular installation. If this equipment does cause harmful interference to radio or television reception, which can be determined by turning the equipment off and on, the user is encouraged to try to correct the interference by one or more of the following measures:

1. Reorient or relocate the receiving antenna.
2. Increase the separation between the equipment and receiver.
3. Connect the equipment into an outlet on a circuit different from that to which the receiver is connected.
4. Consult the dealer or an experienced radio/ TV technician for help.

### FCC Radio Frequency Exposure Statement

The device has been evaluated to meet general RF exposure requirements.

The device can be used in fixed/mobile exposure condition. The min separation distance is 20cm.

### Notice: Shielded cables

All connections to other computing devices must be made using shielded cables to maintain compliance with FCC regulations.

The following importer is the responsible party

**Company Name:** POWER MOBILE LIFE, LLC

**Address:** 400 108th Ave NE Ste 400, Bellevue, WA 98004-5541

**Telephone:** 1-800-988-7973



This product complies with the radio interference requirements of the European Community.

### Declaration of Conformity

Hereby, Anker Innovations Limited declares that this device is in compliance with the essential requirements and other relevant provisions of Directive 2014/53/EU. For the declaration of conformity, visit [www.eufylife.com](http://www.eufylife.com)

Do not use the Device in the environment at too high or too low temperature, never expose the Device under strong sunshine or too wet environment. The suitable temperature for the product and accessories is -20°C-50°C.

**RF exposure information:** The Maximum Permissible Exposure (MPE) level has been calculated based on a distance of  $d=20$  cm between the device and the human body. To maintain compliance with RF exposure requirement, use product that maintain a 20cm distance between the device and the human body.

CAUTION RISK OF EXPLOSION IF BATTERY IS REPLACED BY AN INCORRECT TYPE. DISPOSE OF USED BATTERIES ACCORDING TO THE INSTRUCTIONS

Wi-Fi Operating Frequency Range: 2412~2472MHz for EU;

Wifi Max Output Power: 18.98dBm (ERIP)



This product is designed and manufactured with high quality materials and components, which can be recycled and reused.



This symbol means the product must not be discarded as household waste, and should be delivered to an appropriate collection facility for recycling. Proper disposal and recycling helps protect natural resources, human health and the environment. For more information on disposal and recycling of this product, contact your local municipality, disposal service, or the shop where you bought this product.

### IC Statement

This device complies with Industry Canada licence-exempt RSS standard(s).

Operation is subject to the following two conditions:

1. this device may not cause interference, and
2. this device must accept any interference, including interference that may cause undesired operation of the device."

## IC RF Statement

When using the product, maintain a distance of 20cm from the body to ensure compliance with RF exposure requirements.

FCC ID: 2AOKB-T8420X IC: 23451-T8420X

Anker Innovations Limited

Room 1318-19, Hollywood Plaza, 610 Nathan Road, Mongkok, Kowloon, Hong Kong

## Customer Service

### Warranty

12-month limited warranty.

### Call Us

United States +1 (800) 988 7973 Mon-Fri 9AM-5PM (PT)

United Kingdom +44 (0) 1604 936 200 Mon-Fri 6AM-11AM (GMT)

Germany +49 (0) 69 9579 7960 Mo-Fr 6:00-11:00

### Email Us

Customer Support: [support@eufylife.com](mailto:support@eufylife.com)

Anker Innovations Limited

Room 1318-19, Hollywood Plaza, 610 Nathan Road, Mongkok,  
Kowloon, Hong Kong

 @EufyOfficial

 @EufyOfficial

 @EufyOfficial



## Documents / Resources

	<a href="#">eufy T8420 Security Floodlight Camera</a> [pdf] User Guide T8420X, 2AOKB-T8420X, 2AOKBT8420X, T8420, Security Floodlight Camera
---	--

## References

-  [Smart Home Simplified](#)

