



## eufy T8171 SoloCam E30 2K Wireless Security Camera Installation Guide

[Home](#) » [Eufy](#) » eufy T8171 SoloCam E30 2K Wireless Security Camera Installation Guide 

### Contents

- [1 eufy T8171 SoloCam E30 2K Wireless Security Camera](#)
- [2 What's in the Box](#)
- [3 AT A GLANCE](#)
- [4 CHARGING YOUR CAMERA](#)
- [5 MOUNTING YOUR CAMERA](#)
- [6 SAFETY](#)
- [7 Declaration of Conformity](#)
- [8 Documents / Resources](#)
  - [8.1 References](#)



**eufy T8171 SoloCam E30 2K Wireless Security Camera**



## What's in the Box



eufy SoloCam E30  
(T8171)

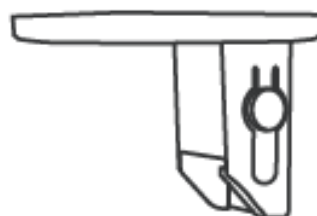

Camera Mounting  
Bracket



Solar Panel



Mounting Bracket of  
the Solar Panel

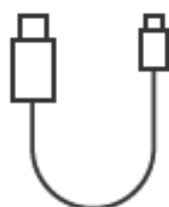

USB-C Cable  
10 ft (3 m)

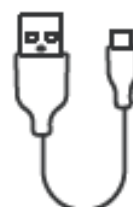

USB-C Cable



Screw Pack x 2



Quick Start Guide

## AT A GLANCE

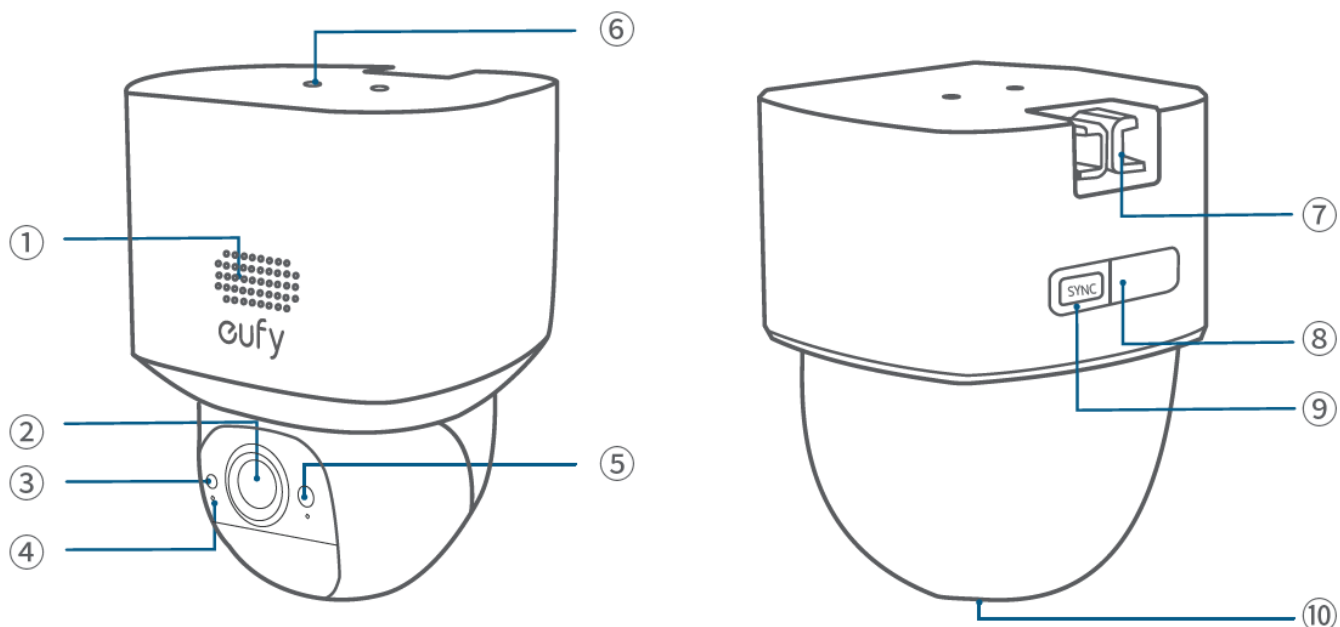

1. Speaker
2. Lens
3. Photosensitive Sensor
4. Microphone
5. LED Indicator
6. Solar Panel Mounting Hole
7. Mounting Hook
8. USB-C Charging Port
9. SYNC Button
10. SD Card Slot

### Solar Panel

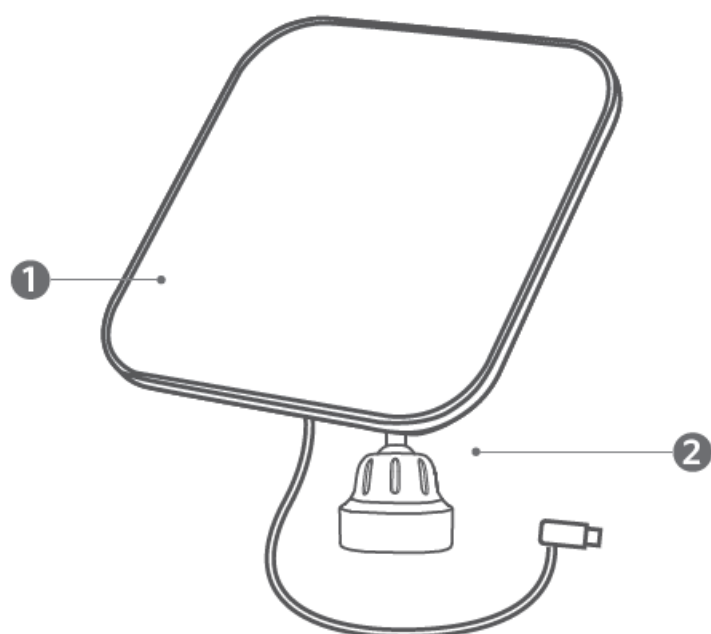

1. Solar panel

2. Mounting bracket

CHARGING YOUR CAMERA

Fully charge before first use.

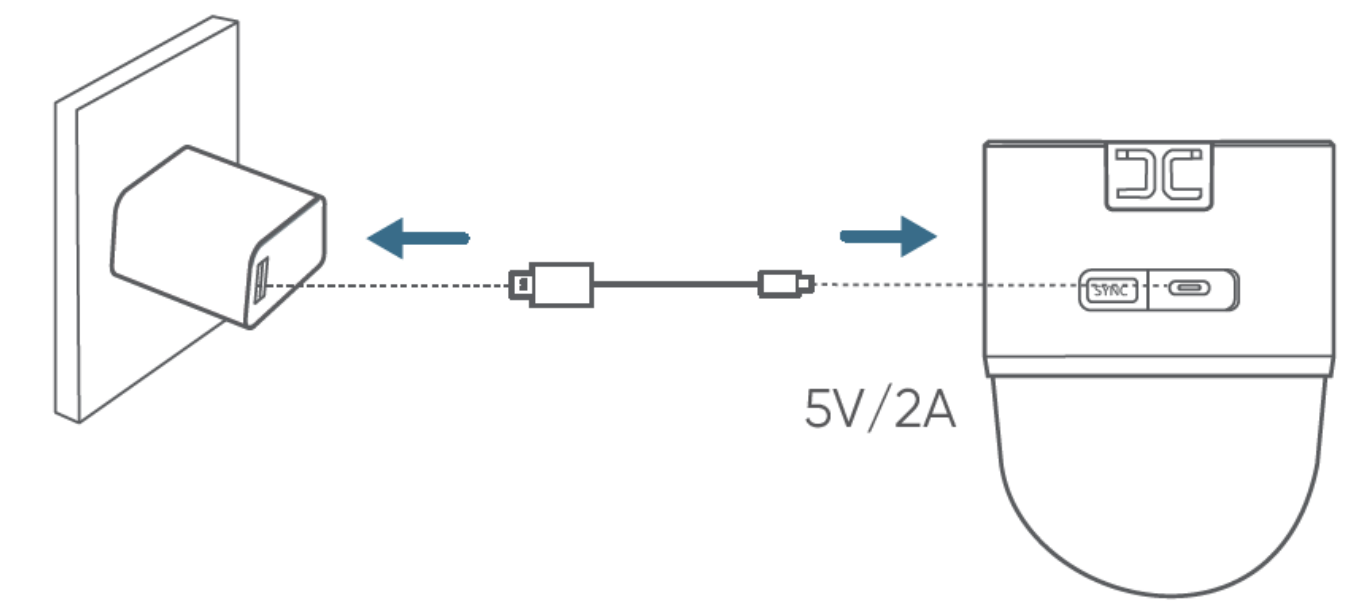

Solid Blue	Charging
Light Off	Fully Charged
Charging Time	8 Hours

SETTING UP THE SYSTEM

1. Download and install the eufy Security app, then sign in or create an account.
2. Follow the in-app instructions to add the camera to the device list.

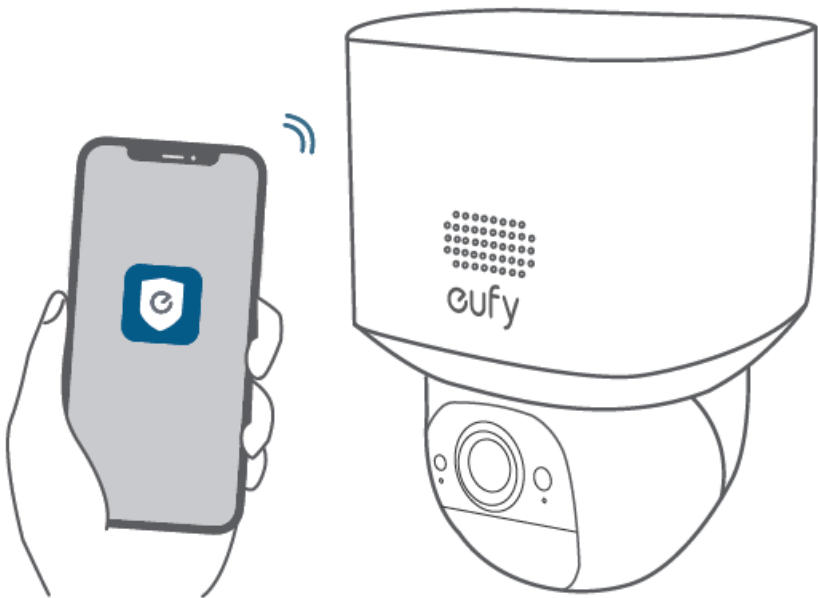

## MOUNTING YOUR CAMERA

### Select a Location and a Height

Select a location where you can get the desired view. We recommend hanging the camera 7-10 ft (2-3 m) above the ground.

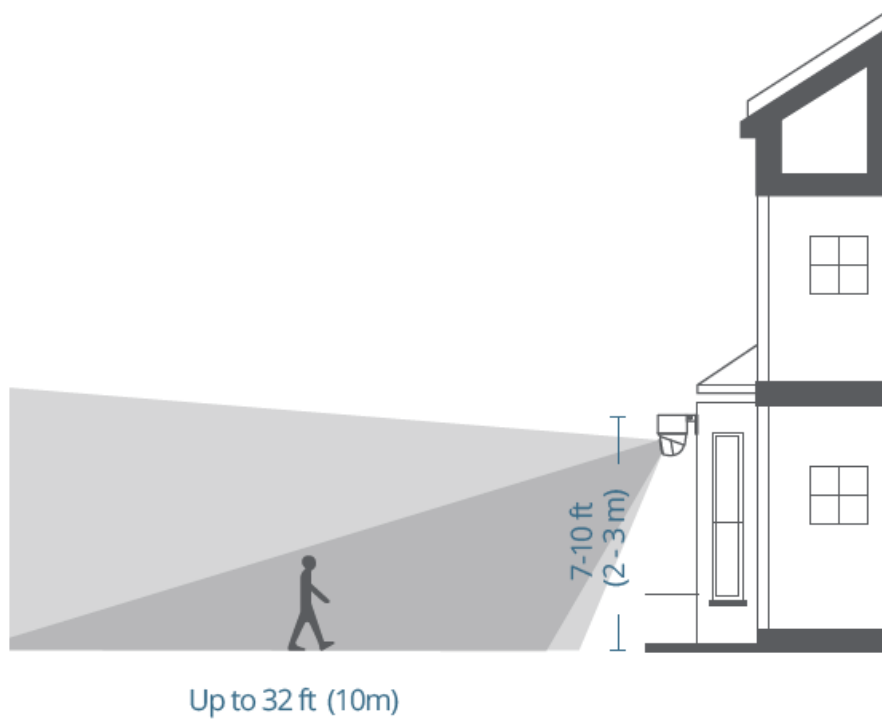

To ensure that no detection is missed, do not install the camera directly facing the monitoring area. Instead, maintain an angle to avoid any potential blind spots.

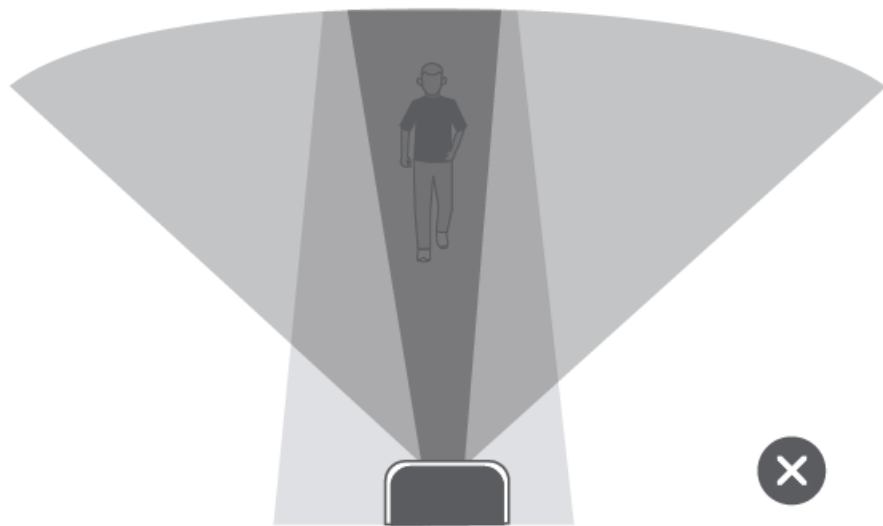
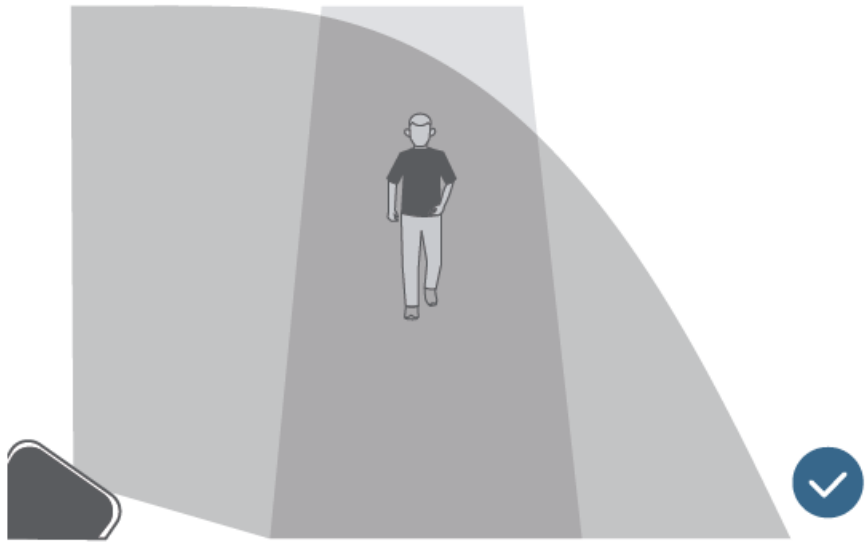

### Select a Solar Panel Location

#### There are two ways to install the solar panel:

Option 1 – if the camera is blocked, install the solar panel in a different position to maximize the solar panel efficiency.

Option 2 – if the camera is not blocked, install the solar panel directly on the top of the camera.

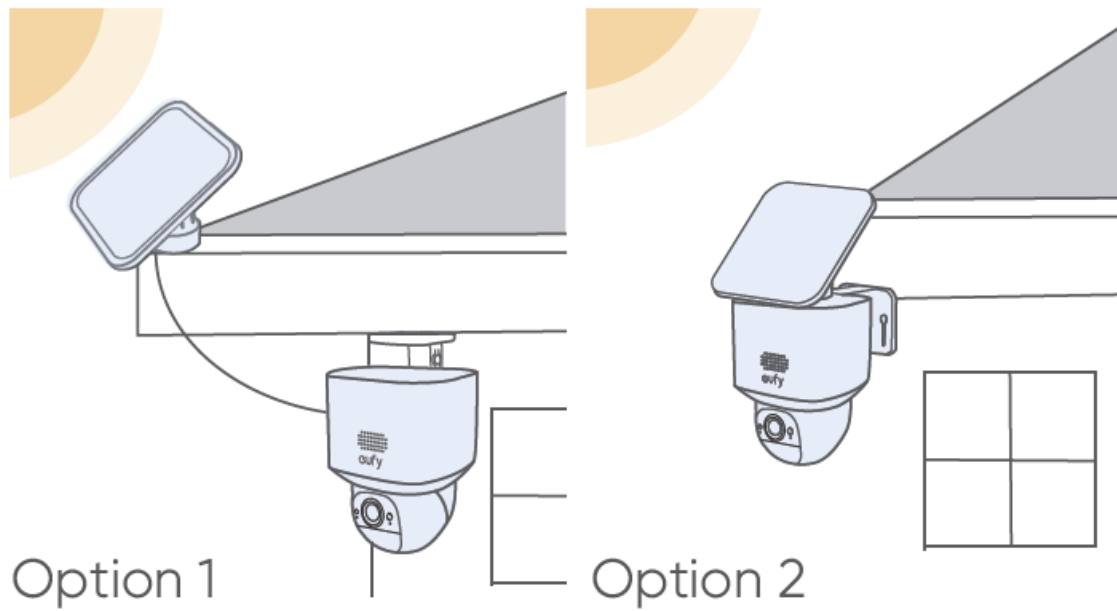

**Option 1: Mount the Camera and the Solar**

Panel Separately (Best for Strong Solar Power)

The camera can be mounted on a wall or under the eave.



Camera mounted on the wall

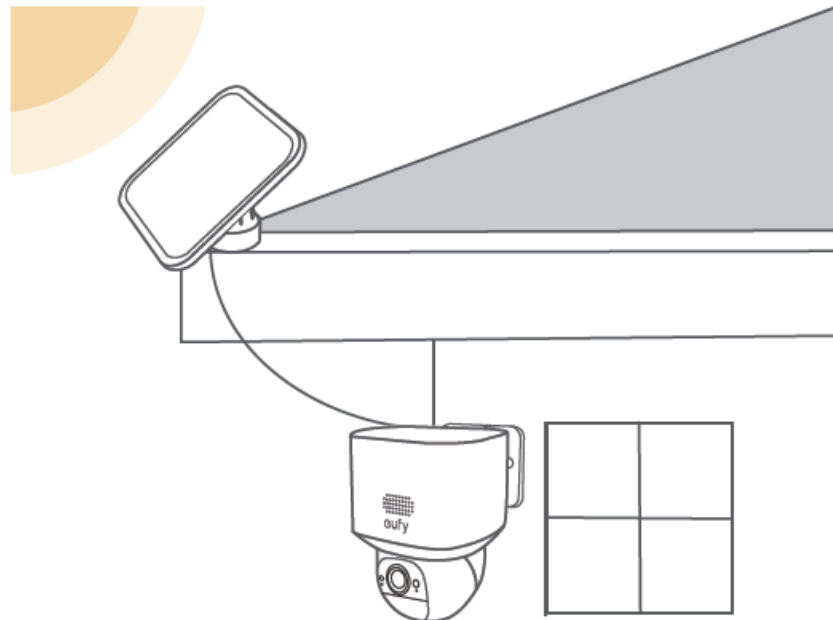

Camera mounted under the eave

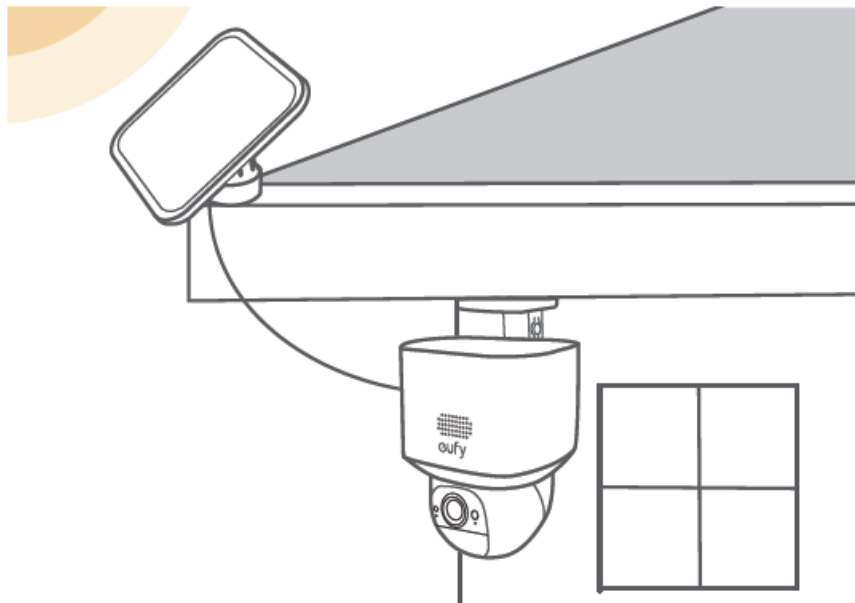

1. Drill holes with a 15/64 inch (5.95 mm) drill bit with the provided positioning card, then insert the anchors into the holes.
2. Connect the solar panel to the camera using the provided USB-C extension cable.
3. Firmly secure the camera onto the mounting bracket.

1. Drill holes with a 15/64 inch (5.95 mm) drill bit with the provided positioning card, then insert the anchors into the holes.

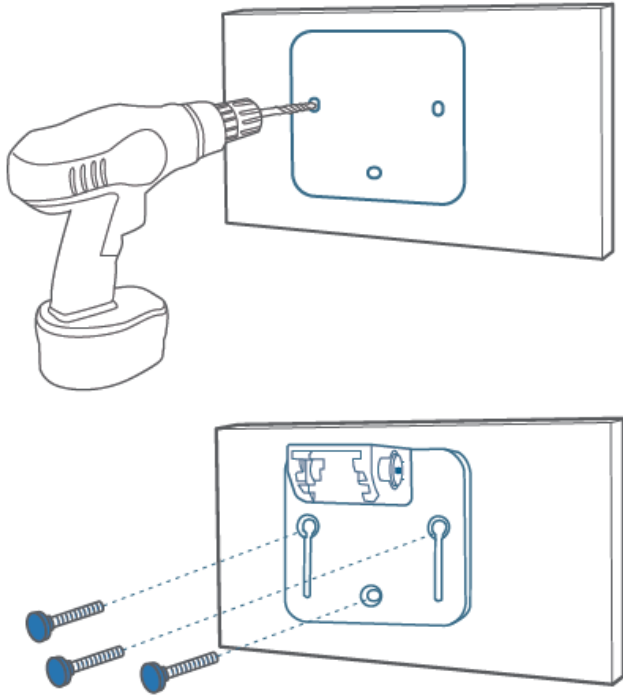

2. Connect the solar panel to the camera using the provided USB-C extension cable.

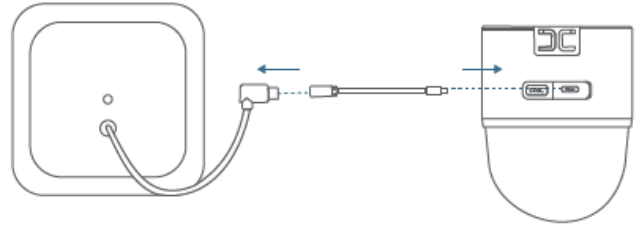

3. Firmly secure the camera onto the mounting bracket.

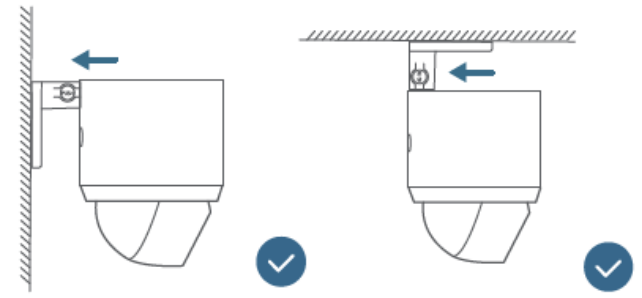

4. Install the mounting bracket of the solar panel in a suitable position.

- Unscrew the knob of the mounting bracket of the solar panel (1), and remove the supporting piece (2).
- Reinstall the supporting piece into the base, and screw the mounting bracket tightly.
- Secure the base of the mounting bracket to your desired position with 2 screws.



Be careful not to install by mistake.

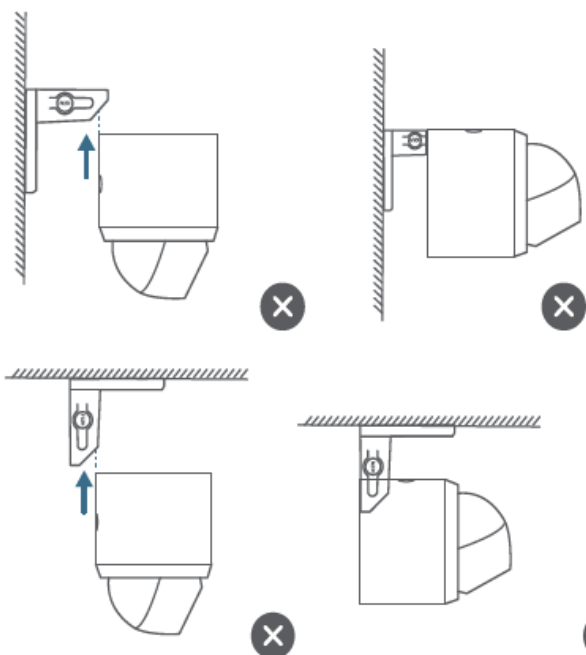

4. Install the mounting bracket of the solar panel in a suitable position.

a. Unscrew the knob of the mounting bracket of the solar panel (1), and remove the supporting piece (2).

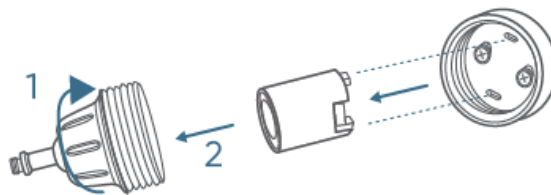

b. Reinstall the supporting piece into the base, and screw the mounting bracket tightly.

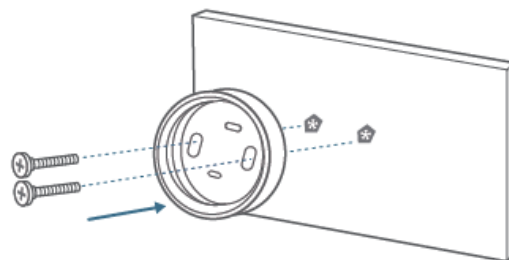

c. Secure the base of the mounting bracket to your desired position with 2 screws.

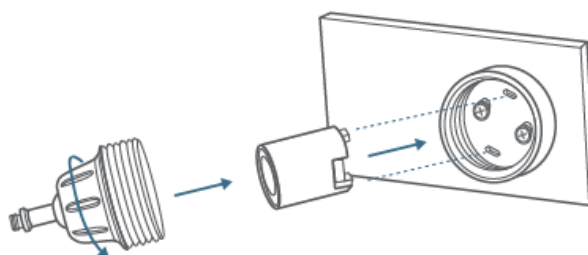

5. Install the solar panel onto its mounting bracket by turning it, then adjust the angle ( $20^{\circ}$ ~ $30^{\circ}$  recommended).

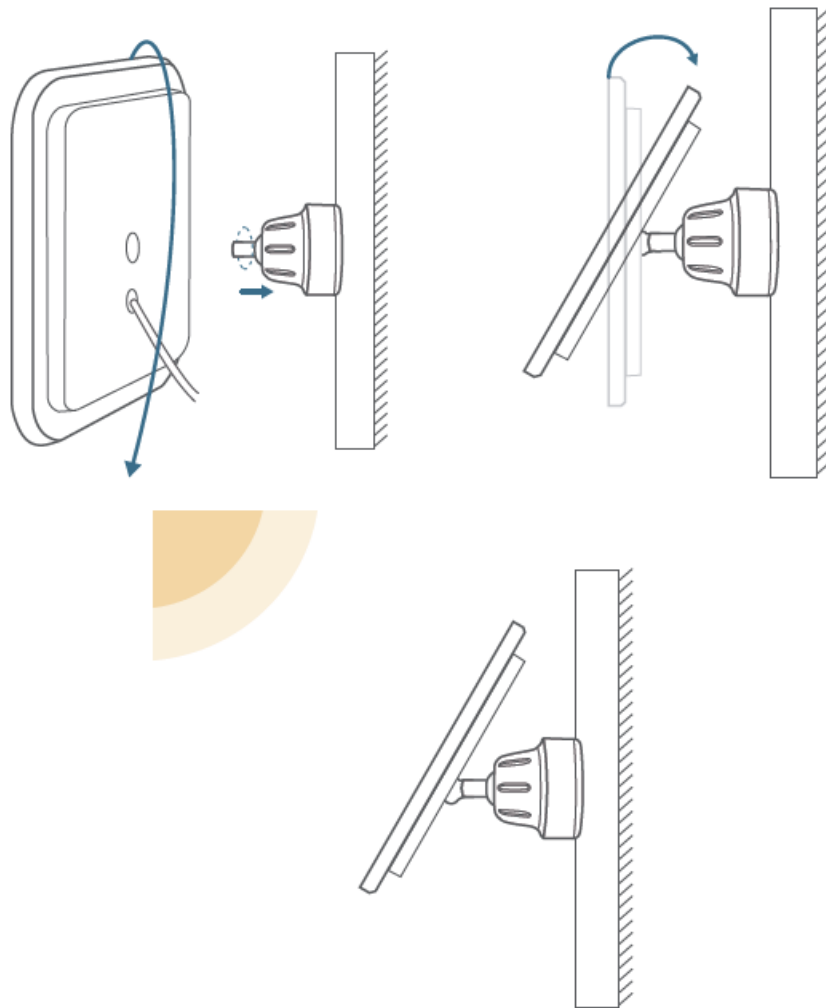

### Option 2: Mount the Camera with the Solar Panel Attached (Less Drilling)

If the camera is not blocked, install the solar panel directly on the top of the camera.

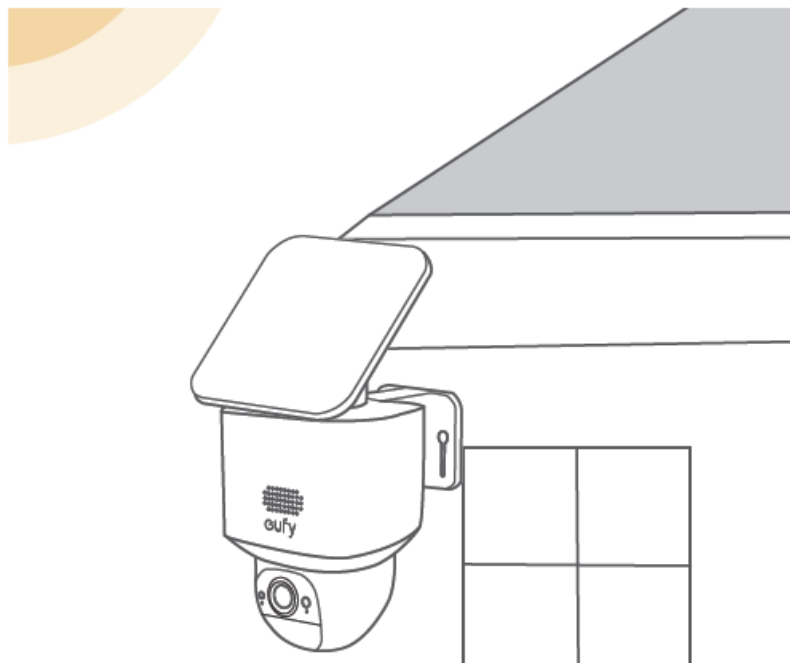

1. Use two 5mm screws to attach the solar panel bracket to the top of the camera.

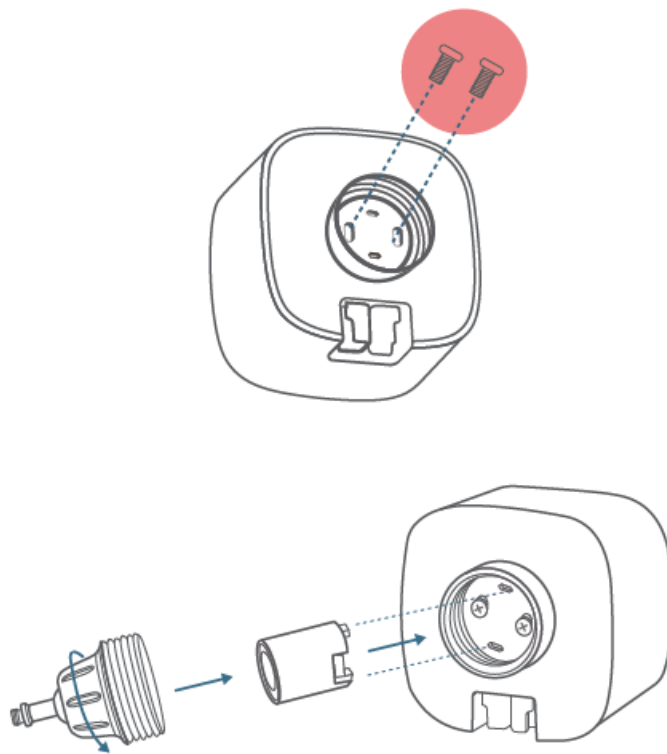

2. Install the solar panel onto the solar panel's mounting bracket by turning it.
3. Connect the USB-C connector to the USB-C port of the solar panel.
4. Drill holes with a 15/64 inch (5.95 mm) drill bit with the included positioning card, then insert the anchors into the holes.

2. Install the solar panel onto the solar panel's mounting bracket by turning it.

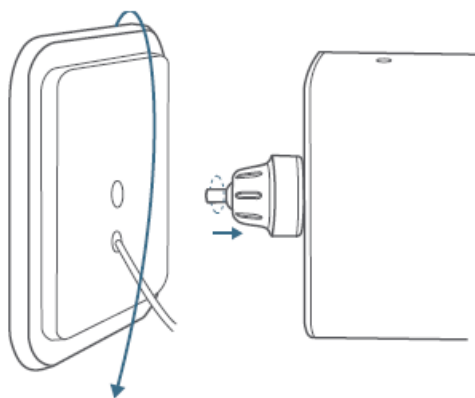

4. Drill holes with a 15/64 inch (5.95 mm) drill bit with the included positioning card, then insert the anchors into the holes.

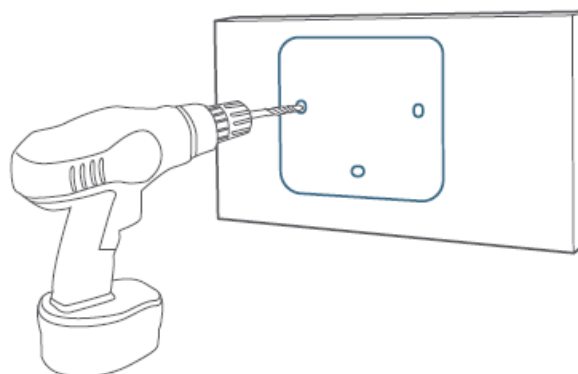

3. Connect the USB-C connector to the USB-C port of the solar panel.

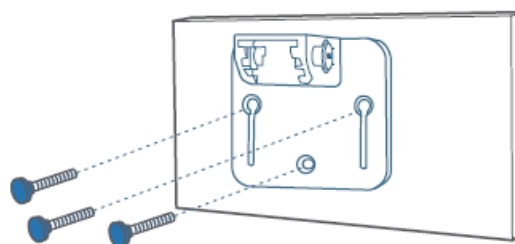
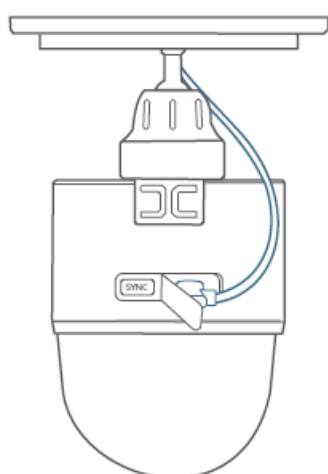

5. Firmly secure the camera onto the mounting bracket and adjust the angle (20°~30° recommended).

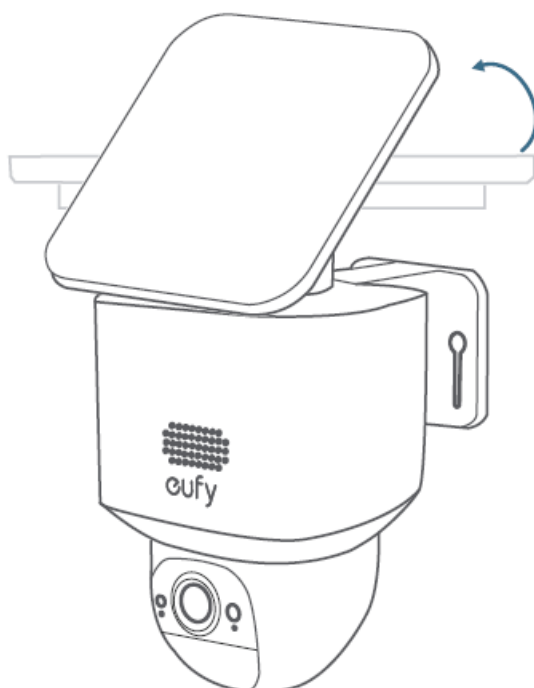

## SAFETY

- The suitable temperature for this device and accessories is -20°C to 50°C (Charging temperature is 0°C to 40°C).
- Unless specifically indicated that it is safe to do so in the user guide or instruction manual, do not use this device in an environment that exceeds the recommended low or high temperature.
- Unless specifically indicated that it is safe to do so in the user guide or instruction manual, avoid exposing your device to direct sunshine or excessively wet environments.
- It is recommended to supply the device in an environment with a temperature that ranges from 5°C to 25°C.
- When supplying power, place the device in an environment that has a normal room temperature and good ventilation.

#### **Warning:**

- Replacing a battery with an incorrect type may bypass safeguards and create danger;
- Disposal of a battery in a fire or other source of significant heat, or by crushing, or cutting, may result in an explosion as well as leakage of flammable liquids and gases;
- Leaving a battery in an extremely hot environment may result in an explosion as well as leakage of flammable liquids and gases;
- A battery subjected to extremely low air pressure may result in an explosion as well as leakage of flammable liquids and gases.

#### **Declaration of Conformity**

This product complies with the radio interference requirements of the European Community.

Hereby, Anker Innovations Limited declares that this device is in compliance with the essential requirements and other relevant provisions of Directive 2014/53/EU. For the declaration of conformity, visit the Website:

<https://support.eufy.com/s/articleRecommend?type=Download&secondType=e=doc..>

Hereby, Anker Innovations Limited declares that this device is in compliance with The Product Security and Telecommunications Infrastructure (Security Requirements for Relevant Connectable Products) Regulations 2023. For the Statement of Compliance, visit the website <https://www.eufy.com/uk/psti-related>

#### **RF exposure information**

The Maximum Permissible Exposure (MPE) level has been calculated based on a distance of d=20 cm between the device and the human body. To maintain compliance with RF exposure requirements, use products that maintain a 20cm distance between the device and human body.

Wi-Fi Operating Frequency Range: 2412~2472MHz; Wi-Fi Max Output Power: 19.01 dBm

The following importer is the responsible party

(contact for EU matters only)

Anker Innovations Deutschland GmbH | Georg-Muche-Strasse 3, 80807 Munich, Germany

Your product is designed and manufactured with high quality materials and components, which can be recycled and reused.



This symbol means the product must not be discarded as household waste, and should be delivered to an appropriate collection facility for recycling. Proper disposal and recycling helps protect natural resources, human health and the environment. For more information on disposal and recycling of this product, contact your local municipality, disposal service, or the shop where you bought this product.

**CUSTOMER SERVICE**  
12-month limited warranty

(US) +1 [800-988-7973](tel:800-988-7973)  
(UK) +44 (0) 1604 936200

[support@eufy.com](mailto:support@eufy.com)

**Documents / Resources**

	<a href="#">eufy T8171 SoloCam E30 2K Wireless Security Camera</a> [pdf] Installation Guide T8171 SoloCam E30 2K Wireless Security Camera, T8171, SoloCam E30 2K Wireless Security Camera, Wireless Security Camera, Security Camera, Camera
---	---

**References**

- [eufy Support](#)
- [eufy Support](#)
- [eufy Support](#)
- [User Manual](#)

[Manuals+](#), [Privacy Policy](#)

This website is an independent publication and is neither affiliated with nor endorsed by any of the trademark owners. The "Bluetooth®" word mark and logos are registered trademarks owned by Bluetooth SIG, Inc. The "Wi-Fi®" word mark and logos are registered trademarks owned by the Wi-Fi Alliance. Any use of these marks on this website does not imply any affiliation with or endorsement.