



eufy T2278 L60 Hybrid Robot Vacuum with Self Empty Station User Guide

[Home](#) » [Eufy](#) » eufy T2278 L60 Hybrid Robot Vacuum with Self Empty Station User Guide 

eufy

CLEAN

QUICK START GUIDE
Robotic Vacuum Cleaner



L60 Hybrid SES (T2278)

Contents

- [1 What's in the Box](#)
- [2 Overview](#)
- [3 Get Started](#)
- [4 Customer Service](#)
- [5 Documents / Resources](#)
 - [5.1 References](#)

What's in the Box

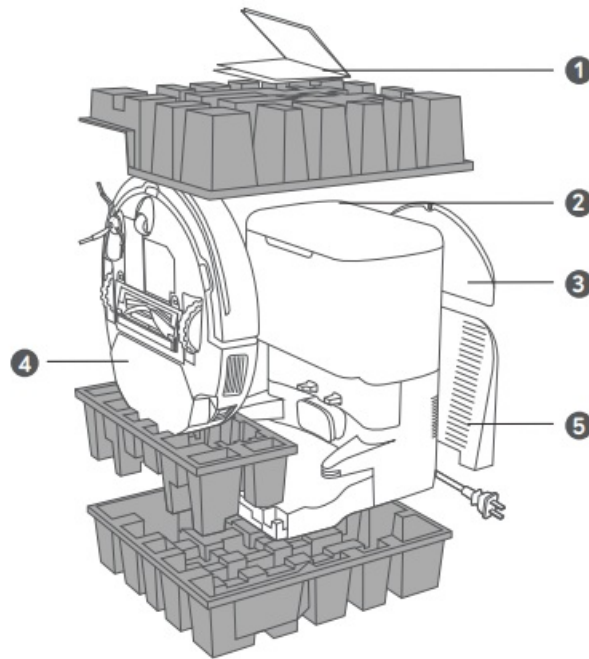



- ❶ Documents
- ❷ Self Empty Station and Power Cord
- ❸ Mopping Module
- ❹ Main Unit
- ❺ Detachable Base

*The Self Empty Station comes with the Cleaning Tool and Disposable Dust Bag preinstalled.

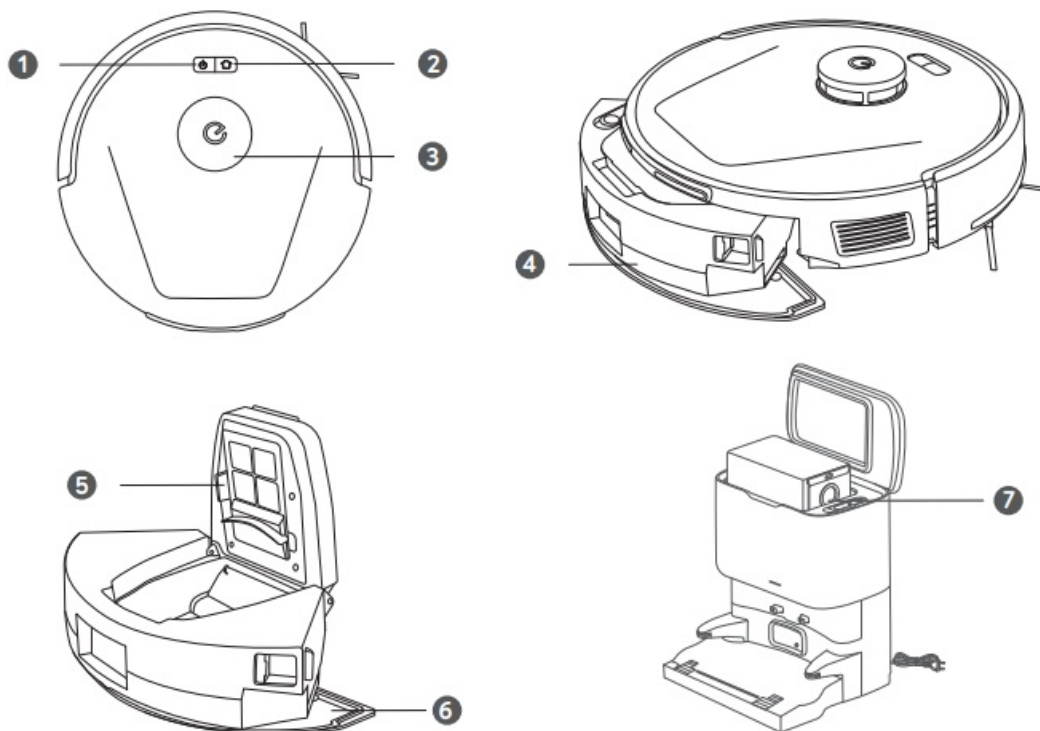
Overview



- ❶ Cleaning start / pause button
- ❷ Recharge button
- ❸ 360° Lidar Navigation Sensor
- ❹ Dust box
- ❺ Filter
- ❻ Mopping Module
- ❼ Disposable dust bag

	Press and hold for 3 seconds to power on or off Press to pause / finish the current task when working
	Press to return Robo Vac to the Charging Station Press to pause the current task when working Press and hold for 3 seconds to enable or disable Child Safety Lock
	Press and hold simultaneously for 3 seconds to reset the Wi-Fi connection

Get Started

1. Install the Self Empty Station in a location that Robo Vac can easily access. It is recommended to place it against a wall and on a hard, level surface rather than on rugs or carpets.

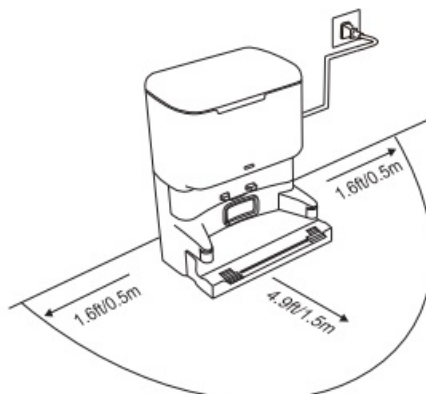



Always keep the Self Empty Station plugged in, otherwise Robo Vac will not automatically return to it.

When the Self Empty Station connects to AC power, the LED indicator on it is steady white.

2. Install the detachable base by pressing down both sides of it firmly until you hear a click.

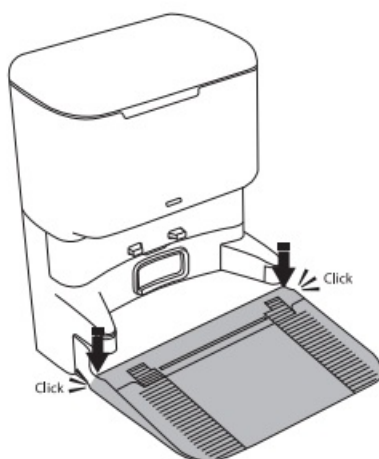

Make sure the detachable base is seamlessly connected to the Self Empty Station, otherwise Robo Vac will fail to return to the Self Empty Station smoothly.

3. Remove the foam blocks beside the bumper before use.

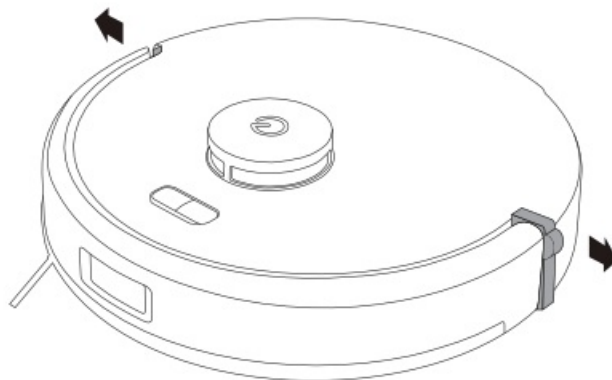

4. Attach Robo Vac to the Self Empty Station and turn it on.

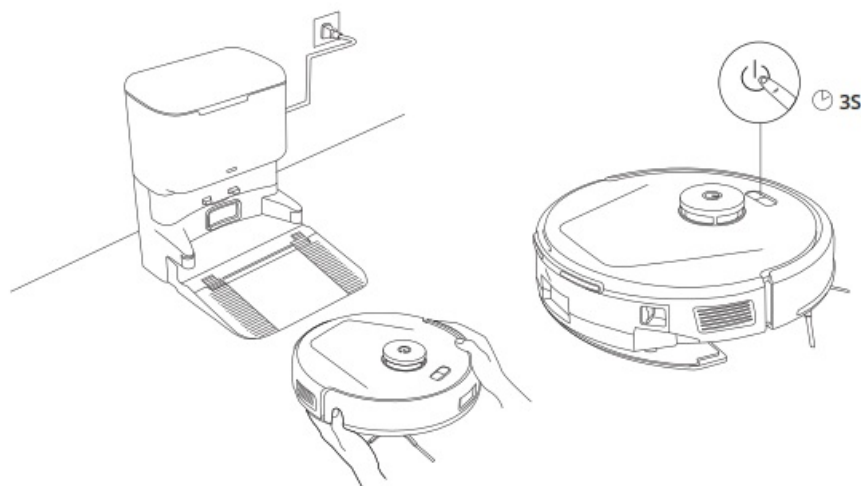

Fully charge Robo Vac before use. The LED indicator on Robo Vac will be solid white when fully charged.

5. Download the app. Follow the in-app instructions to set up the Wi-Fi connection.



<https://dl-eufy.eufylife.com/qcdl?flow=eufy>



You will be informed once a new firmware version is detected when Robo Vac has been connected to the Internet. Please update the firmware promptly for an optimal user experience.

6. Start Quick Mapping in the eufy Clean app, and experience a hassle-free clean powered by Robo Vac.

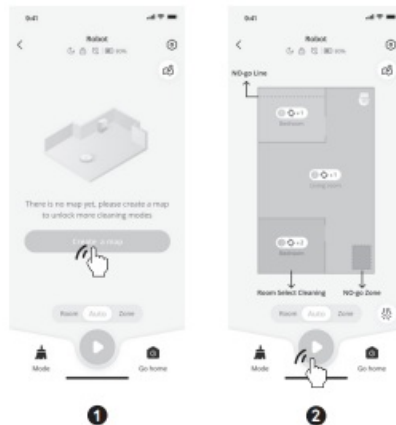

For more information on how to use the Intelligent Mapping feature, please refer to the Owner's Manual by scanning the QR code at Customer Service or visiting <https://support.eufylife.com>.

Cautions

- When Robo Vac has returned to the Self Empty Station, the hair cutting device in the Self Empty Station will automatically turn on. Do not move the Self Empty Station at this time.
- Once you have finished installing the Self Empty Station, do not touch the hair cutting slot on the Self Empty Station.
- Do not flush the main unit with water.
- RoboVac should not be allowed to enter ponding areas.
- Please remove the mopping module when not using the mopping function.
- Do not use the mopping module on carpets or threshold (more than 18mm). If there're carpets in the room, it is recommended to set up a no-go zone or no-mop zone by App before using Robo Vac.

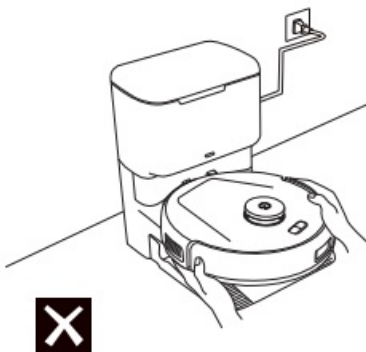
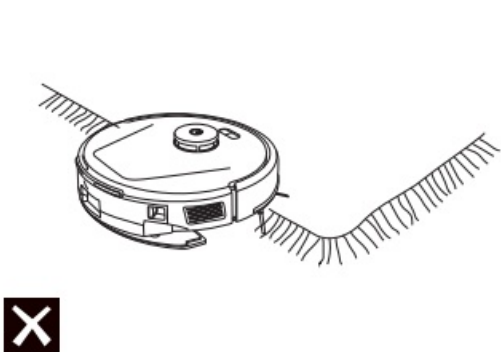

Warranty

12-Month Limited Warranty for the main unit (including the battery).

24-Month Limited Warranty for the Self Empty Station.

• Not applicable to consumables (rolling brush, side brush, mopping cloth, Hair Detangling Mechanism, etc.)

This limited warranty provided by the manufacturer does in no way affect a potential statutory warranty provided by law.

Customer Service

 support@eufy.com  www.eufy.com

 (US/CA) +1 (800) 994 3056 (UK) +44 (0) 1604 936200



https://rainbowbridge.anker.com/qrcode?key=eufylife&utm_campaign=t227x

For manuals, tutorial videos, FAQs, and more information, please visit: <https://support.eufylife.com> Or scan the QR code:



[https://support.eufylife.com/s/phonecontactus?
utm_source=qrcode&utm_medium=qrcode&utm_content=Others_&utm_campaign=appliances_manual&utm_term=ZZA4w2](https://support.eufylife.com/s/phonecontactus?utm_source=qrcode&utm_medium=qrcode&utm_content=Others_&utm_campaign=appliances_manual&utm_term=ZZA4w2)

For more support phone numbers, please visit: <https://support.eufylife.com/s/phonecontactus> Or scan the QR code



@EufyOfficial



@EufyOfficial



@EufyOfficial



@EufyOfficial

Documents / Resources



[eufy T2278 L60 Hybrid Robot Vacuum with Self Empty Station](#) [pdf] User Guide
T2278 L60 Hybrid Robot Vacuum with Self Empty Station, T2278, L60 Hybrid Robot Vacuum with Self Empty Station, Robot Vacuum with Self Empty Station, Self Empty Station, Empty Station

References

- [eufy](#) | [Built with Care](#) | [Up to 54% Off](#) | [eufy US](#)
- [eufy](#) | [Built with Care](#) | [Up to 54% Off](#) | [eufy US](#)
- [eufy Support](#)
- [eufy Support](#)
- [User Manual](#)

[Manuals+](#), [Privacy Policy](#)

This website is an independent publication and is neither affiliated with nor endorsed by any of the trademark owners. The "Bluetooth®" word mark and logos are registered trademarks owned by Bluetooth SIG, Inc. The "Wi-Fi®" word mark and logos are registered trademarks owned by the Wi-Fi Alliance. Any use of these marks on this website does not imply any affiliation with or endorsement.