



ETA7569 Lumio Smart User Manual

[Home](#) » [ETA](#) » **ETA7569 Lumio Smart User Manual** 

Contents

- 1 [ETA7569 Lumio Smart](#)
- 2 [Product Information](#)
- 3 [Product Usage Instructions](#)
- 4 [BASIC STRUCTURE OF THE APP'S MAIN HOME SCREEN](#)
- 5 [BASIC FUNCTIONAL SCREEN](#)
- 6 [INSTALLING THE APPLICATION](#)
- 7 [CREATE ACCOUNT](#)
- 8 [DEVICE PAIRING](#)
- 9 [BASIC ADVICE AND TIPS FOR USE](#)
- 10 [SHARING CONTROL](#)
- 11 [FIRMWARE UPDATE](#)
- 12 [Documents / Resources](#)
 - 12.1 [References](#)
- 13 [Related Posts](#)



ETA7569 Lumio Smart



Product Information

Specifications

- Model: Lumio Smart zvlhčovac vzduchu ETA756990000
- Compatibility: Android and iOS devices
- Connection: Wi-Fi (WPA2) and Bluetooth
- Frequency: 2.4 GHz

Product Usage Instructions

1. Installing the Application

Download the ETA Smart application from the App Store (iOS) or Google Play Store (Android).

2. Create Account

Open the app and follow the on-screen instructions to create an account.

3. Device Pairing

Activate Bluetooth and location services on your device. Click on the “Pair Device” icon in the app and follow the pairing instructions.

4. Basic Advice and Tips for Use

Explore the basic functions of the app, such as controlling air quality settings and UV light activation.

5. Firmware Update

To update the firmware, go to the settings menu in the app and check for updates. Follow the on-screen instructions to complete the update process.

Frequently Asked Questions (FAQ)

- **Q: Why do the illustrations in the manual differ from my application?**

A: The illustrations and translations may vary slightly due to software updates or regional differences. Focus on following the on-screen instructions for accurate usage.

- **Q: How to reset the air filter?**

A: In the app, locate the “Reset Filter” option under device settings to reset the air filter.

- **Q: What is the UV light function for?**

A: The UV light function activates air disinfection for improved air quality.

Dear customers,

Thank you for your purchase and interest in our appliance. Along with this manual, use the user manual for the device itself, which is an integral part of it. This guide focuses primarily on the application itself and its capabilities, not on using the device.

Illustrations and translations of texts or of activating elements applied in the application may slightly differ from the illustrations and descriptions specified in this manual. Therefore, don't get scared if there are differences in your application compared with the illustrations in the manual.

BASIC STRUCTURE OF THE APP'S MAIN HOME SCREEN

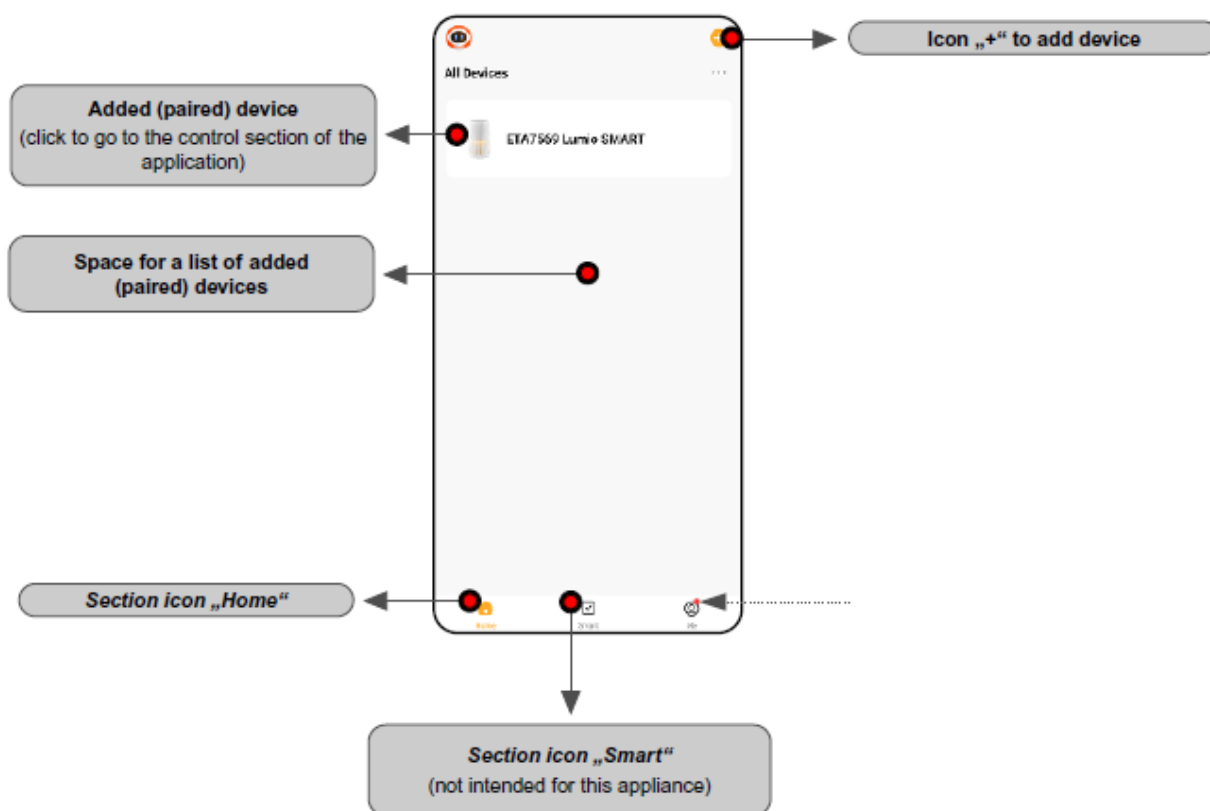

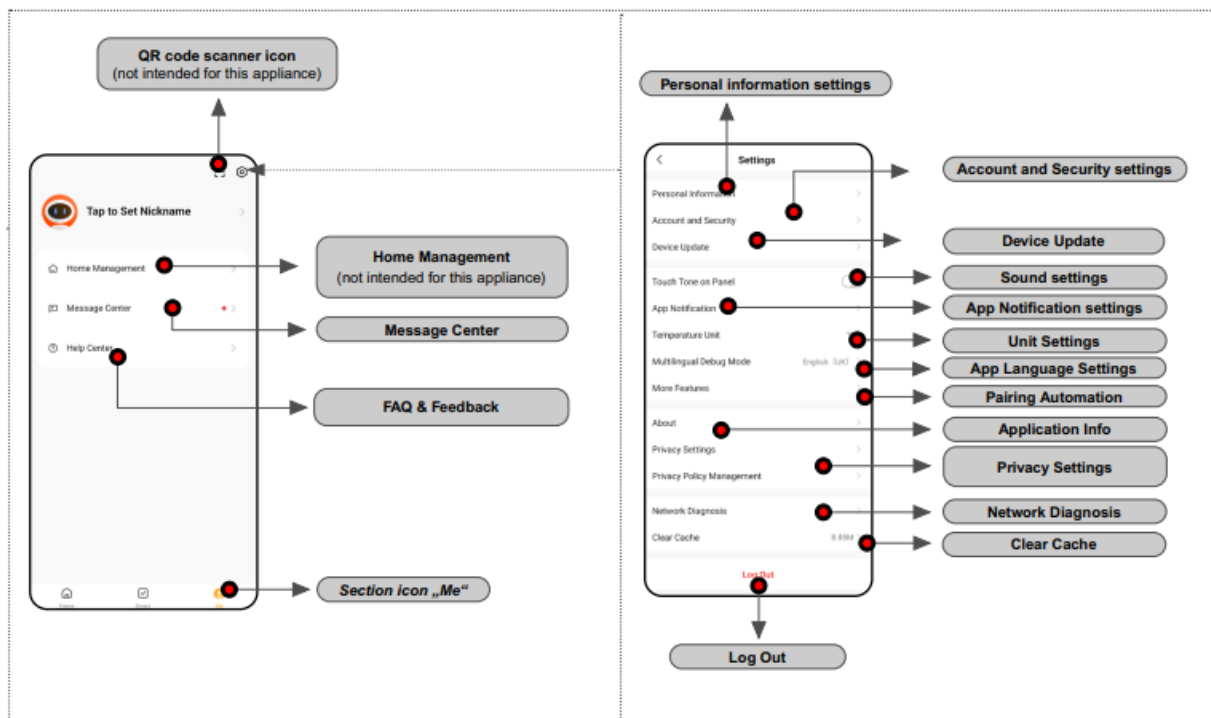

BASIC FUNCTIONAL SCREEN

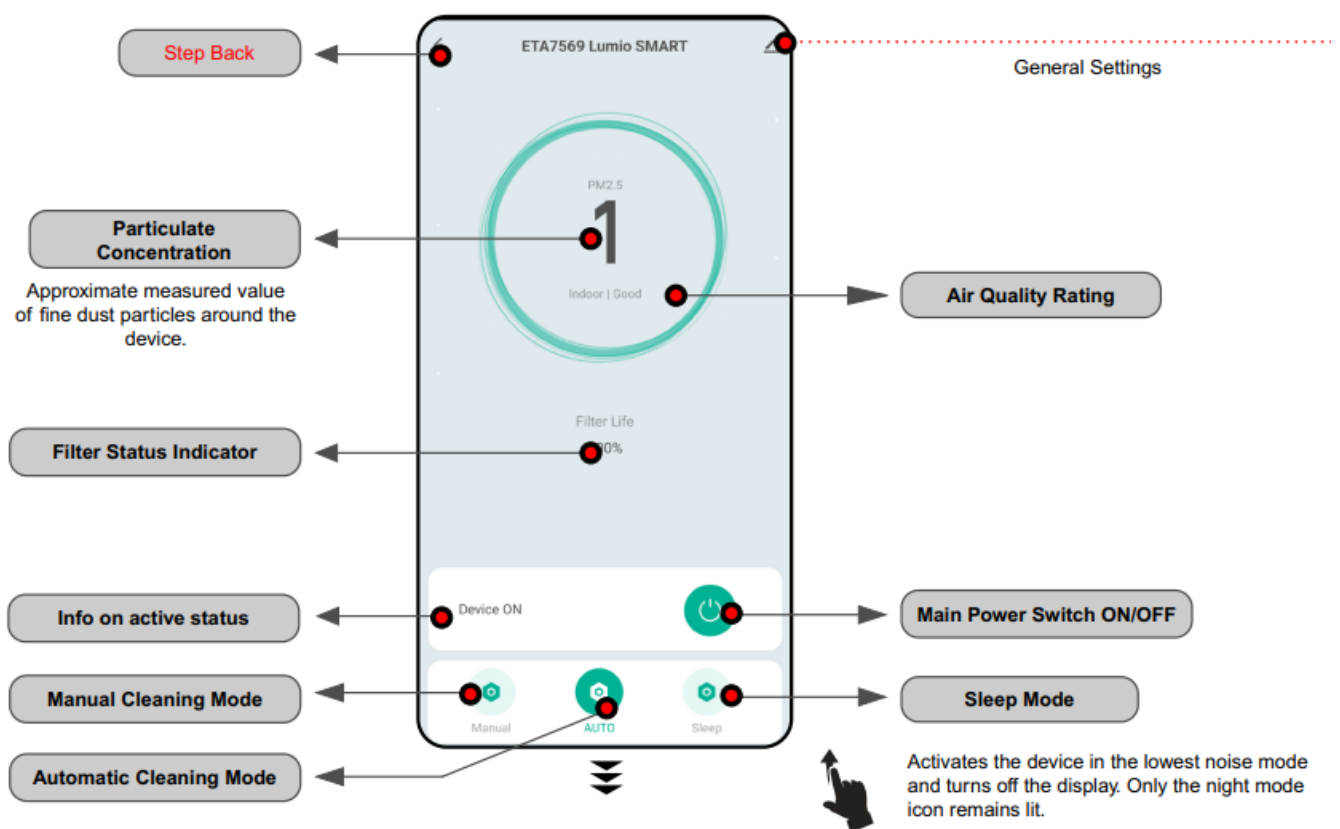

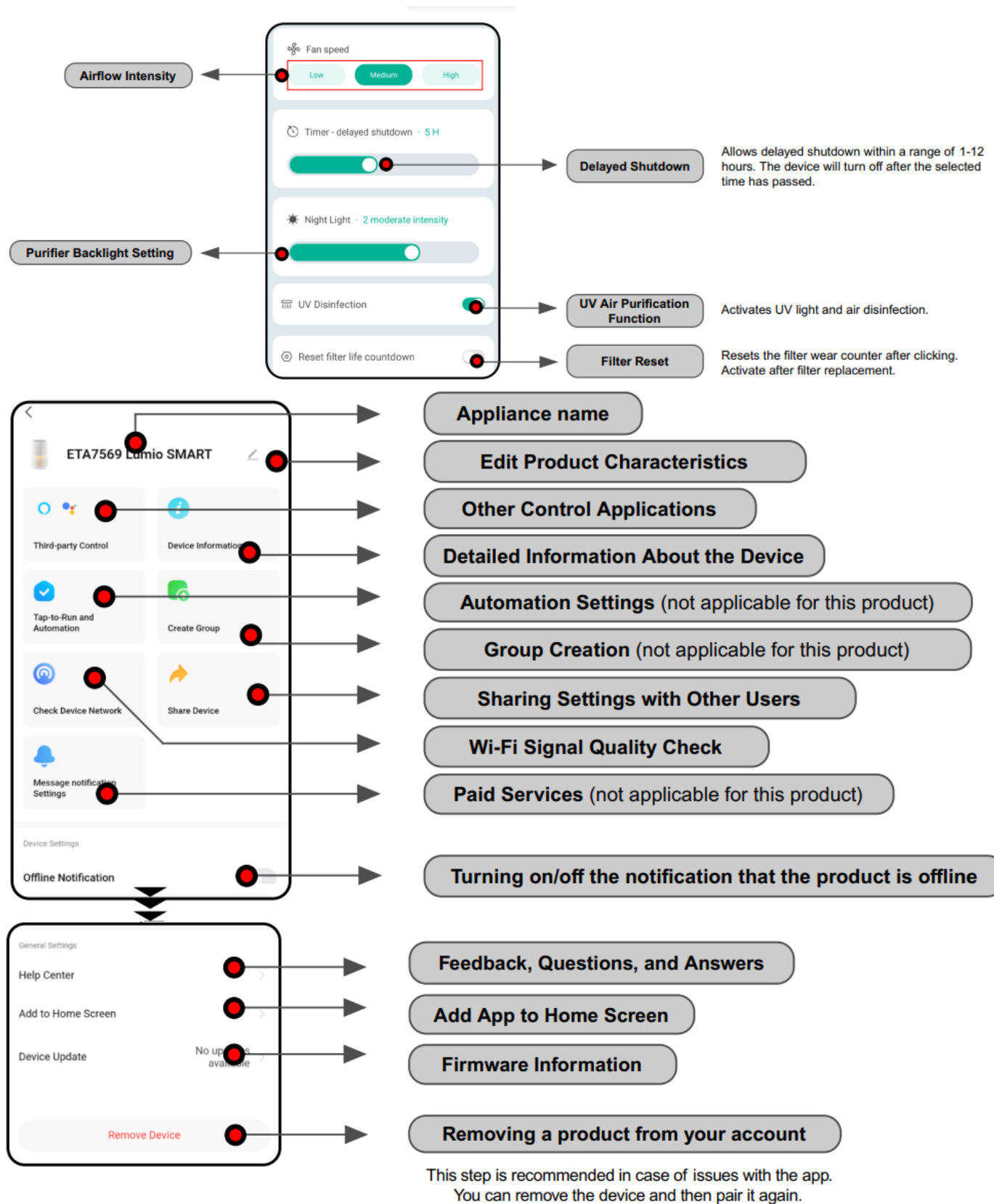

This step is recommended in case of issues with the app. You can remove the device and then pair it again.

ETA SMART APPLICATION USER GUIDE

Dear customer,

- Thank you for your trust in ETA brand products. This manual is intended for all owners of the ETA7569 who want to use its full potential using the ETA SMART application.

- Any additional information, advice and tips can also be found on our website: www.etasince1943.com/air
- We are constantly updating this website and collecting the latest information about the product here.

In case of questions about the function of the application, or in case of any problems, first go to the above website, and if even the information provided there does not help to solve your request, you can contact us at the information e-mail: info@etasince1943.com

INSTALLING THE APPLICATION

You can find the application in the Apple Store or Google Play application database, or you can use the following QR code to speed it up:



Download the application and install it on your mobile phone (tablet).

COMPATIBILITY

Mobile phone (tablet) operation system	Android 7.0 and higher
	IOS 11.0 and higher
Wi-Fi network	ONLY 2.4 GHz
	security WPA1 and WPA2(WPA2 is recommended)
ATTENTION The appliance cannot be operated with Wi-Fi networks secured with IEEE 802.1X protocol (as a rule, company's Wi-Fi networks).	

CREATE ACCOUNT

- Install and activate the ETA SMART application.
- Click on „Sign Up“.

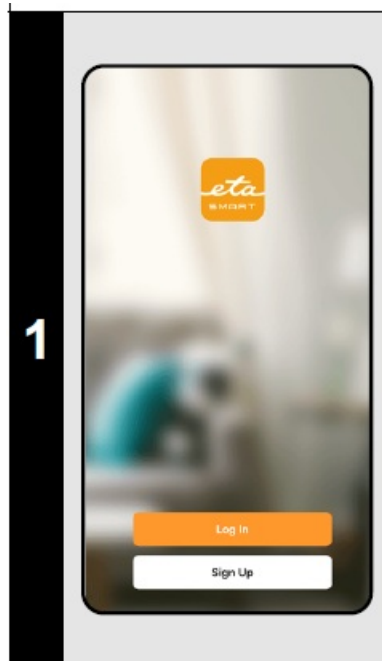

- Agree to Privacy Policy and User Agreement
- Fill in the email you want to use to create user account.
- Then click on „Get Verification Code“.

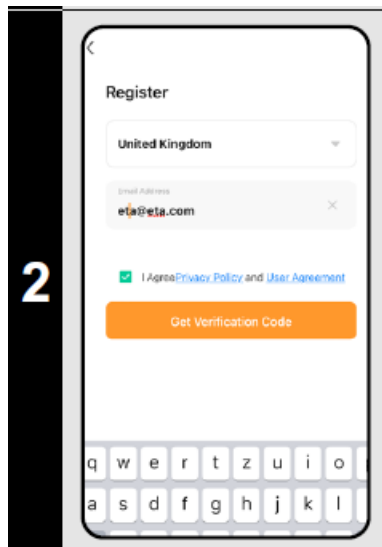

- Verification code will be sent to your email.
- Enter Verification Code



- Set password and complete account creation.

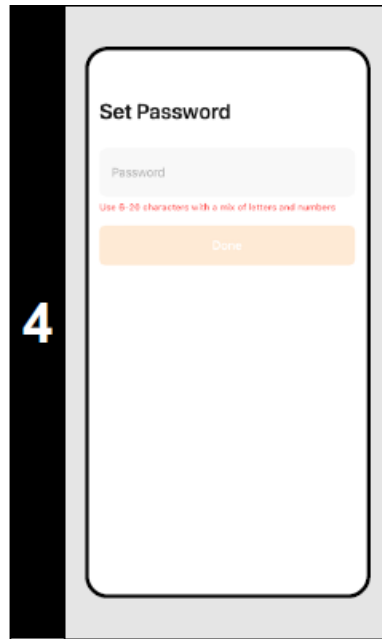

- Log in into the application.
- When you log in for the first time (after creating a password), you can be logged in automatically.

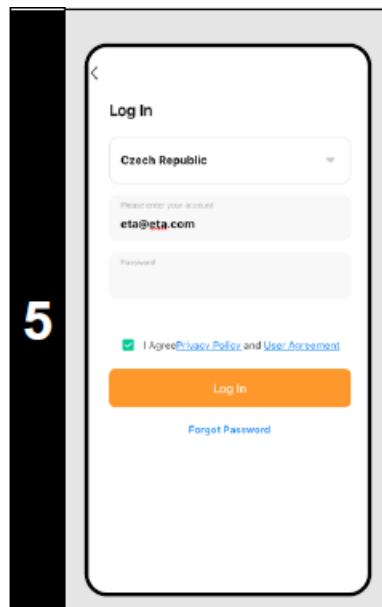

- After successful login, the default screen will appear, in this case without the paired device.

Note

- Grant all necessary permissions to the app when you first run it. Above all, it can be about location (GPS), Bluetooth or storage.

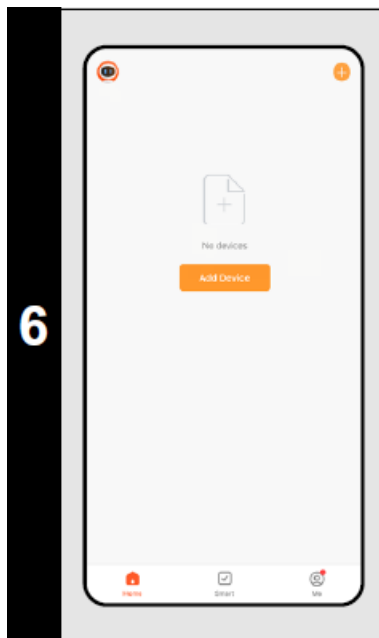

DEVICE PAIRING

- For proper use of the device on a smartphone, the app must first be paired with the device.
- If you haven't paired any device yet, click either on „Add device“ button or „+“ icon. If you have already paired a device, click on „+“ icon.

Note:

- The specific pairing steps may differ slightly depending on whether you are using Android or iOS.
- Bluetooth and location services (GPS) must be enabled and activated in the application for proper device search and smooth pairing process.



- A list of available devices that can be paired with the application will be displayed.



- Before starting the pairing process in the app, you need to activate the WIFI mode on the device itself by pressing and holding the power button B1 (for about 5 seconds) (see manual). A beep will sound, and the WIFI indicator will start blinking. The device is now ready for pairing.

You now have two options to add a device:

1. The application can identify devices in its vicinity in automatic mode (see screenshot). In this case, continue by clicking “Add” at the found device. You will be redirected to step 2.4 and, after entering the WIFI data, immediately to step 2.7). However, to successfully locate the device, you must have the Bluetooth function active on your phone.
2. Add manually – select and click on the “ETA7569 Lumio Smart” in the displayed list of available products.

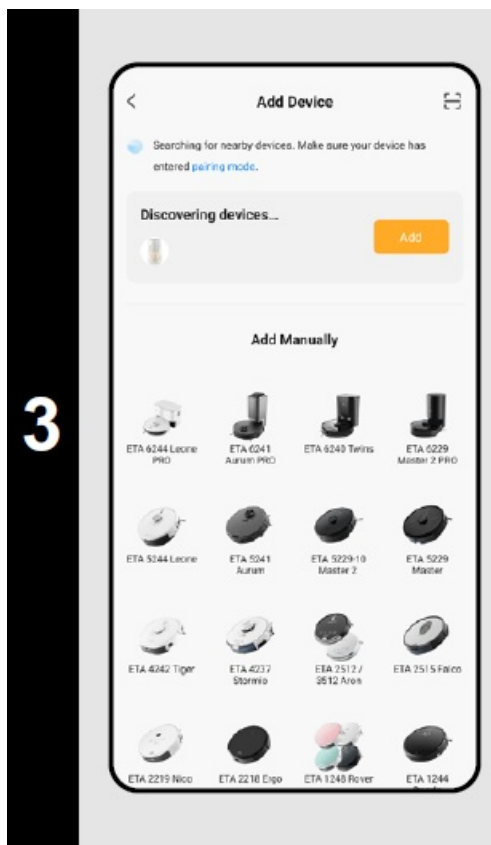

- Keep your phone connected to the home WIFI network (the device only supports 2.4 GHz) to which you want to connect the device. The application will offer the WIFI network to which you are currently connected. Proceed to selection of another available WIFI network by clicking on .
- Enter the WIFI network password and press “Next” to continue.

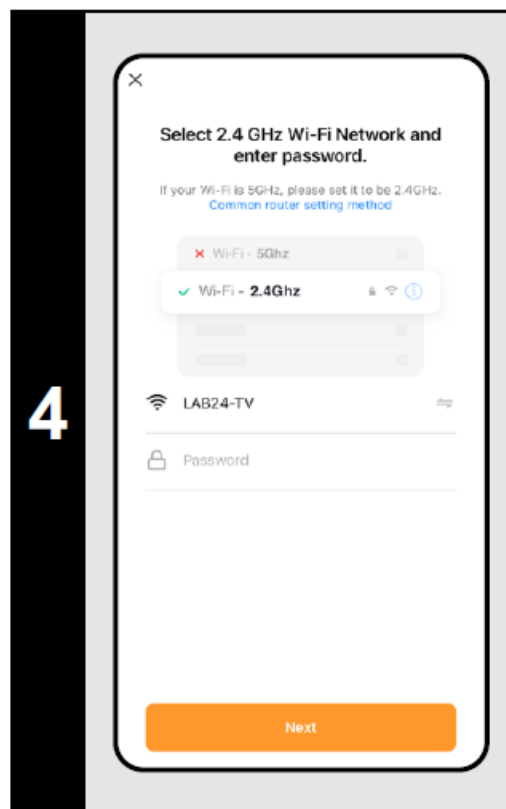

- The application will remind you of the WIFI mode activation procedure.
- After activating the mode, confirm that the WIFI indicator is blinking, and proceed by pressing “Next”.

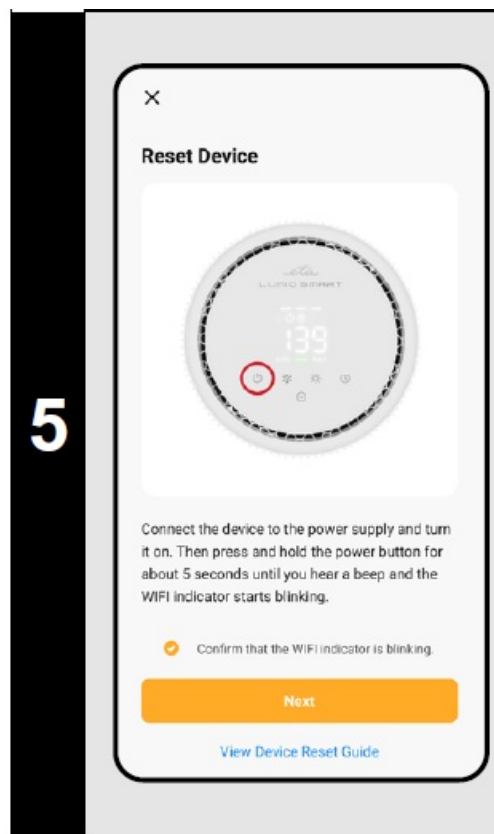

- You will now be prompted to go to the Wi-Fi settings on your phone and connect to the network broadcasted by the device. Click “Go to Connect” to go to WIFI settings.
 - Find and select network named “SmartLife-xxx...”.
- Note – if you get an error message about a bad network connection after connecting the purifier to the network, ignore it. Here the connection to the Internet is not established, but to the device, which may be confused by the phone settings.
- Then go back to the app to complete the pairing process (see step 2.7 below).

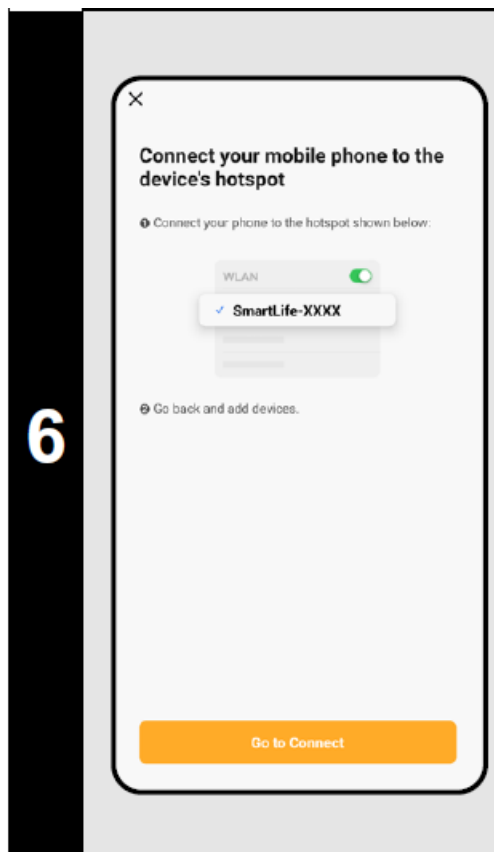

- The device pairing process with your phone will now begin.

- If the automatic device addition feature is not enabled, click “Add” to confirm, as shown below.

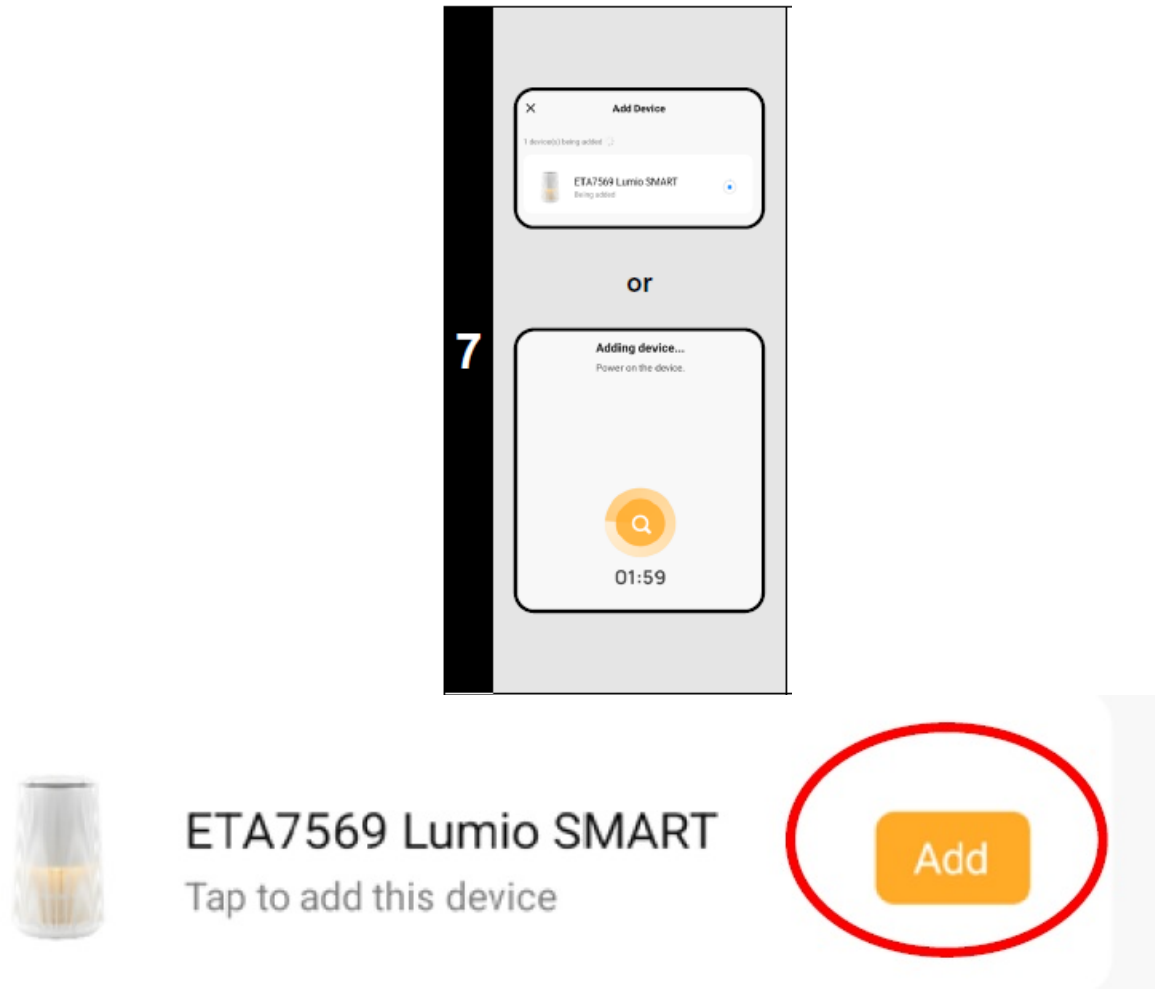

Note:

- The connection screen may take different forms, but in principle it is an identical process.

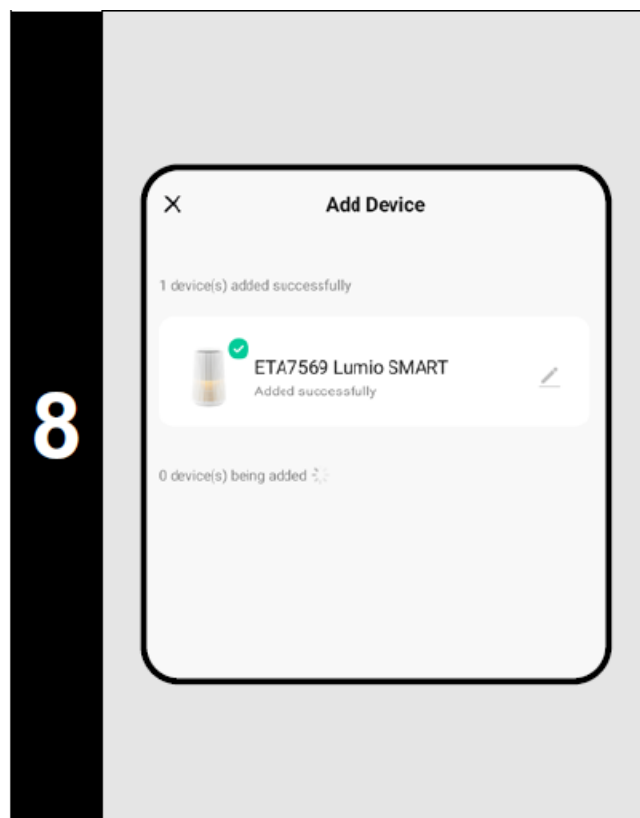

If everything is fine and the pairing is successful, an information window will appear to confirm and complete the pairing process.

BASIC ADVICE AND TIPS FOR USE

Using the ETA device with ETA SMART is intuitive and we did not notice any significant problems or difficulties during our testing you might encounter while using it. Nevertheless, smart products generally have an increased risk associated with incompatibility of mobile devices or problems with wireless connectivity. Therefore, we prepared a set of basic advice and recommendations on how to solve problems characteristic of the smart products segment.

1. Smart device (mobile phone, eventually tablet):

- always use the current version of the application downloaded from official sources.
- make sure your devices have supported versions of Android and iOS.
- have the Bluetooth function active.
- have an active internet connection for proper communication of the application with the cloud server.
- allow the application the required permissions, which in some cases depend on the type of operating phone. In case of problems, make sure that you do not have any parent system settings within your phone, for example, that prevent applications from using certain permissions – in which case you must grant the application an exception.
- the communication between device and the phone may be disturbed by some programs (eg VPN, firewall, etc.) that you use in the phone. In case of problems with pairing or normal operation, turn off these programs.
- In case of problems, try pairing with another phone to avoid the problem in that phone.

2. WIFI router

- make sure you are connected to a 2.4GHz WIFI network.
- in case of problems with the network itself, it is advisable to test the device on another WIFI network. If the problem persists there, the problem is most likely not on the router side.
- If the name of your WIFI network (SSID) or its password contains non-standard characters, try to change them to simpler variants.

During pairing and usage, keep your smart device near the device.

SHARING CONTROL

- The application enables the sharing of device control by other users who have created an account in the ETA SMART application.
- On the main screen, click the pencil symbol in the upper right corner.

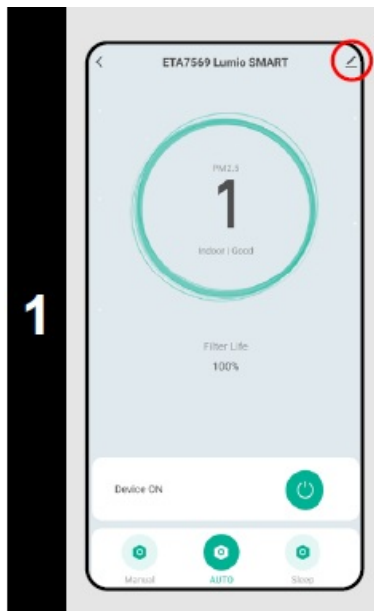

- Choose „Share device“.

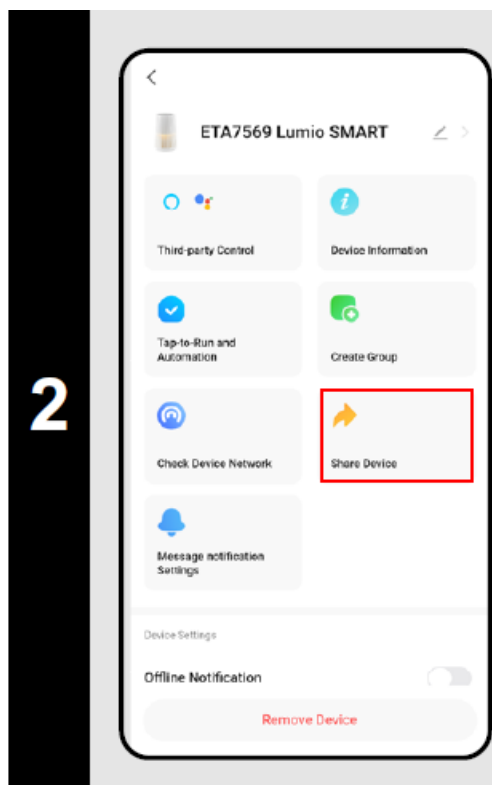

- Click “Add Sharing”.



- In principle, there are several ways to share accounts (and they may differ depending on the OS of the phone) – however, we only recommend using the pairing method below.
- Click “Share with the Account ETA Smart”.

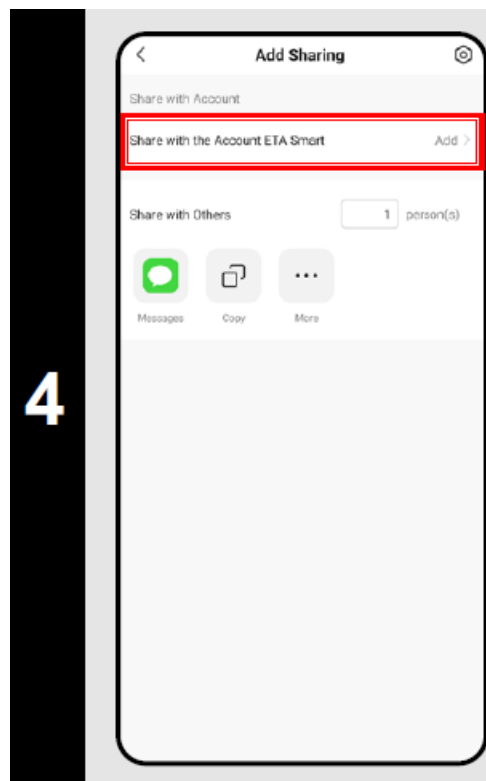

- Now enter the ETA Smart account email of the person you want to share this device with.
- Click “Done”.

Note:

The person must have downloaded the ETA Smart application and registered their own account there.

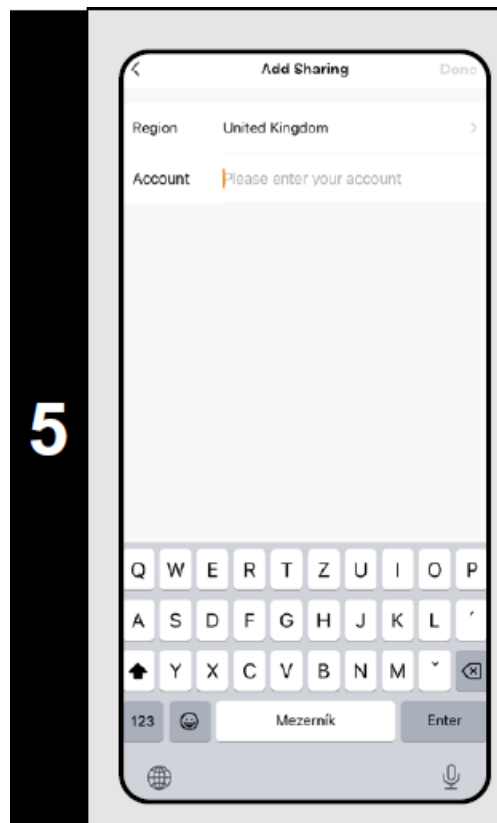

- Sharing is completed successfully and is displayed in the list of shared devices.

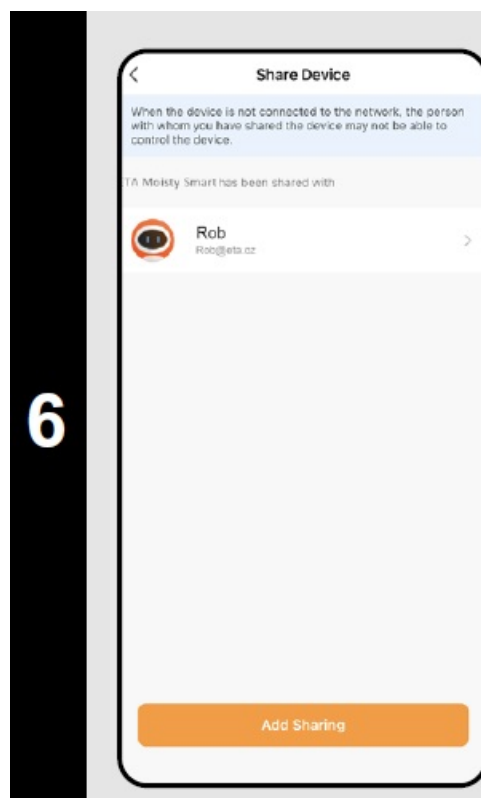

Notes:

- You only share the selected device with that person, not the entire list of paired devices.
- To that person, the shared device will immediately appear in the list of available devices. He can control it, but has limited options to manage and set it up.

FIRMWARE UPDATE

The device has software in its inner memory named Firmware. If a newer version has been issued, it is necessary

to update it.

- Click on the pencil symbol in the right upper corner of the main screen.
- Select „Device Update“.

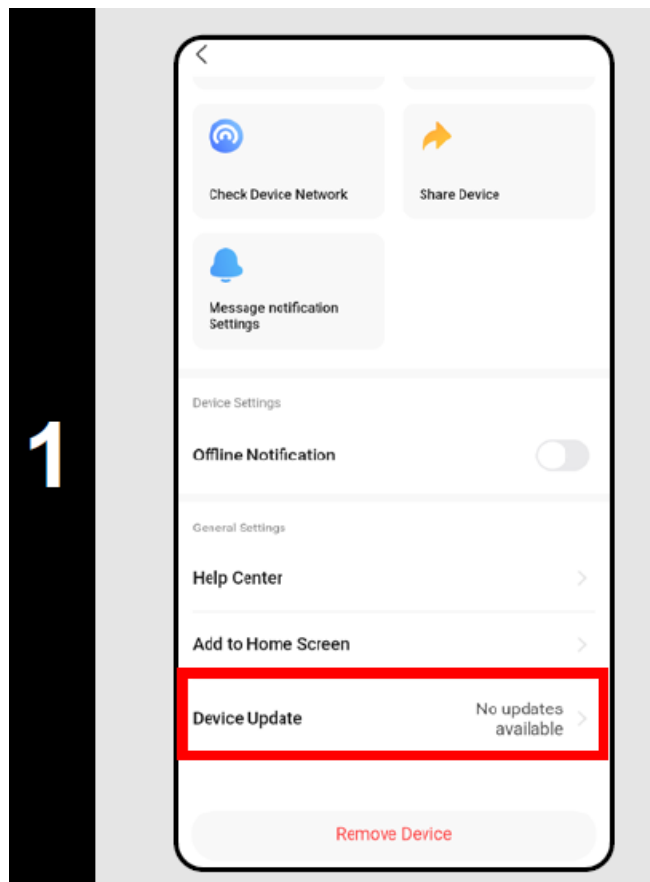

- If a new version is available, confirm update.
- If you require to check automatically new available versions, you may switch-on the „Automatic Updates“ option.

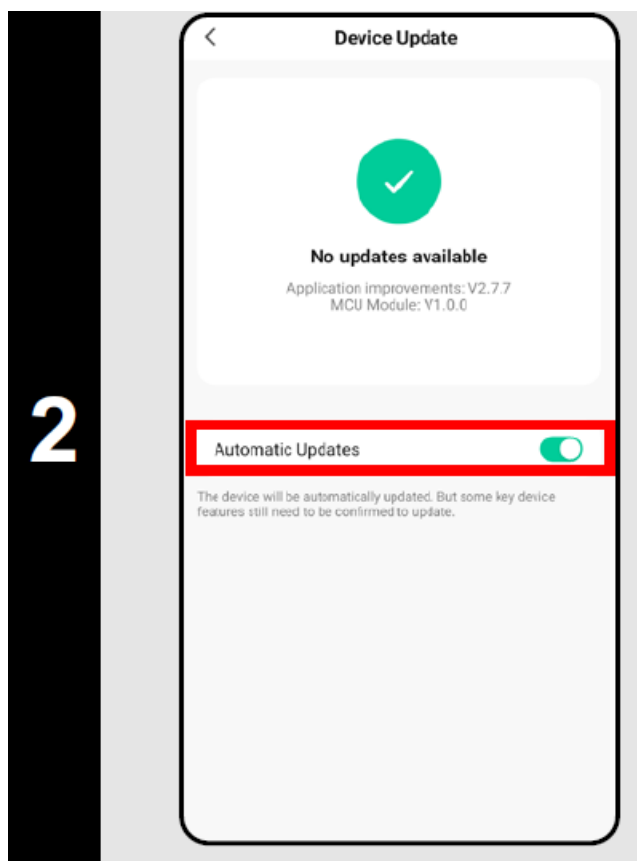

If you experience any issues with the app, contact us at info@etasince1943.com.

Documents / Resources

	<p>eta ETA7569 Lumio Smart [pdf] User Manual ETA7569, ETA756990000, ETA7569 Lumio Smart, ETA7569, Lumio Smart, Smart</p>
---	--

References

- [e Technische Hilfe für luft geräte – ETA DE](#)
- [e Wsparcie dla produktów AIR | eta-polska.pl](#)
- [User Manual](#)

[Manuals+](#), [Privacy Policy](#)

This website is an independent publication and is neither affiliated with nor endorsed by any of the trademark owners. The "Bluetooth®" word mark and logos are registered trademarks owned by Bluetooth SIG, Inc. The "Wi-Fi®" word mark and logos are registered trademarks owned by the Wi-Fi Alliance. Any use of these marks on this website does not imply any affiliation with or endorsement.