



JS-36E User Manual

Contents [[hide](#)]

- [1 Introduction](#)
- [2 Features](#)
- [3 Installation](#)
- [4 System Setting](#)
- [5 Documents / Resources](#)
 - [5.1 References](#)

Introduction

This series' product is a new generation on multifunctional standalone access control. It adopts new ARM core 32-bit microprocessor design, which is powerful, stable and reliable . It contains reader mode and standalone access control mode etc.. It's widely applied to different occasions, such as office, residential communities, villa, bank and prison etc..

Features

Card Type	Read 125KHz Card and HID Card(Optional)

	Read 13.56MHz MI fare card and CPU card(Optional)
Keypad Characteristic	Capacitive touch keypad
Output Way	Contain reader mode, the transmission format could be adjusted by user
Access Way	Fingerprint , card, code or multiple combination methods, mobile phone App (Optional)
Admin Card	Support admin add card and admin delete card
User Capacity	10000
Unlock Signal	NO, NC, COM output using relay
Alarm Output	Use MOS tube output to directly drive the alarm (optional)

Technical Specifications

Operating Voltage: DC12-24V	Standby Current ≤60mA
Operating Current ≤100mA	Operating Temperature:-40°C-60°C
Operating Humidity: 0%-95%	Access ways Fingerprint, card, code, multiple combination methods, mobile phone App (Optional)

Installation

- Remove the back cover from the keypad using the supplied special screw driver
- Drill 2 holes on the wall for the self-tapping screws and 1 hole for the cable
- Put the supplied rubber bungs into the two holes
- Fix the back cover firmly on the wall with 2 self-tapping screws

- Thread the cable through the cable hole
- Attached the keypad to the back cover.(See the figure right)

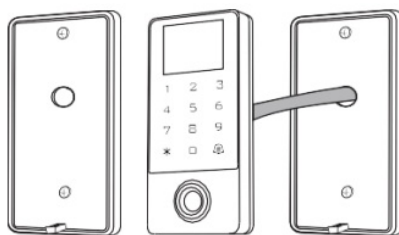

Wiring

Color	Marks	Description
Pink	Bell-A	Door bell button on end
Pink	Bell-B	Door bell button on the other end
Green	D0	Wiegand input (Wiegand output as reader mode)
White	D1	Wiegand input Wiegand output as reader mode
Grey	Alarm	Alarm signal MOS tube drain output end
Yellow	Open(BE EP)	Exit button input end(Beeper input as reader mode)
Brown	DIN(LED)	Door sensor switch input end (card reader mode LED control input)
Red	+12V	Positive power supply
Black	GND	Negative power supply
Blue	NO	Relay NO end
Purple	COM	Relay COM end
Orange	NC	Relay NC end

Diagram

1. Special power supply diagram

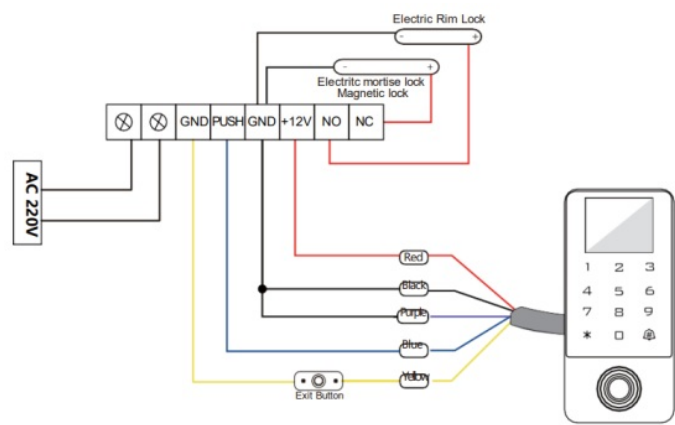

6.2 Reader Mode

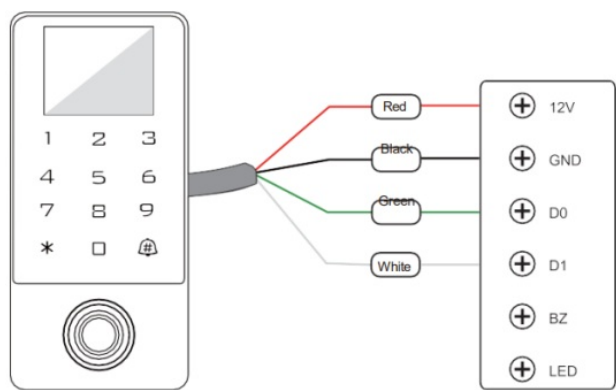

System Setting

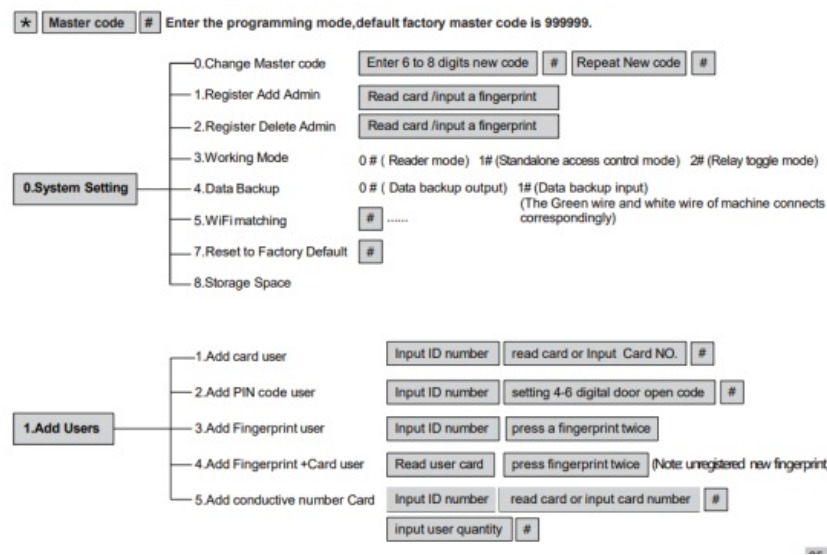

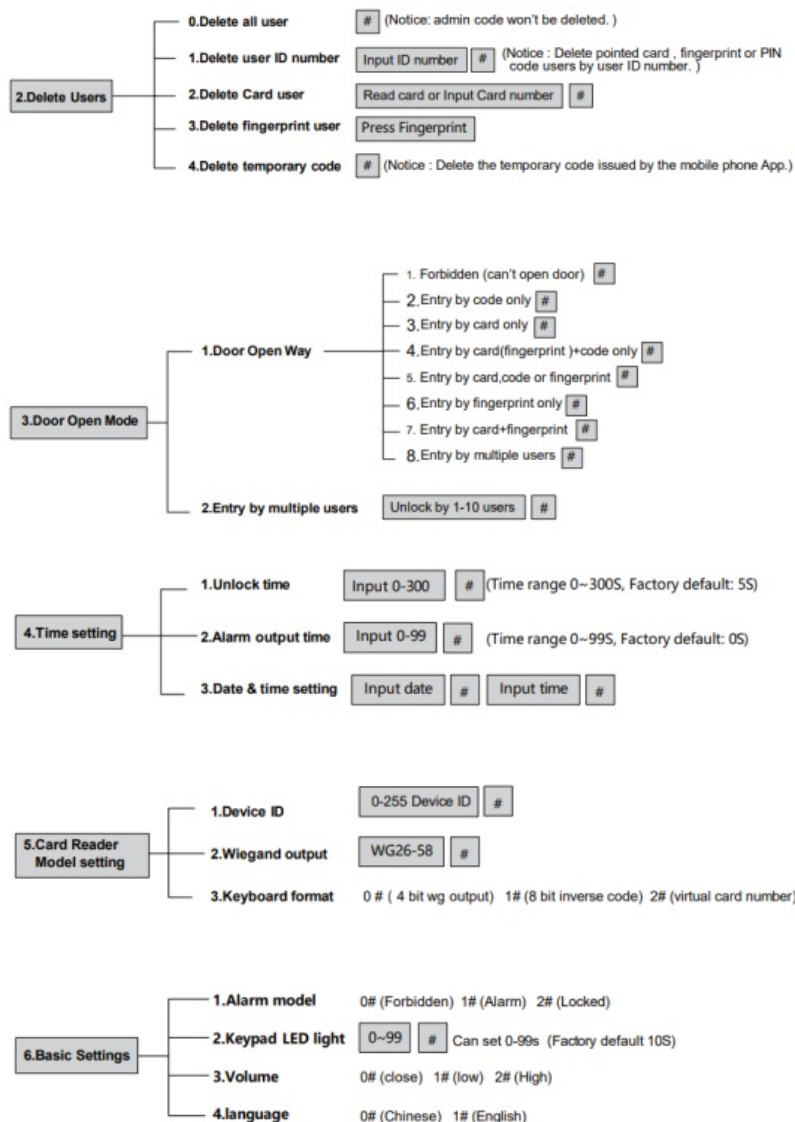

Reset to Factory Default

When forget the administrator password, reset it to the factory default setting, The default administrator password is “999999”

Method 1: Power off, power on, screen lights on, press the # key, The display will shows default settings is successful.

Method 2: Power off, press the exit button continuously, power on, The display will shows default settings is successful.

Method 3: 0.system setting 7.Reset factory default setting #

9. Reader mode switch to standalone access control mode

When the device is under card reader mode, long press * to switch to standalone access control mode

10. Cancel alarm

Read admin card read valid user card valid fingerprint or or or admin password #

Note: When alarm occurs, the buzzer will sound “woo, woo,...” and the alarm can be

canceled by reading the valid card or inputting admin password.

Packing list

Item	Specification	Qty	Remark
Device		1	
User Manual		1	
Self-tapping screwdriver	Φ4mm×25 mm	2	For mounting and fixing
Rubber plug	Φ6mm×28 mm	2	For mounting and fixing
Star screwdriver	Φ20mm×60mm	1	special purpose
Star screws	Φ3mm×5mm	1	For fixing the front cover and the back cover

Note:

- Please do not repair the machine without permission. If there is any problem, please return it to the manufacturer for repair.
- Before installation, if you want to drill holes, please carefully check the hidden wires or conduits to prevent unnecessary trouble caused by drilling the hidden wires when drilling. Use safety glasses when drilling or fixing wire clips.
- If the product is upgraded, the instructions may be different without prior notice.

WIFI function optional

1. Scan the QR code by your mobile phone to download the Tuya Smart APP or search the Tuya Smart APP to download APP by mobile phone application market (Figure 1)
2. Open the APP, click the “+” at the upper right corner, Add Device (Figure 2) (Note: When searching for devices, turn on the Bluetooth and location services functions firstly)

Note: At the same time, turn on the “wireless pairing” function on the access control.

* Admin password # 0. System settings 5. WIFI pairing#

3. Enter the WIFI password, then click Next. (Figure 3)



Figure 1

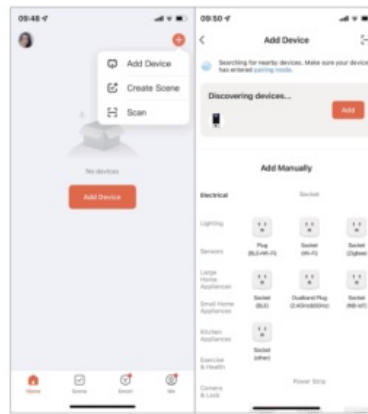

Figure 2

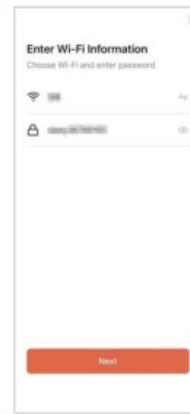
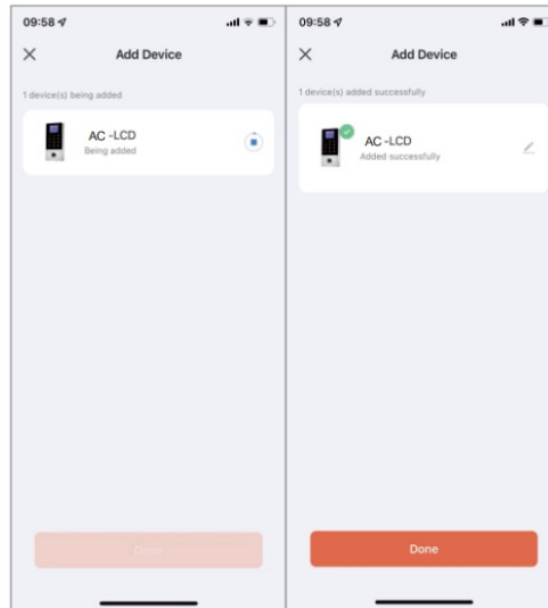
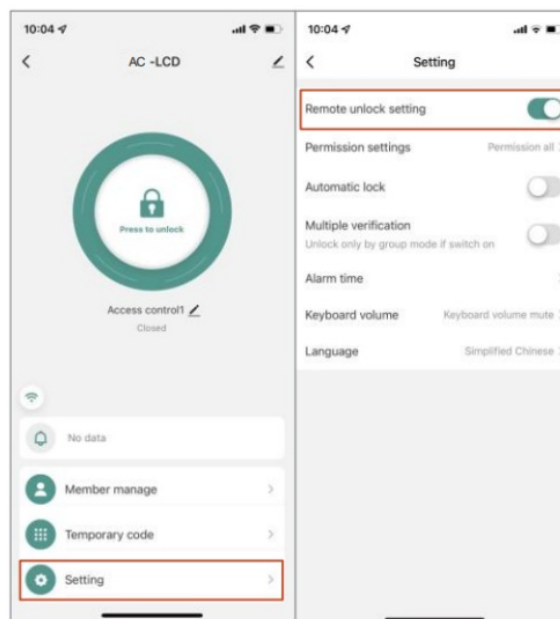

Figure3

4. Wait for successful connection, click Done



5. Set remote unlock, click setting, open remote unlock setting



6. Press to unlock

7. Member management Administrator Add fingerprint start adding input fingerprint twice add successfully, input name, click Done.

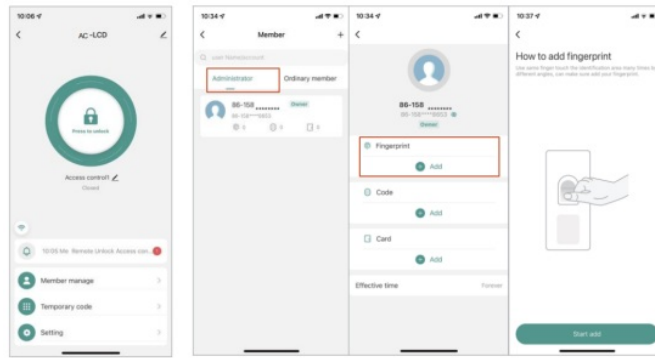

8. Add code user by clicking add temporary code periodically, and input 6 digits code or click randomly generated, then input code name, and click save.

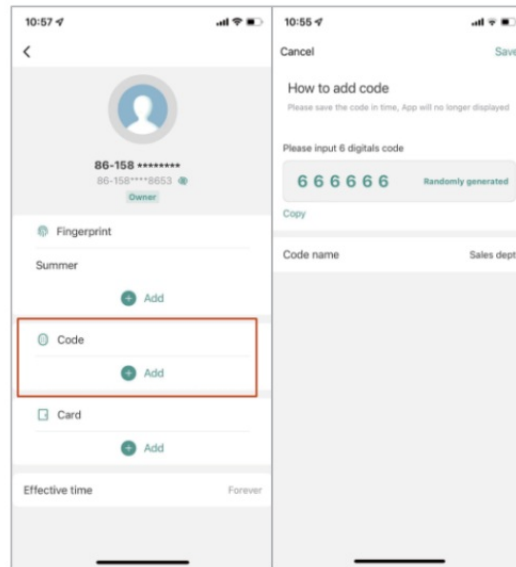

9. Add card by clicking start add, swiping one card within 60 seconds, add card successfully, then fill card name and click “done”.

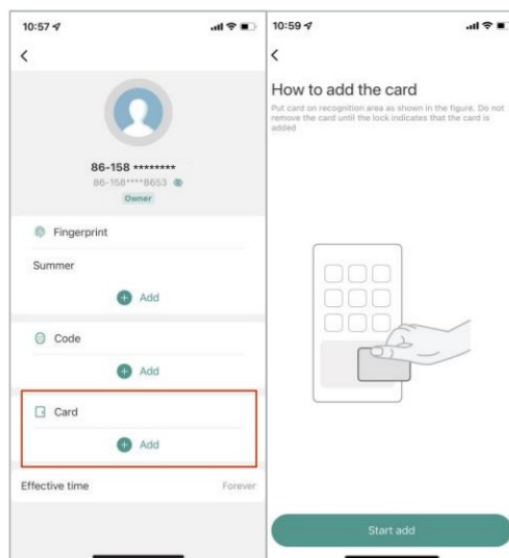

10. Add ordinary user by clicking ordinary member, then click at the upper right corner “+”, then input the related information and click “next step”.

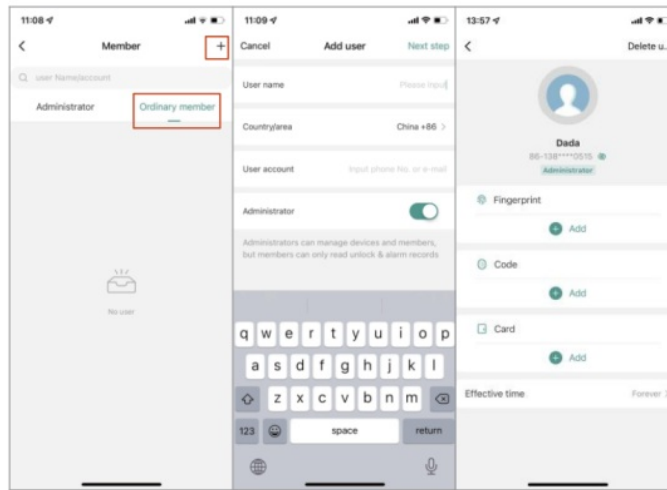

11. Add temporary code, click 'once', input code name, click "save offline code", done.

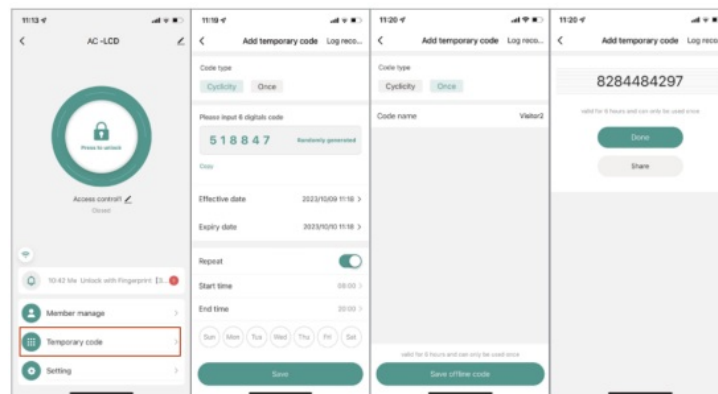

12. Query unlock records

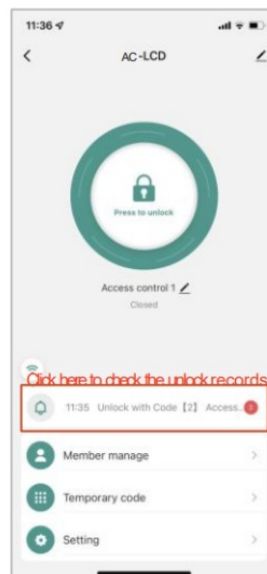

13. Settings: access ways, alarm time, volume, language.

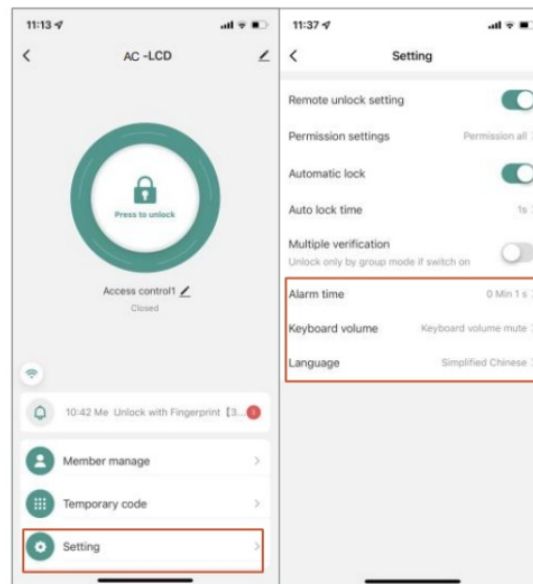

Manage Time & Attendance for all your Branches from Head Office



Disclaimer: Specifications can be changed without prior notice.

1. Buying and Selling SSL products online is prohibited and is termed as ilala
2. Installation/Technical support/Training to end user is the responsibility of the installer or dealer
3. eSSL, do not support end user directly, If they want support charges will be applicable



Enterprise Software Solutions Lab Pvt. Ltd. (Corporate-Office)

#24, 23rd main, Shahlavi Building. JP nagger 2nd phase, Bengaluru-560078



www.ess/security.com

sales@essisecurity.com

Ph: 91-8026090500

Documents / Resources

	eSSL JS-36E Security Standalone Access Control [pdf] User Manual JS-36E Security Standalone Access Control, JS-36E, Security Standalone Access Control, Standalone Access Control, Access Control
---	--

References

- [User Manual](#)

■ eSSL

◆ Access Control, eSSL, JS-36E, JS-36E Security Standalone Access Control, Security Standalone Access Control, Standalone Access Control

Leave a comment

Your email address will not be published. Required fields are marked *

Comment *

Name

Email

Website

☐ Save my name, email, and website in this browser for the next time I comment.

Post Comment

Search:

e.g. whirlpool wrf535swhz

Search

[Manuals+](#) | [Upload](#) | [Deep Search](#) | [Privacy Policy](#) | [@manuals.plus](#) | [YouTube](#)

This website is an independent publication and is neither affiliated with nor endorsed by any of the trademark owners. The "Bluetooth®" word mark and logos are registered trademarks owned by Bluetooth SIG, Inc. The "Wi-Fi®" word mark and logos are registered trademarks owned by the Wi-Fi Alliance. Any use of these marks on this website does not imply any affiliation with or endorsement.