



eSSL AIFACE-PLUTO 4-Inch Visible Light System User Guide

[Home](#) » [eSSL](#) » eSSL AIFACE-PLUTO 4-Inch Visible Light System User Guide 

Contents

- [1 eSSL AIFACE-PLUTO 4-Inch Visible Light System](#)
- [2 Overview](#)
- [3 Installation Environment](#)
- [4 Recommended Palm Gestures](#)
- [5 Recommended Standing Position](#)
- [6 Device Installation](#)
- [7 Standalone Installation](#)
- [8 Power Connection](#)
- [9 Ethernet Connection](#)
- [10 Lock Relay Connection](#)
- [11 RS485 Connection](#)
- [12 Access Control Setting](#)
- [13 Documents / Resources](#)
- [14 Related Posts](#)



eSSL AIFACE-PLUTO 4-Inch Visible Light System



Overview

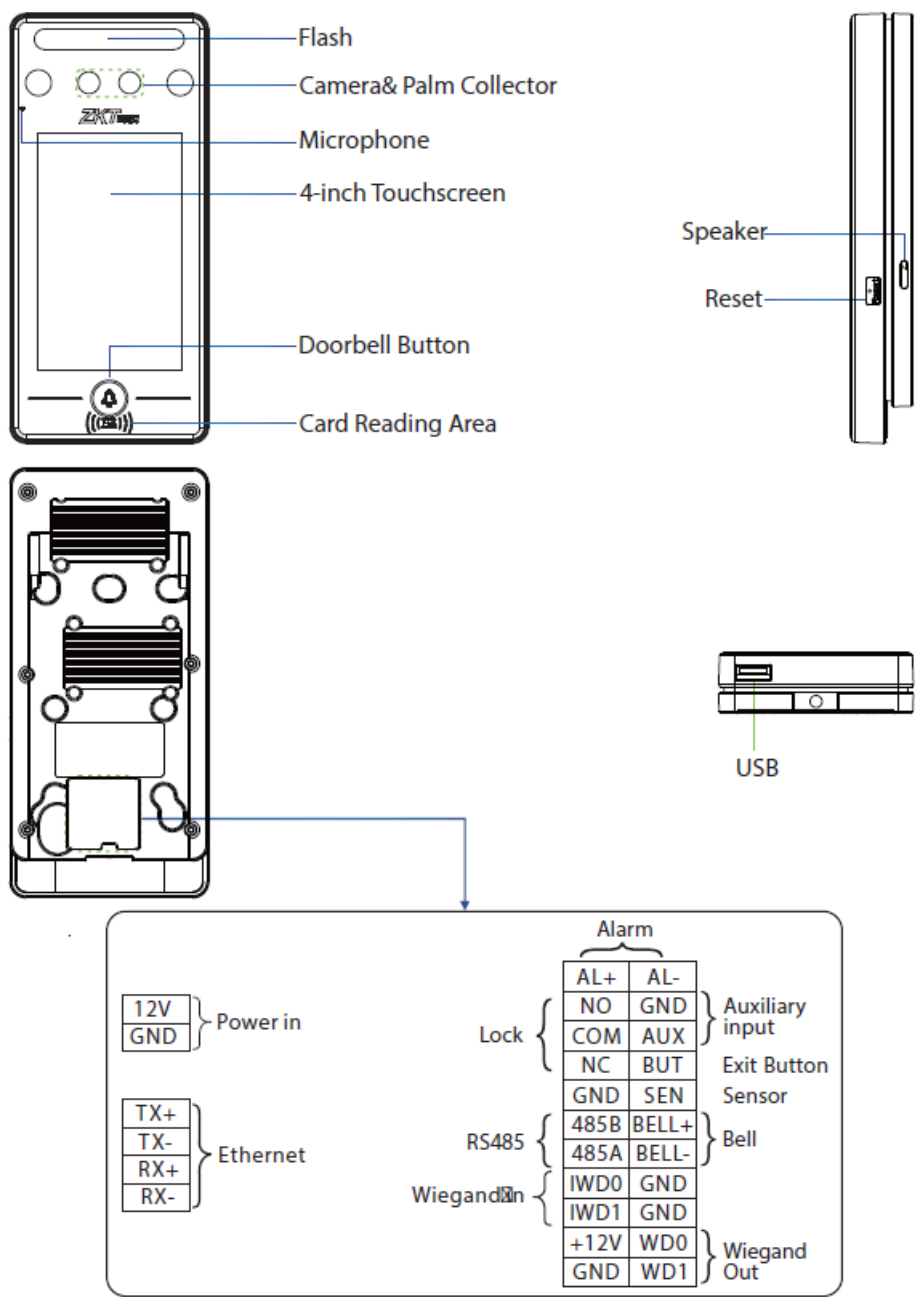

Installation Environment

Please refer to the following recommendations for installation



INSTALL INDOORS
ONLY

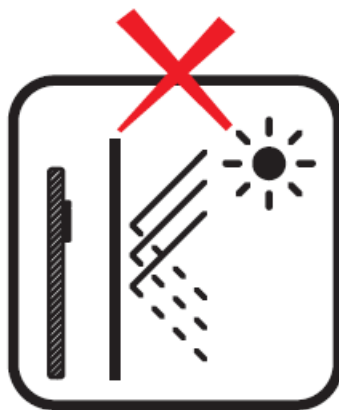

AVOID INSTALLATION
NEAR
GLASS WINDOWS

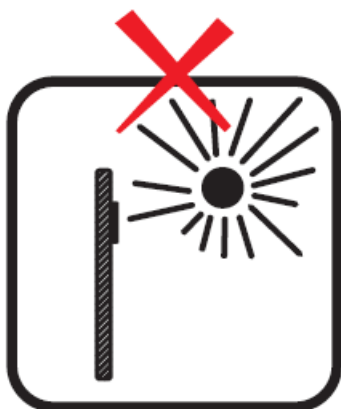

AVOID DIRECT
SUNLIGHT
AND EXPOSURE



AVOID USE OF ANY
HEAT SOURCE
NEAR THE DEVICE

Recommended Palm Gestures

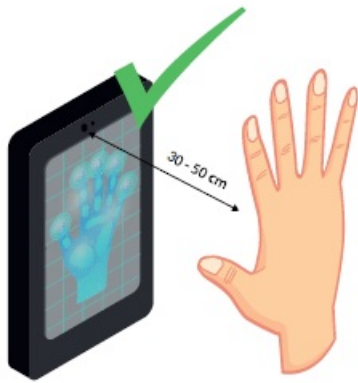

KEEP EFFECTIVE
DISTANCE OF
30-50 cm



KEEP SPACES
BETWEEN
YOUR FINGERS



DO NOT KEEP
YOUR FINGERS
CLOSE



DO NOT KEEP
PALM OUTSIDE
COLLECTION AREA



DO NOT KEEP
YOUR FINGERS
FOLD/CURLED

Note:

1. Place your palm within 30-50 cm of the device.
2. Place your palm in the palm collection area, such that the palm is placed parallel to the device.
3. Make sure to keep space between your fingers.

Recommended Standing Position

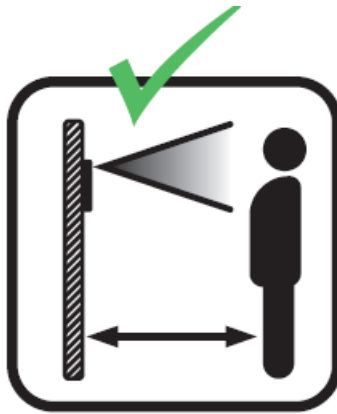

KEEP EFFECTIVE
DISTANCE OF
0.3-2m

Device Installation

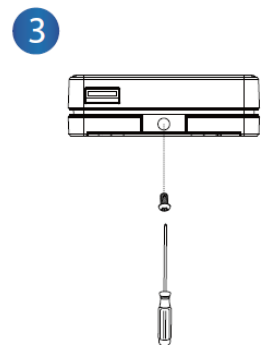
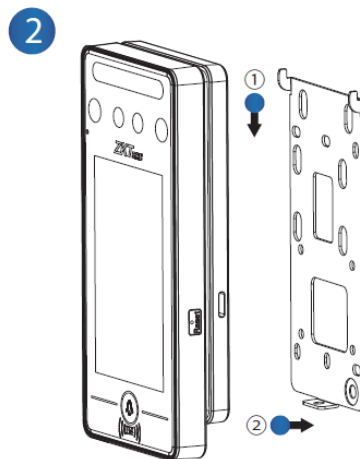
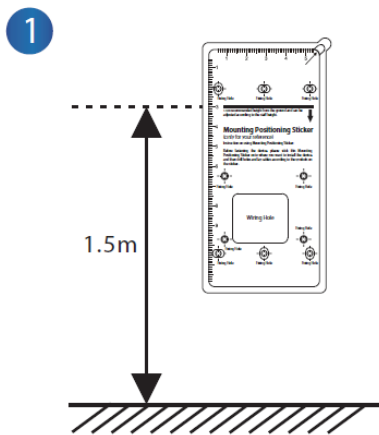

1. Attach the mounting template sticker to the wall, and drill holes according to the mounting paper. Fix the back plate on the wall using wall mounting screws.
2. Attach the device to the back plate.
3. Fasten the device to the back plate with a security screw

Standalone Installation

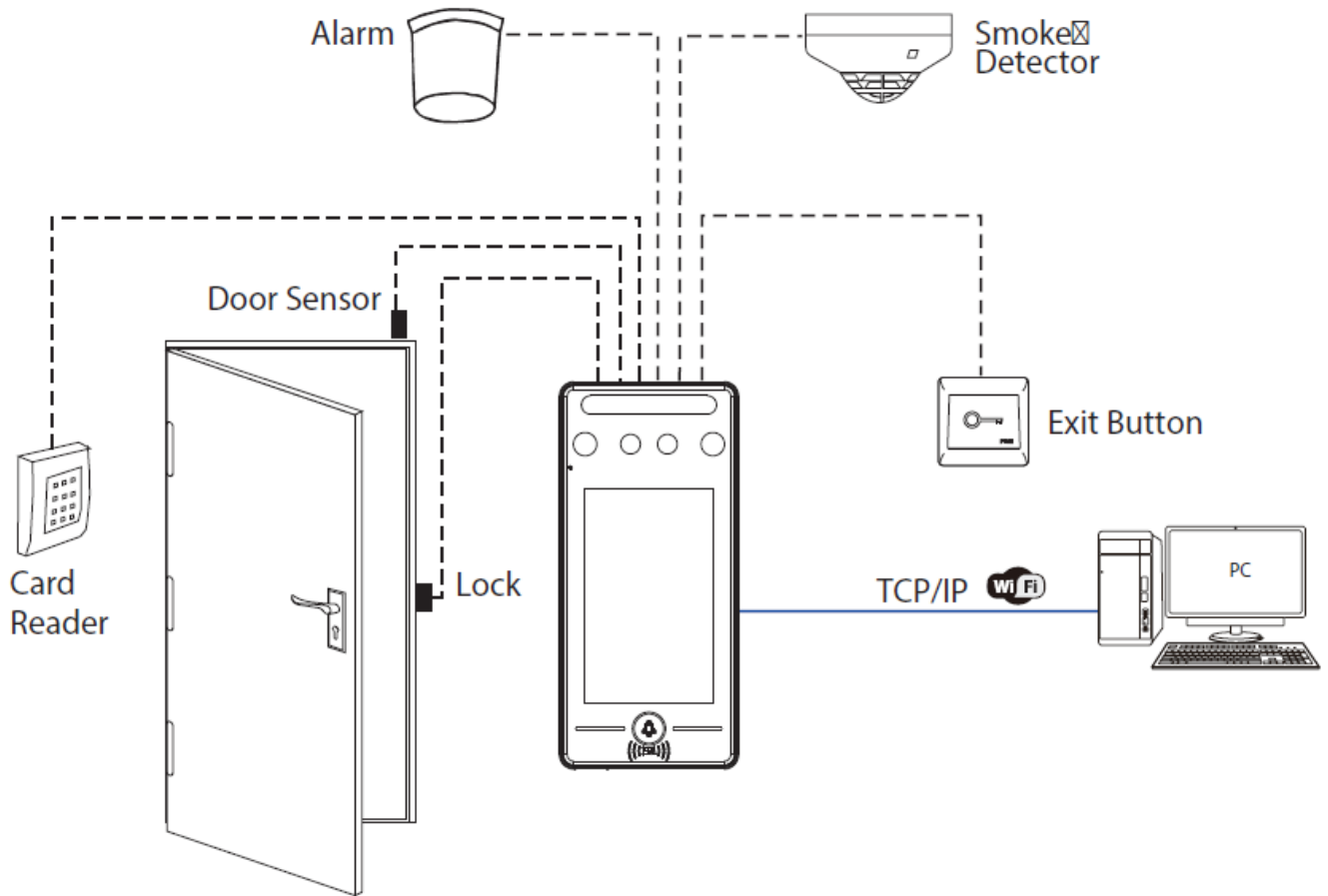

Power Connection

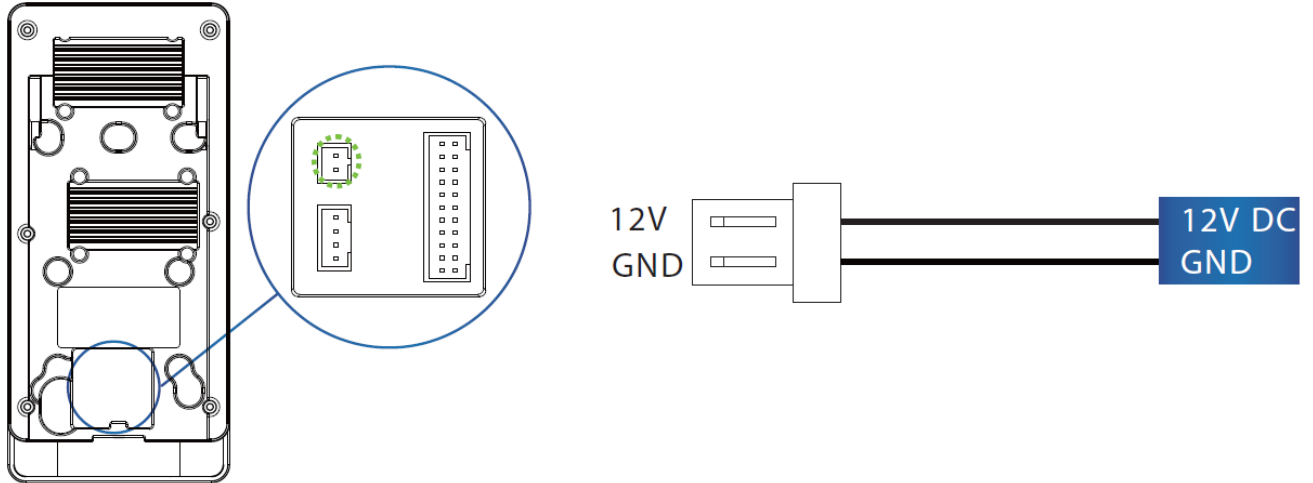

Ethernet Connection

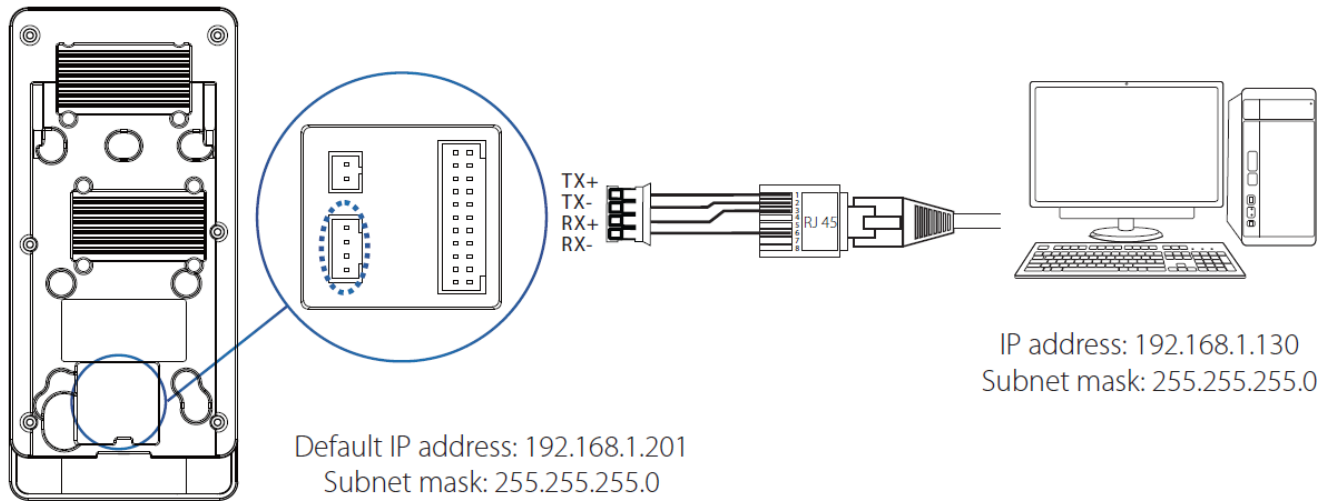

Click [COMM.] > [Ethernet] > [IP Address] , input the IP address and click [OK].

Note: In LAN, IP addresses of the server (PC) and the device must be in the same network segment when connecting to BioAccess IVS software

Lock Relay Connection

The system supports both Normally Opened Lock and Normally Closed Lock. The NO Lock (normally opened when powered) is connected with 'NO1' and 'COM' terminals, and the NC Lock (normally closed when powered) is connected with 'NC1' and 'COM' terminals. The power can be shared with the lock or can be used separately for the lock, as shown in the example with NC Lock below:

1. Device not sharing power with the lock

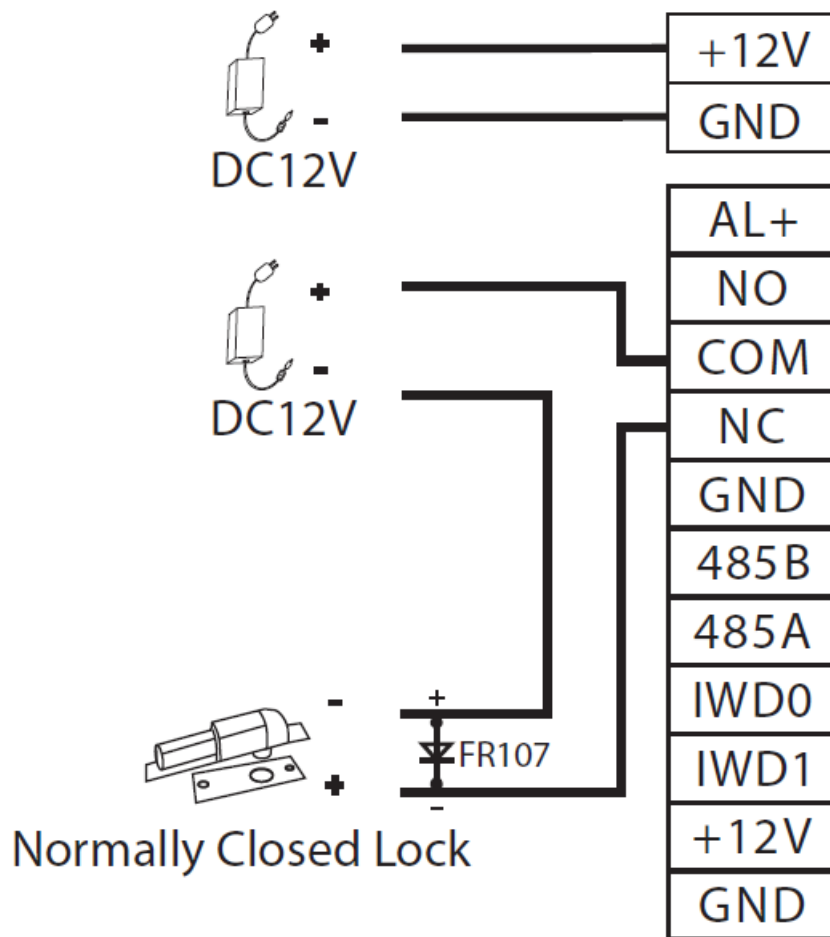

2. Device sharing power with the lock

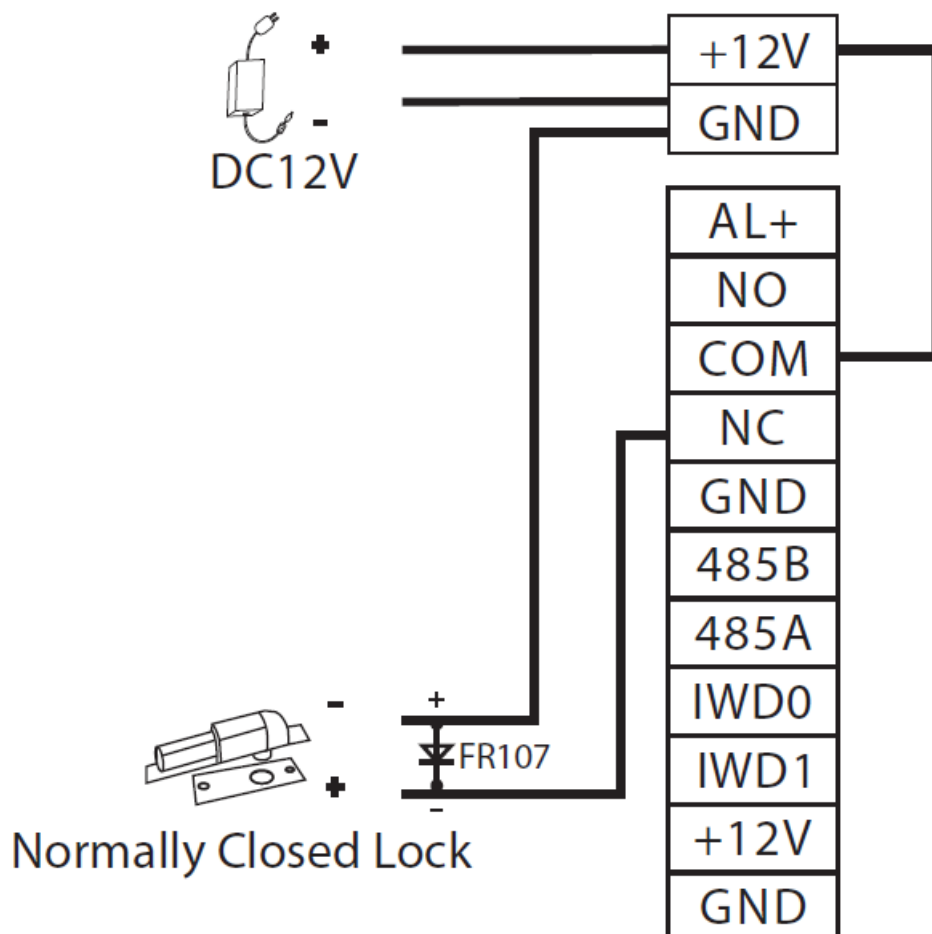

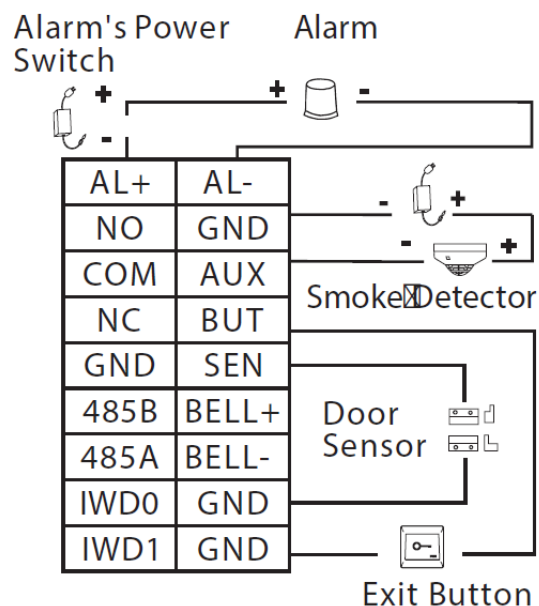
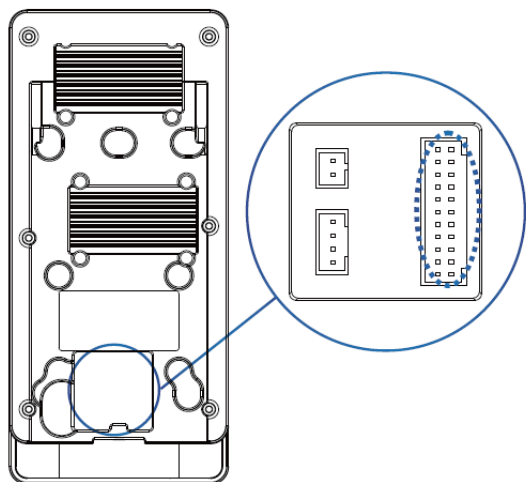

Wiegand Reader Connection

Wiegand card reader connects to the top 4 pins of the wiegand terminal and the last two pins are used by the Access Controller, as shown in the following figure. It sends the credentials to the device via wiegand communication

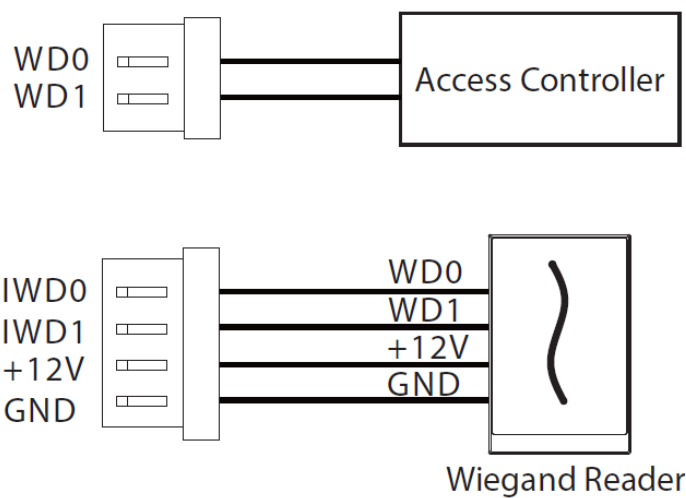
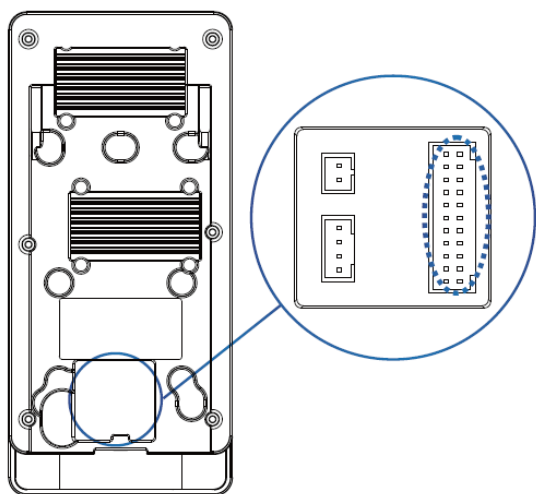

RS485 Connection

The RS485 lets user connect to multiple readers to the device. RS485 can be connected to the terminal, as shown in the figure below

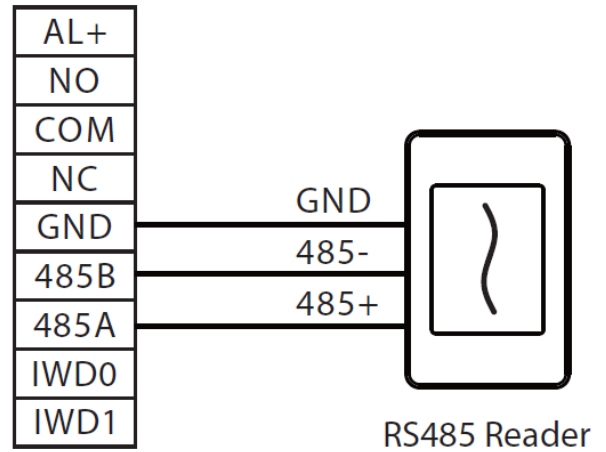
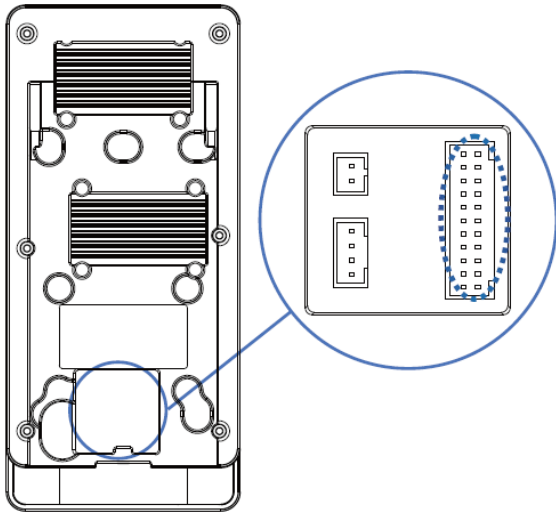

User Registration



When there s no super administrator set in the device, click on  to enter the menu. Add a new user and set User Role to Super Admin, then the system will request for the administrator's verification before entering the menu. It is recommended to register a super administrator initially for security purposes

Method 1: Register on the device



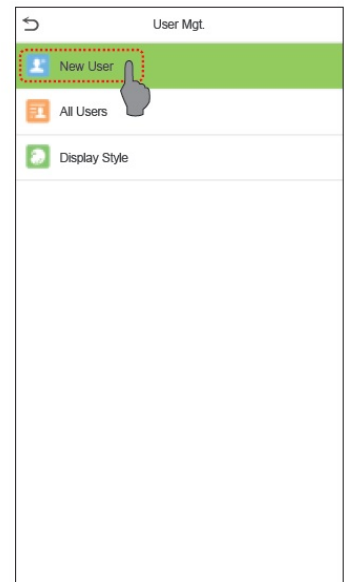
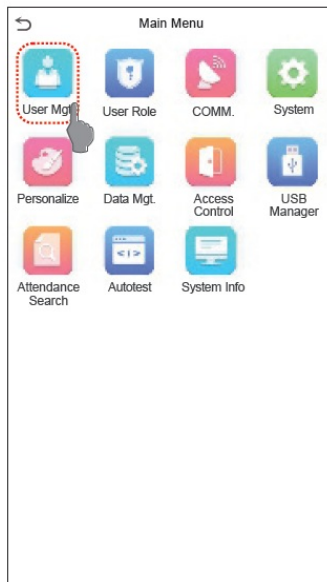
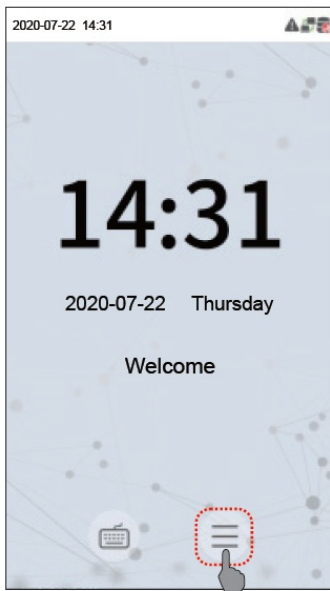

Click on  > [User Mgt.] > [New User] to register a new user. The options include entering the user ID and Name, setting User Role, registering Palm, Face, Card Number, Password and adding User Photo



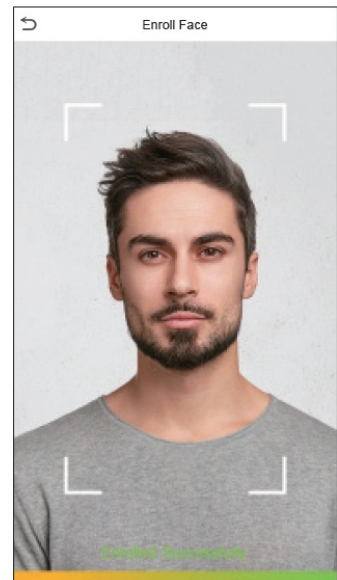
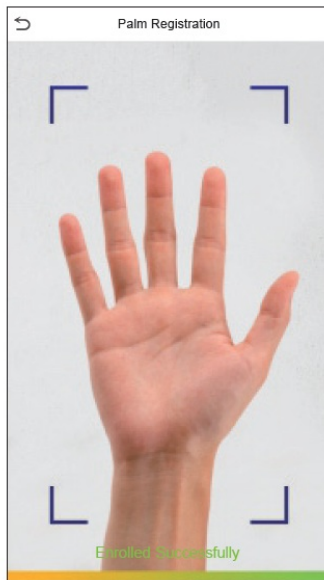

New User	
User ID	1
Name	Mike
User Role	Normal User
Palm	1
Face	1
Card Number	1
Password	*****
User Photo	1
Access Control Role	



Ethernet and Cloud Server Settings

Click on  > [COMM.] > [Ethernet] to set the network parameters. If the TCP/IP communication of the device is successful, the icon  will be displayed in the upper right corner of the standby interface

Click on  > [COMM.] > [Cloud Server Setting] to set the server address and server port, that is, the IP address and port number of the server after the software is installed. If the device communicates with the server successfully, the icon  will be displayed in the upper right corner of the standby interface

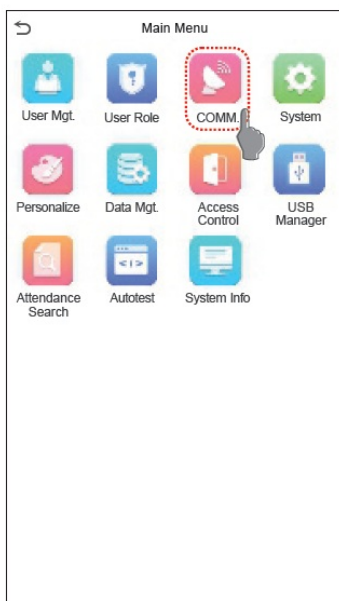

Ethernet	
IP Address	192.168.163.200
Subnet Mask	255.255.255.0
Gateway	192.168.163.1
DNS	0.0.0.0
TCP COMM. Port	4970
DHCP	<input type="checkbox"/>
Display in Status Bar	<input checked="" type="checkbox"/>

Cloud Server Setting	
Server mode	ADMS
Enable Domain Name	<input type="checkbox"/>
Server Address	0.0.0.0
Server Port	8081
Enable Proxy Server	<input type="checkbox"/>
HTTPS	<input type="checkbox"/>

Note:

While pairing the device with ZKBioAccess IVS software. Make sure that the option

Enable Domain Name is disabled and the correct server address and port are entered.

Server Address: Set as the IP address of the ZKBioAccess IVS server.

Server Port: Set as the service port of ZKBioAccess IVS(the default is 8088)

Access Control Setting



Click on  > [Access Control] to enter the access control management interface and set relevant parameters of access control

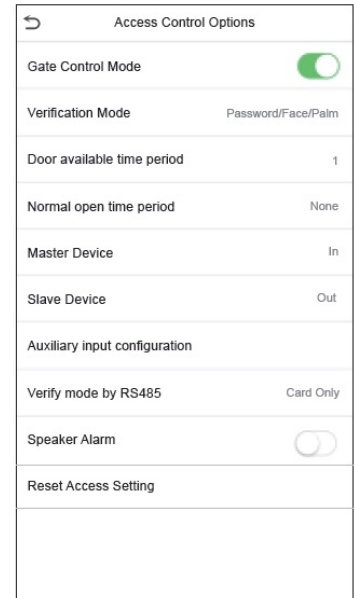
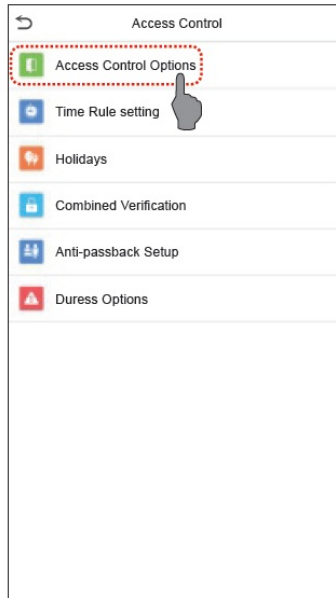
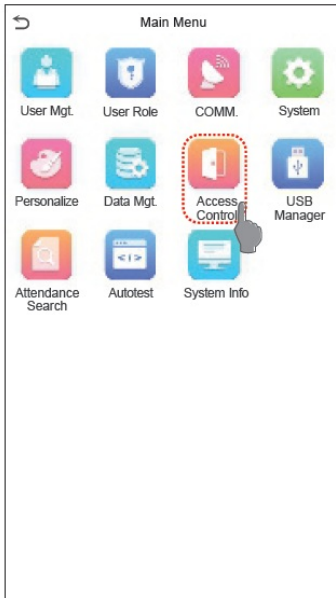

Attendance Record



Click on  > [Attendance Search] > [Event Logs] to enter the logs query interface, input the user ID and select the time range, the corresponding event logs will be displayed.

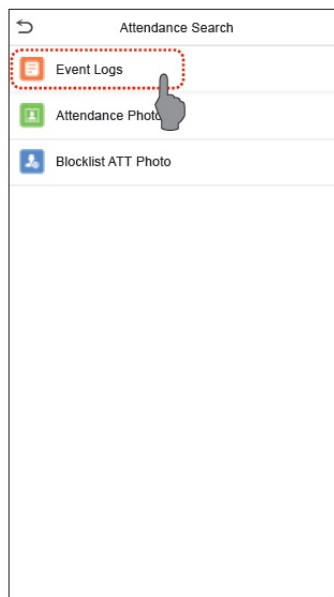

Personal Record Search		
Date	User ID	Time
03-03	Number of Records:04	
	4	11:25
	2	11:25:00
	3	11:25
03-04	Number of Records:04	
	1	11:29
	3	11:29:00
	2	11:28
03-05	Number of Records:04	
	4	11:26
	1	11:27
	3	11:27:00

Email : sales@esslsecurity.com
www.esslsecurity.com

Documents / Resources

 Quick Start Guide 4-Inch Visible Light System  www.esslsecurity.com	eSSL AIFACE-PLUTO 4-Inch Visible Light System [pdf] User Guide AIFACE-PLUTO, 4-Inch Visible Light System, AIFACE-PLUTO 4-Inch Visible Light System
--	---

Manuals+