



essity 2ABK3-571708 Tork Counter Mount Foam Soap Dispenser Instruction Manual

[Home](#) » [essity](#) » **essity 2ABK3-571708 Tork Counter Mount Foam Soap Dispenser Instruction Manual** 

essity 2ABK3-571708 Tork Counter Mount Foam Soap Dispenser



Contents

[1 Installation
Instructions](#)

[2 FCC Statement](#)

[3 Customers Support](#)

[4 Documents /
Resources](#)

[4.1 References](#)

[5 Related Posts](#)

Installation Instructions

1. Hole size: $\frac{7}{8}$ " max 2" Counter thickness MIN 0.063 – MAX 3"

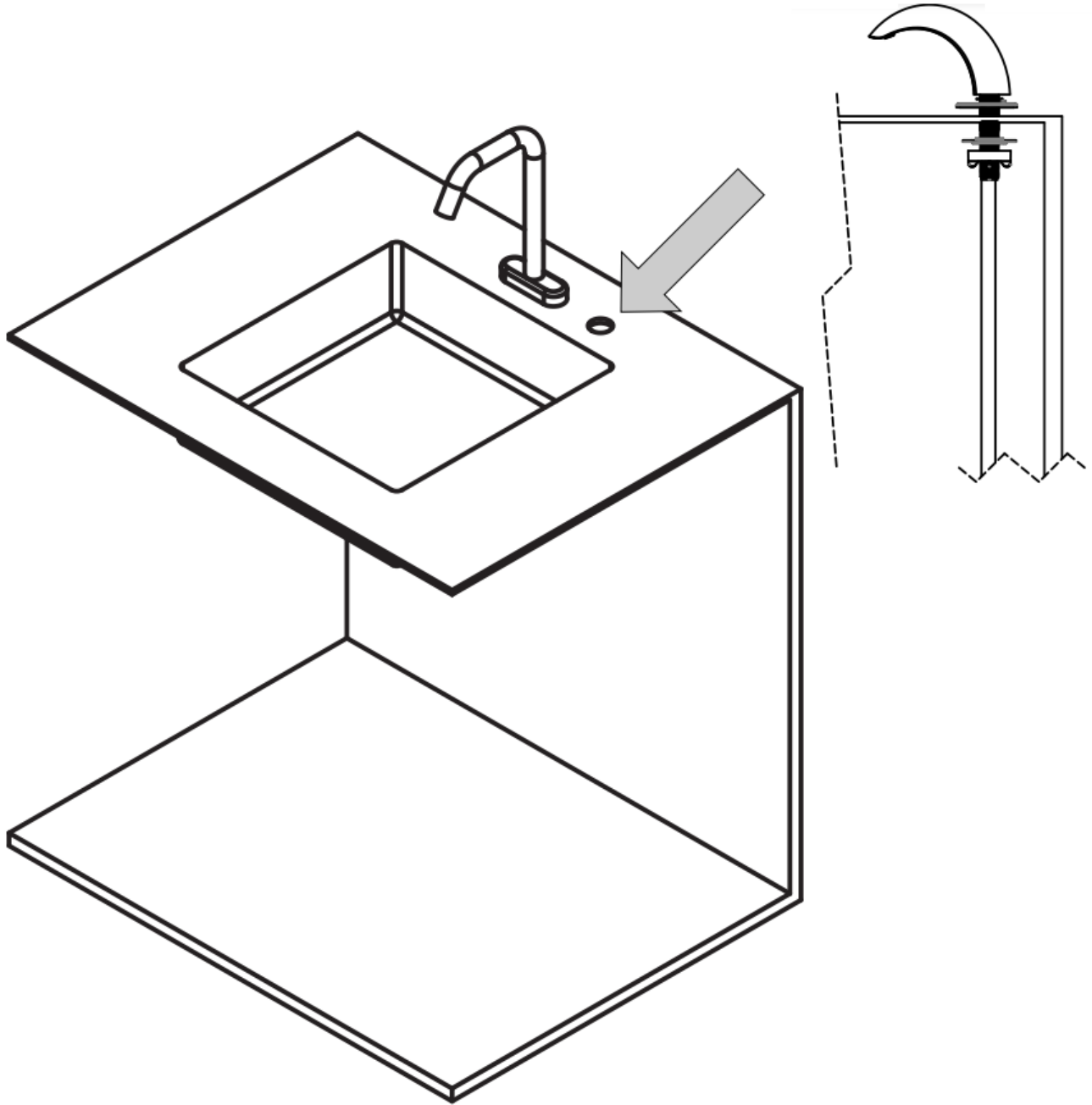

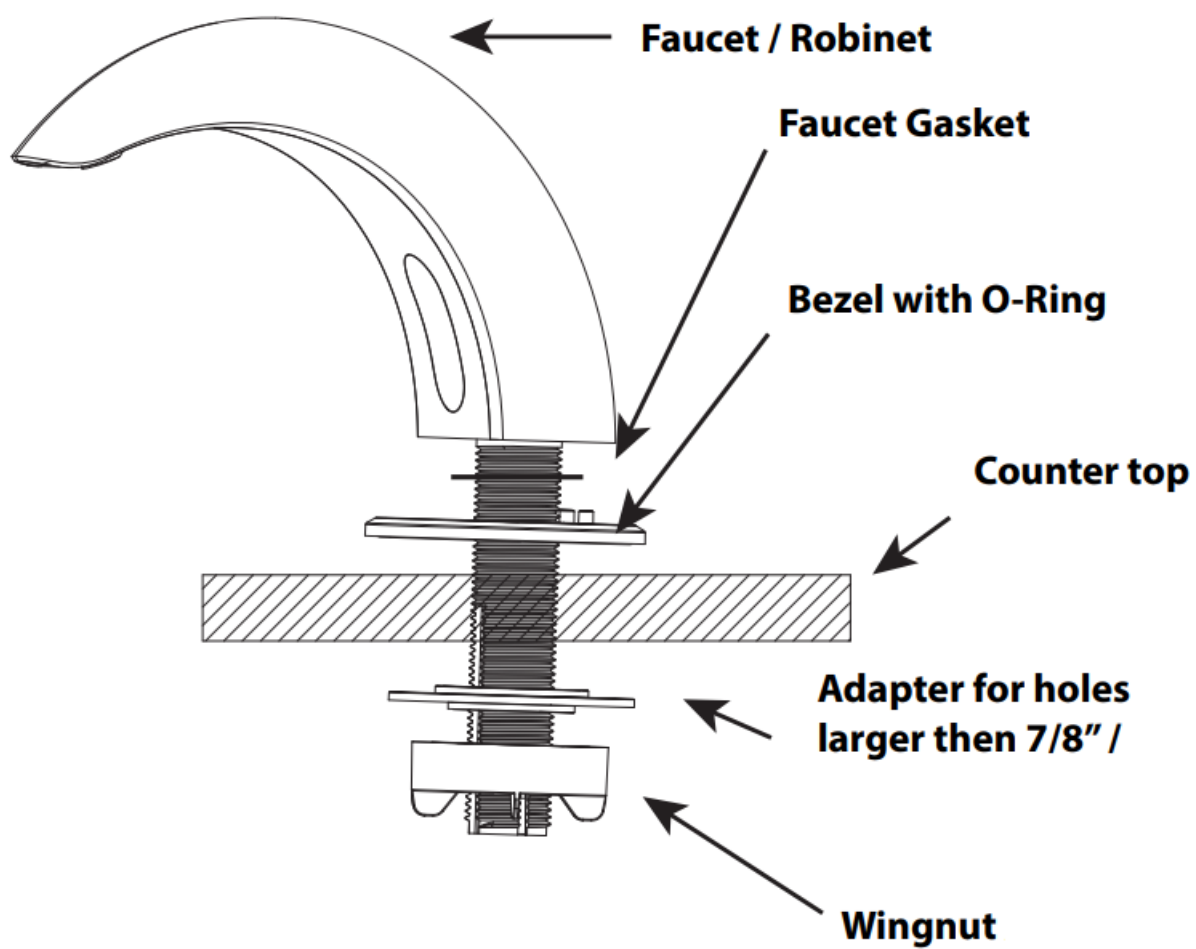

- 2.
3. Minimum 6" between faucet and hole Hole distance from edge of sink 1.5" to 3.5"

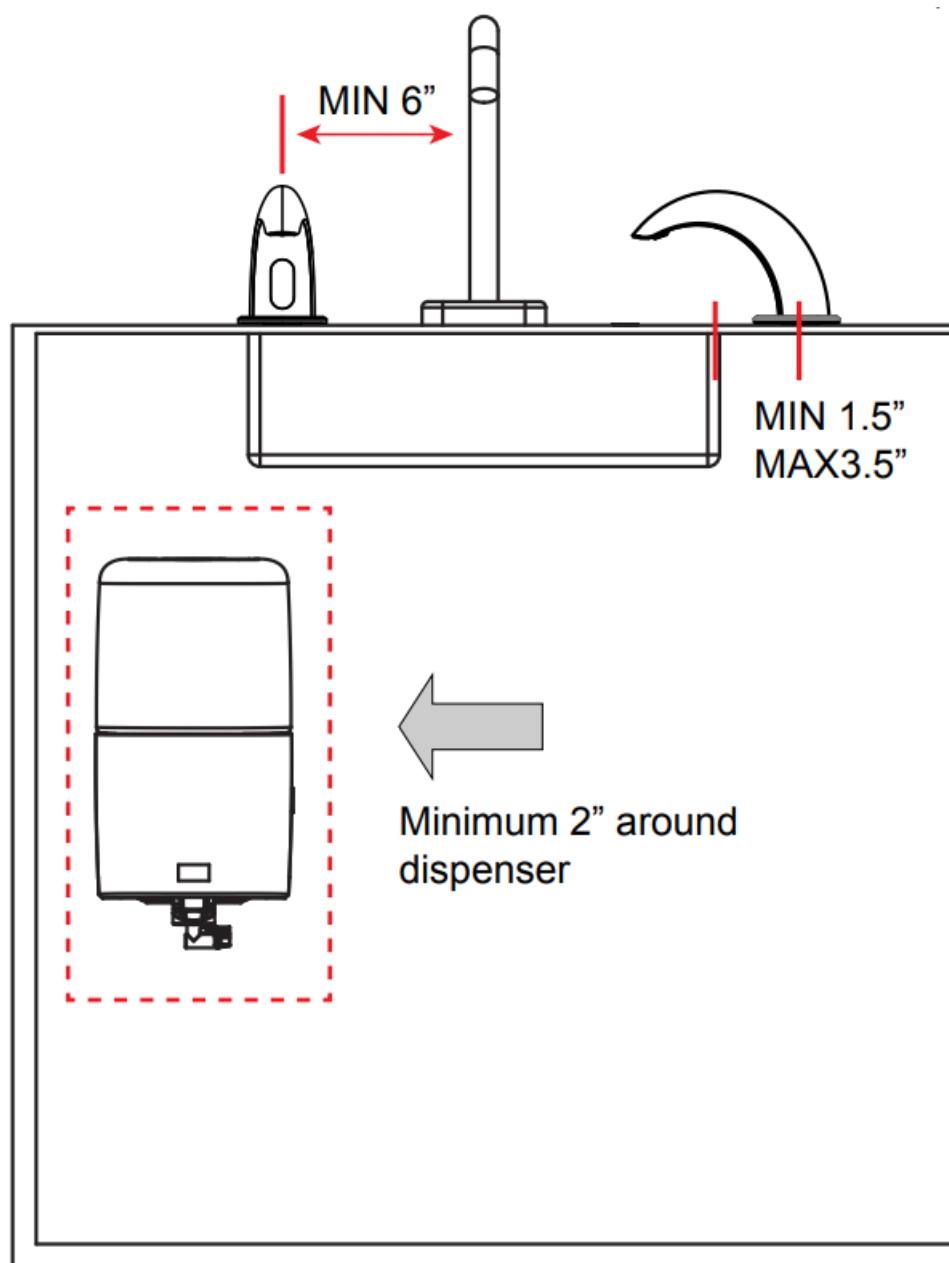

4. To open the dispenser push one of the side buttons.

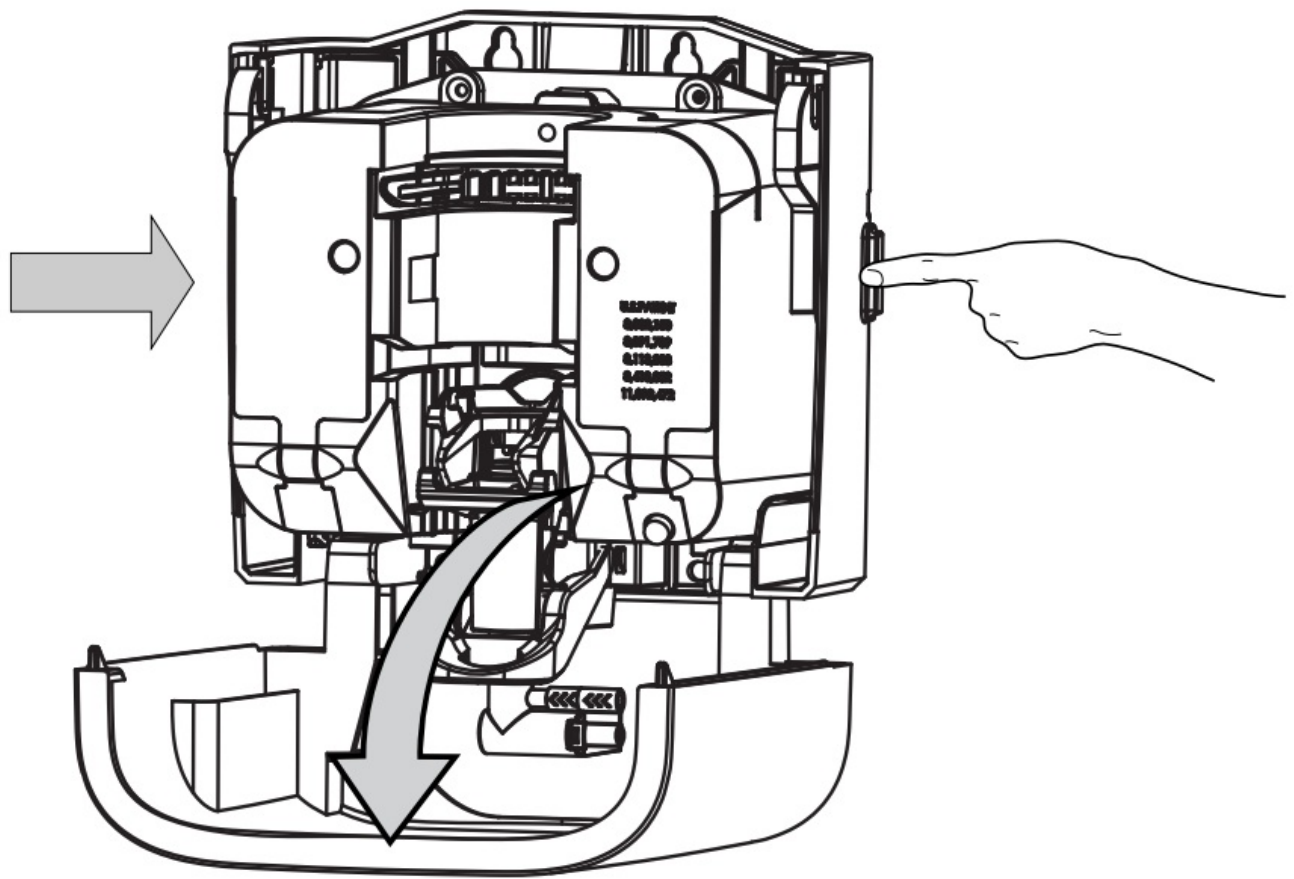

5. Harness and tube to be routed away from work area. Make sure there is some slack in the wire/tubing connection.

Do not pull on harness and wire.

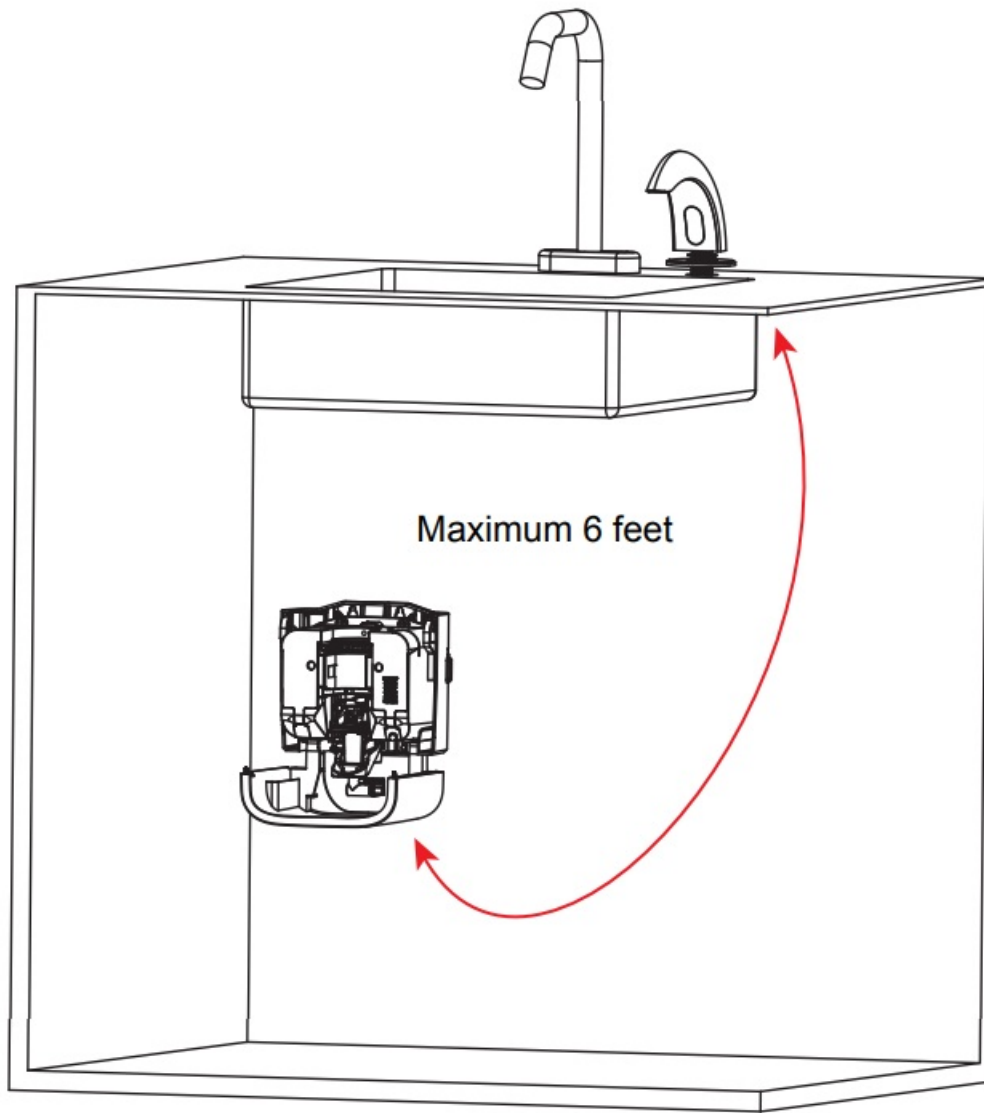

6. Mount the dispenser to wall using double sided tape or screws. The installation surface should be flat and plumb.

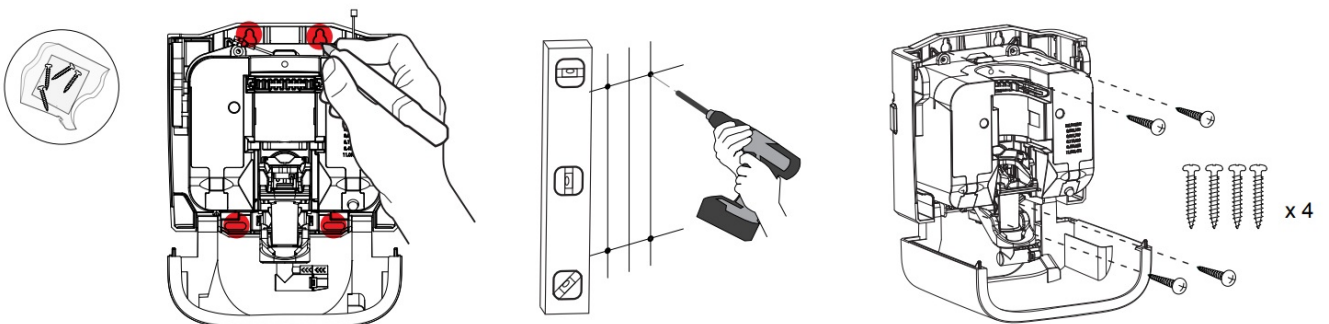

7. Dosage adjuster.

Use a flat bit screwdriver to slide the dosage adjuster

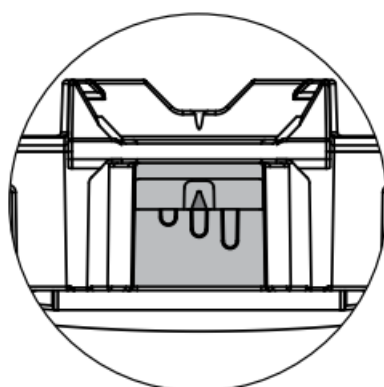
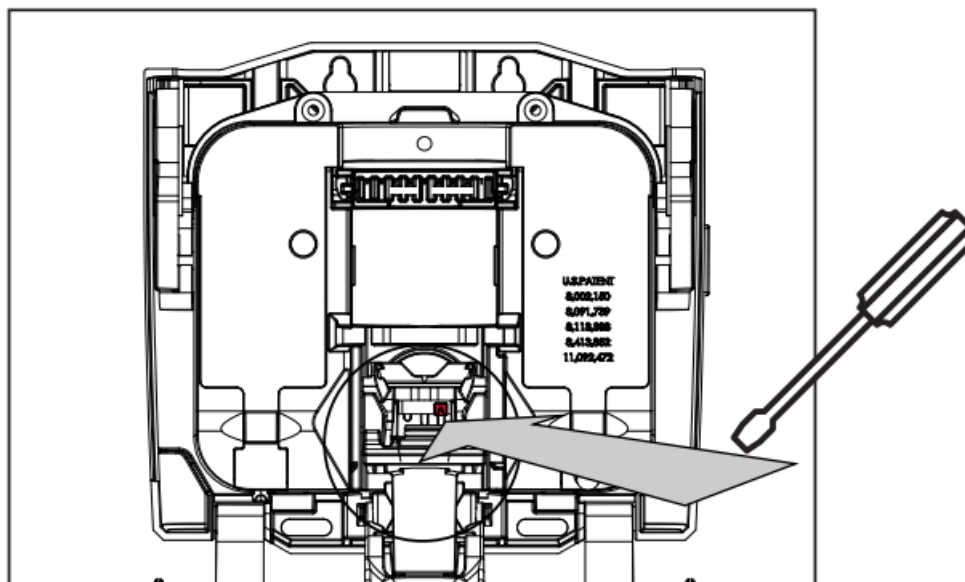

0.5ml

Medium

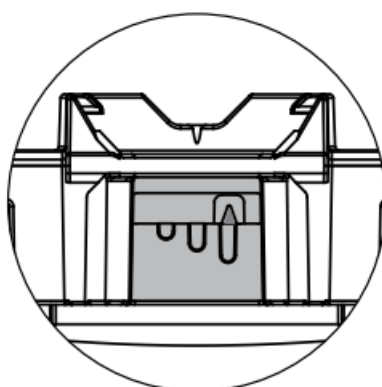

0.9ml

High

8. Connect the hoses.

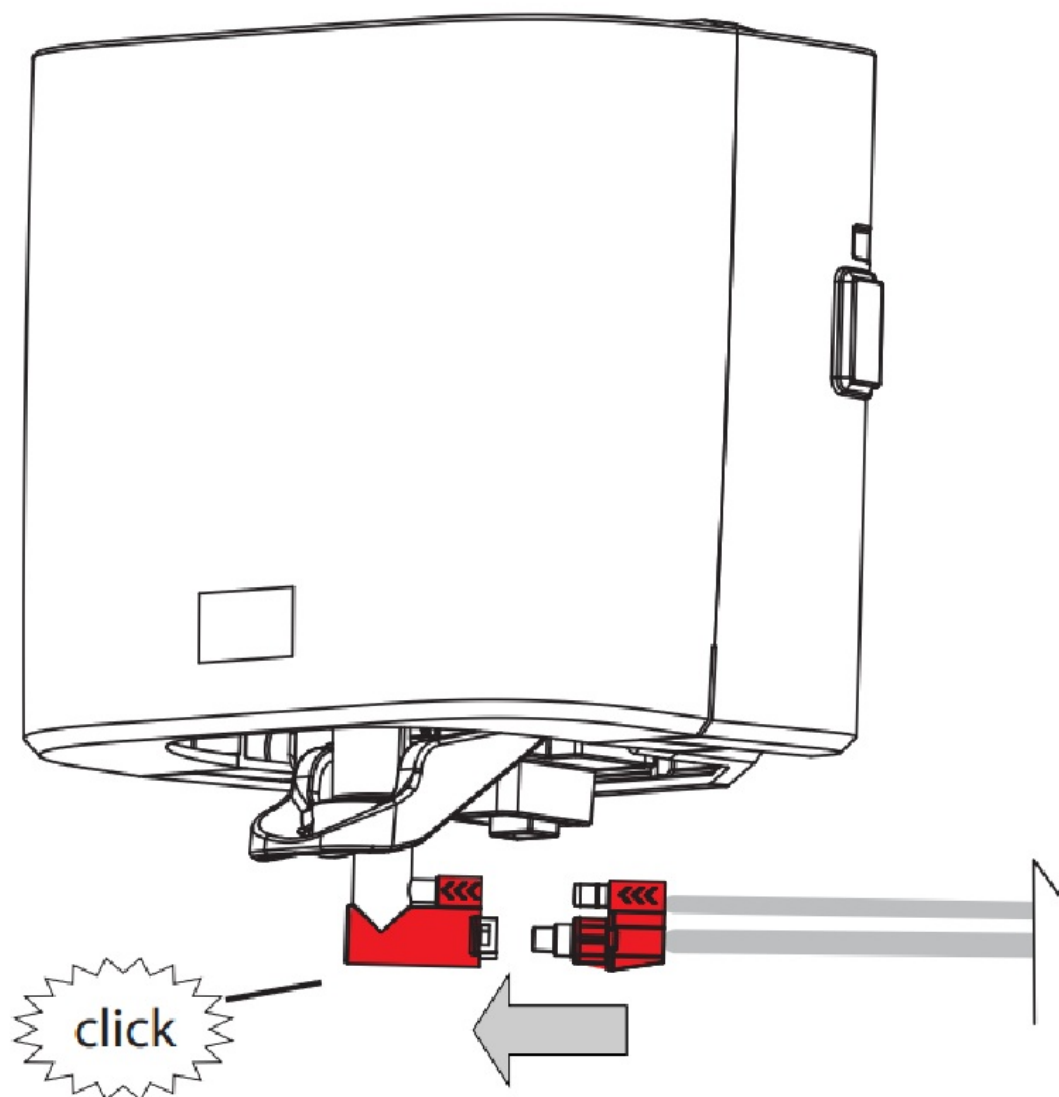

9. Connect the harness to the power system.

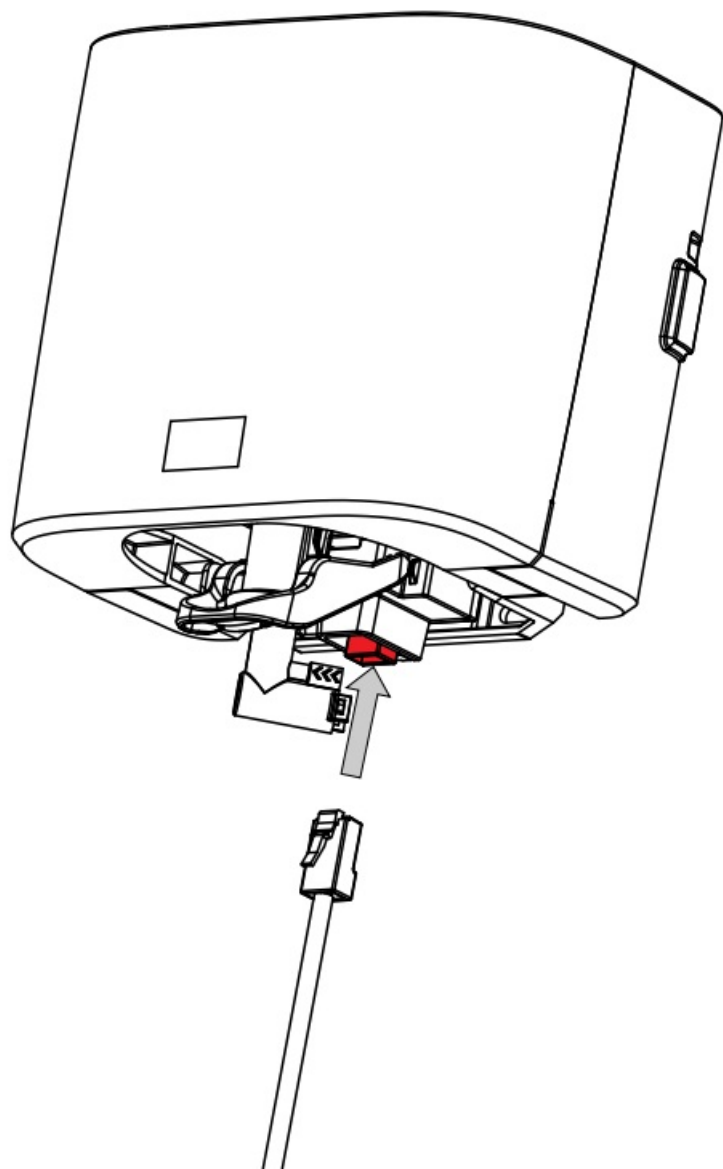

10. Use 4 x Type D 1.5V DC Alkaline battery only

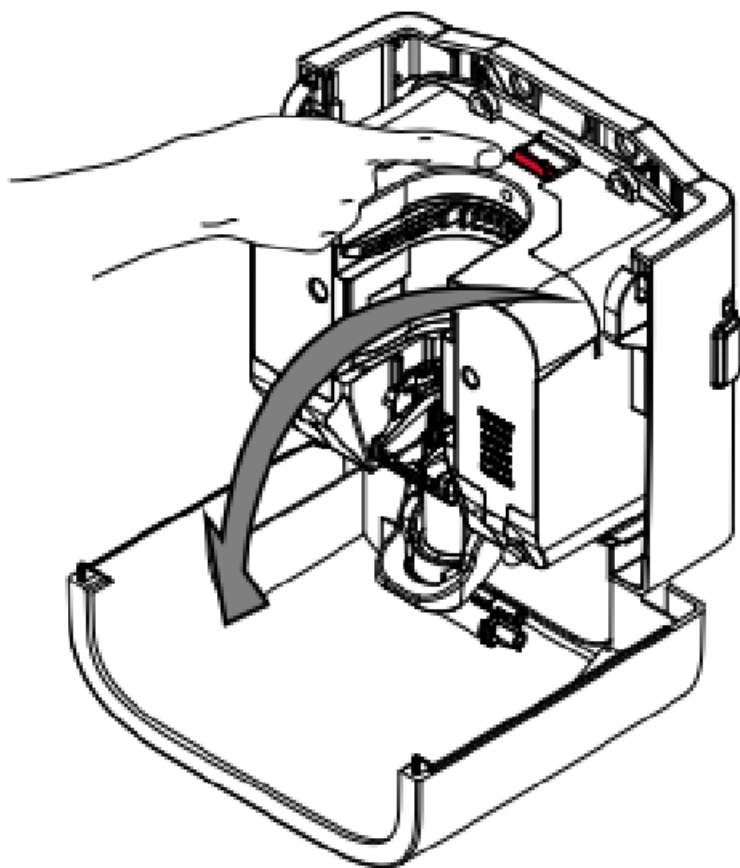

- Insert and remove the batteries as shown in the picture.
- Non-rechargeable batteries are not to be charged.
- Different types of batteries or new and used batteries are not to be mixed.
- Batteries are to be installed with right polarity.
- Exhausted batteries are to be removed from the dispenser and safely disposed of.
- If the dispenser is to be stored unused for a long period, the batteries should be removed.

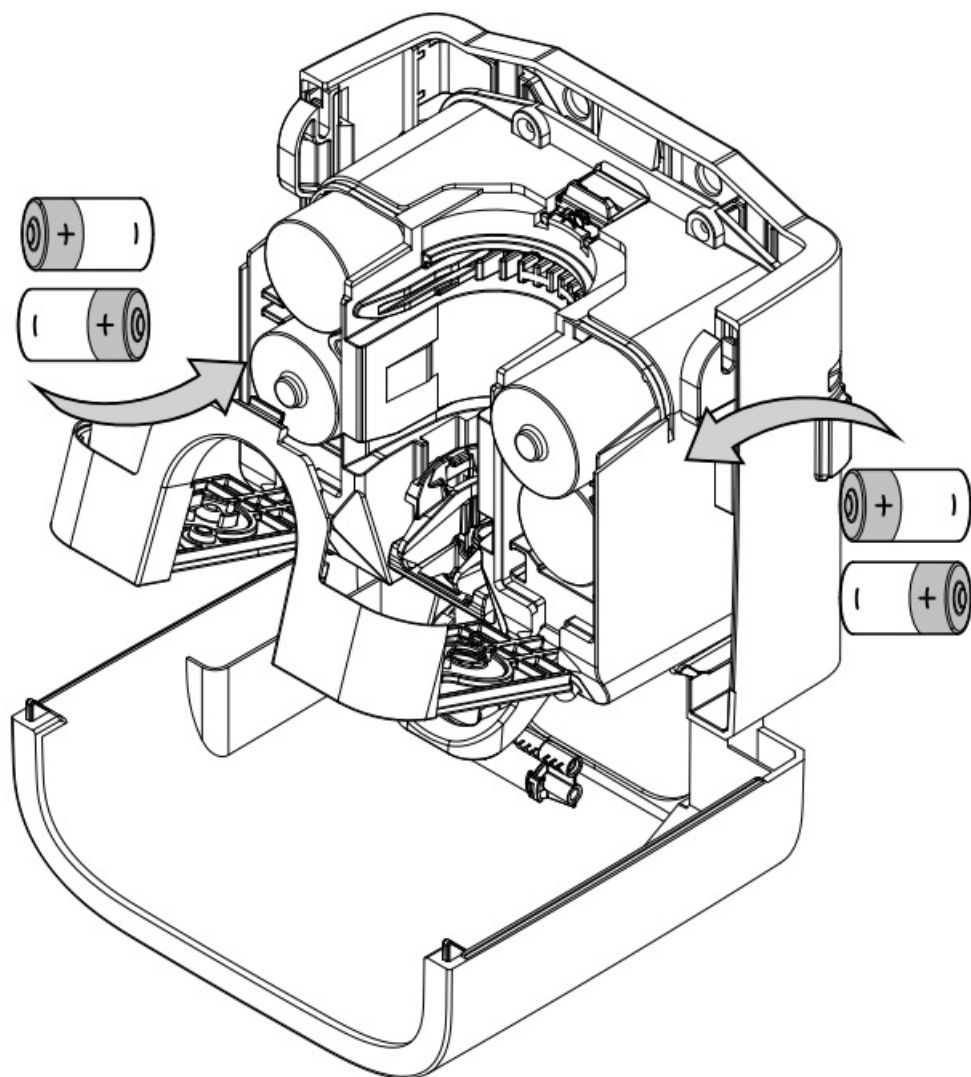

11. Pop cap straight off refill tip before loading in dispenser.

WARNING cap is secured very tight. Use outer rim to pry upwards.

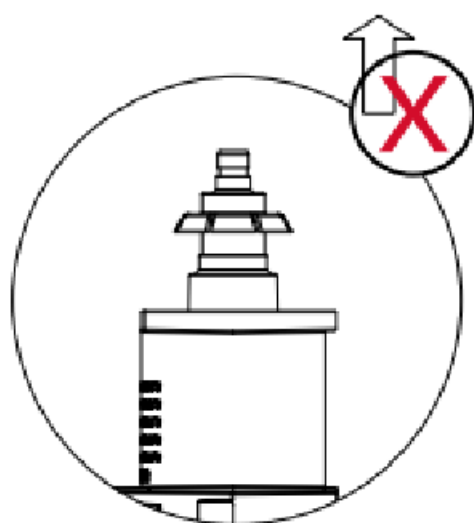
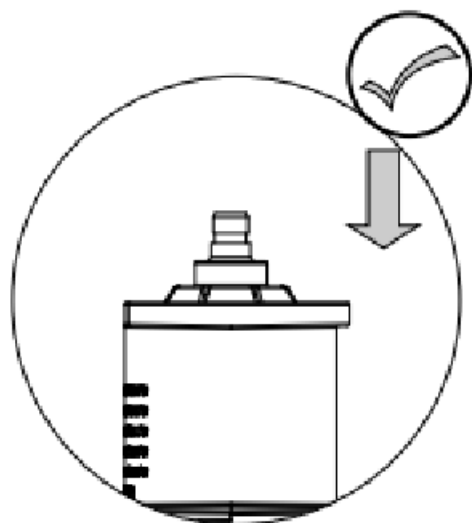
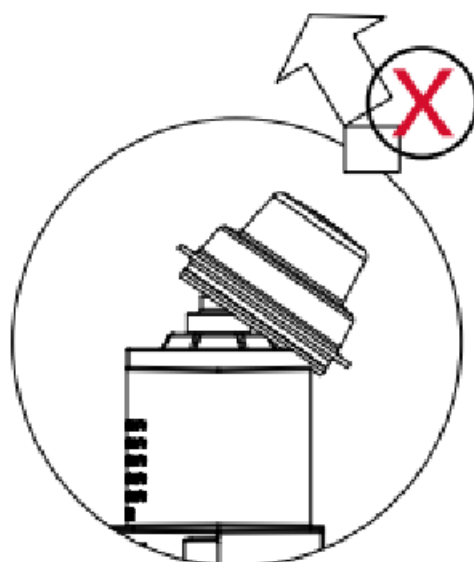
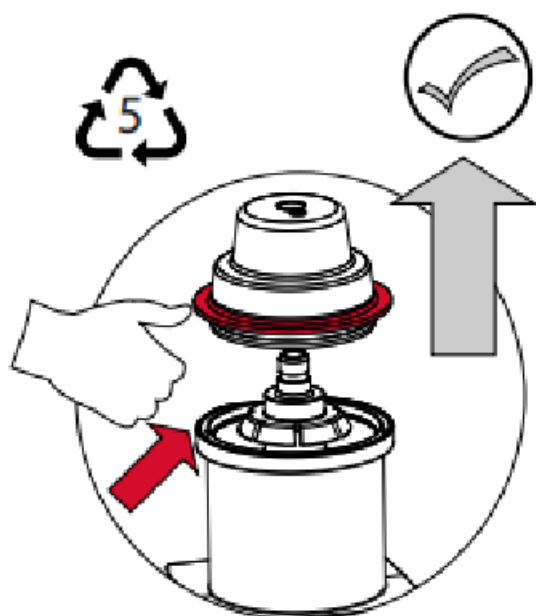

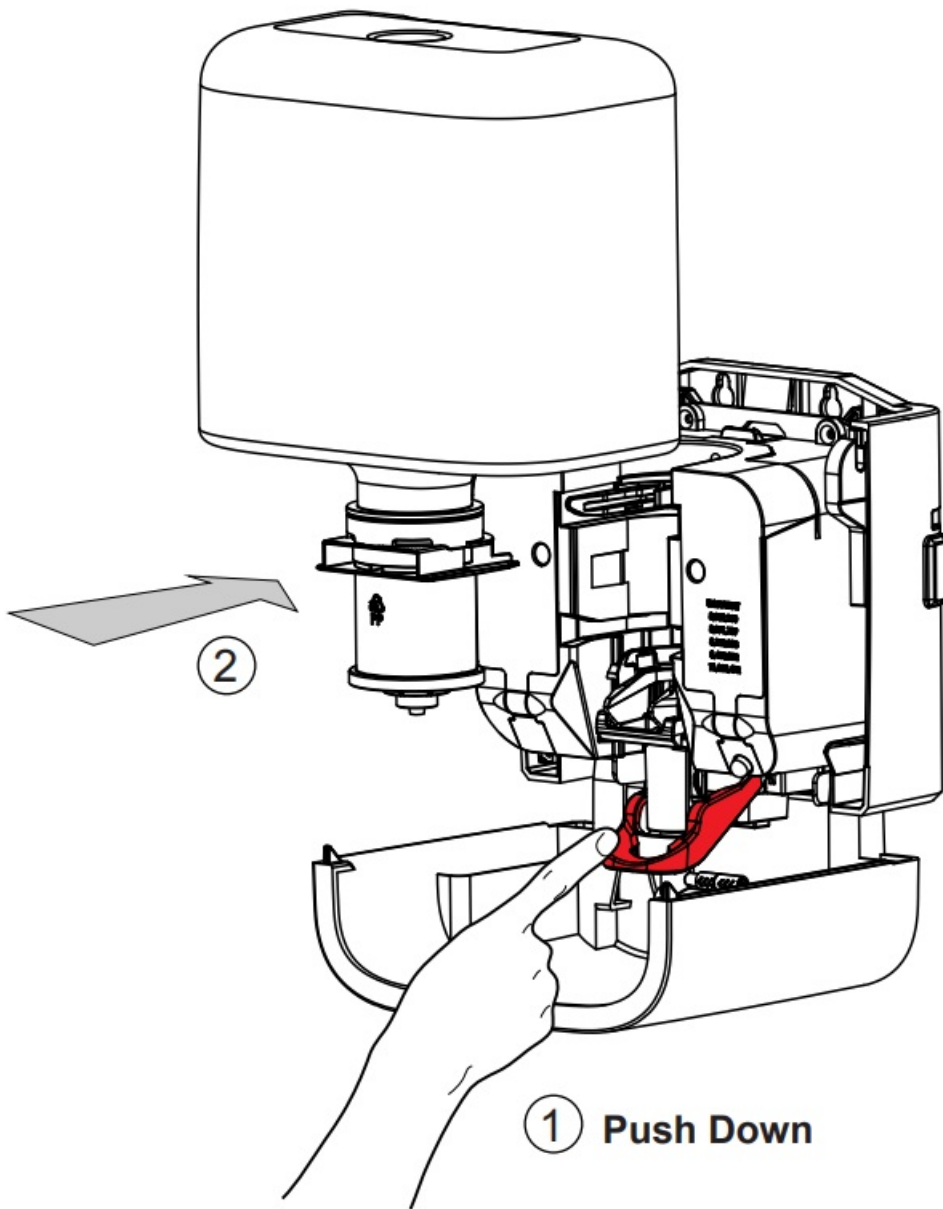

12. L.E.D. Light Meaning

1. Solid Red = Cover Open
2. Green = In Use
3. Flashing Red = Low Battery

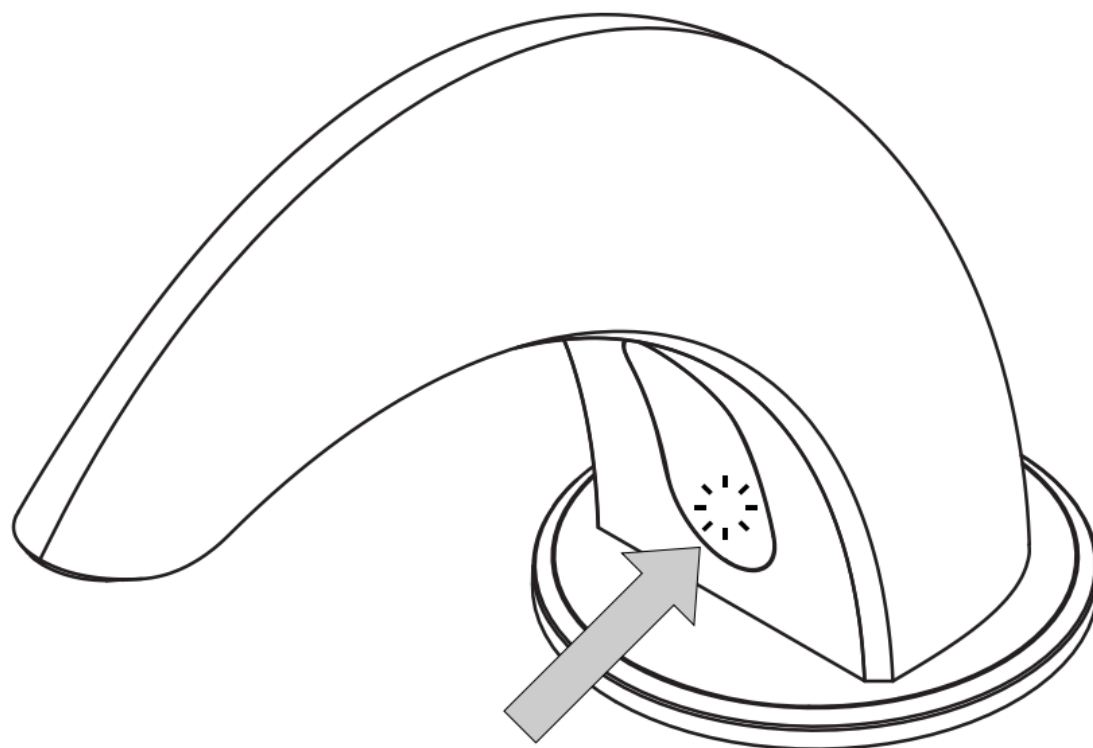

13. Prime button. 10 activations.

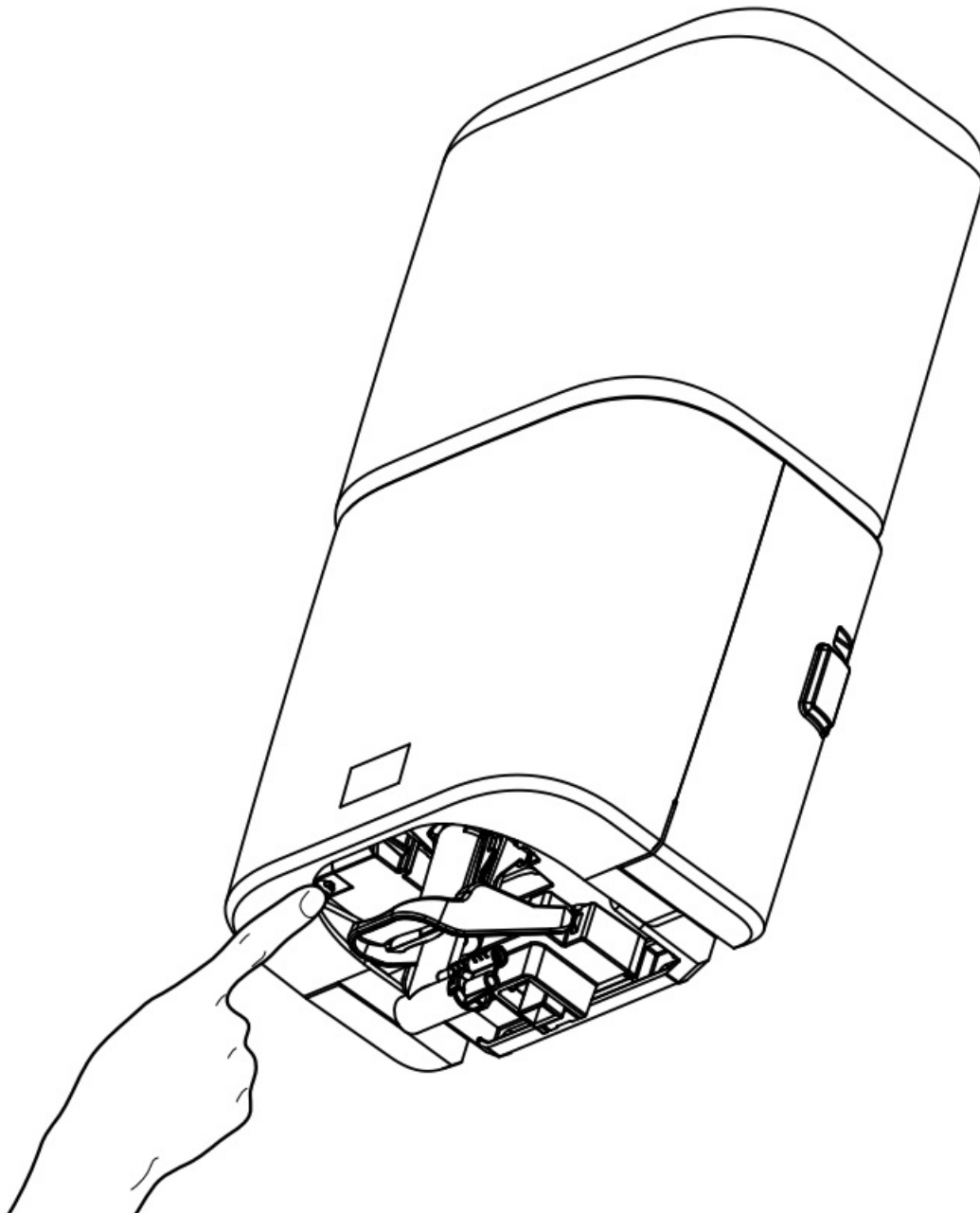

FCC Statement

This device contains licence-exempt transmitter(s)/ receiver(s) that comply with Innovation, Science and Economic Development Canada's licence-exempt RSS(s). Operation is subject to the following two conditions:

1. This device may not cause interference.
2. This device must accept any interference, including interference that may cause undesired operation of the device.

This device complies with Part 15 of the FCC Rules. Operation is subject to the following two conditions: (1) this device may not cause harmful interference, and (2) this device must accept any interference received, including interference that may cause undesired operation.

Note: This equipment has been tested and found to comply with the limits for a Class B digital device, pursuant to part 15 of the FCC Rules. These limits are designed to provide reasonable protection against harmful interference in a residential installation. This equipment generates, uses, and can radiate radio frequency energy and, if not installed and used in accordance with the instructions, may cause harmful interference to radio communications. However, there is no guarantee that interference will not occur in a particular installation. If this equipment does

cause harmful interference to radio or television reception, which can be determined by turning the equipment off and on, the user is encouraged to try to correct the interference by one or more of the following measures:

- Reorient or relocate the receiving antenna.
- Increase the separation between the equipment and receiver.
- Connect the equipment into an outlet on a circuit different from that to which the receiver is connected.
- Consult the dealer or an experienced radio/TV technician for help.

Warning: Changes or modifications not expressly approved by the party responsible for compliance could void the user's authority to operate this equipment.

Clean exterior surfaces of the dispenser using warm water and mild soap. DO NOT USE ABRASIVE CLEANSERS. Dry with a soft cloth.

Description of the unit: Tork Counter Mount Foam Soap Dispenser

Model name: ESSITY CM

Rated voltage: 6V

Rated frequency or nature of supply: D.C.

Rated input or current: 0.5A

Customers Support

For North America:

article number: 571708

FCC ID: 2ABK3-571708

IC: 10866A-571708

www.torkusa.com

www.essity.com, wyrwaorkglobal.com

Made in Philippines



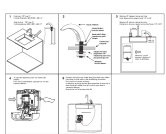

Documents / Resources



[essity 2ABK3-571708 Tork Counter Mount Foam Soap Dispenser](#) [pdf] Instruction Manual
2ABK3-571708 Tork Counter Mount Foam Soap Dispenser, 2ABK3-571708, Tork Counter Mount Foam Soap Dispenser, Counter Mount Foam Soap Dispenser, Mount Foam Soap Dispenser, Foam Soap Dispenser, Soap Dispenser, Dispenser

References

-  [Essity - A global leading hygiene and health company | Global Corporate](#)
-  [Tork – Global No 1 professional hygiene brand | Tork US](#)
- [User Manual](#)