



espiro simple 3 In 1 Side Bed User Manual

[Home](#) » [espiro](#) » espiro simple 3 In 1 Side Bed User Manual 

espiro **simple**

**3 In 1 Side Bed
User Manual**

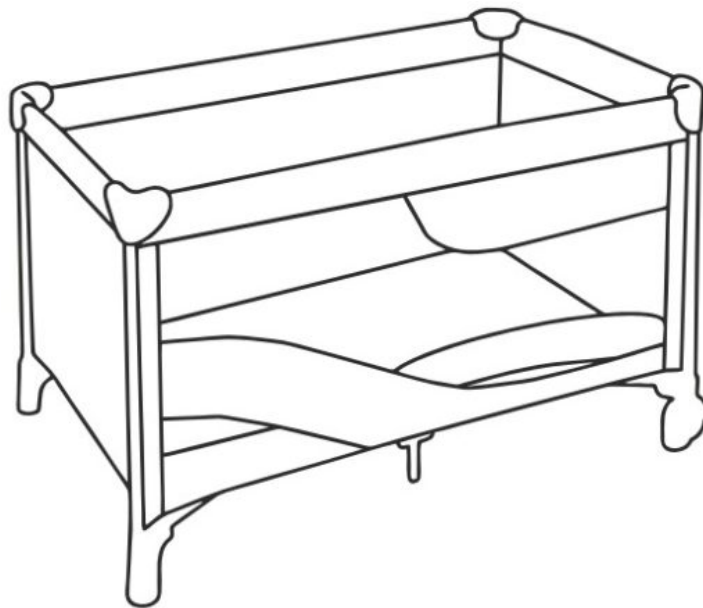

Contents

- 1 simple 3 In 1 Side Bed
- 2 UNFOLDING THE PLAY YARD
- 3 FITTING/REMOVING THE MATTRESS
- 4 FOLDING THE PLAY YARD
- 5 CLEANING AND MAINTENANCE
- 6 SAFETY PRECAUTIONS
- 7 Documents / Resources
 - 7.1 References

simple 3 In 1 Side Bed

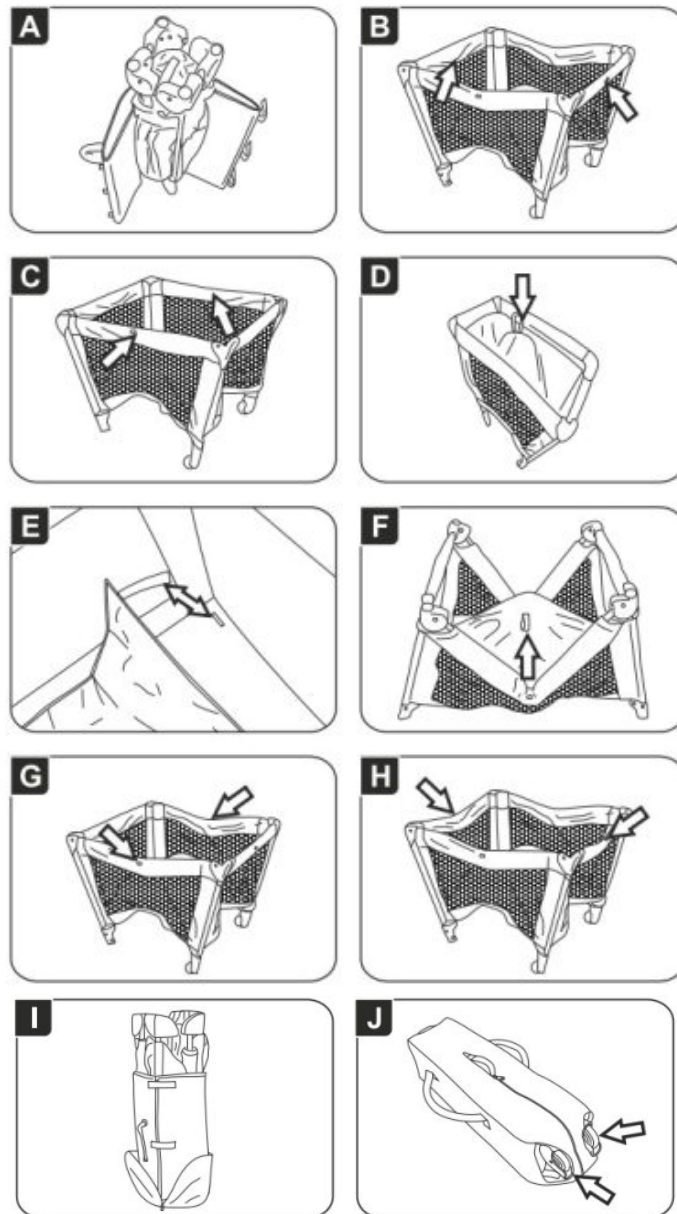

DEAR PARENTS!

Congratulations on your purchase of the versatile SIMPLE baby play yard manufactured by the BABY DESIGN company.

You can be sure that your child's play and sleep in this play yard will be comfortable and safe.

IMPORTANT, KEEP FOR FUTURE REFERENCE: READ CAREFULLY

The play yard is suitable for children weighing up to 15 kg.

UNFOLDING THE PLAY YARD

Take the play yard out of the bag and stand it on its legs.

Undo the three Velcro fasteners on the mattress and put the mattress aside.

Unfold the play yard sidewise. Pull the centre of the shorter side upwards until you hear the lock click. Repeat the same procedure on the other side.

IF THE BOTTOM IS PLACED TOO LOW, IT MAY BE DIFFICULT TO UNFOLD THE PLAY YARD.

Pull the centre of the longer side upwards until you hear the lock click.

Repeat the same procedure on the other side.

Press the centre of the play yard bottom until it is fully unfolded.

FITTING/REMOVING THE MATTRESS

FITTING THE MATTRESS:

Put the mattress on the play yard bottom so that the Velcro fasteners adhere to the bottom. Thread the Velcro strap through the hole in the corner of the play yard bottom and fasten it underneath. Repeat the same procedure on the other three corners.

REMOVING THE MATTRESS:

Undo the four Velcro fasteners on the corners of the mattress and take the mattress out of the play yard.

FOLDING THE PLAY YARD

Pull up the handle in the centre of the play yard bottom up to a height of 50 cm.

IF THE CENTRE OF THE PLAY YARD BOTTOM IS NOT RAISED HIGH ENOUGH, FOLDING THE PLAY YARD MAY BE MORE DIFFICULT.

Press the lock button under the longer side folding mechanism, pull the centre of the side slightly upwards and then fold it down. Repeat the same procedure on the other side.

Press the lock button under the shorter side folding mechanism, pull the centre of the side slightly upwards and then fold it down.

Repeat the same procedure on the other side.

Pull the sides together towards the centre of the play yard frame, wrap with the mattress, fasten with Velcro fasteners and put into the bag.

When putting the play yard into the bag, make sure that you put the end with the wheels first. The bag can be carried using the longer handles or pulled on wheels with the user holding the shorter handle.

CLEANING AND MAINTENANCE

The plastic play yard parts can be cleaned with a soft, wet cloth.

Do not use harsh cleaning agents.

The metal parts should be wiped with a dry cloth to remove dust and water.

The play yard upholstery and mattress can only be washed by hand at 30°C with mild washing agents, preferably with a washing liquid. Do not spin or tumble dry.



From time to time check if all the play yard components are in good working order and safe. Never use the play yard if any of its components is missing, mechanically damaged, torn or broken.

PLEASE NOTE:

- Prolonged exposure to direct sunlight may cause the fabrics to fade. No claims related to fabric fading shall be admitted.
- Do not leave the play yard near any sources of heat (heaters, blowers etc.) It may cause damage to the plastic parts.
- To ensure high quality standards, BABY DESIGN reserves the right to introduce changes to the play yard design without any obligation to notify customers thereof.
- Any repairs of damage caused by negligence will be made against payment.
- BABY DESIGN GROUP SP. Z O.O. SP. K. shall not be liable for any damage to property or bodily injury caused by assembly or use of the product, including its protective and safety components, incompliant with the manufacturer's instructions contained in this manual.

SAFETY PRECAUTIONS

- Never leave your child on the changing mat unattended!
- The play yard is designed for children weighing up to 15 kg.
- The product is suitable for one child only.
- Prior to each use make sure that the play yard is properly unfolded and all the locks are engaged.

- Always lock the wheels.
- When the child can sit up unaided, the lower floor level is the safest.
- The upper level supports must not be used on the lower level.
- Never leave in the play yard any objects which can cause the child to suffocate or choke.
- Your play yard is not a toy! Do not let your child climb on the play yard. If the play yard tips over on the child it may cause serious injuries.
- Check regularly if all the play yard components are in good working order and safe.
- Never use the play yard if any of its components is missing, mechanically damaged, torn or broken.
- Mind your fingers when folding and unfolding the play yard.
- Never put the play yard on an elevation.
- Before putting the child into the play yard, make sure that the floor has been unfolded completely.
- Any bigger objects placed in the play yard may serve as a step causing the child to fall out of the play yard.
- Never put the play yard near electric sockets, hanging cables, tables covered with tablecloths etc.
- Do not leave the play yard near any uncovered sources of heat (such as electric or gas heaters) or in other places where the child can reach any dangerous object.
- Before using the product each time, make sure that it is in perfect working order and that all its functions operate properly. If you find any defects, do not use the product and contact the Baby Design service team or the sales outlet.
- BABY DESIGN GROUP SP. Z O.O. SP. K. cannot be held liable for any damage to property or personal injury caused by assembly or use of the product incompliant with the manufacturer's instructions or recommendations included in the user manual.
- Always assemble all protective and safety components of the play yard according to the user manual.
- To ensure maximum safety, keep your child at a safe distance from movable elements of the play yard when you fold or unfold it.
- WARNING: Be aware of the risk of open fire and other sources of strong heat, such as electric bar fires, gas fires, etc. in the near vicinity of the cot.
- WARNING: Do not use the cot if any part is broken, torn or missing and use only spare parts approved by the manufacturer.
- WARNING: Do not leave anything in the cot or place the cot close to another product, which could provide a foothold or present a danger of suffocation or strangulation, e.g. strings, blind/curtain cords, etc.
- WARNING: Do not use more than one mattress in the cot.
- To prevent injury from falls that when the child is able to climb out of the cot, the cot shall no longer be used for that child.
- WARNING – Only use the mattress sold with this cot, do not add a second mattress on this one, suffocation hazard.



Baby Design Group Sp. z o.o. Sp. k
 Ul. Warszawska 8 42-262 Poczesna POLAND
 Tel. +48 (34) 360 46 64, +48 (34) 360 46 53
 Tel. serwis +48 (34) 364 36 41
 E-mail: biuro@babydesign.eu
 E-mail serwis: serwis@babydesign.eu
www.espiro.pl

Documents / Resources

| | |
|---|---|
|  | <p>espiro simple 3 In 1 Side Bed [pdf] User Manual simple 3 In 1 Side Bed, simple, 3 In 1 Side Bed, Side Bed, Bed</p> |
|---|---|

References

- [User Manual](#)

Manuals+. [Privacy Policy](#)

This website is an independent publication and is neither affiliated with nor endorsed by any of the trademark owners. The "Bluetooth®" word mark and logos are registered trademarks owned by Bluetooth SIG, Inc. The "Wi-Fi®" word mark and logos are registered trademarks owned by the Wi-Fi Alliance. Any use of these marks on this website does not imply any affiliation with or endorsement.