

**espiro**  
**Flow Lightweight  
Stroller**



## espiro Flow Lightweight Stroller User Manual

[Home](#) » [espiro](#) » espiro Flow Lightweight Stroller User Manual 

### Contents

- [1 espiro Flow Lightweight Stroller](#)
- [2 Product Information](#)
- [3 Product Usage Instructions](#)
- [4 ELEMENTS OF THE STROLLER](#)
- [5 UNFOLDING THE STROLLER](#)
- [6 ASSEMBLY AND USING INSTRUCTION](#)
- [7 CLEANING AND OPERATING](#)
- [8 WARNING INSTRUCTION](#)
- [9 Documents / Resources](#)
  - [9.1 References](#)
- [10 Related Posts](#)

**espiro**

**espiro Flow Lightweight Stroller**



## Product Information

### Specifications:

- **Brand:** FLOW
- **Manufacturer:** BDG PRODUKCJA SP.Z.O.O
- **Features:** Folding mechanism, Front and rear wheel assembly, Adjustable footrest and backrest, Canopy with zipper, Parking brake, Ventilation system

## Product Usage Instructions

### Unfolding the Stroller:

1. Press the locking mechanism blockade (1), then press the locking mechanism (2) located on the stroller handle.
2. Unfold the stroller pulling the handle up until locks on both sides of the stroller are locked in place. NOTE! Make sure that the stroller is properly unfolded.

### Assembly of Front and Rear Wheels:

1. Insert the front set of the wheel onto the hub until it is locked in place. Make sure the wheel is properly secured. Repeat on the other side.
2. Insert the rear set of the wheel onto the hub until it is locked in place. Make sure the wheel is properly secured. Repeat on the other side.

### Disassembly of the Wheels:

1. Press the button of the locking mechanism (1) and simultaneously take the front wheel off the hub (2).
2. Press the button of the locking mechanism (1) and simultaneously take the rear wheel off the hub (2).

## FAQ

- **Q: How do I adjust the backrest of the stroller?**

A: To lift the backrest, move it to the required position. To lower the backrest, lift the handle of the locking mechanism, and move the backrest to the desired position.

- **Q: How do I fold the stroller?**

A: The stroller is equipped with an automatic folding mechanism. Press the locking mechanism blockade (1) and press the folding mechanism (2). Push the handle forward at the same time (3). The stroller will fold automatically.

Silica gel packets inside. Do not swallow. Discard after unwrapping the product.



### ATTENTION!

Correctly mounted shoulder straps (1) should be located slightly above the child's shoulders, and the hip straps (2) should tightly hold the child's pelvis. Straps cannot be twisted.

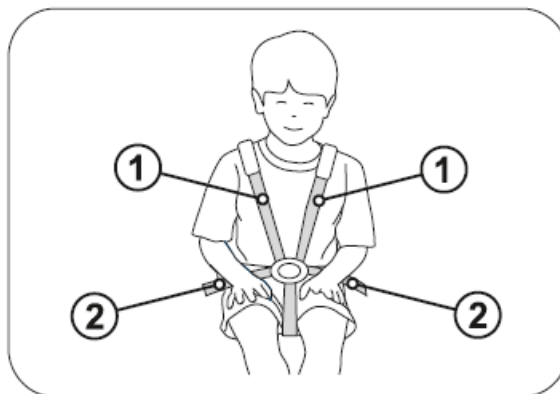

### DEAR PARENTS

Congratulations on your purchase of a FLOW stroller manufactured by the company BDG PRODUKCJA SP. Z O.O. The journey in this stroller will be safe, comfortable, and enjoyable.

### Important – Read carefully and keep it for future reference

Your child's safety may be threatened if you do not follow these instructions!

## ELEMENTS OF THE STROLLER

1. Stroller frame with upholstery
2. Canopy
3. Bumper bar

- 4. Basket
- 5. Rear wheel – 2 pcs
- 6. Front-wheel – 2 pcs
- 7. Footmuff



## UNFOLDING THE STROLLER

- 2. Press the locking mechanism blockade (1), then press the locking mechanism (2) located on the stroller handle.
- 3. Unfold the stroller pulling the handle up until locks on both sides of the stroller are locked in place.

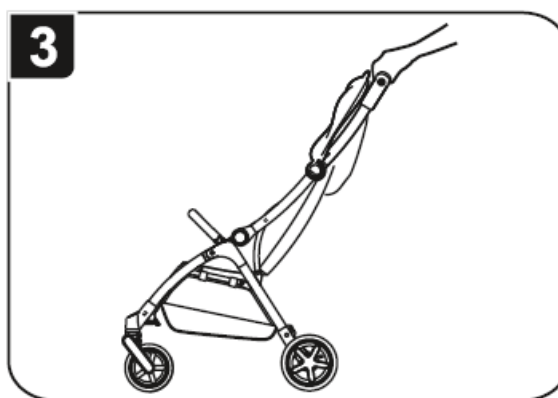
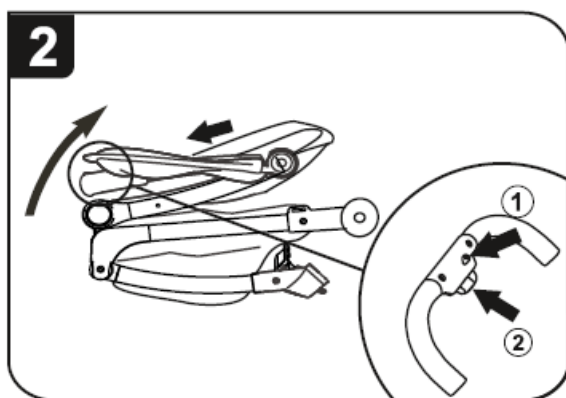

### NOTE!

Make sure that the stroller is properly unfolded.

## ASSEMBLY AND USING INSTRUCTION

## ASSEMBLY OF FRONT AND REAR WHEELS

- 4. Insert the front set of the wheel onto the hub until it is locked in place. Make sure the wheel is properly secured. Repeat on the other side.
- 5. Insert the rear set of the wheel onto the hub until it is locked in place. Make sure the wheel is properly secured. Repeat on the other side.

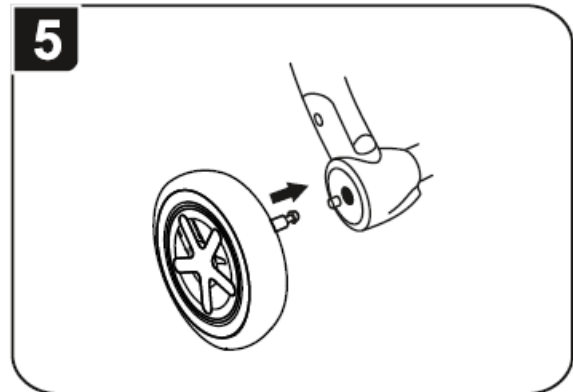
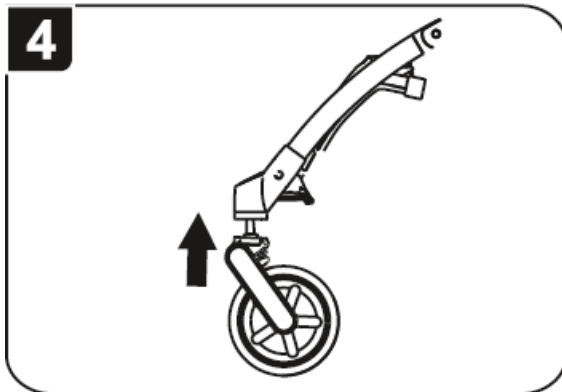

## DISASSEMBLY OF THE WHEELS

- 6. Press the button of the locking mechanism (1) and simultaneously take the front wheel off the hub (2).
- 7. Press the button of the locking mechanism (1) and simultaneously take the rear wheel off the hub (2).

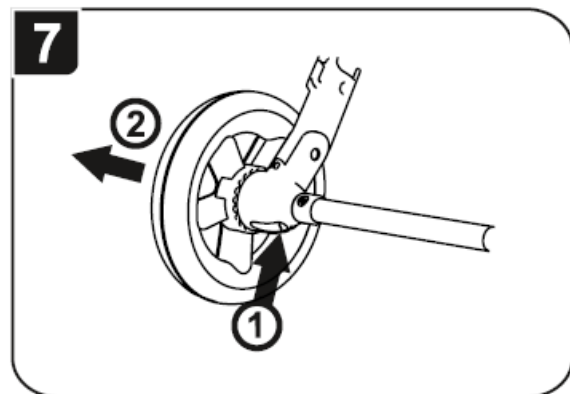
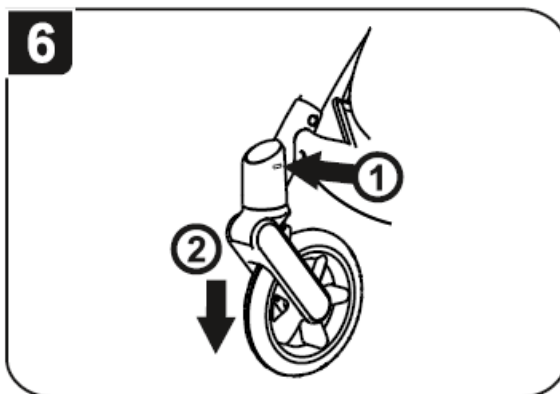

## BUMPER BAR

- 8. To assemble the bumper bar, insert it into plastic openings on both sides of the stroller frame until you hear the sound of the locking mechanism. Repeat on the other side. Make sure the bumper bar is properly secured against sliding out.
- 9. To detach the bumper bar, press the button of the locking mechanism (1) and detach it from the openings in the stroller frame (2)

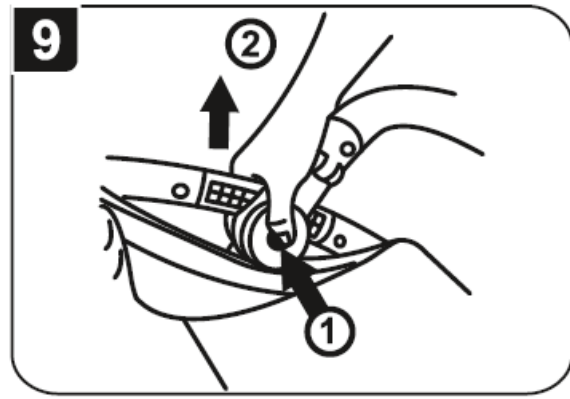
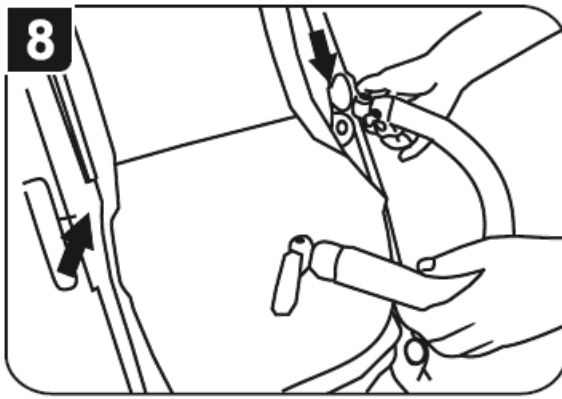

## FOOTREST ADJUSTMENT

- **10.** To lift the footrest, lift its end part.
- **11.** To lower the footrest, press the handle of the locking mechanism (1) and lower the footrest.

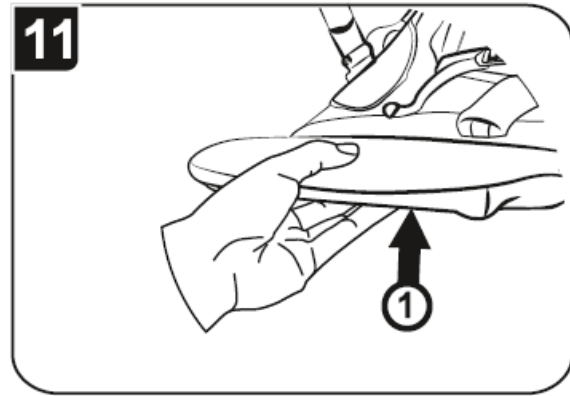
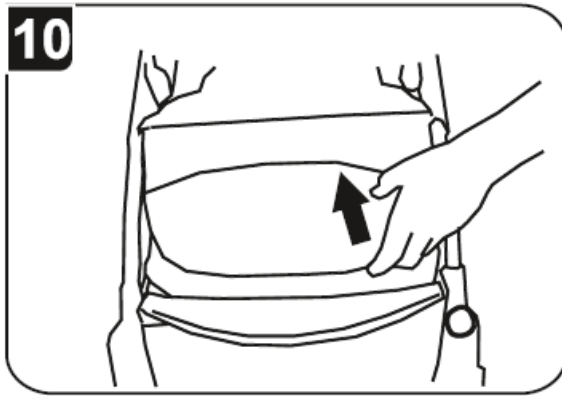

## BACKREST ADJUSTMENT

- **12.** To lift the backrest, move it to the required position.
- **13.** To lower the backrest, lift the handle of the locking mechanism and move the backrest to the desired position.

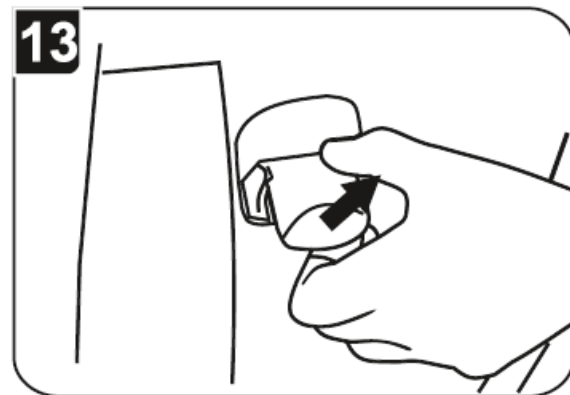

## CANOPY MANUAL

It is possible to adjust the position of the canopy by locking it in a place with a zipper.

- **14.** To enlarge the canopy, unzip the zipper.
- **15.** To change the position of the canopy, hold its top part and adjust it to the required position.

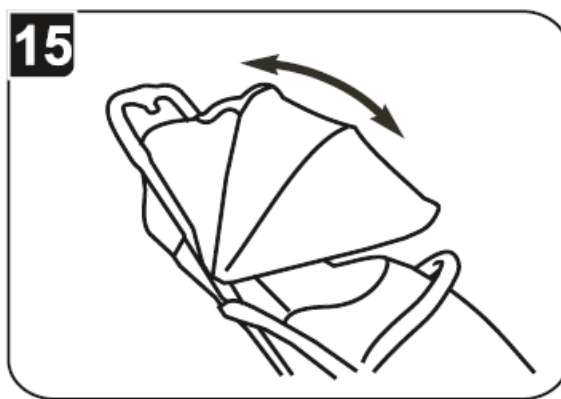
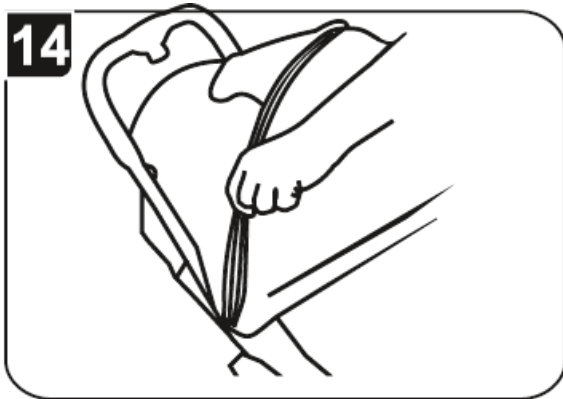

### PARKING DEVICE (brake)

- 16. Press the brake pedal with the foot to lock the rear wheels.
- 17. Press the brake pedal with the foot to unlock the rear wheels.

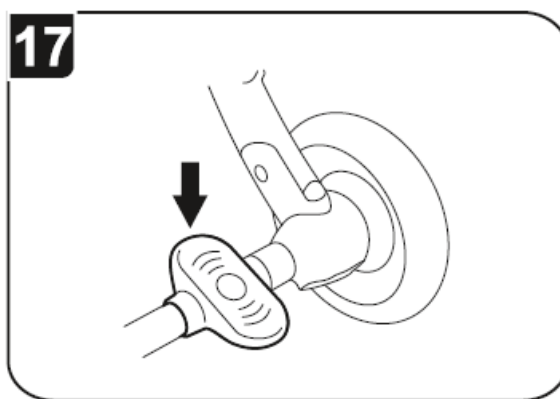
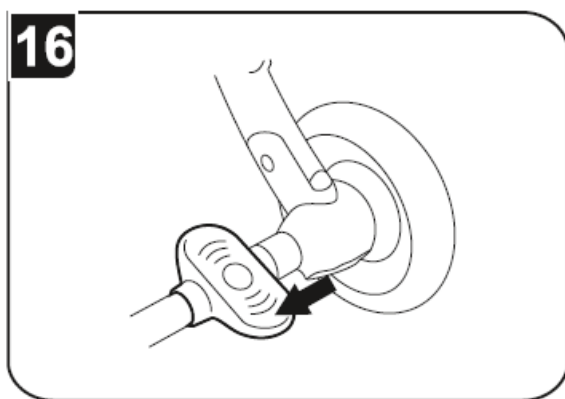

### VENTILATION

- 18. Remove the zippers from the ventilation (1). Roll the fabric and attach it to the upper edge of the canopy (2)

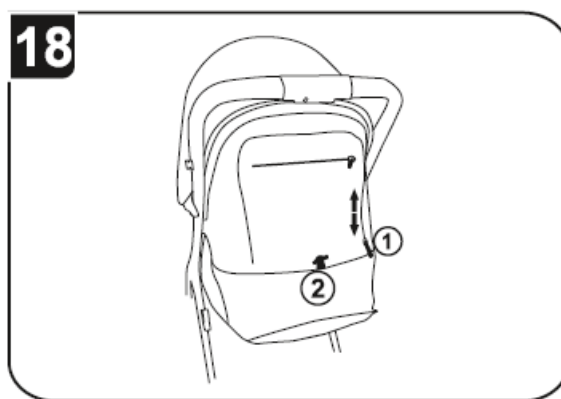

### FOLDING THE STROLLER

#### NOTE:

The stroller is equipped with an automatic folding mechanism.

- 19. Press the locking mechanism blockade (1) and press the folding mechanism (2). Push the handle forward at the same time (3).
- 20. The stroller will fall automatically.

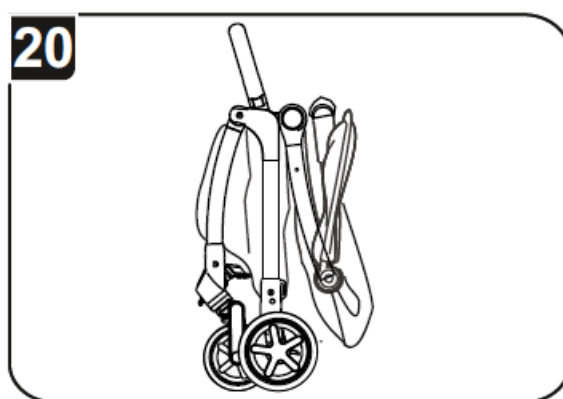
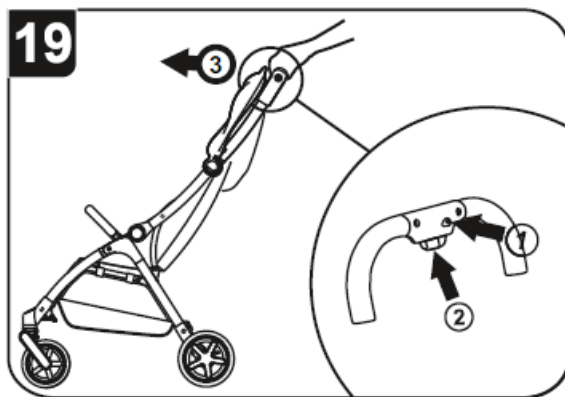

## SHOULDER STRAP LENGTH ADJUSTMENT

- **21.** Pull out the free end of the strap to remove any loose parts.
- **22.** Pull the fastener (1) to loosen the tension of the shoulder straps. Adjust the length of the hips and crotch straps using the fasteners (2)

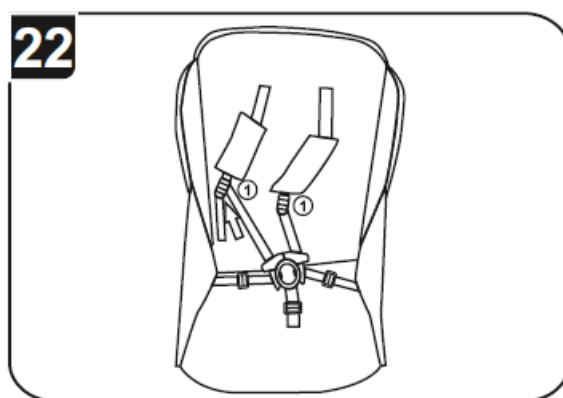
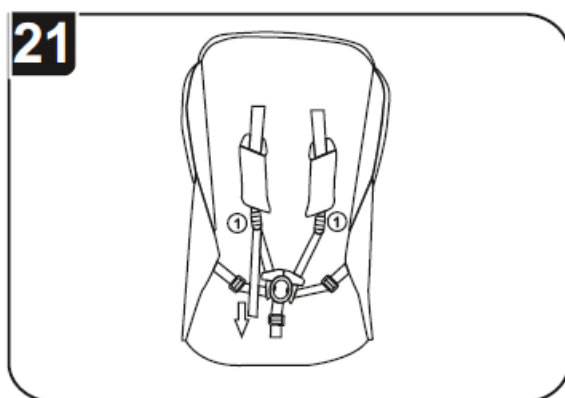

## BUCKLE MANUAL

**23.** The stroller is equipped with a magnetic buckle. To unbuckle the buckle, press both buttons of the buckle located on both sides at the same time and remove one part from the other one.

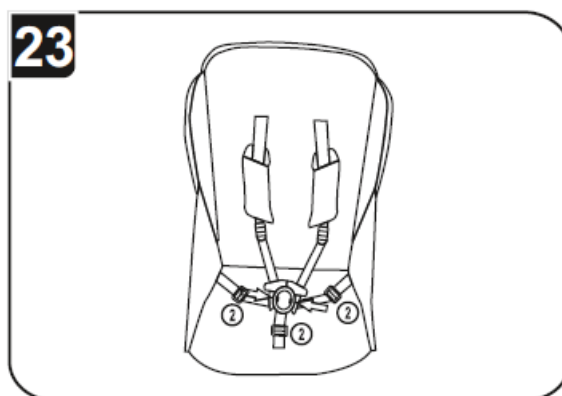

## HOW TO LOCK THE BUCKLE

- **24.** Insert the strap fastening mechanism in the back part of the buckle. Repeat on the other side.
- **25.** Attach two parts of the buckle with one other.
- **26.** Attach the front part of the buckle with the back part until you hear the clicking sound.



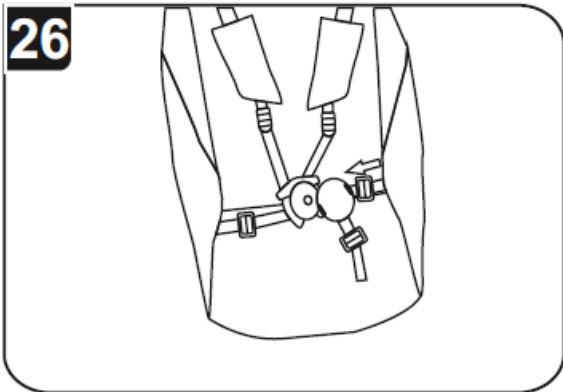
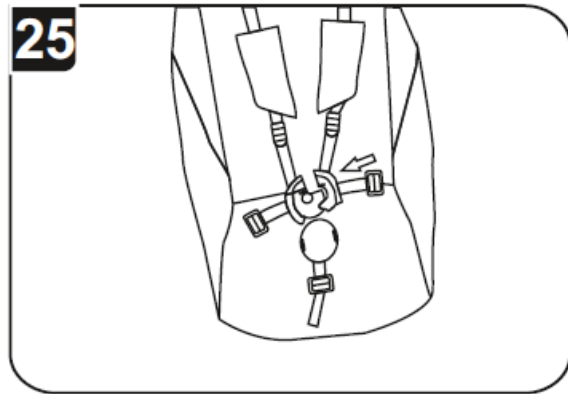
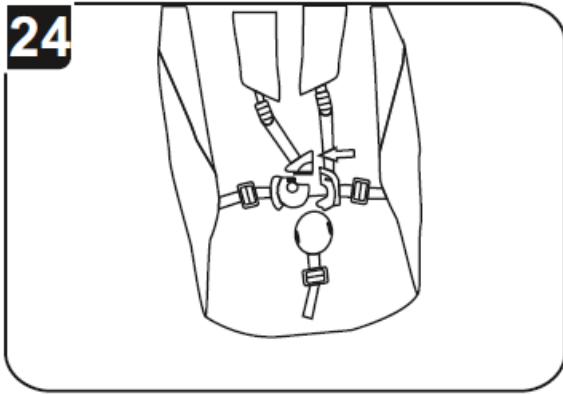

Check if the buckle is properly locked in place.

#### ASSEMBLY/ADJUSTMENT OF THE SAFETY BELTS HEIGHT

- **27.** To assemble/adjust the height of the seat belts, take them out of the openings in the backrest/seat unit and the upholstery and insert them through openings in the upholstery and the seat unit/backrest at the desired height.

**NOTE!** Before locking the child with the seat belts, make sure that the seat belts are properly assembled.



- **28.** In case of use of additional harnesses, mount them to the harness attachment points, located on both sides of the seat rest.

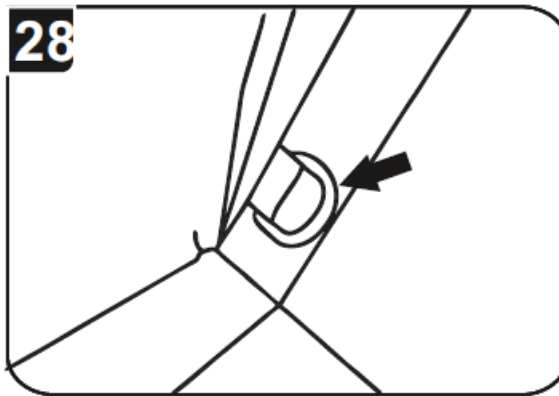

## COVER

- **29.** Insert the cover on the footrest and attach it with press studs on both sides of the seat unit.

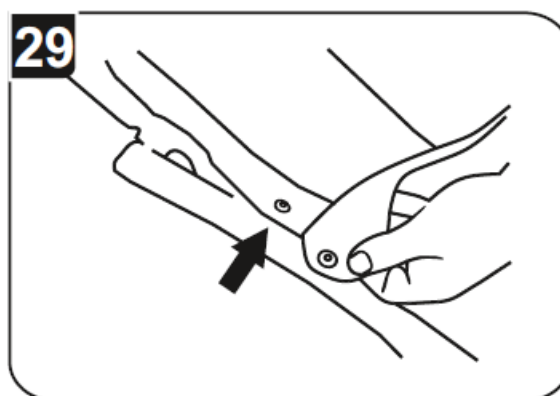

To disassemble the cover, proceed in reverse order.

## CLEANING AND OPERATING

- Plastic parts of the stroller and stripes may be cleaned with a soft, damp cloth. Do not use aggressive cleaning agents.
- Clean metal parts with dry cloth removing dust and water. If the stroller gets muddy or after its use during winter, maintain it with the use of lubricating products.
- Upholstery cleaning manual: – Clean using a cloth with a mild cleaning agent, do not wet it, do not whirl, and dry unfolded.
- Check periodically if screws did not get loose and replace damaged parts.
- Lubricate riding elements, i.e. wheels hubs, and axes using common products, eg. silicone grease. It should be done especially after using the stroller on sandy ground or during winter. Aggressive agents may cause corrosion.
- Remember to maintain all metal elements.

## WARNING INSTRUCTION

### IMPORTANT

READ CAREFULLY AND KEEP FOR FUTURE REFERENCE

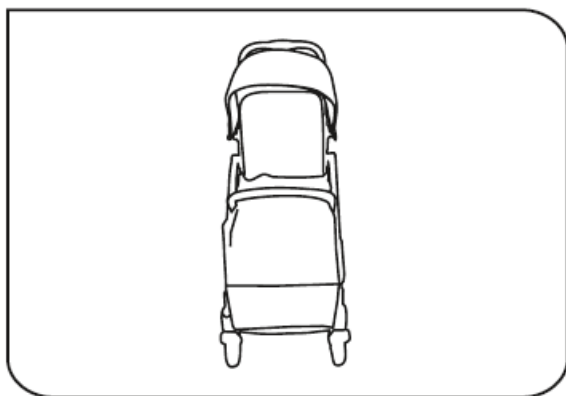

- **WARNING** Never leave the child unattended
- **WARNING** Ensure that all the locking devices are engaged before use
- **WARNING** To avoid injury ensure that your child is kept away when unfolding and folding this product.
- **WARNING** Do not let the child play with this product
- **WARNING** Always use the restraint system

- **WARNING** Check that the pram body seat unit or car seat attachment devices are correctly engaged before use
- **WARNING** This product is not suitable for running or skating
- Maximum weight and age of the child for which the vehicle is suitable:  
22 kg or 4 years whichever comes first.
- For newborn babies, it is recommended to use the most reclined position of the backrest.
- The parking device (brake) should be activated when putting the child in or taking the child out of the stroller
- When parking the stroller, always activate the brake (parking device)
- The maximum load of the basket is 3 kg.
- The maximum load of the pocket of the canopy/carrycot is 0.3 kg.
- Any load on the handle and/or posterior part of the backrest and/or sides of the stroller will influence the stability of the stroller
- Do not hang bags that are not appropriate for hanging or bags different than recommended by the manufacturer on the stroller's guides -it is dangerous and may lead to damage to the stroller.
- This stroller is intended for use by one child.
- Do not use accessories that are not approved by the manufacturer. Use only spare parts which are approved or recommended by the manufacturer.
- Do not use additional ich that are not approved by the manufacturer. Use only spare parts which are approved or recommended by the manufacturer.
- Do not use additional platforms attached to the stroller.
- In the event any defects are detected, do not use the product and contact the service of BDG PRODUKCJA of the seller.
- Never go down or up the stairs with the stroller (also on slides), especially with a child inside – it may lead to serious injury to the child and damage to the stroller.
- Rocking the stroller may deteriorate its structure and lead to damage.
- Never lift or move the product with the child inside it.
- Make sure folding elements are locked before using the stroller (that is is properly unfolded and locked in place).
- Always assemble all protective and securing elements of the stroller in compliance with instructions.
- Always attach the crotch belt to the bumper bar.
- Check periodically if all elements of the stroller are operational and safe, in particular, check if the seat unit, carrycot, and car seat are properly assembled to the chassis.
- When folding and unfolding the stroller, as well as when adjusting the backrest, handle, or other elements of the stroller, keep your and your child's body parts safe.
- The stroller is intended for moving forward. BDG PRODUKCJA is not liable for any damage to property or injuries arising from the assembly and use of the product which is not compliant with instructions and recommendations of the manufacturer covered by this user manual.
- Use only elements supplied or recommended by the manufacturer/distributor.
- Upholstery cleaning manual: – Clean using a cloth with a mild cleaning agent, do not wet it, do not whirl, and dry unfolded.
- Be aware of the risk of open fire and other sources of strong heat in the vicinity of the product.
- Washers, which are a part of the set, are intended to balance any loose between the axis of the front wheel set and the hub. Keep washers away from children – the risk of swallowing.

## RAIN COVER

### NOTE:

The product is not a toy – do not allow the child to play with it. Keep away from fire.

- Keep away from children. There is a risk of suffocation if the product is applied to the nose or mouth.
- Use the product only under the supervision of an adult.
- When the cover is not in use, keep it out of the child's reach.
- Use the cover only for protection against rain or snow. Do not use the cover on hot or sunny days.
- After mounting it on, check whether the cover does not cause discomfort to the child.
- When using the cover, gradually open the zipper or ventilation window to supply fresh air inside the stroller/carrycot.

### BDG PRODUKCJA Sp.Z.O.O.

- **Ul.** Warszawska 8 42 – 262 Poczesna POLAND
- **Tel.** +48 (34) 360 46 64, +48 (34) 360 46 53
- **Tel. serwis** +48 (34) 364 36 41
- **E-mail:** [biuro@babydesign.eu](mailto:biuro@babydesign.eu).
- **E-mail serwis:** [serwis@babydesign.eu](mailto:serwis@babydesign.eu).

[www.espiro.pl](http://www.espiro.pl).

## Documents / Resources

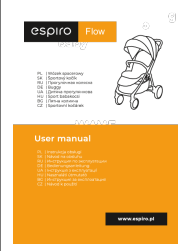
	<p><a href="#">espiro Flow Lightweight Stroller</a> [pdf] User Manual Flow, Flow Lightweight Stroller, Lightweight Stroller, Stroller</p>
---	---

## References

- [User Manual](#)

### [Manuals+](#), [Privacy Policy](#)

This website is an independent publication and is neither affiliated with nor endorsed by any of the trademark owners. The "Bluetooth®" word mark and logos are registered trademarks owned by Bluetooth SIG, Inc. The "Wi-Fi®" word mark and logos are registered trademarks owned by the Wi-Fi Alliance. Any use of these marks on this website does not imply any affiliation with or endorsement.