



# ESP ECSPST Fort Programmable Thermostat with RF and WiFi User Guide

[Home](#) » [ESP](#) » ESP ECSPST Fort Programmable Thermostat with RF and WiFi User Guide 

## Contents

- [1 ESP ECSPST Fort Programmable Thermostat with RF and WiFi](#)
- [2 Product Information](#)
- [3 Features](#)
- [4 Product Overview](#)
- [5 Thermostat Functions](#)
- [6 Operating Modes](#)
- [7 Thermostat Configuration](#)
- [8 Thermostat Installation](#)
- [9 Documents / Resources](#)
  - [9.1 References](#)
- [10 Related Posts](#)



**ESP ECSPST Fort Programmable Thermostat with RF and WiFi**



## Product Information

### Specifications:

- Product Name: ECSPST Fort Programmable Thermostat with RF and WiFi
- Wireless Icon: Always on when paired with the receiver, flashes when the connection is intermittent
- Frost Protection Icon
- Call for Heat Icon
- Programming Mode Icon
- Low Battery Alert
- Confirm Icon
- Up Button
- ON/OFF Button
- Room Temperature or Setting Temperature Display
- Down Button
- WiFi Status Indicator
- Output Indicator Call for Heat: Green
- ON/OFF Indicator Power Indicator: Red Override output status: Green RF indicator: Yellow
- Control Button (With Power Indicator)
- Default Programming Schedule: This can be configured within the ClickSmart+ app

### Product Overview:

The ECSPST Fort Programmable Thermostat with RF and WiFi is a versatile thermostat that offers wireless connectivity and various functions for convenient temperature control.

### Thermostat Functions:

- **Switching between ON & Standby modes:**

To turn the thermostat ON, press the ON/OFF button. Press and hold the ON/OFF button again to switch the thermostat into standby mode. In standby mode, the thermostat will display a standby icon.

Note that only frost protection is active in standby mode.

**Key Lock Function:**

In the main display interface, press and hold two specific keys simultaneously to lock or unlock the keys. When locked, the thermostat will display a lock icon.

- **Frost Protection:**

The thermostat has frost protection to prevent freezing. It will activate automatically when necessary.

- **Open Window/Door Detection Function:**

The thermostat has a function to detect when a window or door is open. It will adjust the temperature accordingly to avoid energy waste.

- **Low Power Alert:**

When the thermostat's battery is critically low, it will display a low battery alert icon. The batteries need to be changed in this situation.

- **Optimal Start:**

If enabled, the thermostat will start calling for heat slightly before the scheduled time, ensuring that the ambient temperature reaches the desired level by the scheduled start time. This feature can be enabled in the configuration menu.

- **Fault:**

If there is damage to the internal sensor, the thermostat will display a fault message to alert the user.

## **Operating Modes:**

- **Schedule Mode:**

In this mode, the thermostat will run according to the set schedule. The screen will display a solid schedule icon.

- **Boost Mode:**

The boost mode sends a call for heat until the next program in the schedule and continues to send the call for heat until the set temperature is achieved. To activate boost mode while in schedule mode, press the up or down button to set the desired temperature. The thermostat's display will flash to indicate that boost mode is activated. When boost mode is active, it will display a flashing boost icon.

- **Manual Mode:**

The manual mode allows you to set the thermostat to a desired temperature. It will continue to maintain this temperature until you end the manual mode. Pressing the up button will toggle between schedule mode and manual mode. The thermostat will indicate that it is in manual mode by not displaying the schedule icon.

- **Thermostat Configuration:**

The thermostat can be configured through the menu options available on the device. Refer to the user manual for detailed instructions on how to access and navigate the configuration menu.

- **Thermostat Installation:**

Refer to the installation instructions provided in the user manual for detailed steps on how to install the thermostat. There are two installation plans, Plan A and Plan B, depending on your specific requirements. Ensure proper pairing of the thermostat and receiver for optimal functionality.

## **FAQ:**

- Q: How can I enable an optimal start on the thermostat?

A: Optimal start can be enabled in the configuration menu of the thermostat. Please refer to the user manual for detailed instructions.

- Q: What does the low battery alert icon indicate?

A: The low battery alert icon indicates that the thermostat batteries are critically low and need to be changed.

- Q: How do I switch between schedule mode and manual mode?

A: To switch between schedule mode and manual mode, press the up button on the thermostat.

## Features

- Large LED display
- Touch button
- Permanent user settings, and program settings during power loss
- One button “Holiday” mode
- Programming Periods;
  - 7 Day individual, 5/2 split (Monday – Friday, Saturday & Sunday)
  - 6 Separate time/temperature periods per day
- Key lock facility
- Low battery indication
- Frost protection
- Optional Intelligent function; Optimal Start
- Open window function
- Integrated with Clicksmart+ App

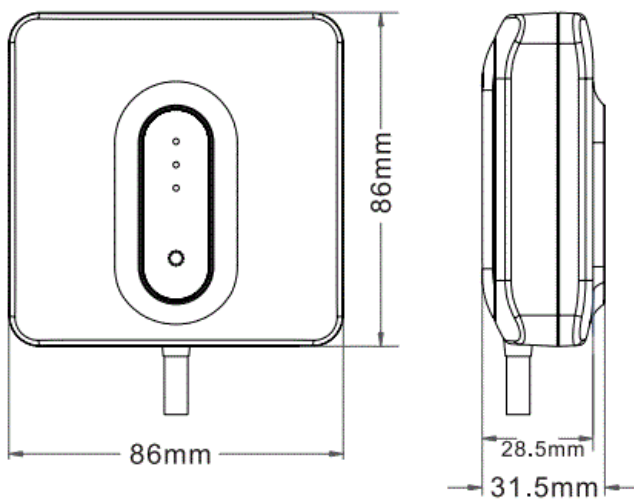

Receiver

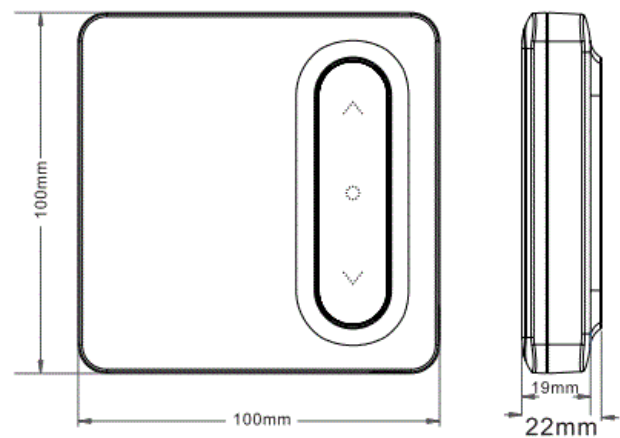

Thermostat

## Product Overview

### Thermostat

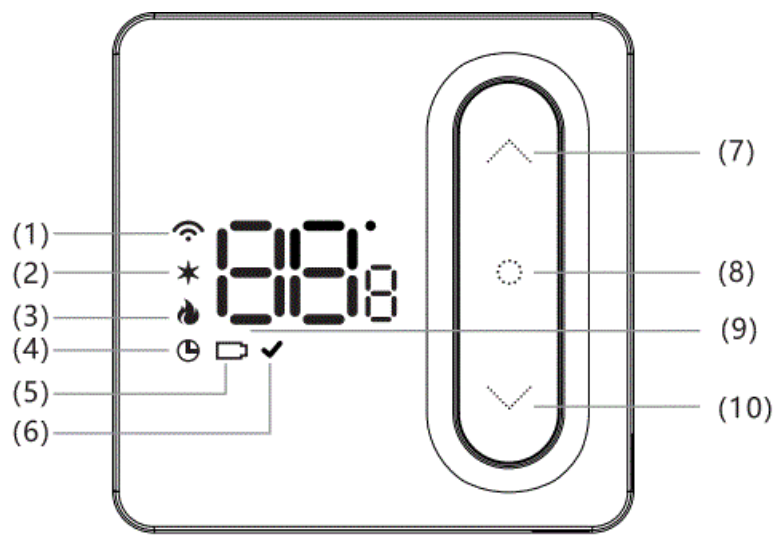

1. Wireless icon “ ” always on when paired with the receiver, flashes when the connection is intermittent
2. Frost protection icon
3. Call for heat icon
4. Programming mode icon
5. Low battery alert
6. Confirm icon
7. Up button
8. ON/OFF button
9. Room temperature or setting temperature display
10. Down button

## Receiver

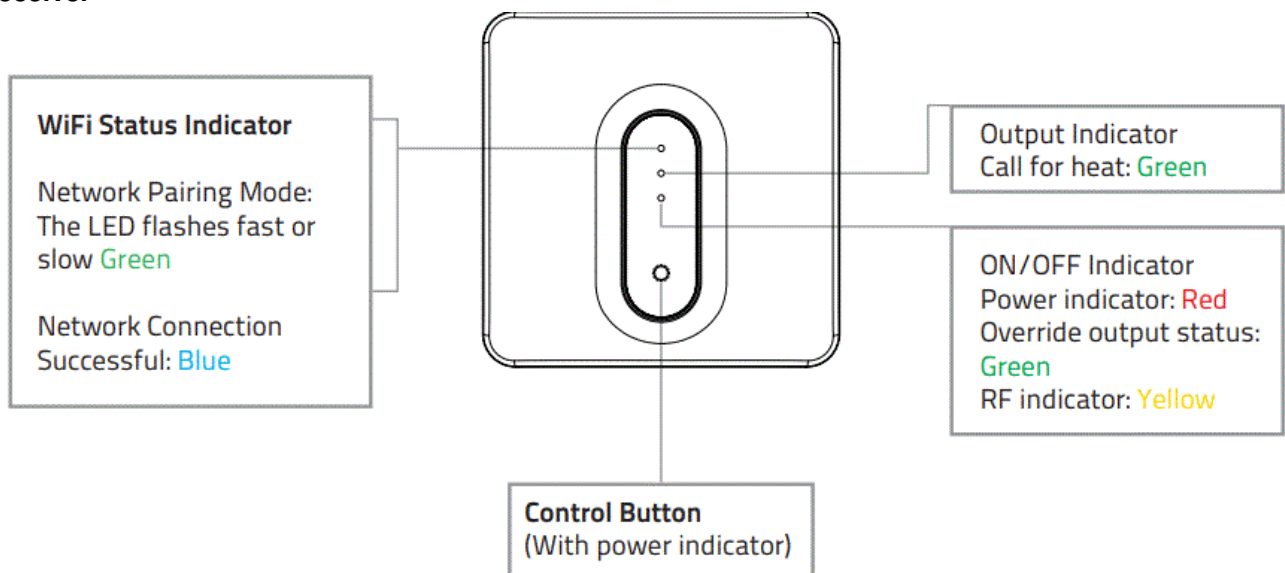

\* To manually call for heat, press and hold the control button, until the LED turns Green.

## Default Programming Schedule

**Note:** The programming schedule can be configured within the ClickSmart+ app

Period 1		Period 2		Period 3		Period 4		Period 5		Period 6	
Morning ON		Morning OFF		Afternoon ON		Afternoon OFF		Evening ON		Evening OFF	
06:00	20°C	08:00	16°C	11:00	20°C	14:00	16°C	18:00	20°C	22:00	16°C



## Thermostat Functions

### Functions

- Switching between ON & Standby modes
- Press " " to turn the Thermostat into the ON mode. Press and hold  again to switch the thermostat into standby mode. When in standby mode the Thermostat will display 'OFF'.

**Note:** When in standby mode, only frost protection is active on the thermostat.

### Key Lock Function

- In the main display interface, press and hold   at the same time to lock or unlock the keys. When locked, the thermostat will display " ".

### Frost Protection

- If the room temperature falls below 5°C, frost damage can occur. To protect your home, the Thermostat once it detects the ambient temperature is below 5°C will send a Call for heat, until the temperature is above 8°C, and will then end the Call for heat. This is indicated by a  icon.
- \*This feature can be disabled in the configuration menu

### Open Window/Door Detection Function

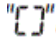
- If the room temperature drops 1.5°C in 3 minutes, this function will activate and display , then turn down all heating. When the room temperature increases by 1.5°C or after 30 minutes, the thermostat will return to normal operation. Press any button to cancel this function when it is active.

### Low Power Alert

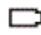
- When the thermostat is critically low on power, it will alert the user by displaying  to notify them to change the batteries.

### Optimal Start

- If optimal start is enabled, the thermostat will start the call for heat slightly before the schedule calls for it. So that by the scheduled start time, the ambient temperature is already at the set temperature.
- \*This feature can be enabled in the configuration menu

## Fault





- If there is damage to the internal sensor the user will be alerted by the display message "Er".

## Operating Modes



### Schedule Mode

- The thermostat will run according to the set schedule, the screen will display a solid  icon.

### Boost Mode









- The boost mode, will send a call for heat until the next program in the schedule and will continue to send the call for heat until the set temperature is achieved.
- When in schedule mode (indicated by a solid  icon), press the  or  and set the desired temperature, the thermostat display will flash to indicate it is activating the boost mode.
- When a boost is currently active it will display the  icon flashing.

### Manual Mode

- The "Manual" mode sets the thermostat to the desired temperature and will continue to do so until, the user ends the Manual mode.
- Pressing  will toggle between Schedule mode & Manual Mode. The Thermostat will indicate it is in Manual mode by not displaying the  icon.

## Thermostat Configuration

To configure the thermostat using its controls you will need to do the following:

1. In standby mode indicated by the Thermostat displaying 'OFF', long press  to enter the configuration menu.
2. The first item will display "LC", press  to enter the configuration for the first item.
3. You can adjust the setting by pressing  or .
4.  will flash, and then press  will save current settings, and exit to the configuration menu.
5. Use the  or  to select the configuration menu, and then press  to enter the next configuration, and follow the steps 3 & 4.
6. Finally once all menus have been configured, long press " " to save and exit the configuration menu.

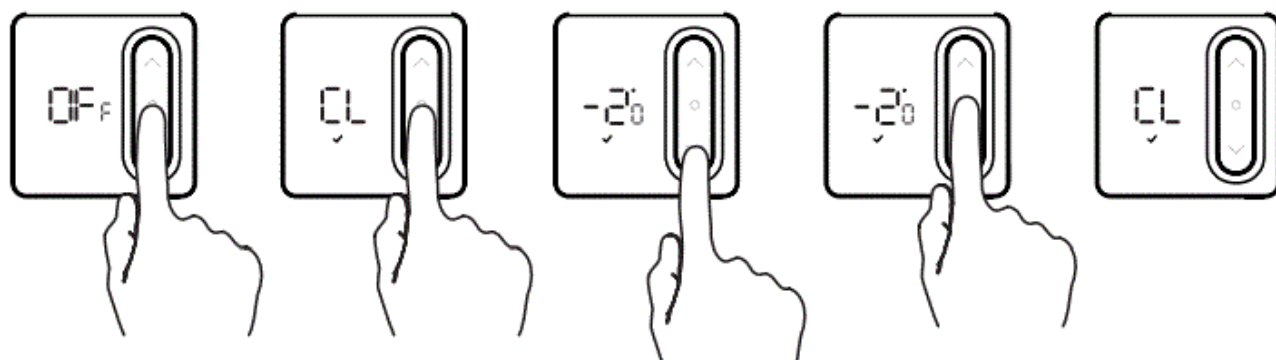

### Restore factory settings:

After entering the configuration menu, press and hold both the  $\nabla$  and  $\wedge$  buttons, to restore the thermostat to factory settings, the thermostat will display 'OFF' and flash 3 times.

This will remove any custom configuration setting(s) and programming setting(s)

Step No.	Displayed (Factory Default)	Press " $\nabla$ " or " $\wedge$ " to select	Descriptions
1	CL (00)	-4°C to +4°C	Temperature calibration
2	RH (30)	+20°C to +35°C	Select maximum setting temperature range
3	RL (05)	+5°C to +20°C	Select minimum setting temperature range
4	db (0%)	0.5°C to 3°C	Start heating conditions: When setting temperature - Room temperature $\geq$ 0.5°C (0.5~3°C option), start heating. Room temperature $\geq$ Setting temperature, stop heating.
5	SE <sub>9</sub> (6)	4 / 6	Number of programming periods per day; 2 ON & 2 OFFs / 3 ON & 3 OFFs
6	ES (OFF)	ON / OFF	Intelligent function (Optimal start)
7	PP (OFF)	ON / OFF	Frost Protection function
8	RY (OFF)	ON / OFF	Thermostat Relay Output
9	SH (ON)	ON / OFF	Thermostat LED Display option ON: LEDs displays on Thermostat VIA app. OFF: LEDs don't display on Thermostat VIA app. OFF: LED lights

## Thermostat Installation

### Battery Installation

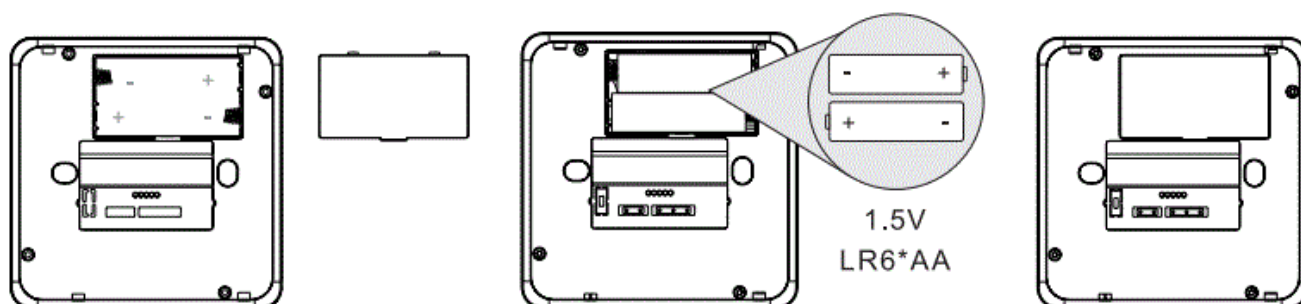



1. Take off cover
2. Install AA Batteries
3. Complete Installation

**Note:** Ensure the batteries are correctly installed, and the polarities are correctly aligned.

#### Desk mounted

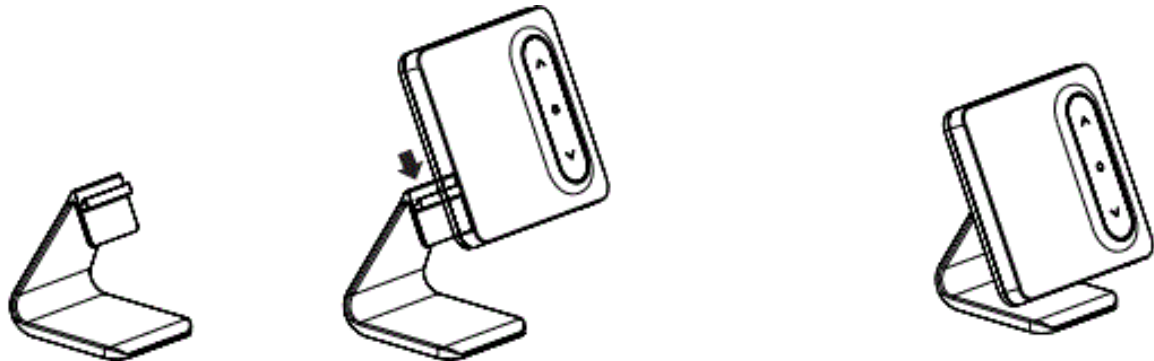

1. Hang the Thermostat on the stand
2. Complete

#### Wall mounted

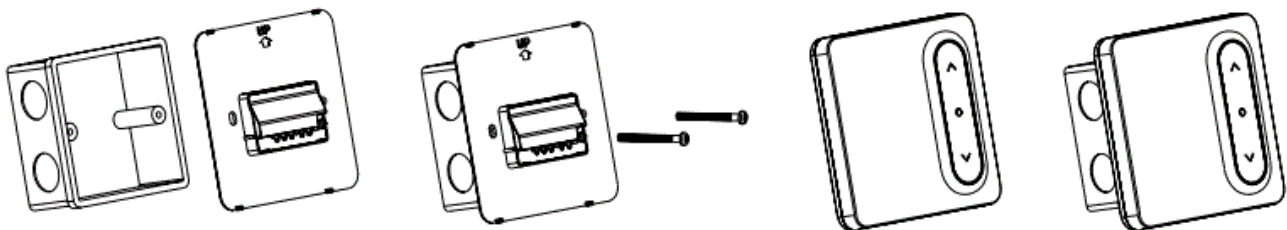

1. Put the backboard on the installation box
2. Secure backplate to installation box using bolts
3. Secure thermostat to backplate
4. . Complete



#### Elite Security Products

Unit 7, Target Park, Shawbank Rd Lakeside, Redditch B98 8YN

[www.espuk.com](http://www.espuk.com)

E&OE – Errors and Omissions Excepted. K23

Telephone: 01527 51 51 50 Fax: 01527 51 51 43 Email: [sales@espuk.com](mailto:sales@espuk.com)



[ESP ECSPST Fort Programmable Thermostat with RF and WiFi](#) [pdf] User Guide  
ECSPST Fort Programmable Thermostat with RF and WiFi, ECSPST, Fort Programmable Thermostat with RF and WiFi, Programmable Thermostat with RF and WiFi, Thermostat with RF and WiFi

## References

- [User Manual](#)

### Manuals+, Privacy Policy

This website is an independent publication and is neither affiliated with nor endorsed by any of the trademark owners. The "Bluetooth®" word mark and logos are registered trademarks owned by Bluetooth SIG, Inc. The "Wi-Fi®" word mark and logos are registered trademarks owned by the Wi-Fi Alliance. Any use of these marks on this website does not imply any affiliation with or endorsement.