

 Escrow-Tech
**ETLSP4000 WiFi
Smart Plug**



Escrow Tech ETLSP4000 WiFi Smart Plug User Manual

[Home](#) » [Escrow Tech](#) » Escrow Tech ETLSP4000 WiFi Smart Plug User Manual 

Contents

- [1 Escrow Tech ETLSP4000 WiFi Smart Plug](#)
- [2 Specifications](#)
- [3 Product Usage Instructions](#)
- [4 What's in the Box](#)
- [5 Parameters](#)
- [6 Install the Carbon-adjust APP](#)
- [7 Getting to Know the Carbon Adjust APP](#)
- [8 Safety Information](#)
- [9 Warranty](#)
- [10 FCC Statement](#)
- [11 FAQs](#)
- [12 Documents / Resources](#)
 - [12.1 References](#)
- [13 Related Posts](#)



Escrow-Tech

Escrow Tech ETLSP4000 WiFi Smart Plug



Specifications

- **Product Name:** Carbon-Adjust Smart Plug
- **Wireless Type:** WiFi 2.4GHz 802.11b/g/n
- **Compatibility:** Android, iOS

Product Usage Instructions

1. Setup

1. Plug in the Carbon-Adjust Smart Plug into a power outlet.
2. Download and install the corresponding app for Android or iOS on your smartphone.
3. Follow the app's instructions to connect the smart plug to your WiFi network.

2. Main Option Button

The main option button on the smart plug can be used for on/off functionality. Long press the button to restore the device to its default settings. Use this feature with caution.

3. Control

You can control the smart plug through the app on your smartphone. Turn devices connected to the smart plug on or off remotely.

4. Maintenance

Regularly check the smart plug for any signs of damage or wear. Ensure it is connected securely to the power outlet.

For Android



For IOS



What's in the Box

- Home Control Device xl
- User Manual x 1



on/off **The Main Option Button**

- Can be used as a restore button
- Long press to restore (make sure you really decide to).

Parameters

- **Wireless type:** WIFI 2.4GHz 802.11b/g/n
- **Humidity:** <80%
- **Material:** ABS+PC
- **Rated voltage:** AC 100-240V
- **Rated current:** 10A (Max)
- **Product Model:** ETLSP4000
- **Working Temp:** -20°C – +50°C

Install the Carbon-adjust APP

- You may find the Carbon-Adjust app on Apple App store, Google Play, or Scan the QR codes on page 01 and 02 and install it
- Enter the register log in interface, input email, name, phone number, accept terms and conditions, verify email, phone number and login



For Android



For IOS

- The Carbon-Adjust app is free and compatible with mobile devices that support iOS 8.0 above, Android 4.4 above.

Connecting your device with the Carbon-Adjust APP Easy Mode

1. Please make sure the device has connected with electricity at the beginning, then open the Carbon Adjust app, go to “DEVICES”, click “ADD DEVICES” and select “Corresponding device”.
2. long press on/of button of the device for 5 seconds until the indicator light quickly flashes, the interface page has already stepped into “Add Device “Page as the above,
3. **Make sure the indicator light is flashing rapidly and confirm it in app:**
 1. Choose local WIFI, enter correct password, and confirm
4. Tap “Connect Now”, choose WIFI hotspot named “Carbon-Adjust xxx”, then back to Carbon-Adjust app
5. Wait for configuring successfully, then tap “Done”

Getting to Know the Carbon Adjust APP

1. Devices

You can add listed devices by tapping “ADD DEVICES” on the Device tab

2. Switch

Switch allows you to turn on/off your device anywhere. As long as you have an internet connection, you can control the device in your home. Tap to the menu icon (:) at the top right corner of the device, this allows you to

modify the device name, link the device to a building already added, amongst other things.

3. **Timer**

You can set the device on or off after the specific time you want with this function.

4. **Countdown**

With the countdown timer feature, you can automatically switch on/off the running household appliance.

5. **Statistics**

You can check the real-time and historical power consumption here if your device is built with energy monitoring function.

If your device is built with an energy monitoring function.

DR/DSM

With this function, you can optimally schedule your compatible and eligible electrical appliance for use such that you achieve a lower carbon footprint score when compared to your initial preferred time for screenshots on how this works.

Cancel Schedule

Not interested anymore?, simply cancel a schedule not yet dispatched.

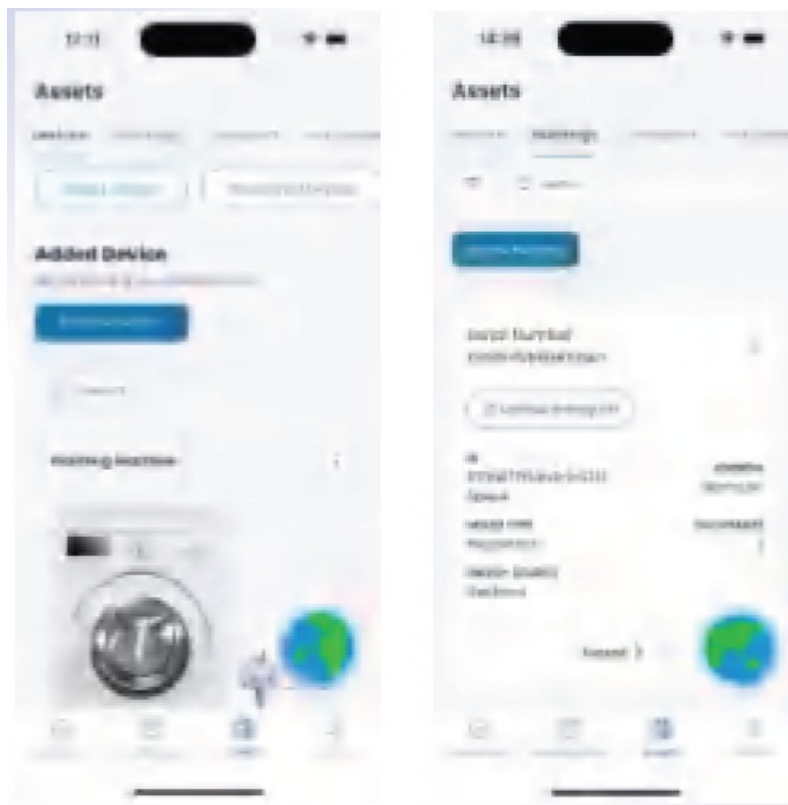

Safety Information

- The device is recommended for use indoors and in a dry location only. Power outlet shall be used within its published outlet rating on the instruction manual.
- Please contact the seller for replacement if there is any damage caused by transportation.
- Please use the device in proper condition and away from children.
- Please ensure safety conditions while using this device.
- Please, do not disassemble or assemble this device (if broken or it opens up) as this can cause the product to be damaged or present with risks.

Warranty

- This device is covered by a limited warranty from the manufacturer (via Escrow-Tech Limited) and covers the product from defects arising from workmanship (at production) and material for 12 months from the date of purchase. Damages from normal use, wear and tear, alteration, misuse, neglect, accident, service provided by unauthorised service centre or personnel, or acts of God are not included (or covered).
- During the warranty period and upon verification of defects, this product will be replaced after receiving the defective product along with proof of purchase.
- By purchasing this device, you agree that all of the generated environmental benefits that ensue from your use of this device belong to “Escrow-tech limited” or any party it assigns such rights to. You agree that you are owed no compensation for these benefits.

Warning:

Changes or modifications to this unit not expressly approved by the party responsible for compliance could void the user's authority to operate the equipment.

NOTE: This device complies with part 15 of the FCC Rules. Operation is subject to the following two conditions:

1. This device may not cause harmful interference, and
2. this device must accept any interference received, including interference that may cause undesired operation.

FCC Statement

This equipment has been tested and found to comply with the limits for a Class B digital device, pursuant to part 15 of the FCC Rules. These limits are designed to provide reasonable protection against harmful interference in a residential installation. This equipment generates, uses and can radiate radio frequency energy and, if not installed and used in accordance with the instructions, may cause harmful interference to radio communications. However, there is no guarantee that interference will not occur in a particular installation. If this equipment does cause harmful interference to radio or television reception, which can be determined by turning the equipment off and on, the user is encouraged to try to correct the interference by one or more of the following measures:

- Reorient or relocate the receiving antenna.
- Increase the separation between the equipment and receiver.
- Connect the equipment into an outlet on a circuit different from that to which the receiver is connected.
- Consult the dealer or an experienced radio/TV technician for help.

The equipment complies with the FCC Radiation exposure limit set forth for an uncontrolled environment. This equipment should be installed and operated with a minimum distance of 20cm between the radiator and your body.

Terms & Conditions



For Homeowners



For Merchants

Made in China for Escrow-Tech Limited Castlemead, Lower Castle Street, Bristol, BS1 3AG

FAQs

Q: How do I reset the Carbon-Adjust Smart Plug?

A: Long press the main option button to restore the smart plug to its default settings.

Q: What should I do if the smart plug is not connecting to my WiFi network?

A: Check your WiFi network settings and ensure you are using a 2.4GHz network compatible with the smart plug.

Documents / Resources

	Escrow Tech ETLSP4000 WiFi Smart Plug [pdf] User Manual ETLSP4000 WiFi Smart Plug, ETLSP4000, WiFi Smart Plug, Smart Plug, Plug
--	--

References

- [User Manual](#)

[Manuals+](#), [Privacy Policy](#)

This website is an independent publication and is neither affiliated with nor endorsed by any of the trademark owners. The "Bluetooth®" word mark and logos are registered trademarks owned by Bluetooth SIG, Inc. The "Wi-Fi®" word mark and logos are registered trademarks owned by the Wi-Fi Alliance. Any use of these marks on this website does not imply any affiliation with or endorsement.