



EROTHE MV 510130 Push Button Combifix Installation Guide

[Home](#) » [EROTHE](#) » EROTHE MV 510130 Push Button Combifix Installation Guide 

Contents

- 1 EROTHE MV 510130 Push Button Combifix
- 2 Installation
- 3 Technical data
- 4 Specifications
- 5 Product Usage Instructions
 - 5.1 Installation
 - 5.2 Technical Data
- 6 FAQ
 - 6.1 Q: Can I install the Klingeltaster without professional help?
 - 6.2 Q: What is the input voltage requirement for this product? A: The input voltage required is 8-12V~.
- 7 Documents / Resources
 - 7.1 References
- 8 Related Posts

EROTHE MV 510130 Push Button Combifix

INSTALLATION GUIDE

Installation

Installation must be carried out in deenergized condition by an electrician

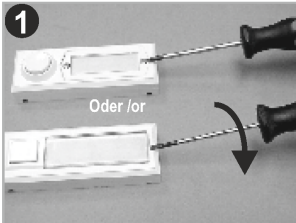

1
Gehäuse öffnen
Open the casing

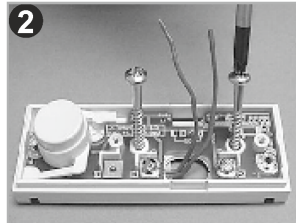

2
Festschrauben (Dist. 32mm)
Wall fixation (Dist. 32mm)

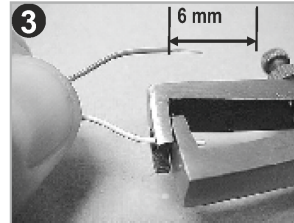

3
Drähte abisolieren (6mm)
Strip the wires (6mm)

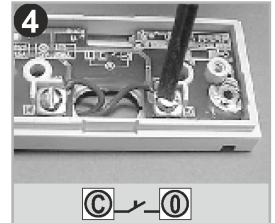

4
Drähte anschließen
Connect wires

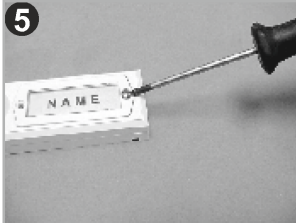

5
Namensschild einlegen, schließen
Insert name plate, close cover

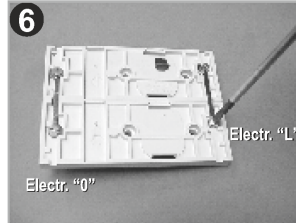



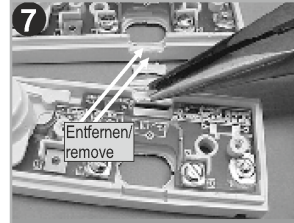

6
Electr. "L"
Electr. "0"
 Anreihung mehrerer Taster
Combinat. several pushes

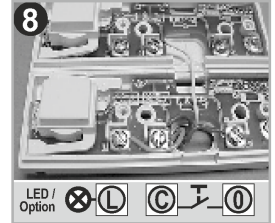

7
Entfernen /
remove
 2 Stege im Unterteil entfernen.
Remove 2 ribs in the base

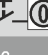

8
LED /
Option    
 Drähte anschließen etc.
Connect wires etc.

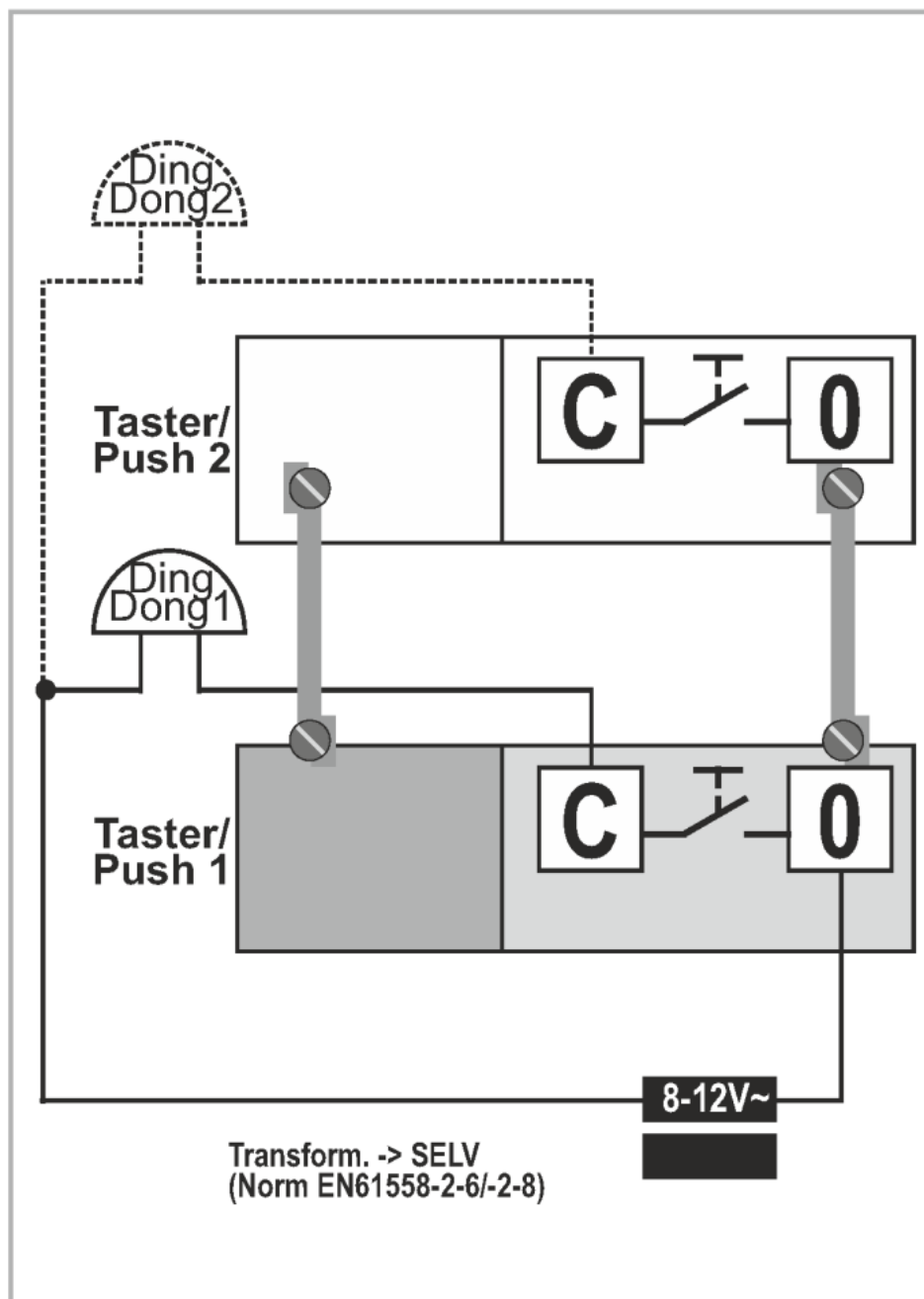

Technical data

- * 8 – 12 V ~ (AC 5 mA – 1,5 A)
- * 8 – 12 V = (DC 5 mA – 1,0 A)
- * Nur Schutzkleinspannung! Protect. low volt. only!
- * Leiter/Wire 0,6 – 0,8 mm
- * -20°C...60°C
- * IP41
- * Druckkraft/Op. force ca. 6 N





Specifications

- Product Name: Klingeltaster / Push button Combifix
- Model Number: MV 510130 11/24
- Input Voltage: 8-12V~
- Installation: Must be carried out in deenergized condition by an electrician

Product Usage Instructions

Installation

Ensure that the installation is performed by a qualified electrician in a deenergized condition. Follow the steps below:

1. Secure the push button with a wall fixation at a distance of 32mm.
2. If combining several push buttons, follow the specified guidelines for alignment.
3. To remove, eliminate 2 ribs in the base of the unit.
4. For LED options, refer to the manual for specific instructions.
5. Ensure proper transformer connection as per SELV standards (Norm EN61558-2-6/-2-8).

Technical Data

Model Number: MV 510130 11/24

FAQ

Q: Can I install the Klingeltaster without professional help?

A: No, the installation must be carried out by a qualified electrician in a deenergized state for safety purposes.

Q: What is the input voltage requirement for this product? A: The input voltage required is 8-12V~.

Documents / Resources



[EROTHE MV 510130 Push Button Combifix](#) [pdf] Installation Guide
51014, MV 510130, MV 510130 Push Button Combifix, MV 510130, Push Button Combifix, Butt
on Combifix

References

- [User Manual](#)

[Manuals+](#), [Privacy Policy](#)

This website is an independent publication and is neither affiliated with nor endorsed by any of the trademark owners. The "Bluetooth®" word mark and logos are registered trademarks owned by Bluetooth SIG, Inc. The "Wi-Fi®" word mark and logos are registered trademarks owned by the Wi-Fi Alliance. Any use of these marks on this website does not imply any affiliation with or endorsement.