



ergotron SV42-6202-1 StyleView Cart with LCD Arm User Guide

[Home](#) » [ERGOTRON](#) » [ergotron SV42-6202-1 StyleView Cart with LCD Arm User Guide](#) 

Contents

- [1 ergotron SV42-6202-1 StyleView Cart with LCD Arm](#)
- [2 RANGE OF MOTION](#)
- [3 WHEEL ALIGNMENT](#)
- [4 ERGONOMICS](#)
- [5 KEYBOARD LIGHT](#)
- [6 Documents / Resources](#)
 - [6.1 References](#)
- [7 Related Posts](#)

ergotron

ergotron SV42-6202-1 StyleView Cart with LCD Arm



RANGE OF MOTION

CAUTION! Completely release brake engagement before raising or lowering the cart. Raising or lowering the cart with the brake partially engaged may cause product damage.

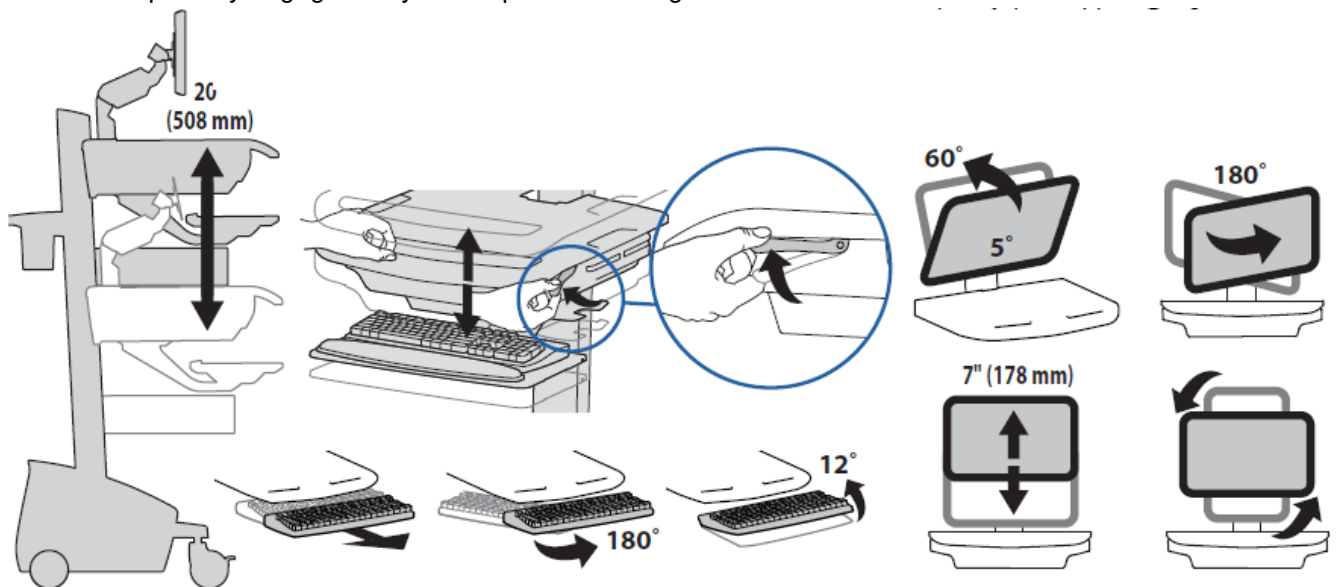

WHEEL ALIGNMENT

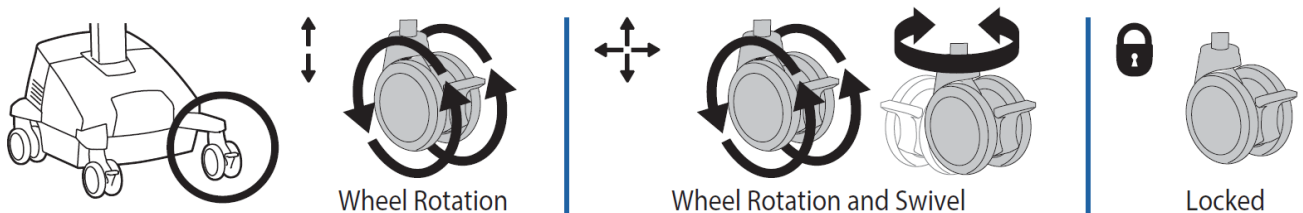

ERGONOMICS

Working customize – to your size

1. Set the top of the monitor screen about one inch below eye level – Release the brake and lift or lower the riser as needed.
2. Tilt screen for comfortable viewing and to reduce eye and neck strain.
3. Pull the keyboard tray forward and position the mouse tray and mouse pouch on right or left, as needed.
4. Work with elbows bent at about 90° to minimize muscle strain.
5. If the riser moves up and down with difficulty, or if it drifts out of a set position, consult the product manual for adjustment information.
6. Stay in charge! Powered carts should be plugged into the outlet as often as possible to keep the battery charged and the computer running.

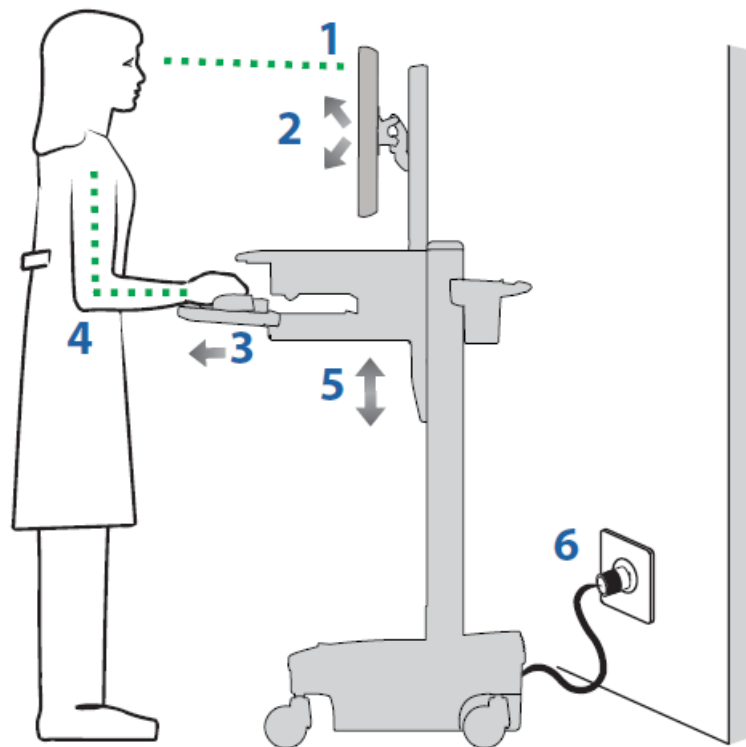

Moving stow – before you go

1. During normal movement, release the brake and lower worksurface to the lowest position for optimal stability and unobstructed view.
2. Tuck away open trays and return the mouse, scanner, and other accessories to their places.
3. Unlock both front casters.
4. Pushcart from the rear with elbows bent at about 90° to maximize control and minimize muscle strain.
5. Don't run out! Before moving, make sure the cord is unplugged from an outlet and hooked to the basket for safe travel. Remember, charge the battery fully 100% every day!

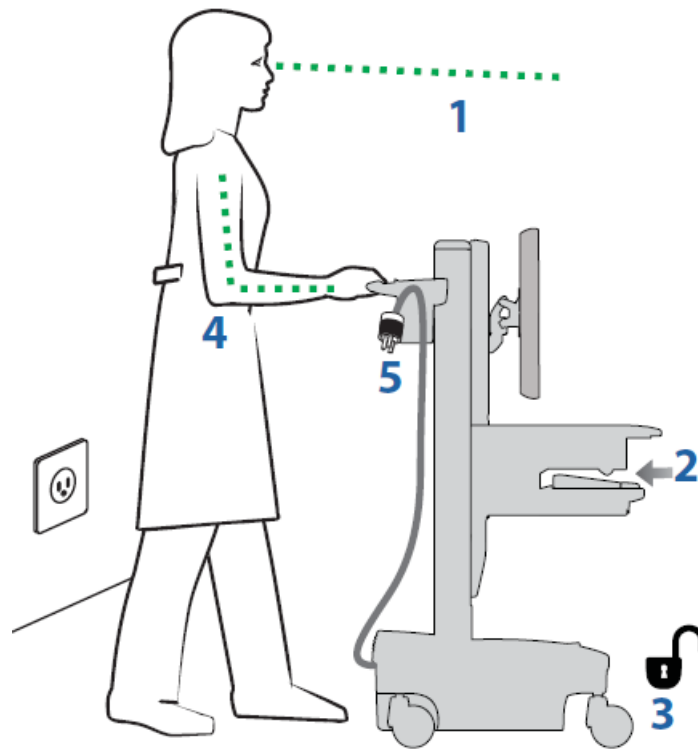

KEYBOARD LIGHT

Your computer must be on for this light to function. Keyboard Light will automatically turn off after 15 minutes if not manually turned off

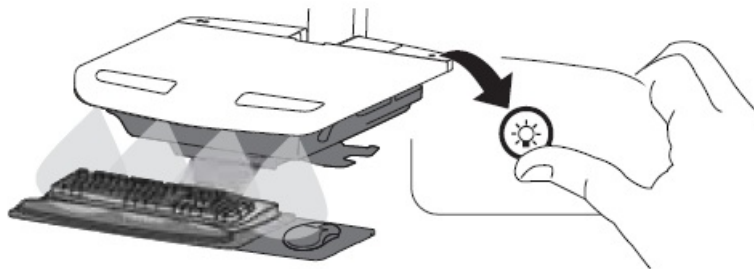

This power system interface will alert you to the percentage of charge remaining in the cart battery with a series of steady or flashing red, yellow, or green lights, and an alarm that will beep when the charge gets below 10%. Remember, the battery needs to be charged to 100% every day, and you can use the cart while charging, so plug in the cord as often as possible to avoid running out of power!

NOTE: Put the monitor in power save mode to optimize battery run time.

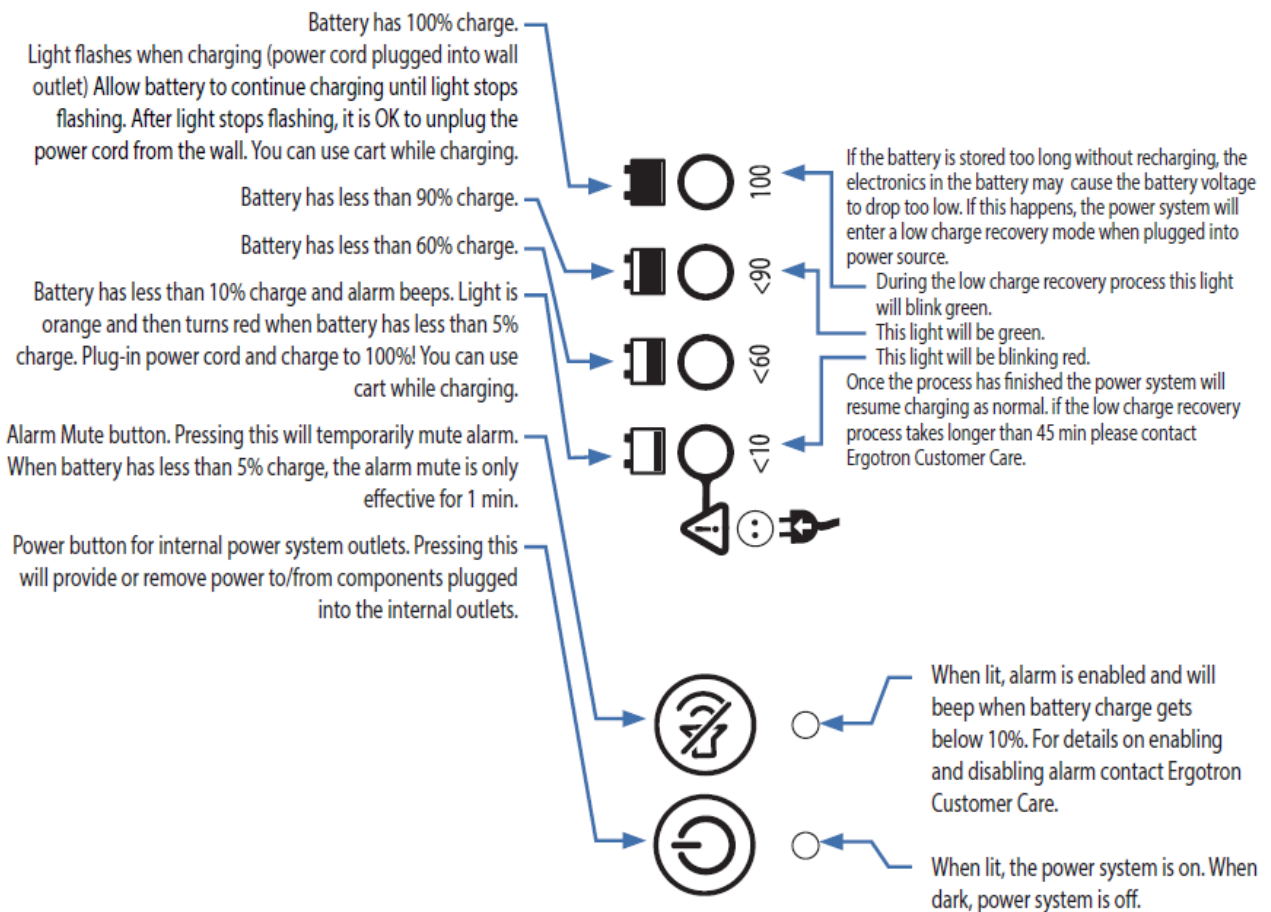

If other lights are flashing red/green it could indicate a power system fault. If this occurs contact Ergotron Customer Care.

NOTE: Frequent operation of the cart while battery charge levels are below 10% may reduce the life of your battery.

- www.ergotron.com
- USA: 1-800-888-8458
- Europe: +31 (0)33-45 45 600 China: 400-120-3051
- Japan: japansupport@ergotron.com

Documents / Resources

	<p>ergotron SV42-6202-1 StyleView Cart with LCD Arm [pdf] User Guide</p> <p>SV42-6202-1 StyleView Cart with LCD Arm, SV42-6202-1, StyleView Cart with LCD Arm, LCD Arm, Arm, StyleView Cart, Cart</p>
--	---

References

- © [Monitor Mounts, Computer Carts, Sit to Stand Desks | Ergotron](#)

