

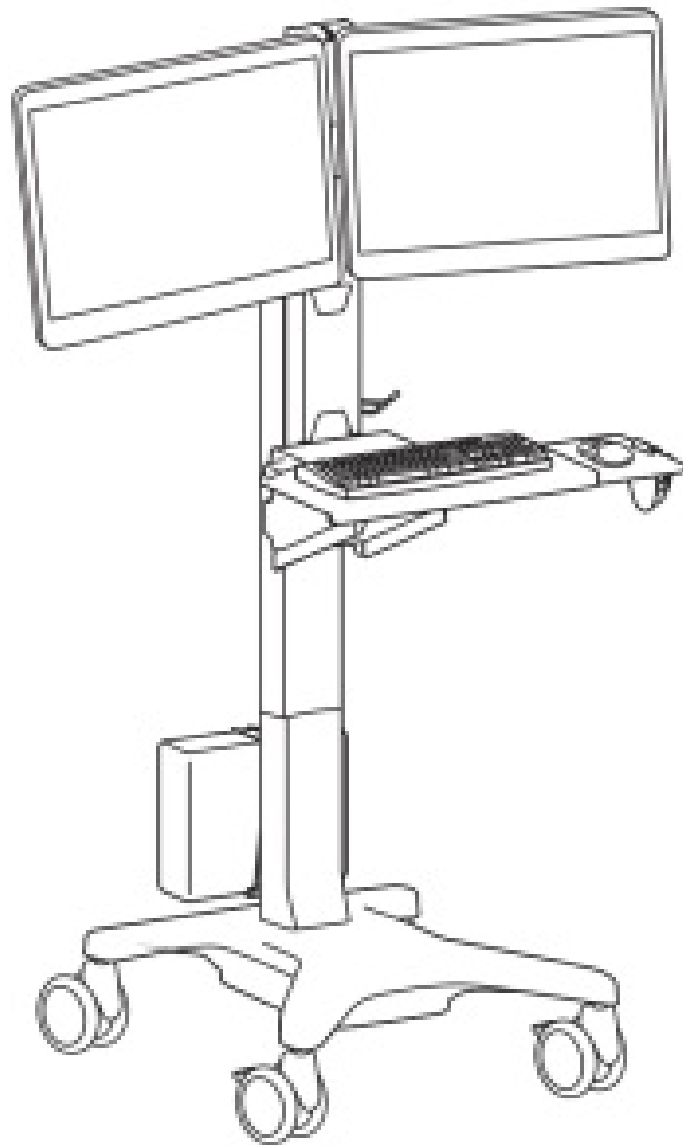

## ergotron Neo-Flex Dual WideView Workspace User Guide

[Home](#) » [ERGOTRON](#) » ergotron Neo-Flex Dual WideView Workspace User Guide 

**ergotron<sup>®</sup>**  
**Neo-Flex<sup>™</sup> Dual**  
**WideView Workspace**



## User Guide

### Contents

- [1 Features & Specifications](#)
- [2 Documents / Resources](#)
- [3 Related Posts](#)

## Features & Specifications

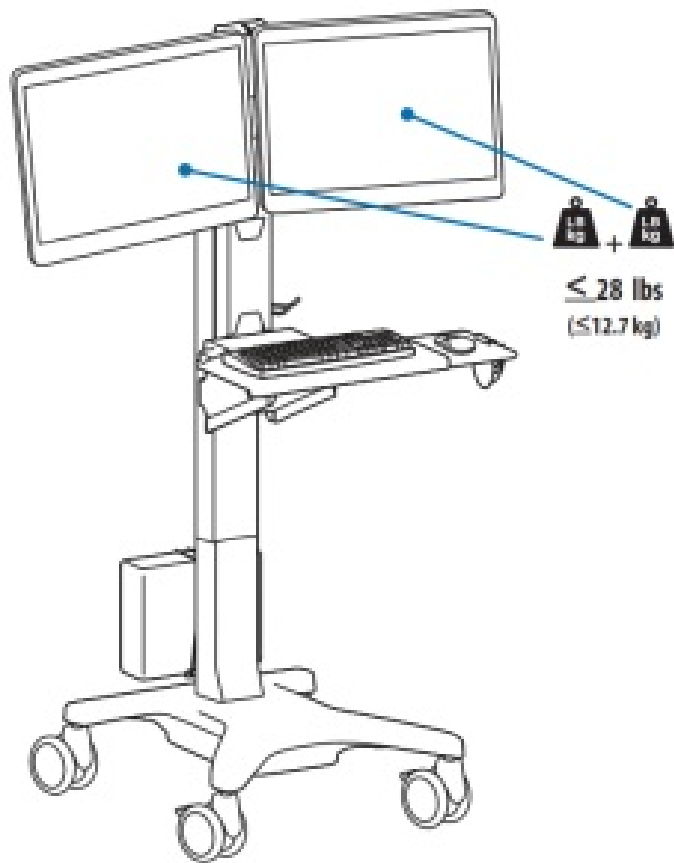

## CPU Holder

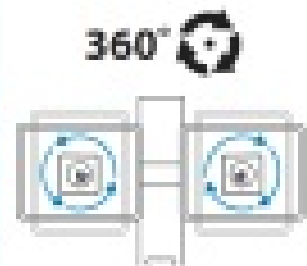
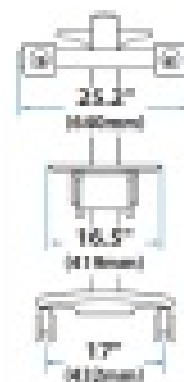
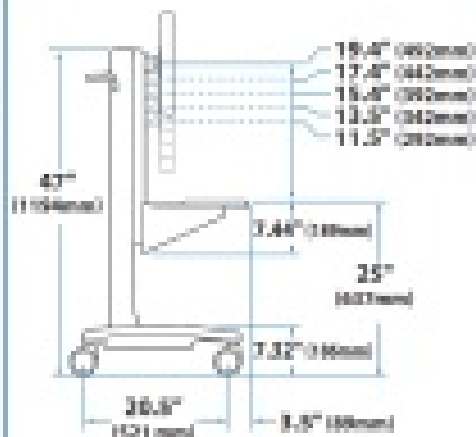
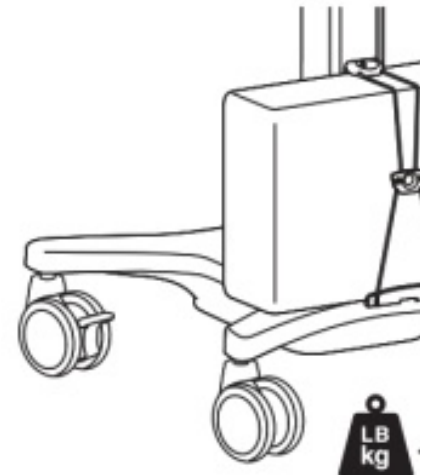

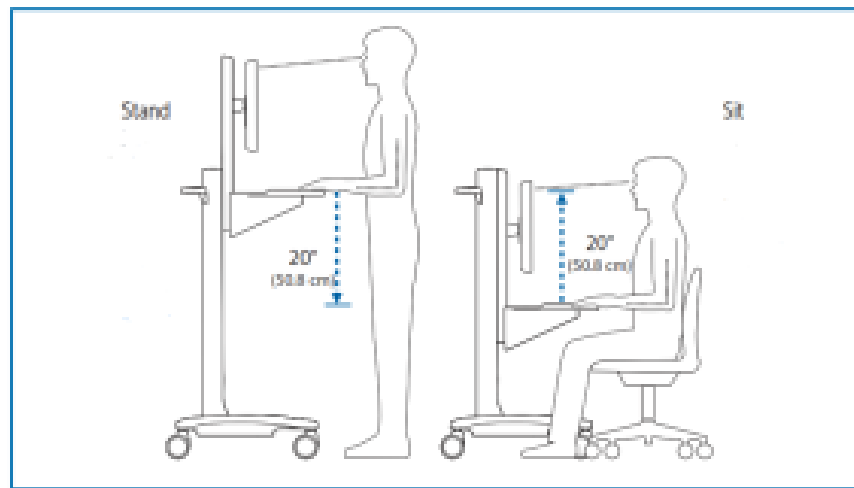

1	1x	Chromolite		1x	1x	1x	1x
2							
3							
4							
5	2x	2x	1x	2x	1x	4x	1x
6	1x	1x					
7	1x		1x		4x	2x	
8	8x		8x	2x			



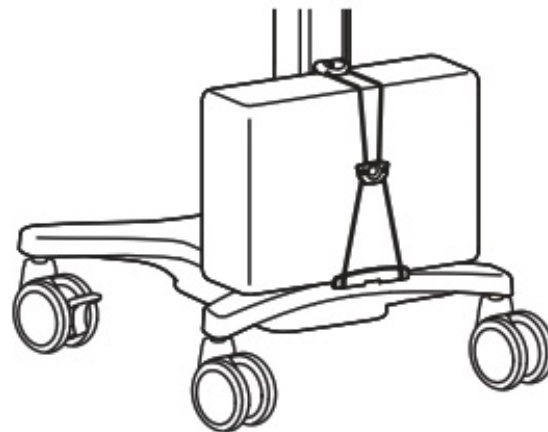
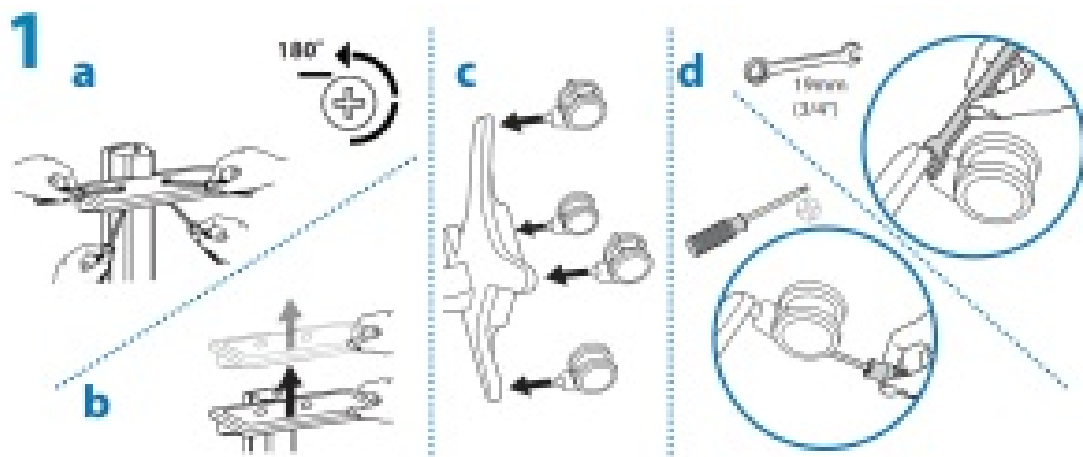

**CPU Holder NOTE:** If you are not attaching a CPU to your cart, skip step 2 and proceed to step 3.

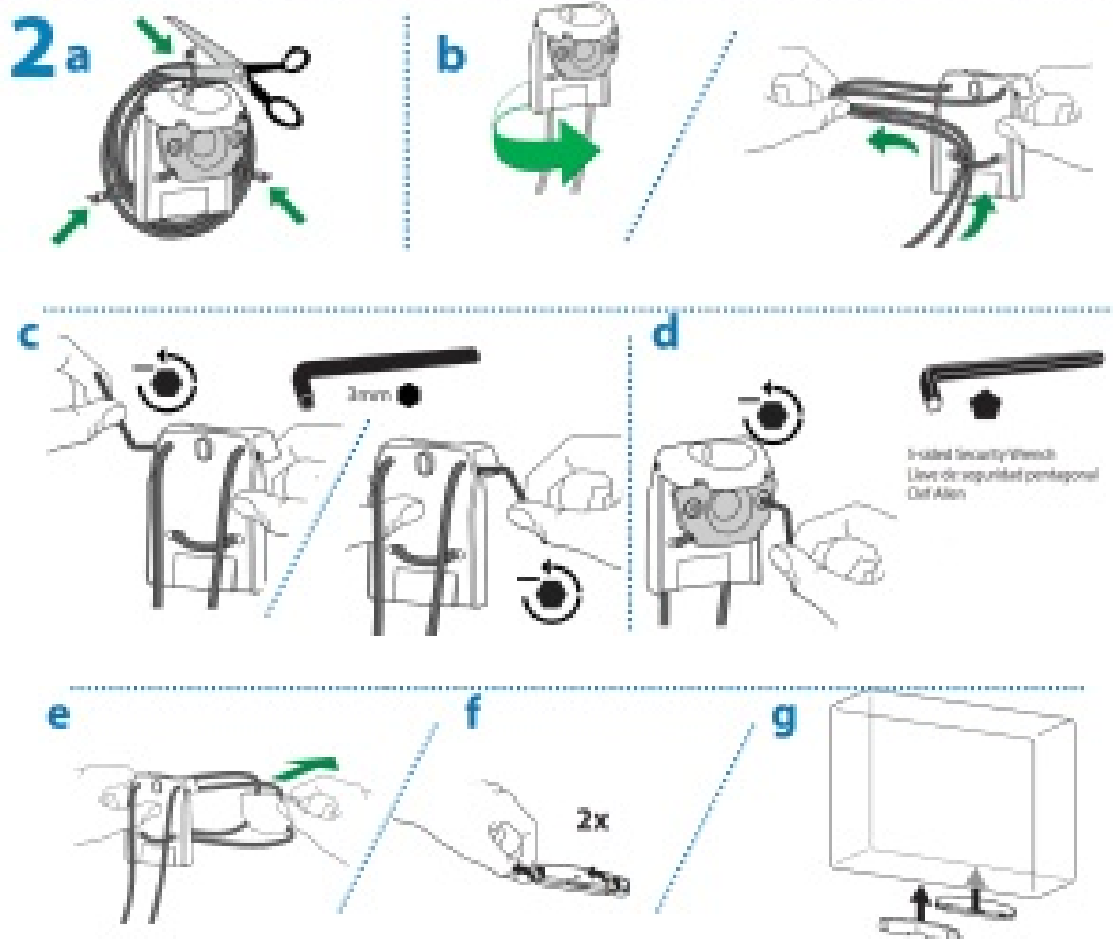

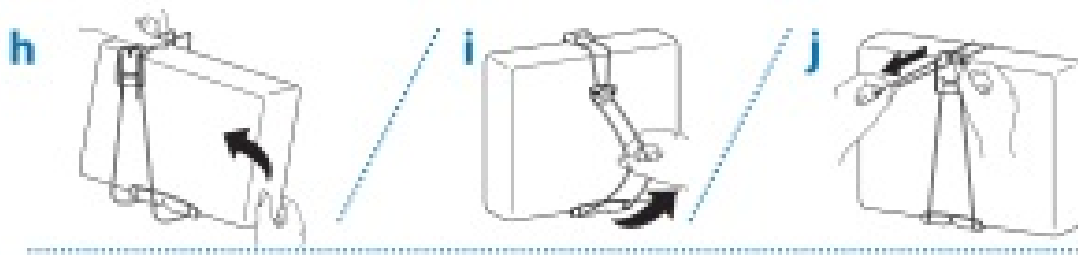

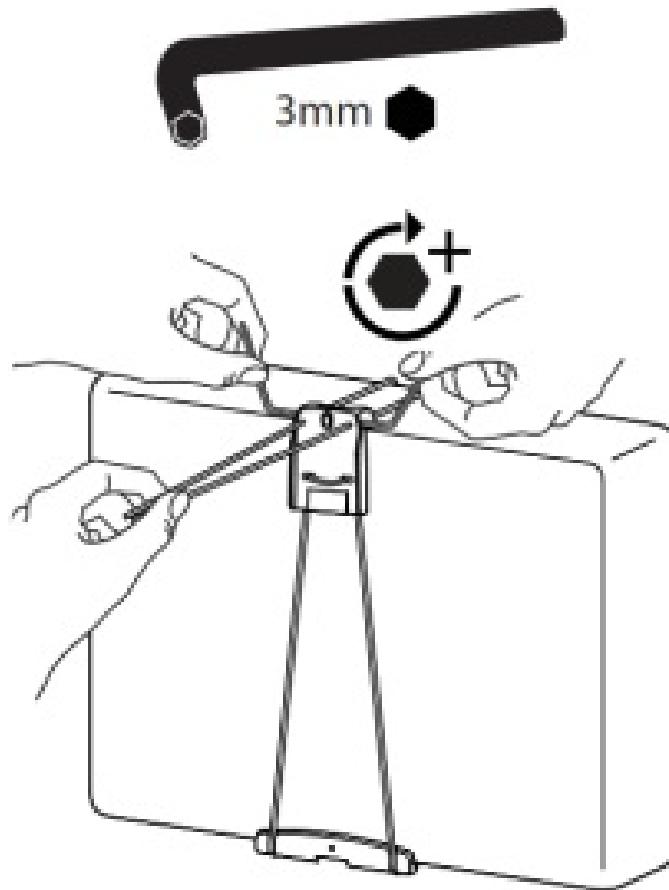

**⚠ Caution:** Do Not overtighten fasteners. Over-tightening may cause damage to fasteners.

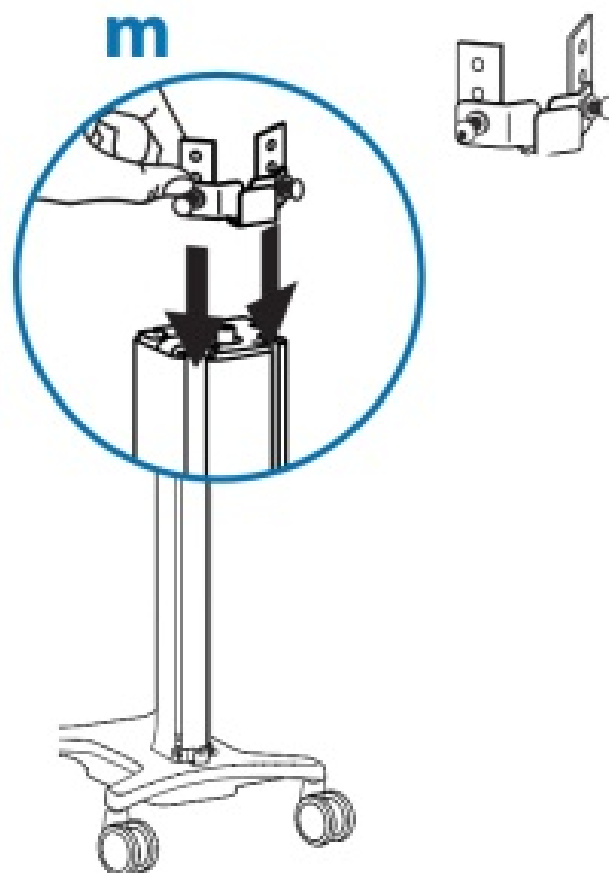
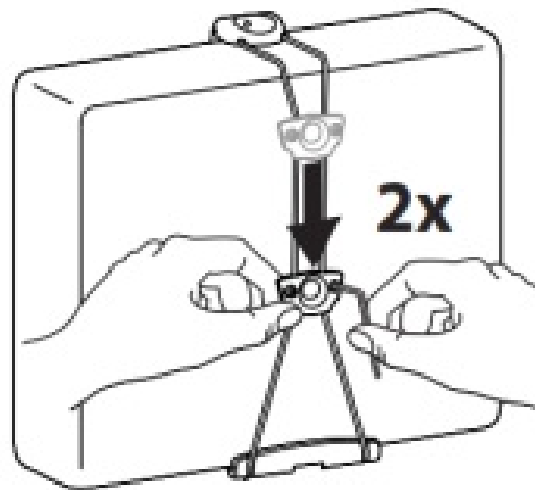
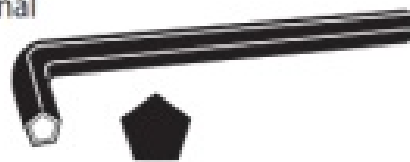

5-sided Security Wrench  
Llave de seguridad pentagonal  
Clef Allen



 **NOTE:** Position at bottom of the tower. Do not tighten at this time.

n

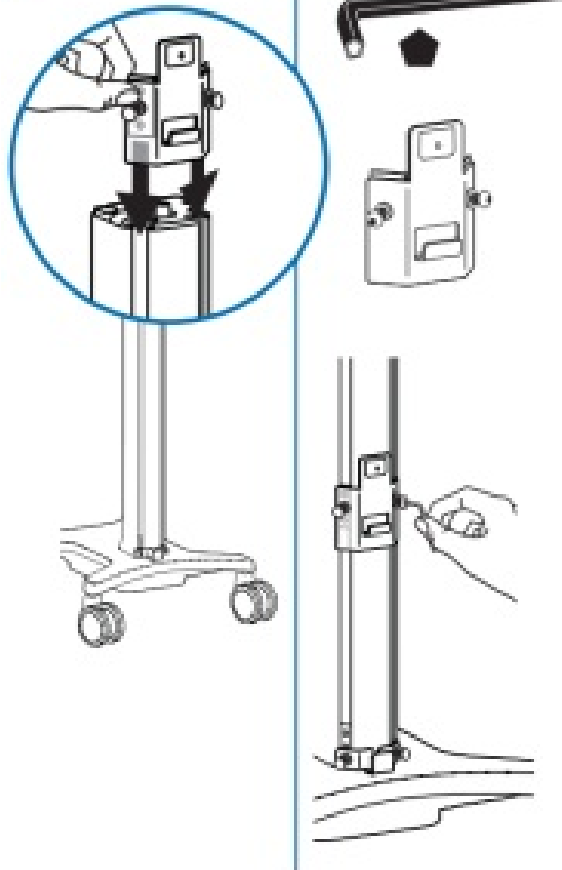

**⚠ Tipping Hazard:** Position bracket so that CPU attaches as low as possible on the tower.

o

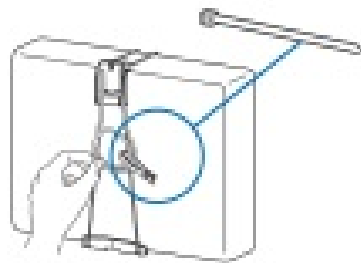

p

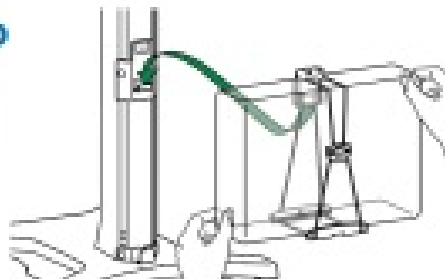

q

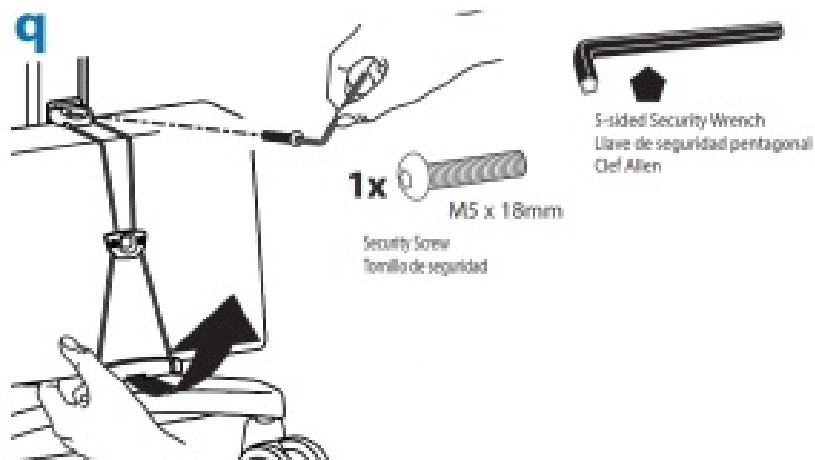



r

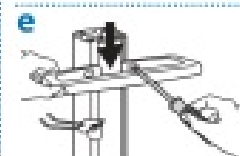
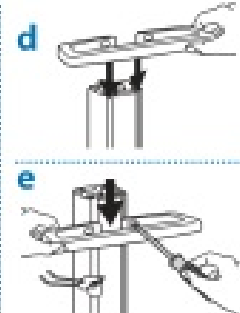
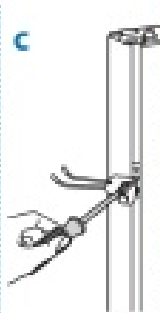
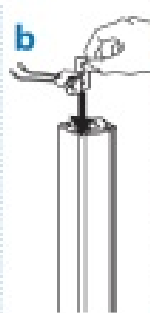
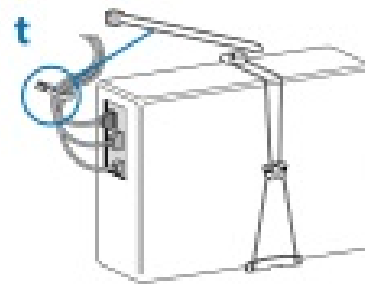
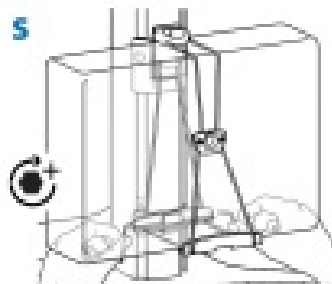
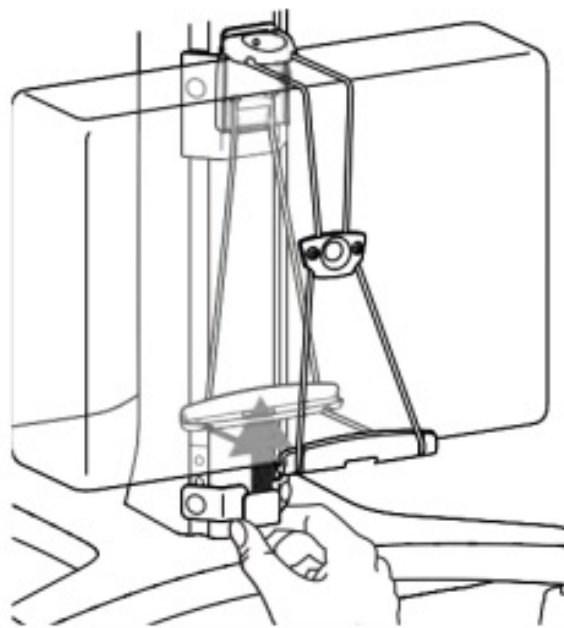

4 a 2x

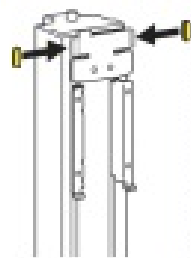

b



c

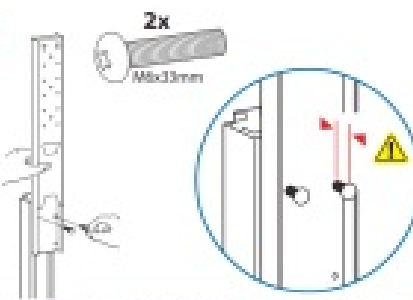

d

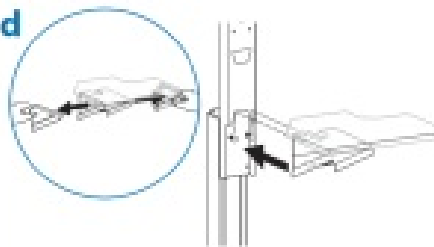

e

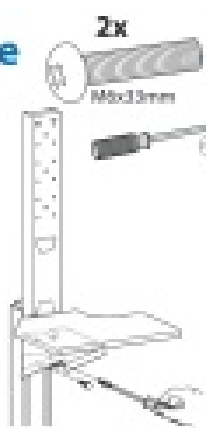

f

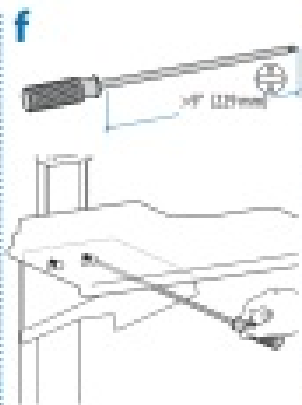

g

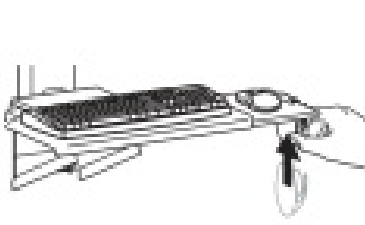
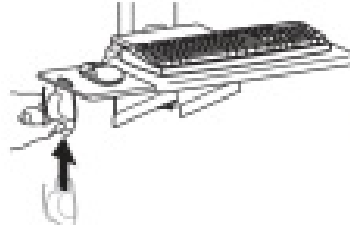
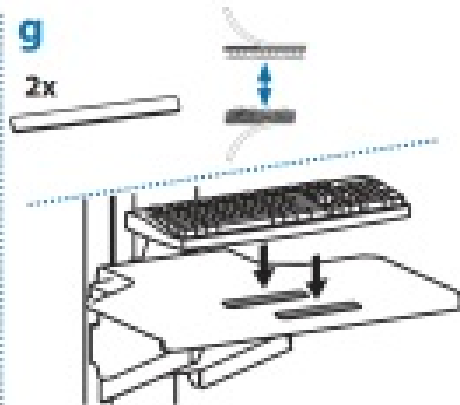

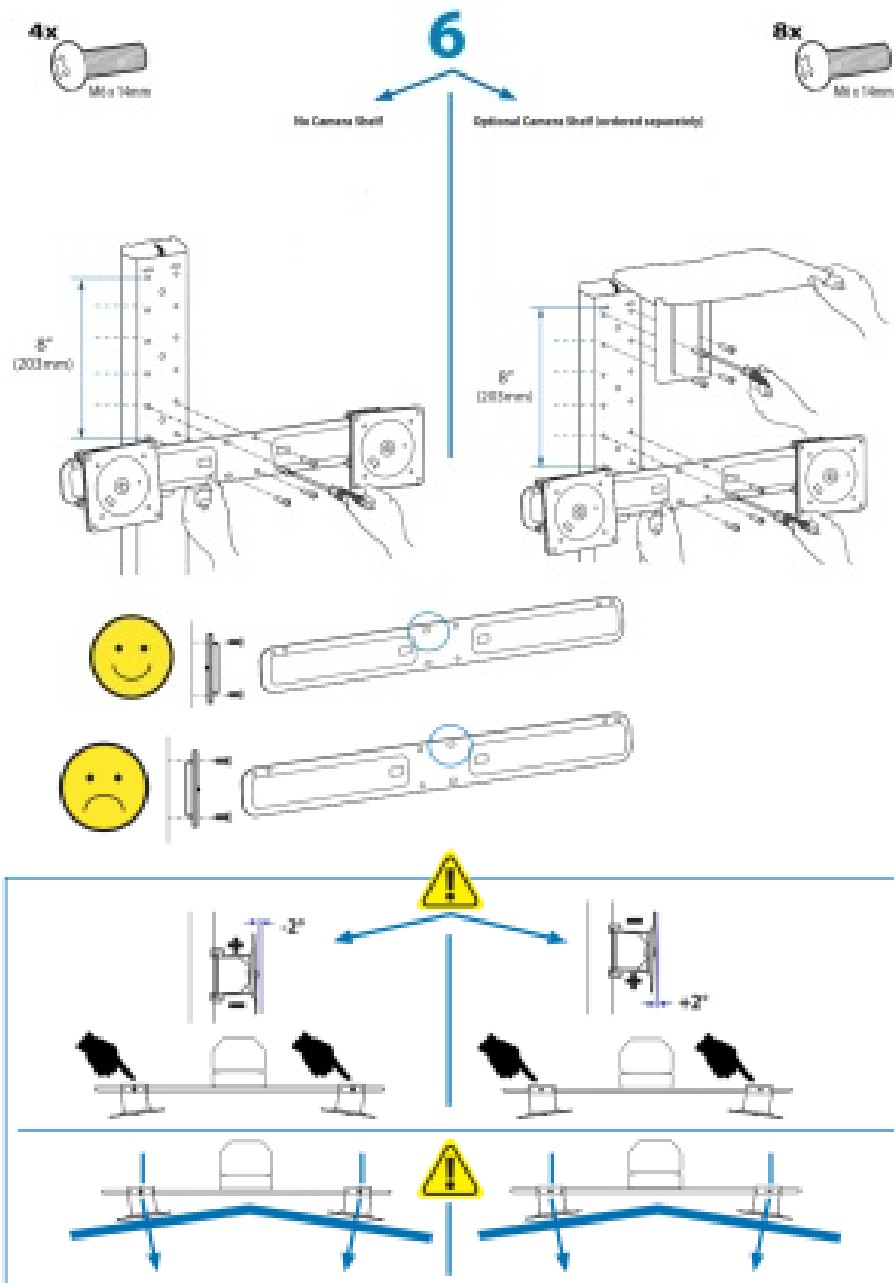

## WARNING

DO NOT load Cart below the minimum or above maximum weight capacities. DO NOT mount a display larger than the recommended size. Failure to comply with a warning may result in Cart instability leading to equipment damage or personal injury.



Min. 14 lbs (6.35 kg)  
Max. 49 lbs (22.2 kg)

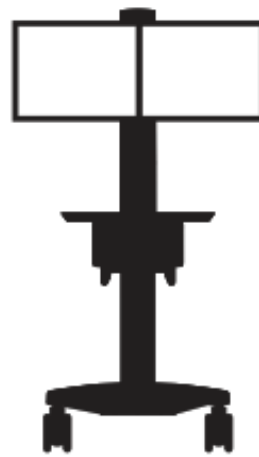

Min. 11 lbs (5 kg)  
Max. 46 lbs (20.9 kg)

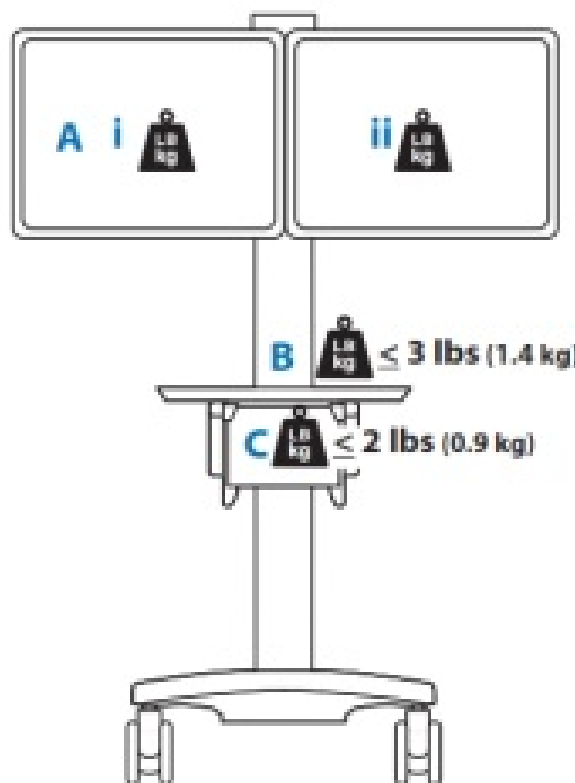

**Ai:** 6-14 lbs (2.72-6.35 kg)\*

**Ai:** 6-14 lbs (2.72-6.35 kg)\*

\***Ai+Aii** ≤ 28 lbs (12.7 kg)

**Ai=Aii** ±1 lbs (.45 kg)

7

75x75mm & 100x100mm Mount  
 Montage de 75x75 mm y 100x100 mm  
 Support 75x75mm & 100x100mm  
 75 x 75 mm & 100 x 100 mm Befestigung  
 75 x 75 mm & 100 x 100 mm bevestigings  
 Montaggio 75 x 75 mm & 100 x 100 mm

4x



4x

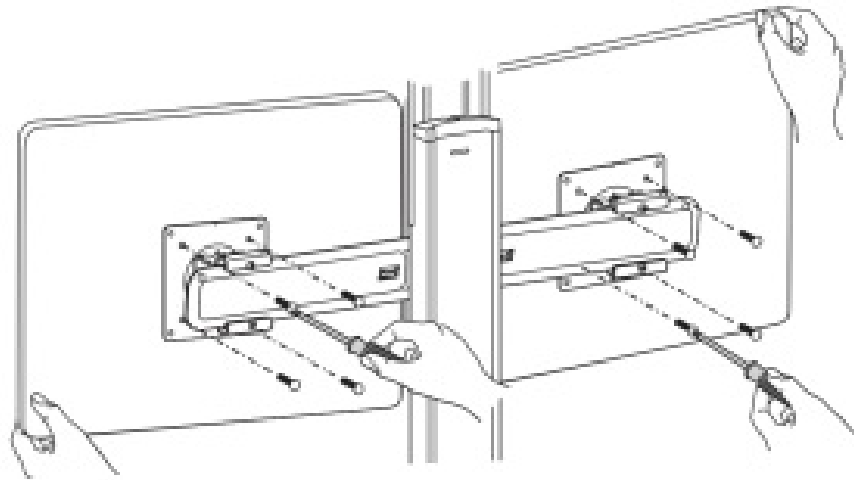

8



Center total width of mounted equipment on stand.  
 Centrar la anchura total del equipo montado en el soporte.

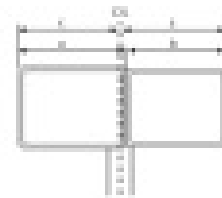

a

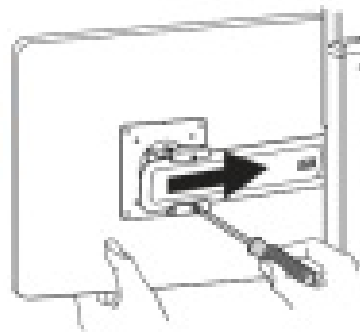

b

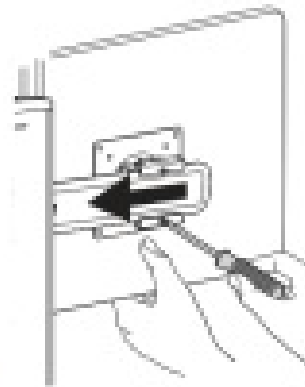

9

a

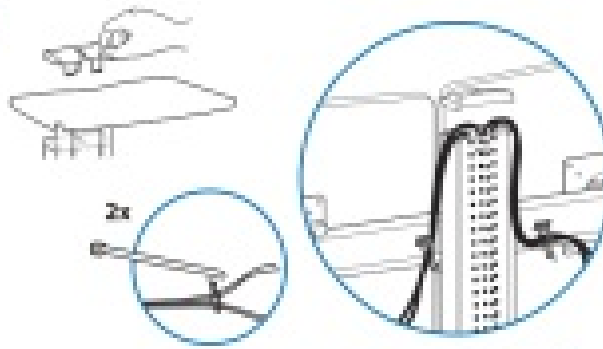

b

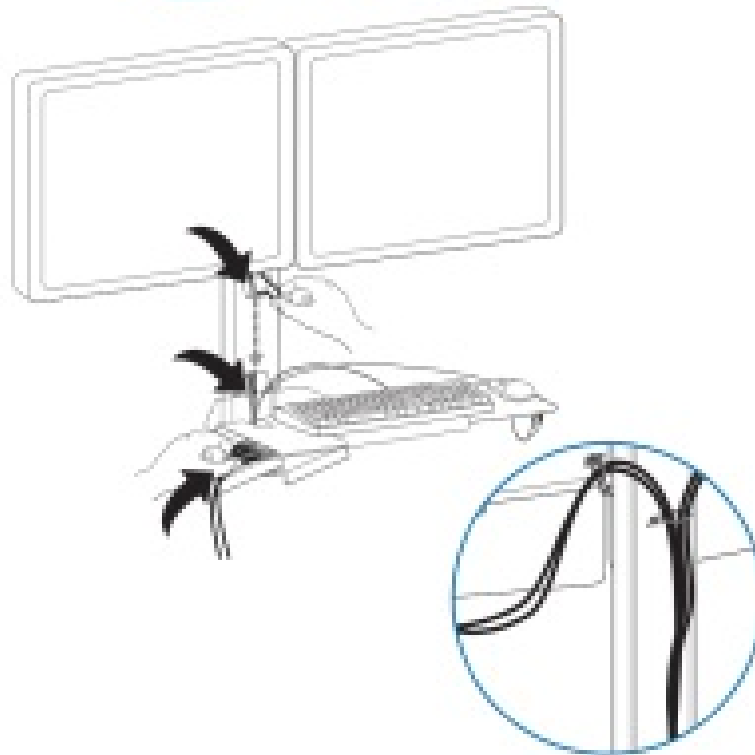

## 10 Adjustment Step

Important! You will need to adjust this product after installation is complete. Make sure all your equipment is properly installed on the product before attempting adjustments. This product should move smoothly and easily through the full range of motion and stay where you set it. If movements are too easy or difficult or if the product does not stay in desired positions, follow the adjustment instructions to create smooth and easy movements. Depending on your product and the adjustment, it may take many turns to notice a difference. Any time equipment is added or removed from this product, resulting in a change in the weight of the mounted load, you should repeat these adjustment steps to ensure safe and optimum operation.

### Lift – Up and down

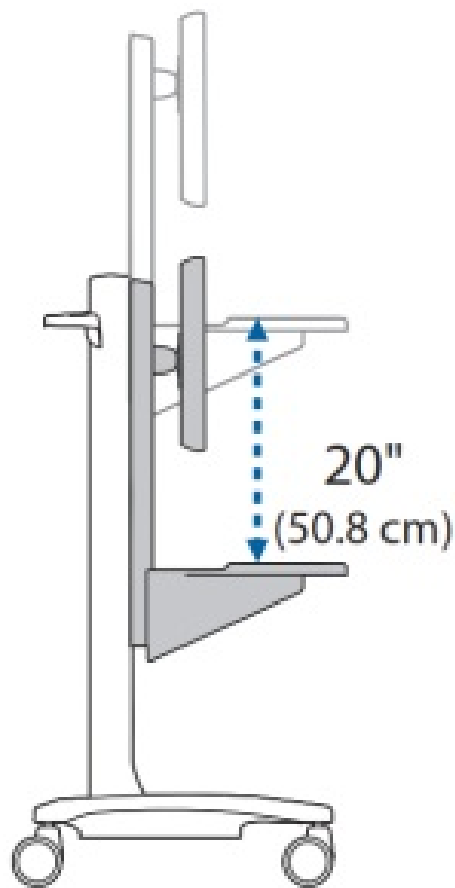

Follow these instructions to tighten or loosen tension.

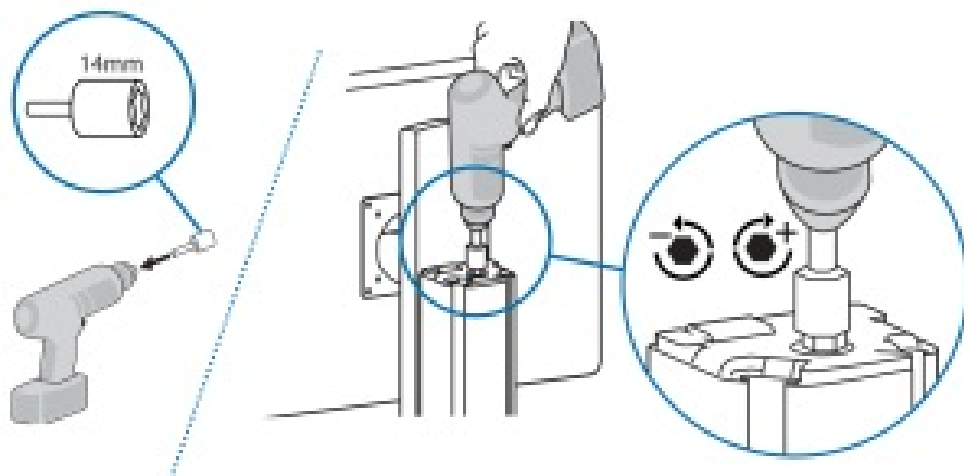

**12**

1x

**a**



**b**

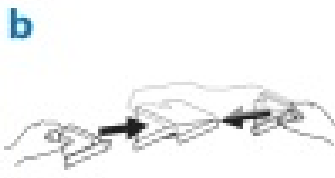

**c**



**WARNING**

DO NOT load Cart below the minimum or above maximum weight capacities. DO NOT mount a display larger than the recommended size. Failure to comply with a warning may result in Cart instability leading to equipment damage or personal injury.

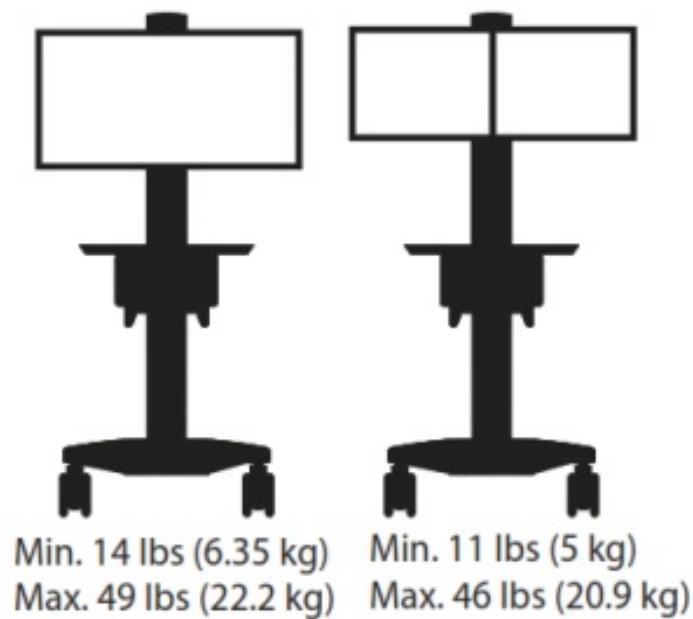

#### WARNING



#### Impact Hazard!

**Moving Parts can Crush and Cut.**

**Minimize Lift Tension BEFORE  
 Removing Mounted Equipment.**

#### To Minimize Lift Tension

1. Lower the work surface to the lowest position.
  2. Turn adjustment nut at top of riser counterclockwise until it stops (may require 40-60 turns to minimize lift tension).
  3. After removing or adding equipment adjust lift tension to compensate for the weight of the new load.
- Failure to heed this warning may result in serious personal injury or property damage!



#### WARNING

**STORED ENERGY HAZARD!**



**DO NOT OPEN THE TOWER OR BASE. DO NOT REMOVE THE SAFETY GUARD.**

A primary mechanism within the Cart is under tension and can be hazardous to people exposed to it under certain conditions.

**DO NOT** open the Cart tower or base.

**DO NOT** attempt to service the Cart.

**DO NOT** remove safety guards or labels designed to protect or inform of possible hazards.

Only Ergotron-approved installers may service or otherwise modify Cart. Failure to heed this warning may result in serious Personal Injury and Damage both to the cart and equipment. 240-027-00

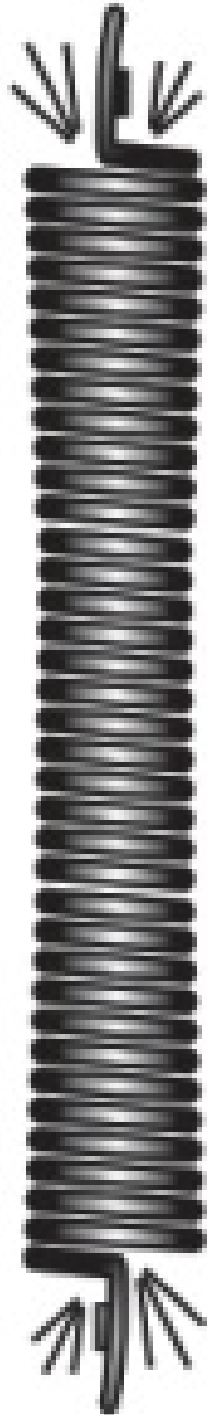

**WARNING**

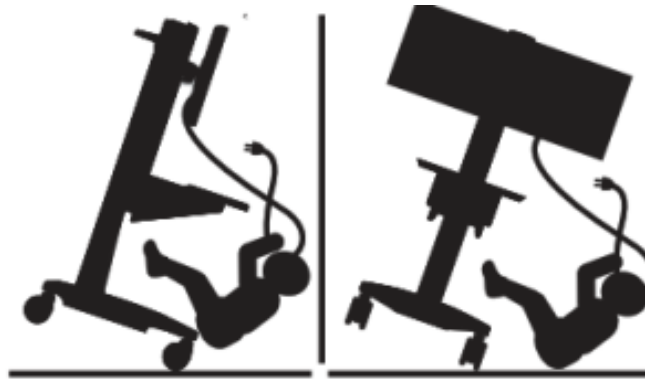

#### TIPPING HAZARD!

DO NOT allow children to climb on Cart.

DO NOT route electric cords or equipment cables within reach of children.

LOCK CASTERS when Cart is stationary.

DO NOT move Cart with Display in the highest position.

DO NOT move Cart over cords or uneven, dirty, soft, or sloping surfaces.

DO NOT move Cart by pushing on Display.

Failure to comply with this warning may result in Cart instability leading to equipment damage or personal injury.



#### TO MOVE CART

1. Push Display down to lowest position.
2. Disconnect the power cord and secure it to Cart.
3. Unlock casters; point casters in direction of travel.
4. Use the rear handle to push Cart.

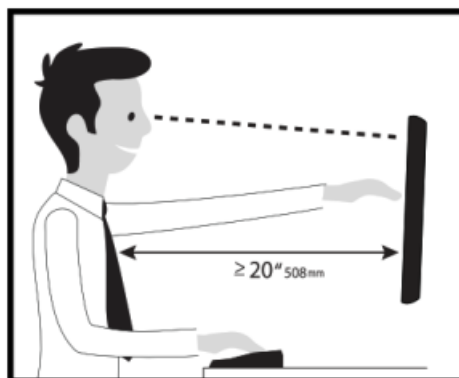

Learn more about ergonomic computer use at: [www.ergotron.com/ergonomics](http://www.ergotron.com/ergonomics)

For the latest User Installation Guide please visit: [www.ergotron.com](http://www.ergotron.com)

For Warranty visit: [www.ergotron.com/warranty](http://www.ergotron.com/warranty)

For Service visit: [www.ergotron.com](http://www.ergotron.com)

For local customer care phone numbers visit: <http://contact.ergotron.com>



[www.ergotron.com](http://www.ergotron.com) | USA: 1-800-888-8458 | Europe: +31 (0)33-45 45 600 | China: 400-120-3051 | Japan: [japansupport@ergotron.com](mailto:japansupport@ergotron.com)

© 2014 Ergotron, Inc. All rights reserved. Neo-Flex is a registered trademark of Ergotron, Inc.

While Ergotron, Inc. makes every effort to provide accurate and complete information on the installation and use of its products, it will not be held liable for any editorial errors or omissions (including those made in the process of translation from English to another language), or for incidental, special or consequential damages of any nature resulting from furnishing this instruction and performance of equipment in connection with this instruction. Ergotron, Inc. reserves the right to make changes in the product design and/or product documentation without notification to its users. For the most current product information, or to know if this document is available in languages other than those herein, please contact Ergotron. No part of this publication may be reproduced, stored in a retrieval system, or transmitted in any form or by any means, electronic, mechanical, photocopying, recording, or otherwise without the prior written consent of Ergotron, Inc., 1181 Trapp Road, Eagan, Minnesota, 55121, USA Patents Pending and Patented U.S. & Foreign. Ergotron is a registered trademark of Ergotron, Inc.

888-24-076-W-00 rev. J • 11/20

## Documents / Resources

 <p>ergotron® Neo-Flex® Dual WideView Workspace</p>	<p><a href="#">ergotron Neo-Flex Dual WideView Workspace</a> [pdf] User Guide ergotron, Neo-Flex, Dual, WideView, Workspace</p>
--	---

[Manuals+](#)