

ErGear EGKB03 Keyboard Tray Under Desk



# ErGear EGKB03 Keyboard Tray Under Desk Instruction Manual

[Home](#) » [ERGEAR](#) » ErGear EGKB03 Keyboard Tray Under Desk Instruction Manual 

## Contents

- [1 ErGear EGKB03 Keyboard Tray Under Desk](#)
- [2 Important Safety Information](#)
- [3 Tools Needed \(Not Included\)](#)
- [4 Supplied Parts and Hardware](#)
- [5 INSTALLATION](#)
- [6 Documents / Resources](#)
  - [6.1 References](#)
- [7 Related Posts](#)

# ErGear

## ErGear EGKB03 Keyboard Tray Under Desk



## Important Safety Information

- Check package contents against supplied parts and hardware list to verify that all parts were received and undamaged. If you require replacement parts, please call technical support or email customer service.
- Carefully read and follow all instructions. We are not liable for damage or injury caused by improper mounting, incorrect assembly or inappropriate use.

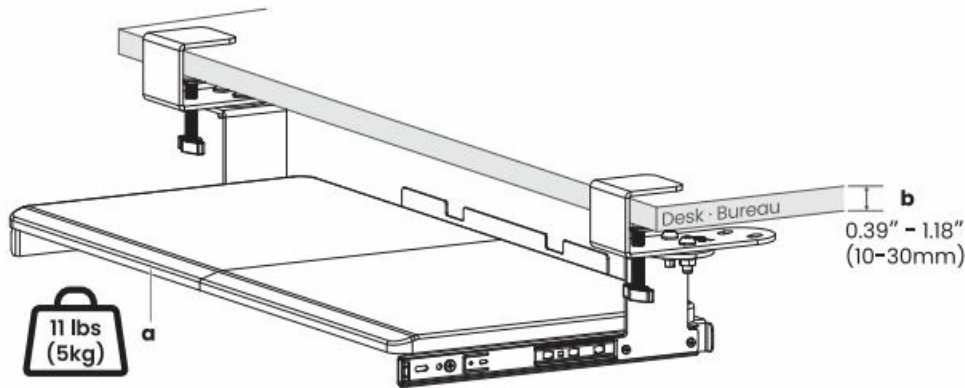

- Do not exceed the maximum weight capacity (11 lbs / 5kg)
- This product fits desktop 0.39" – 1.18" (10-30mm) thick.

## Tools Needed (Not Included)

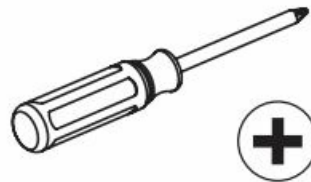

- Phillips Screwdriver
- Tournevis cruciform

## Supplied Parts and Hardware



01A x 1



· Left Tray  
· Plateau gauche

01B x 1



· Right Tray  
· Plateau droit

02 x 2



· Connector  
· Connecteur

03 x 1

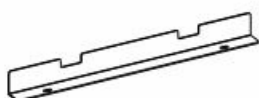

· Keyboard Stopper  
· Cale pour clavier

04 x 1



· Left C-Clamp  
· C Plaque gauche

05 x 1



· Right C-Clamp  
· C Plaque droit

06 x 2



· Bracket  
· Support

07 x 2



· Washer  
· Rondelle

08 x 2



· Keyboard Slide  
· Glissière pour clavier

A x 8



M5 x 10mm  
· Bolt  
· Boulon

B x 8



M5 x 10mm  
· Bolt  
· Boulon

C x 4



M4 x 8mm  
· Bolt  
· Boulon

D x 4



M8 x 20mm  
· Bolt  
· Boulon

E x 4



F x 4



G x 4



H x 1



I x 1



## INSTALLATION

1

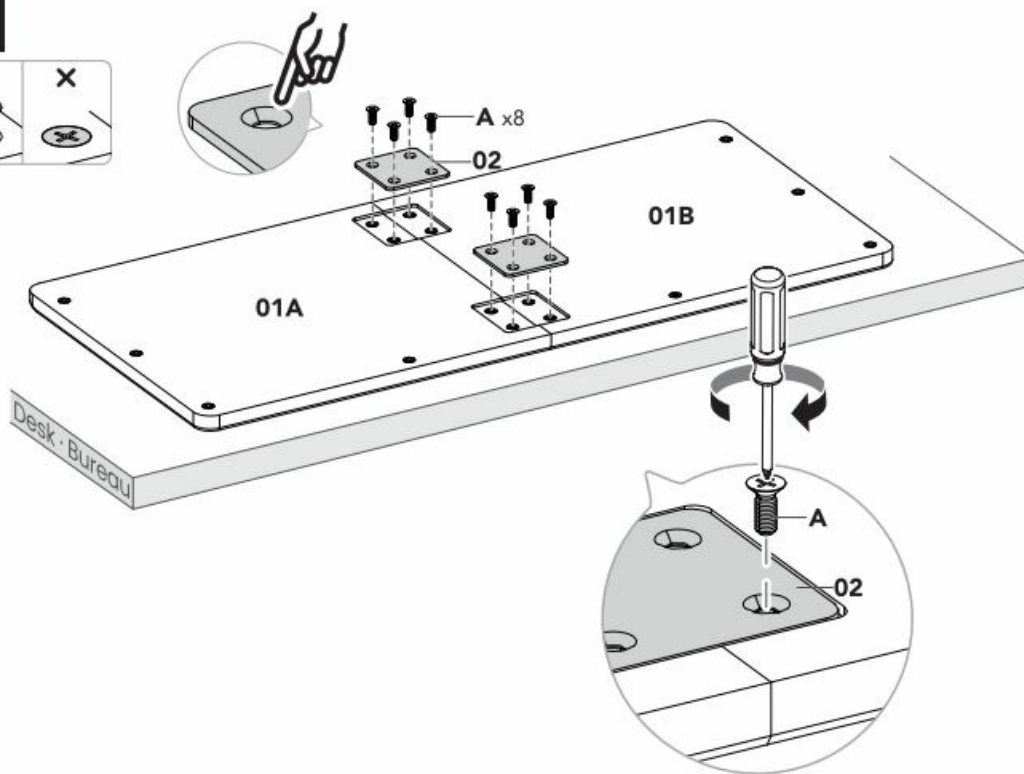

- Press tightly together to ensure no gap.



- Press tightly together to ensure no gap.
- Appuyez fermement ensemble pour vous assurer qu'il n'y a pas d'espace.

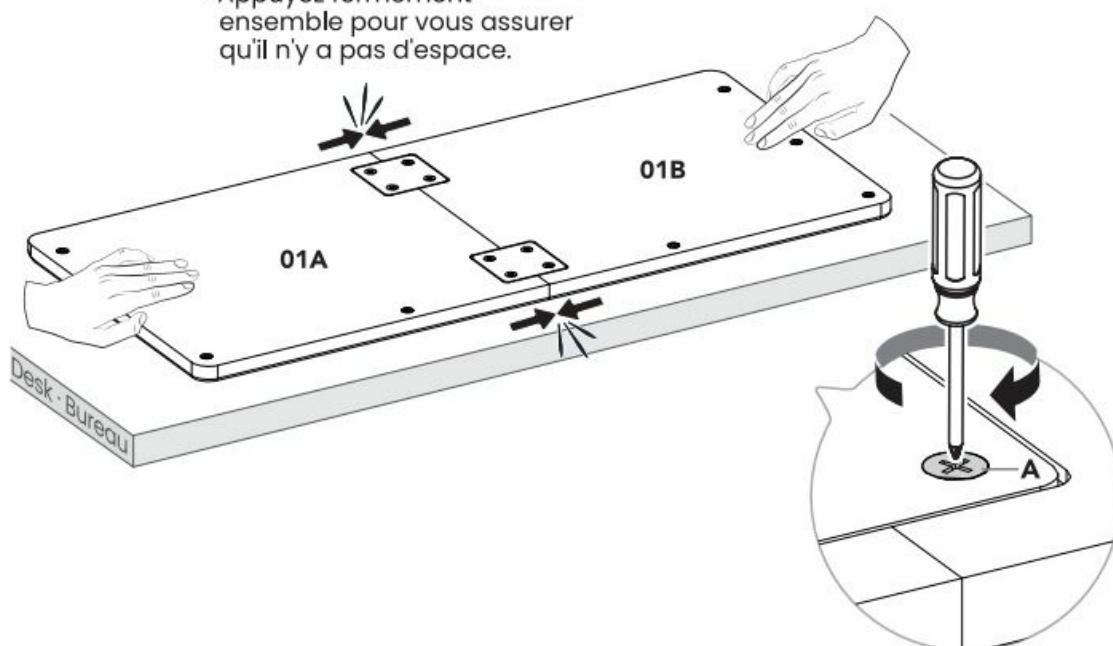

2

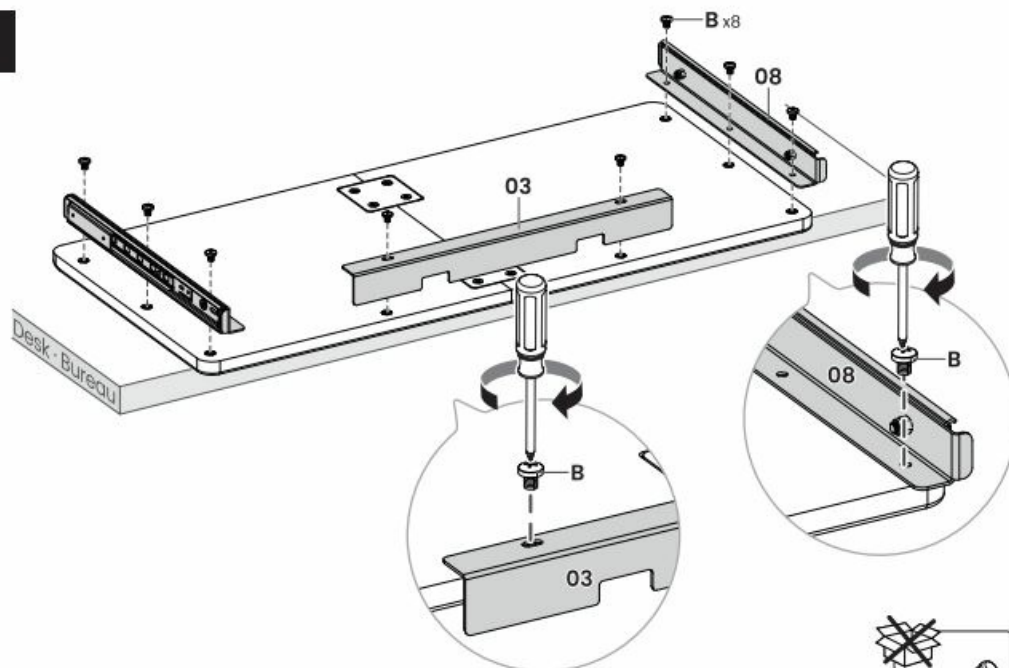

3

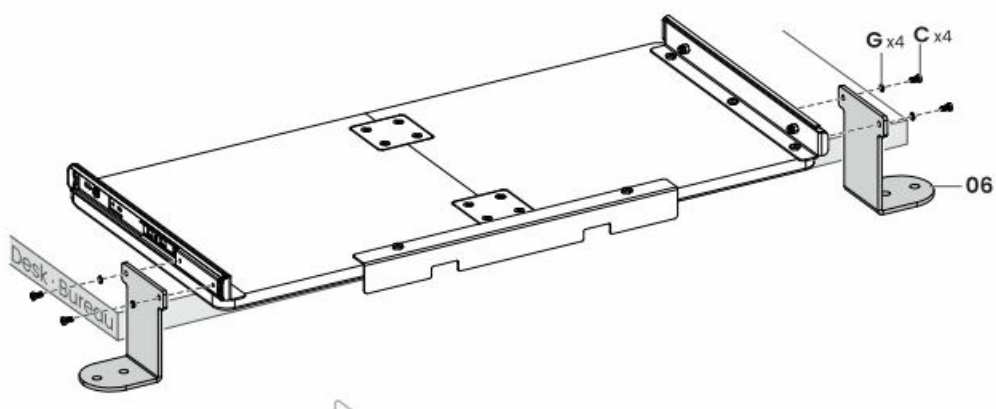

**Tip:** Position the drawer slides toward the back for easier bracket installation.

**For Rectangular Desk, go to 4A on this page. For the L-shaped desk, go to 4B on the next page.**

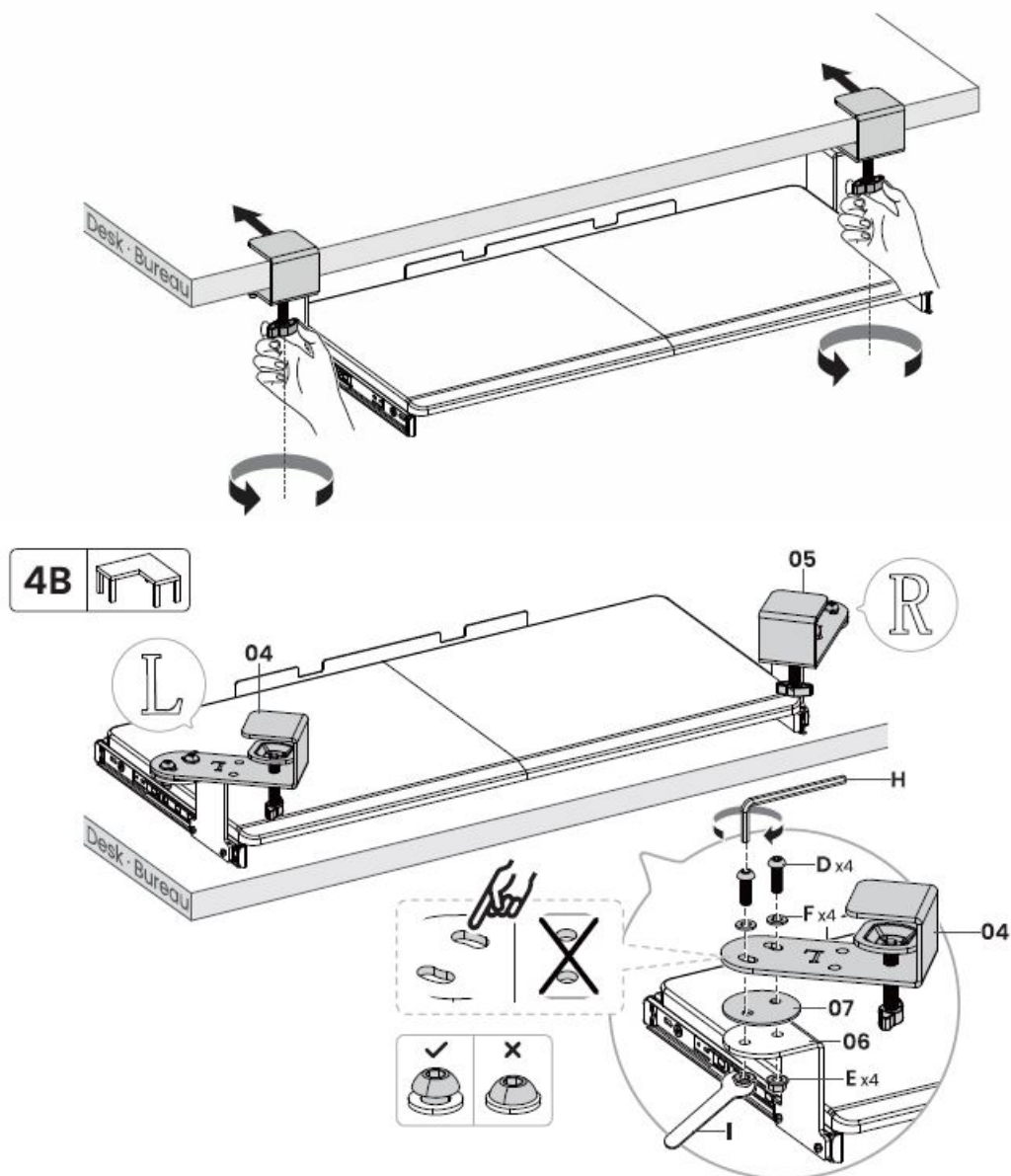
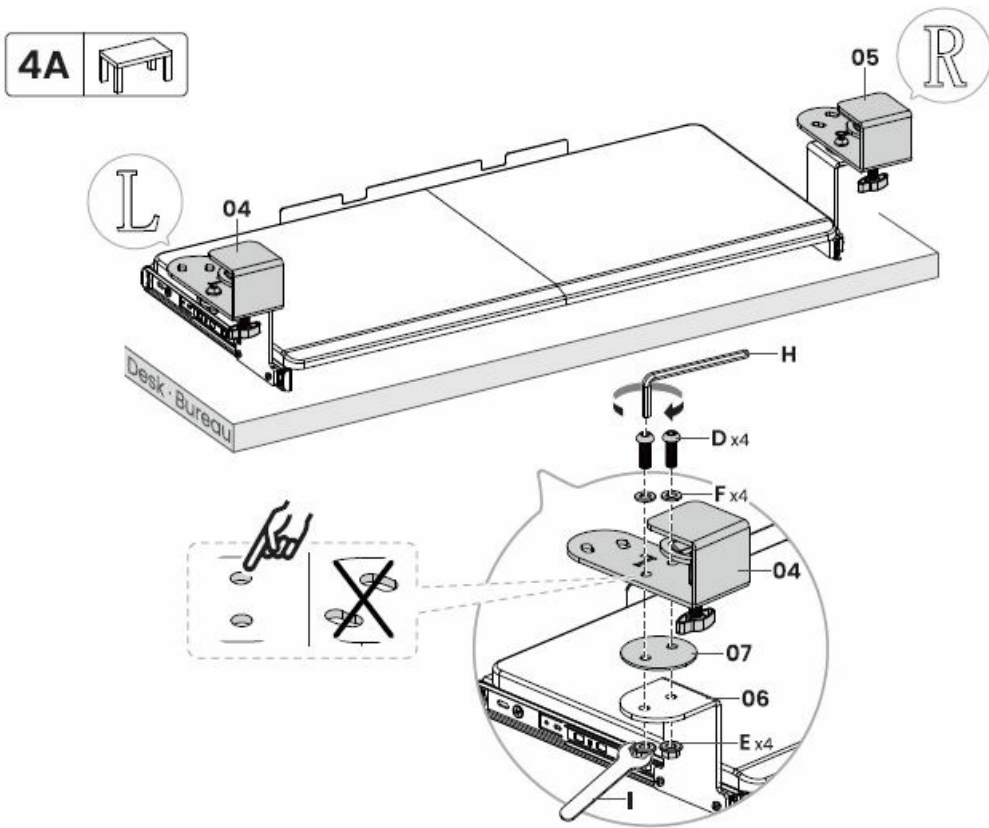



- Before securing the keyboard tray to the desktop, fine-tune C-clamp positions to fit, remove the keyboard tray, then fully tighten the bolts.

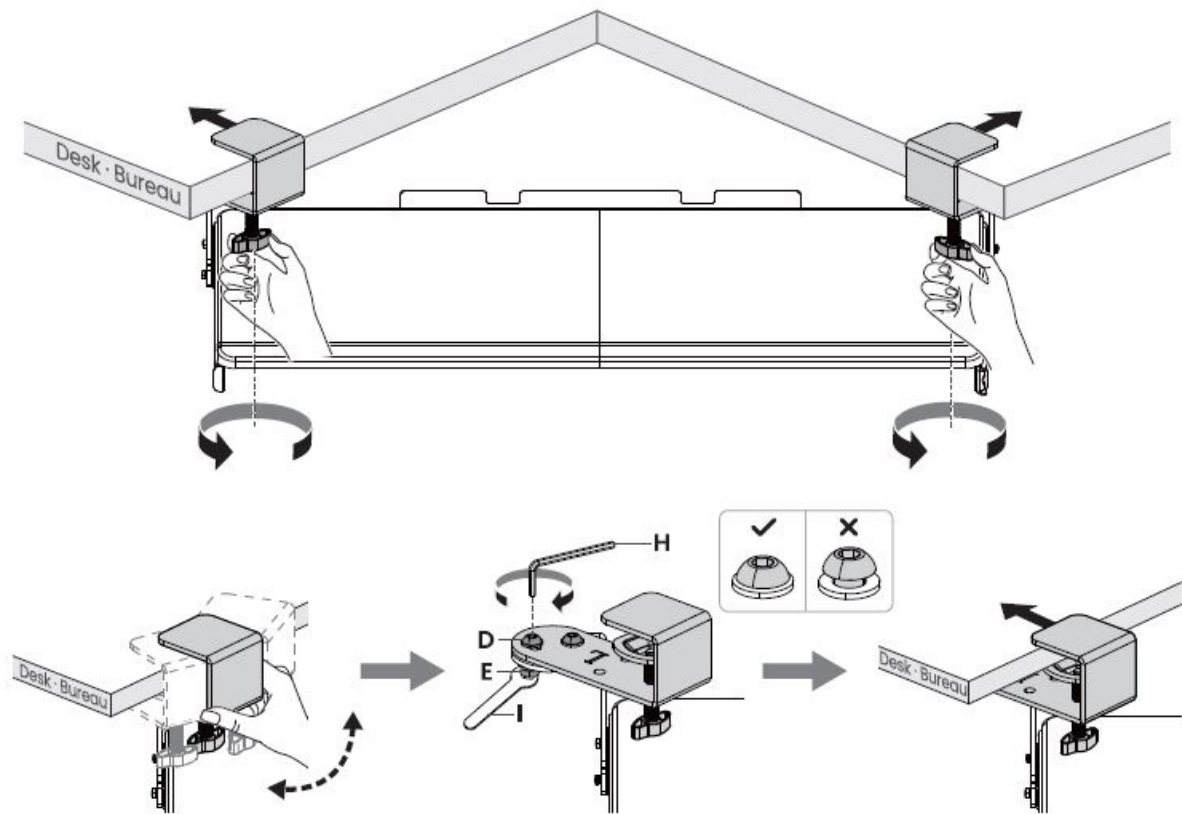

**5**

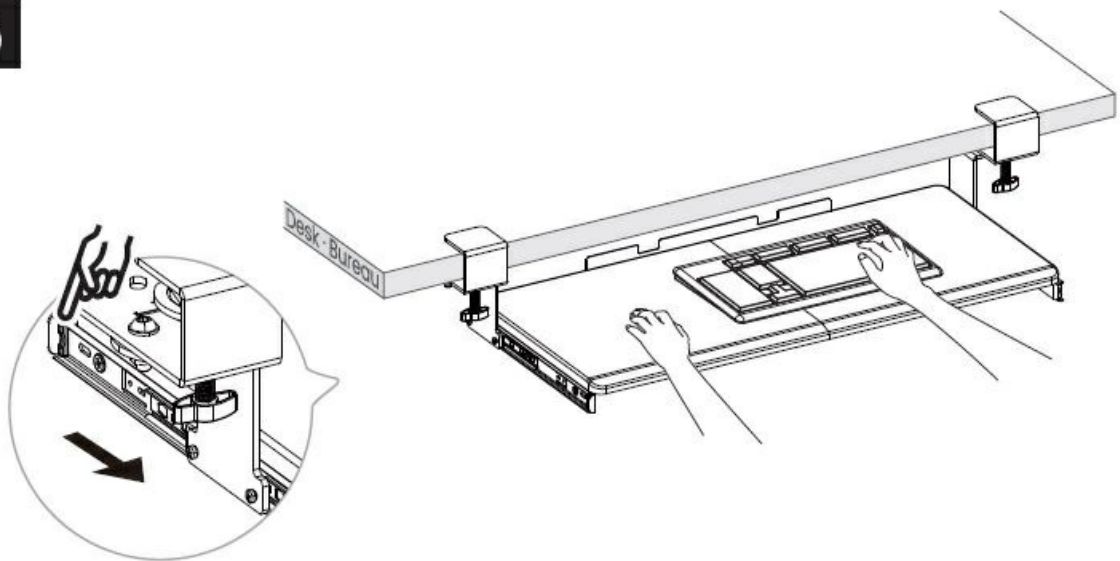

- Slide the tray in or out. The rubber detents will hold it open or closed when engaged.

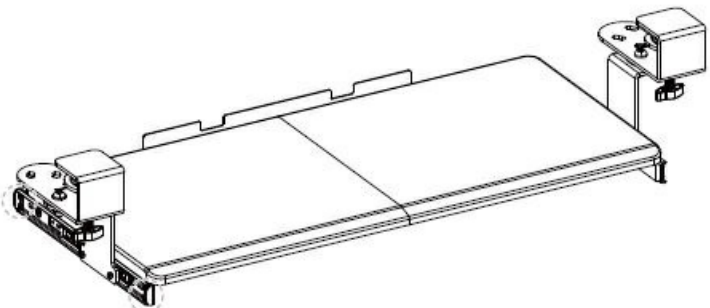

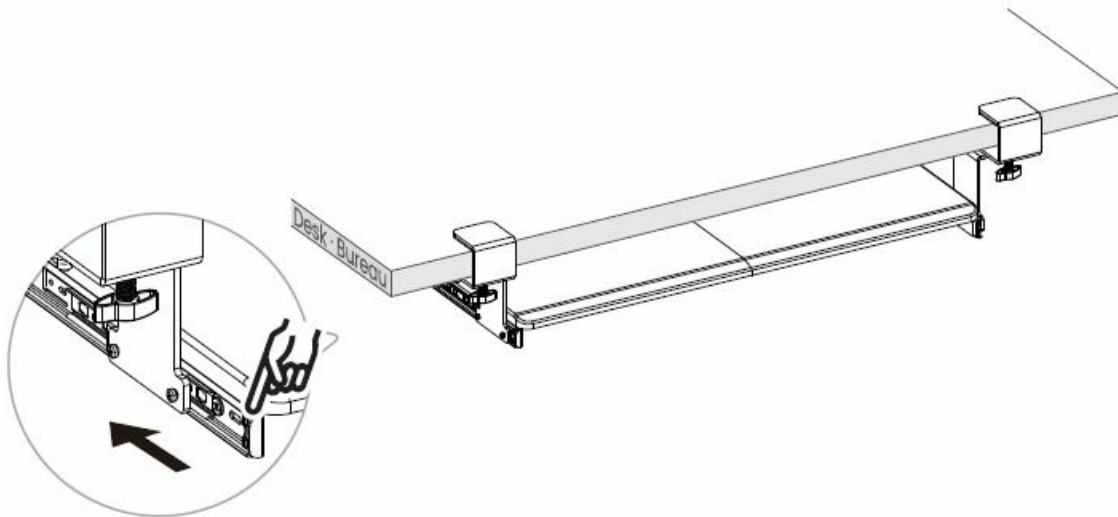

- 860-01904-00 Rev01
- 1-800-651-9525 (us/CA) Mon-Fri, 8am-8pm (CST)
- 44-808-196-3875 (UK) Mon-Fri, 2pm-10pm (UTC)
- [support@ergear.com](mailto:support@ergear.com)
- <https://ergear.com>

---

## Documents / Resources

	<p><a href="#">ErGear EGKB03 Keyboard Tray Under Desk</a> [pdf] Instruction Manual EGKB03 Keyboard Tray Under Desk, EGKB03, Keyboard Tray Under Desk, Tray Under Desk, Under Desk</p>
---	---

## References

- [User Manual](#)

### [Manuals+](#), [Privacy Policy](#)

This website is an independent publication and is neither affiliated with nor endorsed by any of the trademark owners. The "Bluetooth®" word mark and logos are registered trademarks owned by Bluetooth SIG, Inc. The "Wi-Fi®" word mark and logos are registered trademarks owned by the Wi-Fi Alliance. Any use of these marks on this website does not imply any affiliation with or endorsement.