



Epson ELPAP10 Wireless LAN Module for Projectors User's Guide

[Home](#) » [Epson](#) » Epson ELPAP10 Wireless LAN Module for Projectors User's Guide 

Contents

- [1 Epson ELPAP10 Wireless LAN Module for Projectors](#)
- [2 Precautions](#)
- [3 U.S. FCC Notices](#)
- [4 Industry Canada \(IC\) Notices](#)
- [5 Overview of Wireless Network Connections](#)
- [6 Installing](#)
 - [6.1 Project using software or applications](#)
- [7 Reading the Wireless LAN Indicator](#)
- [8 Frequently Ask Questions](#)
- [9 Related Posts](#)

EPSON

Epson ELPAP10 Wireless LAN Module for Projectors



Caution

- **This unit should only be used for Epson projectors.**

If it is installed on another device such as a computer, it may result in computer failure, damage, or malfunctions.

- **Do not disassemble or remodel this unit.**

This may result in burns.

- This unit is only for indoor use.
- To comply with RF exposure compliance requirements, a distance of at least 20 cm must be maintained at all times between the antenna of this unit and people in the vicinity.

Precautions

Notes on Handling and Storage

- Do not store in locations with high temperatures or high humidity. It may in particular be damaged or deformed if left in a vehicle with the windows shut, or placed in locations with unusually high temperatures for extended periods such as in direct sunlight.
- Do not get it wet. This may cause malfunctions to occur.
- Do not use near microwave ovens. Wireless communication may be interrupted by electromagnetic interference generated by microwave ovens.
- Do not drop it, subject it to shocks, or place heavy objects on it.

Frequency Precautions

The frequency band for this unit is 2.4 GHz. This frequency range is the same frequency bandwidth as industrial, scientific, and medical devices such as microwave ovens and mobile unit identification (RF-ID) systems (licensed premises radio stations and unlicensed specified low-power radio stations) used in factory production lines. Before using this unit, check that there are no radio stations for mobile unit identification or specified low-power radio station premises nearby. In the event that this unit should interfere electromagnetically with the premises of a radio station used for mobile unit recognition, cease use immediately and stop generating the electromagnetic field. Contact your local dealer or the nearest address provided in the “**Support and Service Guide**” supplied with the projector if this unit interferes electromagnetically with a special low-power radio station used for mobile unit identification or causes similar problems.

This document provides safety instructions and describes the specifications. Read this document carefully before use to ensure your safety and product performance.

Data transmission is always initiated by software, which is then passed down through the MAC, through the digital and analog baseband, and finally to the RF chip. Several special packets are initiated by the MAC. These are the only ways the digital baseband portion will turn on the RF transmitter, which it then turns off at the end of the packet. Therefore, the transmitter will be on only while one of the aforementioned packets is being transmitted. In other words, this device automatically discontinues transmission in case of either absence of information to transmit or operational failure. This equipment is restricted to indoor operation only.

U.S. FCC Notices

This device complies with Part 15 of the FCC Rules. Operation is subject to the following two conditions:

1. This device may not cause harmful interference, and

2. this device must accept any interference received, including interference that may cause undesired operation.

This equipment has been tested and found to comply with the limits for a Class B digital device, pursuant to Part 15 of the FCC Rules. These limits are designed to provide reasonable protection against harmful interference in a residential installation. This equipment generates, uses, and can radiate radio frequency energy and, if not installed and used in accordance with the instructions, may cause harmful interference to radio communications. However, there is no guarantee that interference will not occur in a particular installation. If this equipment does cause harmful interference to radio or television reception, which can be determined by turning the equipment off and on, the user is encouraged to try to correct the interference by one of the following measures:

- Reorient or relocate the receiving antenna.
- Increase the separation between the equipment and the receiver.
- Connect the equipment to an outlet on a circuit different from that to which the receiver is connected.
- Consult the dealer or an experienced radio/TV technician for help.

Caution: Changes or modifications not expressly approved by the party responsible for compliance could void the user's authority to operate this equipment. Properly shielded and grounded cables and connectors must be used for connection to host computers and/or peripherals in order to meet FCC emission limits. This transmitter must not be co-located or operating in conjunction with any other antenna or transmitter. This equipment complies with FCC radiation exposure limits set forth for an uncontrolled environment and meets the FCC radio frequency (RF) Exposure Guidelines. This equipment should be installed and operated keeping the radiator at least 7.8 inches (20 cm) or more away from the person's body

Industry Canada (IC) Notices

CAN ICES-3(B)/NMB-3(B)

This device complies with Industry Canada's license-exempt RSSs. Operation is subject to the following two conditions: (1) This device may not cause harmful interference, and (2) this device must accept any interference, including interference that may cause undesired operation. This equipment complies with IC radiation exposure limits set forth for an uncontrolled environment and meets RSS-102 of the IC radio frequency (RF) Exposure rules. This equipment should be installed and operated keeping the radiator at least 7.8 inches (20 cm) or more away from the person's body.

Overview of Wireless Network Connections

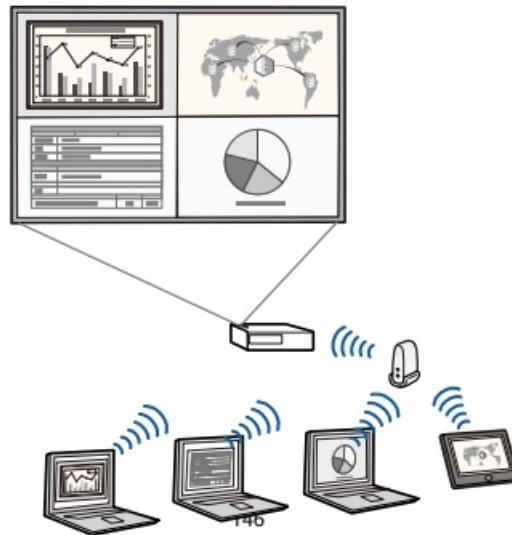
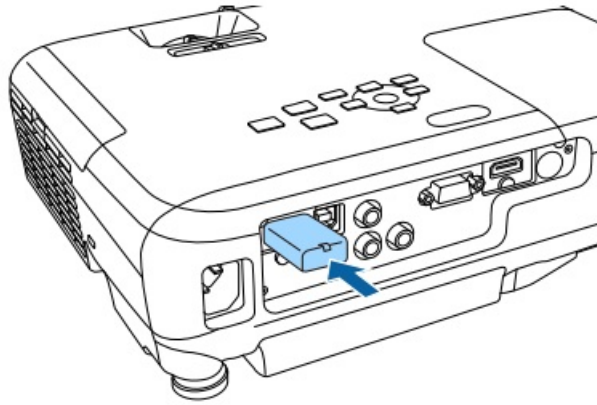

This wireless LAN unit allows the projector to communicate wirelessly with other devices. When you connect this unit to the projector, you can project the screen of a computer with a built-in wireless LAN feature, or the content of smartphones and tablet devices wirelessly over a network. There are two connection modes available depending on your network environment.

Quick connection mode

Connects the device directly to the projector without using a Local Area Network (LAN). While using Quick Connection mode, you cannot connect the device to any access points other than this unit.

Advanced connection mode

Connects the device to the projector using a wireless LAN access point.

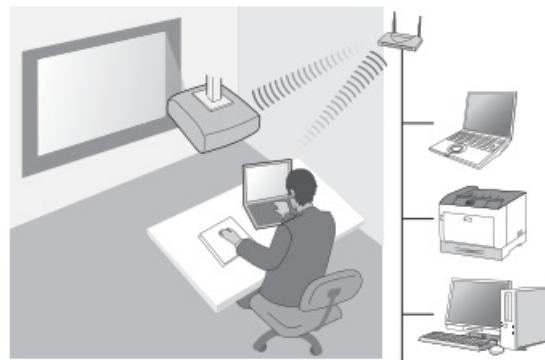

Software and applications for wireless connection

You can project the screens or content of connected devices using one of the following software items or applications.

- **EasyMP Multi PC Projection (Windows/OS X)**

- Projects screens from up to four computers simultaneously in separate projected panels.
- You can install this software from the supplied EPSON Projector Software CD-ROM or the Epson Web site.

- **EasyMP Network Projection (Windows/OS X)**

- Projects the screen from one computer connected to the projector over a network.
- You can install this software from the supplied EPSON Projector Software CD-ROM or the Epson Web site.

- **Epson iProjection (iOS/Android)**

- Projects the content of a smartphone or tablet device.
- You can download this app from the App Store or Google Play.

- **Quick Wireless Connection USB Key (Windows)**

- Projects the computer's screen by simply connecting this key.
- You can purchase the key from the Epson Web site or your local dealer.

Installing

Install the wireless LAN unit

Install this unit to the projector's wireless LAN unit installation section or the USB-A port. The installation position differs depending on the projector. See the "User's Guide" supplied with the projector for more details.

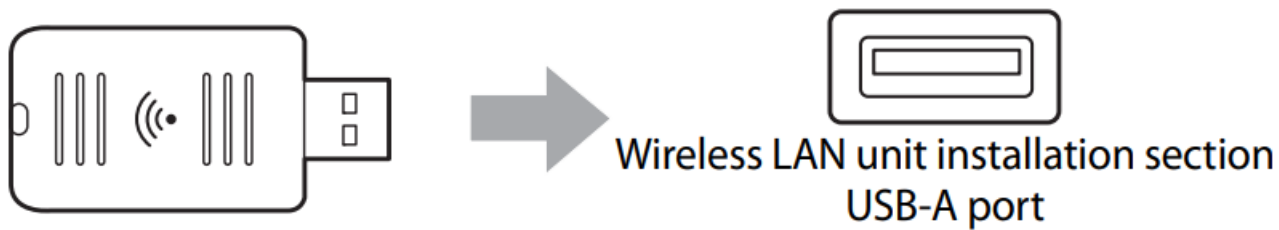

Make network settings for the projector

Press the [Menu] button on the remote control or the control panel, and then set up the Network menu items. The setting names and content differ depending on the projector. See the “**User’s Guide**” supplied with the projector for more details.

Setting Item	Content
Wireless Mode	Enable wireless LAN.
Connection Mode	Select Quick *1 or Advanced depending on the connection method.
SSID Auto Setting (Quick connection mode only)	To assign an SSID automatically to speed up the search for a projector, select On *2. To set the SSID and passphrase manually, select Off .
Search Access Point (Advanced connection mode only)	Search for available access points, and select the SSID you want to connect to. When using models that do not have the Search Access Point function, or if you want to specify the access point manually, set an SSID and passphrase.

1. This setting may not be available on all versions of the software or the application.
2. When SSID Auto Setting is set to On, the Passphrase is set automatically to the projector that is functioning as a simple access point (for supported models only). Change the Passphrase to use Epson iProjection or to enhance the connection security.

Project using software or applications

Preparing to connect





- Press the [LAN] button on the remote control to display Network information (the LAN standby screen).
- Connect the device to the same network as the projector. (You do not need to do this when connecting a computer using Quick Connection mode.)

Operating the software

1. Search for the projector using software or applications.
2. Select the projector you want to connect to.
3. Select Connect or Join.
4. When prompted, enter the keyword currently displayed on the LAN standby screen.

The operations differ depending on the software or application. See the operation guide for each software or the explanation on the App Store, or Google Play for more details.

Reading the Wireless LAN Indicator

Indicator	Status
 Off	This unit is not installed in the projector. Or wireless LAN is disabled in the projector's Network menu.
 Blue	This unit is installed in the projector and connections are available.
 Blue (Flashing quickly)	This unit is installed in the projector and is connecting to a device.
 Blue (Flashing slowly)	An error has occurred. Turn off the projector, reinstall this unit, and then turn on the projector.

For the specification of this unit, see “Specifications” at the end of this guide.

Frequently Ask Questions

What is the wireless LAN unit in the Epson projector?

This high-speed, wireless network adapter plugs directly into select Epson projectors allowing quick and easy access to the LAN or peer-to-peer networks without wires or cables.

What do I need to make my projector wireless?

Most wireless projectors on the market use a transmitter and receiver system. A transmitter, such as a USB stick or dongle, is plugged into your computer (or other source device) and the projector has a built-in WiFi chip to act as a receiver.

What is the Epson ELPAP10 Wireless LAN Module for Projectors?

The Epson ELPAP10 Wireless LAN Module is a wireless network adapter that allows compatible Epson projectors to connect to a wireless network.

What are the benefits of using the Epson ELPAP10 Wireless LAN Module?

The Epson ELPAP10 Wireless LAN Module allows for convenient wireless projection from multiple devices without the need for cords or cables. It also enables remote control and monitoring of the projector from a computer or mobile device.

Which Epson projectors are compatible with the ELPAP10 Wireless LAN Module?

The ELPAP10 Wireless LAN Module is compatible with a wide range of Epson projectors, including the PowerLite, BrightLink, and Pro series projectors.

How do I install the ELPAP10 Wireless LAN Module?

To install the ELPAP10 Wireless LAN Module, simply insert it into the USB port on the back of your compatible Epson projector. The projector will automatically recognize the module and prompt you to complete the setup process.

What is the range of the ELPAP10 Wireless LAN Module?

The range of the ELPAP10 Wireless LAN Module depends on the wireless network it is connected to. It can typically reach a range of up to 100 feet indoors and up to 300 feet outdoors.

What security features are included with the ELPAP10 Wireless LAN Module?

The ELPAP10 Wireless LAN Module supports a range of security protocols, including WPA-PSK, WPA-EAP, and WPA2-PSK, to help ensure secure wireless communication.

Can multiple projectors use the ELPAP10 Wireless LAN Module simultaneously?

Yes, multiple projectors can use the ELPAP10 Wireless LAN Module simultaneously, as long as they are connected to the same wireless network.

Can the ELPAP10 Wireless LAN Module be used with non-Epson projectors?

No, the ELPAP10 Wireless LAN Module is specifically designed for use with compatible Epson projectors and may not work with non-Epson projectors.

Can I use the ELPAP10 Wireless LAN Module to stream video or audio wirelessly?

Yes, the ELPAP10 Wireless LAN Module allows for wireless projection of both video and audio content from compatible devices.

Is the ELPAP10 Wireless LAN Module easy to set up and use?

Yes, the ELPAP10 Wireless LAN Module is designed to be easy to set up and use, with intuitive on-screen prompts and straightforward network configuration options.

Download this PDF Link: [Epson ELPAP10 Wireless LAN Module for Projectors User's Guide](#)