

# EPSON DS-530 II Color Duplex Document Scanner User Guide

[Home](#) » [Epson](#) » EPSON DS-530 II Color Duplex Document Scanner User Guide 

## EPSON DS-530 II Color Duplex Document Scanner

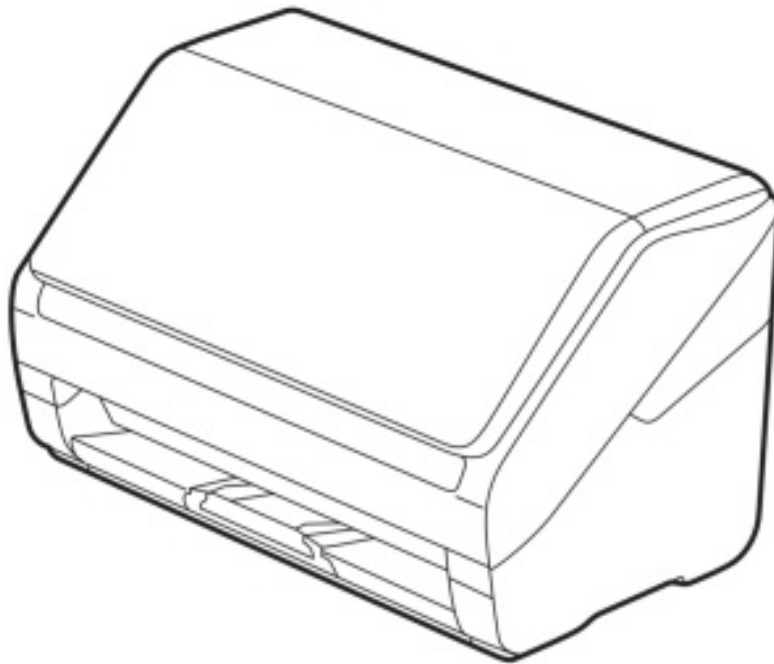

## Contents

- 1 Package Content
- 2 Remove The Packing
- 3 Turn On The Scanner
- 4 Install Software
- 5 Scan A Document
- 6 Scan From A Mobile Device (DS-575W II)
- 7 Scan From A Computer
- 8 Troubleshooting Wi-Fi Setup(DS-575W II)
- 9 Help
  - 9.1 Scanner software help
  - 9.2 User's Guide
  - 9.3 Epson technical support
- 10 Documents / Resources
  - 10.1 References
- 11 Related Posts

## Package Content

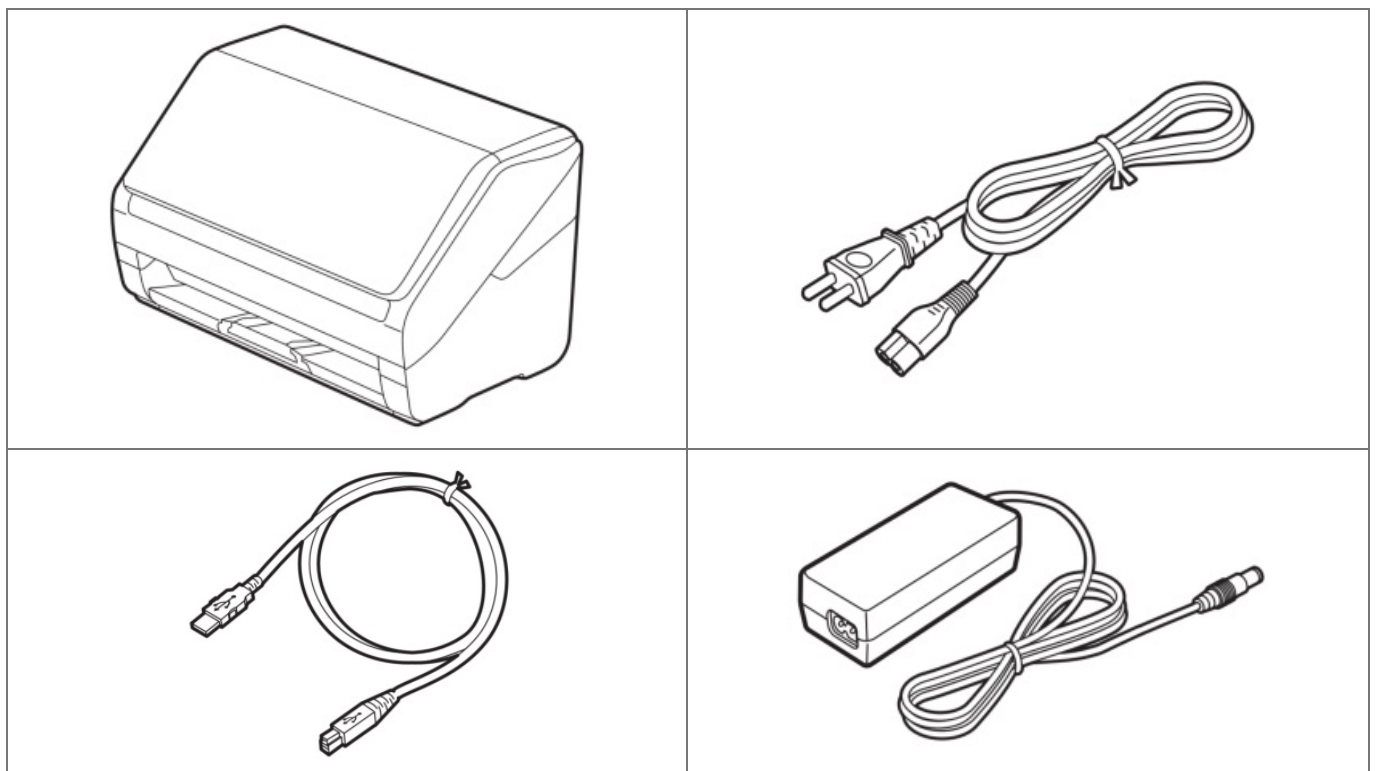

**Note:** Do not connect the USB cable until instructed to do so.

## Remove The Packing

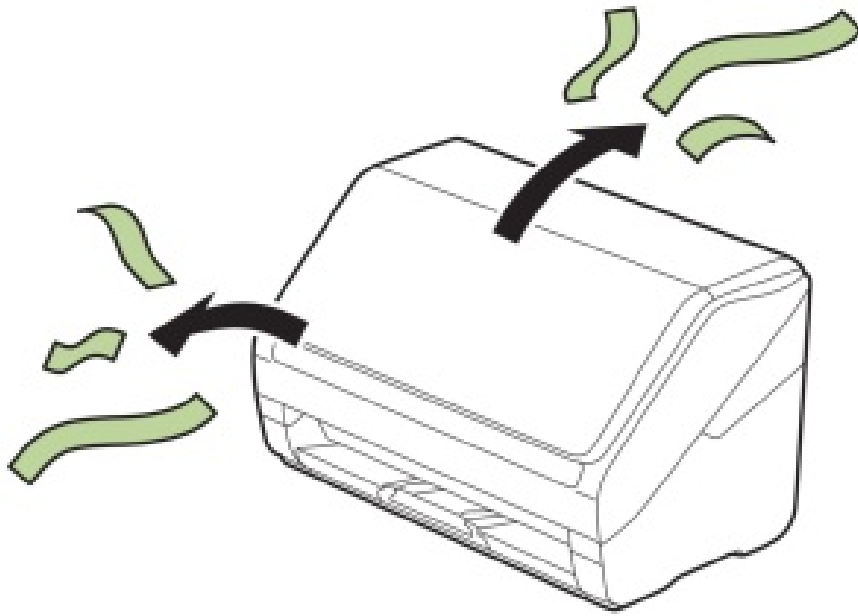

Turn On The Scanner

1

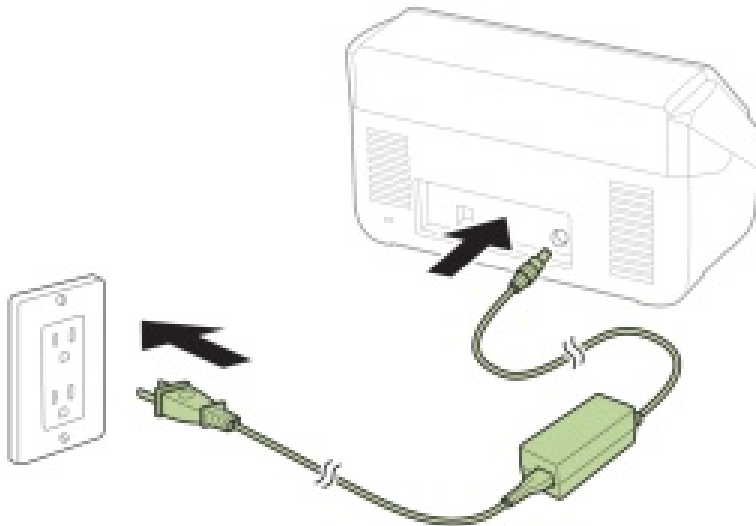

2



Press the  power button.

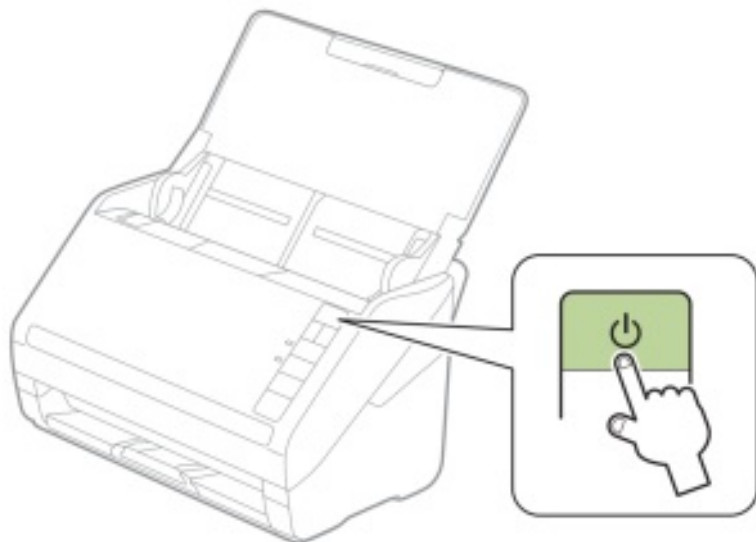

## Install Software

**Note:** An internet connection is required to obtain the product software

1. Visit Epson's support site listed below for your model

- DS-530 II (U.S./É.-U.)

[www.epson.com/support/ds530II](http://www.epson.com/support/ds530II)

DS-530 II (Canada)

[www.epson.ca/support/ds530II](http://www.epson.ca/support/ds530II)

- DS-575W II (U.S./É.-U.)

[www.epson.com/support/ds575wII](http://www.epson.com/support/ds575wII)

DS-575W II (Canada)

[www.epson.ca/support/ds575wII](http://www.epson.ca/support/ds575wII)

- DS-770 II (U.S./É.-U.)

[www.epson.com/support/ds770II](http://www.epson.com/support/ds770II)

DS-770 II (Canada)

[www.epson.ca/support/ds770II](http://www.epson.ca/support/ds770II)

2. Click **Download** for the Drivers and Utilities Combo Package.

3. Double-click the file you downloaded to install the software. Follow the on-screen instructions to set up the connection.



## Scan A Document

**Note:** To scan using the  start button, you must connect the scanner to a computer with Document Capture Pro (Windows®) or Document Capture (Mac) installed.

1

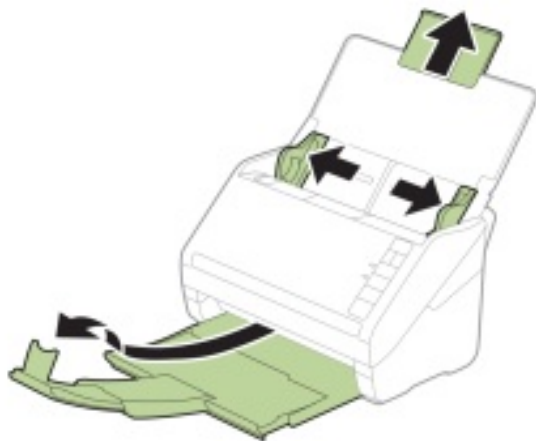

Load the document facedown, short edge first.

2

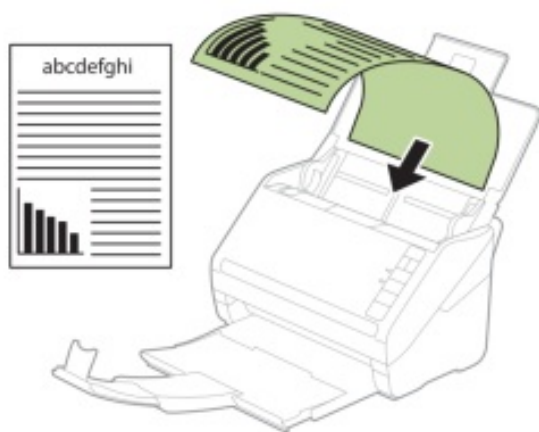

3

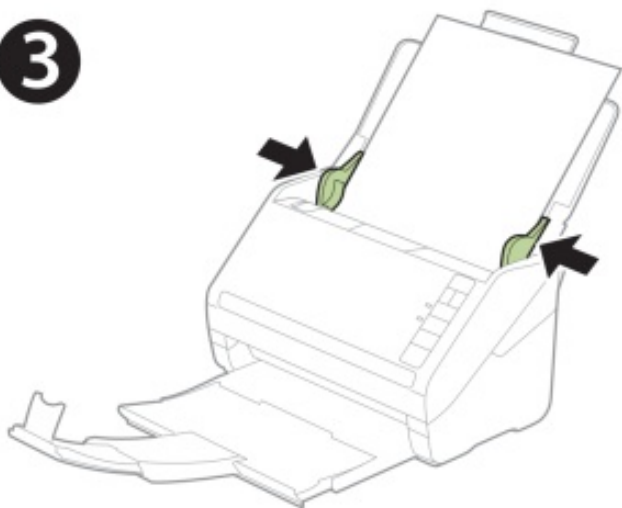

Press the  start button.

Document Capture Pro (Windows) or Document Capture (Mac) starts automatically and your document is scanned.

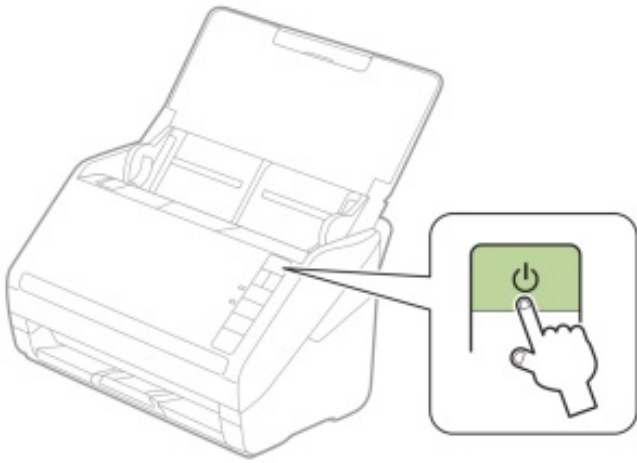

**Note:** For detailed information on loading and scanning originals, see the online User's Guide.



### Scan From A Mobile Device (DS-575W II)



To scan from an iOS or Android™ device, download and install the free Epson Smart Panel app from the App Store or Google Play™.



### Scan From A Computer

You can also scan from your computer with Document Capture Pro (Windows) or Document Capture (Mac).

**Windows 10:** Click  > **Epson Software** > **Document Capture Pro**.

**Windows 8.x:** Navigate to the **Apps** screen and select **Document Capture Pro**.

**Windows 7:** Click  > **All Programs** > **Epson Software** > **Document Capture Pro**.

**Mac:** Select **Applications** > **Epson Software** > **Document Capture**.

For more information about scanning from a computer and creating custom scan jobs with Document Capture Pro (Windows) or Document Capture (Mac), click the Help or ? button in the scanner software or see the online *User's Guide*.



### Troubleshooting Wi-Fi Setup(DS-575W II)

- Your network name (SSID) and password are case sensitive. Make sure you enter uppercase and lowercase letters correctly.

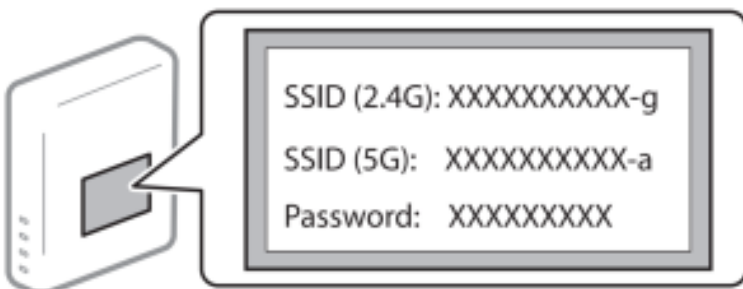

- If the scanner did not connect automatically and you are connecting it to the network manually, make sure you select the same network that the computer is connected to.
- The scanner can only connect to a network that supports 2.4 GHz connections. If your router offers both 2.4 GHz and 5 GHz connections, make sure the 2.4 GHz band is enabled and you are connecting to it.

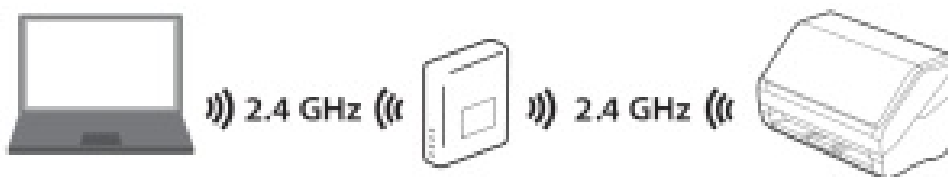

- If your computer is connected to the 5 GHz band, connect it to the 2.4 GHz band for scanner setup. This will allow the scanner to automatically connect to the network when you repeat the software installation process.
- Turn your router off and on again, then repeat the software installation process.



#### Scanner software help

Click the Help or ? button on your software screen.

#### User's Guide

Double-click the Epson DS Series User's Guide icon on your desktop (or in the Applications/Epson Software/Guide folder on a Mac).

#### Epson technical support

#### Internet support

Visit [www.epson.com/support](http://www.epson.com/support) (U.S.) or [www.epson.ca/support](http://www.epson.ca/support) (Canada) and search for your product to download software and utilities, view manuals, get FAQs and troubleshooting advice, or contact Epson.

#### Speak to a support representative

Call (562) 276-4300 (U.S.) or (905) 709-3839 (Canada), 6 am to 8 pm, Pacific Time, Monday through Friday, and 7 am to 4 pm, Pacific Time, Saturday.

Days and hours of support are subject to change without prior notice. Toll or long distance charges may apply



*EPSON is a registered trademark and EPSON Exceed Your Vision is a registered logomark of Seiko Epson Corporation.*

*Windows is a registered trademark of Microsoft Corporation in the United States and/or other countries.*

*Mac is a trademark of Apple Inc., registered in the U.S. and other countries. App Store is a service mark of Apple Inc.*

*Android and Google Play are trademarks of Google LLC.*

*General Notice: Other product names used herein are for identification purposes only and may be trademarks of*

their respective owners. Epson disclaims any and all rights in those marks.  
This information is subject to change without notice.



CPD-59607

© 2020 Epson America, Inc., 7/20

## Documents / Resources



[EPSON DS-530 II Color Duplex Document Scanner](#) [pdf] User Guide

DS-530 II, DS-575W II, DS-770 II, DS-530 II Color Duplex Document Scanner, Color Duplex Document Scanner, Document Scanner, Scanner

## References

- [E Epson® Official Support](#)
- [E Epson DS-530 II | DS Series | Scanners | Support | Epson Canada](#)
- [E Epson DS-575W II | DS Series | Scanners | Support | Epson Canada](#)
- [E Epson DS-770 II | DS Series | Scanners | Support | Epson Canada](#)
- [E Epson® Official Support](#)
- [E Epson DS-530 II | DS Series | Scanners | Support | Epson US](#)
- [E Epson DS-575W II | DS Series | Scanners | Support | Epson US](#)
- [E Epson DS-770 II | DS Series | Scanners | Support | Epson US](#)

[Manuals+](#)