



EPSON 97H 3LCD Projector User Guide

[Home](#) » [Epson](#) » EPSON 97H 3LCD Projector User Guide 

Contents

- 1 EPSON 97H 3LCD Projector
- 2 Product Information
- 3 Product Usage Instructions
- 4 Quick Setup
- 5 Connect the projector
- 6 Turn on your equipment
- 7 Adjust the image
- 8 Using the remote control
- 9 Project wirelessly
- 10 A project over a wired network
- 11 Install network software
- 12 Troubleshooting
- 13 Where to get help
- 14 Optional accessories
- 15 Documents / Resources
 - 15.1 References
- 16 Related Posts

EPSON®

EPSON 97H 3LCD Projector



Product Information

Specifications:

- Supported Connections: Computer, USB, HDMI, VGA, Audio
- Additional Functions: PC Free feature, MHLTM standard support
- Supported Devices: Digital Cameras, USB Flash Drives, USB Storage Devices, Epson DC-06 Document Camera, Tablets, Smartphones
- Supported Operating Systems: OS X 10.5.8 or higher
- Supported Network Connection: Ethernet
- Additional Accessories: External Monitor, External Speakers, Microphone

Product Usage Instructions

Connecting the Projector:

Follow the instructions below to connect the projector to various devices:

Computer Connection:

- Connect the projector to your computer using one of the following cables: USB cable, HDMI cable, VGA cable, or Audio cable.
- Refer to the online User's Guide for detailed instructions on each type of connection.

Camera, USB device, or Epson DC-06 document camera Connection:

- Connect a digital camera, USB flash drive, USB storage device, or Epson DC-06 document camera to the projector's USB-A (flat) port.
- Use a USB cable for the connection.
- If you connect a digital camera, USB flash drive, or USB storage device, you can use the projector's PC Free feature.
- Refer to the online User's Guide for detailed instructions on connecting and using different devices.

Mobile Media Device Connection:

- Connect tablets, smartphones, and other devices that support the MHLTM standard to the HDMI2/MHL port.
- Use an MHL cable for the connection.
- Not all features or functions may be supported. Check your device's documentation for more information.

Computer Port Connection:

- Connect one end of a VGA cable to the projector's Computer1 or Computer2 port, and the other end to your computer's monitor port.
- If you are using a laptop, switch it to an external display (see Troubleshooting).
- You can also connect an audio cable for audio output.

HDMI Port Connection:

- Connect one end of an HDMI cable to the projector's HDMI1 or HDMI2 port and the other end to an HDMI port on your computer.

Wired Network Connection:

- You can connect the projector to your network using an Ethernet cable.

External Monitor, External Speakers, and Microphone Connection:

- You can also connect an external monitor, external speakers, or a microphone to your projector to enhance your presentations.
- Refer to the online User's Guide for detailed instructions on connecting these devices.

Turning on the Equipment:

1. Turn on your computer or video source.
2. Plug in the projector. The power light on the projector turns blue.
3. Refer to the "Project over a wired network" section for further instructions if applicable.

Using the Remote Control:

Follow the instructions below to use the remote control:

- Make sure the batteries are installed correctly (two AA batteries).
- To shut down the projector, press the power button twice, then unplug it. You don't have to wait for the projector to cool down.
- The default language of the menu system is English. To select another language:
 1. Press the Menu button on the projector or remote control.
 2. Select "Extended" and press <Enter>.
 3. Select "Language" and press <Enter>.
 4. Select your language and press <Enter>.
 5. Press the Menu button to exit the menu system.

FAQ

- Q: Can I connect multiple video devices to the projector?
A: Yes, you can connect multiple video devices and use the Source Search button on the projector or remote control to switch between them. Supported cables for video devices include S-Videocable, RCA video cable, HDMI cable, Component video to VGA cable, and Audio cable.
- Q: How do I install the Epson USB Display software on my Mac?
A: If you are using OS X 10.5.8 or higher, follow these steps:
 - After turning on the projector, the setup folder for the USB Display appears in the Finder.
 - Double-click the USB Display Installer and follow the on-screen instructions to install the Epson USB Display software (only on first connection).

Quick Setup

Before using the projector, make sure you read the safety instructions in the online User's Guide.

Connect the projector

- Choose from the following connections. See the sections below or the online User's Guide for details.

Computer

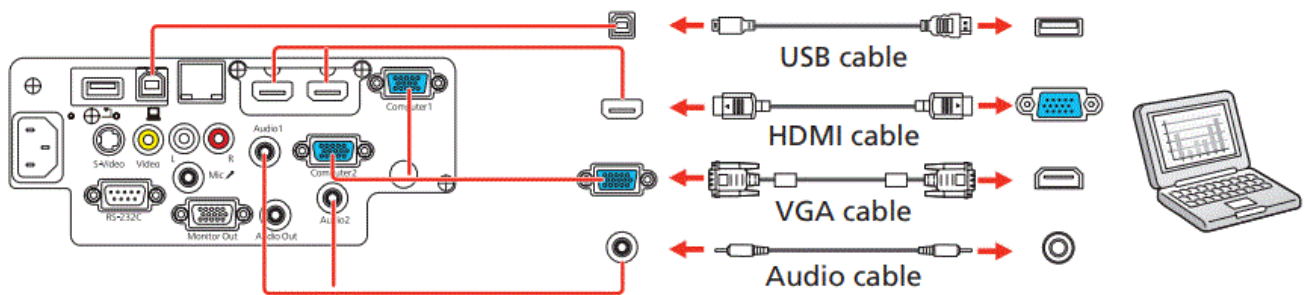

USB port

- Connect the square end of a USB cable to the projector's USB-B (square) port. Connect the flat end of the cable to any USB port on your computer. Windows® XP or later: After turning on the projector, follow the on-screen instructions to install the Epson® USB Display software (EMP_UDSE.EXE; only on the first connection). If the software screen does not display automatically, open My Computer or Computer, then double-click
- EPSON_PJ_UD. OS X 10.5.8 or higher: After turning on the projector, the setup folder for USB Display appears in the Finder. Double-click the USB Display Installer and follow the on-screen instructions to install the Epson USB Display software (only on the first connection).

Computer port

- Connect one end of a VGA cable to the projector's Computer1 or Computer2 port, and the other end to your computer's  monitor port. If you are using a laptop, switch it to an external display (see "Troubleshooting"). You can also connect an audio cable.

HDMI port

- Connect one end of an HDMI cable to the projector's HDMI1 or HDMI2 port and the other end to an HDMI port on your computer.

Wired network

- You can connect the projector to your network using an Ethernet cable.

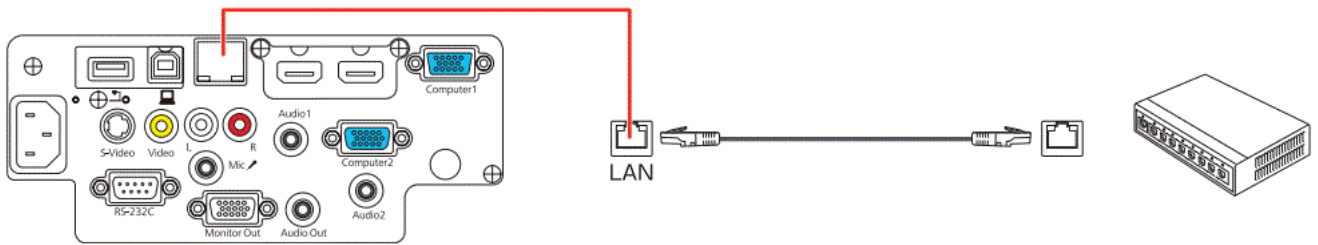

- See “Project over a wired network” for instructions.

Video device

- Connect multiple video devices and use the Source Search button on the projector or remote control to switch between them.

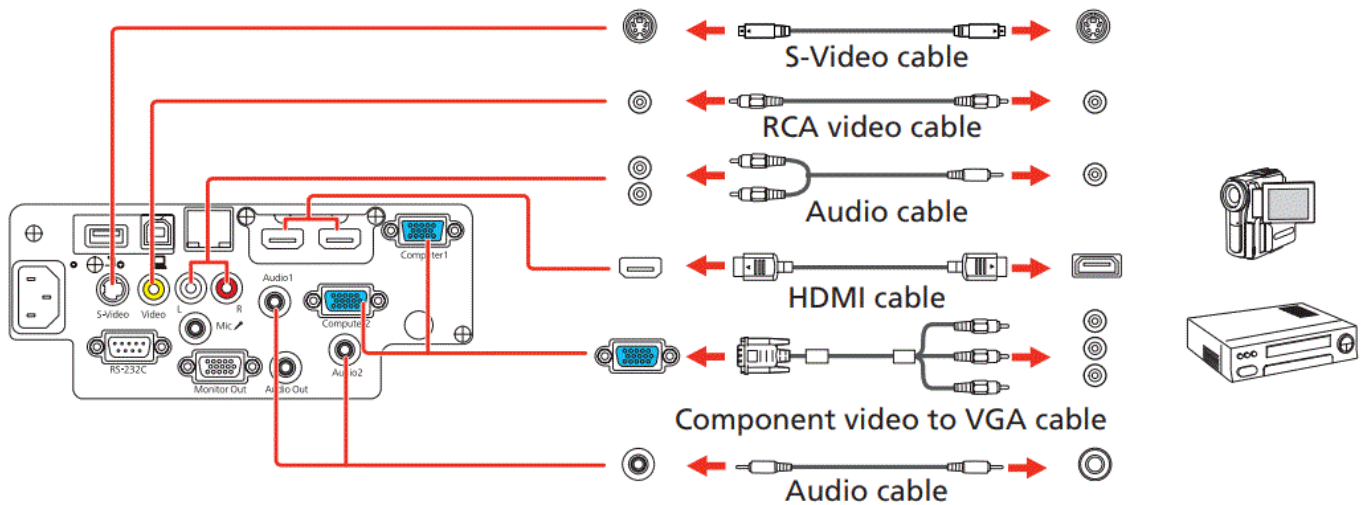

Camera, USB device, or Epson DC-06 document camera

- Connect a digital camera, USB flash drive, USB storage device, or Epson DC-06 document camera to the projector's USB-A (flat) port.

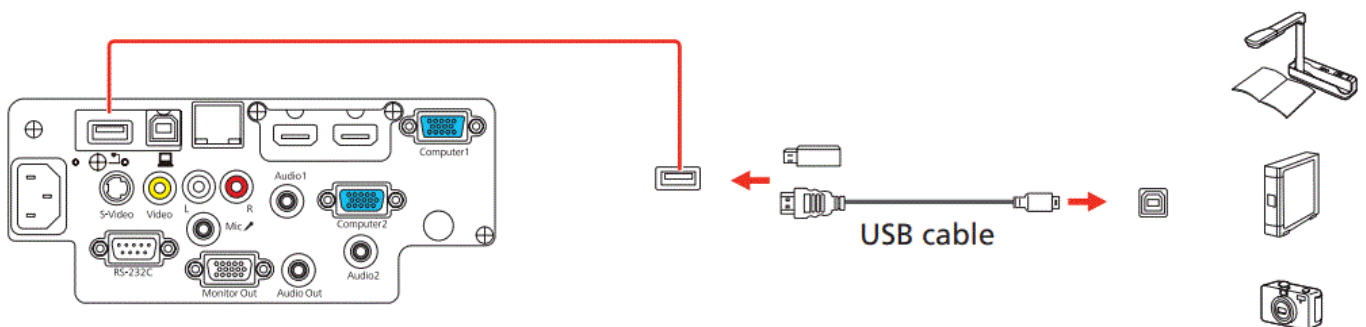

- If you connect a digital camera, USB flash drive, or USB storage device, you can use the projector's PC-free feature. You can also connect other Epson document cameras to the projector. See the online User's Guide for details.

Mobile media device

Connect tablets, smartphones, and other devices that support the MHL™ standard to the HDMI2/MHL port.

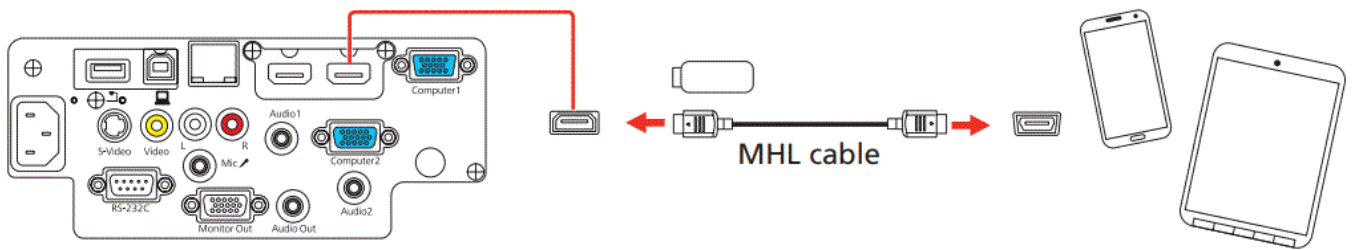

Some devices may require an adapter or may not require an MHL cable. Not all features or functions may be supported. Check your device's documentation for more information.

External monitor, external speakers, and microphone

You can also connect an external monitor, external speakers, or a microphone to your projector to enhance your presentations. See the online User's Guide for details.

Turn on your equipment

1. Turn on your computer or video source.
2. Plug in the projector. The  power light on the projector turns blue.

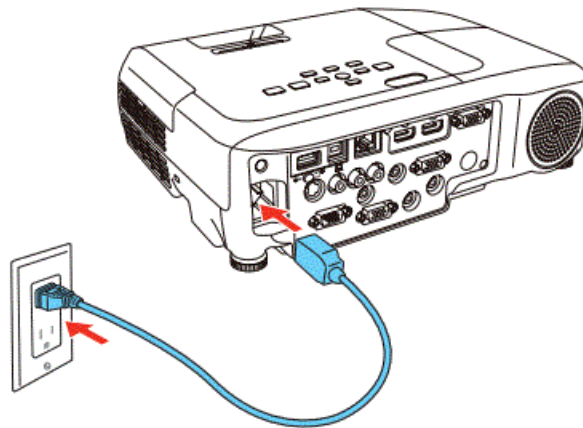



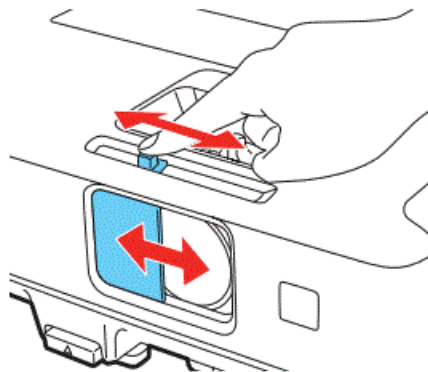

3. Open the A/V Mute slide all the way.

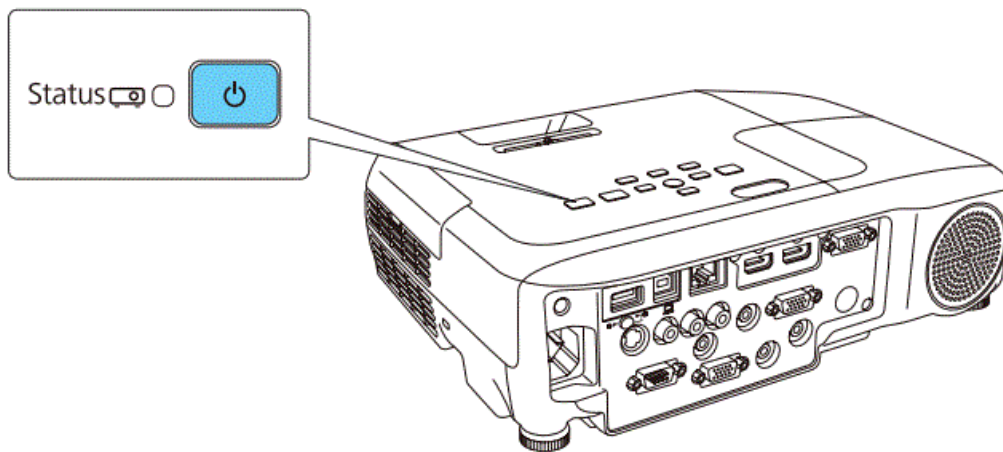

4. Press the  power button on the projector or remote control. The projector beeps, and the Status light flashes blue and then stays on.



Note: To shut down the projector, press the  power button twice, then unplug it. You don't have to wait for the projector to cool down.

- The default language of the menu system is English. To select another language, press the Menu button on the projector or remote control. Select Extended and press . Select Language and press . Select your language and press . Press the Menu button to exit the menu system.

Adjust the image

- If you don't see an image, press the Source Search button on the projector or the remote control to select the image source.

Note: If you still see a blank screen or have other display problems, see the troubleshooting tips on the back of this sheet.

- To raise the image, press the foot release button and lift the front of the projector. Release the button to lock the foot in position.

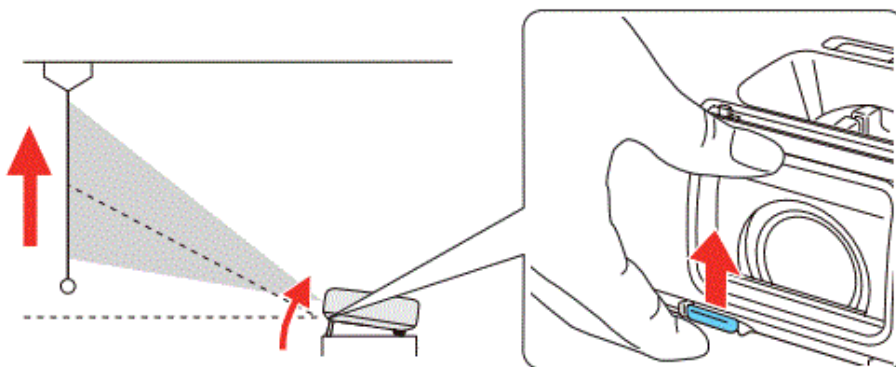

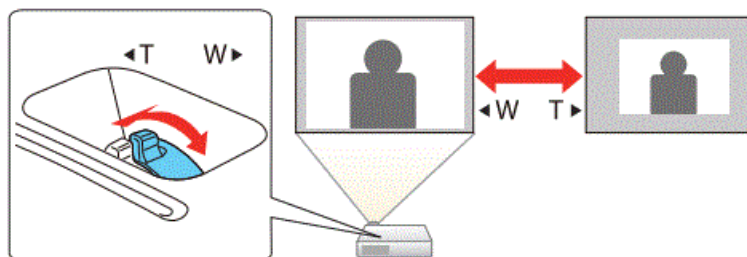

- Turn the zoom ring to enlarge or reduce the image.



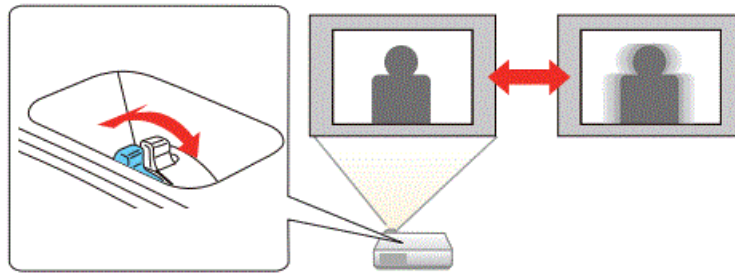



- Turn the focus ring to sharpen the image.

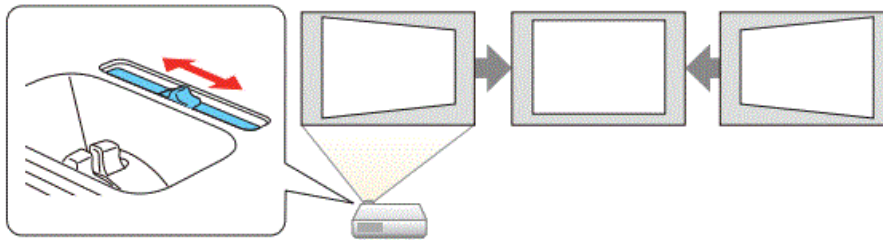

5. If your image looks like  or , you may have placed the projector off to one side of the screen at an angle. Place the projector directly in front of the center of the screen, facing the screen squarely. If you can't move the projector, use the horizontal keystone slider to correct the image.



6. Your projector automatically adjusts images that look like  or , but if necessary you can press the  or  button on the projector to correct it.

Using the remote control

Make sure the batteries are installed as shown (two AA batteries)

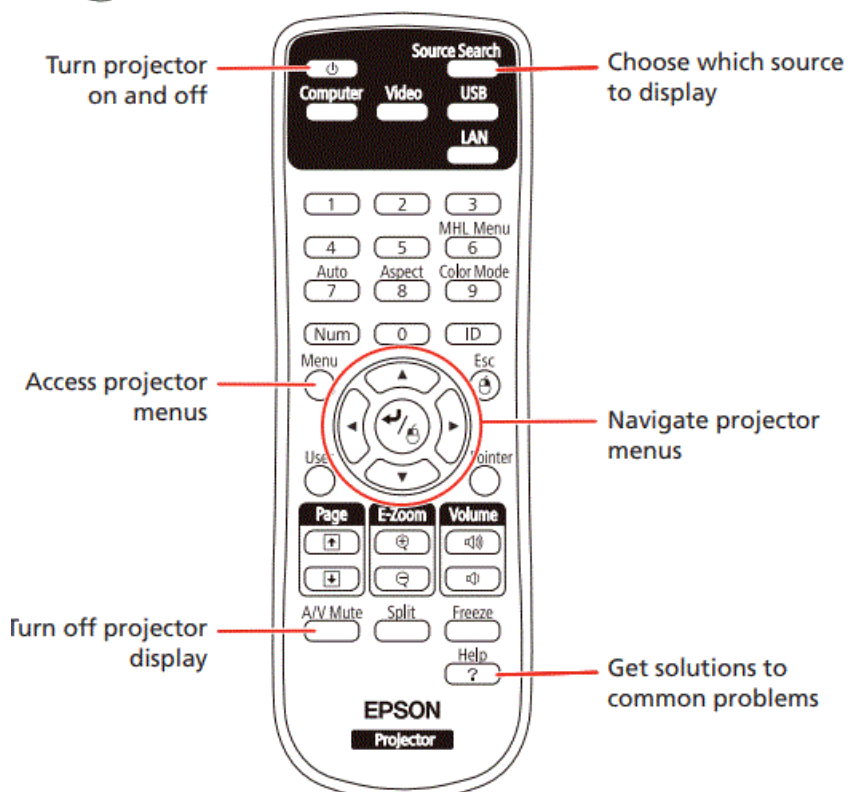
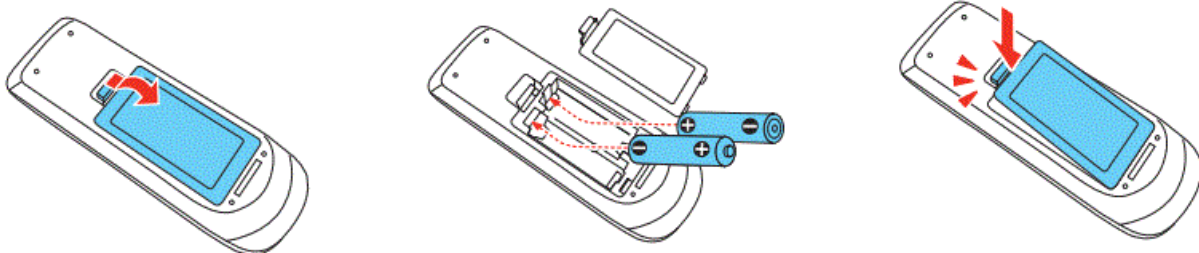

- For more information on using the remote control, see the online User's Guide.

Project wirelessly

Follow the steps here to connect the projector over a wireless network. You will need the optional wireless LAN module (part number V12H418P12).

1. To install the wireless LAN module, first remove the screw as shown.

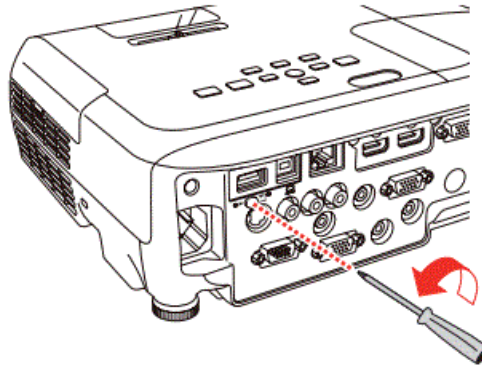

2. Connect the wireless LAN module to the USB-A (flat) port.

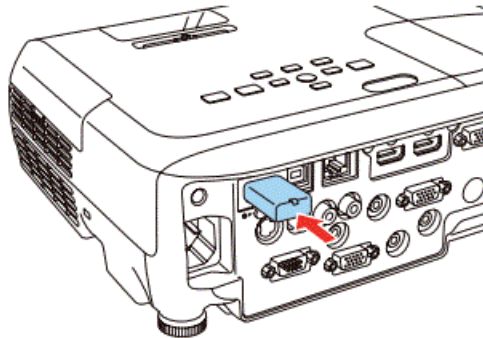

3. To configure your projector for wireless projection, do one of the following:
 - If you're using the optional Quick Wireless Connection USB key (Windows only, part number V12H005M09), press the LAN button on the remote control. When you see SSID and IP address information on the screen, remove the wireless LAN module and connect the key to the projector's USB-A port. Look for the displayed message, remove the key, and connect it to a USB port on your computer. Follow the on-screen instructions to install the driver, then reconnect the wireless LAN module to the projector's USB-A port. For details, see the online User's Guide.
 - If you're not using the key, continue with the steps on the next page.
4. Attach the wireless LAN module cover and secure it using the screw you removed.

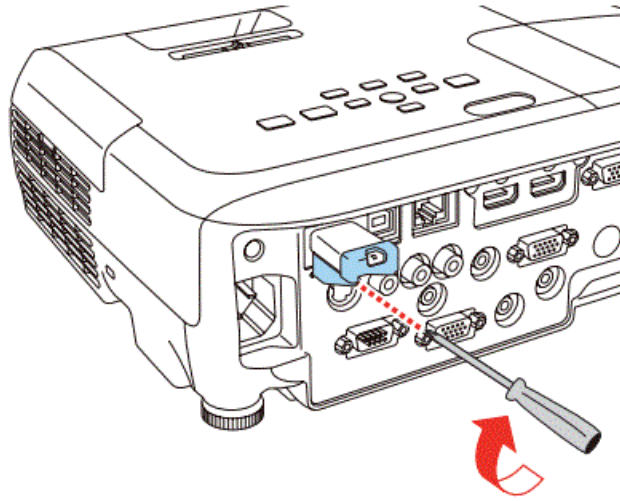

5. Press the Menu button on the remote control, select the Network menu, and press

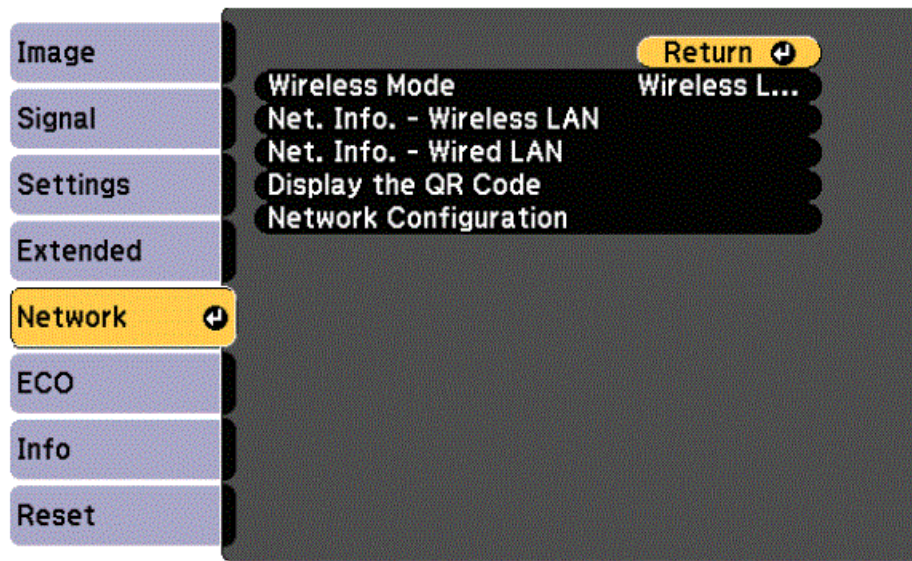

6. Choose Network Configuration and press

7. Select the Wireless LAN menu and press

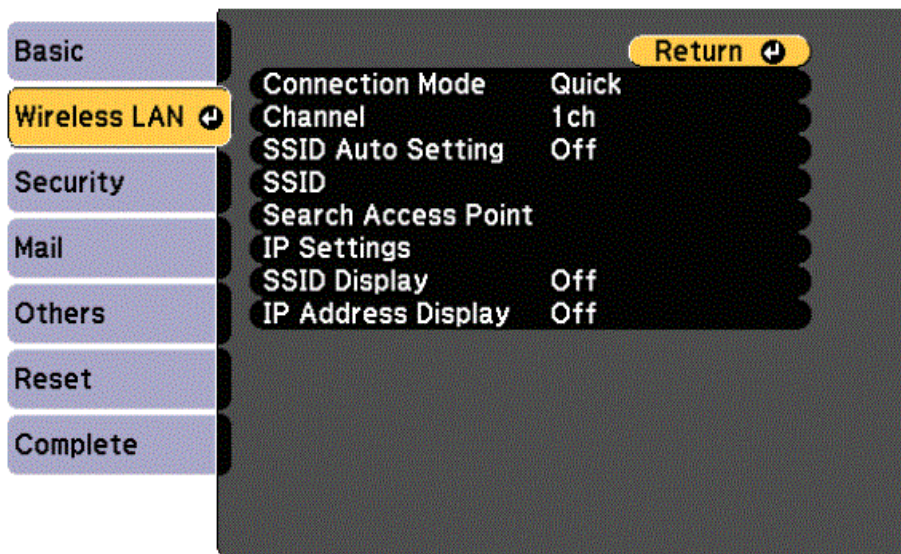



8. Choose Connection Mode, press , select Quick (for a direct connection to a computer, tablet, or smartphone) or Advanced (for a connection to a router or access point), then press again. When you're

finished, press Esc to return to the Wireless LAN menu.

9. If you choose the Advanced connection mode, select SSID, press  and enter your network name (SSID) on the screen that appears.





- To select a number or character, use the arrow buttons on the remote control to highlight it, then press .
- To switch between uppercase and lowercase letters, select CAPS and press .
- To change the displayed symbols, select SYM1 or SYM2 and press .

When you're finished entering the SSID, select Finish and press .

10. If you choose the Advanced Connection mode, select IP Settings and press .

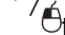
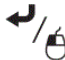
If your network assigns addresses automatically, turn on DHCP. If not, turn off DHCP and enter the projector's IP Address, Subnet Mask, and Gateway Address, as needed.

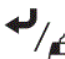
To enter numbers, use the arrow buttons on the remote control to highlight a number, then press  the button. When you're finished entering an address, highlight Finish, then press  Press Esc.

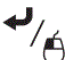
11. To prevent the SSID and IP address from appearing on the network standby screen, set the SSID Display and IP Address Display settings to Off.
12. When you're finished selecting settings in the Wireless LAN menu, press Esc.
13. If you are connecting the projector to a secure network, select the Security menu and press . Then select settings and press Esc when you're finished.
14. Select Complete and press , then select Yes and press  again to save your settings.
15. See "Install network software" for additional instructions.

A project over a wired network

Follow the steps here to configure your projector for your wired network using the projector's menu system.

1. Plug in and turn on the projector.

2. Press the Menu button on the remote control, select the Network menu, and press ↵/⏏

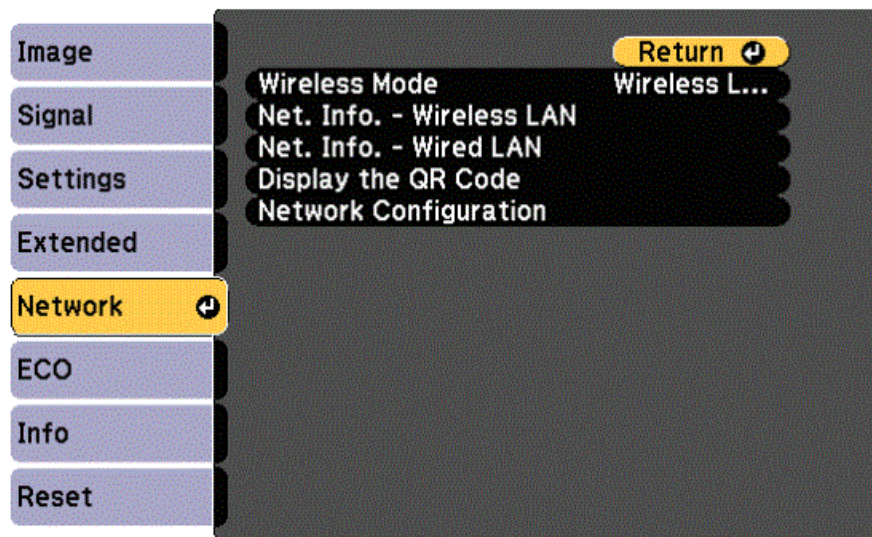

3. Select Network Configuration and press.

4. Select the Basic menu and press ↵/⏏

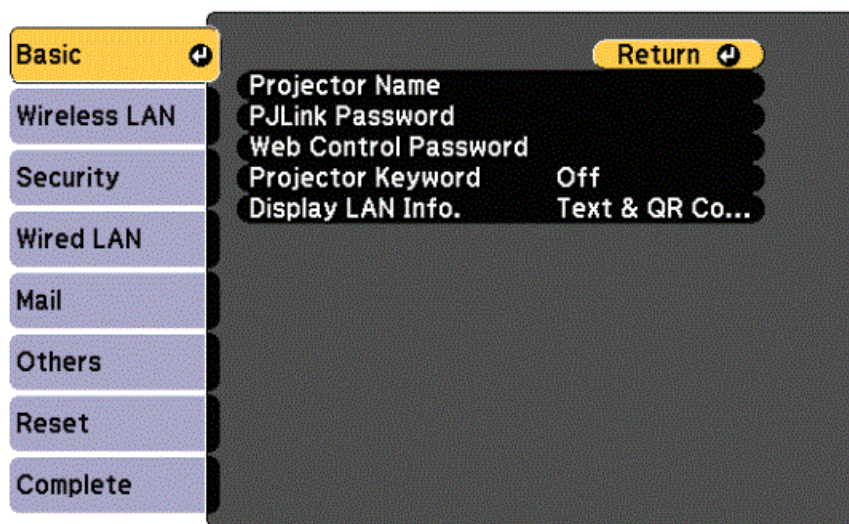

5. Select the Projector Name setting and enter a name (up to 16 characters long) to identify your projector over the network.

Use the displayed keyboard to enter characters. Press ↵/⏏ the arrow buttons on the remote control to highlight the characters and press to select them.

Note: See the online User's Guide for information on adding passwords.

6. Select the Wired LAN menu and press it ↵/⏏.

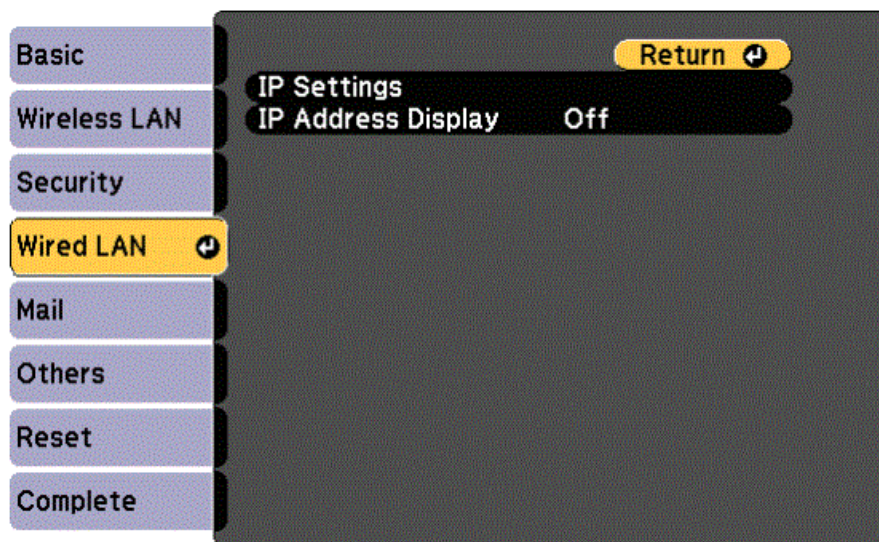

7. Choose IP Settings and press ↵/⏏
8. If your network assigns addresses automatically, turn on the DHCP setting. If not, turn off the DHCP setting and enter the projector's IP Address, Subnet Mask, and Gateway Address, as needed. Then press Esc.
9. To prevent the IP address from appearing on the network standby screen, set the IP Address Display setting to Off.
10. When you are finished, select Complete and press ↵/⏏, then press ↵/⏏ again to save your settings.
11. Press the Menu button to exit the menu system.
12. See "Install network software" for additional instructions

Install network software

Computer

- Install the EasyMP® Network Projection software on each computer that will project over the network. Use the CD labeled Epson Projector Software to install the program.
- For instructions on installing and using your network software, click the icon on your desktop to access the online EasyMP Network Projection Operation Guide (requires an Internet connection). If you don't see the EasyMP
- Network Projection Guide icon, you can install it from the projector CD or go to the Epson website, as described on the right.
- To monitor and control your projector over the network, download and install the EasyMP Monitor software and manual from the Epson support web site. You can install a link to the downloads page from the projector CD or go to the Epson website, as described on the right

Mobile device

To project from an iOS or Android™ device, download and install the Epson iProjection™ app. Visit epson.com/projectorapp (U.S.) or epson.ca/projectorapp (Canada) for more information.



Troubleshooting

If you see a blank screen or a No signal message after turning on your computer or video device, check the following:

- Make sure the Status light on the projector is blue and not flashing, and the A/V Mute slide is open.
- Press the Source Search button on the projector or the remote control to switch to the correct image source, if necessary.
- If you're using a Windows laptop, press the function key on your keyboard that lets you display on an external monitor. It may be labeled CRT/LCD or have an icon such as . You may have to hold down the Fn key while pressing it (such as Fn + F7). Wait a moment for the display to appear.
- If you're using a Mac laptop, open System Preferences and select Displays. Click the Arrangement tab, and select the Mirror Displays checkbox.

Where to get help

Manuals

For more information about using the projector, click the icons on your desktop to access the online manuals (requires an Internet connection). If you don't have icons to the manuals, you can install them from the projector CD or go to the Epson website, as described below.

Telephone support services

To use the Epson® PrivateLine® Support service, call (800) 637-7661. This service is available for the duration of your warranty period. You may also speak with a support specialist by calling (562) 276-4394 (U.S.) or (905) 709-3839 (Canada). Support hours are 6 AM to 8 PM, Pacific Time, Monday through Friday, and 7 AM to 4 PM, Pacific Time, Saturday. Days and hours of support are subject to change without notice. Toll or long-distance charges may apply.

Internet support

Visit epson.com/support (U.S.) or epson.ca/support (Canada) for solutions to common problems. You can download utilities and documentation, get FAQs and troubleshooting advice, or e-mail Epson.

Registration

Register today to get product updates and exclusive offers. You can use the CD included with your projector or register online at epson.com/webreg.

Optional accessories

For a list of optional accessories, see the online User's Guide.

You can purchase screens or other accessories from an Epson-authorized reseller. To find the nearest reseller, call 800-GO-EPSON (800-463-7766). Or you can purchase online at epsonstore.com (U.S. sales) or epson.ca (Canadian sales).



EPSON, EasyMP, and PowerLite are registered trademarks, Epson iProjection is a trademark, and EPSON Exceed Your Vision is a registered logomark of Seiko Epson Corporation. PrivateLine is a registered trademark of

Epson America, Inc.

OS X and Mac are trademarks of Apple Inc., registered in the U.S. and other countries.

General Notice: Other product names used herein are for identification purposes only and may be trademarks of their respective owners. Epson disclaims any rights in those marks.

This information is subject to change without notice. © 2014 Epson America, Inc., 11/14

Printed in XXXXXX

Documents / Resources

	EPSON 97H 3LCD Projector [pdf] User Guide 97H 3LCD Projector, 97H, 3LCD Projector
---	--

References

- [E Epson Canada | Homepage](#)
- [E Wireless Projector - iProjection App | Epson Canada](#)
- [E Epson® Official Support](#)
- [E iProjection App | Epson US](#)
- [E Epson® Official Support](#)
- [E Epson Product Registration](#)
- [🌐 Buy Direct from Epson | Epson US](#)
- [📖 Manual-Hub.com - Free PDF manuals!](#)
- [User Manual](#)

[Manuals+](#), [Privacy Policy](#)

This website is an independent publication and is neither affiliated with nor endorsed by any of the trademark owners. The "Bluetooth®" word mark and logos are registered trademarks owned by Bluetooth SIG, Inc. The "Wi-Fi®" word mark and logos are registered trademarks owned by the Wi-Fi Alliance. Any use of these marks on this website does not imply any affiliation with or endorsement.