

EPOMAKER TH99 RGB Mechanical Keyboard User Guide

Contents

1 TH99 RGB Mechanical Keyboard

1.1 EPOMAKER TH99

1.2 1800 Compact Hot-swappable RGB Mechanical Keyboard with Numpad

1.3 BASIC FUNCTION

1.4 Function Key Combinations

1.5 Lights

1.6 PAIRING BLUETOOTH

1.7 PAIRING WIRELESS 2.4GHz

1.8 Wired Mode

1.9 Battery Check

1.10 Indicator

1.11 SPECS

1.12 Remove Switches

1.13 Install Switches

1.14 TECHNICAL ASSISTANCE

1.15 COMMUNITY FORUMS

1.16 WARRANTY

2 Documents / Resources

2.1 References

TH99 RGB Mechanical Keyboard

EPOMAKER TH99

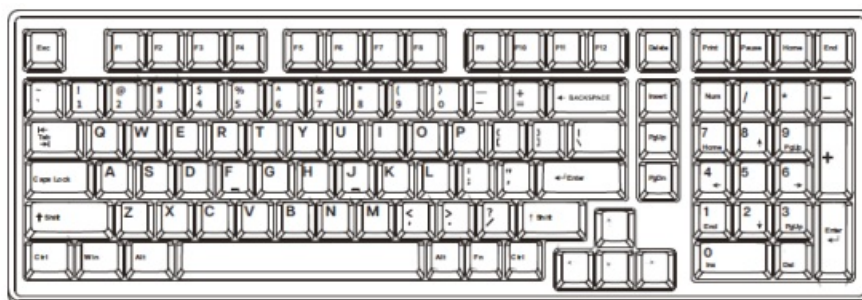

1800 Compact Hot-swappable RGB Mechanical Keyboard with Numpad

Should you require more assistance please email us at support@epomaker.com



Made in China
Manufacturer: Shenzhen Changyue Technology Co., Ltd.
Address: Seventh Floor, Kai Deer Building, No.188 Tongshu Road,
Xixi Street, Nanshan District, Shenzhen Guangdong, CN
Email: support@epomaker.com
Web: www.epomaker.com



APEX CE SPECIALISTS DMH
Incorporating 141888 Neuss Germany
Contact: info@apex-uk.com Email: info@apex-uk.com
APEX CE SPECIALISTS LIMITED
80 Princess Street, Manchester, M1 4BT, UK
Contact: info@apex-uk.com Email: info@apex-uk.com



BASIC FUNCTION

Windows		Mac	
F1	F		
F2	F2	F2	Screen Brightness –
F3	F3	F3	Screen Brightness +
F4	F4	F4	Task
F5	F5	F5	Launchpad
F6	F6	F6	Short press: Search Long press: Siri
F7	F7	F7	Screenshot
F8	F8	F8	Previous Track
F9	F9	F9	Play/Pause
F10	F10	F10	Next Track
F11	F11	F11	Mute
F12	F12	F12	Volume –
Fn+ F1	Screen Brightness –	Fn+ F1	Volume +
Fn+ F2	Screen Brightness +	Fn+ F2	F1
Fn+ F3	Task	Fn+ F3	F2
Fn+ F4	My Computer	Fn+ F4	F3
Fn+ F5	Search	Fn+ F5	F4
Fn+ F6	Screenshot	Fn+ F6	F5
Fn+F7	Previous Track	Fn+F7	F6
Fn+F8	Play/Pause	Fn+F8	F7
Fn+F9	Next Track	Fn+F9	F8
Fn+F10	Mute	Fn+F10	F9
Fn+F11	Volume –	Fn+F11	F10
Fn+F12	Volume +	Fn+F12	F11
Fn+Win	Lock/Unlock Win Key		F12

Function Key Combinations

Fn + Esc (Hold 5s) Reset the keyboard

Fn + R Long press to pair Device BT1; short press to change to Device Bt1

Fn + Q Long press to pair Device BT2; short press to change to Device Bt2

Fn + W Long press to pair Device BT3; short press to change to Device Bt3

Fn + E Long press to pair Device BT3; short press to change to Device Bt3

Fn + Enter Battery Check

Lights

Fn + Backspace Turn on/off Backlights
Fn + Insert Turn on/off Backlights
Fn + Del Toggle Backlight Effect
Fn + ↑ Toggle Backlight Color
Fn + ↓ Backlight Brightness +
Fn + ← Backlight Brightness –
Fn + → Backlight Speed –

PAIRING BLUETOOTH

Toggle the switch to the BT side, make sure that the keyboard is under the Bluetooth mode:

1. Hold Fn+Q/W/E for 3-5 seconds till the indicator flashes fast, the keyboard is ready to pair.
2. Turn on your Bluetooth device and find “TH99 BT-1”, “TH99 BT-2”, “TH99 BT-3”, then connect. When the keyboard is connected to the Bluetooth device, the indicator stops flashing and the connection is done.
3. Press Fn+ Q/W/E to toggle between the Bluetooth devices 1/2/3.

PAIRING WIRELESS 2.4GHz

Toggle the switch to the 2.4G side, make sure that the keyboard is under the 2.4G wireless mode:

1. Hold Fn+R for 3-5 seconds till the indicator flashes fast, the keyboard is ready to pair.
2. Insert the 2.4G dongle to your computer. When the keyboard is connected, the indicator stops flashing.

Wired Mode

Toggle the switch to the middle and plug the keyboard.

Note: The battery charges when the keyboard is plugged. Red light is on for 10s when charging.

Battery Check

Hold Fn + Enter, the keys from 1 to 0 lights up to show the battery percentage; for example, if the keys from 1 to 6 light up when holding Fn + Enter, it means that the battery life is currently 60%; if keys of 1-0 light up, battery life is 100%.

Indicator

Win Lock: Press Fn+Win key to lock the Win key, and the key lights up. Press Fn + Win again to release the key and the light off.

Capslock: Press Capslock to lock the Capital letters and the Capslock key lights up. Press Capslock again to release the key and the light off.

Numlock: Press Numlock to lock the Numpad to the secondary layer and Num key lights up. Press Numlock again to release the numpad and the light off.

Spacebar: Red light is on for 10s when charging. Red light blinks when the battery is low.

SPECS	
MODEL:	Epomaker TH99
KEYS AMOUNT:	102 Keys
MOUNTING TYPE:	Gasket
CASE MATERIAL:	ABS Plastic
PLATE MATERIAL:	PC
STABILIZER TYPE:	Plate-mounted
PCB TYPE:	3/5-pin Hotswap PCB
CONNECTIVITY:	Type-C Wired, Bluetooth, 2.4G
ANTI-GHOST KEY:	NKRO
LED DIRECTION:	South-facing
POLLING RATE:	1000hz under Wired and 2.4G Mode; 125hz under Bluetooth Mode
BATTERY CAPACITY:	4000mAh
COMPATIBILITY:	WINDOWS
DIMENSION:	417 x 149 x 45 mm
WEIGHT:	Around 1.2 kg



REPLACING KEYCAPS AND SWITCHES

For a full guide on how to remove keycaps and switches scan the QR Code or type in your browser:
<https://epomaker.com/blogs/guides/diy-guide-how-to-remove-and-replace-your-mechanical-keyboard-switches>

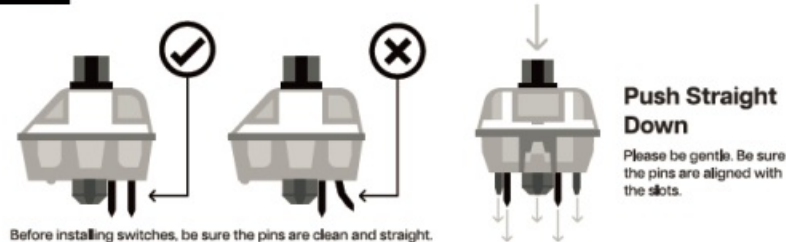

Included Tools

Keycap Puller



Mechanical Switch

Example of a switch as seen from top after you remove the keycap to prepare for switch removal.

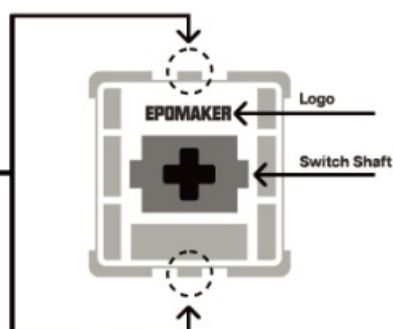

The Switch Puller tool aligns vertically to the Switch to unclip the plastic securing the switch to the plate.

Remove Switches

1. Grab your Switch Removal Tool and align the gripping teeth vertically (on the Y-Axis) at the center of the switch, as shown in the example graphic above.
2. Grab the switch with the Switch Puller and apply pressure until the switch releases itself from the plate.
3. Using firm but gentle force pull the switch away from the keyboard using a vertical motion.

Install Switches

1. Check that all the switch metallic pins are perfectly straight and clean.
2. Align the switch vertically to have the Gateron logo facing north. The pins should align themselves to the keyboard PBC.
3. Press the switch down until you hear a click. This means your switch clips have attached themselves to the keyboard plate.
4. Inspect the switch to ensure it's properly attached to your keyboard, and test it.

Note: If the key doesn't work its possible you may have bent one of the switches while installing it. Pull the switch out and repeat the process.

Pins may be damaged beyond repair and need replacement if this process is not done correctly. Never apply excessive force when replacing keycaps or switches. If you cannot remove or install keycaps or switches please contact customer service as soon as possible to avoid damage to the keyboard due to operating errors.

TECHNICAL ASSISTANCE

For technical assistance, please email to support@epomaker.com with your purchase order number and 2 detailed description of your issue.

We normally respond to enquires within 24 hours you purchased your keyboard from a distributor or not from any official store of Epomaker, please contact them correctly for any additional help.

COMMUNITY FORUMS

Join our community and learn together with other keyboard enthusiasts.

WARRANTY

EPOMAKER's Warranty covers any factory defects that might affect the proper functionality of your purchase. It doesn't cover any damage that may occur from normal wear and tear. If your product is defective we will send you a replacement unit. Replacement units might require you to send the defective unit back to Epomaker.

We provide a 1 year warranty for our products when bought from our website (EPOMAKER.com). Your item will not be covered by your 1 year warranty if the inspection shows any sign of modification or changes unsupported by the original product, these include: Changing internal components, Assembling and reassembling the product, Replacing Batteries, etc.

We will ONLY cover the item if it is bought from our official stores. You do not have a warranty with us if you bought the item from another reseller or likewise. Please contact the store that you bought your product from to resolve issues.

Documents / Resources

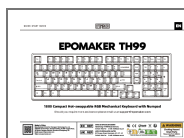

[EPOMAKER TH99 RGB Mechanical Keyboard](#) [pdf] User Guide
TH99 RGB Mechanical Keyboard, TH99, RGB Mechanical Keyboard, Mechanical Keyboard, Keyboard

References

- [User Manual](#)

[Manuals+](#), [Privacy Policy](#)

This website is an independent publication and is neither affiliated with nor endorsed by any of the trademark owners. The "Bluetooth®" word mark and logos are registered trademarks owned by Bluetooth SIG, Inc. The "Wi-Fi®" word mark and logos are registered trademarks owned by the Wi-Fi Alliance. Any use of these marks on this website does not imply any affiliation with or endorsement.