



# EPOMAKER TH80 Wireless Keyboard User Guide

[Home](#) » [EPOMAKER](#) » EPOMAKER TH80 Wireless Keyboard User Guide 

Contents

1 EPOMAKER TH80 Wireless Keyboard

2 WINDOWS and MACOS SHORTCUTS

3 INSTRUCTIONS

4 Remove Switches

5 Install Switches

6 TECHNICAL ASSISTANCE

7 WARRANTY

8 Documents / Resources

9 Related Posts

EPOMAKER

## EPOMAKER TH80 Wireless Keyboard



## **WINDOWS and MACOS SHORTCUTS**

**WINDOWS**

**FN + A** Long press 3s to  
Switch to Windows mode

**FN + F1** Screen Brightness -

**FN + F2** Screen Brightness +

**FN + F3** Task View

**FN + F4** Task Management

**FN + F5** Email

**FN + F6** My Computer

**FN + F7** Last Song

**FN + F8** Play/ Pause

**FN + F9** Next Song

**FN + F10** Mute

**FN + F11** VOL -

**FN + F12** VOL +

**FN + ESC** Long press 3s to restore the  
default setting

**FN + 1** Bluetooth Device 1

**FN + 2** Bluetooth Device 2

**FN + 3** Bluetooth Device 3

**FN + 4** 2.4GHz Wireless

**FN + 5** Wired

**FN + \** Toggle the light mode

**FN + BACKSPACE**  
Turn off/turn on the backlight

**FN + U** PrtSc

**FN + K** Home

**FN + L** End

**MACOS**

**FN + S** Long press 3s to  
Switch to macOS mode

**F1** Screen Brightness-

**F2** Screen Brightness +

**F3** Control Center

**F4** Call Siri

**F5** Keyboard Brightness -

**F6** Keyboard Brightness +

**F7** Last Song

**F8** Play/ Pause

**F9** Next Song

**F10** Mute

**F11** VOL -

**F12** VOL +

**FN + ESC** Long press 3s to restore the  
default setting

**FN + 1** Bluetooth Device 1

**FN + 2** Bluetooth Device 2

**FN + 3** Bluetooth Device 3

**FN + 4** 2.4GHz Wireless

**FN + 5** Wired

**FN + \** Toggle the light mode

**FN + BACKSPACE**  
Turn off/turn on the backlight

**FN + U** -

**FN + K** Home

**FN + L** End

## **INSTRUCTIONS**

### **CHANGE RGB EFFECTS**

Pressing Fn+ \l at the same time allows you to switch the RGB effect of your TH80 Keyboard.

### **PAIRING BLUETOOTH TH**

- FN • 1/2/3 Long Press for 3 seconds to pair Bluetooth device
- FN + 11213 Short Press to switch to last paired device

Long press the FN+ 1/2/3 for 3 seconds, the keyboard will start pairing and the light will flash. If there's no connection, the keyboard will enter into sleep mode.

### PAIRING WIRELESS SS 2,4GHz

FN+4 Switch to Wireless Mode

Firstly, turn on the keyboard via the switch on the keyboard's bottom. Then plug the receiver into your device. After being recognized by your device, press FN+4\$, you will see the 4\$ key's backlit flashes. When the LED stays on the green, the pairing is successfully done.

### BLUETOOTH TH a WIRELESS 2,4GHZ SPECIFICATIONS

The operating system should be windows 8 or above to support the Bluetooth function. The device should support Bluetooth 5.0 or a higher version to use Bluetooth 5.0.

### KEYBOARD SHOR TCUTS

If you switch devices and/or systems, please make sure to press FN+A/S to switch the keyboard layout according to the system you used, or some shortcuts/multimedia keys may not work properly.

### KEYBOARD WAKE UP/

If your keyboard is sleeping press any key to wake it up, it will remember the last device connected.

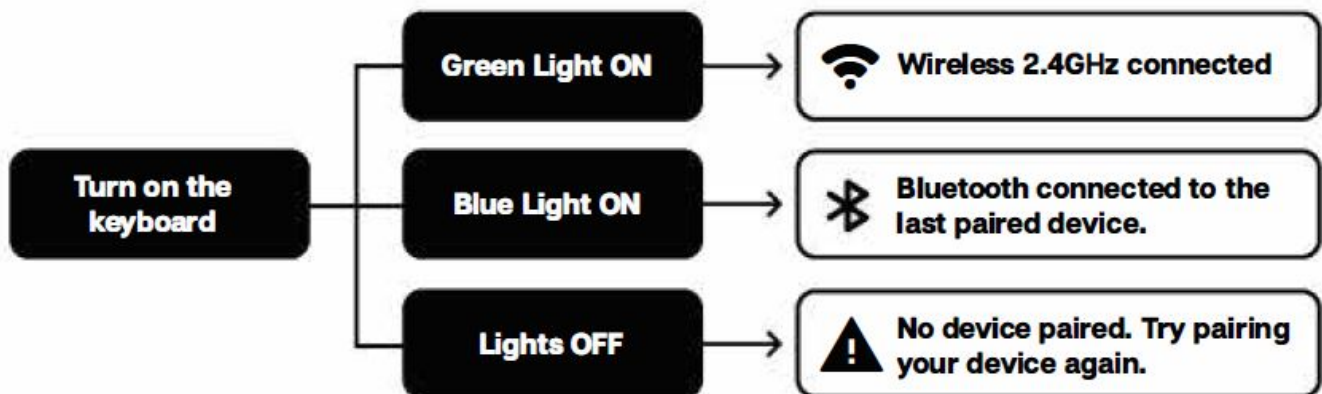

### REPLACING KEVCAPS AND SWITCHES

For a full guide on how to remove keycaps and switches scan the QR Code or type in your browser:

<https://epomaker.com/blogs/guides/diy-guide-how-to-remove-and-replace-your-mechanical-keyboard-switches>



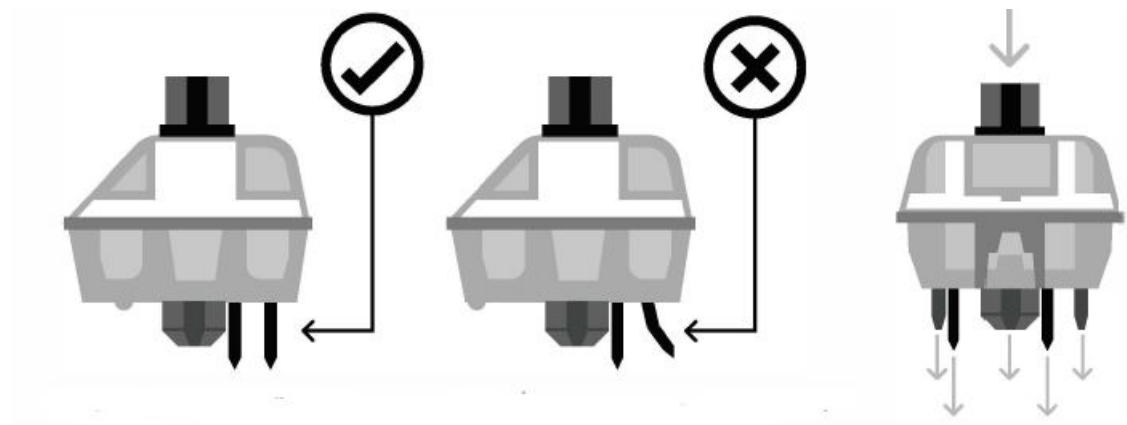

Before installing switches, be sure the pins are clean and straight.

### Push Straight Down

Please be gentle. Be sure the pins are aligned with the slots.

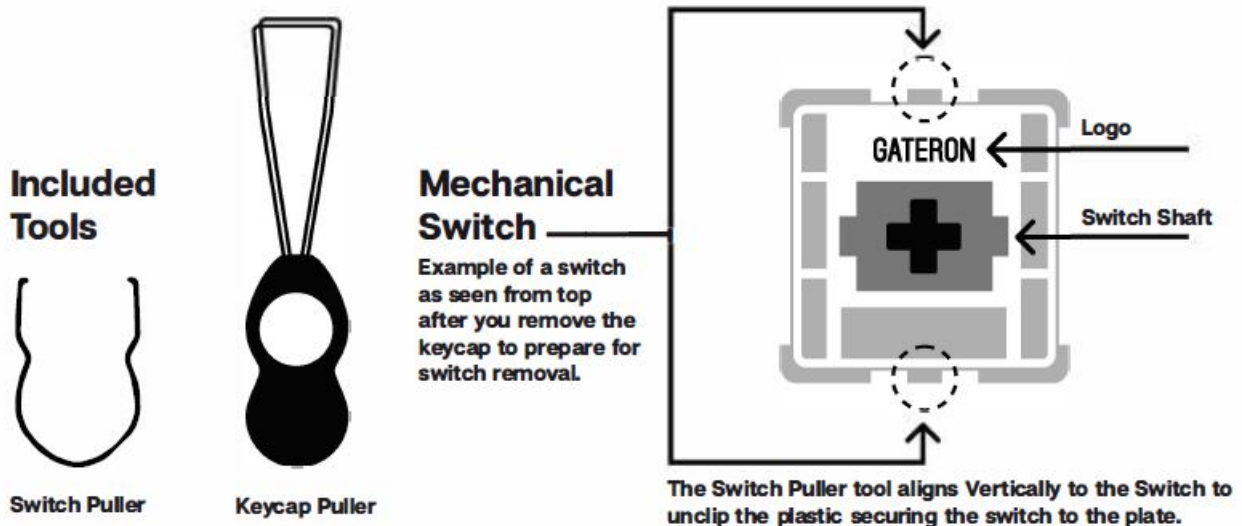

## Remove Switches

1. Grab your Switch Removal Tool and align the gripping teeth vertically (on the Y-Axis) at the center of the switch, as shown in the example graphic above.
2. Grab the switch with the Switch Puller and apply pressure until the switch releases itself from the plate.
3. Using firm but gentle force pull the switch away from the keyboard using a vertical motion.

**Note:** If the key doesn't work its possible you may have bent one of the switches while installing it. Pull the switch out and repeat the process. Pins may be damaged beyond repair and need replacement if this process is not done correctly. Never apply excessive force when replacing keycaps or switches. If you cannot remove or install keycaps or switches please contact customer service as soon as possible to avoid damage to the keyboard due to operating errors.

The Switch Puller tool aligns Vertically to the Switch to unclip the plastic securing the switch to the plate.

## Install Switches

1. Check that all the switch metallic pins are perfectly straight and clean.

2. Align the switch vertically to have the Gateron logo facing north. The pins should align themselves to the keyboard PCB.
3. Press the switch down until you hear a click. This means your switch clips have attached themselves to the keyboard plate.
4. Inspect the switch to ensure it's properly attached to your keyboard, and test it.

## TECHNICAL ASSISTANCE

For technical assistance, please email to [support@epomaker.com](mailto:support@epomaker.com) with your purchase order number and a detailed description of your issue. We normally respond to inquiries within 24 hours. If you purchased your keyboard from a distributor or not from any official store of Epomaker, please contact them directly for any additional help.

Join our community and learn together with other keyboard enthusiasts.

- <https://discord.gg/2q3Z7C2>
- <https://www.reddit.com/user/epomaker/>

## WARRANTY

EPOMAKER's Warranty covers any factory defects that might affect the proper functionality of your purchase. It doesn't cover any damage that may occur from normal wear and tear. If your product is defective we will send you a replacement unit. Replacement units might require you to send the defective unit back to Epomaker. We provide a 1 year warranty for our products when bought from our website (EPOMAKER.com). Your item will not be covered by your 1 year warranty if the inspection shows any sign of modification or changes unsupported by the original product, these include: Changing internal components, Assembling and reassembling the product, Replacing Batteries, etc. We will ONLY cover the item if it is bought from our official stores. You do not have a warranty with us if you bought the item from another reseller or likewise. Please contact the store that you bought your product from to resolve issues.

### Made in China

Manufacturer: Shenzhen Changyun Technology Co., Ltd. Address: Seventh Floor, Kai Daer Building, No.168 Tongsha Road, Xiii Street, Nanshan District, Shenzhen, Guangdong, CN

- Email: [support@epomaker.com](mailto:support@epomaker.com)
- Web: [www.epomaker.com](http://www.epomaker.com)

## Documents / Resources

	<a href="#">EPOMAKER TH80 Wireless Keyboard</a> [pdf] User Guide TH80 Wireless Keyboard, TH80, Wireless Keyboard
---	---