



**MagForce 68 65
Percent Type C
Wired RGB Analog
Keyboard**



EPOMAKER MagForce 68 65 Percent Type C Wired RGB Analog Keyboard Instruction Manual

[Home](#) » [EPOMAKER](#) » EPOMAKER MagForce 68 65 Percent Type C Wired RGB Analog Keyboard Instruction Manual 

Contents

- [1 EPOMAKER MagForce 68 65 Percent Type C Wired RGB Analog Keyboard](#)
- [2 BASIC FUNCTION](#)
- [3 MULTI-MEDIA](#)
- [4 LIGHT EFFECTS](#)
- [5 FUNCTIONS IN ADVANCED SETTING](#)
- [6 Included Tools](#)
- [7 Documents / Resources](#)
 - [7.1 References](#)



EPOMAKER MagForce 68 65 Percent Type C Wired RGB Analog Keyboard



BASIC FUNCTION

FN + ESC	~
FN + 1!	F1
FN + 2@	F2
FN + 3#	F3
FN + 4\$	F4
FN + 5%	F5
FN + 6^	F6
FN + 7&	F7
FN + 8*	F8
FN + 9(F9
FN + 0)	F10
FN + -_	F11
FN + +=	F12
FN + ;:	HOME
FN + ‘”	END
FN + ,<	PRTSCR
FN + .>	SCRLK
FN + /?	PAUSE

MULTI-MEDIA

FN + Q	Multi-media Player
FN + W	Volume -
FN + E	Volume +
FN + R	Mute
FN + T	Previous Track
FN + Y	Next Track
FN + U	Play/Pause
FN + I	Stop
FN + O	Mail
FN + P	Browser
FN + [{	My Computer
FN +]}	Calculator
FN + WIN	Lock/Unlock Win Key

LIGHT EFFECTS

FN + INS	Toggle Backlight RGB Effects
FN + SPACEBAR	Change Light Effect's Direction
FN + ↑	Backlight Brightness +
FN + ↓	Backlight Brightness -
FN + ←	Backlight Speed -
FN + →	Backlight Speed +

FUNCTIONS IN ADVANCED SETTING

(NOTE: SOME FPS GAMES MAY BAN THESE FEATURES.)

- **Dynamic Keystroke (DKS):** Set up 4 different functions on 4 different positions on your keystroke.
- **MT:** Set up two different functions two actions on a key: holding to be one function and tapping to be another function.

- **TGL:** Keep the key staying triggered by either holding it or double tapping it.
- **SOCD (Be aware that some FPS games may ban this feature):** Set up a pair of keys: when both keys are pressed, it registers the last input.

SPECS

MODEL:	EPOMAKER MagForce 68
KEY AMOUNTS:	68 Keys
CASE MATERIAL:	Aluminum
PLATE MATERIAL:	Aluminum
STABILIZER TYPE:	Plate-mounted
PCB TYPE:	Hall Effect
CONNECTIVITY:	Type-C Wired Only
ANTI-GHOST KEY:	NKRO
LED DIRECTION:	South-facing
POLLING RATE:	Up to 8000hz
COMPATIBILITY:	WINDOWS
DIMENSION:	314 x 115 x 45 mm
WEIGHT:	Around 0.8kg

REPLACING KEYCAPS AND SWITCHES

For a full guide on how to remove keycaps and switches scan the QR Code or type in your browser:

<https://epomaker.com/blogs/guides/diy-guide-how-to-remove-and-replace-your-mechanical-keyboard-switches>



Included Tools

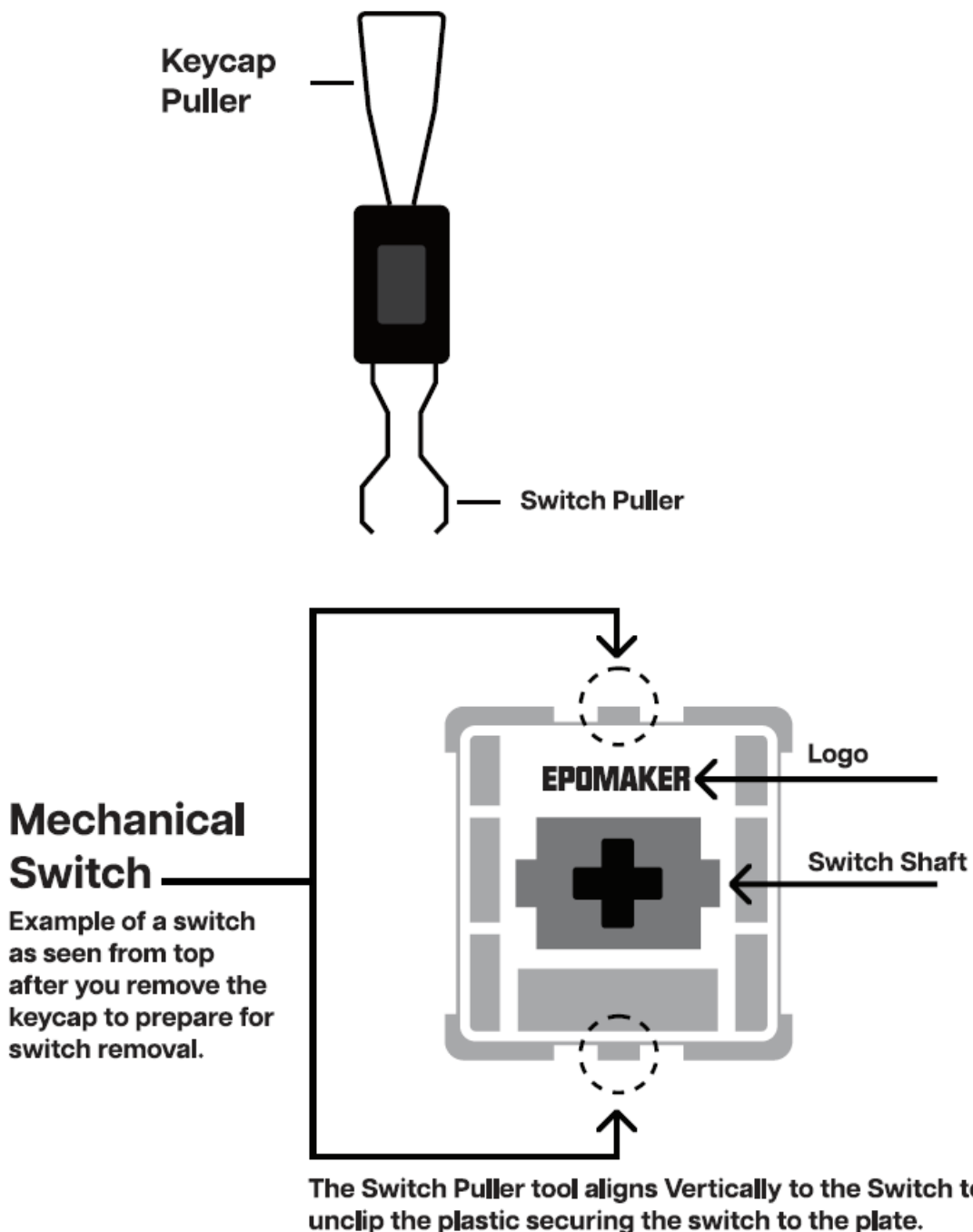

Remove Switches

1. Grab your Switch Removal Tool and align the gripping teeth vertically (on the Y-Axis) at the center of the switch, as shown in the example graphic above.
2. Grab the switch with the Switch Puller and apply pressure until the switch releases itself from the plate.
3. Using firm but gentle force pull the switch away from the keyboard using a vertical motion.

Install Switches

1. Check that all the switch are perfectly clean and clear.
2. Put the switch vertically to have the LED slot aligning the RGB light on the PCB.

3. Press the switch down until you hear a click, meaning that the switch clips have attached itself to the keyboard plate.
4. Inspect the switch to ensure it's properly attached to your keyboard and test it.

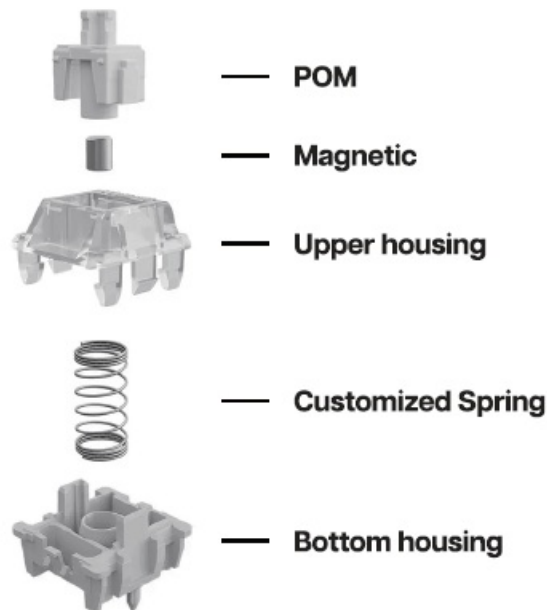

Note: If the key doesn't work its possible you may have bent one of the switches while installing it. Pull the switch out and repeat the process.

Pins may be damaged beyond repair and need replacement if this process is not done correctly. Never apply excessive force when replacing keycaps or switches. If you cannot remove or install keycaps or switches please contact customer service as soon as possible to avoid damage to the keyboard due to operating errors.

65% Hall Effect Hot Swappable Type-C Wired RGB Analog Keyboard

Should you require more assistance please email us at support@epomaker.com

Made in China

Manufacturer: Shenzhen Changyun Technology Co., Ltd.

Address: Seventh Floor, Kai Daer Building, No.168 Tongsha Road,Xili Street, Nanshan District, Shenzhen,Guangdong, CN

Email: support@epomaker.com

Web: www.epomaker.com



EC REP

APEX CE SPECIALISTS GMBH
Habichtweg 141468 Neuss Germany
Contact: Wells Yan
E-mail: info@apex-ce.com

UK REP

APEX CE SPECIALISTS LIMITED
89 Princess Street, Mancheste, M1 4HT, UK
Contact: Wells Yan
E-mail: info@apex-ce.com

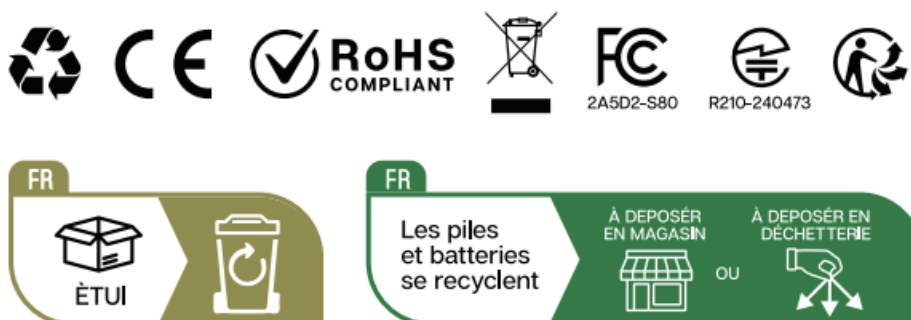

Points de collecte sur www.quefairedemesdechets.fr

WARNING

Choking Hazard Small Parts
Keep away from children and pets

Documents / Resources

	<p>EPOMAKER MagForce 68 65 Percent Type C Wired RGB Analog Keyboard [pdf] Instruction Manual</p> <p>MagForce 68 65 Percent Type C Wired RGB Analog Keyboard, MagForce 68, 65 Percent Type C Wired RGB Analog Keyboard, Type C Wired RGB Analog Keyboard, Wired RGB Analog Keyboard, RGB Analog Keyboard, Analog Keyboard, Keyboard</p>
---	--

References

- [User Manual](#)

[Manuals+](#), [Privacy Policy](#)

This website is an independent publication and is neither affiliated with nor endorsed by any of the trademark owners. The "Bluetooth®" word mark and logos are registered trademarks owned by Bluetooth SIG, Inc. The "Wi-Fi®" word mark and logos are registered trademarks owned by the Wi-Fi Alliance. Any use of these marks on this website does not imply any affiliation with or endorsement.