



**Galaxy70 Type-C
Mechanical
Keyboard**



EPOMAKER Galaxy70 Type-C Mechanical Keyboard User Guide

[Home](#) » [EPOMAKER](#) » EPOMAKER Galaxy70 Type-C Mechanical Keyboard User Guide 

Contents

- [1 EPOMAKER Galaxy70 Type-C Mechanical Keyboard](#)
- [2 MAC OS \(FN+SI\)](#)
- [3 FUNCTION KEY COMBINATIONS](#)
- [4 LIGHT EFFECTS](#)
- [5 PAIRING BLUETOOTH](#)
- [6 SPECS](#)
- [7 TECHNICAL ASSISTANCE](#)
- [8 WARRANTY](#)
- [9 Documents / Resources](#)
 - [9.1 References](#)



EPOMAKER Galaxy70 Type-C Mechanical Keyboard



WINDOWS(FN+A)

F1	F1
F2	F2
F3	F3
F4	F4
F5	F5
F6	F6
F7	F7
F8	F8
F9	F9
F10	F10
F11	F11
F12	F12
FN + F1	My computer
FN + F2	Homepage

FN + F3	Calculator
FN+F4	Mail
FN+F5	Player
FN+F6	Stop
FN+F7	Previous Track
FN+F8	Play/Pause
FN+F9	Next Track
FN+F10	Mute
FN+F11	Volume -
FN+F12	Volume +

MAC OS (FN+SI

F1	Screen Brightness -
F2	Screen Brightness +
F3	Task
F4	Launchpad
F5	
F6	
F7	Previous Track
F8	Play/Pause
F9	Next Track
F10	Mute
F11	Volume -
F12	Volume +
FN + F1	F1
FN + F2	F2
FN + F3	F3
FN+F4	F4
FN+F5	F5
FN+F6	F6
FN+F7	F7
FN+F8	F8
FN+F9	F9
FN+F10	F10
FN+F11	F11
FN+F12	F12

FUNCTION KEY COMBINATIONS

**FN +
BACKSPACE**
(HOLD 3S)

Reset the Keyboard to the
Factory Setting

FN + Q

Long Press to Pair Device BT1;
Short Press to switch among
Bluetooth device

FN + SPACE

Battery Check

FN + W

Long Press to Pair Device BT2;
Short Press to switch among
Bluetooth device

FN + WIN
(Only for Windows)

Lock/unlock Win key

FN + E

Long Press to Pair Device BT3;
Short Press to switch among
Bluetooth device

FN + A

Win Mode
(Backlights blink Green)

FN + S

Mac Mode
(Backlights blink Blue)

FN + R

Long Press to connect via 2.4G

LIGHT EFFECTS

FN + T	Turn on/off Backlights
FN + \ 	Toggle Backlight Colors
FN + ENTER	Toggle Backlight Effects
FN + R_SHIFT	Toggle Indicator Lightbar Effects
FN + ↑	Backlights Brightness +
FN + ↓	Backlights Brightness -
FN + ←	Backlights Speed -
FN + →	Backlights Speed +

PAIRING BLUETOOTH

Toggle the switch to ON, make sure that the keyboard is under the wireless mode:

1. Hold Fn+Q/W/E for 3-5 seconds till the indicator light bar blinks fast in blue/green/red, and the keyboard is ready to pair.
2. Turn on your Bluetooth device and find "Galaxy70", then connect. When the keyboard is connected to the Bluetooth device, the indicator stops flashing and the connection is done.
3. Press Fn+ Q/W/E to toggle between the Bluetooth devices 1/2/3.

PAIRING WIRELESS 2.4GHZ

1. Toggle the switch to ON, the indicator light bar blinks yellow, and the keyboard is under the 2.4G mode. connect.
2. Hold Fn+R for 3-5 seconds till the indicator blinks fast in yellow, and the keyboard is ready to
3. Insert the 2.4G dongle into your device. When the indicator stops, the connection is done.

WIRED MODE

Toggle the switch in the OFF and plug it in.

INDICATOR LIGHT BAR / CHARGING STATUS

- **Red light blinks:** Low battery
- The red light stays on Charging
- **Rainbow:** Fully charged

Note: Charging time takes around 7.5 hours.

BATTERY CHECK

Hold Fn+Space, the keys from 1 to 0 lights up to show the battery percentage; for example, if the keys from 1 to 6 light up when holding Fn+ Space, it means that the battery life is currently 60%; if keys of 1-Olight up, battery life is 100%.

SPECS

BRAND:	EPOMAKER
MODEL:	Galaxy70
KEY AMOUNTS:	82 Keys
MOUNTING TYPE:	Gasket
STABILIZER TYPE:	Plate-mounted
CASE MATERIAL:	Aluminum
PLATE MATERIAL:	Flex-cut PP
PCB TYPE:	3/5-pin Hotswap PCB
CONNECTIVITY:	Type-C Wired, Bluetooth, 2.4G Bluetooth
ANTI-GHOST KEY:	NKRO in all modes
POLLING RATE:	1000hz in USB & 2.4G mode; 125hz in Bluetooth mode
BATTERY CAPACITY:	4000mAh
OS COMPATIBILITY:	Windows/MacOS/Android/iOS
DIMENSION:	351 x 141 x 45 mm
WEIGHT:	Around 1.8kg

REPLACING KEYCAPS AND SWITCHES

For a full guide on how to remove keycaps and switches scan the QR Code or type in your browser:

<https://epomaker.com/blogs/guides/diy-guide-how-to-remove-and-replace-your-mechanical-keyboard-switches>

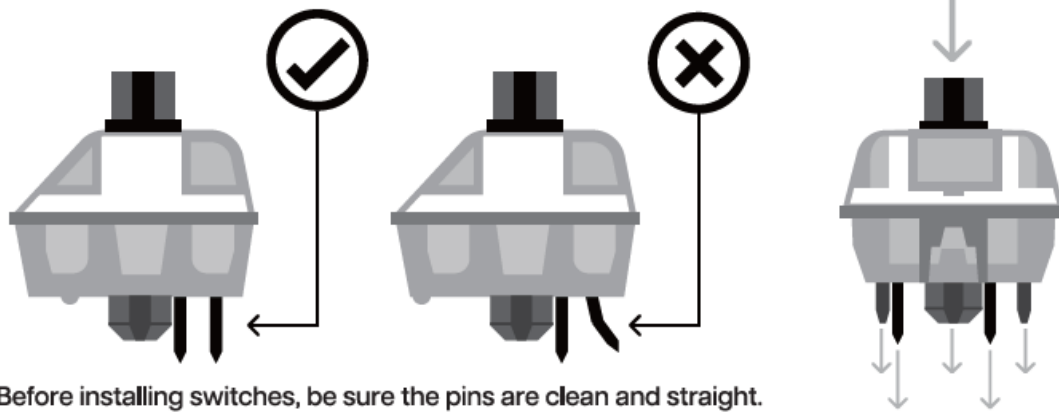

Push Straight Down

- Please be gentle. Be sure the pins are aligned with the slots.

Included Tools

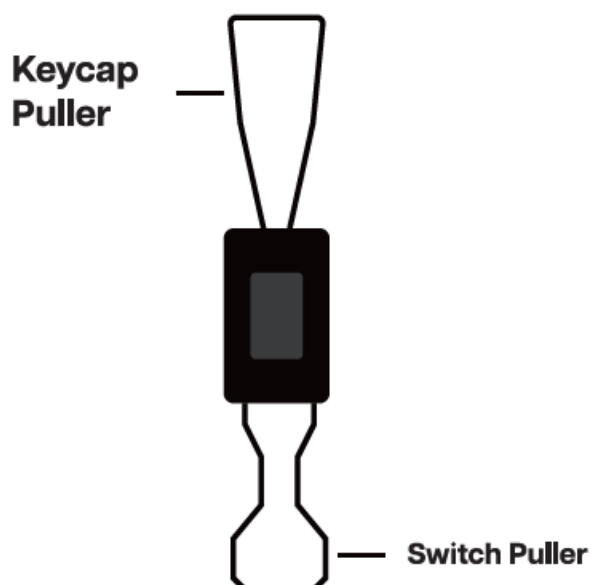

Remove Switches

1. Grab your Switch Removal Tool and align the gripping teeth vertically {on the Y-Axis) at the center of the switch, as shown in the example graphic above.
2. Grab the switch with the Switch Puller and apply pressure until the switch releases itself from the plate.
3. Using firm but gentle force pull the switch away from the keyboard using a vertical motion.

Mechanical Switch

Example of a switch as seen from top after you remove the keycap to prepare for switch removal.

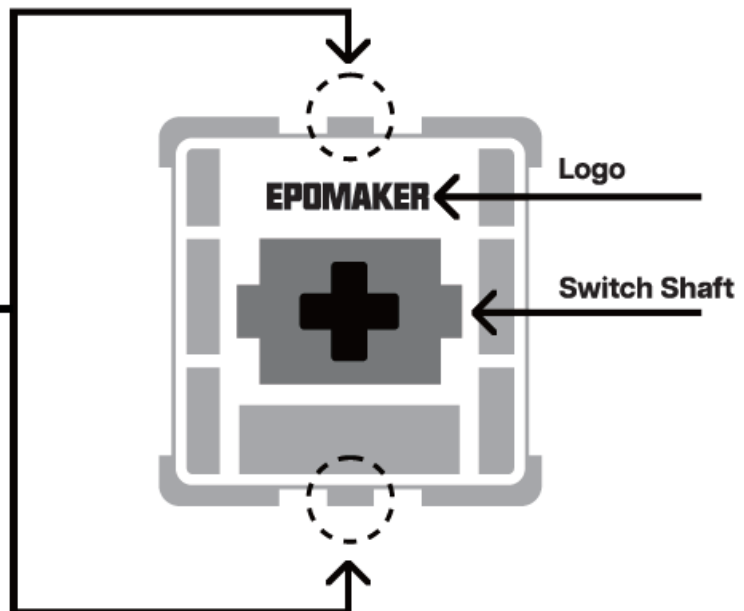

The Switch Puller tool aligns Vertically to the Switch to unclip the plastic securing the switch to the plate.

Install Switches

1. Check that all the switch metallic pins are perfectly straight and clean.
2. Align the switch vertically to have the Gateron logo facing north. The pins should align themselves to the keyboard PCB.
3. Press the switch down until you hear a click. This means your switch clips have attached themselves to the keyboard plate.
4. Inspect the switch to ensure it's properly attached to your keyboard, and test it.

Note: If the key doesn't work it's possible you may have bent one of the switches while installing it. Pull the switch out and repeat the process.

- Pins may be damaged beyond repair and need replacement if this process is not done correctly. Never apply excessive force when replacing keycaps or switches. If you cannot remove or install keycaps or switches please contact customer service as soon as possible to avoid damage to the keyboard due to operating errors.

TECHNICAL ASSISTANCE

For technical assistance, please email support@epomaker.com with your purchase order number and a detailed description of your issue.

We normally respond to inquiries within 24 hours. If you purchased your keyboard from a distributor or not from any official store of Epomaker, please contact them directly for any additional help.

COMMUNITY FORUMS

Join our community and learn together with other keyboard enthusiasts.



<https://discord.gg/2q3Z7C2>



• <https://www.reddit.com/r/EpomakerKeyboard/>

WARRANTY

EPOMAKER's Warranty covers any factory defects that might affect the proper functionality of your purchase. It doesn't cover any damage that may occur from normal wear and tear. If your product is defective we will send you a replacement unit. Replacement units might require you to send the defective unit back to Epomaker. We provide a 1-year warranty for our products when bought from our website {[EPOMAKER.com](https://www.epomaker.com)}. Your item will not be covered by your 1-year warranty if the inspection shows any sign of modification or changes unsupported by the original product, these include: Changing internal components, Assembling and reassembling the product, Replacing Batteries, etc. We will ONLY cover the item if it is bought from our official stores. You do not have a warranty with us if you bought the item from another reseller or likewise. Please contact the store that you bought your product from to resolve issues.

75% Aluminum Gasket-mounted Hot-swappable RGB 2.4Ghz / Bluetooth 5.0 / Type-C Mechanical Keyboard

- Should you require more assistance please email us at support@epomaker.com.

APEX CE SPECIALISTS GMBH

Habichtweg 1 41468 Neuss Germany Contact: Wells Yan E-mail: info@apex-ce.com

APEX CE SPECIALISTS LIMITED

89 Princess Street, Manchester, M1 4HT, UK Contact: Wells Yan E-mail: info@apex-ce.com

Made in China

- **Manufacturer:** Shenzhen Changyun Technology Co., Ltd. 2 Set Sunsha born: She mating a 58 ha Road,
- **Email:** support@epomaker.com
- **Web:** www.epomaker.com

Documents / Resources



[EPOMAKER Galaxy70 Type-C Mechanical Keyboard](#) [pdf] User Guide
Galaxy70 Type-C Mechanical Keyboard, Galaxy70, Type-C Mechanical Keyboard, Mechanical Keyboard, Keyboard

References

- [User Manual](#)

[Manuals+](#). [Privacy Policy](#)

This website is an independent publication and is neither affiliated with nor endorsed by any of the trademark owners. The "Bluetooth®" word mark and logos are registered trademarks owned by Bluetooth SIG, Inc. The "Wi-Fi®" word mark and logos are registered trademarks owned by the Wi-Fi Alliance. Any use of these marks on this website does not imply any affiliation with or endorsement.