



EPOMAKER F75 MAX Swappable 2.4Ghz/Bluetooth 5.0/Wired RGB Mechanical Keyboard User Guide

[Home](#) » [EPOMAKER](#) » EPOMAKER F75 MAX Swappable 2.4Ghz/Bluetooth 5.0/Wired RGB Mechanical Keyboard User Guide 



QUICK START GUIDE F75 MAX



75% Gasket-mounted Hot Swappable 2.4Ghz/Bluetooth 5.0/Wired RGB Mechanical Keyboard with TFT screen and a Knob

Should you require more assistance please email us at support@epomaker.com.

Contents

- 1 F75 MAX Swappable 2.4Ghz/Bluetooth 5.0/Wired RGB Mechanical Keyboard**
- 2 FUNCTION KEY COMBINATIONS**
- 3 LIGHT EFFECTS**
- 4 SCREEN CONTROL**
- 5 PAIRING BLUETOOTH**
- 6 BATTERY-SAVING MODE**
- 7 SPECS**
- 8 Included Tools**
- 9 TECHNICAL ASSISTANCE**
- 10 WARRANTY**
- 11 Documents / Resources**
 - 11.1 References**

F75 MAX Swappable 2.4Ghz/Bluetooth 5.0/Wired RGB Mechanical Keyboard

	WINDOWS	MAC oS
F 1	F 1	Screen Brighiness –
F 2	F 2	Screen Brightness +
F3	F3	Toggle betwaen task:
F4	F4	Desktop
F5	F5	Keyboard Backlight –
F6	F6	Keyboard Backlight +
F7	F7	Previous Track
F8	F8	Play/Pause
F9	F9	Next Track
F10	F10	Mute
F11	F11	Volume –
F12	F12	Volume +
FN+F1	Browser	F 1
FN+F2	Mail	F 2
FN+F3	Toggle between tasks	F3
FN+F4	Explorer	F4
FN+F5	Keyboard Backlight –	F5
FN+F6	Keyboard Backlight +	F6
FN+F7	Previous Track	F7
FN+F8	Play/Pause	F8
FN+F9	Next Track	F9
FN+F10	Mute	F10
FN+F11	Volume –	F11
FN+F12	Volume +	F12

FUNCTION KEY COMBINATIONS

FN+EsC (HOLD 35)	Reset the Keyboard to the Factory Setting	FN+~	Holdfor3stoPair24G Connectivity
FN+DEL	Ins	FN+1!	HoldforstoPair Buletooth Device1
FN+END	Home,	FN+2@	Hold for 3s to Pair Bluetooth Device 2
FN+U	prise	FN+3#	HodforSstopar Blustooth Device 3
FN+I	scr	FN+WIN	Lok Windows key
FN+O	Pause	FN+KNOB	Toggle control between Screen and Volume

LIGHT EFFECTS

FN+↑	Backlights Brightness +
FN+↓	Backlights Brightness –
FN+→	Backlights Speed-
FN+→	Backlights Speed +
FN+ \\	Toggle Backlight effect
FN+TAB	Toggle Backlight Colour

SCREEN CONTROL

SYSTEM	Win/Mac/iOS/Android
EFFECT	Toggle the Backlight RGB
‘COLOUR	Toggle the Backlight colour
BRIGHTNESS	Backlight Brightness +/-
SPEED	Backlight Speed +/-
‘VOLUME	Control the Volume +/-
LANGUAGE	Toggle the screen language (Chinese or English)

PAIRING WIRELESS 2.4G

1. Toggle the switch to 24G side, press and hold the F + ~ for 3 seconds until the screen shows “2.4G Pairing” and the light indicator flashes quickly
2. Insert the 2.4Ghz dongle to your device.
3. When the screen shows “2.4G Success!” and the green light indicator stop flashing, the keyboard is connected to the device.

PAIRING BLUETOOTH

1. Toggle the switch to BT side, press and hold Fn+ 11/ 26/ 3# for 3 seconds until the screen 'shows "BT1/2/3 Pairing" and the green light indicator under 1/2/3 flashes quickly.
2. Turn on your Bluetooth device and find
 - * AULA F75 Max-1/ AULA F75 Max-2/ AULA F75 Max-3", then connect.
3. When the screen shows "BT1/2/3 Success!" and the green light indicator stop flashing, the keyboard is connected to the Bluetooth device.
 - * Short press Fn+ 1/ 20/ 34 to toggle between Bluetooth device 1/2/3

WIRED MODE

Toggle the switch to the Wired (middle) and then plug in the USB-C cable, then the keyboard is connected.

* The battery charges under either wireless or wired mode, as long as the keyboard is plugged.

BATTERY-SAVING MODE

The keyboard will go into deep sleep after 5 minutes of no key pressing. Backlight will be off.

Press any key to wake up the keyboard and connect back to connectivity.

LIGHT INDICATOR: (ALSO SHOWS ON THE SCREEN)

Windows key: Windows key stays at white light when the windows key is locked Caps key: The indicator stays at white when the caps lock is on Scroll key: The indicator lights up when the scroll lock is on

SPECS

Brand:	EPOMAKER x AULA
Model:	F75 Max
Key Amounts:	80 Keys + 1 knob
Screen:	0.85-inch TFT Screen
Software:	AULA Driver
Mounting Type:	Gasket
Stabilizer Type:	Plate-mounted
Case Material:	ABS Plastic
Plate Material:	PC Flex-cuts
PCB Type:	3/5-pin Hotswap PCB
Connectivity:	Type-C Wired, Bluetooth, 2.4G
Anti-Ghost Key:	NKRO in all modes
Polling Rate:	1000hz in USB & 2.4G mode; 125hz in Bluetooth mode
Battery Capacity:	4000mAh
Backlight:	RGB, South-facing LEDs
OS Compatibility:	Windows/Mac/Android/iOS
Battery Lasting:	≥30.5 hrs (with RGB on) / ≥80 hrs (with RGB off)
Dimension:	327.69 (L)×143.17(W)×43.26(H)±0.5mm
Weight	Net 960g

REPLACING KEYCAPS AND SWITCHES

For a full guide on how to remove keycaps and switches scan the QR Code or type in your browser:

<https://epomaker.com/blogs/guides/diy-guide-how-to-remove-and-replace-your-mechanical-keyboard-switches>

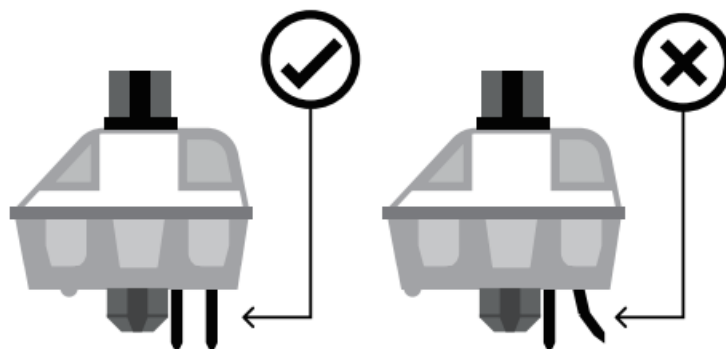

Before installing switches, be sure the pins are clean and straight

Push Straight Down

Please be gentle. Be sure the pins are aligned with the slots.

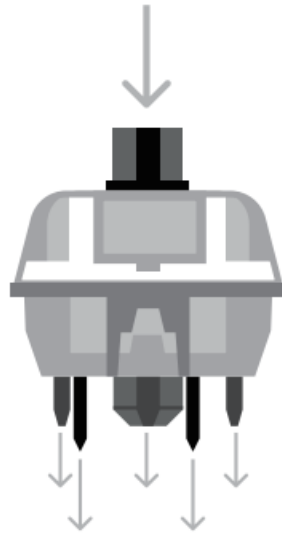

Included Tools

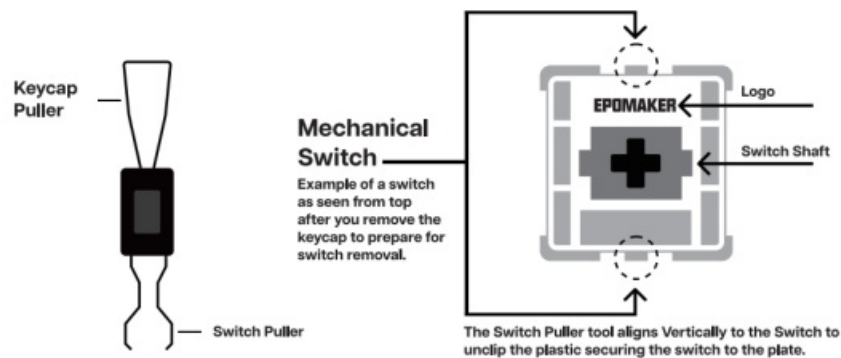

Remove Switches

1. Grab your Switch Removal Tool and align the gripping tooth vertically (on the Y-Auxs) at the center of the switch, 2 shown in the example graphic above.
2. Grab the switch with the Switch Puler and apply pressure until the switch releases itself from the plate.
3. Using firm but gentle force pull the switch away from the Keyboard using a vertical motion

Install Switches

1. Check that all the switch metal pins are perfectly straight and clean
2. Align the switch vertically to have the Gateron logo facing north. The pins should align themselves on the keyboard PCB.
3. Press the switch down until you hear a click. This means your switch clips have attached themselves to the keyboard plate.
4. Inspect the switch to ensure it is properly attached to your keyboard, and test it,

⚠ Note: If the key doesn't work, it's possible you may have bent one of the switches while installing. Pull the switch out and repeat the process.

Pin may be damaged beyond repair and need replacement if process is not done correctly. Never apply excessive force when replacing keys or switches. If you cannot remove or install keys properly or switches please contact our customer service as soon as possible to avoid damage to the keyboard due to operating errors.

TECHNICAL ASSISTANCE

For technical assistance, please email to support@epomaker.com with your purchase order number and detailed description of your issue.

We normally respond to enquiries within 24 hours. If you purchased your keyboard from a distributor or not from any official store of Epomaker, please contact them directly for any additional help.

COMMUNITY FORUMS

Join our community and learn together with other keyboard enthusiasts.



<https://discord.gg/2q327C2>



<https://www.reddit.com/r/Epomakerkeyboard/>

WARRANTY

EPOMAKER's Warranty covers any factory defects that might affect the proper functionality of your purchase.

It doesn't cover any damage that may occur from normal wear and tear.

If your product is defective we will send you a replacement unit. Replacement units might require you to send the defective unit back to Epomaker.

We provide a 1 year warranty for our products when bought from our website (EPOMAKER.com). Your item will not be covered by your 1 year warranty if the inspection shows any sign of modification or changes unsupported by the original product, these include: Changing internal components, Assembling and reassembling the product, Replacing Batteries, etc.

We will ONLY cover the item if it is bought from our official stores. You do not have a warranty with us if you bought the item from another reseller or likewise. Please contact the store that you bought your product from to resolve issues.

Made in China

Manufacturer: Shenzhen Changyun Technology Co., Ltd.

Address: Seventh Floor, Kai Daer Building, No.168 Tongsha Road, Xili Street, Nanshan District, Shenzhen, Guangdong, CN

Email: support@epomaker.com

Web: www.epomaker.com



EC REP APEX CE SPECIALISTS GMBH

Habichtweg 141468 Neuss Germany

Contact: Wells Yan E-mail: info@apex-ce.com

UK REP APEX CE SPECIALISTS LIMITED

89 Princess Street, Manchester, M1 4HT. UK

Contact: Wells Yan E-mail: info@apex-ce.com



Points de collecte sur www.quefairedemesdechets.fr



WARNING

Choking Hazard Small Parts Keep away from children and pets



Documents / Resources

	EPOMAKER F75 MAX Swappable 2.4Ghz/Bluetooth 5.0/Wired RGB Mechanical Keyboard [pdf] User Guide F75 MAX Swappable 2.4Ghz Bluetooth 5.0 Wired RGB Mechanical Keyboard, F75 MAX, Swap pable 2.4Ghz Bluetooth 5.0 Wired RGB Mechanical Keyboard, 2.4Ghz Bluetooth 5.0 Wired RG B Mechanical Keyboard, 5.0 Wired RGB Mechanical Keyboard, RGB Mechanical Keyboard, Me chanical Keyboard, Keyboard
---	--

References

- [User Manual](#)

Manuals+ Privacy Policy

This website is an independent publication and is neither affiliated with nor endorsed by any of the trademark owners. The "Bluetooth®" word mark and logos are registered trademarks owned by Bluetooth SIG, Inc. The "Wi-Fi®" word mark and logos are registered trademarks owned by the Wi-Fi Alliance. Any use of these marks on this website does not imply any affiliation with or endorsement.