



EPOMAKER EP84 PLUS 75% Triple-Mode Hot-Swappable Mechanical Keyboard User Guide

[Home](#) » [EPOMAKER](#) » EPOMAKER EP84 PLUS 75% Triple-Mode Hot-Swappable Mechanical Keyboard User Guide 



QUICK START GUIDE EPOMAKER EP84 PLUS

Contents

- [1 EP84 PLUS 75% Triple-Mode Hot-Swappable Mechanical Keyboard](#)
- [2 WINDOWS SHORTCUT](#)
- [3 MAC SHORTCUT](#)
- [4 LIGHT EFFECTS](#)
- [5 FUNCTION KEY COMBINATIONS](#)
- [6 CHANGE RGB EFFECTS](#)
- [7 PAIRING BLUETOOTH](#)
- [8 SPECS](#)
- [9 TECHNICAL ASSISTANCE](#)
- [10 WARRANTY](#)
- [11 Documents / Resources](#)
- [12 Related Posts](#)

EP84 PLUS 75% Triple-Mode Hot-Swappable Mechanical Keyboard

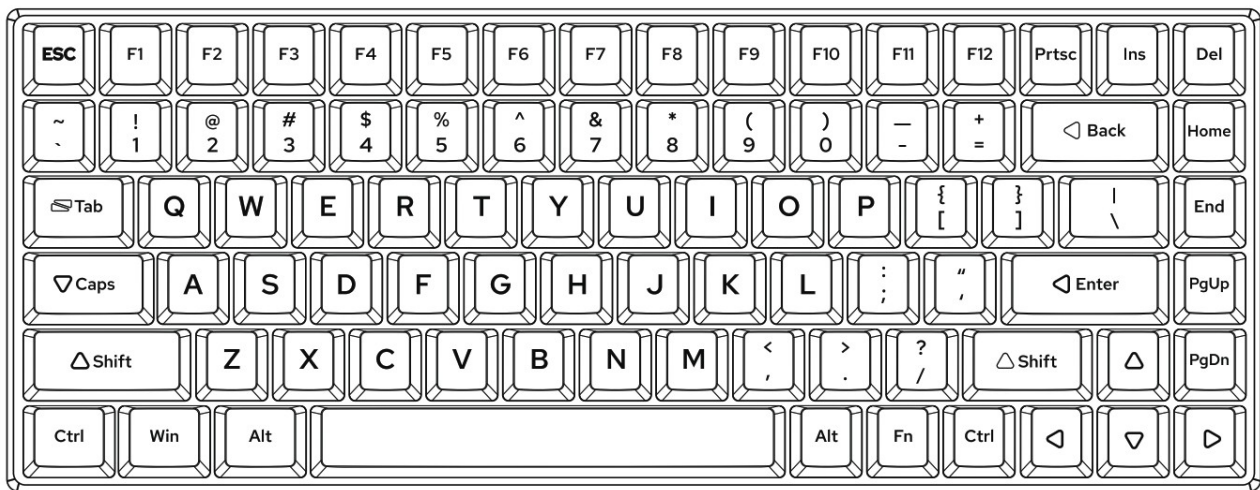

75% Triple-mode Hot-swappable Mechanical Keyboard

Should you require more assistance please email us at support@epomaker.com

WINDOWS SHORTCUT

FN + F1	Media Player
FN + F2	Volume –
FN + F3	Volume +
FN + F4	Mute
FN + F5	Play/Pause
FN + F6	Previous Track
FN + F7	Play/Pause
FN + F8	Next Track
FN + F9	Email
FN + F10	Browser
FN + F11	Calculator
FN + F12	Search
FN + WIN	Lock WIN Key

MAC SHORTCUT

FN + F1	Screen Brightness –
FN + F2	Screen Brightness +
FN + F3	Task
FN + F4	Control Pad
FN + F5	
FN + F6	
FN + F7	Previous Track
FN + F8	Play/Pause
FN + F9	Next Track
FN + F10	Mute
FN + F11	Volume –
FN + F12	Volume +

LIGHT EFFECTS

FN + BACKSPACE	Turn On/Off Backlights
FN + \	Toggle RGB Effects
FN + -_	Change Backlight Direction
FN + =+	Change Backlight Colors
FN + ↑	Backlights Brightness +
FN + ↓	Backlights Brightness –
FN + →	Backlights Speed +
FN + ←	Backlights Speed –

FUNCTION KEY COMBINATIONS

FN+ESC (HOLD 3S)	Reset the Keyboard to the Factory Setting
FN + SPACEBAR	Battery Check
FN + Z/X/C	Short Press to Switch to BT1; Long Press to Pair Devices
FN + 1!	Short Press to Switch to BT2; Long Press to Pair Devices
FN + 2@	Short Press to Switch to BT3 Long Press to Pair Devices
FN + 3#	Short Press to Switch to 2.4G Mode; Long Press to Pair Devices
FN + 4\$	Toggle to Layer 1/2/3
FN + 5%	Check Layer
FN + V (HOLD 3S)	Wired Mode

CHANGE RGB EFFECTS

Press Fn + \| to switch the RGB effects of your Epomaker EP84 Plus keyboard.

PAIRING BLUETOOTH

Toggle the switch in the back to ON to make sure that the keyboard is under the Wireless mode

1. Press Fn+1!/2@/3# and the whole keyboard flashes white 3 times, the keyboard is under the Bluetooth mode;
2. Hold Fn+1!/2@/3# for 3-5 seconds till the 1!/2@/3# indicators flashes fast in red/green/blue, the keyboard is ready to pair;
3. Turn on your Bluetooth device and find 'EP84 PLUS3.0' or 'EP84 PLUS 5.0', then connect. When the keyboard is connected to the Bluetooth device, the light on the 1!/2@/3# key stops flashing and the connection is done.
4. Press Fn+1!/2@/3# to toggle between the Bluetooth devices 1/2/3.

PAIRING WIRELESS 2.4GHZ

Toggle the switch in the back to ON to make sure that the keyboard is under the Wireless mode

1. Short press the FN + 4\$ key combination, the backlight will flash blue 3 times, the keyboard will enter 2.4G mode
2. Long press the FN + 4\$ key combination for 3-5 seconds to enter pairing mode, the 4\$ indicator light will flash white, insert the receiver, after successful pairing, the 4\$ indicator light will be on for 2 seconds and then turn off, the connection is successful

WIRED MODE

Press Fn+5%, the keyboard enters to the wired mode successfully.

CHECK BATTERY

Hold Fn+Spacebar, the keys from 1! to 0) lights up to show the battery percentage; for example, if the keys from 1! to 6^ light up when holding Fn+Spacebar, it means that the battery life is currently 60%; if keys of 1!-0) light up, battery life is 100%.

CHECK LAYER AND MODE

Press the key combination FN+V for 3 seconds, Z/X/C lights up to show the configuration level of the keyboard, e.g. the X key lights up, which means the keyboard is on level 2.

CHARGING INDICATOR LIGHT (IN THE MIDDLE OF THE KEYBOARD)

Charging: Red light stays for 2 seconds then off

Charged: Green light stays for 2 seconds then off

SPECS

KEYS AMOUNT:	84 Keys
CASE MATERIAL:	ABS Plastic
PLATE MATERIAL:	Steel
STABILIZER TYPE:	Plate-mounted
PCB TYPE:	3/5-pin Hotswap PCB
BATTERY CAPACITY:	3000mAh
CONNECTIVITY:	Type-C Wired, 2.4 & Bluetooth Wireless
ANTI-GHOST KEY:	NKRO in all modes
COMPATIBILITY:	WINDOWS/MAC
DIMENSION:	310 x 116 x 35 mm
WEIGHT:	Around 0.82kg

REPLACING KEY CAPS AND SWITCHES

For a full guide on how to remove keycaps and switches scan the QR Code or type in your browser:



<https://epomaker.com/blogs/guides/diy-guide-how-to-remove-and-replace-your-mechanical-keyboardswitches>

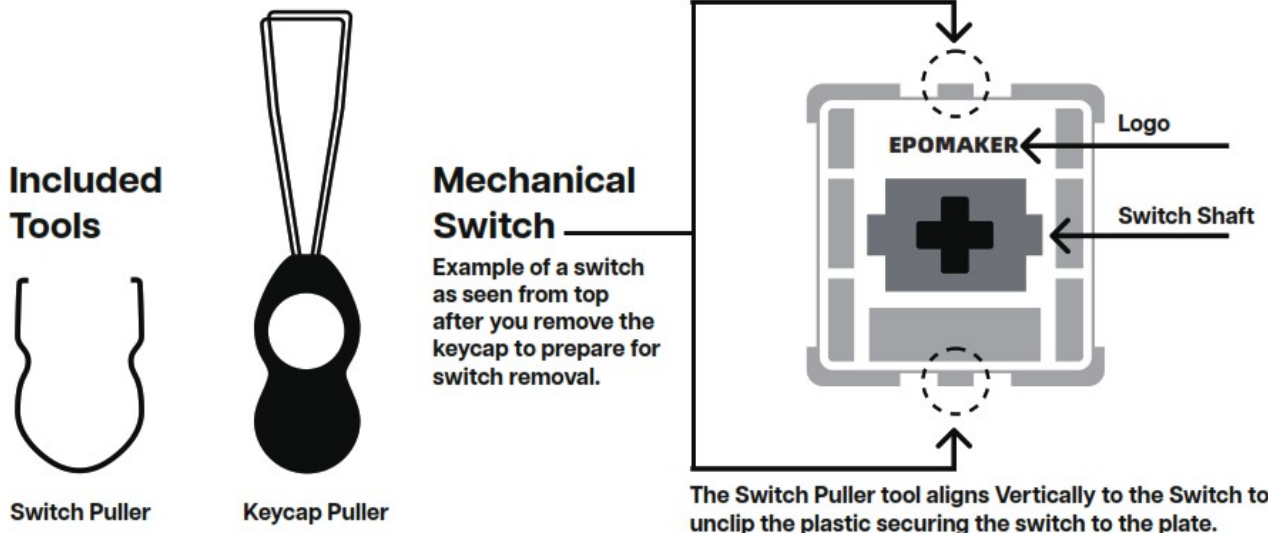
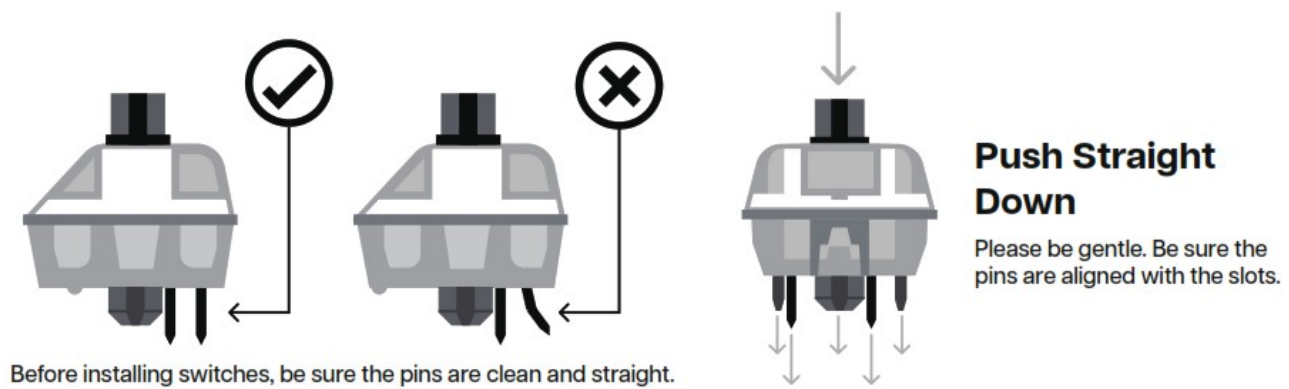

Remove Switches

1. Grab your Switch Removal Tool and align the gripping teeth vertically (on the Y-Axis) at the center of the switch, as shown in the example graphic above.
2. Grab the switch with the Switch Puller and apply pressure until the switch releases itself from the plate.
3. Using firm but gentle force pull the switch away from the keyboard using a vertical motion.

Install Switches

1. Check that all the switch metallic pins are perfectly straight and clean.
2. Align the switch vertically to have the Gateron logo facing north. The pins should align themselves to the keyboard PCB.
3. Press the switch down until you hear a click. This means your switch clips have attached themselves to the keyboard plate.
4. Inspect the switch to ensure it's properly attached to your keyboard, and test it.



Note: If the key doesn't work its possible you may have bent one of the switches while installing it. Pull the switch out and repeat the process.

Pins may be damaged beyond repair and need replacement if this process is not done correctly. Never apply excessive force when replacing keycaps or switches. If you cannot remove or install keycaps or switches please contact customer service as soon as possible to avoid damage to the keyboard due to operating errors.

TECHNICAL ASSISTANCE

For technical assistance, please email to support@epomaker.com with your purchase order number and a detailed description of your issue.

We normally respond to enquiries within 24 hours. If you purchased your keyboard from a distributor or not from any official store of Epomaker, please contact them directly for any additional help.

COMMUNITY FORUMS

Join our community and learn together with other keyboard enthusiasts.

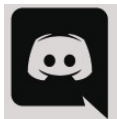

<https://discord.gg/2q3Z7C2>



<https://www.reddit.com/r/Epomaker/>

WARRANTY

EPOMAKER's Warranty covers any factory defects that might affect the proper functionality of your purchase. It doesn't cover any damage that may occur from normal wear and tear. If your product is defective we will send you a replacement unit. Replacement units might require you to send the defective unit back to Epomaker.

We provide a 1 year warranty for our products when bought from our website (EPOMAKER.com). Your item will not be covered by your 1 year warranty if the inspection shows any sign of modification or changes unsupported by the original product, these include: Changing internal components, Assembling and reassembling the product, Replacing Batteries, etc.

We will ONLY cover the item if it is bought from our official stores. You do not have a warranty with us if you bought the item from another reseller or likewise. Please contact the store that you bought your product from to resolve issues.



<https://epomaker.com/pages/terms-of-service>

Made in China

Manufacturer: Shenzhen Changyun Technology Co., Ltd.

Address: Seventh Floor, Kai Daer Building, No.168 Tongsha Road,
Xili Street, Nanshan District, Shenzhen, Guangdong, CN

Email: support@epomaker.com

Web: www.epomaker.com

EC REP

UK REP

APEX CE SPECIALISTS LIMITED

Unit 3d North Point House, North Point Business Park,
New Mallow Road Cork, T23 AT2@P, Ireland

Contact: Wells — Tel: +353212066339

APEX CE SPECIALISTS LIMITED

89 Princess Street, Manchester, M1 4HT, UK

Contact: Wells E-mail: info@apexce.com



Documents / Resources

	<p>EPOMAKER EP84 PLUS 75% Triple-Mode Hot-Swappable Mechanical Keyboard [pdf] Use r Guide</p> <p>EP84 PLUS 75 Triple-Mode Hot-Swappable Mechanical Keyboard, EP84 PLUS, 75 Triple-Mode Hot-Swappable Mechanical Keyboard, Hot-Swappable Mechanical Keyboard, Swappable Mechanical Keyboard, Mechanical Keyboard, Keyboard</p>
---	---

[Manuals+](#).