



EPH CONTROLS CWP1E – 1 Zone RF Timeswitch Pack Instruction Manual

[Home](#) » [EPH CONTROLS](#) » EPH CONTROLS CWP1E – 1 Zone RF Timeswitch Pack Instruction Manual 

Contents

- [1 EPH CONTROLS CWP1E – 1 Zone RF Timeswitch Pack](#)
- [2 Setting the date & time](#)
- [3 Factory program settings](#)
- [4 Adjusting the program settings](#)
- [5 Boost function](#)
- [6 Operating the thermostat](#)
- [7 Documents / Resources](#)
 - [7.1 References](#)
- [8 Related Posts](#)



EPH CONTROLS CWP1E – 1 Zone RF Timeswitch Pack



Setting the date & time

- a) Lower the cover on the front of the unit.
- b) Move the selector switch to the CLOCK SET position.

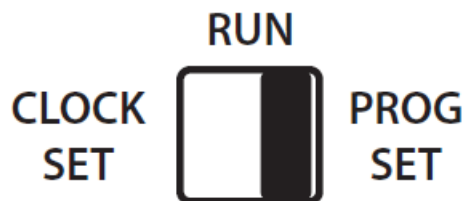

- c) Press the plus or mins buttons to select the DAY and press ok

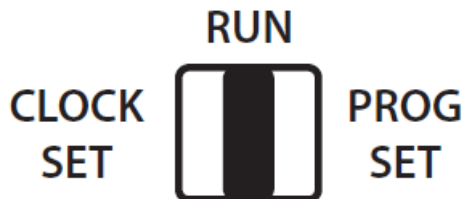

- d) Repeat the above to select the MONTH, YEAR, HOUR and MINUTE.
- e) When this is complete, move the selector switch to the RUN position.

ON/OFF settings different settings available How to select

- a) Lower the cover on the front of the unit.
- b) By pressing the ZONE 1 SELECT button to change between settings for the timeswtich.

Important: Keep this document

AUTO	operates up to 3 ON/OFF periods per day
ALL DAY	operates from1st ON time (P1 on) to last off time (P3 off)
ON	permanently on
OFF	permanently off

Factory program settings

	5/2D					
	P1 ON	P1 OFF	P2 ON	P2 OFF	P3 ON	P3 OFF
Mon-Fri	6:30	8:30	12:00	12:00	16:30	22:30
Sat-Sun	7:30	10:00	12:00	12:00	17:00	23:00

Adjusting the program settings

- a) Lower the cover on the front of the unit.
- b) Move the selector switch to the PROG SET position.

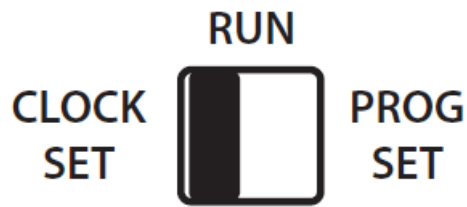

- **c)** Press the PLUS or MINS buttons to adjust the P1 ON time. Press OK
- **d)** Press the PLUS or MINS buttons to adjust the P1 OFF time. Press OK
- **e)** Repeat this process to adjust the ON & OFF times for P2 & P3.
- **f)** When this is complete, move the selector switch to the RUN position.

Boost function

This function allows the user to turn ON the timeswitch for a period of 1, 2 or 3 hours. This does not affect your program settings. If the zone that you wish to Boost is timed to be OFF, you have the facility to switch it ON for 1,2 or 3 hours.

- **a)** Press the boost button once, twice or three times respectively.
- **d)** To cancel the boost function, simply press the boost button again.

Operating the thermostat

The thermostat will allow the timeswitch to activate provided the ambient temperature is below the setpoint.

- **a)** Adjusting the temperature setpoint

Rotate the dial clockwise to increase or counter clockwise to decrease the temperature setpoint.

You can press in the handwheel to confirm or the temperature will be confirmed automatically after 5 seconds.

- **b)** Boost from the thermostat

You can activate the timeclock for 1,2 or 3 hours by pressing the boost button on the thermostat 1, 2 or 3 times.

The thermostat will display +1H, +2H, +3H to represent what is selected.

To turn off the boost from the thermostat, you must press the boost until '+1H, +2H, +3H' disappears from the thermostat screen.

EPH Controls Ireland

technical@ephcontrols.com

www.ephcontrols.com

EPH Controls UK

technical@ephcontrols.co.uk

www.ephcontrols.co.uk

Documents / Resources

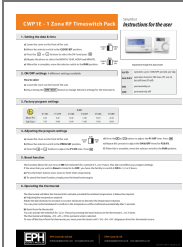

[EPH CONTROLS CWP1E - 1 Zone RF Timeswitch Pack](#) [pdf] Instruction Manual
CWP1E - 1 Zone RF Timeswitch Pack, CWP1E - 1, Zone RF Timeswitch Pack, RF Timeswitch Pack, Timeswitch Pack, Pack

References

- [EPH Home Page - EPH Controls](#)
- [EPH Home Page - EPH Controls](#)