

**EnviroVent**  
**EnviroVent Damp**  
**Pro Positive Input**  
**Ventilation**



# EnviroVent Damp Pro Positive Input Ventilation Installation Guide

[Home](#) » [envirovent](#) » EnviroVent Damp Pro Positive Input Ventilation Installation Guide 

## Contents

- [1 EnviroVent Damp Pro Positive Input Ventilation](#)
- [2 Product Usage Instructions](#)
- [3 Safety](#)
- [4 Diagrams](#)
- [5 WIRING](#)
- [6 Box contents](#)
- [7 Installation](#)
- [8 Fire Safety](#)
- [9 SETTINGS](#)
- [10 Maintenance](#)
- [11 Warranty Conditions & Exclusions apply to all Envirovent Products](#)
- [12 FAQ](#)
- [13 Documents / Resources](#)
  - [13.1 References](#)
- [14 Related Posts](#)

## EnviroVent

**EnviroVent Damp Pro Positive Input Ventilation**



## Specifications

- Product Name: Damp Pro
- Installation Guide: Ventilation Unit
- Recommended Usage: Suitable for properties with warm damp equable climate
- Electrical Requirements: Compliant with Building Regulations and IET Wiring Regulations
- Safety Precautions: Installation by a competent person, not suitable for persons with reduced capabilities

## Product Usage Instructions

### Safety Guidelines

Before beginning installation, ensure to read and understand all provided instructions. Installation should be carried out by a competent individual.

### Wiring and Electrical Connection

All wiring must comply with Building Regulations and IET Wiring Regulations. An earth connection is necessary, and a suitable isolator with a minimum contact separation of 3.0mm should be used for insulation. The power supply cable should be the flexible cable supplied with the unit. If damaged, it must be replaced by an authorized service agent to prevent hazards.

### User Guidelines

The unit is not intended for use by individuals with reduced capabilities unless supervised by someone responsible for their safety. Children should be supervised to prevent misuse of the unit.

## Safety

Read and understand these instructions before beginning installation. The unit should be installed by a competent person.

### Location

Check there is space for the unit in your chosen location. The unit must not affect the operation of open-flue

appliances. Consult local regulations or a qualified gas engineer. The open sides of the diffuser must face a minimum 1m unobstructed path away from any smoke detectors. If the diffuser cannot be repositioned, up to two sides can be closed using the plastic blanking plates. In this configuration the open sides must face a minimum 1.5m unobstructed path away from any smoke detectors. In properties with a floor above 4.5m fire diffusers must be fitted a minimum of 1m away from the smoke detectors instead of the included plastic diffusers. Partition walls between buildings must be complete with any breaks filled. In properties with a floor more than 4.5m above ground level the unit must be wired into a smoke alarm (see page 12 for wiring information) The appliance is considered suitable for use in countries with a warm damp equable climate, but may also be used in other countries.

### Wiring Regulations

All wiring must comply with Building Regulations and the current IET Wiring Regulations (BS7671 in the UK) or equivalent standards for other countries. The final installation should be examined and tested by a qualified electrician.

This product is not suitable for use with a Type AC RCD 

### Electrical Connection

The unit must be earthed and a suitable isolator with a minimum contact separation of 3.0mm must be used to provide insulation for the unit. The unit must be able to be disconnected from the mains supply after installation. When wiring the unit, the included unswitched fuse spur should be incorporated in the fixed wiring. The power supply cable running into the unit must remain the supplied flexible cable (not a solid core lighting cable). If the power supply cable becomes damaged, it must be replaced by EnviroVent, an authorized service agent for your region/country, or a similarly qualified person in order to avoid a hazard. Do not remove or tamper with any electronic components inside the product.

### Users

The unit is not intended for use by persons (including children) with reduced physical, sensory or mental capabilities or lack of experience and knowledge, unless they have been given supervision and usage instruction by a person responsible for their safety. Children should be supervised to ensure they do not play with the unit. Cleaning and user maintenance must not be performed by children.

### Diagrams

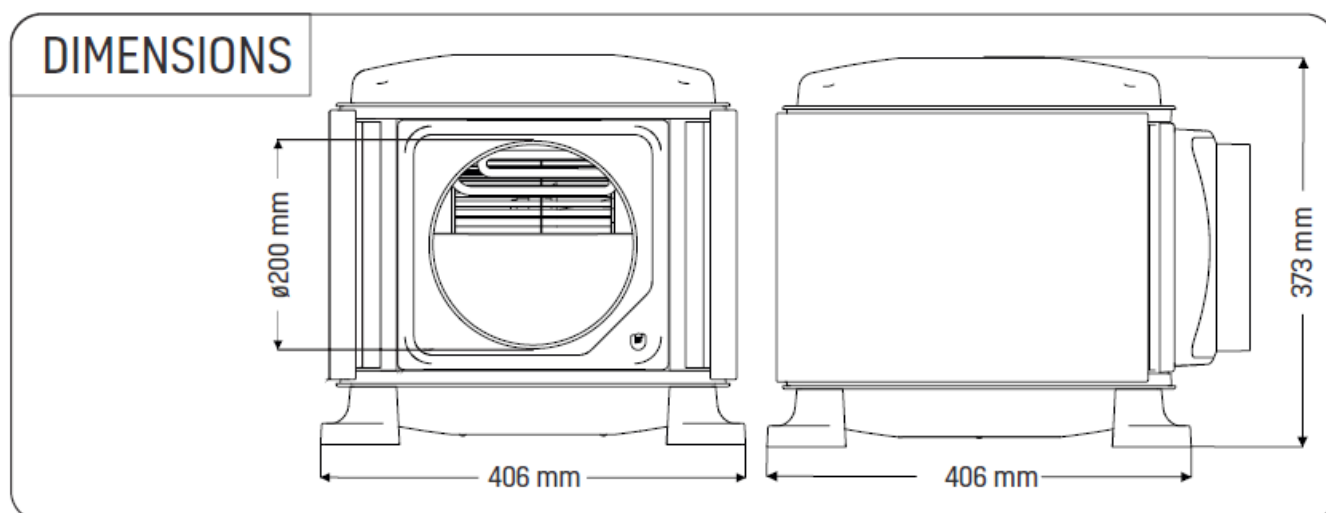

### KEYPAD

1. Airflow 1
2. Airflow 2
3. Airflow 3
4. Airflow 4

- 5. Temperature <190C
- 6. Temperature >190C
- 7. Temperature >250C
- 8. Top button
- 9. Numeric Display
- 10. Bottom button

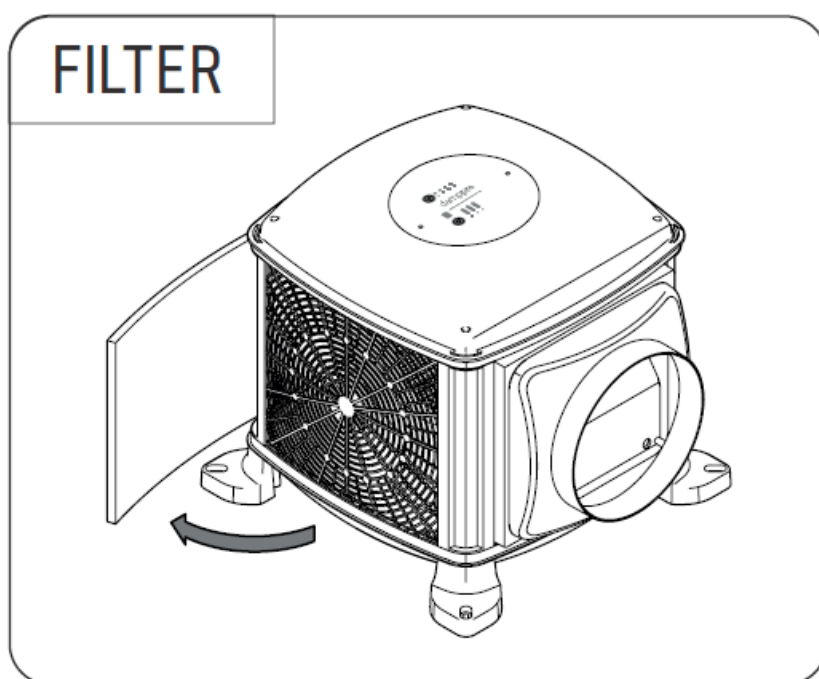
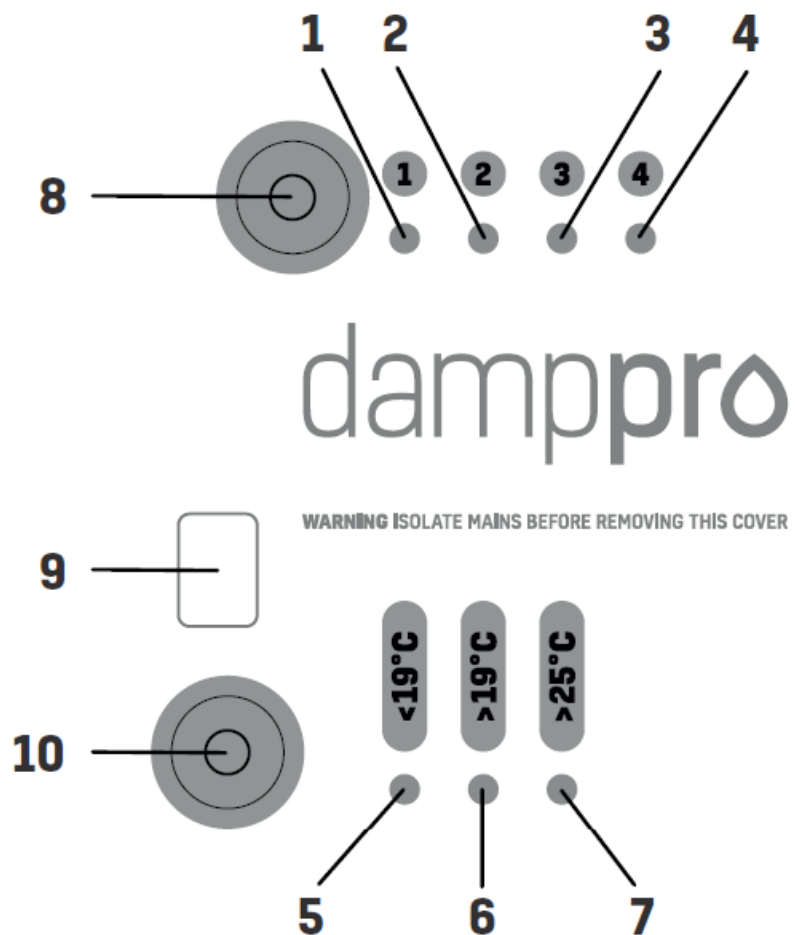

## WIRING

## VENTILATION UNIT

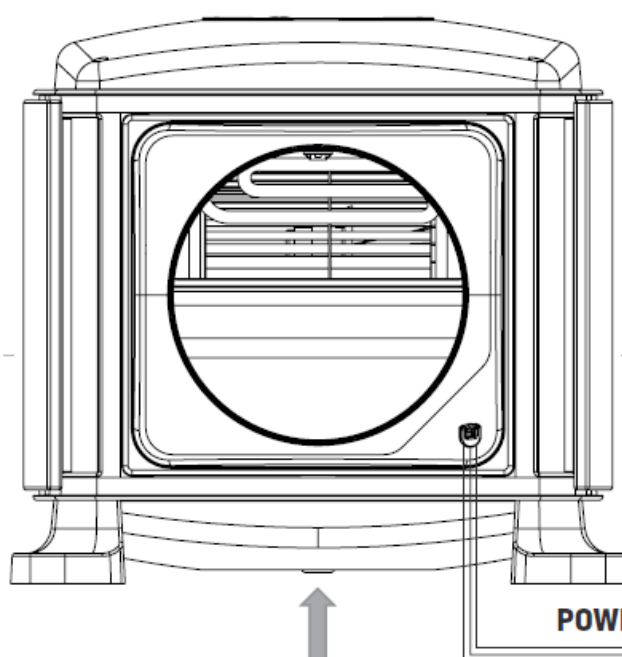

## LOCAL ISOLATOR

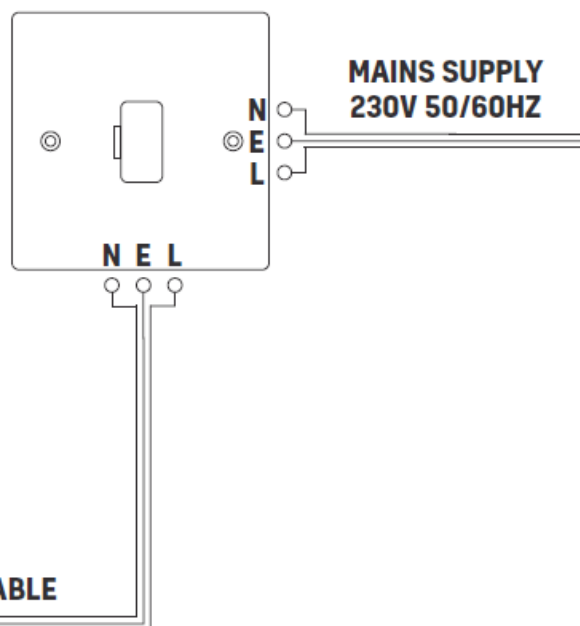

**MAINS SUPPLY**  
**230V 50/60HZ**

**POWER CABLE**

**TO CONNECT OPTIONAL HEATER ENABLE CABLE SEE**

### STEP 1 TO 4

The local isolator must be connected to the mains as part of the fixed wiring. Connect the N, L and E cores of the power cable to the matching terminals on the local isolator.

**1**

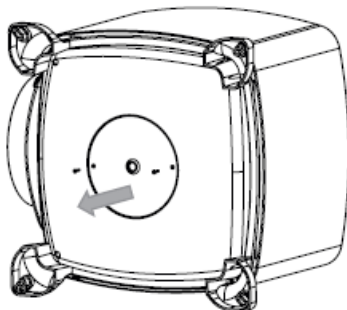

Remove base cap [two screws]

**2**

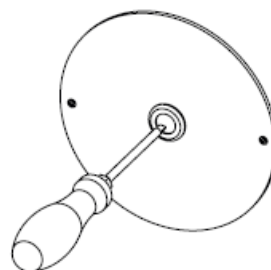

Make small hole in grommet  
and thread 2 core cable through

**3**

**BLUE WIRES**      **RED WIRES**

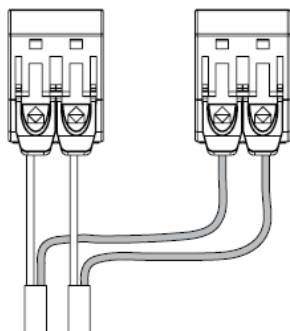

Heater enable  
Volt free  
connection

Wire in 2 core cable

**4**

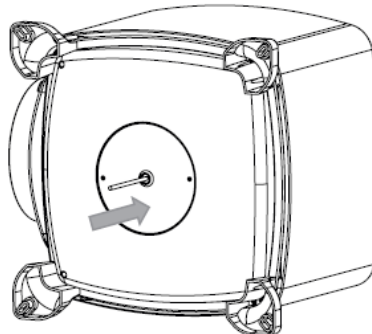

Replace base cap [two screws]

**Box contents**

- 1x Ventilation unit
- 1x 200mm diffuser (+ 2x blanking plates)
- 1x Instruction guide
- 1x Diffuser mounting template
- 1x Flexible duct (1m x 200mm dia.)
- 1x Unswitched fuse spur
- 1x Remote control (With DP-EVL-H-W unit only)
- 8x Foam pads
- 4x Washers
- 4x Screws 10g x 3"
- 4x Screws 10g x 1.5"
- 4x Screws 8g x 1.5"
- 4x Screws 8g x 1"
- 4x Plasterboard plugs
- 1x Roll of fixing tape

### **Pre – Installation Checklist**

- Does the unit fit through the loft hatch?
- Check there are no obstructions in the hallway or landing where the diffuser is to be fitted and in the loft space above.
- Ensure the loft has adequate cross-flow ventilation to provide a supply of fresh air to the unit.
- Check that all partition walls are intact. Seek building advice if any are missing or broken.
- Check for flued appliances drawing air from the loft, the user should be made aware of any of these.
- Check that any flue passing through the loft is undamaged. Seek building advice if any are damaged or broken.
- Repair any ceiling gaps which allow air leakage into the loft.
- Ensure any loft water storage tanks are covered and sealed.

### **About the ventilation unit**

The damp pro loft unit is a Positive Input Ventilation (PIV) unit which creates healthy living environments by supplying filtered air into a property at a continuous rate through a ceiling mounted diffuser. The diffuser is normally installed in a hallway or landing area. The units have been developed to improve indoor air quality and reduce condensation and mold problems. In conditions between 19°C – 25°C the units will increase air flow rate by 10%. In hot conditions above 25°C the units will temporarily switch off to avoid bringing hot air into the property from the loft space.

### **Installation**

Ensure the open sides of the diffuser face an unobstructed path of at least 1m away from smoke detectors. If repositioning is not possible, up to two sides can be closed using plastic blanking plates. For properties with a floor above 4.5m, fire diffusers must be placed a minimum of 1m away from smoke detectors.

1. Place a dust sheet below the required ceiling diffuser position and check the ceiling below and loft space above are unobstructed.
2. Mark a 222mm diffuser hole using the template.
3. Wearing a dust mask and eye protection, cut out the hole.

4.

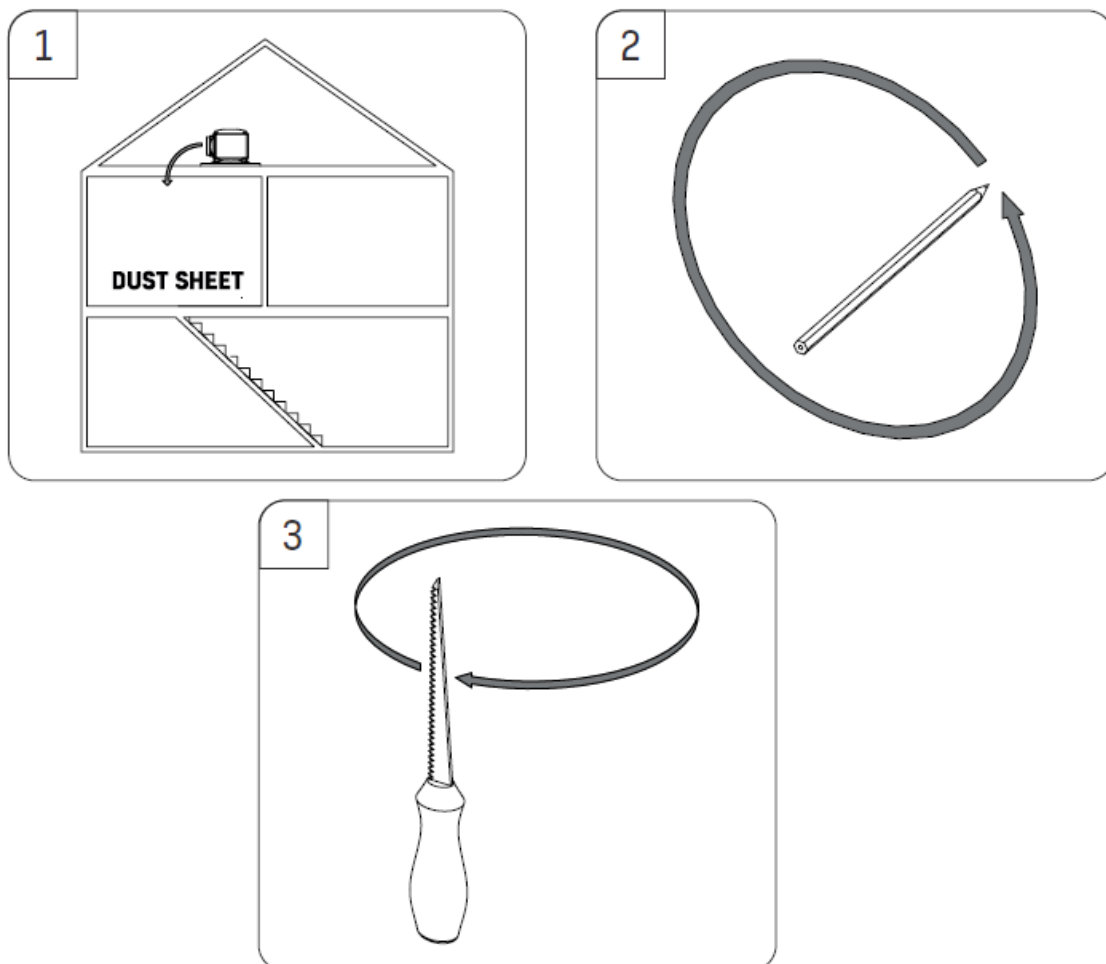

- a) Screw the feet of the unit onto two 25mm x 50mm wood battens using the four 10g x 1.5" screws. (Battens not supplied).
- b) Position the unit with anti-vibration pads and washers onto the loft ceiling joists as in the diagram.
- c) Screw the unit to the ceiling joists using the four 10g x 3" screws.
- d) If the loft insulation sits above the joists and impedes the unit, create a raised wooden platform to mount onto.

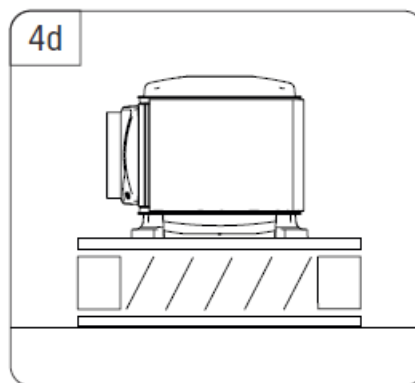
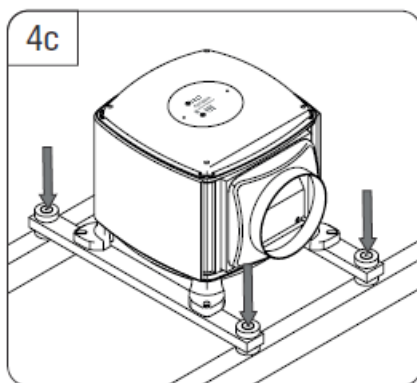
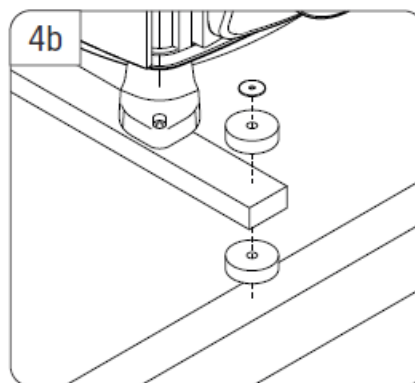
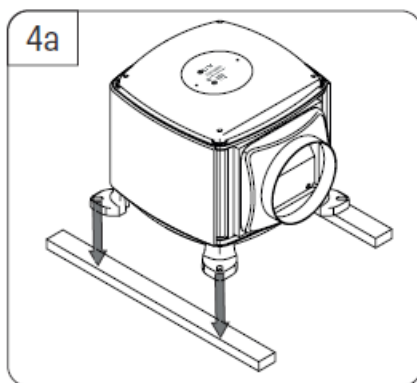

5. Insert the diffuser spigot into the ceiling hole so that the diffuser outlets face towards the walls then mark the four fixing holes.
6. Attach the duct to the spigot of the diffuser and seal the connection using the tape supplied.
7. Insert the diffuser spigot into the hole then fix it in place.  
Use the four plasterboard plugs and four 8g x 1.5".  
Then clip the diffuser cover into the diffuser spigot.
8. Attach the flexible duct to the spigot on the unit and ensure it is pulled taut. Seal the connection tightly using the tape supplied. Cut the duct to length if required.

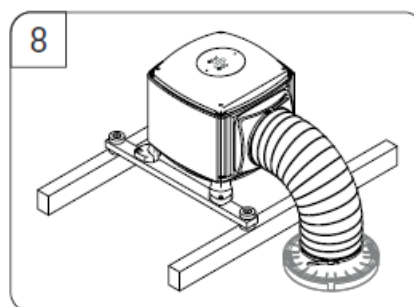
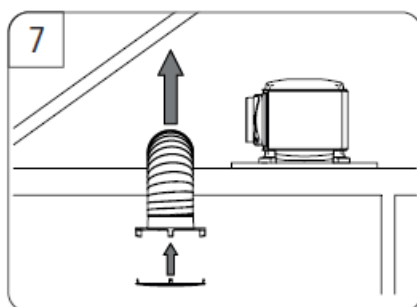
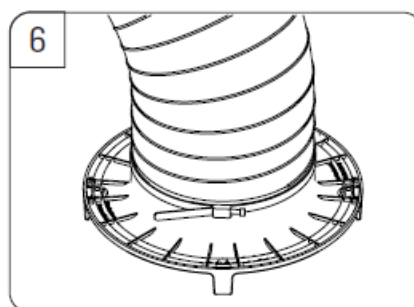
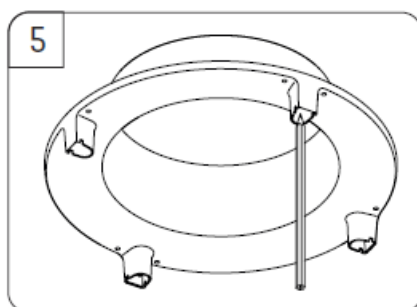

9. With the mains supply isolated, wire the power cable into the unswitched fuse spur then wire the unswitched fuse spur into the mains supply (see wiring diagram on page 4).  
Use two of the 8g x 1" screws to attach the spur to a loft joist.
10. Optional step for DP-EVL-H model  
The DP-EVL-H units can be wired to a heater enable switch (not included). Wire into the connection located



under the unit (see Page 4, cable not included) and fit it in an accessible area.

Do NOT wire into mains or any other power source.

Use two of the 8g x 1" screws to attach the switch to the wall.

11. Reconnect the mains supply at the local isolator. After a few seconds air will begin to flow from the diffuser (see page 13 for air flow rate settings).

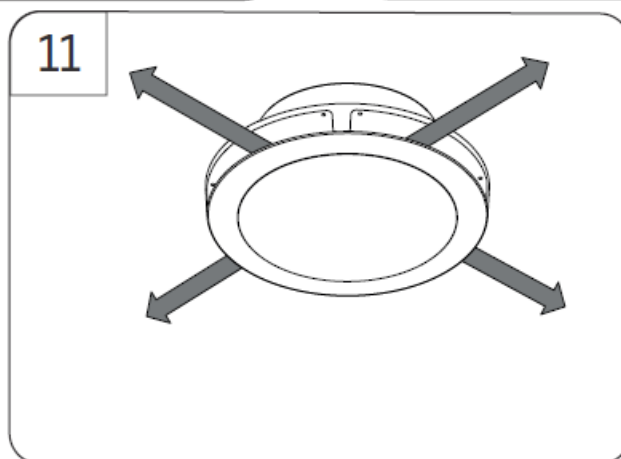
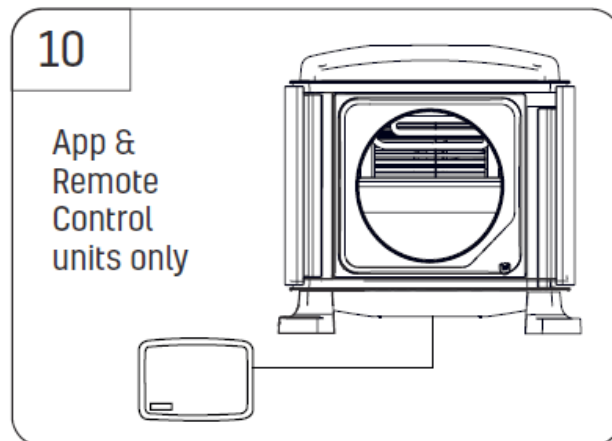
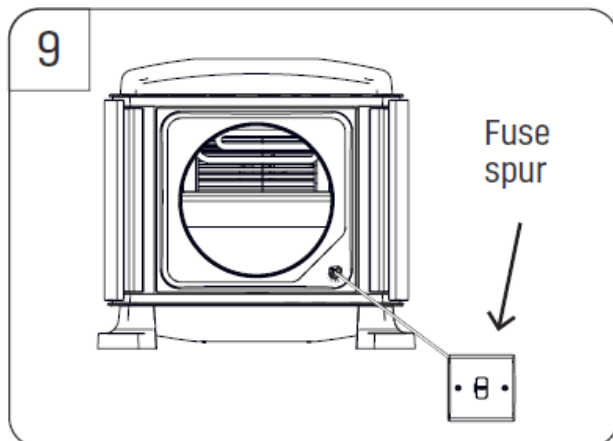

## Fire Safety

### Fire Kits

For installations with a floor more than 4.5m above ground, a compatible fire kit must be fitted.

**The kits listed below contain all the extra parts and instructions required:**

Order Code	Description
KIT-PIV-SMOKE-200	200mm fire-rated diffuser for PIV units only

### Smoke Alarms

For installations with a floor more than 4.5m above ground, the unit must be wired into a smoke alarm in order to switch the unit off upon the detection of smoke.

The unit can be wired into an existing smoke alarm (check compatibility with the smoke alarm manufacturer). All wiring should be completed by a competent person.

To test the installation, press the TEST button on top of the smoke alarm and keep it pressed until the PIV unit switches off (LEDs on the board go out).

### Wireless Remote Control (DP-EVL-H-W only)

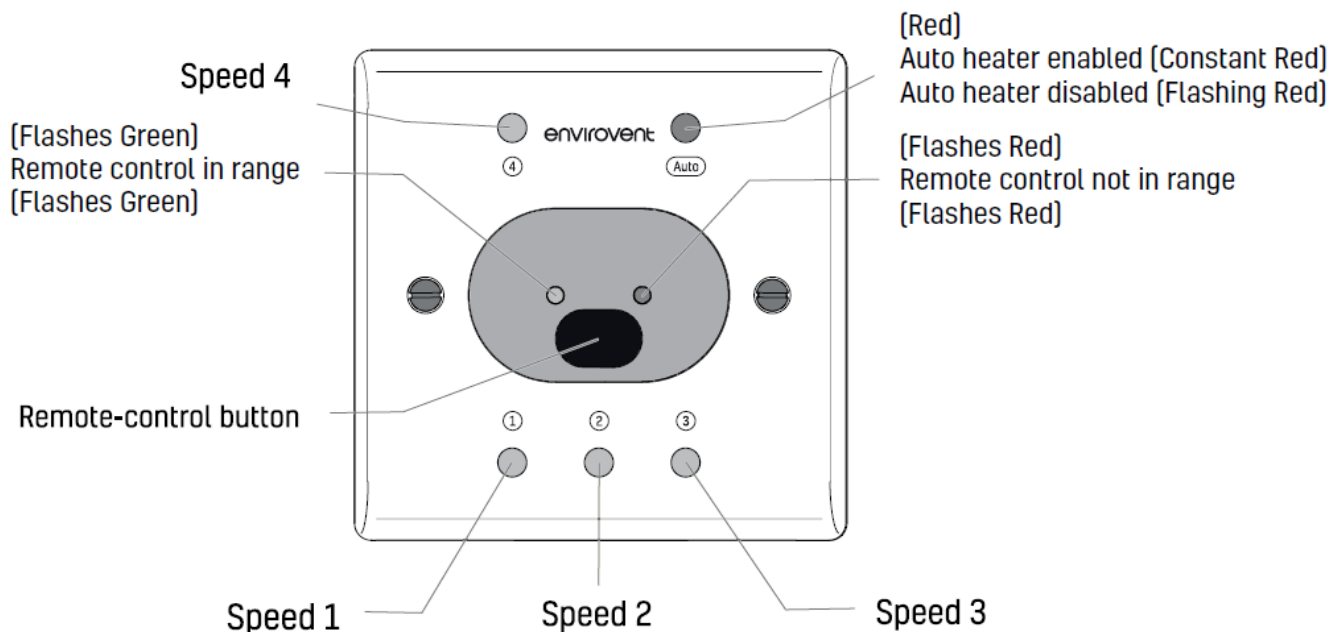

#### To indicate the current status of the unit:

- Press the remote-control button once and the LEDs will light up according to the current status of the unit.

#### To modify the air flow rate:

- Press the remote-control button once
- Further presses will then cycle the unit through each of the air flow rate settings – 1 , 2 , 3 , 4
- Further presses will cycle back through the same settings

#### To enable/disable the automatic comfort heater function:

- This function is enabled by default.
- Press the remote-control button once.
- Press again for 5 seconds to disable comfort heater function.
- AUTO LED will flash red for 5 seconds.
- Press again for 5 seconds to enable comfort heater function.
- AUTO LED will light constant red for 5 seconds.

#### Pairing an additional remote-control:

1. Turn the unit off at the isolation point.
2. Restore power; for 20 seconds from restart the unit will be in pairing mode.
3. Press the remote-control button once within the 20 seconds and the control will pair to the unit.
4. Successful pairing is indicated by a green light on the remote.

#### Remote-control batteries

When the battery needs to be replaced, unscrew the switch front cover. The battery is located on the back of the cover. Battery type 3V Lithium CR2032. The switch will remain paired with the unit after battery replacement. Ensure the new battery is inserted with correct polarity, and the removed battery is safely disposed of.

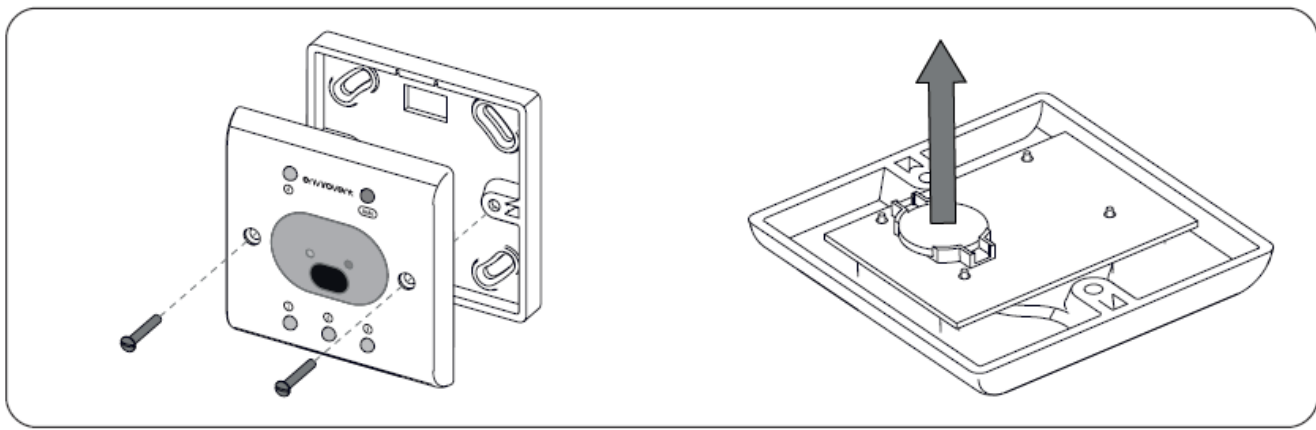

### Wired comfort heater enable/disable (DP-EVL-H only)

A switch to enable/disable the heater function can be connected up to 3 meters away from the unit. This must be a volt free contact. Do not wire the cable or switch into the Mains. When the switch is pressed on, the comfort heater function is enabled and the system will maintain the incoming air temperature at 10 °C. When the switch is pressed off, the automatic comfort heater function is disabled.

### SMOKE ALARM WIRING

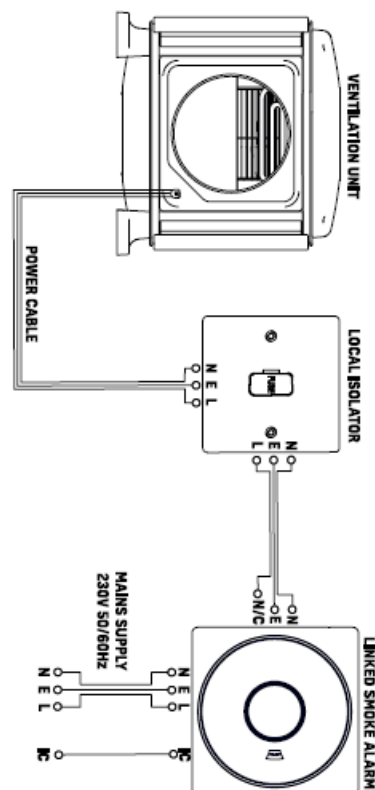

### SETTINGS

#### Top button

- Press to show the current air flow rate setting.
- The corresponding LED will illuminate on the keypad.
- Further presses scroll through the air flow rate settings 1, 2, 3 and 4 on a loop.
- Adjust this according to the size, type and occupancy of the property.

#### Bottom button

- Press to show the total running time.
- The numeric display will illuminate to show the total amount of time the unit has been running. e.g. '1234' (hours)

### Energy Usage and Airflow Performance

House size setting	Max air flow rate (l/s) <sup>a</sup>	Power usage (Watts) <sup>b</sup>
1.	21	4
2.	29	4
3.	38	6
4.	49	9

a Diffuser installed without blanking plates fitted. b Power usage shown with heater function disabled.

### Running costs

Please scan our QR code to see the annual running costs of this product.



Or visit: [envirovent.com/annual-running-costs](https://envirovent.com/annual-running-costs)

### Maintenance

The damp pro loft unit is designed to operate for 5 years before requiring a full service. EnviroVent recommend that filters are checked regularly and replaced as required. Areas with high particulate matter for example industrial areas, or higher-grade filters will become clogged quicker and will need replacing more frequently. Spare and replacement filters must be purchased from EnviroVent. Failure to maintain the unit as recommended may breach the terms of the warranty.

### Spares/Accessories

Item Description	Order Code
Replacement coarse particle filter (ISO Coarse 65%)	FILTERPIV-COARSE
Replacement medium particle filter (ePM10 50%)	FILTERANC-MEDI
Replacement fine particle filter (ePM2.5 50%)	FILTERANC-FINE
Replacement coarse particle filter including carbon(ISO coarse 65% including carbon)	FILTERANC-COARSE+C
Replacement diffuser	1DIFPIV
Fixing kit	FIXINGKITEVL
Heater switch*	HEATER ENABLE SWITCH
Smoke alarm**	1ACSMOKEALARM-KIT

### Warranty

We appreciate you choosing this quality EnviroVent product, which is designed and manufactured to the highest specification in Harrogate, North Yorkshire. We are confident that you will be delighted with the performance of the system and the resulting improvement in air quality in your home after the installation of the unit.

The Damp Pro range are all covered by a full 5-year warranty.

### Supply & Fit

If your fan has been supplied and installed by EnviroVent it is covered with a full Parts and Labor warranty. If you detect a fault, please contact us on 01423 810810. We will provide guidance over the phone, if necessary, a visit from one of our technicians can be arranged. Please note that call-out charges may apply if no fault is identified during the visit. Depending on the circumstances, the visit may need to be organized by the building owner or a local specialist.

### Supply Only

If your fan has been supplied by EnviroVent and installed by a third party, it is covered by a Parts Only Warranty. If you detect a fault and the product has been installed in accordance with the fitting/wiring instructions, please return the product to the place of purchase for a replacement.

### Warranty Conditions & Exclusions apply to all Envirovent Products

If the fault has been caused by any of the below points, EnviroVent are not liable, and the warranty will not cover the unit, and you will be charged for the replacement unit.

- Faults that occur due to improper use, incorrect installations, or negligence.
- Faults that occur due to normal wear of components outside the warranty period, accidental damage, misuse, or abuse to units.
- The customer/homeowner fails to observe and adhere to the instructions in the installation guide and the user resident guide regarding safety, use, start up and maintenance. This includes the checking and changing of filters (check the maintenance section of the installation guide or user resident guide for more information).
- The use of units or parts that have been purchased from an unapproved source, including but not limited to auction websites. This includes using unapproved parts (such as filters) with approved EnviroVent parts. A receipt will be required as proof of purchase.
- Faults that occur from tampering, services or repair work that is completed by somebody without EnviroVent's approval or authorization (this does not include general cleaning).

- Any unit that has been turned off for prolonged periods of time, this can damage the unit – units can be turned off for cleaning or general maintenance if required.

**Your unit serial number** \_\_\_\_\_

You should not dismantle or remove any parts of the product other than those instructed in this guide. Tampering with the unit will void the warranty.

**For all enquiries including faults, please contact your supplier.**

## Notes

### Manufactured by:

EnviroVent Ltd  
Harrogate West Business Park  
Unit 1 Bardner Bank  
Killinghall  
Harrogate  
HG3 2SP

- T / 01423 810 810
- E / [info@envirovent.com](mailto:info@envirovent.com)
- W / [envirovent.com](http://envirovent.com)

For all enquiries including faults, please contact your supplier

### Supplied by:

- Boxed unit weight: 7.7 kg
- Unboxed unit weight: 5.5 kg

### E&OE | MKT ENV357 – V14 – 28.02.25

Due to our policy of continuous innovation and improvement EnviroVent reserves the right to alter products specification and appearance without notice.

### We want to hear from you

Your feedback is important to us as we strive to improve our products, services, and overall customer experience. Please email us to help us serve you better: [feedback@envirovent.com](mailto:feedback@envirovent.com)

## FAQ

- **Q: What should I do if I encounter difficulties during installation?**

A: Contact your supplier for assistance and guidance on installing the unit.

- **Q: Can the unit be used in all countries?**

A: The unit is suitable for countries with warm, damp climates but can also be used in other regions.

## Documents / Resources

 <p>EnviroVent Damp Pro Positive Input Ventilation [pdf] Installation Guide Damp Pro Positive Input Ventilation, Positive Input Ventilation, Input Ventilation</p>	
---	--

References

- [🔍 UK Manufacturer Of Ventilation Systems & Extractor Fans | EnviroVent](#)
- [🔍 Ventilation System Annual Running Costs | EnviroVent](#)
- [User Manual](#)

[Manuals+](#), [Privacy Policy](#)

This website is an independent publication and is neither affiliated with nor endorsed by any of the trademark owners. The "Bluetooth®" word mark and logos are registered trademarks owned by Bluetooth SIG, Inc. The "Wi-Fi®" word mark and logos are registered trademarks owned by the Wi-Fi Alliance. Any use of these marks on this website does not imply any affiliation with or endorsement.