



ENVIRO C60 Fireplace User Guide

[Home](#) » [Enviro](#) » ENVIRO C60 Fireplace User Guide 

Contents

- [1 ENVIRO C60 Fireplace](#)
- [2 Product Information](#)
- [3 Product Usage Instructions](#)
- [4 Minimum Venting Requirements](#)
- [5 Fireplace Dimensions](#)
- [6 Framing & Clearances – CSS Side Vent](#)
- [7 Installation](#)
- [8 Documents / Resources](#)
 - [8.1 References](#)
- [9 Related Posts](#)



ENVIRO C60 Fireplace



Product Information

Specifications

- **Model Number:** C-16873 C60

- **Product Name:** C60 Fireplace
- Installation Reference Guide
- **Minimum Framing Dimensions:**
 - **Depth:** 20" (508 mm)
 - **Width:** 71" (1397 mm)
 - **Header Height:** 38" (965 mm)
 - **Rough Opening Height:** 43.5" (1105 mm)
 - **Enclosure Ceiling:** 72" (1829 mm)
- **Vent Size:** Co-axial 5 x 8
- **Clearance to Combustibles:**
 - A – Finishing edge to side wall: 7" (229 mm)
 - B – Minimum clearance to enclosure ceiling: 72" (1829 mm)
 - C – Minimum clearance to mantel height: See Chart
 - D – Front of door to edge of floor protection: 0" (0 mm)
 - E – **Minimum alcove width:** 76" (1930 mm)
- **Non-Combustible Board Placement:**
 - **Framing:** Metal Stud
 - **Concrete Board:** COMBUSTIBLE – 5 3/16"
 - **Sidewall Drywall:** NON COMBUSTIBLE – 13 3/4"
- **Minimum Venting Requirements:** 20" (509 mm)
- **Fireplace Dimensions:**
 - **Mantel Projections:**
 - 62" [1575mm]
 - Do not use two 12 vent sections or this dimension will not work. Use one 24 section.
- **Optional Step Cool Surface System Part 1 Dimensions:**
 - 2/9/11/7/58/63/51/2/3/2/
- **C60 CSS Front Vent – Overall Dimensions:**
 - 12.18
 - 2 7/12.24
 - 4.75 4.75
 - 1.39
 - 13.64 14.92
 - 8.00
 - 0.50
 - 2.63
 - 0.88
 - 6.07
 - 8.42 7.67
 - 6.17
 - 9.75
 - 36.00 36.00
 - 4.75 26.00
 - 4.75

- 9.95
- 9.75 2.48
- 10.72
- 4.65
- .49
- 14.39
- 7.47 9.75
- 36.00
- 11.74 36.00

• **CSS Side Vent – Dimensions:**

- 2.48 .49
- 2.48 .49 .50
- 4.75 2.48 9.75
- 36.00 36.00
- 4.75
- .49
- 9.75 36.00 2.48 4.75
- .49
- 36.00
- .50
- 36.00
- 36.00
- 26.00
- 26.00
- 4.75
- 4.75
- 4.75
- 36.00
- 26.00
- 9.95
- 4.75
- 2.00

• **C60 CSS Combustible Facing Kit Dimensions:**

- 26.00 9.95 4.75
- .92
- 26.00 9.95
- 2.48
- .49 .49
- .50 2.48 2.48
- .49.49
- .50 .49 .50
- 2.48 4.75 2.00
- 4.75 2.00

- 2.00
- .50 .92
- 2.48
- 2.00 4.75
- .50 .92 .50
- 4.75
- .92 .50

- **Optional Step Cool Surface System Part 2:**

- CSS Outlet Min. Top and Bottom standoff = 25/8 (6.7 cm) *All C Series*
- C60 = 71 (180 cm) C60 = 63 1/4 (161 cm)

- **Steel Stud:** 7 1/2 (2.5 cm)

- 2 x 4 (On Edge): 37 1/4 (94.6 cm)

- **Min. Height C60 Outlet Finished Opening Size:** 3 8 (1 cm)

- C34 – 33 (83.8 cm) C44 – 43 (109.2 cm) C60 – 59 (149.9 cm)

- **C60 Venting Clearances – Front Vent:**

- 80 (203 cm) Minimum Ceiling
- 91 (231 cm) C72 Min. Ceiling
- 2 3/4 (69.8 cm)
- 5 5/8 (14.3 cm)

- **Shown here are the minimum framing and clearances for the CSS when the fireplace is installed with the minimum allowable vent length:**

- 73 1/4 (174.9 cm) Side Brace Min. Height
- 39 (99 cm) Min. Length 5 dia. flex vent (not supplied)
- Min. Vent 20 (50.8 cm) Min. Depth

- **Optional Step Cool Surface System Part 3:**

- C34 = 45 (114cm) C44 = 55 (140cm) C60 = 71 (180cm) C72 = 83 (211cm)
- Min. Height 51-3/8 (130cm)

- **Min. Height to Ceiling:** 14.50

- 15.00 (38cm) Min. to Ceiling 5 (12.5cm)

- 11.50 (29cm) 3/4 (2cm) Gap Shown

- Min. Ceiling Height 18.75 (48cm)

- 11.5 (29cm) Min. Distance to wall from standoff 5.00 (13cm)

- Min. Distance to Ceiling 4.5 (11.5cm)

Product Usage Instructions

Minimum Framing Dimensions

Depth	20"	508 mm
Width	71"	1397 mm
Header Height	38"	965 mm
Rough Opening Height	43.5"	1105mm
Enclosure Ceiling	72"	1829 mm

Note: Vent size = Co-axial 5 x 8"

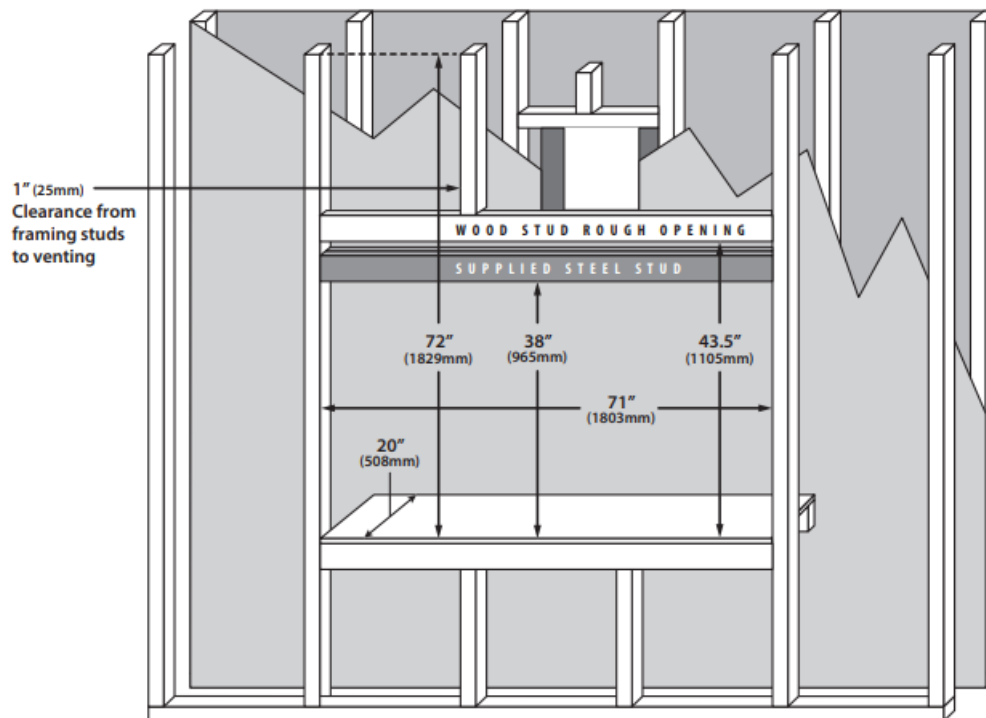

Clearance to Combustibles

A - Finishing edge to side wall	7"	229 mm
B - Minimum clearance to enclosure ceiling	72"	1829 mm
C - Minimum clearance to mantel height	See Chart	See Chart
D - Front of door to edge of floor protection	0"	0 mm
E - Minimum alcove width	76"	1930 mm

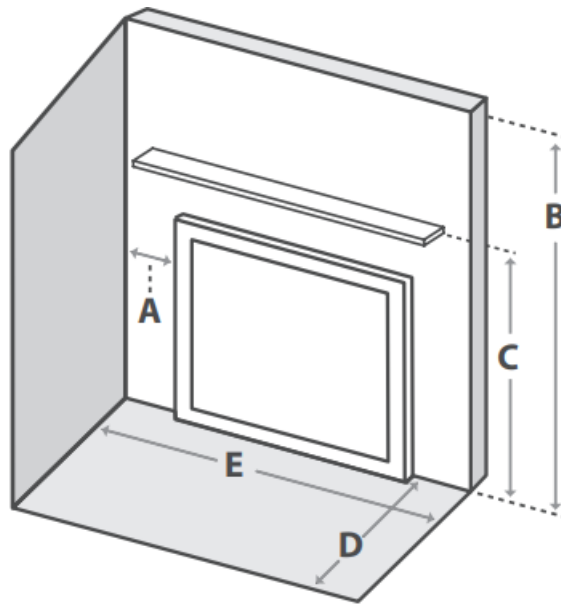

Non-Combustible Board Placement

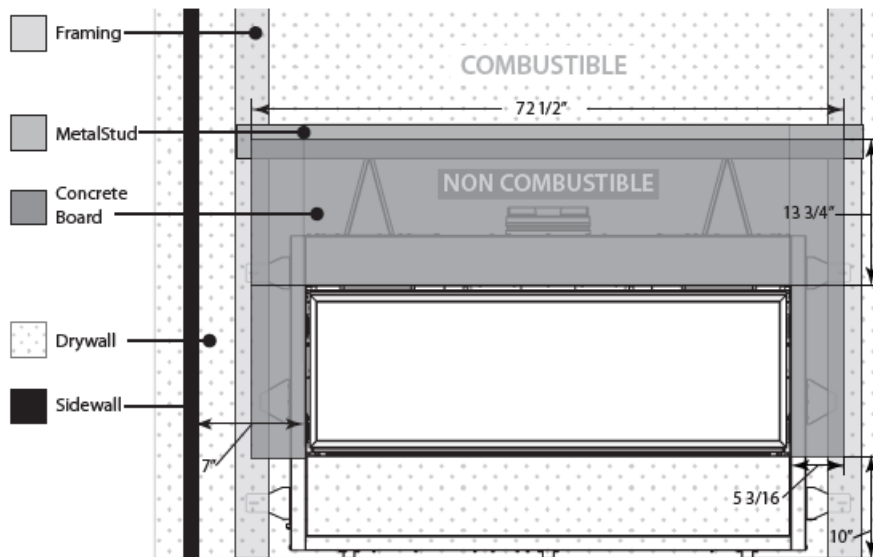

Minimum Venting Requirements

Minimum permitted venting is shown below. The framing height to the center of the thimble is 62". Minimum venting must include a 24" vertical section and a 90 degree elbow which is then terminated horizontally. For a vertical termination please follow the vent pipe manufacturer's installation instructions for vertical vent termination framing. A minimum of 1 in. (25 mm) clearance on all sides of the vertical vent pipe must be maintained. For every 12" of horizontal run there must be a 1/4" of rise. 1" of clearance between framing and venting must be maintained at all times. 2" above the venting and 3" above an elbow.

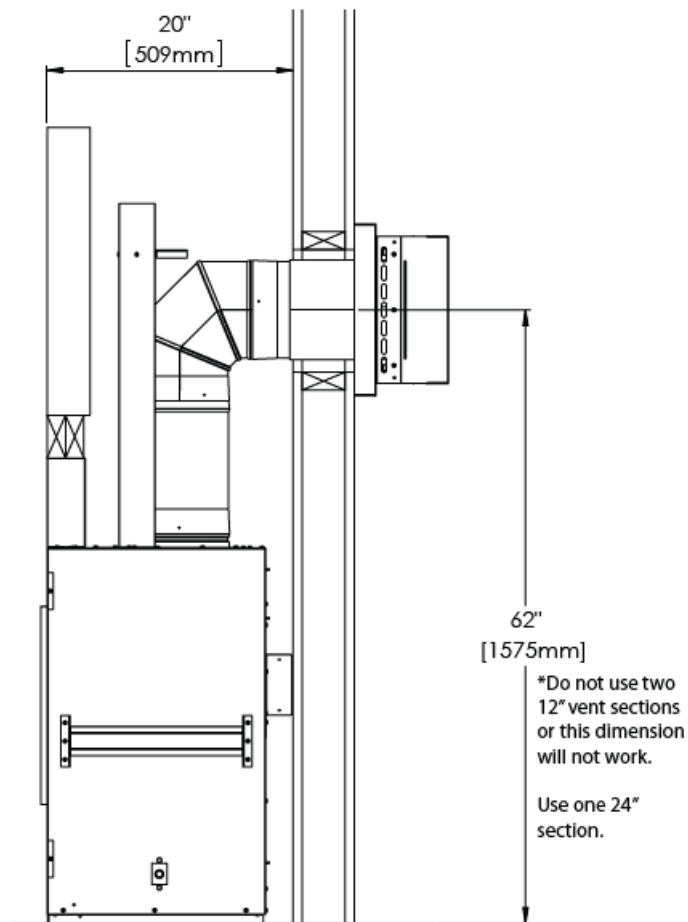

Fireplace Dimensions

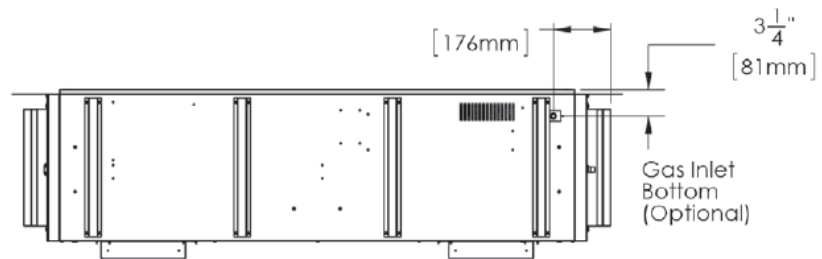
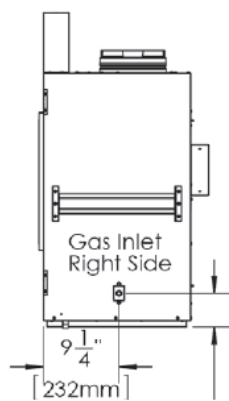
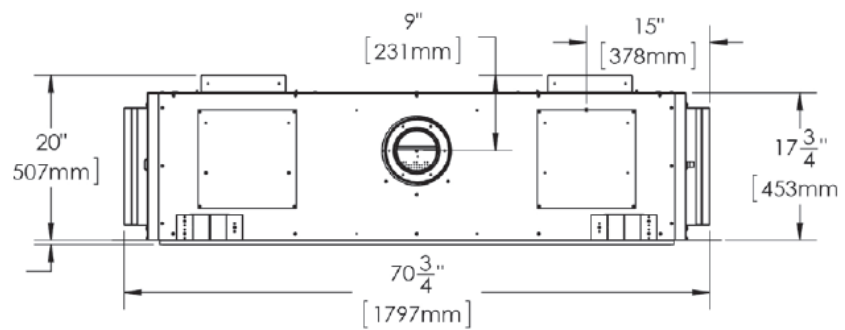

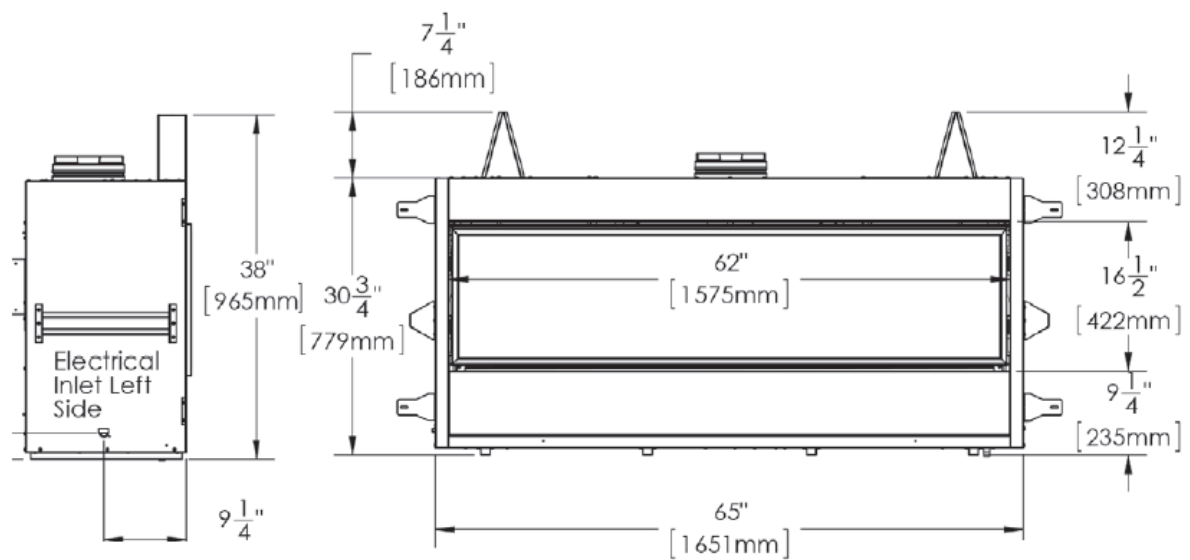

Mantel Projections

Mantel graph dimensions are measured from the bottom of the fireplace, if you wish to reference the mantel height from the tiling edge subtract 15 inches (381mm) from the mantel height depicted on the graph. If you plan to install a TV above your fireplace refer to the appropriate section of the owner's manual for available options. It is acceptable to install a combustible mantel over top of the non-combustible board. If you are activating the Cool Surface System you are eligible to subtract 12" (305mm) from the mantel height shown in this diagram. See page 6 for more details.

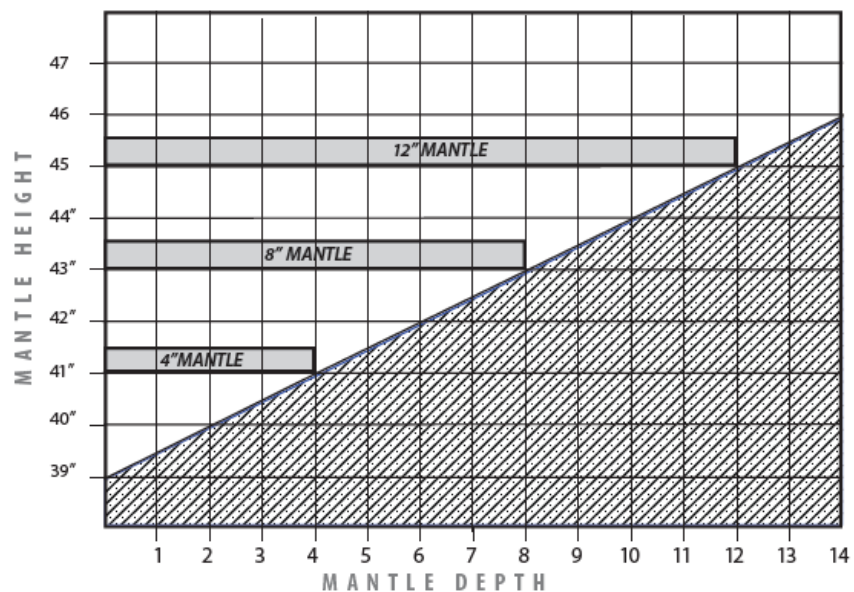

Dimensions

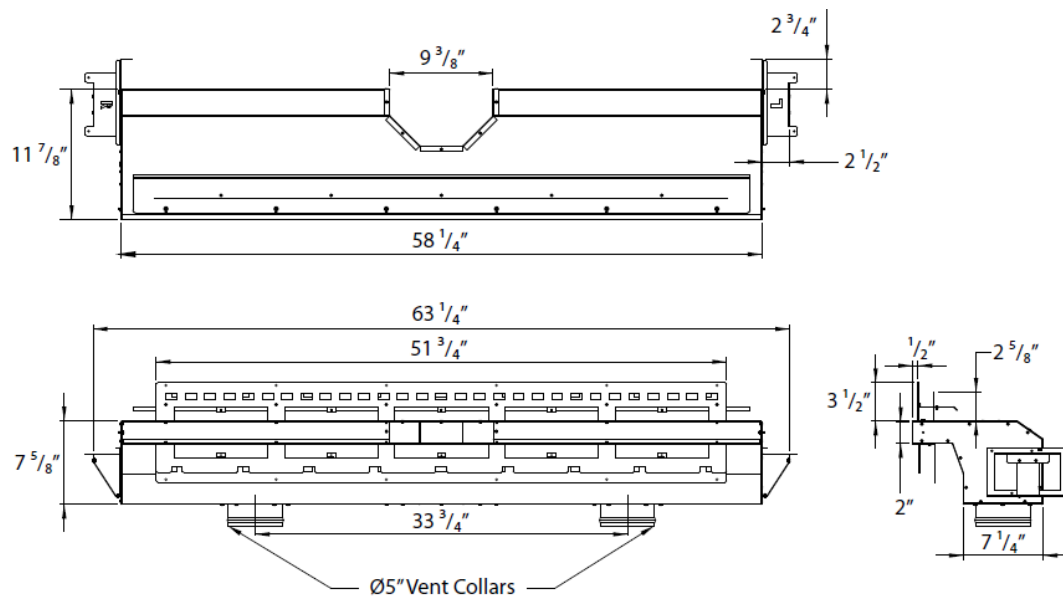

C60 CSS Front Vent – Overall Dimensions

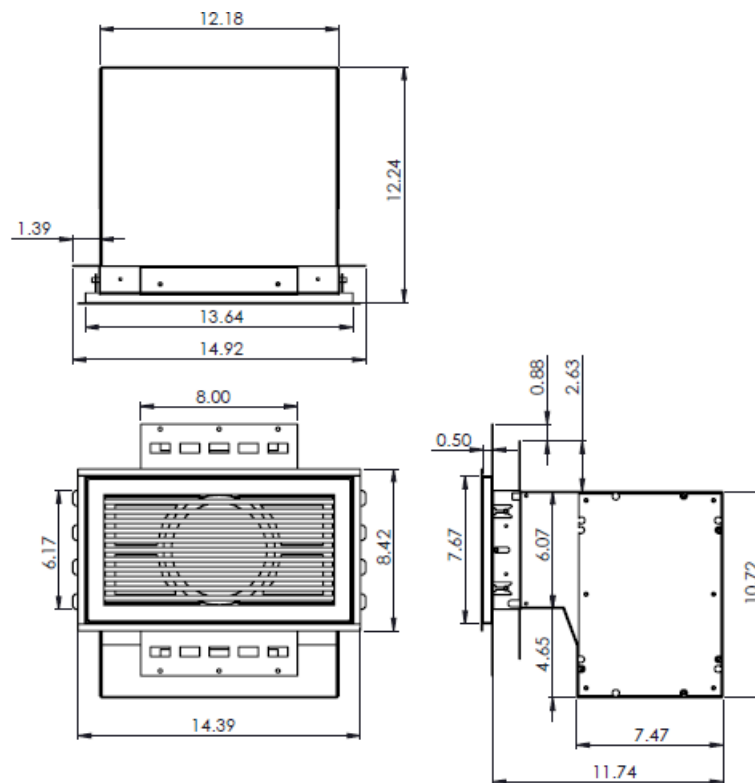

CSS Side Vent – Dimensions

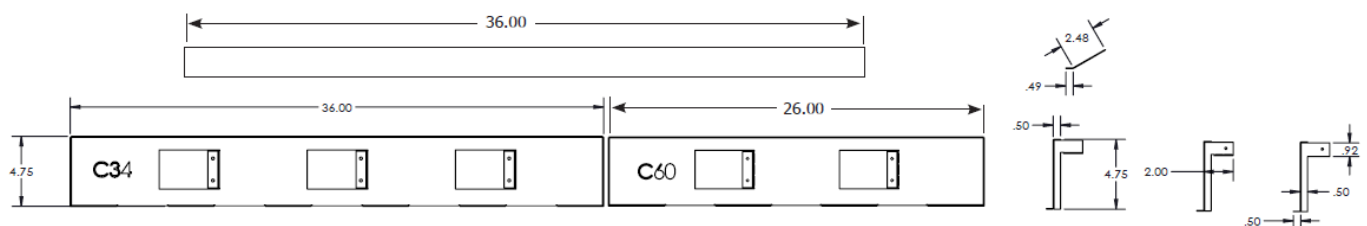

C60 CSS Combustible Facing Kit Dimensions

Framing & Rough Opening – Front Vent

CSS Outlet Min. Top and Bottom standoff = 25/8" (6.7 cm) *All C Series*

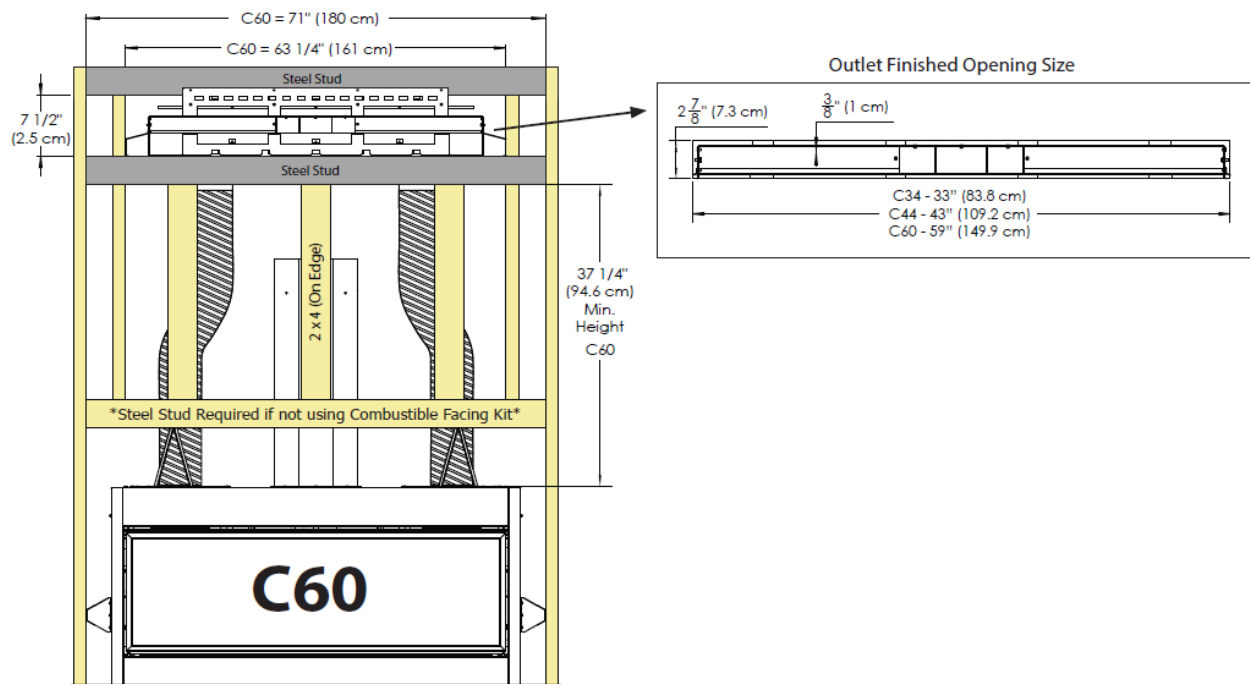

Venting Clearances – Front Vent

Shown here are the minimum framing and clearances for the CSS when the fireplace is installed with the minimum allowable vent length: Min. Ceiling Clearance from top of CSS outlet = 4" (10.2 cm) Min. Ceiling Clearance in wall from top of CSS Body = 55/8" (14.3 cm) CSS Body Min. Rear standoff = 2 3/4" (69.8 cm)

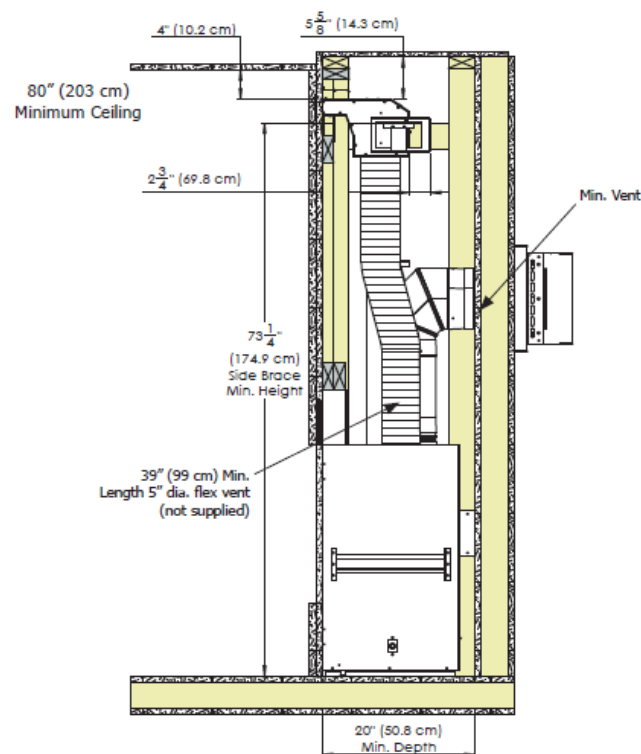

Framing & Clearances – CSS Side Vent

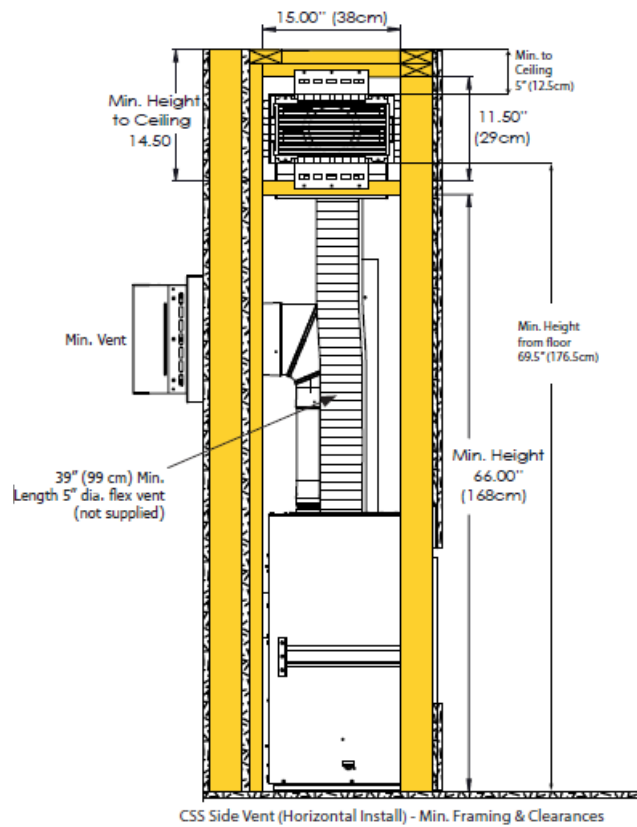
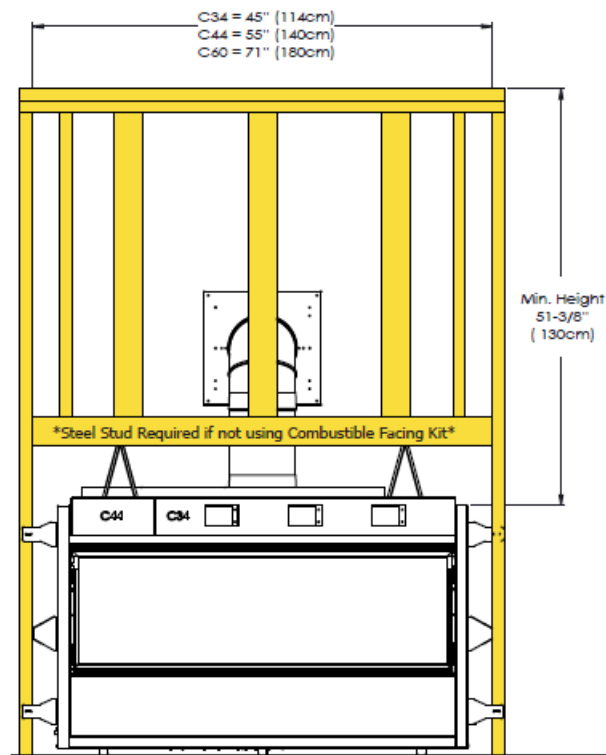

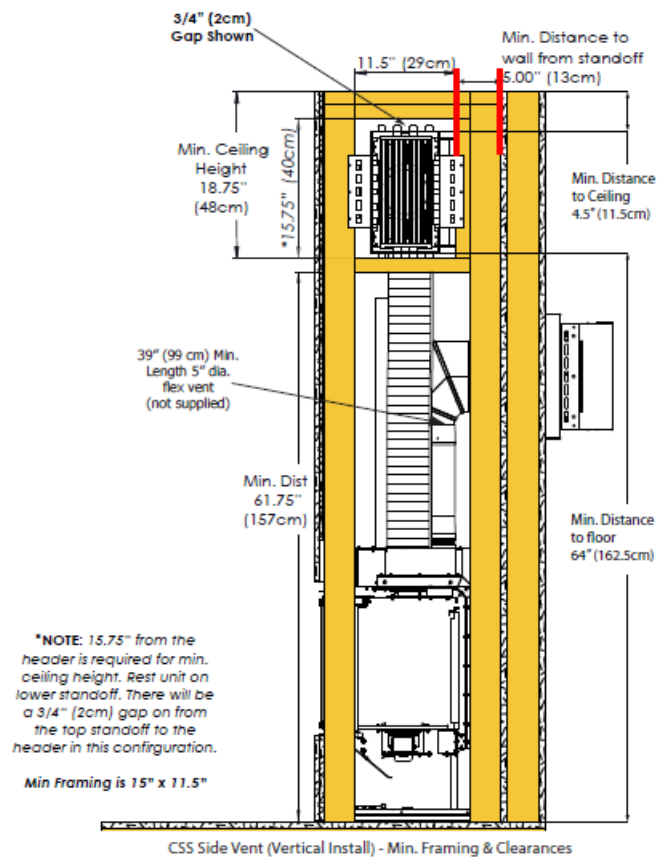

Framing & Revised Mantle Clearances – Front Vent

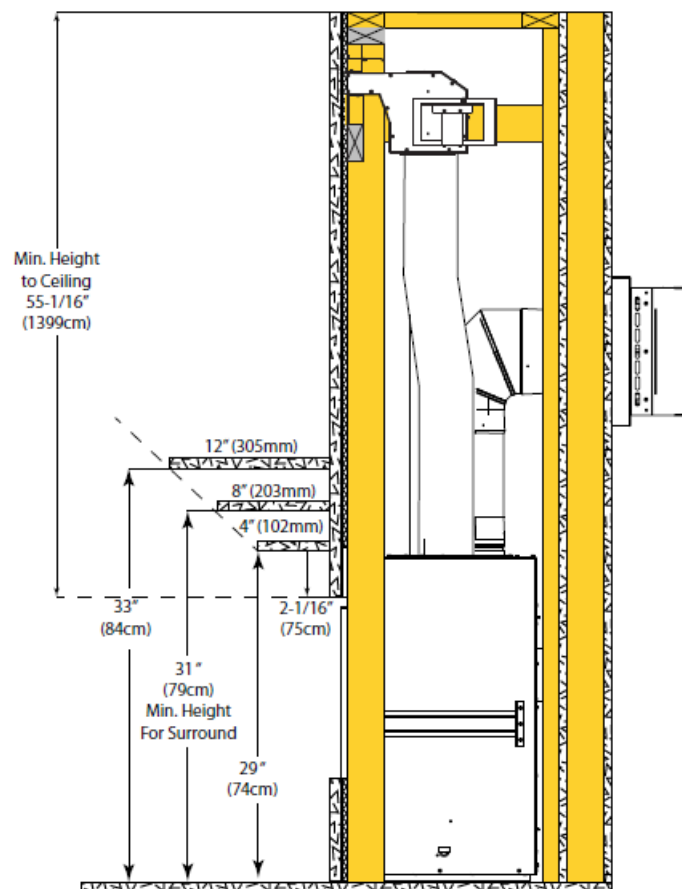

Framing & Revised Mantle Clearances – Side Vent

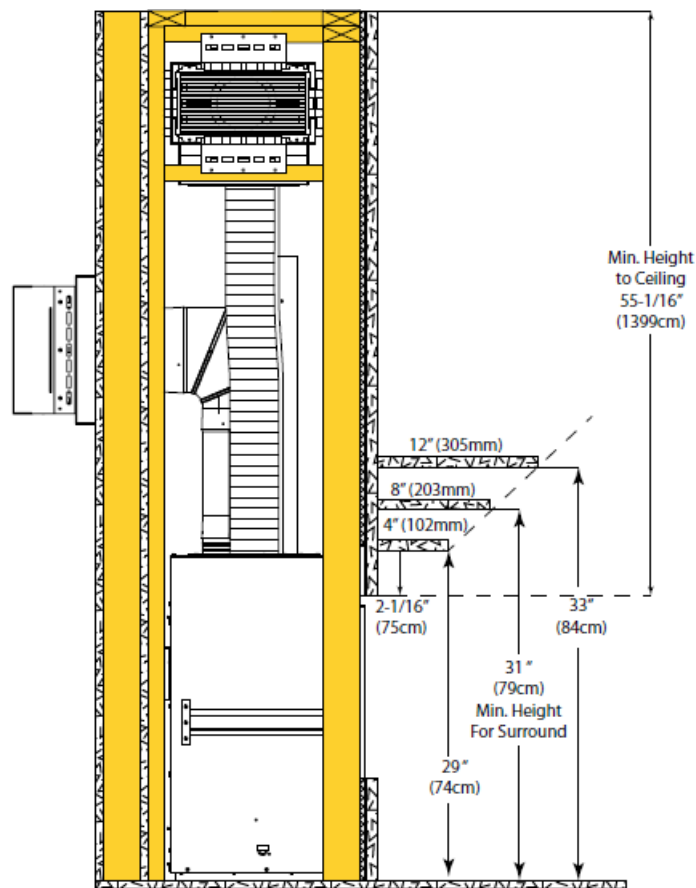

Installation

1. Refer to the owner's manual for specific installation requirements and additional product instructions.
2. Ensure minimum framing dimensions are followed:
 - **Depth:** 20" (508 mm)
 - **Width:** 71" (1397 mm)
 - **Header Height:** 38" (965 mm)
 - **Rough Opening Height:** 43.5" (1105 mm)
 - **Enclosure Ceiling:** 72" (1829 mm)
3. **Make sure to maintain the specified clearances to combustible materials:**
 - A – **Finishing edge to side wall:** 7" (229 mm)
 - B – **Minimum clearance to enclosure ceiling:** 72" (1829 mm)
 - C – **Minimum clearance to mantel height:** See Chart
 - D – **Front of door to edge of floor protection:**

TV Installation Considerations

If you are planning to mount a TV above your fireplace some considerations must be made to ensure it is protected from the heat. During testing temperatures did not exceed 121°F (49°C) midway up the front wall (see figures on right). There is no guarantee that these temperatures will not harm the longevity of your TV. Make sure to consult your TV manufacturer's specifications to find the maximum allowable operating temperature. Since every home and installation is unique, temperatures should be verified at the time of install if possible. If desired, front wall temperatures can be lowered to 104°F (40°C) with the use of a mantle (see CSS TV clearances with Mantle figure). See revised mantle clearances chart above. A TV should not be installed if temperatures exceed the manufacturers maximum allowable temperature.

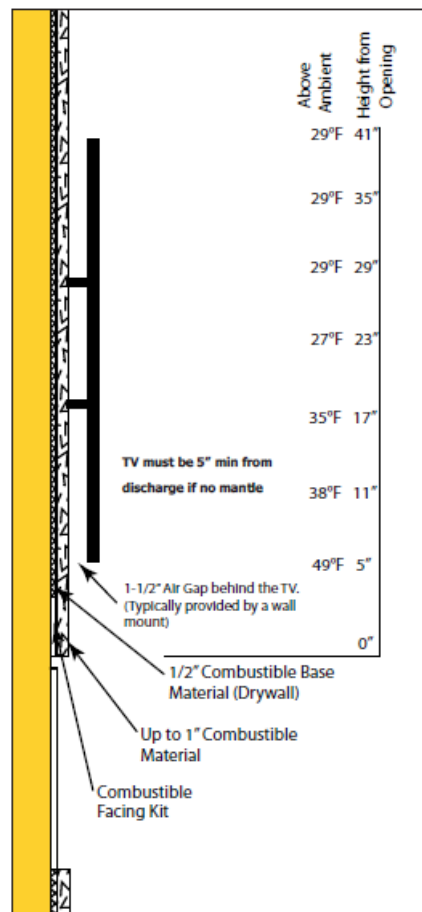

CSS - TV Clearances

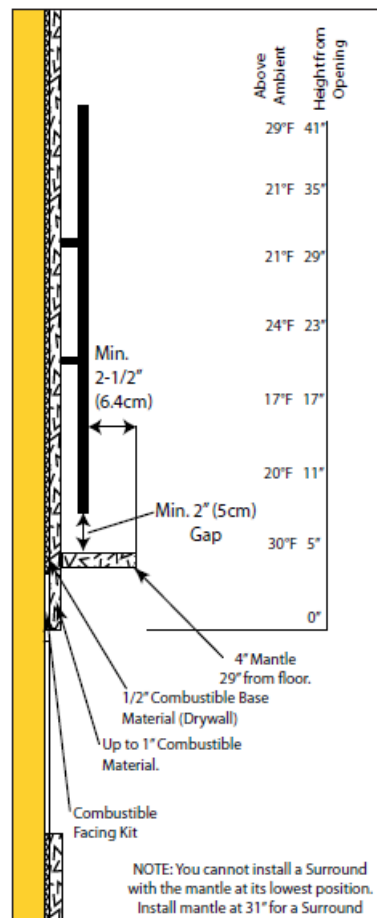

CSS - TV Clearances with Mantle

Documents / Resources

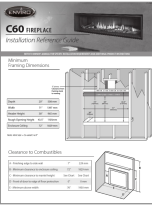
	<p>ENVIRO C60 Fireplace [pdf] User Guide C60 Fireplace, C60, Fireplace</p>
---	--

References

- [User Manual](#)