



## EntryLogic TP450 Printer User Guide

[Home](#) » [EntryLogic](#) » EntryLogic TP450 Printer User Guide 



TP450 User Guide  
[www.entrylogic.com](http://www.entrylogic.com)

### Contents

- 1 This box contains the following:
- 2 Paper Roll Installation:
- 3 Printer Function Introduction:
- 4 Driver installation
- 5 ATTENTION:
- 6 Bluetooth printer
- 7 Bluetooth printer setting
- 8 Specifications & Compliance
- 9 Documents / Resources
- 10 Related Posts

**This box contains the following:**



**1 User Manual**

**1 TP450 Printer**



**1 Power Adapter**



**1 Power Cable**



**1 USB Cable**

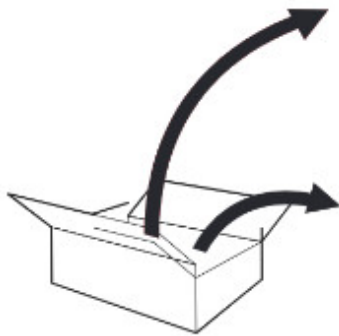

### Paper Roll Installation:

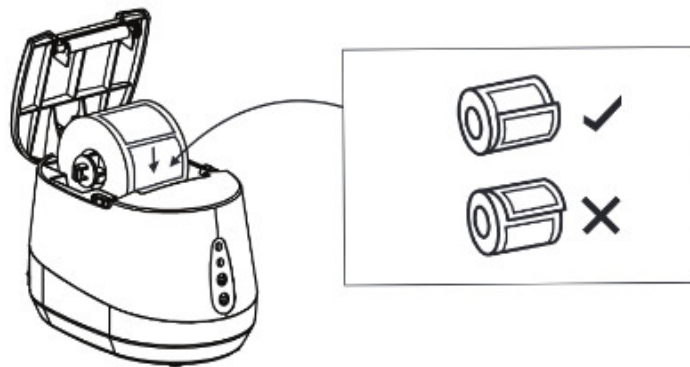

1. Open top cover
2. Drop paper roll in the hole as illustrated
3. Pull the paper into the paper holder, then close top cover
4. Print one self-test to make sure paper correctly installed.

### Printer Function Introduction:

#### 1 Button Name Indicator

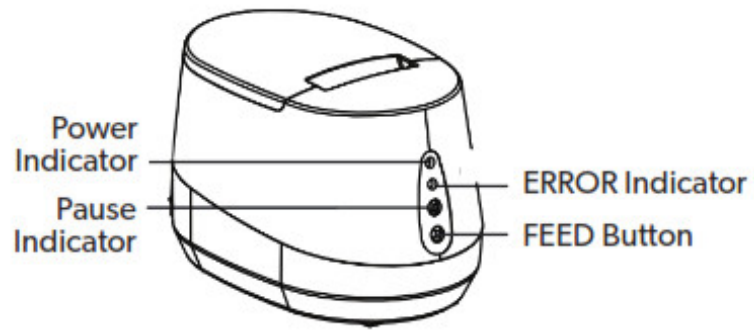

- |                                   |  |
|-----------------------------------|--|
| 1. FEED Button<br>2. PAUSE Button | 3. POWER/ON LINE Indicator<br>4. ERROR Indicator |
|-----------------------------------|--|



**Buttons:**

Item	Functions	Descriptions
1	Feed	Press the FEED button when POWER indicator is on and ERROR indicator is off. It feeds the label to the beginning of the next label.
2	Pause	Press the FEED button during printing and the printing job is suspended
3	Self-test	<ol style="list-style-type: none"> <li>1. Turn off the printer power.</li> <li>2. Make sure the paper roll is installed correctly and the printer top cover is close</li> <li>3. Press the FEED button and turning on the printer power simultaneously. When the self-test paper comes out, release the FEED button.</li> </ol>
4	Dump mode	<ol style="list-style-type: none"> <li>1. Turn off the printer power.</li> <li>2. Make sure the paper roll is installed correctly and the printer top cover is close</li> <li>3. Press and hold on the PAUSE button and FEED button, then turn on the printer power. When the POWER indicator and ERROR indicator light simultaneously release both buttons.</li> </ol> <p>The printer is changed to Dump Mode.</p>
5	Mode Switch	<ol style="list-style-type: none"> <li>1. Turn off the printer power.</li> <li>2. Make sure the paper roll is installed correctly and the printer top cover is close</li> <li>3. Press PAUSE button, then turn on the printer power. When the POWER indicator and ERROR indicator light, print mode switching prompt appears 2-3 seconds, and both lights flash at the same time. Press the FEED button to switch modes. Then restart the printer.</li> </ol>
6	Initialize	<ol style="list-style-type: none"> <li>1. Turn off the printer power.</li> <li>2. Press and hold on the PAUSE button and FEED button, then turn on the printer power. When the POWER indicator lights and ERROR indicator dims, release both buttons.</li> </ol> <p>The printer DRAM is cleared and printer settings are restored to defaults.</p>

**Connection:**

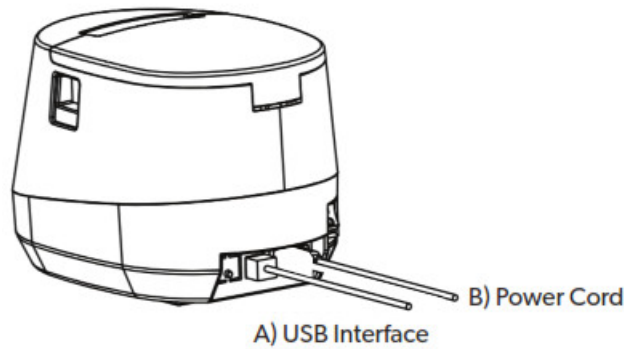

- A) Connect AC power cord to power, DC power cord to printer.
- B) Connect printer and computer/tablet.

## Driver installation

### Method 1: Port installation

1. double click the driver installation file;
2. select and install the printer driver and proceed ,then to the next step;
3. select, other, next step;
4. choose the type of printer and go to the next step;
5. specify the port and select according to the current printer;
6. when the printer driver installation prompts that the installation is successful, click"finish".

### Method 2: Add mode installation

1. enter the interface of printer, click add printer;
2. click add local printer;
3. select the printer port, select the existing port (select the port of your current printer), and next step;
4. select install from disk, browse and drive installation directory (default C disk), select execute file and confirm;
5. choose the type of printer and go to the next step;
6. when the printer driver is installed and show successful, then click "finish".

## ATTENTION:

1. Use your printer on stable surfaces, that avoid external vibrations.
2. Do not use or store printer in high temperature, high humidity, polluted environments.
3. Connect the power adapter properly to grounded receptacle. Avoid using the same socket with large power consuming devices, that can lead to power fluctuation.
4. Avoid water or other objects going into the printer. If this occurs, turn off the printer immediately
5. Printing without an installed paper roll will seriously damage the printing head.
6. Unplug your printer from power receptable when unused for long periods.
7. Only use approved accessories. Never try to disassemble, repair or remodel your printer.
8. Use standard power adapter.
9. Use high-quality paper. This ensures the printing quality and life of the printer.
10. Please turn off power before plugging/unplugging cables.

11. The printer is only suitable for use in tropical climates below 5000 meters sea level.

### **Cleaning your printer**

Clean your print if text is not clear, printed columns are unclear, or the paper feeds noisily.

#### **Printer head cleaning steps:**

1. Turn printer off, release power cord. Open top cover, and take out paper roll
2. Wait until printing head cools off if it's just finished printing
3. Clean printing head completely using swab with alcohol (without water)
4. Until alcohol completely volatilized, close top cover.
5. Connect power again, print test to check if clean.

### **Bluetooth printer**

Bluetooth: It is a kind of technology with short-distance wireless connection which globally used, using the same 2.4GHz nearby free charge and free application for frequency radio range with microwave. It can transfer data without alignment, with an effective transmission range of 10m. The Bluetooth printer carries out data transmission by matching with the Bluetooth device, the receiving master transfers the data to the printer and print it out. Hand-held terminal with Bluetooth interface, laptop, and other information terminals could print via Bluetooth interface.

Mini receipt printer compatible with Bluetooth 2.1 standard, with the power level of CLASS 2, and effective transmission distance is 10m. The name of the device is Printer 001, the initial password is "123456". Users may change the name of the device and the password if necessary.

The Bluetooth printer need to be paired with the main device of Bluetooth before working, the process of pairing will be started by the main device.

For detail pairing method, please refer to the function instructions for main device of Bluetooth. When pairing, the Bluetooth printer should power on.

**Note:** If the name of the printer is not changed, please do not power on other printers at the same time when pairing, otherwise it cannot identify which printer is paired successfully.

### **Bluetooth printer setting**

1. Connect the printer with computer, turn on the printer. Open the "tools" folder in printer CD, find the printer setting tools, choose the port and print a test page, if works, then enter into "Advanced" option.

**Note:** Bluetooth printer and the port setting procedures: firstly connect the power and run on the Bluetooth printer, connect the Bluetooth device to USB interface of the computer (master), a Bluetooth icon at the lower right corner on the desktop will appear.

2. Click "Bluetooth setting", set the related information such as the name of the Bluetooth device and the password, then click "Setting". The printer will "beep" a sound. Then restart the computer and check if the information of the self-test page printed matches with the settings.
3. Enter "Control Panel" — "Hardware and Sound" — "Add a Blue tooth device" (Computer should support Bluetooth function).
4. Default name of Bluetooth setting. Choose "Printer001", click "Next".
5. Choose "Enter the device's pairing code", enter the pass word" 123456", add the device.

6. After adding the device, choose "Equipment and printer", find the added Bluetooth device Printer001, click the properties of hardware, check the port information of the device.
7. After installing the printer driver, find the icon of driver, check the properties of it, choose the right port and print a test page via driver.

## Specifications & Compliance

FCC and ISED Canada Compliance: This equipment has been tested and is in compliance with Part 15 of the FCC Rules and ISED Canada license-exempt RSS standard(s). Operation is subject to the following two conditions:

1. this device may not cause harmful interference, and
2. this device must accept any interference received, including interference that may cause undesired operation.

FCC-ID: 2AH6G-TP450

IC-ID: 26745-TP450

The AC Power Adapter has been tested and is in compliance with the safety standards set forth by Part 1: Safety Requirements in both the US [UL 62368-1:2014 Ed.2] and Canada [CSA C22.2#62369-1:2014 Ed.2].

In accordance to local laws, when the device reaches end of life, it should be recycled in a manner that protects human health and the environment. Please consult your local authorities for local laws and regulations regarding the recycling and proper disposal of office electronics.

### FCC Warning Statement

Changes or modifications not expressly approved by the party responsible for compliance could void the user's authority to operate the equipment. This equipment has been tested and found to comply with the limits for a Class B digital device, pursuant to Part 15 of the FCC Rules. These limits are designed to provide reasonable protection against harmful interference in a residential installation. This equipment generates uses and can radiate radio frequency energy and, if not installed and used in accordance with the instructions, may cause harmful interference to radio communications. However, there is no guarantee that interference will not occur in a particular installation. If this equipment does cause harmful interference to radio or television reception, which can be determined by turning the equipment off and on, the user is encouraged to try to correct the interference by one or more of the following measures:

- Reorient or relocate the receiving antenna.
  - Increase the separation between the equipment and receiver.
  - Connect the equipment into an outlet on a circuit different from that to which the receiver is connected.
  - Consult the dealer or an experienced radio/TV technician for help.
- RF Exposure Statement

To maintain compliance with FCC's RF Exposure guidelines, This equipment should be installed and operated with minimum distance of 20cm the radiator your body. This device and its antenna(s) must not be co-located or operation in conjunction with any other antenna or transmitter.

### ISED Canada Statement:

This device contains licence-exempt transmitter(s)/receiver(s) that comply with Innovation Science and Economic Development Canada's licence-exempt RSS(s).

Operation is subject to the following two conditions:

1. this device may not cause interference and

2. this device must accept any interference, including interference that may cause undesired operation of the device.

Radiation Exposure: This equipment complies with Canada radiation exposure limits set forth for an uncontrolled environment RF Exposure Statement To maintain compliance with IC's RF Exposure guidelines, This equipment should be installed and operated with minimum distance of 20cm the radiator your body. This device and its antenna(s) must not be co-located or operation in conjunction with any other antenna or transmitter.

©2021 EntryLogic. All Rights Reserved. EntryLogic™ is a trademark of EntryLogic, Inc.

## Documents / Resources

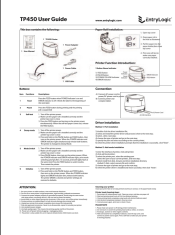
	<p><a href="#">EntryLogic TP450 Printer</a> [pdf] User Guide TP450, 2AH6G-TP450, 2AH6GTP450, TP450 Printer, Printer</p>
---	---

[Manuals+](#)