



ENS Security HNC3IV341T MP Lite AI IR Vari-Focal Eyeball Network Camera User Guide

[Home](#) » [ENS SECURITY](#) » ENS Security HNC3IV341T MP Lite AI IR Vari-Focal Eyeball Network Camera User Guide 

ENS Security

HNC3IV341T MP Lite AI IR Vari-Focal Eyeball Network Camera User Guide

Contents

- [1 Foreword](#)
- [2 Important Safeguards and Warnings](#)
- [3 Operation and Daily Maintenance](#)
- [4 Introduction](#)
- [5 Network Configuration](#)
- [6 Initializing Device](#)
- [7 Installation](#)
- [8 Documents / Resources](#)
- [9 Related Posts](#)



Foreword

General

This manual introduces the functions, installation, and operations of the camera.

Safety Instructions

The following categorized signal words with defined meanings might appear in the manual.

Signal Words	Meaning
 WARNING	Indicates a medium or low potential hazard which, if not avoided, could result in slight or moderate injury.
 CAUTION	Indicates a potential risk that, if not avoided, could result in property damage, data loss, lower performance, or unpredictable result.
 NOTE	Provides additional information as a supplement to the text.

Revision History

Version	Revision Content	Release Date
V1.0.2	Updated SD card installation.	November-21
V1.0.1	Updated “Important Safeguards and warnings.”	April-21
V1.0.0	First release.	May-19

Privacy Protection Notice

As the device user or data controller, you might collect the personal data of others such as their face, fingerprints, and license plate number. You need to be in compliance with your local privacy protection laws and regulations to protect the legitimate rights and interests of other people by implementing measures that include but are not limited: Providing clear and visible identification to inform people of the existence of the surveillance area and provide required contact information.

About the Manual

- The manual is for reference only. Slight differences might be found between the manual and the product.
- We are not liable for any loss caused by the operations that do not comply with the manual.
- The manual will be updated according to the latest laws and regulations of related jurisdictions.

For detailed information, see the paper User Manual, use our CD-ROM, scan the QR code or visit our official website. The manual is for reference only. Slight differences might be found between the electronic version and the paper version.

- All the designs and software are subject to change without prior written notice. The product updates might cause some differences between the actual product and the manual. Please contact customer service for the latest program and supplementary documentation.
- There still might be deviations in technical data, functions, and operations description, or errors in print. If there is any doubt or dispute, please refer to our final explanation.
- Upgrade the reader software or try other mainstream reader software if the manual (in PDF format) cannot be opened.
- All trademarks, registered trademarks, and the company names in the manual are the properties of their respective owners.
- Please visit our website, and contact the supplier or customer service if there is any problem occurred when using the device.
- If there is any uncertainty or controversy, please refer to our final explanation.

Important Safeguards and Warnings

Electrical Safety

- All installation and operation should conform to your local electrical safety codes.
- The power supply must conform to the requirements of ES1 in IEC 62368-1 standard and be no higher than PS2. Note that the power supply requirements are subject to the device label.
- Make sure the power supply is correct before operating the device.
- A readily accessible disconnect device shall be incorporated in the building installation wiring.
- Prevent the power cable from being trampled or pressed, especially the plug, power socket and junction extruded from the device.

Environment

- Do not aim the device at strong light to focus, such as lamp light and sunlight; otherwise, it might cause over-brightness or light marks, which are not the device malfunction, and affect the longevity of Complementary Metal-Oxide Semiconductor (CMOS).
- Do not place the device in a damp or dusty environment, extremely hot or cold temperatures, or locations with strong electromagnetic radiation or unstable lighting.
- Keep the device away from any liquid to avoid damage to the internal components.
- Keep the indoor device away from rain or dampness to avoid fire or lightning.
- Keep sound ventilation to avoid heat accumulation.
- Transport, use and store the device within the range of allowed humidity and temperature.
- Heavy stress, violent vibration or water splash are not allowed during transportation, storage and installation.
- Pack the device with standard factory packaging or the equivalent material when transporting the device.
- Install the device in a location where only professional staff with relevant knowledge of safety guards and warnings can access it. Accidental injury might happen to the non-professionals who enter the installation area when the device is operating normally.

Operation and Daily Maintenance

- Do not touch the heat dissipation component of the device to avoid scald.
- Carefully follow the instructions in the manual when performing any disassembly operation on the device; otherwise, it might cause water leakage or poor image quality due to unprofessional disassembly. Please make sure that the gasket ring is flat and properly installed in the groove before installing the cover. Please contact after-sale service for desiccant replacement if there is condensed fog on the lens after unpacking or when the desiccant turns green (Not all models are included with the desiccant).
- We recommend using the device together with the lightning arrester to improve the lightning protection effect.
- We recommend grounding the device to enhance reliability.
- Do not touch the image sensor (CMOS) directly. Dust and dirt could be removed with air blower, or you can wipe the lens gently with a soft cloth that is moistened with alcohol.
- You can clean the device body with soft dry cloth, and for stubborn stains, use the cloth with mild detergent. To avoid possible damage on the device body coating which could cause a performance decrease, do not use volatile solvents such as alcohol, benzene, or diluent to clean the device body, nor can strong, abrasive

detergent be used.

- The Dome cover is an optical component. Do not touch or wipe the cover with your hands directly during installation or operation. For removing dust, grease, or fingerprints, wipe gently with moistened oil-free cotton with diethyl or moistened soft cloth. You can also remove dust with an air blower.



WARNING

- Strengthen the protection of network, device data, and personal information by adopting measures that include but are not limited to using a strong password, changing passwords regularly, upgrading the firmware to the latest version, and isolating computer networks. For some devices with old firmware versions, the ONVIF password will not be changed automatically along with changing the system password, and you need to upgrade the firmware or manually change the ONVIF password.
- Use standard components or accessories provided by the manufacturer and make sure the device is installed and maintained by professional engineers.
- Do not expose the surface of the image sensor to laser beam radiation in an environment where a laser beam device is used.
- Do not provide two or more power supply sources for the device unless otherwise specified. A failure to follow this instruction might cause damage to the device.

Introduction



Waterproof all the cable joints with insulating tape and waterproof tape to avoid short circuits and water damage. For the detailed operation, see the FAQ manual.

Figure 1-1 Cables

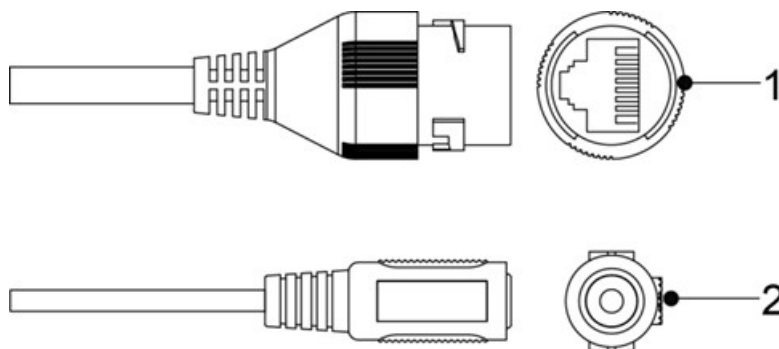



Table 1-1 Cable information

No.	Port Name	Description
1	Ethernet port	<p>Connects to network with a network cable. Provides power to the device with PoE.</p>  <p>PoE is available on select models.</p>
2	Power input	<p>Inputs 12 VDC power. Please be sure to supply power as instructed in the Guide.</p>  <p>Device abnormality or damage could occur if power is not supplied correctly.</p>

Network Configuration

Device initialization and IP address setting can be finished with the ConfigTool or in the web interface.
For more information, see the web operation manual.

- Device initialization is available on select models, and it is required at first use or after the device is reset.
- Device initialization is available only when the IP addresses of the device (192.168.1.108 by default) and the PC stay on the same network segment.
- Plan useable network segments properly to connect the device to the network.
- The following figures and interfaces are for reference only.

Initializing Device

Step 1 Double-click ConfigTool.exe to open the tool.

Step 2 Click  Modify IP.

Step 3 Click Search Setting.

Figure 2-1 Setting

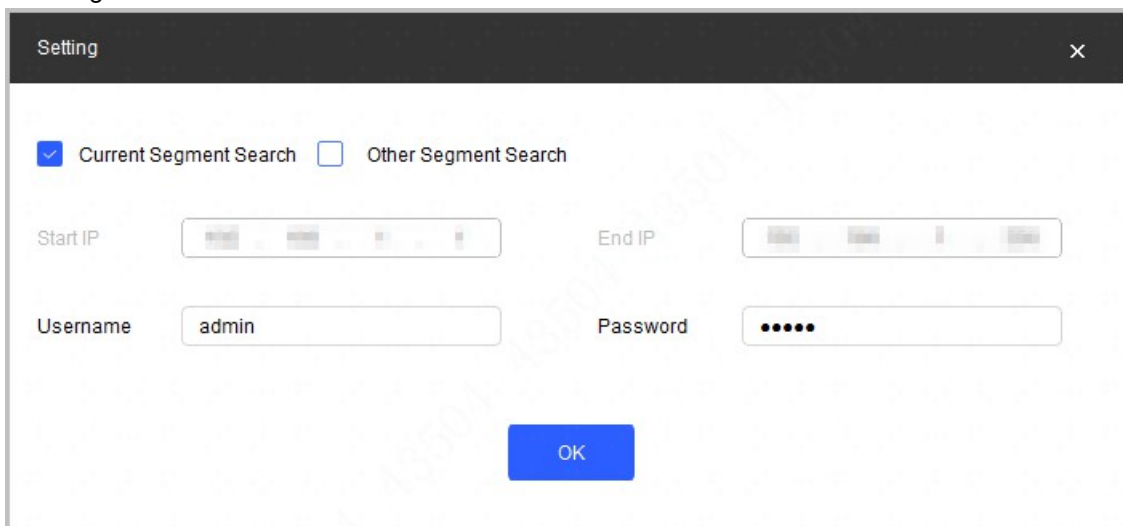

Step 4

Select the searching way.

- Current Segment Search (default)
Select the Current Segment Search checkbox. Enter the username in the Username box and the password in

the Password box. The system will search devices accordingly.

- Other Segment Search

Select the Other Segment Search checkbox. Enter IP address in the Start IP box and End IP box respectively. Enter user name and password. The system will search for the devices accordingly.



- If you select the Current Segment Search checkbox and the Other Segment Search checkbox together, the system searches for devices under both conditions.
- Enter username and password when you want to change IP, configure the system, update the device, restart the device, and more.

Step 5 Click OK.

Step 6 Select one or several devices in uninitialized status, and then click Initialize.

Step 7 Select the devices to be initialized, and then click Initialize.

- If you do not provide the linked information for a password reset, you can reset the password only through an XML file.
- When initializing multiple devices, ConfigTool initializes all devices based on the password reset mode of the first selected device.

Figure 2-2 Password setting

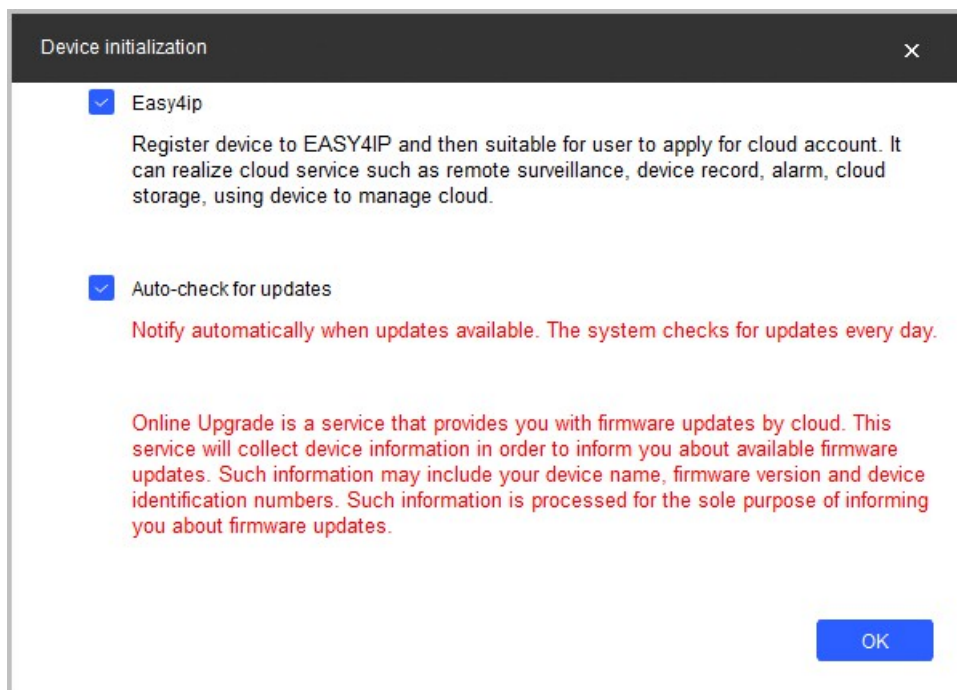

Step 8 Set and confirm the password of the devices, enter a valid email address, and then click Next.

Figure 2-3 Device initialization



Step 9 Select Easy4ip or select Auto-check for updates as needed. If neither, leave them unselected.

Step 10 Click OK to initialize the device.

Click the success icon () or the failure icon () for the details.

Step 11 Click Finish.

2.2 Changing Device IP Address

- You can change IP address of one or multiple devices in one time. This section is based on changing IP addresses in batches.
- Changing IP addresses in batches is available only when the corresponding devices have the same login password.

Step 1 Follow “Step 1” to “Step 4” in “2.1 Initializing Device” to search devices on your network segment.

After clicking Search setting, enter the username and password, and please make sure they are the same as what you set during initialization, otherwise, there will be a wrong password notice.

Step 2 Select the devices whose IP addresses need to be changed, and then click Batch Modify IP.

Figure 2-4 Change IP Address

Step 3 Select Static mode, and then enter start IP, subnet mask, and gateway.



IP addresses of multiple devices will be set to the same if you select the Same IP checkbox.

- If a DHCP server is available in the network, devices will automatically obtain IP addresses from the DHCP server when you select DHCP.

Step 4 Click OK.

2.3 Logging into Web Page

Step 1 If the setup wizard is displayed, finish the settings as instructed.

Open the IE browser, then enter the IP address of the device in the address bar, and then press the Enter key.

Step 2 Enter the username and password in the login box, and then click Login.

Step 3 For the first-time login, click Click Here to Download Plugin and then install the plugin as instructed. The home page is displayed when the installation is finished.

Installation

3.1 Packing List

- The tool required for the installation such as an electric drill is not provided in the packing.
- The operation manual and related tools are contained in the disk or the QR code.

Figure 3-1 Packing list

Network Camera X 1 Screw Package X 1 Waterproof Connector X 1 Positioning Map X 1

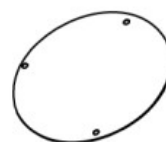

Quick Start Guide X 1 CD-ROM/QR Code X 1 Wrench X 1 (Optional)

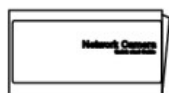

3.2 Dimension

Figure 3-2 Dimensions (mm [inch])

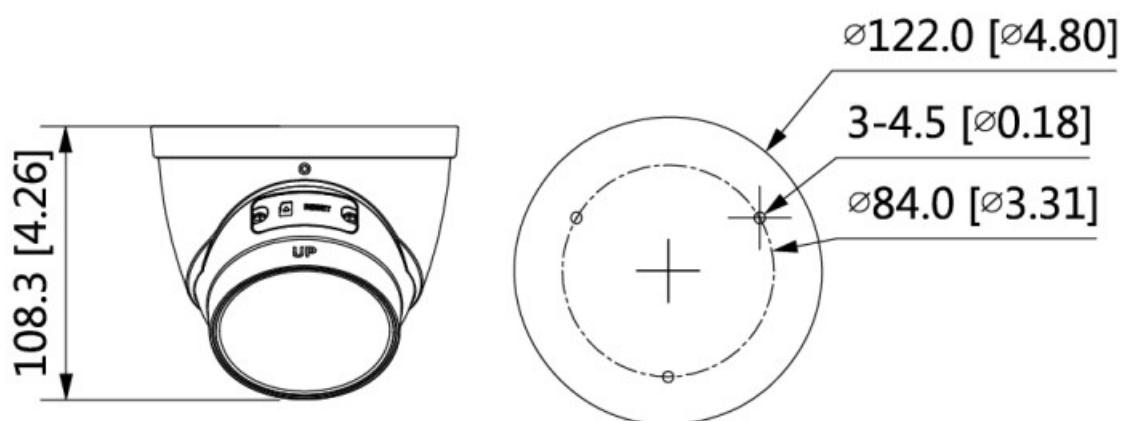

3.3 Installing Device

Installation Type

Figure 3-3 Installation method

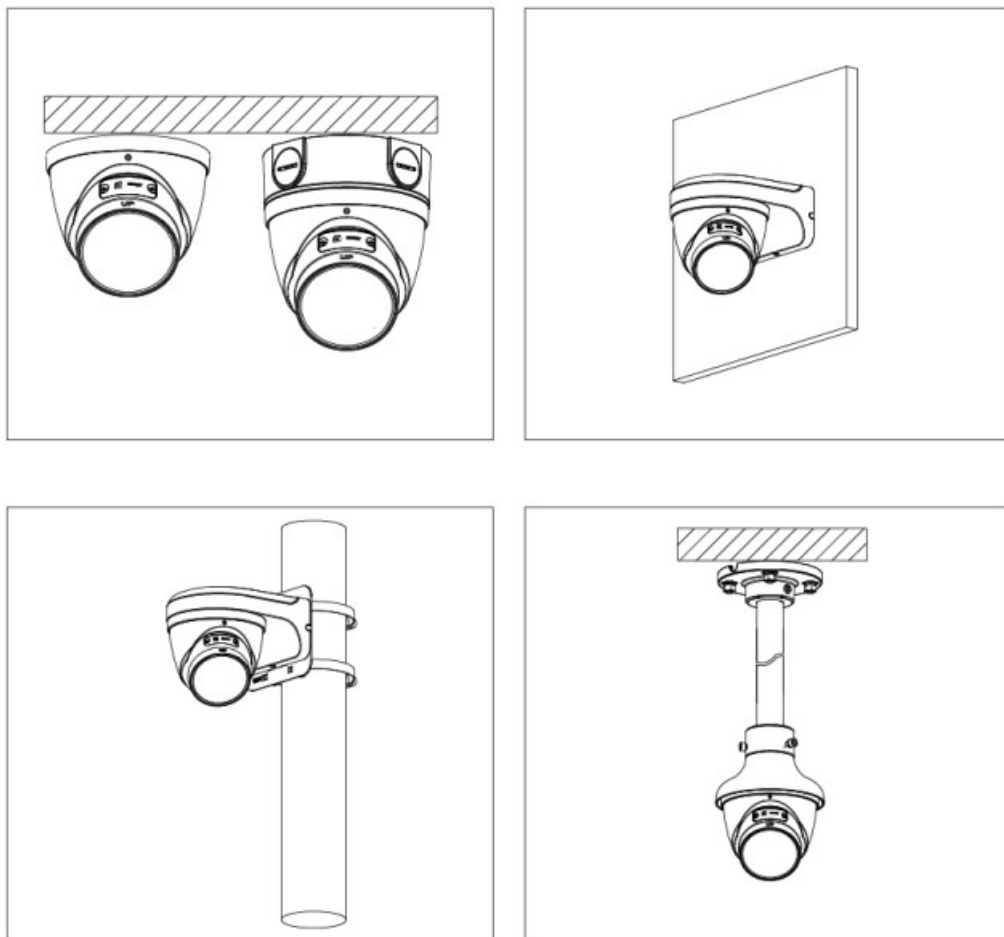

Detaching the Enclosure

Figure 3-4 Detach the enclosure

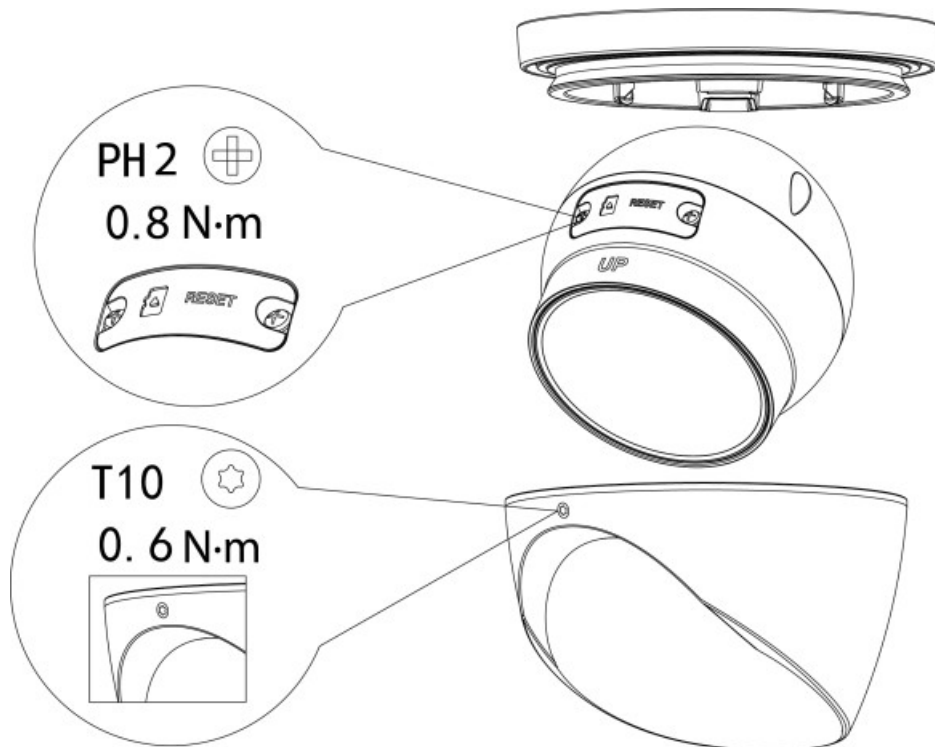

3.3.3 Installing SD Card (Optional)

- SD card slot is available on select models.
- Disconnect the power before installing or removing the SD card.



Press the reset button for 10 seconds to reset the device.

Figure 3-5 Install SD card

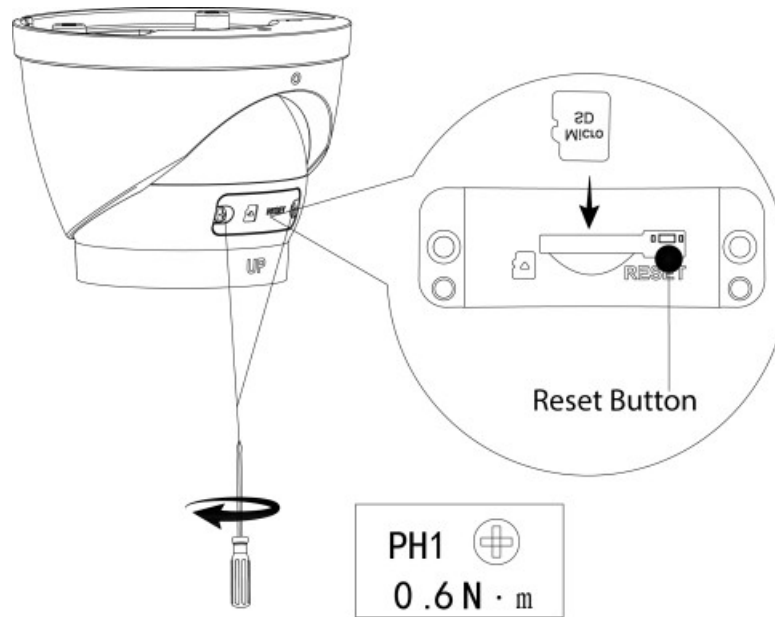

Attaching Device

! Make sure the mounting surface is strong enough to hold at least three times the weight of the device and bracket.

Figure 3-6 Cable going through the mounting surface

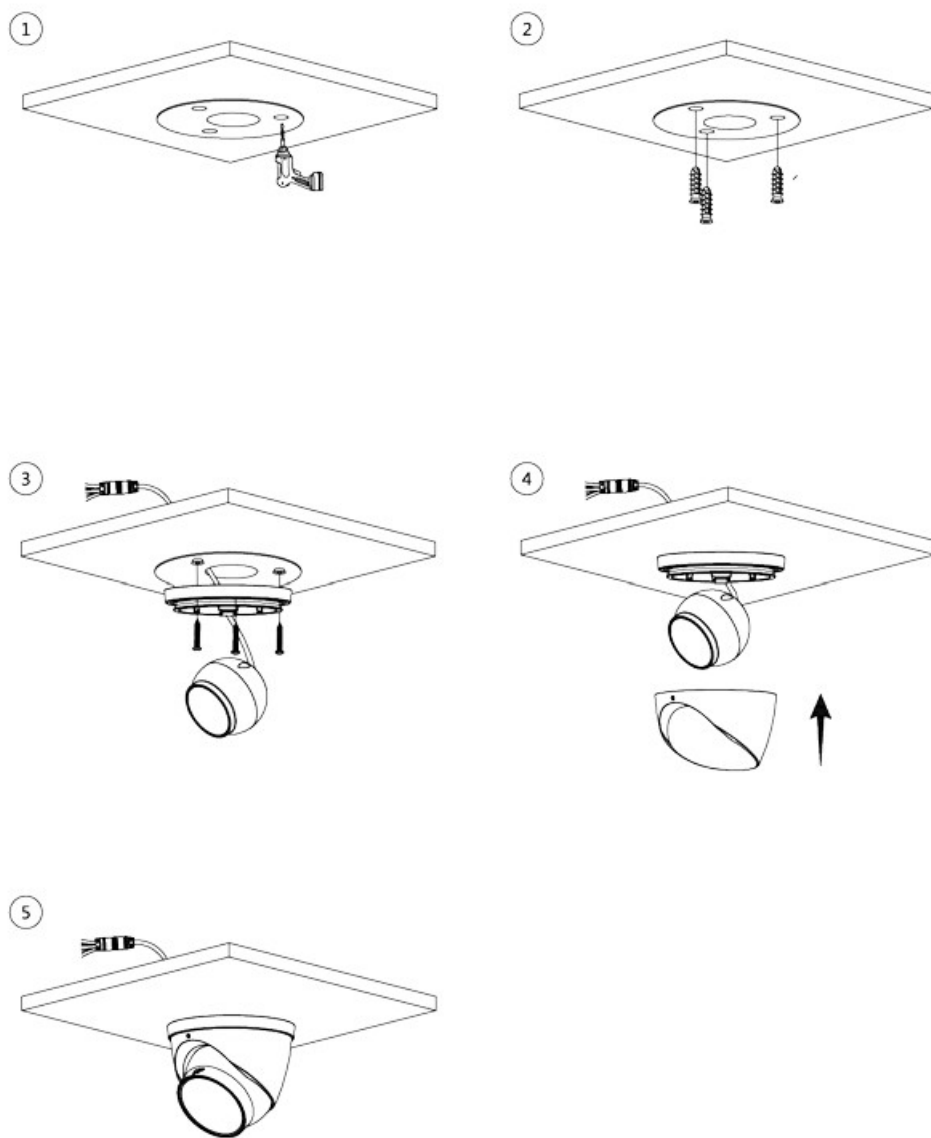
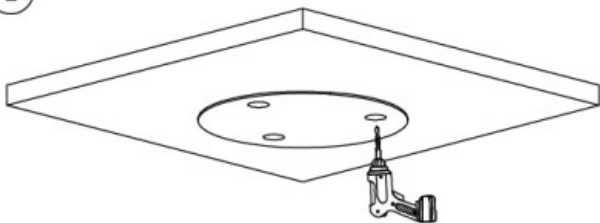
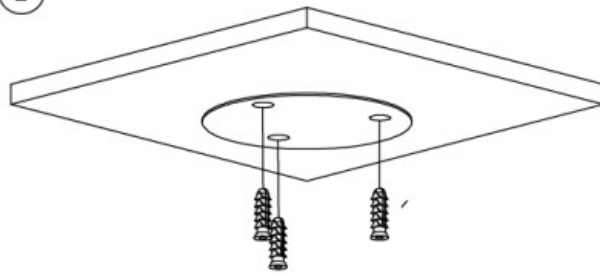

Figure 3-7 The cable going through the side cable tray

1



2



3



4

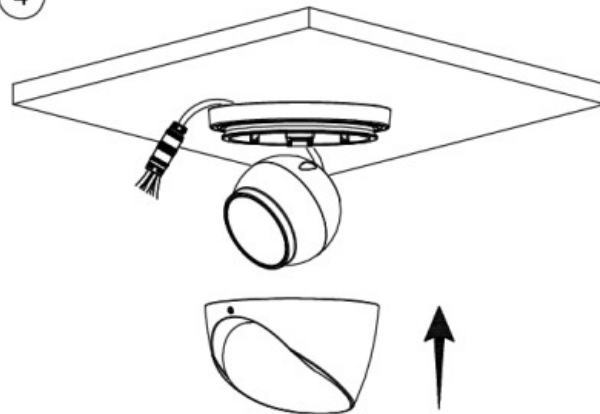

5

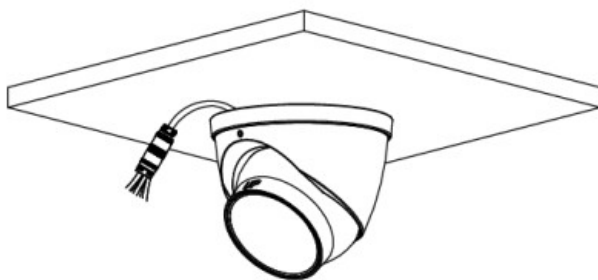

Installing Waterproof Connector (Optional)



This part is needed only when a waterproof connector comes with the device and the device is used outdoors.

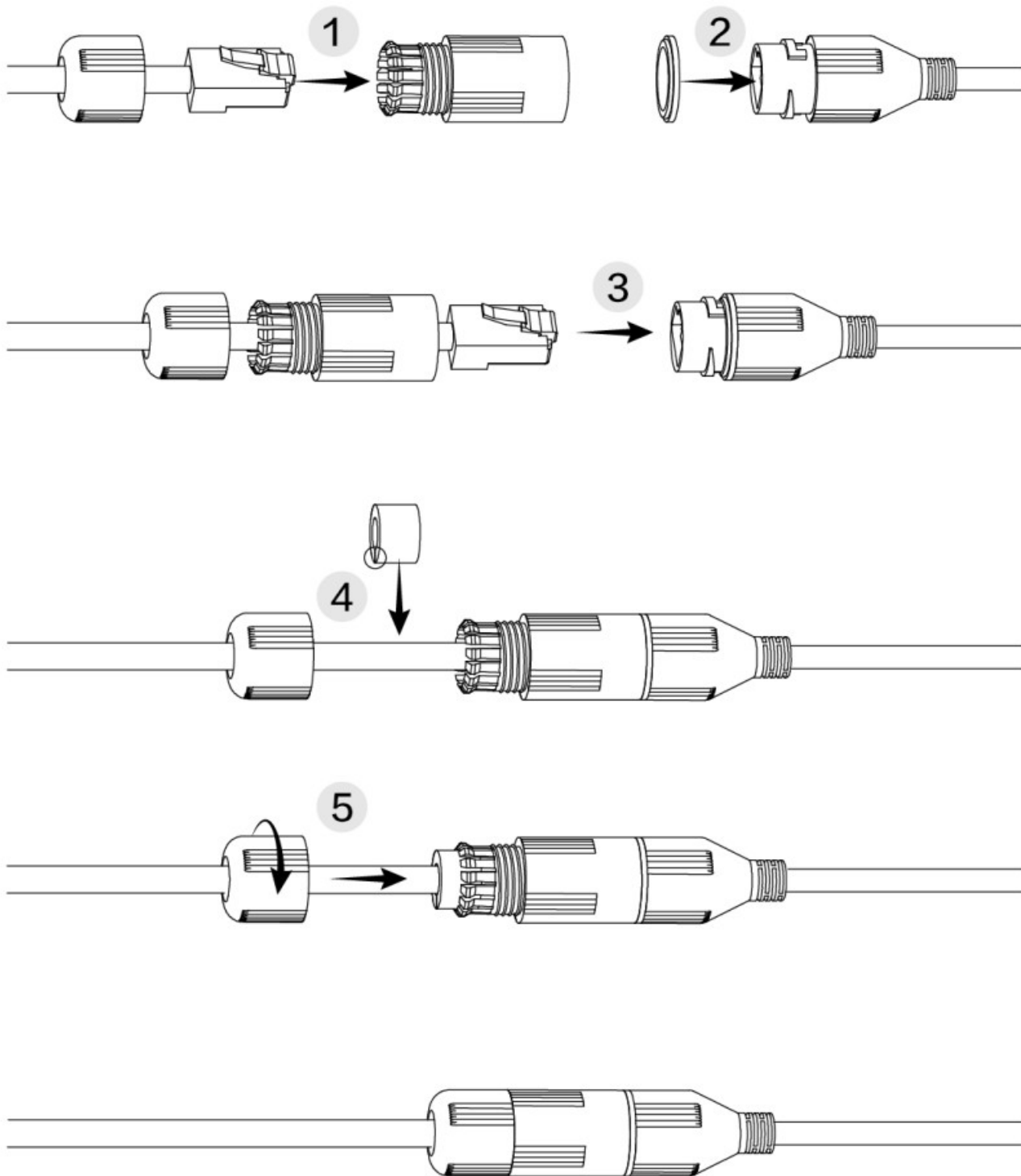

Adjusting Lens Angle
Figure 3-9 Adjust lens angle

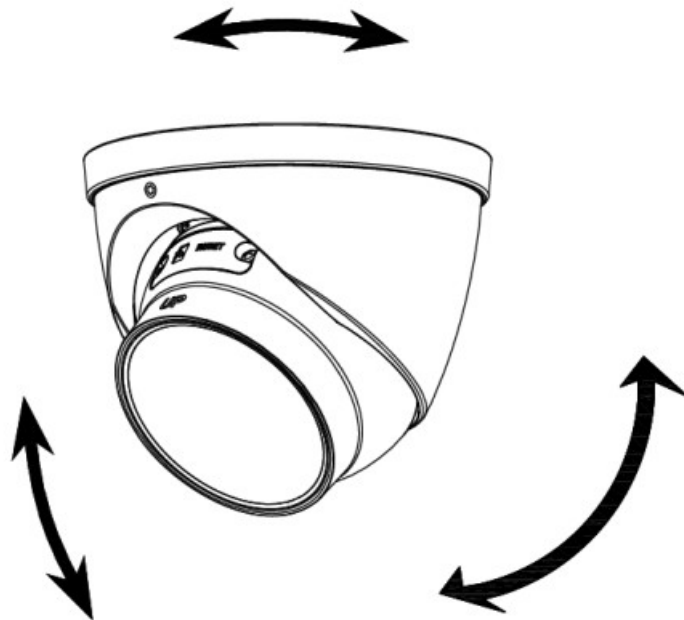

Documents / Resources

 <p>Eyeball Network Camera Quick Start Guide</p>	<p>ENS Security HNC3IV341T MP Lite AI IR Vari-Focal Eyeball Network Camera [pdf] User Guide</p> <p>HNC3IV341T MP Lite AI IR Vari-Focal Eyeball Network Camera, HNC3IV341T MP Lite AI IR Vari-Focal Eyeball Network Camera, Eyeball Network Camera, Network Camera, Camera</p>
---	---