

Enping
FS-2023 Selectable
Frequency UHF Wireless
Microphone



Enping FS-2023 Selectable Frequency UHF Wireless Microphone Instructions

[Home](#) » [Enping](#) » Enping FS-2023 Selectable Frequency UHF Wireless Microphone Instructions 

Contents

- [1 Enping FS-2023 Selectable Frequency UHF Wireless Microphone](#)
- [2 Product Specifications](#)
- [3 Product Usage Instructions](#)
- [4 Frequently Asked Questions \(FAQ\)](#)
- [5 INTRODUCTION OF RECEIVER AND TRANSMITTER](#)
- [6 CONNECTION EXAMPLE GUIDE](#)
- [7 SPECIFICATIONS](#)
- [8 TROUBLE SHOOTING](#)
- [9 FCC Caution](#)
- [10 Documents / Resources](#)
 - [10.1 References](#)
- [11 Related Posts](#)

Enping

Enping FS-2023 Selectable Frequency UHF Wireless Microphone



Product Specifications

- **Product Model:** FS-2023
- **Frequency Range:** UHF
- **Wireless Microphone Type:** Selectable Frequency
- **Power Source:** 2 AA batteries (for handheld microphone)
- **Output Connections:** 1/4" (6.35mm) Mixed Output, XLR Audio Output
- **Number of Channels:** 16

Product Usage Instructions

Receiver Operation:

1. Turn on the Receiver using the ON/OFF Power Switch.
2. Adjust the Volume Control to set the desired audio level.
3. Monitor the RF Signal Indicator to ensure a stable connection.
4. Use the Frequency Selectable Button to choose from the 16 available channels.
5. Connect your audio equipment to the 1/4" (6.35mm) Mixed Output or XLR Audio Output.

Transmitter Operation:

1. Insert 2 AA batteries into the Handheld Microphone's Battery Compartment.
2. Turn on the Handheld Mic using the ON/OFF Switch.
3. Check the LED Frequency Display to confirm the selected frequency.

Frequently Asked Questions (FAQ)

- **How do I change the frequency on the handheld microphone?**

Use the Frequency Selectable Button on the receiver to change the frequency that corresponds to the

handheld microphone.

- **What should I do if I experience interference during operation?**

Try changing the channel on both the receiver and transmitter to avoid interference from other devices.

Additionally, ensure that the antennas are properly positioned for optimal signal reception.

WELCOME

The system provides clear, noise-free wireless transmission and excellent sound reproduction. Simple setup and installation will have you streaming clear sound in no time. System functions include handheld microphone , UHF signal transmission, high signal-to-noise ratio performance, etc. Enjoy two-channel voice distribution across transmitters. Whether it is for work or entertainment, whether it is a small stage vocal performance or a conference room speech, this wireless microphone system will provide you with a high-quality audio experience. Enjoy hassle-free, reliable wireless sound transmission with today's latest system technology in an all-in-one kit. It can be connected to power amplifiers, mixers, active speakers and other equipment. Suitable for small stage, church, meeting, party, karaoke.

INTRODUCTION OF RECEIVER AND TRANSMITTER

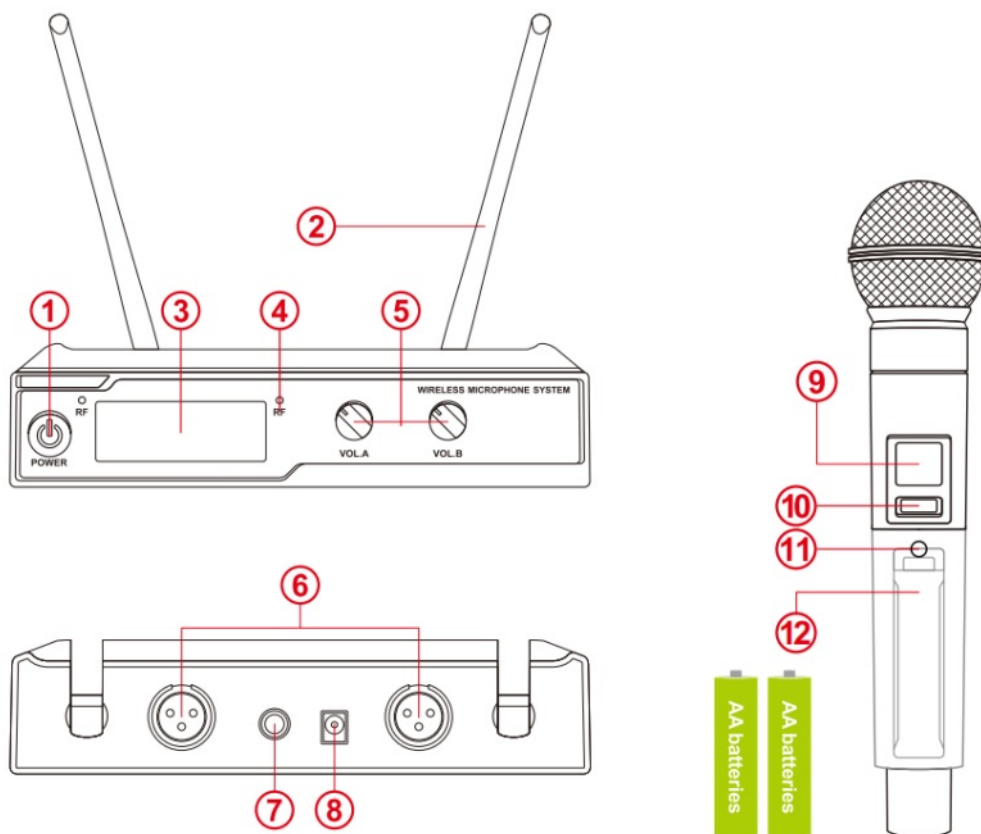

1. Receiver ON/OFF Power Switch
2. Antenna
3. Receiver Frequency Display
4. RF Signal Indicator
5. Volume Control
6. XLR Audio Output
7. 1/4" (6.35mm) Mixed Output
8. Power input
9. Handheld Mic LED Frequency Display
10. Handheld Mic ON/OFF Switch

11. Frequency Selectable Button (16 CH)
12. Battery Compartment (2 AA batteries)

CONNECTION EXAMPLE GUIDE

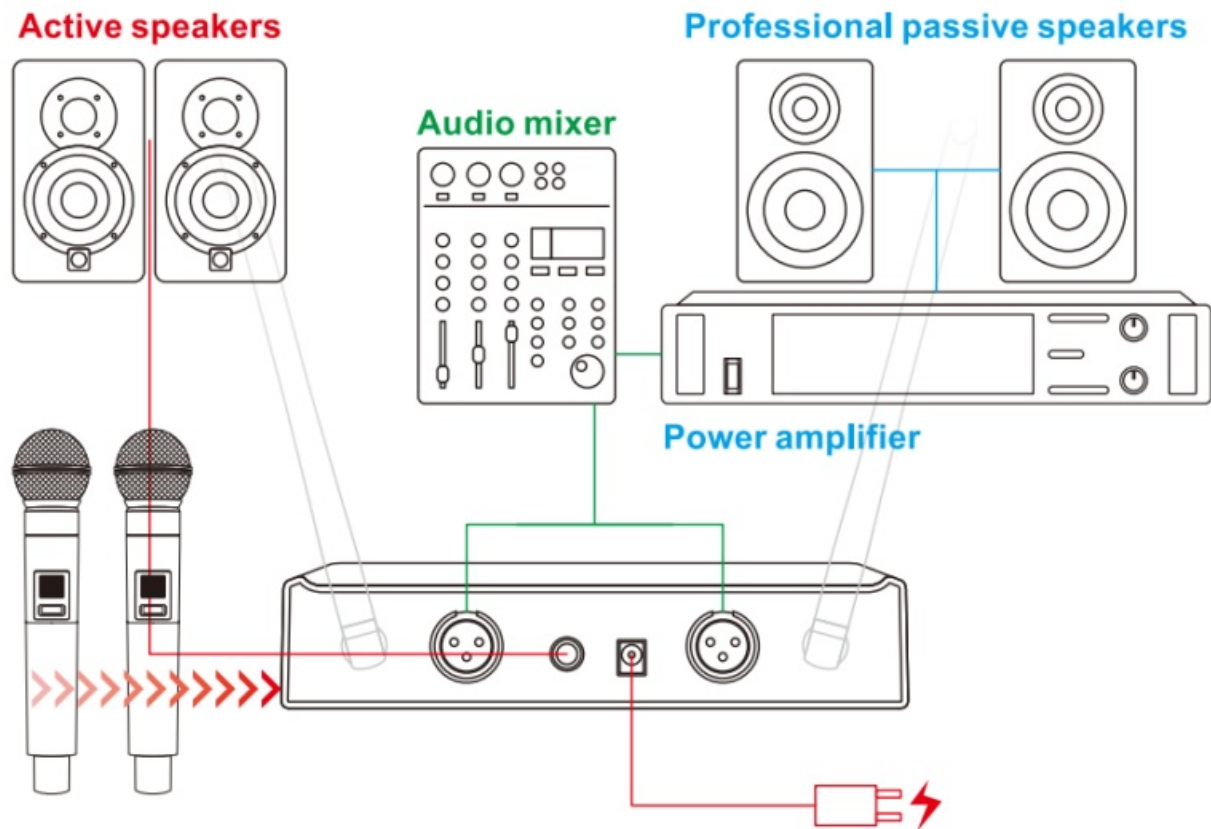

Operation of the receiver:

1. Connect the power adapter with the Power input ⑧ . Then Plug the power adapter into a power socket.
2. Use the Audio Cable to connect the receiver 1/4" output ⑦ and 1/4" input of a mixer or active speaker.
3. Pull out antenna A & B ② , make it vertically.
4. Turn ON the ON/OFF power switch ① and the Frequency Display Screen③ is bright.
5. When turn on the microphone, the receiver RF Signal Indicator ④ is lit.
6. The sound volume could be adjusted by the volume control knobs ⑤.
7. Please unplug the power adapter if you don't use for a long time.

Operation of the transmitter:

1. Open the battery compartment cover (12) , install 2PCS AA batteries correctly, then cover it.
2. Turn ON the ON/OFF Power switch ⑩ when using,the LED Frequency display ⑨ is lit.
3. If other system is using the same frequency, or the signal is not good. Please change the frequency by the Frequency Selectable Button(11). There are 16 channels per each microphone.
4. If battery icon is become "empty", please replace the batteries.
5. Please take out the batteries if you don't use transmitter for long time.

SPECIFICATIONS

- **Channel Frequency:** 470.2 ~ 607.7MHz
- **Pickup/Polar Pattern:** Uni-Directional
- **Impedance:** 600 Ohms \pm 30%
- **Frequency Response:** 50~15KHz \pm 3
- **Sensitivity:** -95dBm (S/N:12dB)
- **RF Image Rejection:** -75dB
- **Audio Dynamic Range:** 95dB
- **T.H.D.:** <1%
- **Frequency Stability:** \pm 0.002%
- **S/N Ratio:** >70dB
- **Interference:** >70dB
- **Output power:** <10 mW
- **Power Adapter:** AC 90-240V,50Hz-60Hz, DC 12V
- **Transmitter Power Supply:** 2 x AA battery
- **Wireless Range:** Up to 50 meters

TROUBLE SHOOTING

Check the following items before contacting a dealer. If the trouble is not improved, contact us.

- **NO sound, the receiver's RF indicator does not light up.**
 - Make sure the transmitter power switch is ON and the receiver is plugged in. (Push up the switch of the hand-held microphone)
 - Check that the battery is installed. And make sure the battery is fully charged.
 - Check that the frequency on the transmitter matches the frequency on the receiver.
- **No sound, the receiver's RF indicator is on.**
 - Turn up the receiver audio volume control. Also turn up the volume control of other connected devices.
 - Check that the connection between the receiver and the mixer or other equipment is correct.
- **Receiver signal is noisy or contains extraneous sounds with transmitter on.**
 - Check if the battery is low.
 - Check for other sources of RF interference causing interference.
 - If using a guitar or other musical instrument, check the connections. If multiple transmitters are used together, it is possible that multiple transmitters are operated on the same frequency. Please change the frequency.
 - Find the same frequency point, close the others, and only keep one of them.
 - Signal may be too weak. Reposition the antenna. Move them closer to the transmitter if possible.
- **Noise from receiver with transmitter off.**
 - Check for other sources of RF interference causing interference.
 - It is recommended to replace the audio cable with a better quality.
 - Test other equipment connected to the receiver for problems.
- **Momentary loss/stop of sound as transmitter is moved around performing area.**

Reposition the receiver and perform another "drill" test and observe the RF indicator. If audio loss persists, mark these "dead spots" in the performance area and avoid them during the performance.

FCC Caution

This device complies with part 15 of the FCC Rules. Operation is subject to the following two conditions:

1. This device may not cause harmful interference, and
2. this device must accept any interference received, including interference that may cause undesired operation.

Any Changes or modifications not expressly approved by the party responsible for compliance could void the user's authority to operate the equipment.

Note: This equipment has been tested and found to comply with the limits for a Class B digital device, pursuant to part 15 of the FCC Rules. These limits are designed to provide reasonable protection against harmful interference in a residential installation. This equipment generates uses and can radiate radio frequency energy and, if not installed and used in accordance with the instructions, may cause harmful interference to radio communications. However, there is no guarantee that interference will not occur in a particular installation. If this equipment does cause harmful interference to radio or television reception, which can be determined by turning the equipment off and on, the user is encouraged to try to correct the interference by one or more of the following measures:

- Reorient or relocate the receiving antenna.
- Increase the separation between the equipment and receiver.
- Connect the equipment into an outlet on a circuit different from that to which the receiver is connected.
- Consult the dealer or an experienced radio/TV technician for help.

RF warning for Portable device:

The device has been evaluated to meet general RF exposure requirement. The device can be used in portable exposure condition without restriction.

Documents / Resources

	<p>Enping FS-2023 Selectable Frequency UHF Wireless Microphone [pdf] Instructions FS204B, 2AUCK-FS204B, 2AUCKFS204B, FS-2023 Selectable Frequency UHF Wireless Microphone, FS-2023, FS-2023 Wireless Microphone, Selectable Frequency UHF Wireless Microphone, Selectable Frequency Wireless Microphone, UHF Wireless Microphone, Selectable Frequency Microphone, Wireless Microphone, Microphone</p>
---	--

References

- [User Manual](#)

[Manuals+](#), [Privacy Policy](#)

This website is an independent publication and is neither affiliated with nor endorsed by any of the trademark owners. The "Bluetooth®" word mark and logos are registered trademarks owned by Bluetooth SIG, Inc. The "Wi-Fi®" word mark and logos are registered trademarks owned by the Wi-Fi Alliance. Any use of these marks on this website does not imply any affiliation with or endorsement.