



## ENLITE EN-EMLD2 Aurora 2W 3 Hour Non-Maintained Emergency Instruction Manual

[Home](#) » [ENLITE](#) » ENLITE EN-EMLD2 Aurora 2W 3 Hour Non-Maintained Emergency Instruction Manual 

ENLITE EN-EMLD2 Aurora 2W 3 Hour Non-Maintained Emergency



## Contents

[1 Operation Instructions](#)

[2 IMPORTANT INSTALLATION INFORMATION](#)

[3 EMERGENCY TESTING](#)

[3.1 Environmental Protection \(W.E.E.E.\) – Enlite’s WEEE Reg.No. WEE/BG0130YX \(UK Only\)](#)

[3.2 GUARANTEE](#)

[4 Documents / Resources](#)

[4.1 References](#)

[5 Related Posts](#)

## Operation Instructions

1

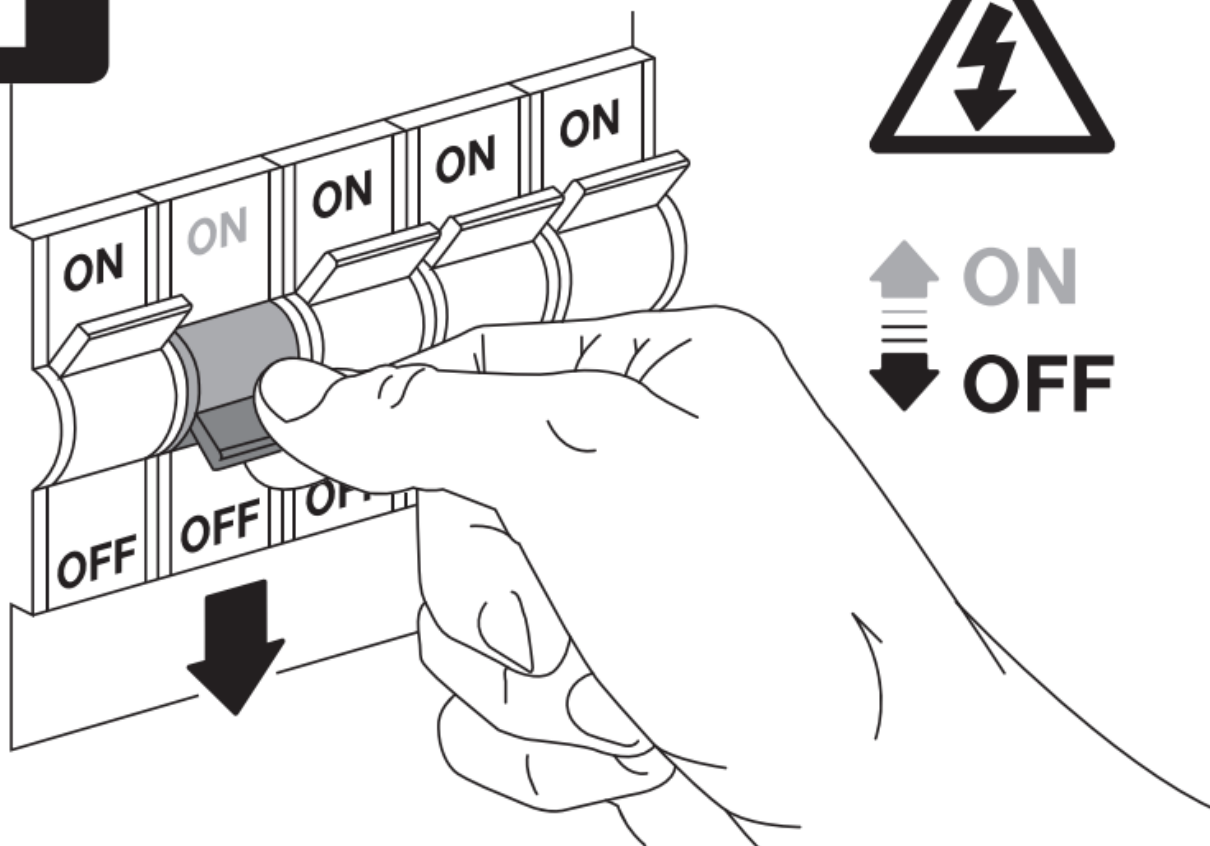

2

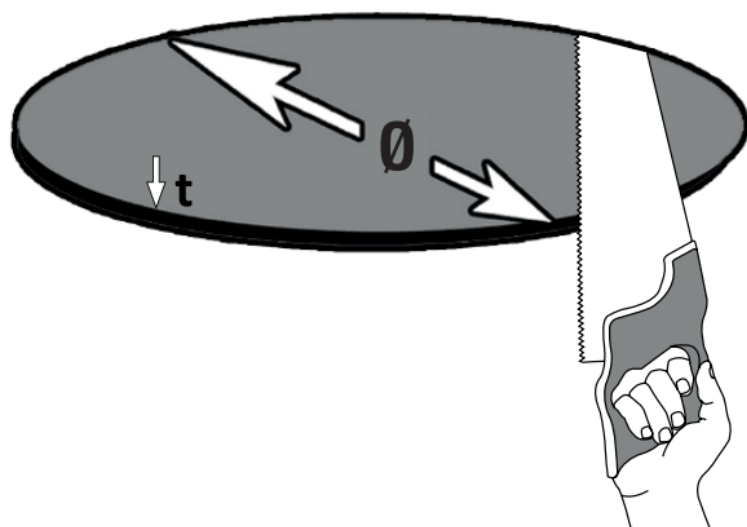

$t \geq 10\text{mm}$

$\emptyset =$

EN-EMLD2=40mm

EN-EMLD3=40mm

3

Permanent Supply:  
Brown - (L) Permanent Live  
Blue - (N) Neutral

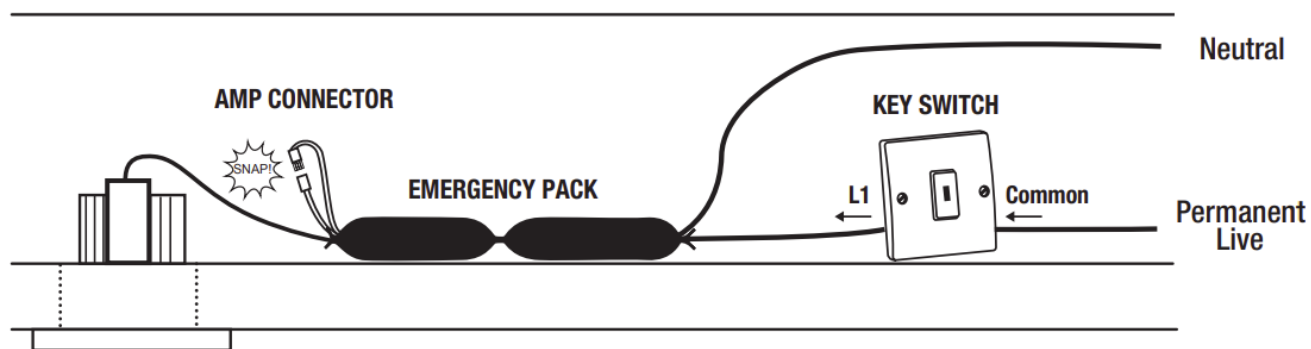

4

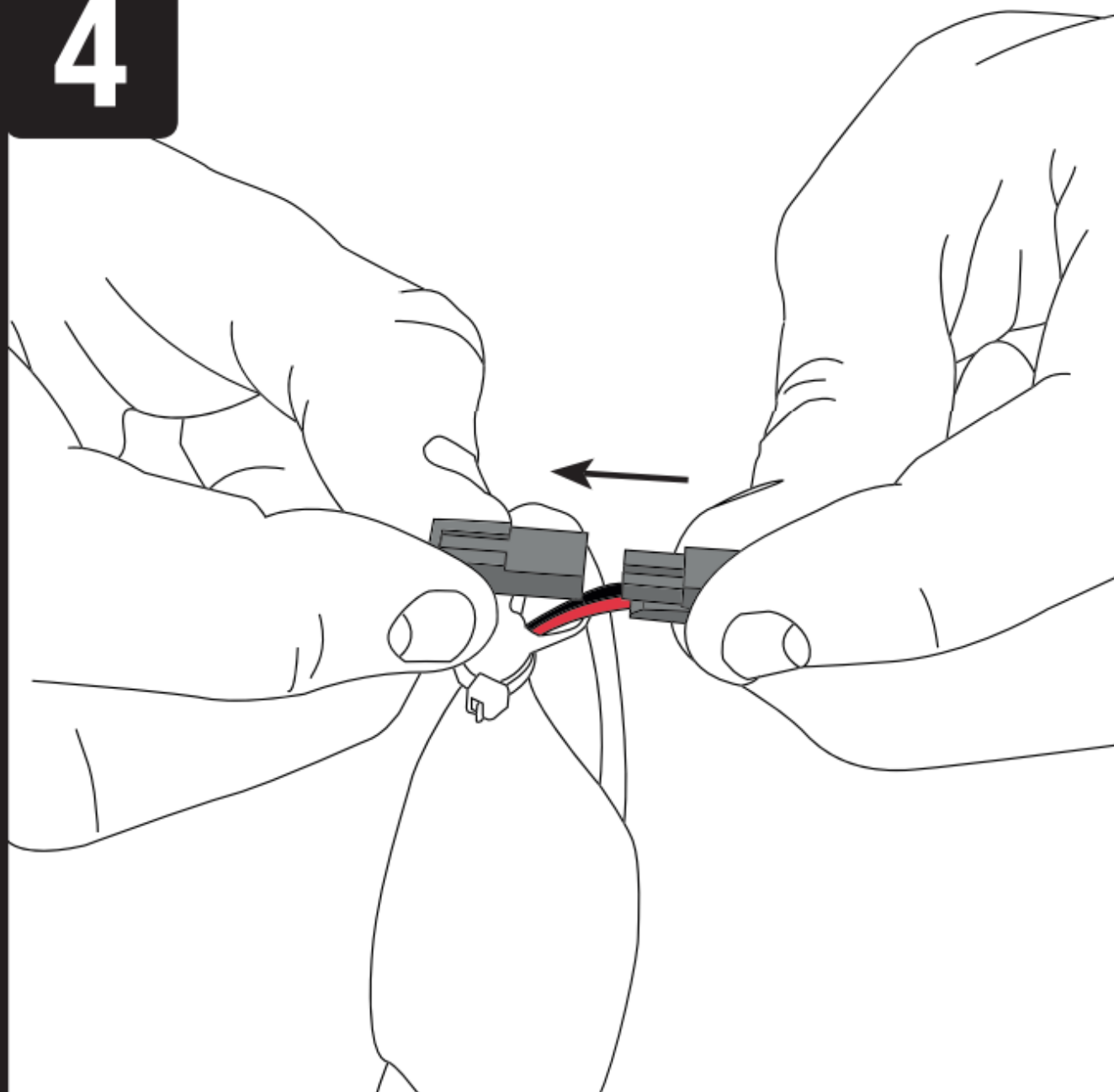

5



6

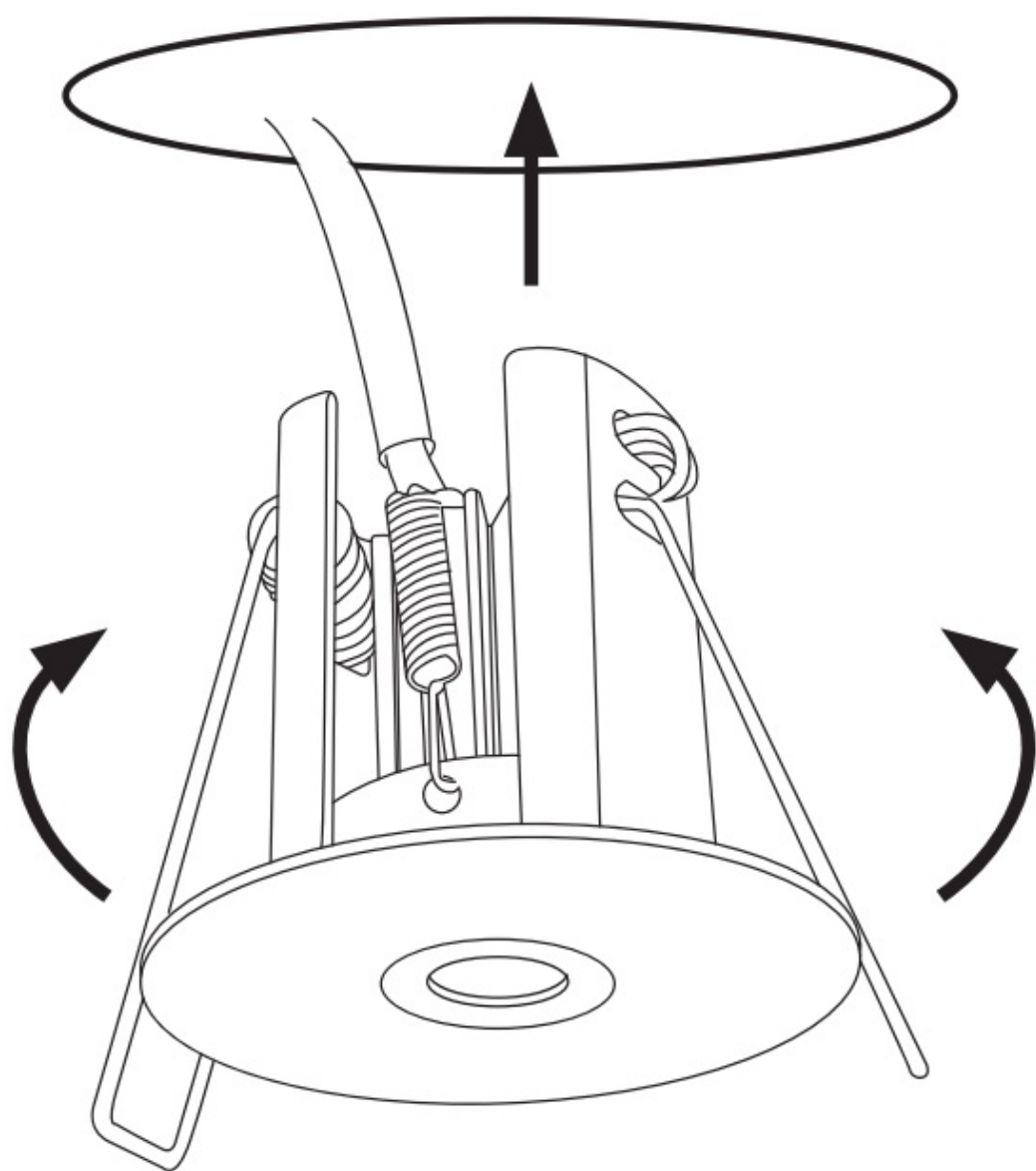

# 7

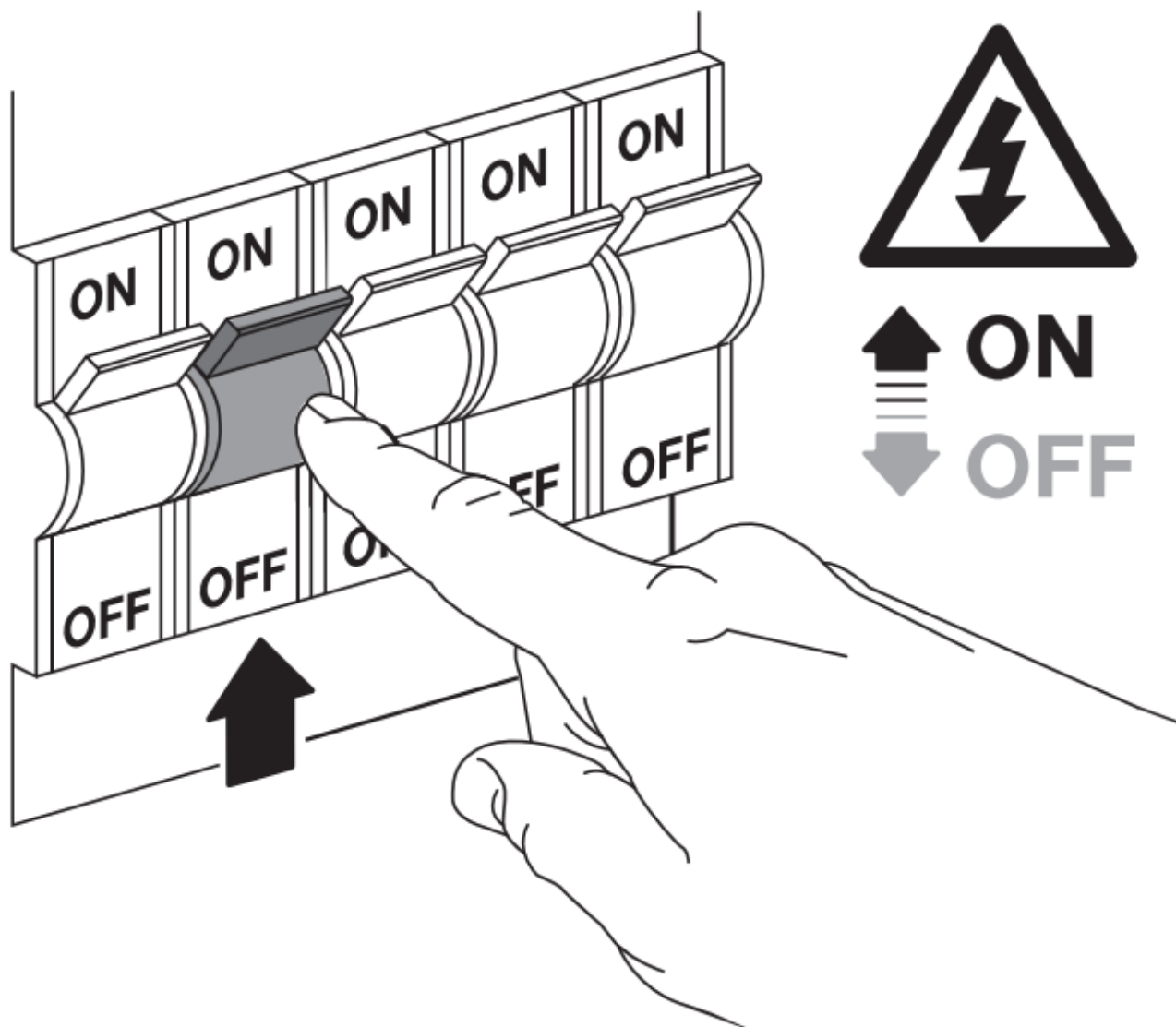

**PLEASE READ THESE INSTRUCTIONS CAREFULLY BEFORE INSTALLATION LEAVE A COPY FOR THE USER / MAINTENANCE ENGINEER FOR FUTURE REFERENCE**

## **IMPORTANT INSTALLATION INFORMATION**

- Installation should be carried out by a qualified electrician in accordance with the latest edition of the National wiring regulations (For Australia please check the latest edition of the Wiring Rules -AS/NZS 3000:2007). This unit requires an unswitched 230 240V mains supply to charge the battery.
- This is a Non-maintained unit and will only energise in the event of an electrical mains supply failure.
- Ensure that ALL connections are tight with no loose strands, including factory connections.
- Batteries must be charged for 24 hours to ensure full emergency duration and before testing.
- The battery will recharge normally after a short-circuit battery test.
- A green LED within the module indicates the battery is charging correctly.
- Please note – There is basic insulation between the battery and supply.

- The wiring between supply and the battery circuit is double insulated
- The battery is Ni-MH 1800mA 7.2V
- The battery +ve and -ve connections must be correct. If reversed the product will not operate. Do not reverse the polarity of the battery.
- LED module may also be mounted without the downlight in a 20mm hole, but inverter and battery only can be installed from above.
- The input cable conductor cross sectional area is 0.75mm<sup>2</sup> -1.5mm<sup>2</sup>
- To test in emergency mode operate the installation emergency keyswitch which will switch off the permanent mains supply to the emergency lighting circuit.
- The emergency lighting will operate from 0°C to 25°C
- The emergency lighting is not suitable for high -risk task area lighting. It will provide 3 hour duration illumination if the normal lighting fails.
- While the luminaire no longer meets its rated duration of emergency operation, the battery should be replaced with a battery of the same specification.
- If the external flexible cable or cord of this luminaire is damaged, it shall be replaced by a special cord or cord exclusively available from the manufacturer or his service agent.
- Photometric data – add IES and LDT files are available from the Enlite website [www.enlitelighting.com](http://www.enlitelighting.com)
- The luminaire should be positioned so that prolonged staring into the luminaire at a distance closer than 0.25m is not expected.
- Emergency luminaire rated flux: 105lm
- 3 hours battery duration is maintained only if the battery is working in an environment with temperatures between 10°C and 45 °C.

## EMERGENCY TESTING

### After connecting the mains supply check the following:

1. The green charge indicator LED is illuminated. This indicates that the mains supply is present and that the charger circuit is working correctly.
2. The unit should be left on charge for a minimum of 24 hours before testing the emergency mode.
3. To simulate normal mains supply failure, operate the key switch (See figure 3 on page 1).
4. The lamp will now light under emergency conditions.
5. When the unit no longer meets its rated duration of operation the battery pack must be replaced with a battery of the same type, voltage and Amp hour rating.

### Environmental Protection (W.E.E.E.) – Enlite's WEEE Reg.No. WEE/BG0130YX (UK Only)



Waste Electrical & Electronic Equipment Regulations (WEEE) requires that any of our products showing this marking (left) must not be disposed of with other household or commercial waste. Enlite does not levy any WEEE disposal charges to its customers for affected WEEE related products.

To prevent possible harm to the environment or human health from uncontrolled waste disposal, please separate any such product from other waste types and recycle it responsibly at your local facilities. Check with your Local Authority, Recycling Centre or retailer for recycling advice. If, when you purchased any Enlite product, your supplier included a WEEE disposal fee, you should then contact your supplier for advice on his take back of the product for the correct disposal.



## GUARANTEE

This product is guaranteed for a period of 1 years from the date of purchase. The guarantee is invalid in the case of improper use, installation, tampering, and removal of the Q.C. date label, installation in an improper working environment or installation not according to the current edition of the National Wiring Regulations. Should this product fail during the guarantee period it will be replaced free of charge, subject to correct installation and return of the faulty unit. Enlite does not accept responsibility for any installation costs associated with the replacement of this product. This warranty is in addition to the statutory rights in your country of purchase. Enlite reserves the right to alter specifications without prior notice.



## Documents / Resources

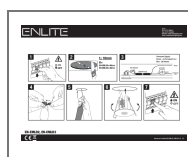

[ENLITE EN-EMLD2 Aurora 2W 3 Hour Non-Maintained Emergency](#) [pdf] Instruction Manual  
EN-EMLD2 Aurora 2W 3 Hour Non-Maintained Emergency, EN-EMLD2, Aurora 2W 3 Hour  
Non-Maintained Emergency, Non-Maintained Emergency, Maintained Emergency, Emergency

## References

- [Oslo Sportslager - kvalitet - service - kunnskap i 90 år](#)