

**ENG  
GO**  
CONTROLS  
**REPEATERZB**  
**ZigBee-Network**  
**Repeater**



# ENG GO CONTROLS REPEATERZB ZigBee Network Repeater User Guide

[Home](#) » [ENG GO CONTROLS](#) » ENG GO CONTROLS REPEATERZB ZigBee Network Repeater User Guide 

## Contents

- [1 ENG GO CONTROLS REPEATERZB ZigBee Network Repeater](#)
- [2 Product Information](#)
- [3 Product Usage Instructions](#)
- [4 INTRODUCTION](#)
- [5 Technical specification](#)
- [6 Installation of the repeater in the app](#)
- [7 Factory Reset](#)
- [8 Documents / Resources](#)
  - [8.1 References](#)
- [9 Related Posts](#)



**ENG GO CONTROLS REPEATERZB ZigBee Network Repeater**



#### Specifications:

- **Power supply:** 230V AC 50Hz
- **Communication:** ZigBee 3.0 2.4GHz
- **Dimensions:** 40 x 24 x 82 mm
- LED diode indications

#### Product Information

The Repeater is a ZigBee network repeater designed to increase the wireless network signal range for Engo devices operating over the ZigBee 3.0 protocol. It helps improve radio signal range in areas where the wireless network is affected by distance or obstacles like concrete walls or reinforced ceilings. Please note that this device requires the EGATEZB ZigBee 3.0 gateway for operation.

#### Product Usage Instructions

##### Installation:

1. Make sure your router is within range of your smartphone and that you are connected to the internet for faster pairing.
2. **Step 1 – Download ENGO Smart App:** Download and install the ENGO Smart app from Google Play or Apple App Store on your smartphone.
3. **Step 2 – Register a New Account:** Follow the app instructions to create a new account
4. **Step 3 – Installation of the ZigBee 3.0 Repeater in the App:**
  1. Ensure the ZigBee gateway is added to the app.

2. Connect the repeater to the power supply; the blue LED should flash.
3. If not flashing, perform a factory reset (refer to the Factory Reset section).
4. Access the gateway interface in the app.
5. In the Zigbee devices list, select Add Devices.
6. Wait for the device to be found, then click Done to complete the installation.

### **Factory Reset (Entering Pairing Mode):**

#### **To perform a factory reset and enter pairing mode:**

1. Unplug and plug the repeater three times with intervals of 3 seconds each.
2. The LED on the device will flash, indicating it has been removed from the ZigBee network and gateway.
3. The repeater will then enter pairing mode automatically for reconnection.

### **FAQ**

- **Q: Can the repeater operate independently without the EGATEZB ZigBee 3.0 gateway**
  - **A:** No, the repeater requires the EGATEZB ZigBee 3.0 gateway for operation. It cannot function stand-alone.

### **INTRODUCTION**

Repeater increases wireless network signal range for all Engo devices which works over ZigBee 3.0 protocol. It helps to improve radio signal range in places, where wireless network is disturbed by distance or other obstacles (concrete walls, reinforced ceilings, etc.). This device cannot operate standalone. In order to use it EGATEZB ZigBee 3.0 gateway is needed.

### **WARNING**

This product must be used with the EGATEZB ZigBee 3.0 gateway (purchased separately).

### **PRODUCT COMPLIANCE:**

**This product complies with the following EU Directives:** 2014/30/EU, 2014/35/EU, 2014/53/EU, 2011/65/EU.

### **SAFETY INFORMATION:**

Use in accordance with national and EU regulations. Use the device only as intended, keeping it in a dry condition. The product is for indoor use only. Please read the entire manual, before installation or use.

### **WARNING:**

For the entire installation, there may be additional protection requirements, which the installer is responsible for

### **Technical specification**

Power supply	230V AC 50Hz
Communication	ZigBee 3.0 2,4GHz
Dimensions [mm]	40 x 24 x 82

### LED diode indications

	EXPLANATION
<b>LED diode flashes blue</b>	The device is in pairing mode with the ZigBee network (when the device wasn't previously added to the ZigBee 3.0 network, or after recovery factory reset)
<b>LED diode lights up blue</b>	The device has been added to the ZigBee 3.0 network
<b>The LED diode is off</b>	The repeater is not connected to the power supply 230V

### Installation of the repeater in the app

Make sure your router is within range of your smartphone. Make sure you are connected to the Internet. This will reduce the pairing time of the device

#### STEP 1 – DOWNLOAD ENGO SMART APP

Download the ENGO Smart app from Google Play or Apple App Store and install it on your smartphone.



#### STEP 2 – REGISTER THE NEW ACCOUNT

To register a new account, please follow the steps below:

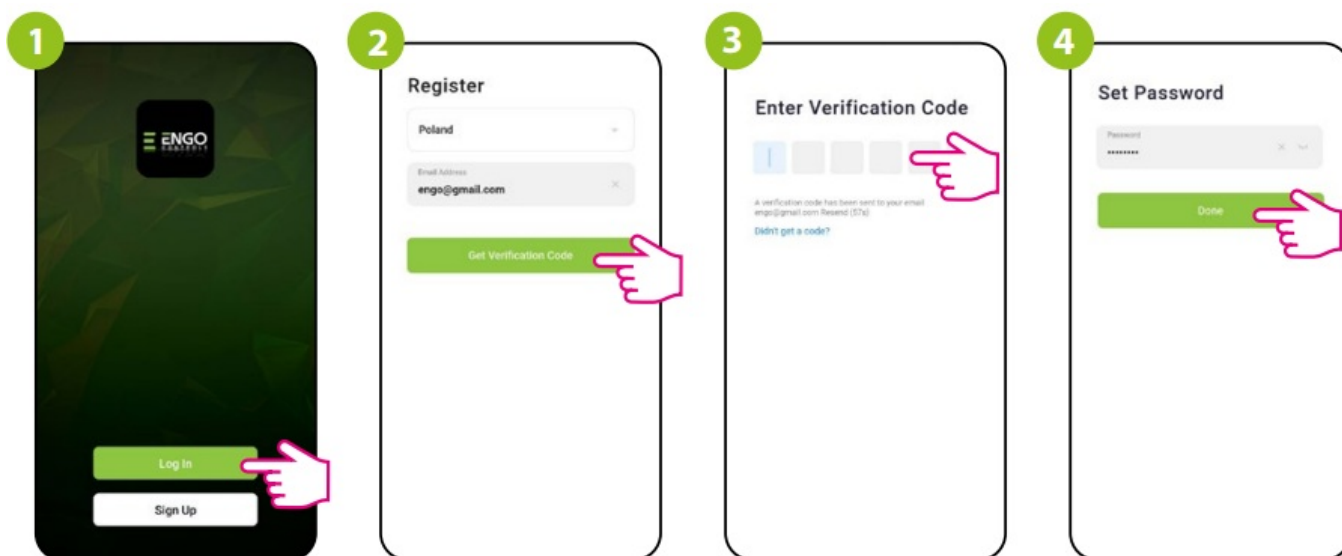

1. Enter the verification code received in the email.
2. Remember that you only have 60 seconds to enter the code!
3. Then set the login password.
4. Enter your e-mail address to which the verification code will be sent.

### STEP 3 – INSTALLATION OF THE ZigBee 3.0 REPEATER IN THE APP

After installing the app and creating an account:



1. Make sure you have added the ZigBee gateway to the app.

2. Make sure the repeater is connected to a power supply. The blue LED should flash. If not, perform a factory reset (check the „Factory reset” section).
3. Enter the gateway interface.
4. In the „Zigbee devices list” go to „Add devices”.
5. Wait until the application finds the device and click ”Done”.
6. The repeater is installed. The Blue LED diode is steady and the app shows the main interface.

## Factory Reset

Factory Reset (entering the pairing mode)

Unplug and plug again the repeater three times at intervals of 3 seconds. The LED on the device will flash, which means the repeater has been removed from the ZigBee network and gateway. After that repeater will enter pairing mode automatically. You can add it back to the ZigBee network (check the „STEP 3” section).



Ver. 2.1

**Release date:** II 2024 **Soft:** v1.0.0

**Producer:** Engo Controls S.C. 43-262 Kobielice 4 Rolna St. Poland

**Distributor:**

QL CONTROLS Sp z o.o. Sp. k. 43-262 Kobielice 4 Rolna St. Poland

[www.engocontrols.com](http://www.engocontrols.com)

## Documents / Resources

	<p><a href="#">ENGO CONTROLS REPEATERZB ZigBee Network Repeater</a> [pdf] User Guide REPEATERZB ZigBee Network Repeater, REPEATERZB, ZigBee Network Repeater, Network Repeater, Repeater</p>
--	--

## References

- [ENGO Controls - Sterowanie ogrzewaniem](#)
- [User Manual](#)

This website is an independent publication and is neither affiliated with nor endorsed by any of the trademark owners. The "Bluetooth®" word mark and logos are registered trademarks owned by Bluetooth SIG, Inc. The "Wi-Fi®" word mark and logos are registered trademarks owned by the Wi-Fi Alliance. Any use of these marks on this website does not imply any affiliation with or endorsement.