



ENGO CONTROLS ESIMPLE230W Non-Programmable Wired Thermostat User Guide

[Home](#) » [ENGO CONTROLS](#) » ENGO CONTROLS ESIMPLE230W Non-Programmable Wired Thermostat User Guide 



ENGO SIMPLE – Non-programmable, wired thermostat



QUICK GUIDE
Ver. 1
Release date: VIII 2022

Contents

- 1 INTRODUCTION:
- 2 Product Compliance
- 3 SAFETY INFORMATION:
- 4 INSTALLATION:
- 5 Package content
- 6 Wall mounting
- 7 LED light indications
- 8 Technical informations
- 9 Documents / Resources
 - 9.1 References
- 10 Related Posts

INTRODUCTION:

ESIMPLE230W / ESIMPLE230B is a surface-mounted, wired room thermostat intended for surface heating / cooling, characterized by high thermal inertia. The room setpoint temperature is set with a knob. Thanks to the built-in algorithms, it offers much better temperature control accuracy than traditional mechanical thermostats.

Product Compliance

This product complies with the following EU Directives: 2014/30/EU, 2014/35/EU, 2011/65/EU.



Please note!

SAFETY INFORMATION:

Use in accordance with national and EU regulations. Use the device only as intended, keeping it in a dry condition. The product is for indoor use only. Please read the entire manual, before installation or use.

INSTALLATION:

Installation must be performed by a qualified person with appropriate electrical qualifications, in accordance with the standards and regulations in force in a given country and in the EU. The manufacturer is not responsible for non-compliance with the instructions.

WARNING:

For the entire installation, there may be additional protection requirements, which the installer is responsible for.

Package content

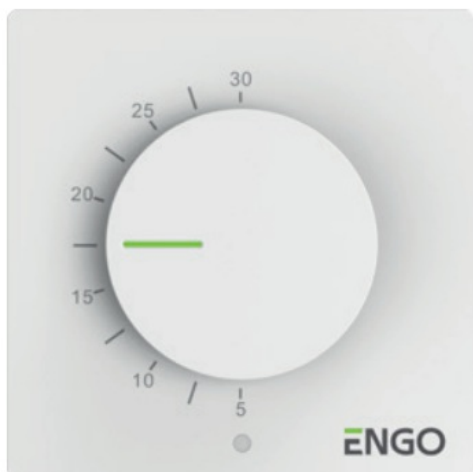

Thermostat **ESIMPLE230W** / **ESIMPLE230B**



Mounting screws



Manual

Proper thermostat location

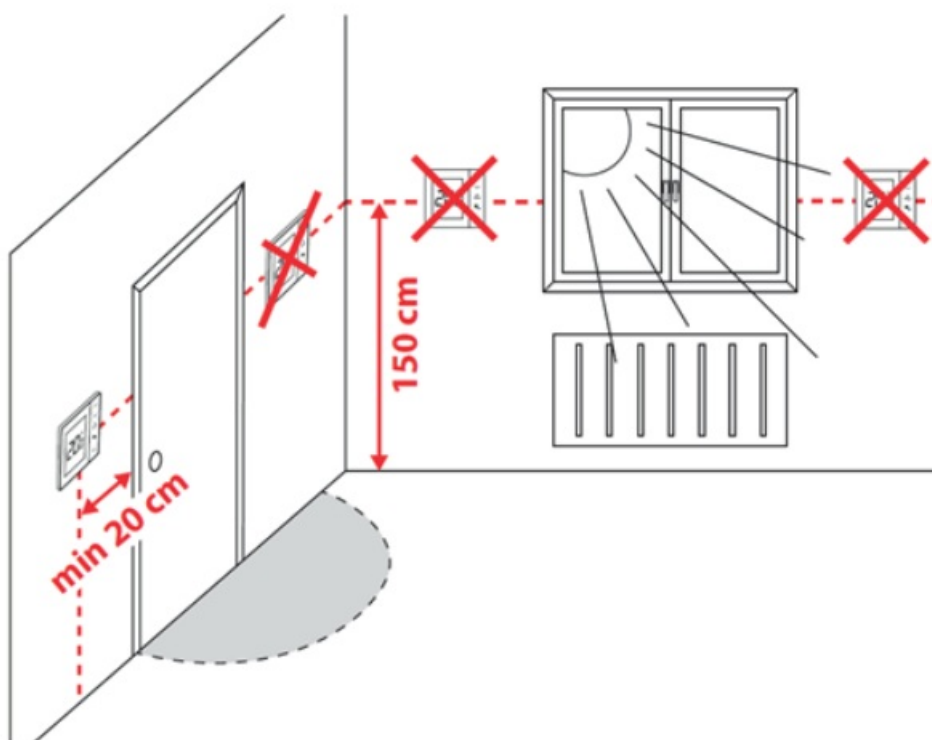

For the thermostat to work properly, it must be installed in a suitable place.

Preferably approx. 150 cm above floor level, away from sources of heat or cold. In addition, the thermostat should not be installed behind curtains or other obstacles or in places with high humidity, as this will prevent an accurate measurement of the temperature in the room. It is not recommended to install the thermostat on an outside wall, in a draft or in a place where it will be exposed to direct sunlight.

Diagram for connecting the thermostat to the underfloor heating control box.

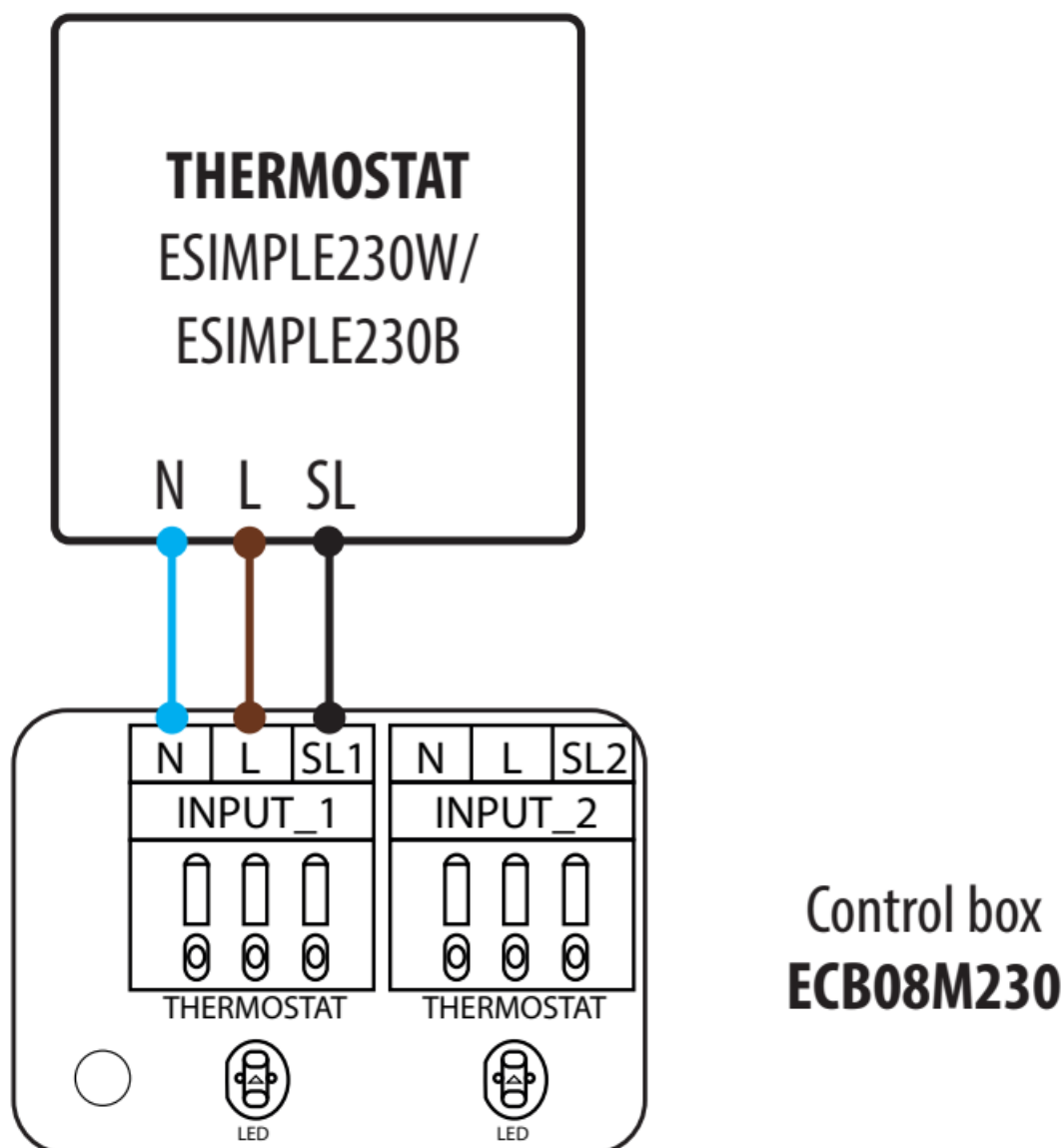

Legend:

L, N – power supply 230V

SL – 230V output signal from thermostat

SL1...SL8 – 230V control input in the control box

Wall mounting



Please note!

During wire connections procedure, please make sure they are not connected to the 230V AC power supply.

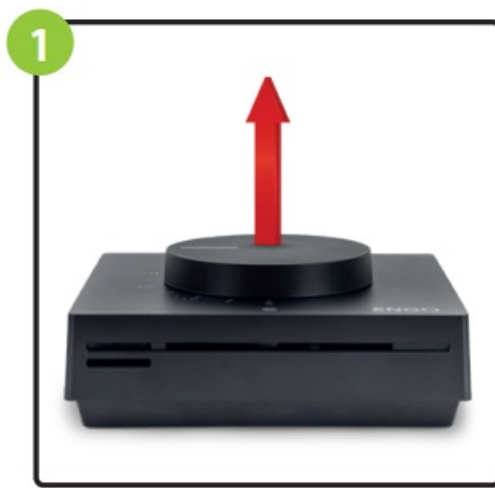

Take off the knob.

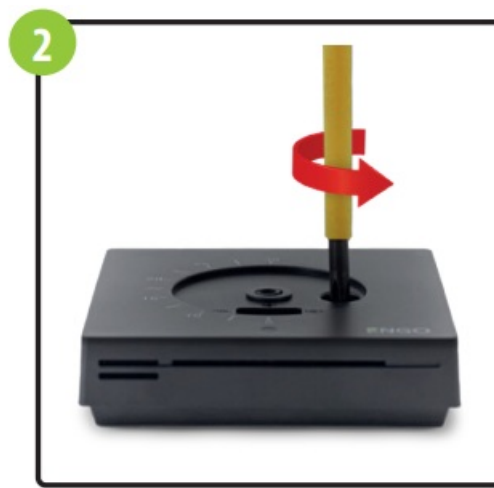

Unscrew the screw placed under the knob.

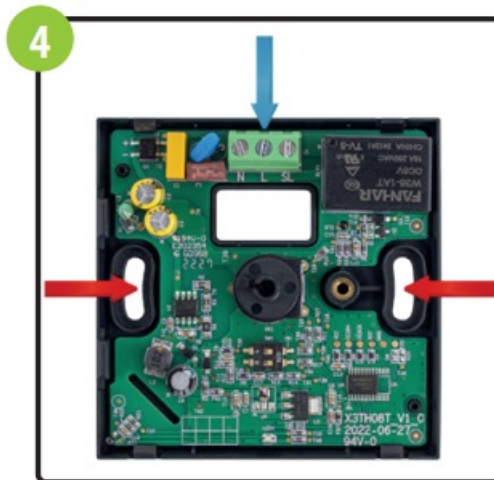

Take off the front cover of the thermostat, as shown in the picture. Connect the thermostat as shown in the connection diagram above (see blue arrow). Then attach it to the wall using the supplied mounting screws through the holes provided (see red arrows).







Put the front cover back in place and screw both parts together. Insert the knob paying attention to the attachment method. Thermostat is ready to use. You can set the temperature using the knob.

Switches (sliders) for additional settings



Additional functions of the ESIMPLE230W / ESIMPLE230B thermostats can be switched on or off by switches, which are located on the front cover, under the knob. Refer to the table below to understand what these features are:

Upper slider*	Function	Slider position
HEAT	Heating mode	
COOL	Cooling mode	
Bottom slider**	Function	Slider position
SPAN	Hysteresis ($\pm 0.5^{\circ}\text{C}$)	
TPI	TPI Algorithm	

Selecting the heating or cooling mode*

The heating or cooling mode is based on the setting of the switches (sliders), which are located under the knob on the front cover. The position of the HEAT slider indicates the heating mode. When heating is required, a red LED lights up and the thermostat gives a voltage of 230V at the SL output. The position of the COOL slider indicates the cooling mode. When cooling is required, a blue LED lights up and the thermostat gives 230V at the SL output. When the thermostat is not in work mode, the LEDs are turned off.

Operation algorithm selection**

The thermostat gives a possibility to choose the mode of controlling the room temperature by TPI algorithm or by hysteresis $\pm 0.5^{\circ}\text{C}$. The TPI algorithm is designed for underfloor heating (for heating systems with high inertia) –

to precisely maintain the room temperature.

LED light indications

The status of the thermostat is determined by the LED, illuminating in the following colors:



A detailed explanation of the meaning of the LED lights can be found in the table below:

LED DIODE	EXPLANATION
Solid red	Thermostat sends a signal for heating (the thermostat gives 230V at the SL output).
Solid blue	Thermostat sends a signal for cooling (the thermostat gives 230V at the SL output).
Off	Temperature has been reached or no power supply.

Technical informations

Power supply	230V AC 50Hz
Max load	3(1) A
Temperatur control range	5 – 30°C
Control method	TPI or Hysteresis (±0.5°C)
Communication	Wired
Output signal	230V AC
IP protection class	IP30
Dimensions	80 x 80 x 22 mm

**Producer:**

Engo Controls S.C.
43-200 Pszczyna
ul. Górnośląska 3E
Polska

Distributor:

QL CONTROLS Sp z o.o. Sp. k.
43-262 Kobielice
ul. Rolna 4
Polska

www.engocontrols.com

Documents / Resources



[ENGO CONTROLS ESIMPLE230W Non-Programmable Wired Thermostat](#) [pdf] User Guide
ESIMPLE230W, ESIMPLE230B, ESIMPLE230W Non-Programmable Wired Thermostat, ESIM
PLE230W, Non-Programmable Wired Thermostat, Wired Thermostat, Thermostat

References

- [ENGO Controls - Sterowanie ogrzewaniem](#)