

ENGO
CONTROLS
ENGO CONTROLS
EROL-ZB ZigBee Roller
Shutter



ENGO CONTROLS EROL-ZB ZigBee Roller Shutter User Guide

[Home](#) » [ENGO CONTROLS](#) » ENGO CONTROLS EROL-ZB ZigBee Roller Shutter User Guide 

Contents

- [1 ENGO CONTROLS EROL-ZB ZigBee Roller Shutter](#)
- [2 Usage Instructions](#)
- [3 Technical specifications](#)
- [4 Introduction](#)
- [5 Product Features](#)
- [6 Input/Output](#)
- [7 Button functions](#)
- [8 Connection description](#)
- [9 Installation thermostat in the app](#)
- [10 Device calibration](#)
- [11 Documents / Resources](#)
 - [11.1 References](#)
- [12 Related Posts](#)



ENGO CONTROLS EROL-ZB ZigBee Roller Shutter



Technical Specifications

- Power supply: 230V AC 50Hz
- Max load: 2×16(5)A
- Communication: ZigBee 3.0 2.4GHz
- Output: SL1, SL2 – 230V AC 50 Hz
- Input: S1, S2 – 230V AC 50 Hz
- Dimensions: 46 x 46 x 24 mm

Introduction

The roller shutter controller allows you to control rollers via a wall switch and the Engo Smart mobile app. It features 16A relays for large motor drives and can be easily installed behind the wall switch. The device enables checking the roller shutter position, setting timers and schedules, and integration with Amazon Alexa or Google Assistant. It also acts as a ZigBee network range extender.

ATTENTION:

This product requires a ZigBee gateway (sold separately) for operation.

Product Features

- Product Compliance: Complies with EU Directives 2014/53/EU and 2011/65/EU.
- Safety Information: Use in accordance with national and EU regulations. Indoor use only. Installation by qualified personnel.

Installation

Installation must be done by a qualified person following relevant electrical standards. Additional protection requirements may apply.

Input/Output

1. LED diode
2. Function button
3. Power supply 230V AC

4. SL1 – 230V AC output for opening
5. SL2 – 230V AC output for closing
6. S1 – 230V AC signal input for opening
7. S2 – 230V AC signal input for closing

LED Diode Indications

- **Flashing Blue:** Pairing mode or device not added to ZigBee network yet.
- **Blue Light:** Connected to ZigBee network.

Button Functions

Click 5 times: Module reset (device removed from network and enters pairing mode). Device beeps in pairing mode.

Connection Description

- ZigBee 3.0
- N L SL1 SL2 S1 S2
- M
- L AC 230V N PE
- Fuse
- L, N: 230V AC power supply
- PE: Ground (electricity)
- SL1, SL2: Roller shutter drive control (output) contacts – 230V
- AC
- S1, S2: Roller shutter drive control (input) contacts – 230V
- AC
- M: Roller shutter drive Monostable contact (momentary)

Wireless Communication

Install thermostat in the app. Ensure router proximity to smartphone and Internet connection for quick pairing.

Usage Instructions

Step 1 – Download Engo Smart App

Download the ENGO Smart app from Google Play or Apple App Store and install it on your smartphone.

Frequently Asked Questions (FAQ)

Q: Do I need a ZigBee gateway for this product?

A: Yes, this product must be used with a ZigBee gateway, which needs to be purchased separately for proper operation.

ZigBee Roller Shutter

EROL-ZB

Quick Guide

Ver. 1.0

Release date: IX 2024 Soft:

ZigBee module: v1.0.10 Main module: v1.2.1

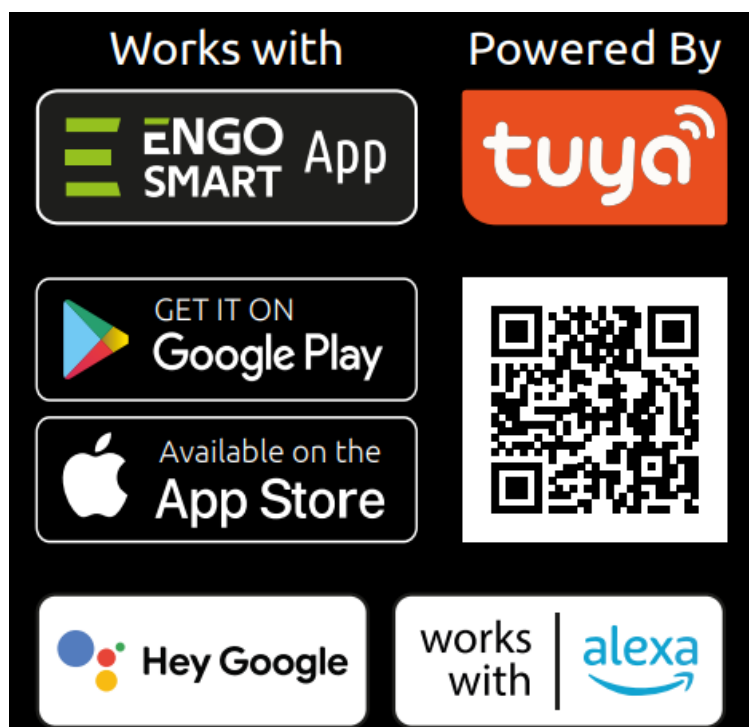

Producer:

- Engo Controls Sp z o.o. Sp. k.
- 43-262 Kobielice
- Rolna 4 St.
- Poland

www.engocontrols.com

Technical specifications

Power supply	230V AC 50Hz
Max load	2×16(5)A
Communication	ZigBee 3.0 2,4GHz
Output SL1, SL2	230V AC 50 Hz
Input S1, S2	230V AC 50 Hz
Dimension [mm]	46 x 46 x 24

Introduction

The roller shutter controller allows to control rollers via wall switch and Engo Smart mobile app. With 16A relays, the controller can cope with large motor drives. Installation in the wall box behind the wall switch is simple and aesthetically pleasing. Device allows you to check the position of the roller shutter, set timers and schedules and integrate with Amazon Alexa or Google Assistant. This device can act as a repeater as well – it will extend the ZigBee network range.

ATTENTION:

This product must be used together with ZigBee gateway (purchased separately).

Product Features

- Powerfull relays: 2x16A
- Can be controlled via roller shutter buttons or from the app
- Works with ENGO Smart (compatible with Tuya App)
- Mounting in a flush-mounted box or on a DIN rail -bracket included
- Support for voice commands via Amazon Alexa or Google Assistant.
- Works as ZigBee repeater

Product Compliance

This product complies with the following EU Directives: 2014/53/EU i 2011/65/EU.

Safety Information:

Use in accordance with national and EU regulations. Use the device only as intended, keeping it in a dry condition. The product is for indoor use only. Installation must be carried out by a qualified person in accordance with national and EU regulations.

Installation:

Installation must be performed by a qualified person with appropriate electrical qualifications, in accordance with the standards and regulations in force in a given country and in the EU. The manufacturer is not responsible for non-compliance with the instructions.

ATTENTION:



For the entire installation, there may be additional protection requirements, which the installer is responsible for.

Input/Output



1. LED diode
2. Function button
3. Power supply 230V AC
4. SL1 – 230V AC output for opening
5. SL2 – 230V AC output for closing
6. S1 – 230V AC signal input for opening
7. S2 – 230V AC signal input for closing

LED diode indications

	EXPLANATION
LED diode flashes on blue 	The device is in pairing mode with the ZigBee network (when the device does not has been previously added to the ZigBee network , or after restoring factory settings)
LED diode lights up blue 	The device is connected to a ZigBee network

Button functions

	EXPLANATION
click 5 times, the LED will flash blue  ..	Module reset (device will be removed from the ZigBee network and automatically will go into pairing mode). In addition, device beeps when in pairing mode.

Connection description

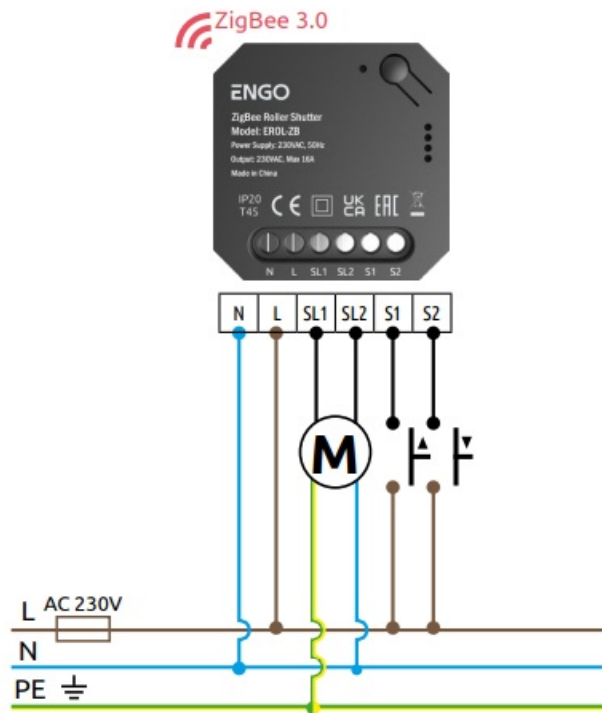

Legend:

 Fuse

L, N 230V AC power supply

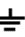
PE  Ground (electricity)

SL1, SL2 Roller shutter drive control (output) contacts – 230V AC

S1, S2 Roller shutter drive control (input) contacts – 230V AC

 M Roller shutter drive

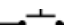
 Monostable contact (momentary)

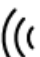
 Wireless communication

Installation thermostat in the app

Make sure your router is within range of your smartphone. Make sure you are connected to the Internet. This will reduce the pairing time of the device.

STEP 1 – DOWNLOAD ENGO SMART APP

Download the ENGO Smart app from Google Play or Apple App Store and install it on your smartphone.



Powered By



STEP 2 – REGISTER THE NEW ACCOUNT

To register a new account, please follow the steps below:

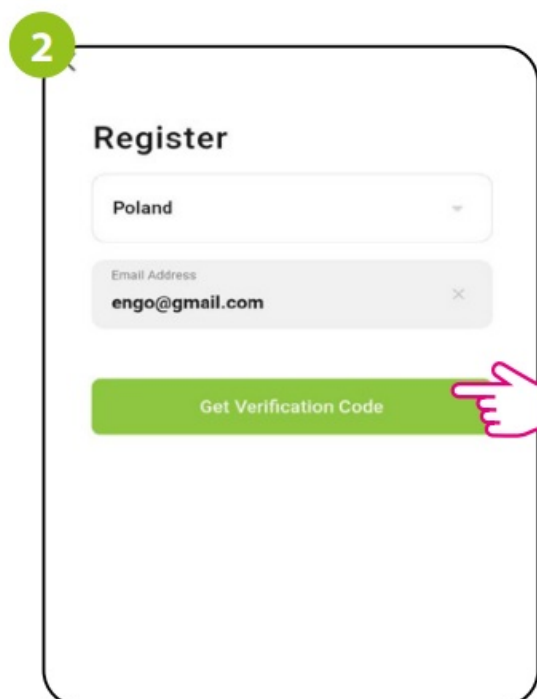
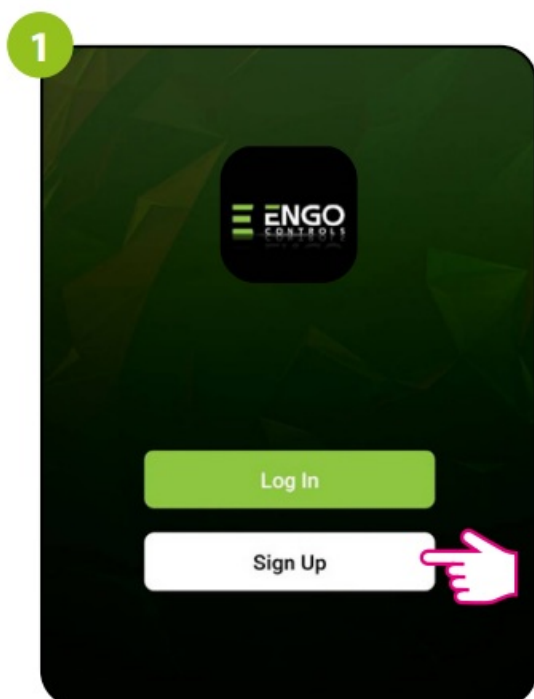

1. Click „Register” to create new account.
2. Enter your e-mail address to which the verification code will be sent.

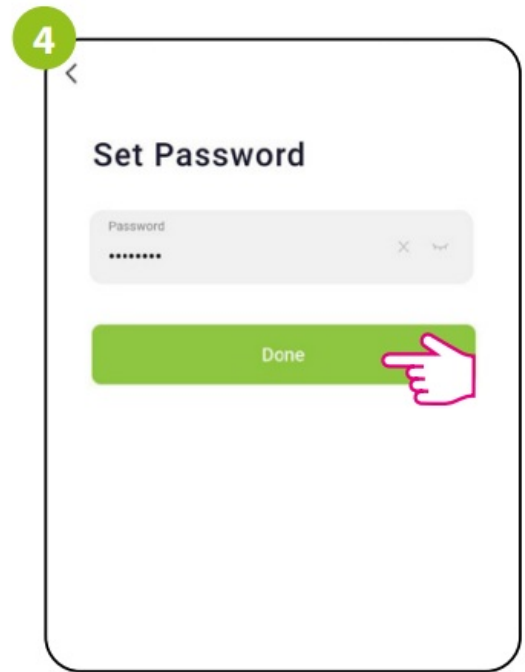
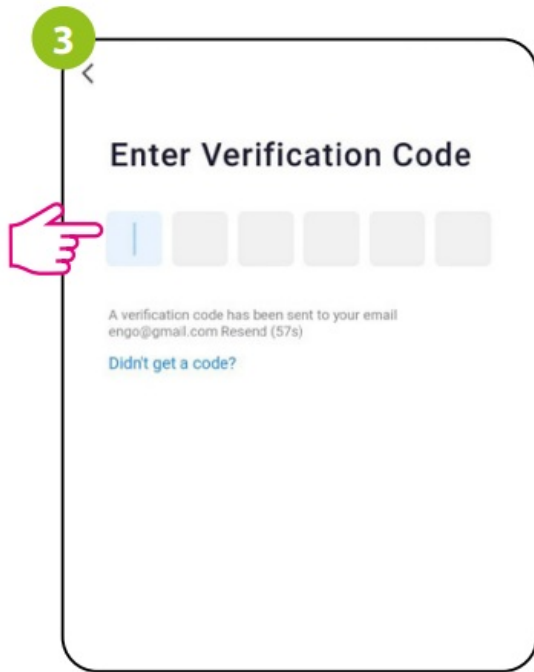

3. Enter the verification code received in the email. Remember that you only have 60 seconds to enter the code!!
4. Then set the login password.

STEP 3 – CONNECT THE RELAY TO ZigBee NETWORK

After installing the application and creating an account, follow these steps:



1. Make sure ZigBee gateway has been added to the Engo Smart app.
2. Make sure the roller shutter is connected to the power supply. Blue LED should flash quickly. If not, press the button 5 times quickly or switch the controller's power off/on 5 times. The relay will enter pairing mode. In addition, device beeps when in pairing mode.

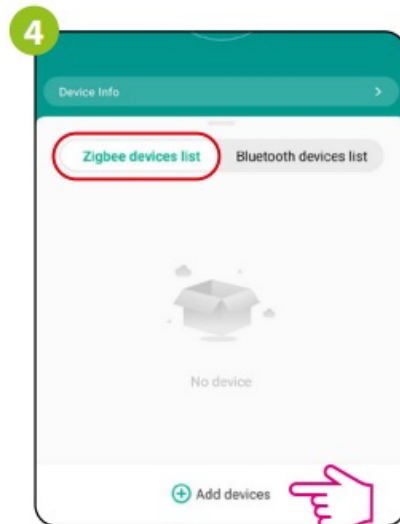
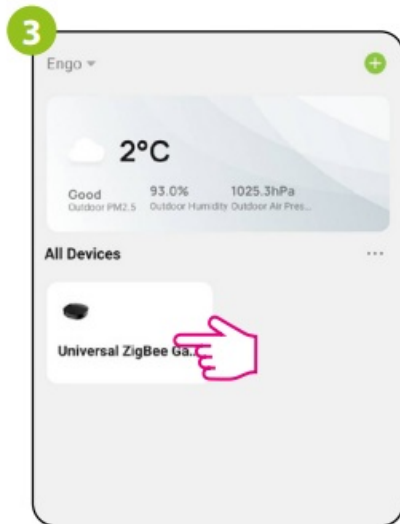

3. Enter the gateway interface.

4. In „Zigbee devices list” go „Add devices”.

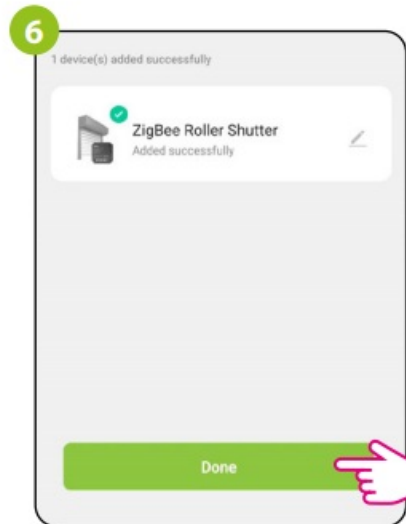
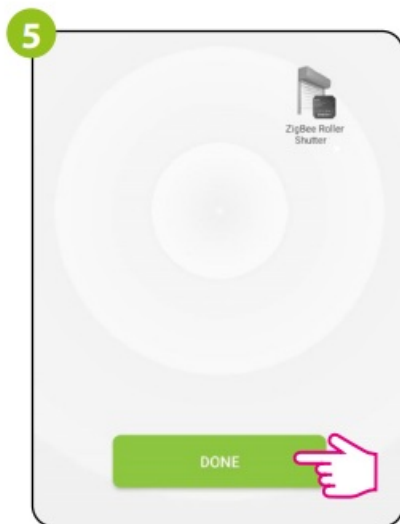

5. Wait until the application finds the roller shutter and click "Done".

6. Name the device and click "Done".

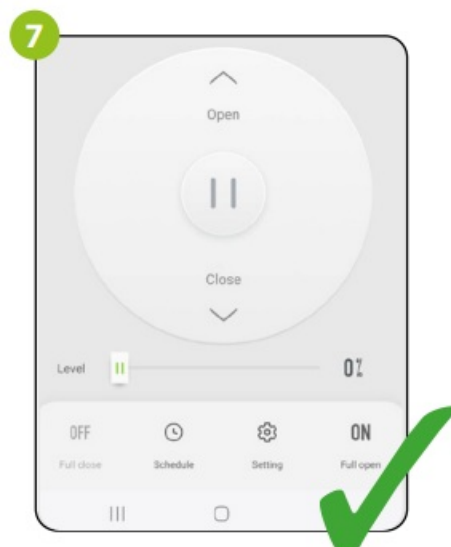

7. The roller shutter has been installed and displays the main interface.

Device calibration

It is important to calibrate opening time of the roller shutter – so the opening/closing percentage levels will be displayed accurately in the app and will refer to the actual state of the roller shutter.

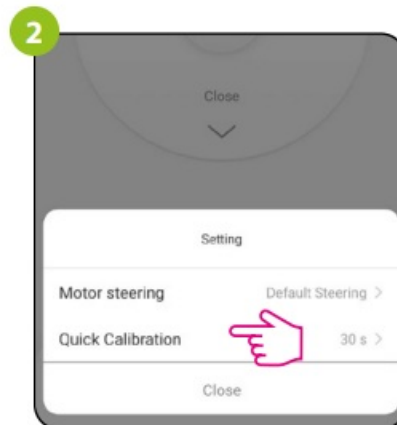
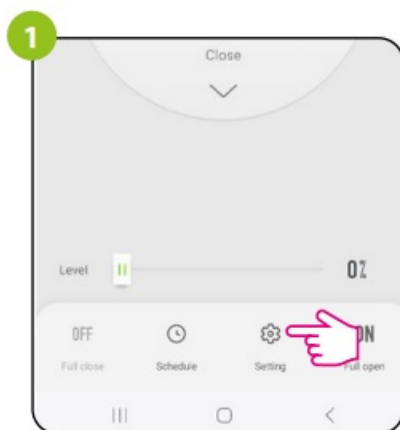

1. Go „Settings”.
2. Select: „Quick Calibration”.

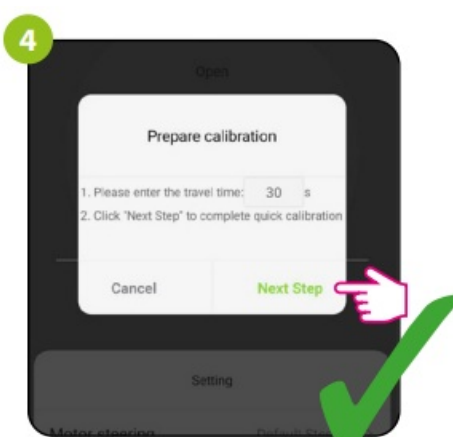
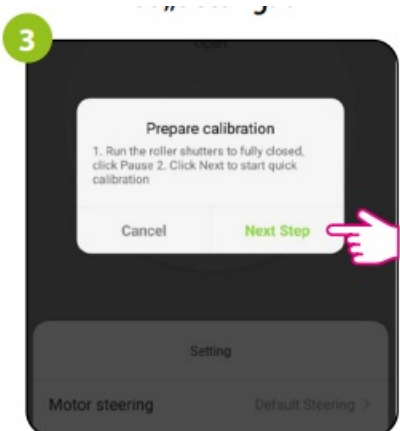

3. Click „Next step”.
4. Enter the opening time of the roller shutter and confirm.

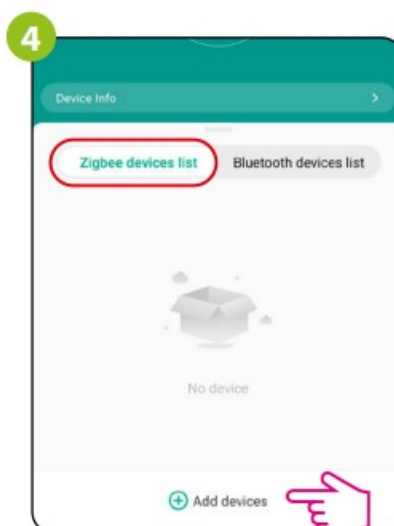
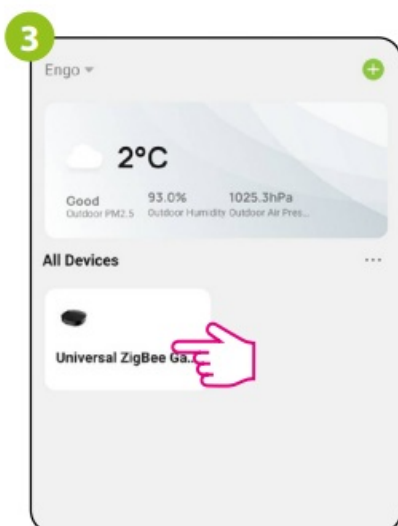

Factory reset

To reset the device, press the button 5 times quickly or switch the controller's power off/on 5 times. The LED will start flashing blue. The roller shutter will be removed from the application, then goes into pairing mode. Now it's possible to add the relay again (see STEP 3 – CONNECT THE RELAY TO ZigBee). Device will return to the previous network if it is not added to the new one.



Documents / Resources

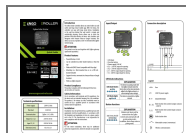

[ENGO CONTROLS EROL-ZB ZigBee Roller Shutter](#) [pdf] User Guide
EROL-ZB ZigBee Roller Shutter, EROL-ZB, ZigBee Roller Shutter, Roller Shutter, Shutter

References

- [ENG](#) [ENGO Controls - Sterowanie ogrzewaniem](#)
- [User Manual](#)

[Manuals+](#), [Privacy Policy](#)

This website is an independent publication and is neither affiliated with nor endorsed by any of the trademark owners. The "Bluetooth®" word mark and logos are registered trademarks owned by Bluetooth SIG, Inc. The "Wi-Fi®" word mark and logos are registered trademarks owned by the Wi-Fi Alliance. Any use of these marks on this website does not imply any affiliation with or endorsement.