



**ENGO
CONTROLS
EPLUG-ZB
ZigBee
Smart Plug**



ENGO CONTROLS EPLUG-ZB ZigBee Smart Plug User Guide

[Home](#) » [ENGO CONTROLS](#) » ENGO CONTROLS EPLUG-ZB ZigBee Smart Plug User Guide 

Contents

- [1 ENGO CONTROLS EPLUG-ZB ZigBee Smart Plug](#)
- [2 Device description](#)
- [3 Technical specifications](#)
- [4 Introduction](#)
- [5 Product features](#)
- [6 Installation sensor in the app](#)
- [7 Documents / Resources](#)
 - [7.1 References](#)



ENGO CONTROLS EPLUG-ZB ZigBee Smart Plug



Works with & Powered By

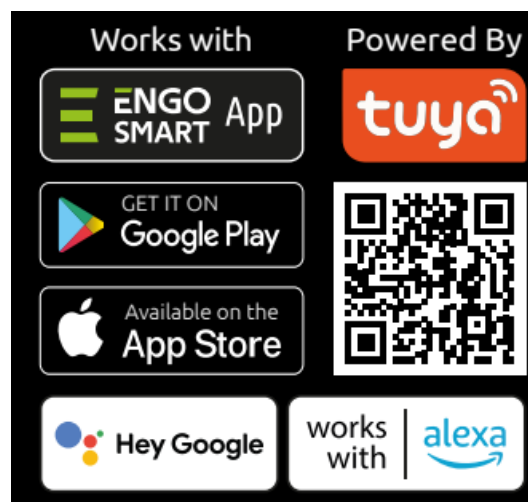

Device description



1. Function button

Pressing for 10 seconds activates pairing mode and factory reset.

press 1 time – switch plug on/off

2. LED diode

Flashing – active pairing mode with the application Lights up continuously – device on

3. Connection socket

F-type appliance (Schuko standard)





Technical specifications

- Power supply 230V AC 50Hz
- Max load 16(5)A
- Communication ZigBee 3.0, 2.4GHz
- Dimensions [mm] $\Phi 50 \times 85$

Introduction

The advanced Smartplug uses ZigBee 3.0 technology, and provides a full control of your electrical appliances. It allows you to control electrical devices up to 3680W. The temporary power consumption, current and voltage are visible in the ENGO Smart app, where the history of switching ON/OFF and electricity consumption is also visible. It is also possible to set a schedule or timer for the plug in the ENGO Smart App. The ZigBee internet gateway is required for installation in the app.

Product features

-  Works with ENGO Smart (Compatible with Tuya App)
-  ZigBee 3.0 communication standard
-  Works as repeater
-  Safety and protection for children – current path shields
-  LED indicating operation status

Product Compliance

This product complies with the following EU Directives: 2014/53/EU, 2011/65/EU.

Safety information

Use in accordance with national and EU regulations. Use the device only as intended, keeping it in a dry condition. The product is for indoor use only. Installation must be carried out by a qualified person in accordance with national and EU regulations.

Installation

Installation must be performed by a qualified person with appropriate electrical qualifications, in accordance with the standards and regulations in force in a given country and in the EU. The manufacturer is not responsible for non-compliance with the instructions.

ATTENTION:

For the entire installation, there may be additional protection requirements, which the installer is responsible for.

Installation sensor in the app

Make sure your router is within range of your smartphone. Make sure you are connected to the Internet. This will reduce the pairing time of the device.

STEP 1 – DOWNLOAD ENGO SMART APP

Download the ENGO Smart app from Google Play or Apple App Store and install it on your smartphone.

Download the ENGO Smart app from
Google Play or Apple App Store and install
it on your smartphone.

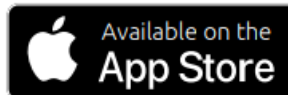

Powered By



STEP 2 – REGISTER THE NEW ACCOUNT

To register a new account, please follow the steps below:

1. Click „Register” to create new account.
2. Enter your e-mail address to which the verification code will be sent.

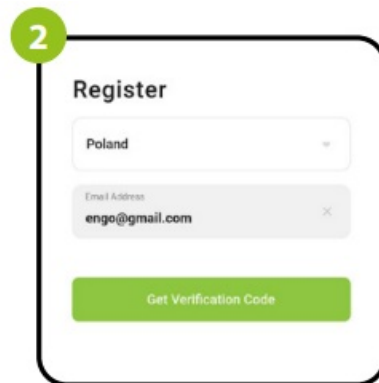

3. Enter the verification code received in the email. Remember that you only have 60 seconds to enter the code!!
4. Then set the login password.

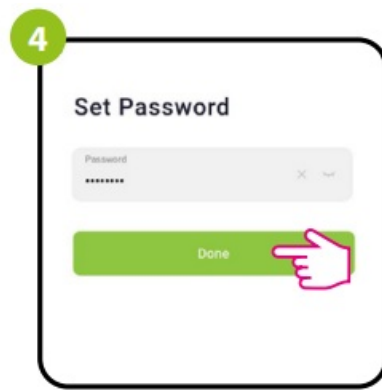
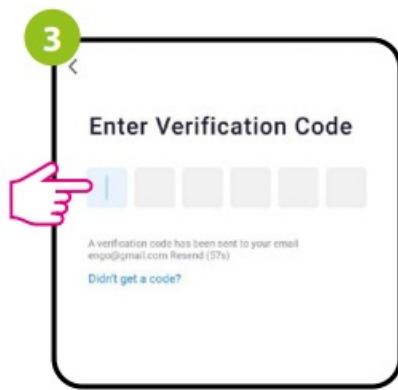

STEP 3 – CONNECT THE SMART PLUG TO ZigBee network

After installing the application and creating an account, follow these steps:

1. Make sure ZigBee gateway has been added to the Engo Smart app.
2. Press and hold the button for about 10 seconds until the LED starts flashing. The plug will enter pairing mode.



3. Enter the gateway interface.
4. In „Zigbee devices list” go „Add devices”.

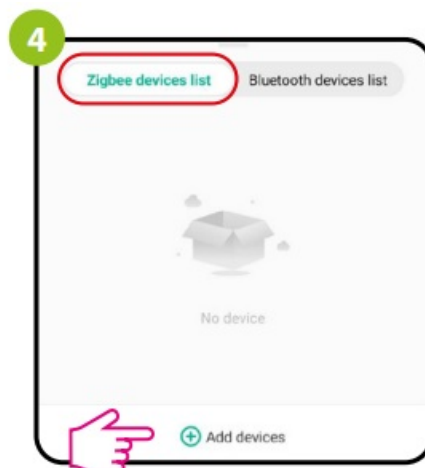
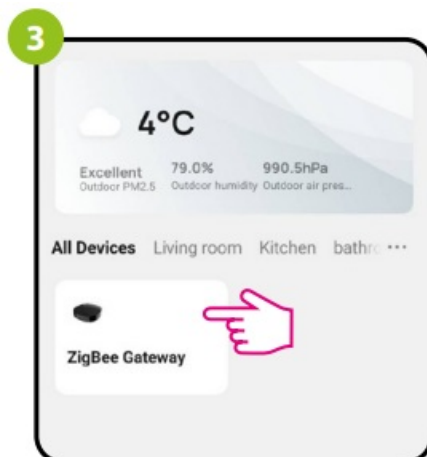

5. Wait until the application finds the device and click "Done".
6. The plug has been installed and displays the main interface.

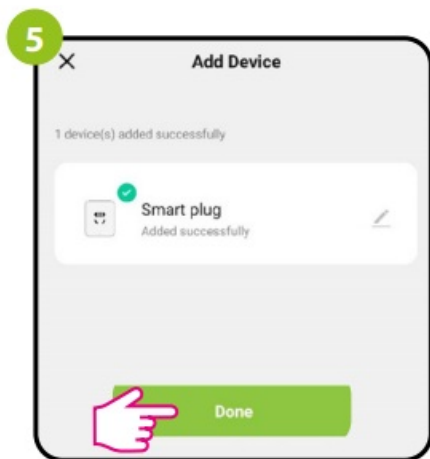

Ver. 1.0

Release date: VIII 2024

Soft: V1.0.14

Producer:

Engo Controls sp. z o.o. sp. k.

43-262 Kobielice Rolna 4 St. Poland

www.engocontrols.com

Documents / Resources



[ENGOCONTROLS EPLUG-ZB ZigBee Smart Plug](#) [pdf] User Guide
EPLUG-ZB, EPLUG-ZB ZigBee Smart Plug, ZigBee Smart Plug, Smart Plug, Plug

References

- [ENGOC Controls - Sterowanie ogrzewaniem](#)
- [User Manual](#)

Manuals+ Privacy Policy

This website is an independent publication and is neither affiliated with nor endorsed by any of the trademark owners. The "Bluetooth®" word mark and logos are registered trademarks owned by Bluetooth SIG, Inc. The "Wi-Fi®" word mark and logos are registered trademarks owned by the Wi-Fi Alliance. Any use of these marks on this website does not imply any affiliation with or endorsement.