



ENGO CONTROLS EIRTXWIFI Wi-Fi IrDA Transmitter User Guide

[Home](#) » [ENGO CONTROLS](#) » ENGO CONTROLS EIRTXWIFI Wi-Fi IrDA Transmitter User Guide 

ENGO CONTROLS EIRTXWIFI Wi-Fi IrDA Transmitter



Contents

- [1 INTRODUCTION](#)
- [2 Product Compliance](#)
- [3 Technical specification](#)
- [4 Device application with the ENGO APP and devices](#)
- [5 EIRTXWIFI installation](#)
- [6 Explanation for LED indicator](#)
- [7 Installation of the IR remote control in the APP](#)
 - [7.1 STEP 1 – DOWNLOAD ENGO SMART APP](#)
 - [7.2 STEP 2 – REGISTER THE NEW ACCOUNT](#)
 - [7.3 STEP 3 – CONNECT THE IR REMOTE CONTROL TO WI-FI](#)
- [8 Reset of the remote control](#)
- [9 CUSTOMER SUPPORT](#)
- [10 Documents / Resources](#)
 - [10.1 References](#)
- [11 Related Posts](#)

INTRODUCTION

EIRTXWIFI is a universal product that can replace a traditional remote control. It allows you to conveniently control various infrared receiving devices, such as TV, decoder, air conditioner, etc. It supports local and remote control of devices. In addition, using the ENGO Smart mobile app, you can create scenes to, for example, automatically turn on/off the TV or air conditioner (only when Wi-Fi is available).

Product Compliance

This product complies with the following EU Directives: 2014/53/EU, 2016/65/EU

Technical specification

Power supply	5V DC micro USB
Communication	WiFi 2,4 GHz
Dimensions	72 x 72 x 21 mm

Device application with the ENGO APP and devices

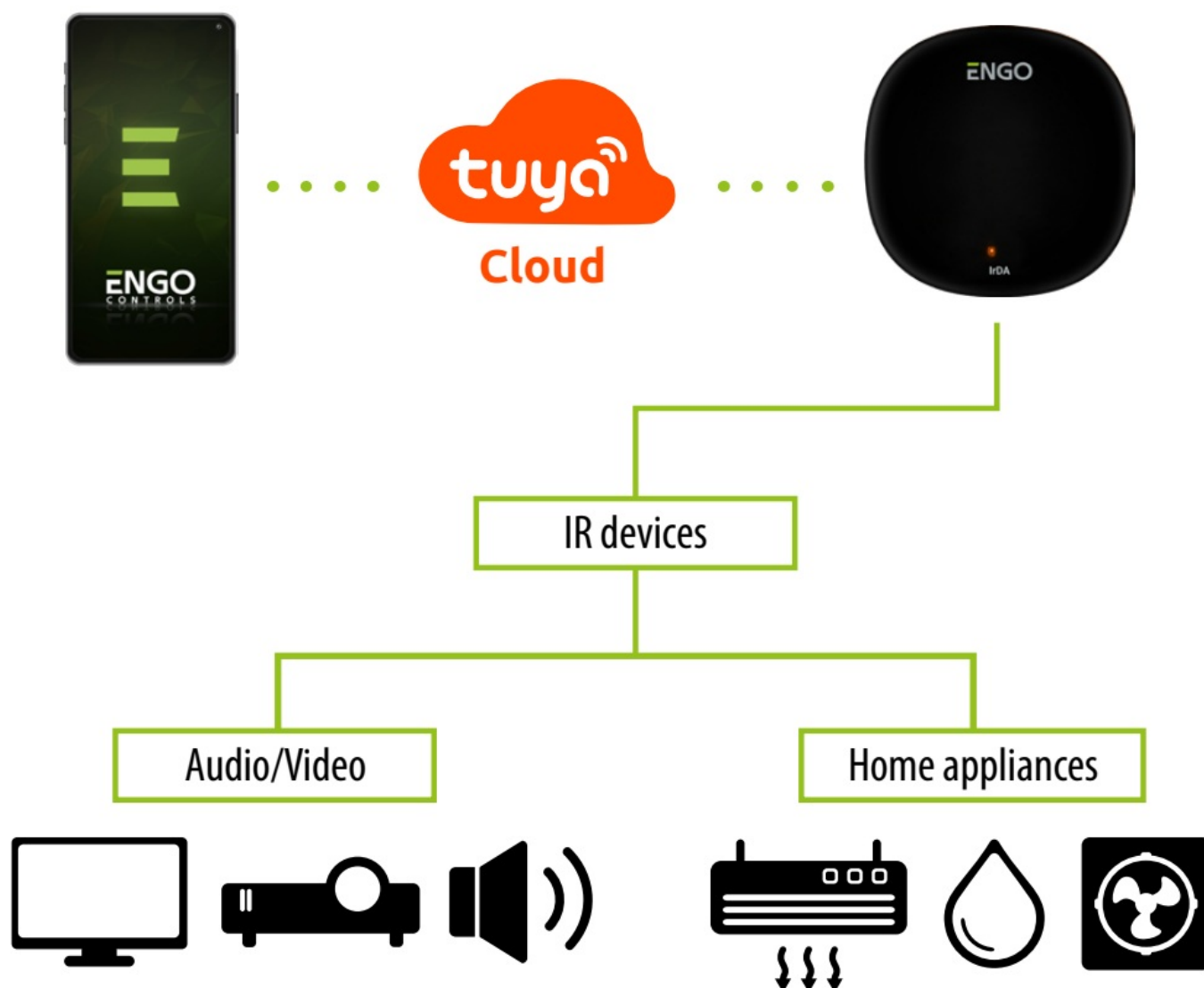

EIRTXWIFI installation



Warning!

Connect the EIRTXWIFI remote control to a 230V AC power supply, use the supplied plug and USB cable only. The remote control must be placed in the same room as the controlled devices. EIRTXWIFI sends an infrared signal – lack of architectural barriers is required for proper control of the devices.

Explanation for LED indicator



LED indicates current status of the device

LED status	Device status	Explanation
LED is flashing	The device is in pairing mode	This mode is activated by holding the Reset button (10 sec.)
LED is off	<ol style="list-style-type: none"> 1. The device is connected to the Internet 2. No power supply 	<ol style="list-style-type: none"> 1. Normal work mode 2. Connect the device to a power supply
LED lights up	<ol style="list-style-type: none"> 1. The device is not connected to the Internet 2. The device is in learning mode 	<ol style="list-style-type: none"> 1. Check network connection quality or if the router is connected correctl 2. When the device is correctly connected to the network, it goes into learning mode. When the process is successful, the yellow LED will turn off

Installation of the IR remote control in the APP

Make sure your router is within range of your smartphone. Make sure you are connected to the Internet. This will reduce the pairing time of the device.

STEP 1 – DOWNLOAD ENGO SMART APP

Download the ENGO Smart app from Google Play or Apple App Store and install it on your smartphone.



STEP 2 – REGISTER THE NEW ACCOUNT

To register a new account, please follow the steps below:

1. Click „Register” to create new account.

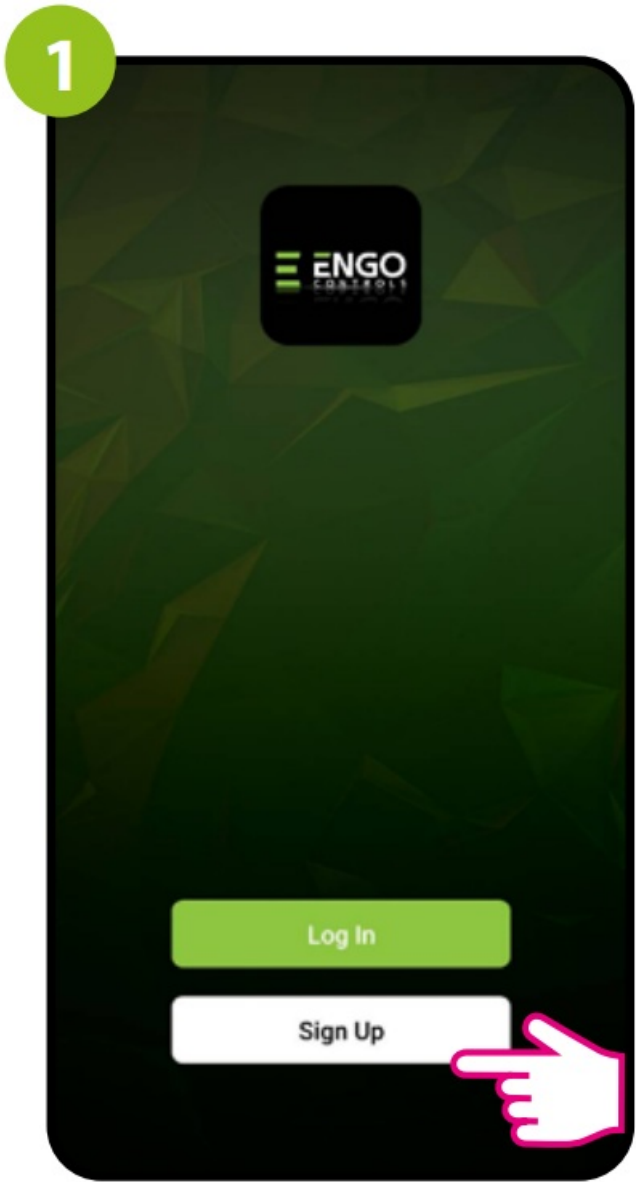

2. Enter your e-mail address to which the verification code will be sent.

2

Register

Poland

Email Address
engo@gmail.com

Get Verification Code



3. Enter the verification code received in the email.
Remember that you only have 60 seconds to enter the code!

3

Enter Verification Code

|

A verification code has been sent to your email
engo@gmail.com Resend (57s)

[Didn't get a code?](#)



4. Then set the login password.



STEP 3 – CONNECT THE IR REMOTE CONTROL TO WI-FI

After installing the app and creating an account:.

1. Turn on Wi-Fi and Bluetooth on your smartphone. It's best to connect mobile to the Wi-Fi network to which you want to assign the device.

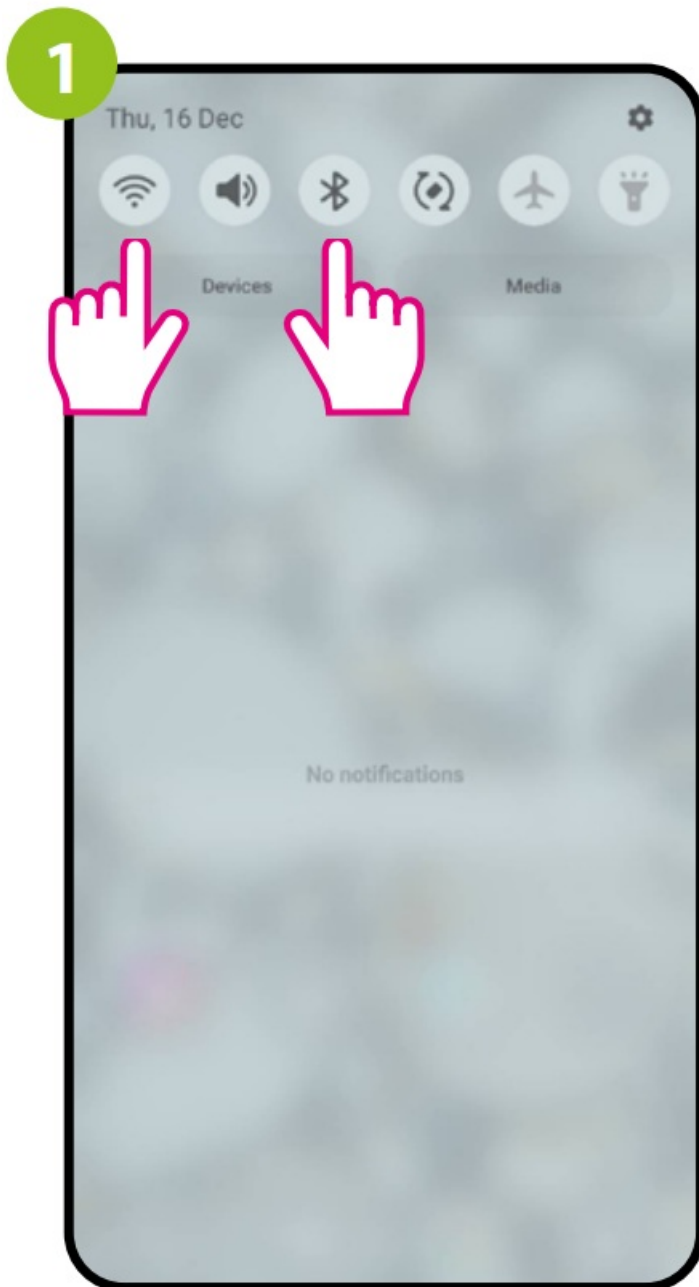

2. Make sure the device is powered on. Using the PIN included, press and hold the RESET button for 8 seconds until LED starts flashing. The pairing mode is enabled.



3. In the app, select: „Add Device”.

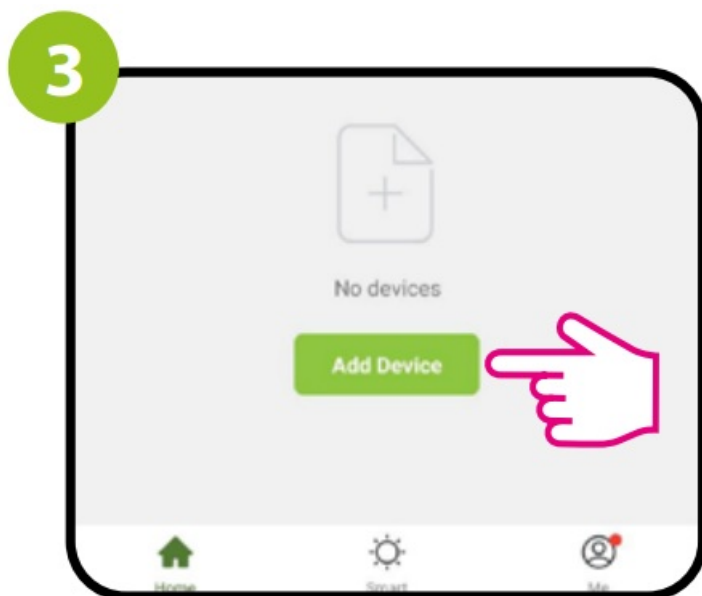

4. Then choose: „Auto Scan”.

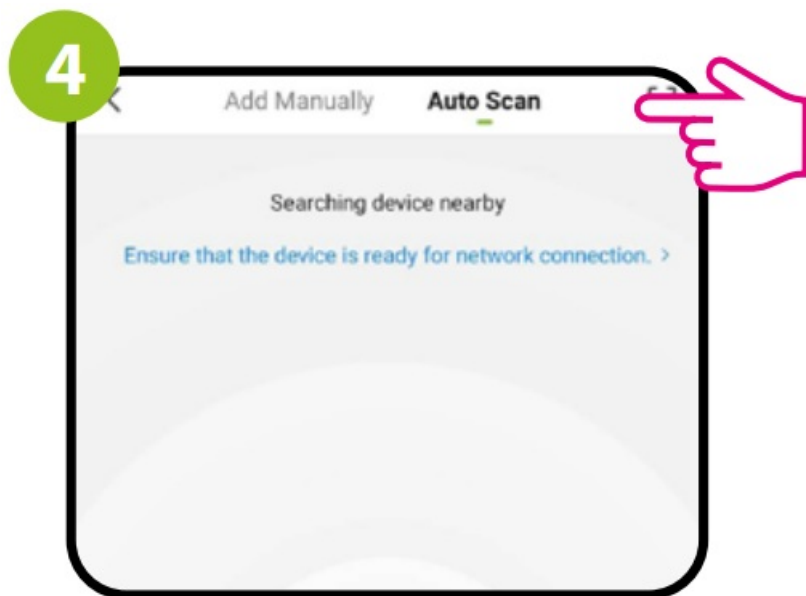

5. After finding the thermo- stat, go „Next”.



6. Select the Wi-Fi network in which the thermostat will operate and enter the password of this network.

6



7. Wait for the app to configure the thermostat with the selected Wi-Fi network.

7

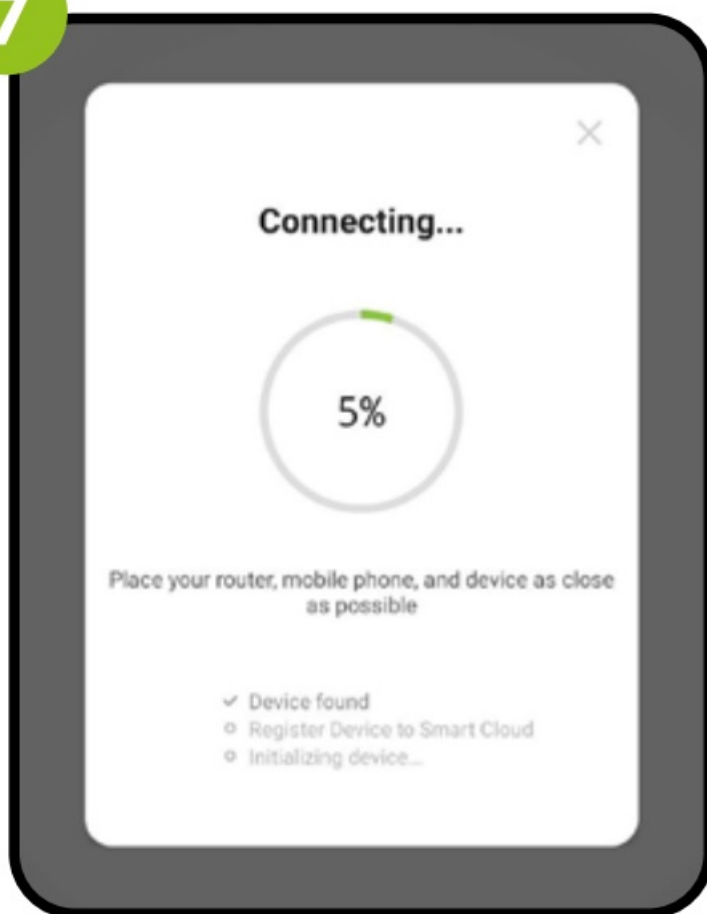

8. Name the device and click „Done”

8

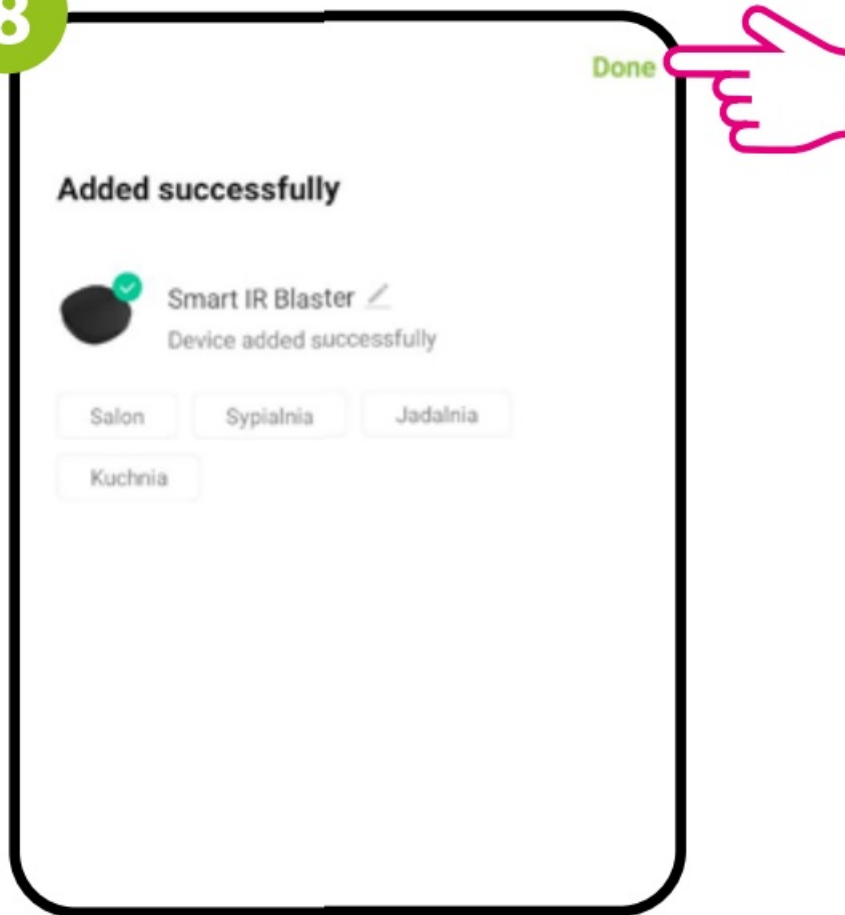

9. You can then pair up any device that supports infrared remote control. Click „Add”.

9

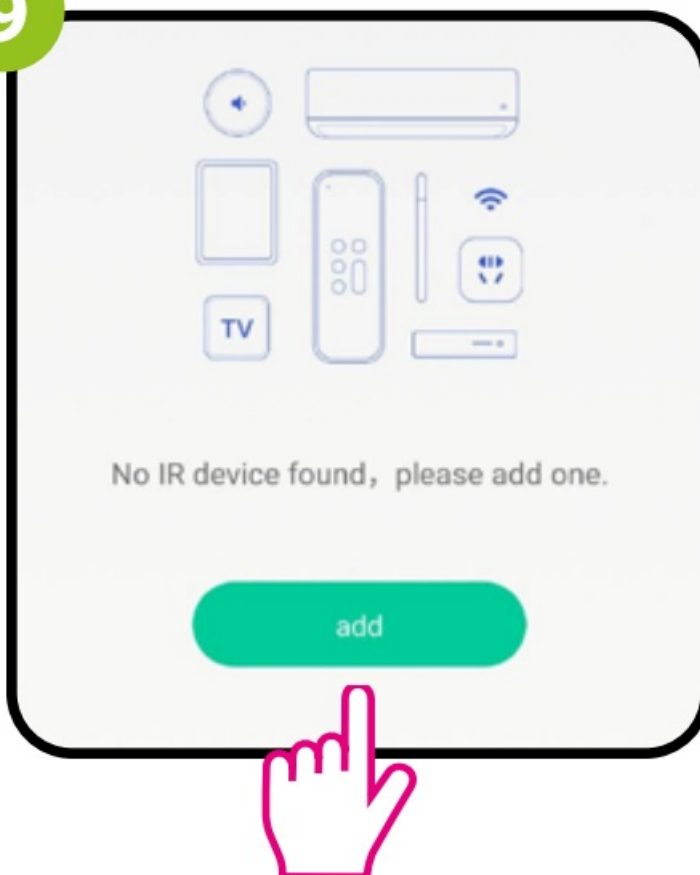

10. Choose the device type which you want to connect the IR remote control with.

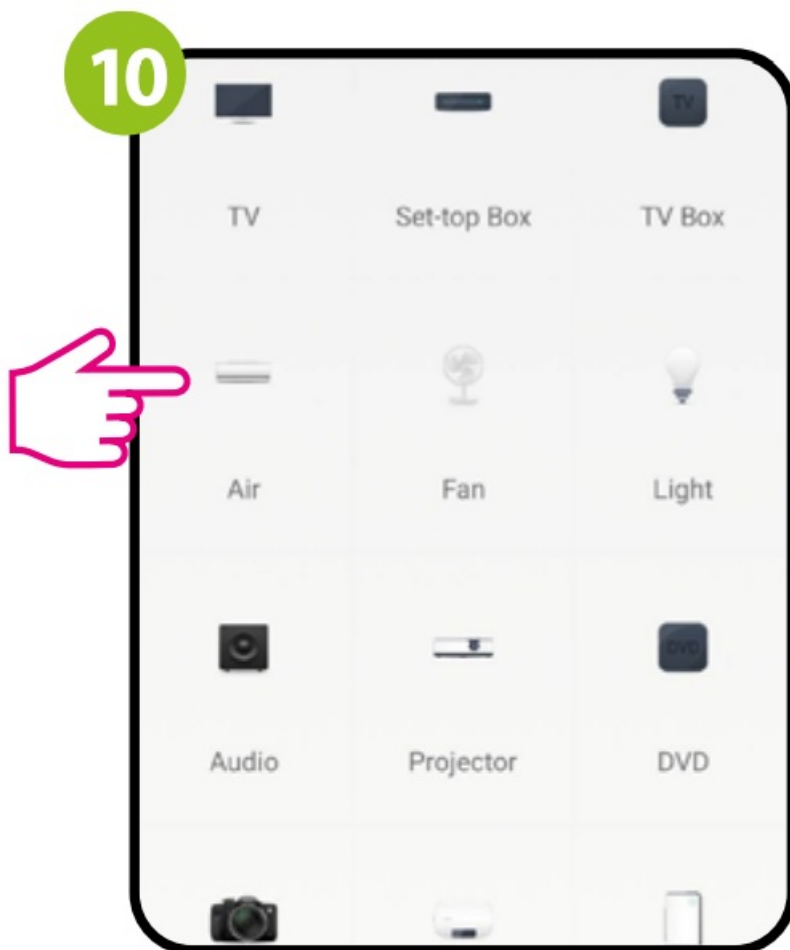

11. Choose „Quick match”.

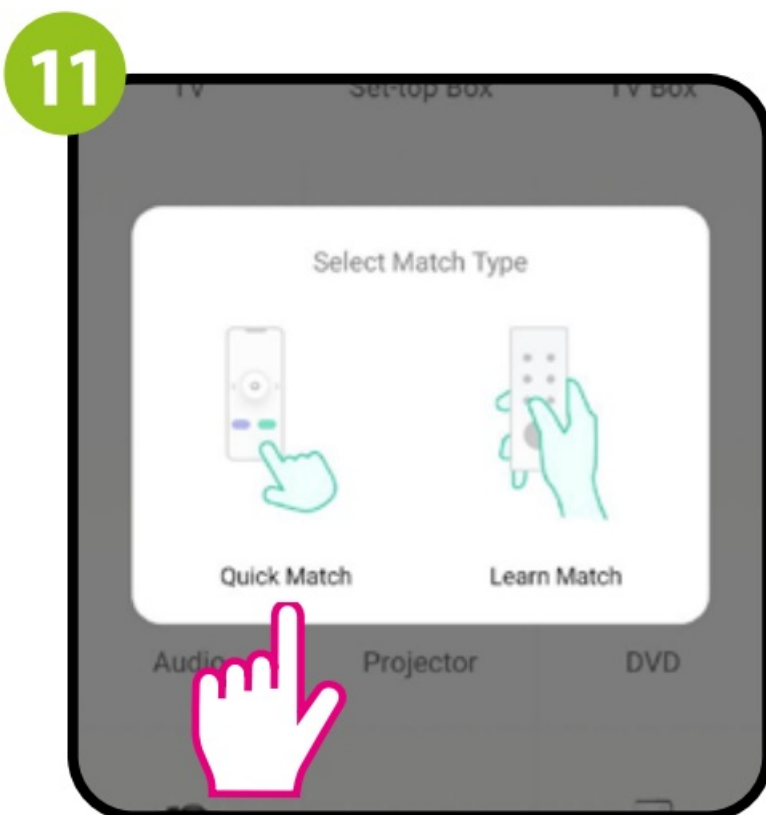

12. Find the device brand from the list and follow further instructions.

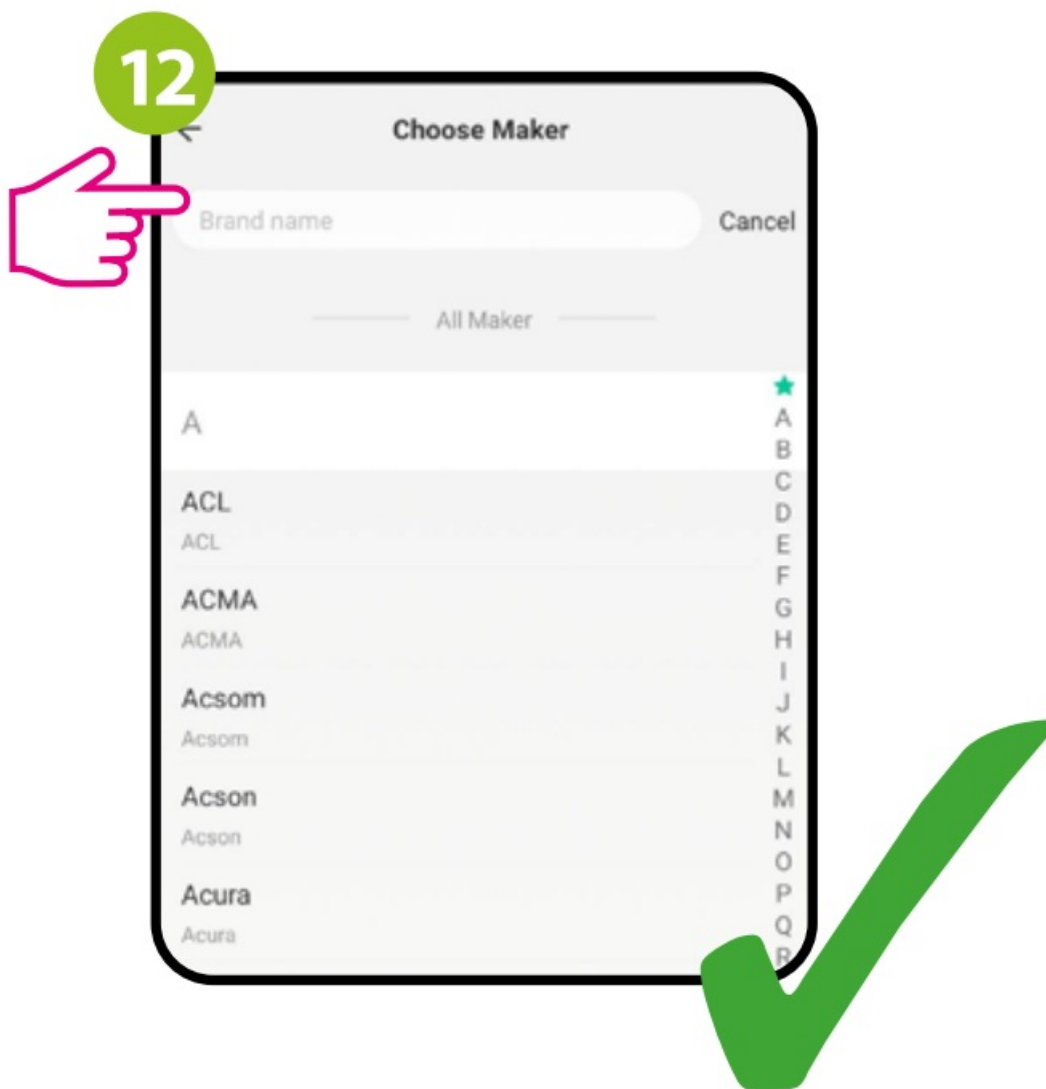

Reset of the remote control

To restore the default settings of the device, press RESET button and hold it for about 10 seconds – until the LED lights up. The IR remote control will then reset to the default (factory) settings and the pairing process will begin.

CUSTOMER SUPPORT

www.engocontrols.com



Documents / Resources



[ENGO CONTROLS EIRTXWIFI Wi-Fi IrDA Transmitter](#) [pdf] User Guide
EIRTXWIFI Wi-Fi IrDA Transmitter, EIRTXWIFI, Wi-Fi IrDA Transmitter, IrDA Transmitter, Transmitter

References

-  [ENGO Controls - Sterowanie ogrzewaniem](#)

Manuals+.