



ENGO CONTROLS EGATE-PRO ZigBee Universal Gateway User Guide

[Home](#) » [ENGO CONTROLS](#) » ENGO CONTROLS EGATE-PRO ZigBee Universal Gateway User Guide 

ENGO
CONTROLS

EGATE



EGATE-PRO
Quick Guide

Contents

- [1 EGATE-PRO ZigBee Universal Gateway](#)
- [2 Safety information](#)
- [3 Installation:](#)
- [4 Gateway description](#)
- [5 Introduction](#)
- [6 Installation](#)
- [7 Factory reset](#)
- [8 Documents / Resources](#)
 - [8.1 References](#)

EGATE-PRO ZigBee Universal Gateway

Product Compliance

This product complies with the following EU Directives: 2014/53/EU i 2011/65/EU.

Safety information

Use in accordance with national and EU regulations. Use the device only as intended, keeping it in a dry condition. The product is for indoor use only. Please read the entire manual, before installation or use.

Installation:

Installation must be performed by a qualified person with appropriate electrical qualifications, in accordance with the standards and regulations in force in a given country and in the EU. The manufacturer is not responsible for non-compliance with the instructions.



WARNING:

For the entire installation, there may be additional protection requirements, which the installer is responsible for.

Gateway description



1. Antenna
2. Blue diode
3. Red diode
4. SMA antenna socket
5. RESET button
6. USB power socket type C
7. LAN Ethernet input (RJ45)

Internet gateway operating modes



The ZigBee gateway can communicate over the internet with the cloud in two ways:

- 2.4 GHz Wi-Fi network
- Ethernet network via LAN cable







Introduction

The Internet gateway meets the needs of the most demanding Engo Smart users. It is very easy to configure the

network and the communication method can be chosen between Wi-Fi or LAN. An external antenna increases the range which ensures stable communication even in large flats or houses. It easily overcomes a reinforced concrete ceiling or several partition walls. The ability to migrate network settings to a new device without losing data gives the user security and convenience.

The function of changing communication channel settings from the device interface, eliminates interference from other devices and ensures stable operation. Operation in the ZigBee 3.0 standard allows the connection of compatible devices operating in the Tuya system. Works with Google Home and Alexa voice assistants. Housing suitable for mounting on a wall or as a free-standing unit.

Product features

	ZigBee 3.0 communication standard
	Wi-Fi 2.4 GHz communication standard
	Ethernet socket (RJ45)
	Compatibility with the application ENGO Smart (in technology Tuya Cloud)
	LEDs indicating operation status
	Stores smart rules
	5V DC powered via USB type C

Technical data

Power supply	5V DC USB type C
Communication	ZigBee 3.0 2,4GHz Wi-Fi 2,4GHz Ethernet (RJ45)
Dimensions	90 x 90 x 22mm

Explanation for LED indicator

Red diode	Blue diode	Device status
Lights on continuously	Lights on continuously	Immediately after switching on the power supply, both LEDs light up continuously for a few seconds or immediately after a factory reset of the device
Flashes slowly	Lights on continuously	A few seconds after switching on, the gateway is ready for pairing with the application
Lights on continuously	Does not lights	Connected to the cloud
Lights on continuously	Flashes	ZigBee network is opened – searching for devices
Does not lights	Does not lights	No power supply

Installation



ATTENTION:

A minimum distance between the router and gateway of 1m is recommended to avoid WiFi and Zigbee interference.



ATTENTION:

Connect the gateway to a 230V AC power supply, use the supplied plug and USB cable only.

Installation of the gateway in the app

Make sure your router is within range of your smartphone. Make sure you are connected to the Internet. This will reduce the pairing time of the device.

STEP1 – DOWNLAD ENGO SMART APP

Download the ENGO Smart app from Google Play or Apple App Store and install it on your smartphone.

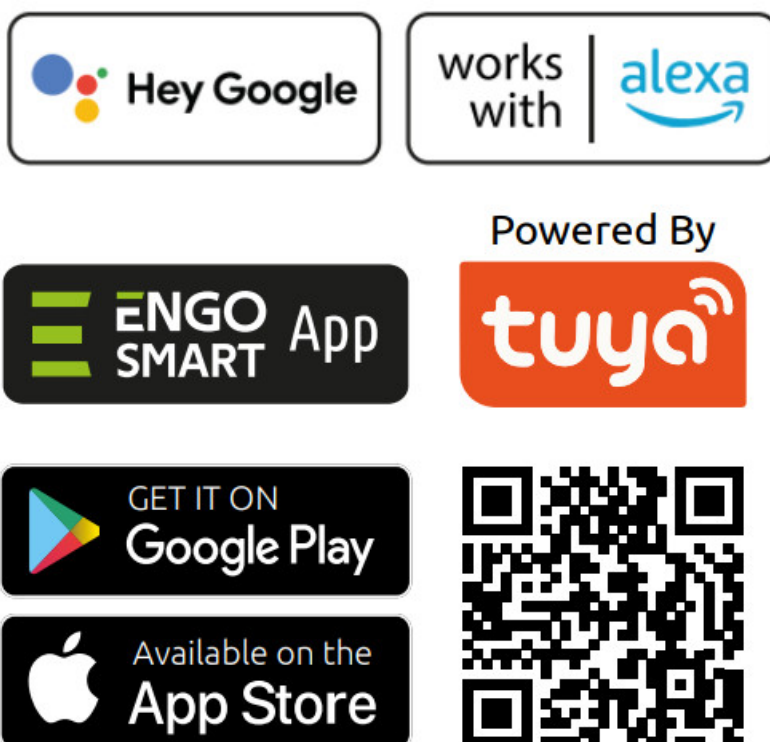

<https://engocontrols.com/redirect-app/>

STEP2 – REGISTER THE NEW ACCOUNT

To register a new account, please follow the steps below:

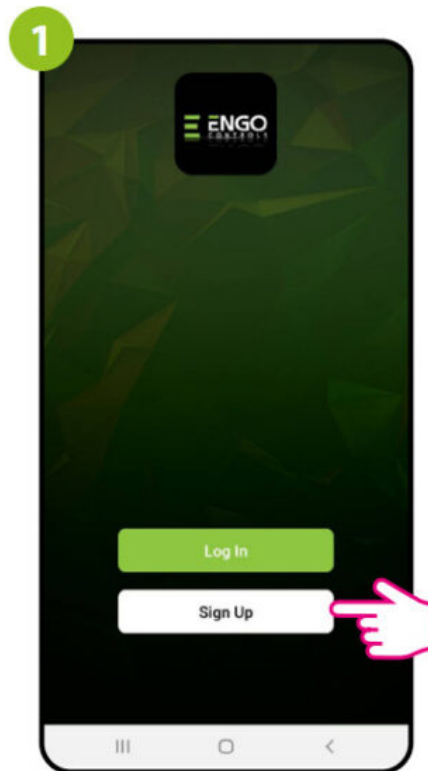

Click „Sign Up” to create new account.

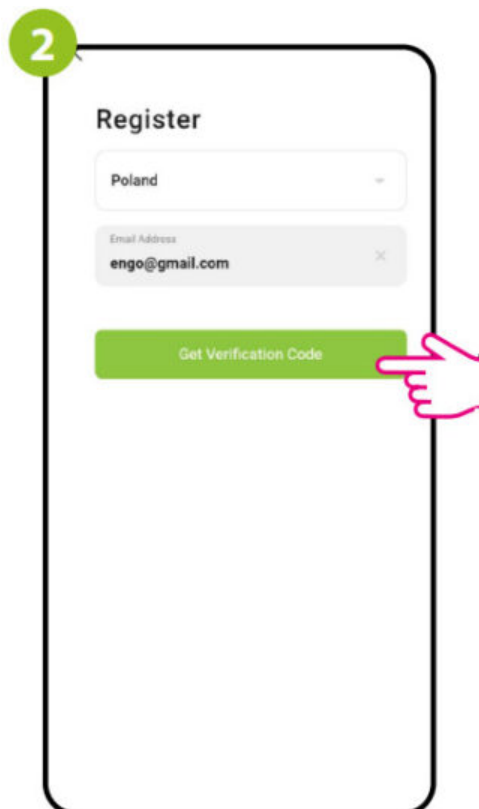

Enter your e-mail address to which the verification code will be sent.

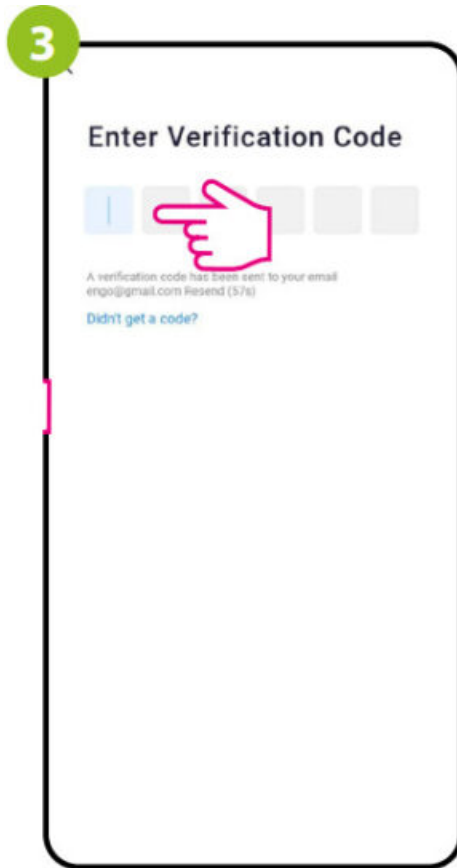

Enter the verification code received in the email.
Remember that you only have 60 seconds to enter the code!

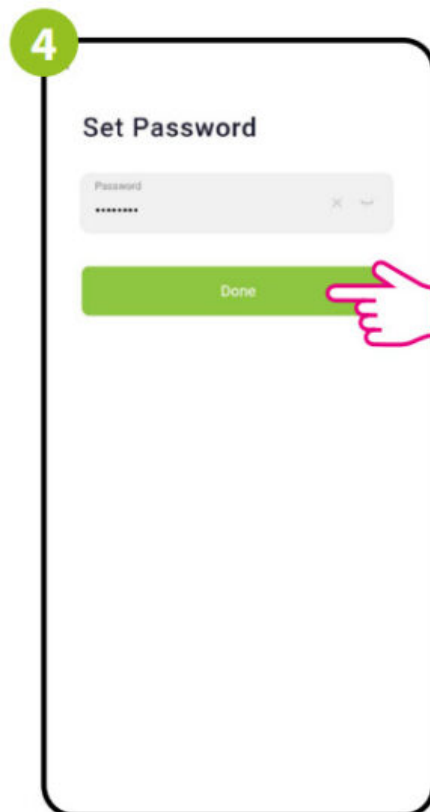

Then set the login password.

STEP 3a – Installation of the Internet gateway via LAN cable
After installing the app and creating an account:

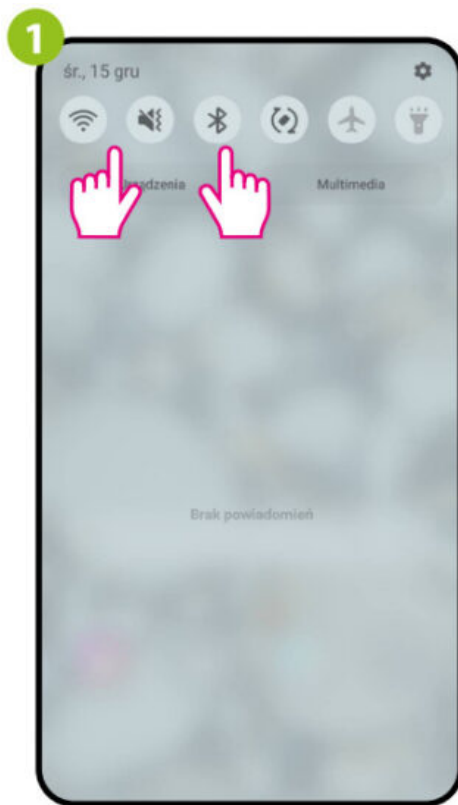

On the mobile device, make sure that the ENGO Smart app has access to the permissions (Location, Bluetooth, Nearby devices). Then turn on Bluetooth and location. Connect to that 2.4 GHz Wi-Fi network to which you want to assign the gateway (Wi-Fi and wired Ethernet must be one network – from the same router).

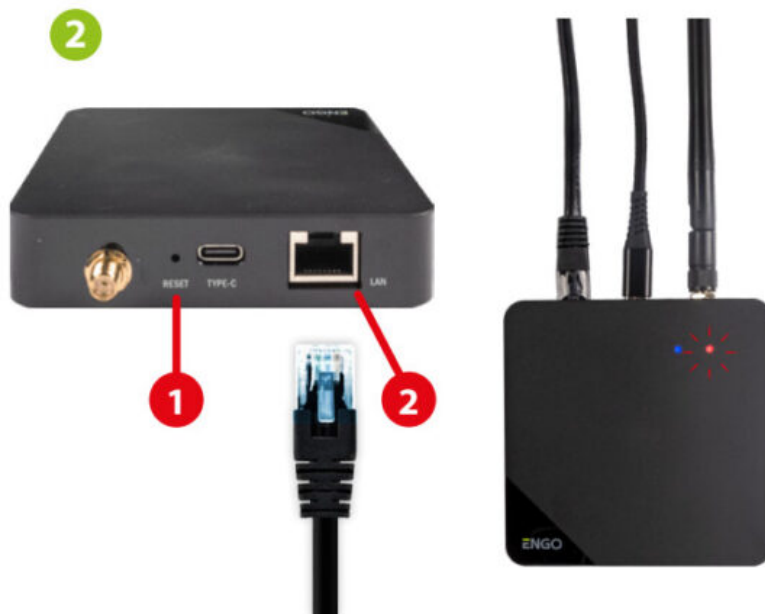

Make sure the device is connected to the power supply and to the Internet via the cable (2). Then press and hold the RESET button (1) (using the pin provided) for 10 seconds. The red LED must flash slowly, then the gateway is in pairing mode. If the red LED flashes quickly, then press the RESET button again for 10 seconds, wait a moment and make sure that the red LED flashes slowly.

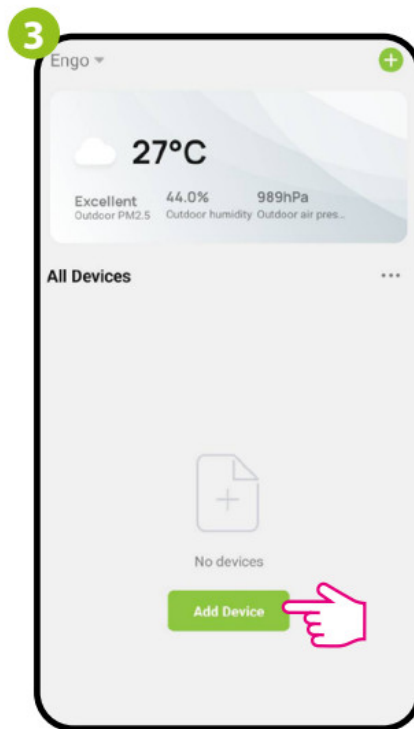

In the app, select: „Add Device”.

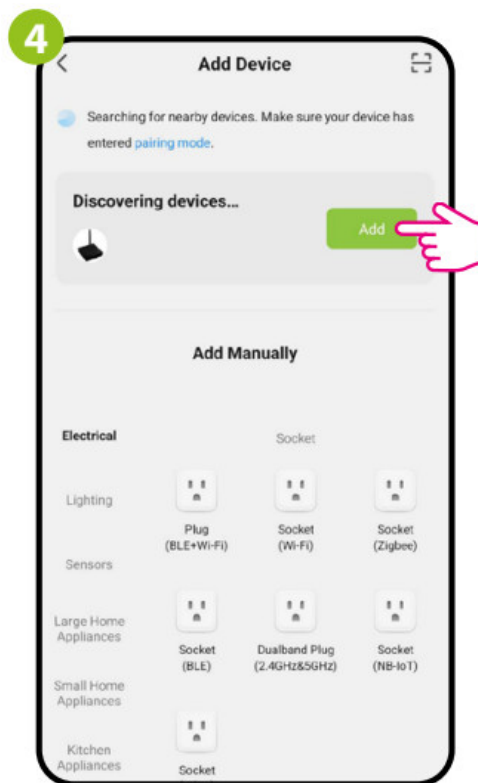

After finding the gateway, go „Add”



Wait for the app to configure the device.



Go „DONE“.

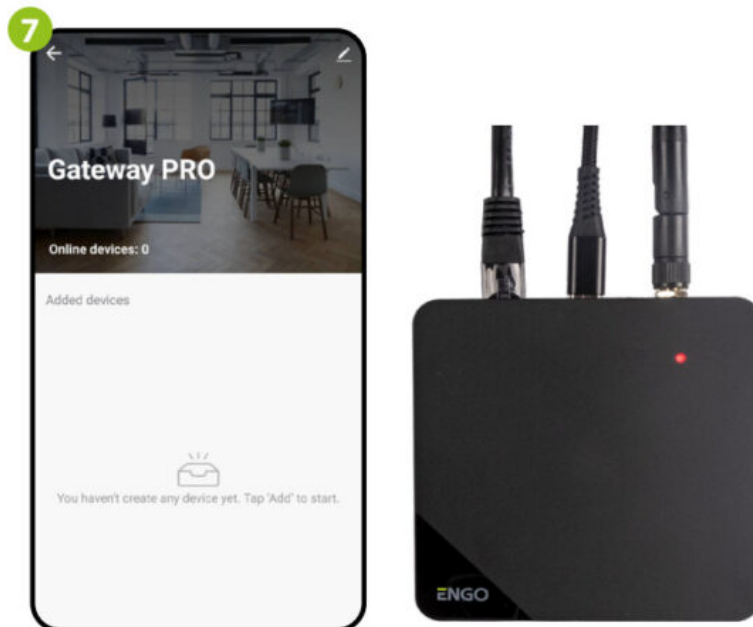

The gateway has been installed and displays the main interface. On the device, the red LED lights up continuously.

STEP 3b – Installation of the Internet gateway using a 2.4 GHz Wi-Fi network

After installing the app and creating an account:

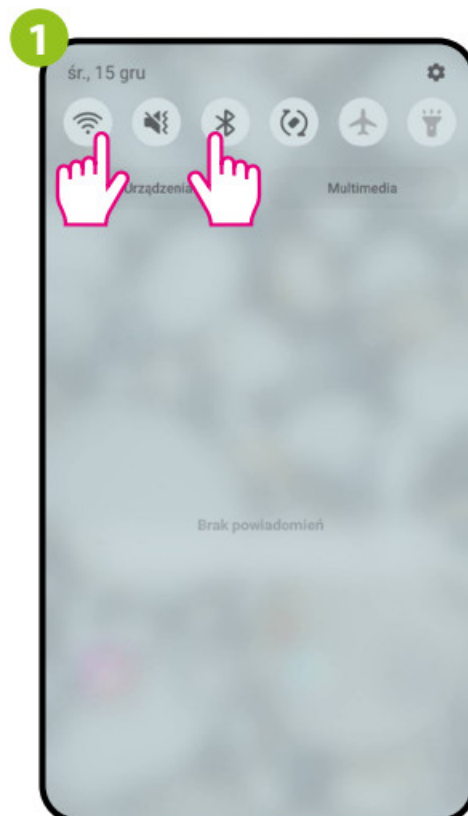

On the mobile device, make sure that the ENGO Smart app has access to the permissions (Location, Bluetooth, Nearby devices). Then turn on Bluetooth and location. Connect to that 2.4 GHz Wi-Fi network to which you want to assign the gateway (Wi-Fi and wired Ethernet must be one network – from the same router).



Make sure the unit is powered on. Then press and hold the RESET button (1) (using the pin provided) for 10 seconds. The red LED must flash slowly, then the gateway is in pairing mode. If the red LED flashes quickly, then press the RESET button again for 10 seconds, wait a moment and make sure the red LED flashes slowly.

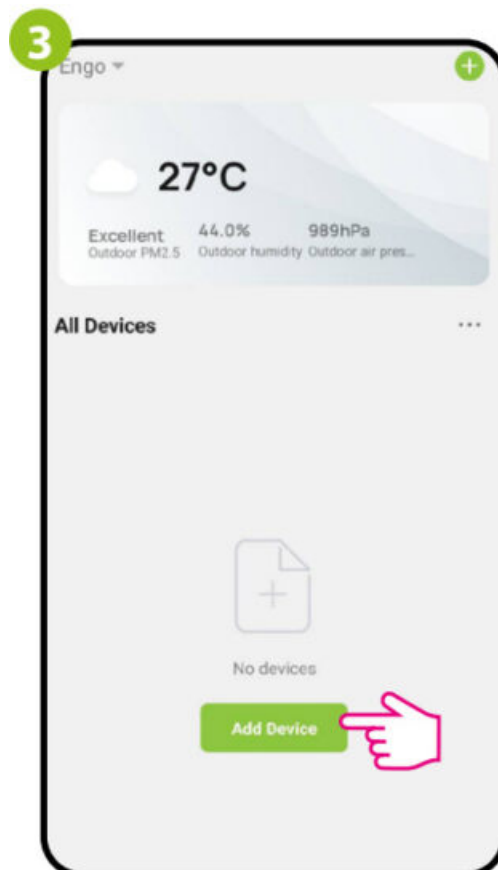

In the app, select: „Add Device”.

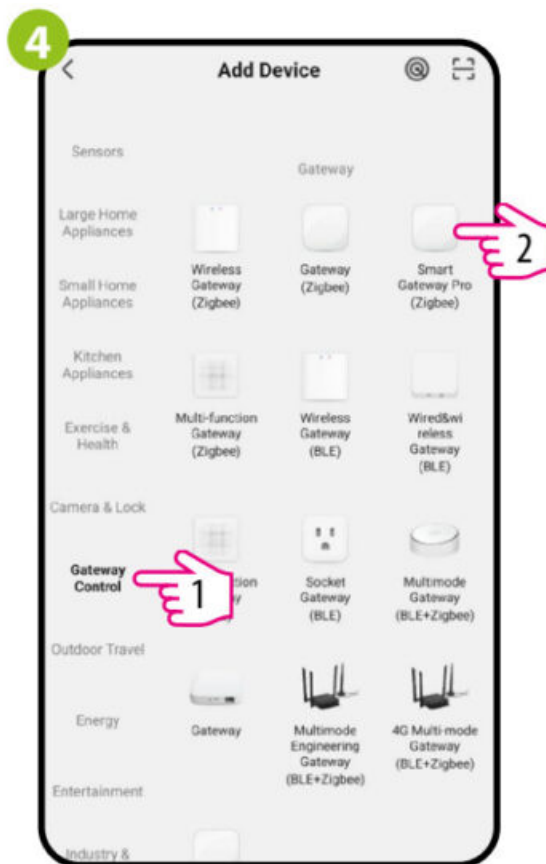

Go to the „Gateway Control” tab, then select „Smart Gateway Pro (Zigbee)”.

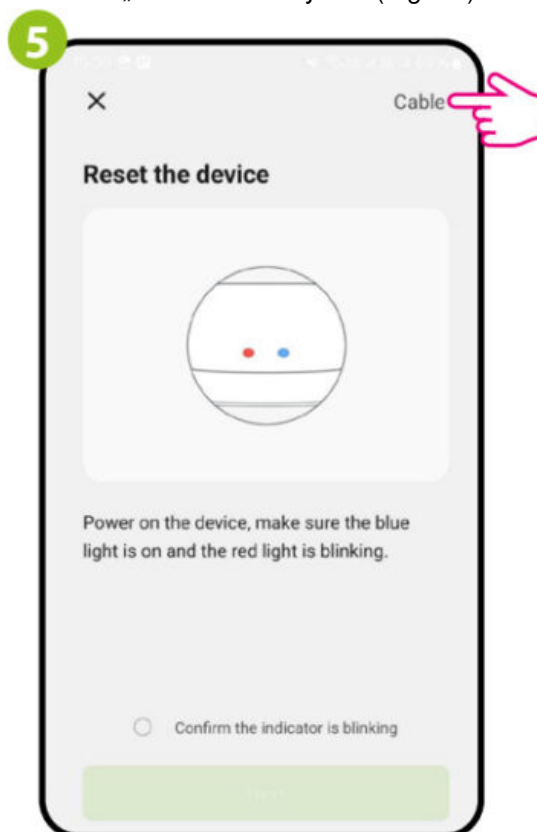

Click „Cable”.

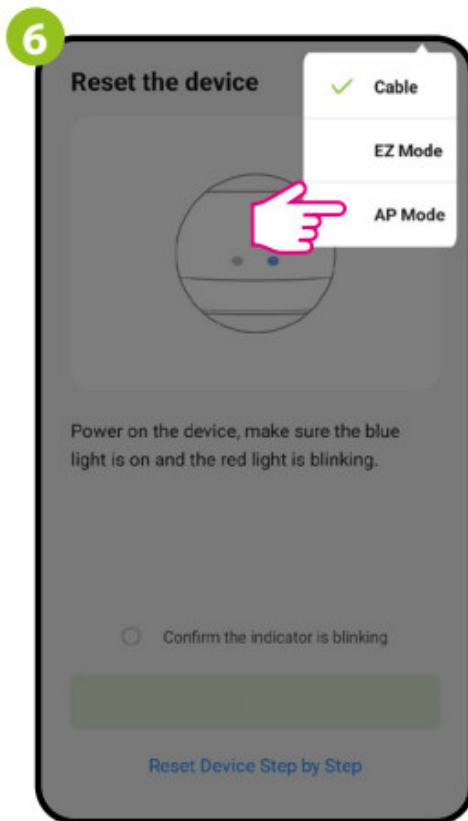

Select „AP Mode”.

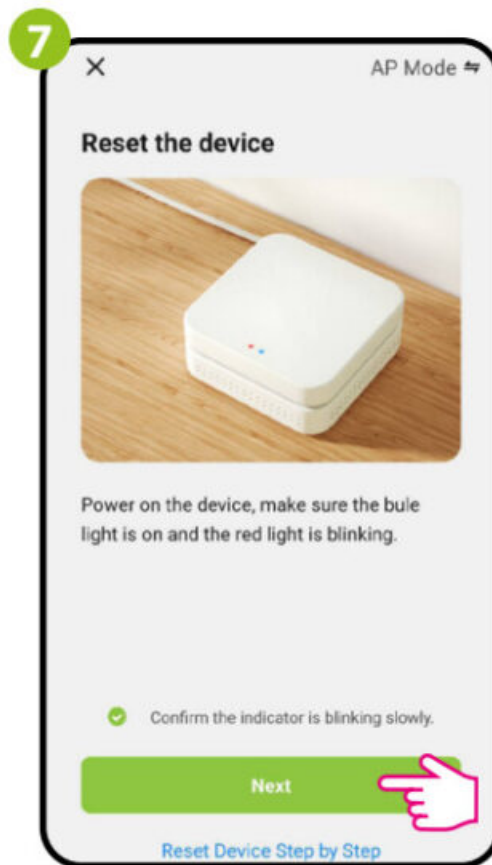

Check the required field and go „Next”.



Select the Wi-Fi network in which the gateway will operate and enter the password of this network.

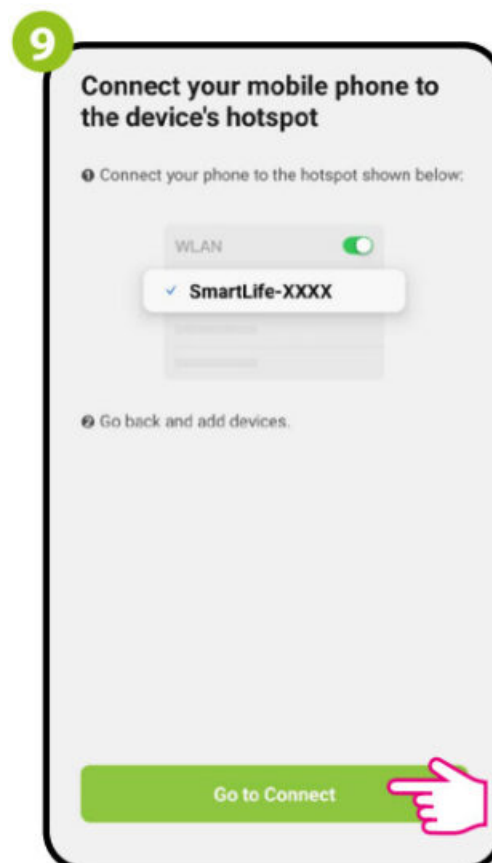

Click „Go to Connect”.

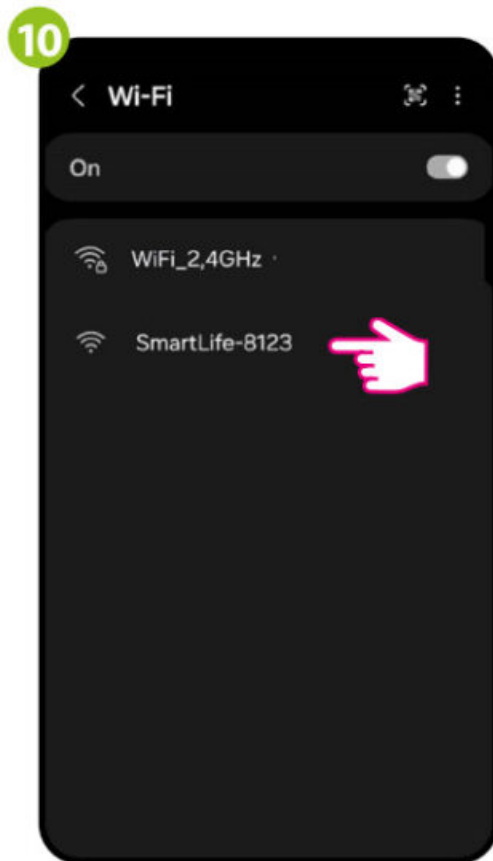

The device will go to the Wi-Fi network settings screen. Select the „SmartLife-XXXX” network and connect to it.

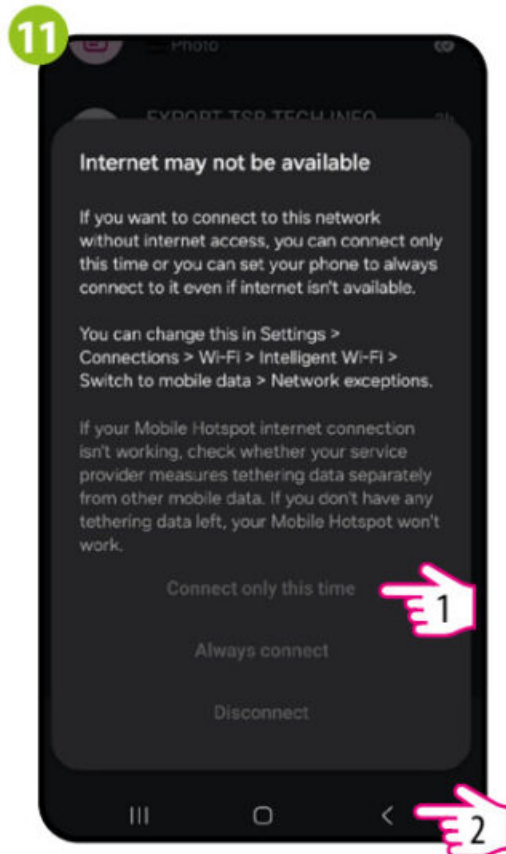

Once the network has been configured, select „Connect only this time”, then click „Back”.

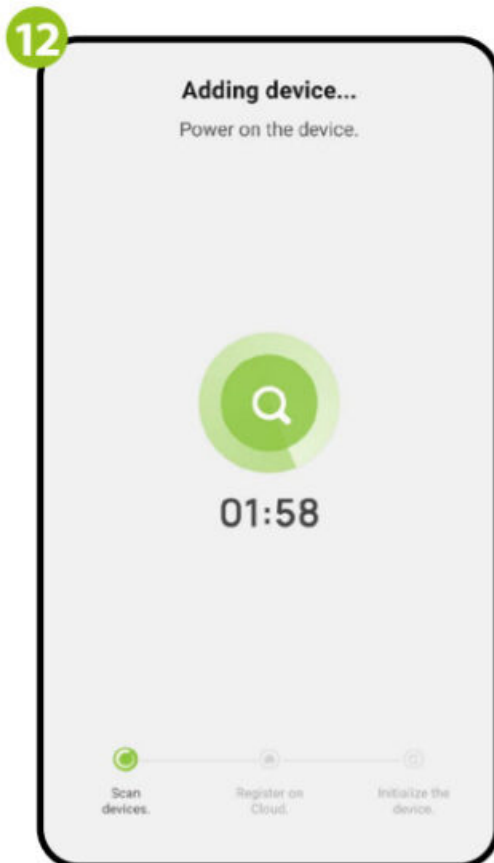

Wait for the app to configure the device.

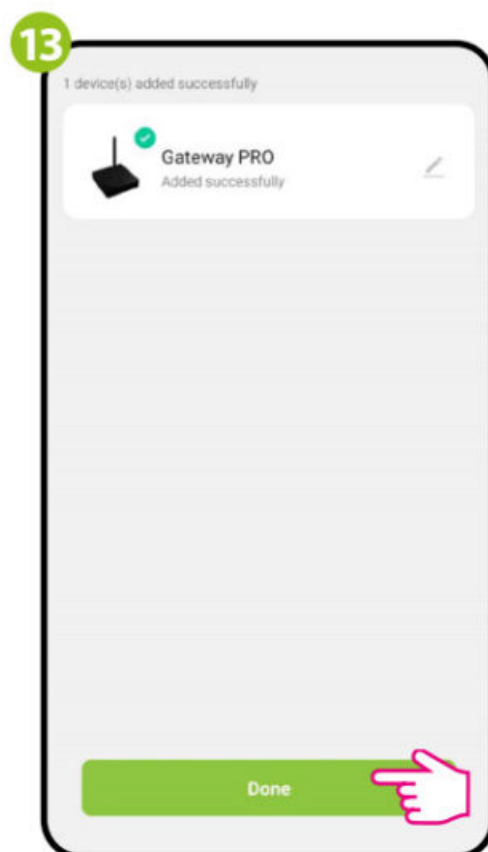

Go „DONE”.

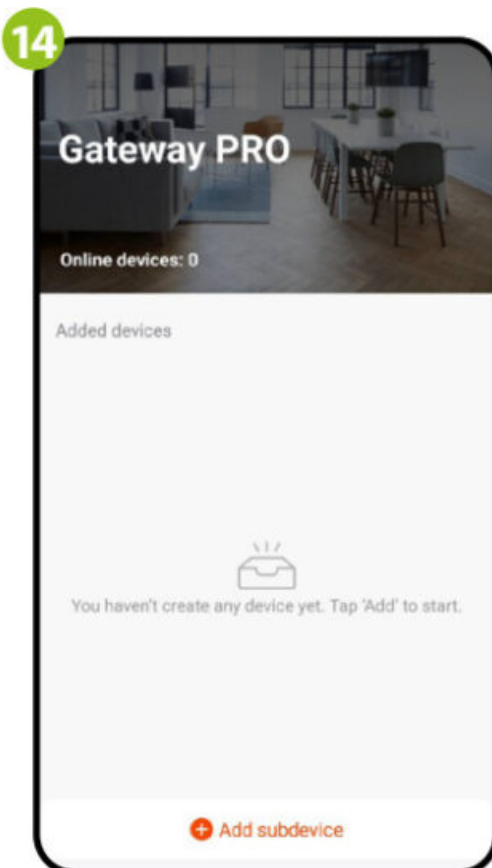

The gateway has been installed and displays the main interface. On the device, the red LED lights up continuously.

Factory reset



To restore the default settings of the device, press the RESET button (1) and hold it for approx. 10 seconds – until both LEDs light up. Then release the button, the universal internet gateway will restore the default (factory) values and the pairing process will begin.



Ver. 1.0

Release date: VII 2024

Soft:

Main module: v1.10.0

ZigBee module: v1.0.13

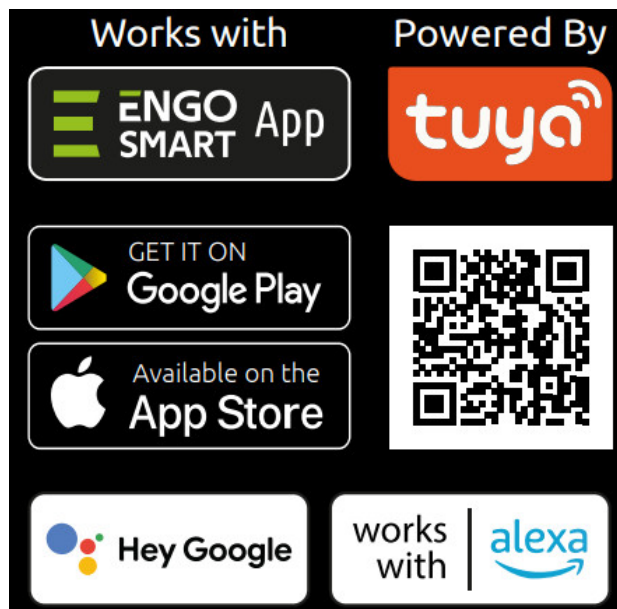

<https://engocontrols.com/redirect-app/>



Producer:

Engo Controls sp. z o.o. sp. k.

Rolna 4 st.

43-262 Kobielice Poland

www.engocontrols.com

Documents / Resources

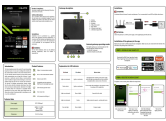
	ENGO CONTROLS EGATE-PRO ZigBee Universal Gateway [pdf] User Guide EGATE-PRO ZigBee Universal Gateway, EGATE-PRO, ZigBee Universal Gateway, Universal Gateway, Gateway
---	--

References

- [User Manual](#)

[Manuals±](#), [Privacy Policy](#)

This website is an independent publication and is neither affiliated with nor endorsed by any of the trademark owners. The "Bluetooth®" word mark and logos are registered trademarks owned by Bluetooth SIG, Inc. The "Wi-Fi®" word mark and logos are registered trademarks owned by the Wi-Fi Alliance. Any use of these marks on this website does not imply any affiliation with or endorsement.